

GULF INTRACOASTAL WATERWAY CALOOSAHATCHEE RIVER TO ANCLOTE RIVER LEE COUNTY, FLORIDA EXAMINATION SURVEY FY24 9-FOOT PROJECT

SURVEY NOTES

- REFER TO SURVEY NO. 24-088.
- SOUNDINGS ARE IN FEET AND TENTHS AND REFER TO NOAA'S REPORTED MEAN LOWER LOW WATER (MLLW) OF THE 1983-2001 TIDAL EPOCH.
- TIDAL REDUCTIONS WERE OBTAINED UTILIZING A REAL-TIME KINEMATIC (RTK) GPS AND REFERENCED TO MLLW UTILIZING A HYBRID KINEMATIC TIDE DATUM (KTD) MODEL. KTD FILE NAME IS: "SPC-FL-WEST-2010-12-07.KTD".
- ALL ELEVATIONS ARE BELOW THE CHART DATUM UNLESS PRECEDED BY A (+) SIGN.
- PLANE COORDINATES ARE BASED ON THE TRANSVERSE MERCATOR PROJECTION FOR THE WEST ZONE OF FLORIDA AND REFERENCED TO NORTH AMERICAN DATUM OF 1983 (NAD83).
- ALL STATIONING REFERS TO THE CENTERLINE OF THE CHANNEL.
- THIS SURVEY WAS PERFORMED USING FLORIDA PERMANENT REFERENCE NETWORK (NTRIP) FOR REAL-TIME KINEMATIC (RTK) GPS POSITIONING FOR ALL CUTS.
- DEPTHS DEPICTED BY THIS SURVEY ARE REFERENCED TO MLLW, TIDAL EPOCH 1983-2001 AS REPORTED BY THE NATIONAL OCEANIC AND ATMOSPHERIC ADMINISTRATION (NOAA). NOAA'S DATUM MODEL WAS USED AND CALIBRATED TO THE PUBLISHED MLLW HEIGHTS OF THE BENCHMARKS ASSOCIATED WITH THE TIDE GAGE SITE SPECIFIED BELOW:

NOAA TIDAL STATION "872 5479 A" FOR ENTIRE PROJECT (PID: DR9234)
VERTICAL MEASUREMENTS WERE MADE USING A RESON SEBAT T-50 MULTI-BEAM. ALL SOUNDINGS SHOWN ARE IN HIGH FREQUENCY.
- NOAA TIDAL STATION "872 5479 A" FOR ENTIRE PROJECT (PID: DR9234)
VERTICAL MEASUREMENTS WERE MADE USING A RESON SEBAT T-50 MULTI-BEAM. ALL SOUNDINGS SHOWN ARE IN HIGH FREQUENCY.
- DESIGNED BY: WRM
DRAWN BY: WRM
FILE NO.: 24-088-9S-ORIP-LEE.DGN
DATE: APR 2024
- NOAA TIDAL STATION "872 5479 A" FOR ENTIRE PROJECT (PID: DR9234)
VERTICAL MEASUREMENTS WERE MADE USING A RESON SEBAT T-50 MULTI-BEAM. ALL SOUNDINGS SHOWN ARE IN HIGH FREQUENCY.
- NOAA TIDAL STATION "872 5479 A" FOR ENTIRE PROJECT (PID: DR9234)
VERTICAL MEASUREMENTS WERE MADE USING A RESON SEBAT T-50 MULTI-BEAM. ALL SOUNDINGS SHOWN ARE IN HIGH FREQUENCY.
- NOAA TIDAL STATION "872 5479 A" FOR ENTIRE PROJECT (PID: DR9234)
VERTICAL MEASUREMENTS WERE MADE USING A RESON SEBAT T-50 MULTI-BEAM. ALL SOUNDINGS SHOWN ARE IN HIGH FREQUENCY.
- NOAA TIDAL STATION "872 5479 A" FOR ENTIRE PROJECT (PID: DR9234)
VERTICAL MEASUREMENTS WERE MADE USING A RESON SEBAT T-50 MULTI-BEAM. ALL SOUNDINGS SHOWN ARE IN HIGH FREQUENCY.
- NOAA TIDAL STATION "872 5479 A" FOR ENTIRE PROJECT (PID: DR9234)
VERTICAL MEASUREMENTS WERE MADE USING A RESON SEBAT T-50 MULTI-BEAM. ALL SOUNDINGS SHOWN ARE IN HIGH FREQUENCY.
- SURVEY ACCURACY PERFORMANCE STANDARDS, QUALITY CONTROL, AND QUALITY ASSURANCE REQUIREMENTS WERE FOLLOWED DURING THIS SURVEY IN ACCORDANCE WITH USACE EM 1110-2-1003, HYDROGRAPHIC SURVEYING, 30 NOV 2013.

VESSEL	DATE OF SURVEY	CUT
SV AMELIA	26 MAR 2024	L-11
SV AMELIA	27 MAR 2024	L-6 THRU L-10
SV AMELIA	29 MAR 2024	L-1 THRU L-5
SV AMELIA	22 APR 2024	L-22
SV AMELIA	23 APR 2024	L-14 THRU L-21
SV AMELIA	24 APR 2024	L-12 & L-13

LEGEND	
	MONUMENT
	LIGHTED BEACON
	GREEN DAYBEACON
	RED DAYBEACON
	RED LIGHTED BUOY
	GREEN LIGHTED BUOY
	CAN BUOY
	NUN BUOY
	TIDE STAFF
	PROJECT DEPTH

US Army Corps of Engineers
Jacksonville District
SAFETY ON THIS JOB DEPENDS ON YOU

DEPARTMENT OF THE ARMY
JACKSONVILLE DISTRICT, CORPS OF ENGINEERS
JACKSONVILLE, FLORIDA

DESIGNED BY: WRM
DRAWN BY: WRM
FILE NO.: 24-088-9S-ORIP-LEE.DGN
DATE: APR 2024

GULF INTRACOASTAL WATERWAY
CALOOSAHATCHEE RIVER TO ANCLOTE RIVER
LEE COUNTY, FLORIDA
**HYDROGRAPHIC EXAMINATION SURVEY FY24
9-FOOT PROJECT**
INDEX, LOCATION AND VICINITY MAP

Scale: AS SHOWN
Drawing no. **1**
SHEET 01 OF 48

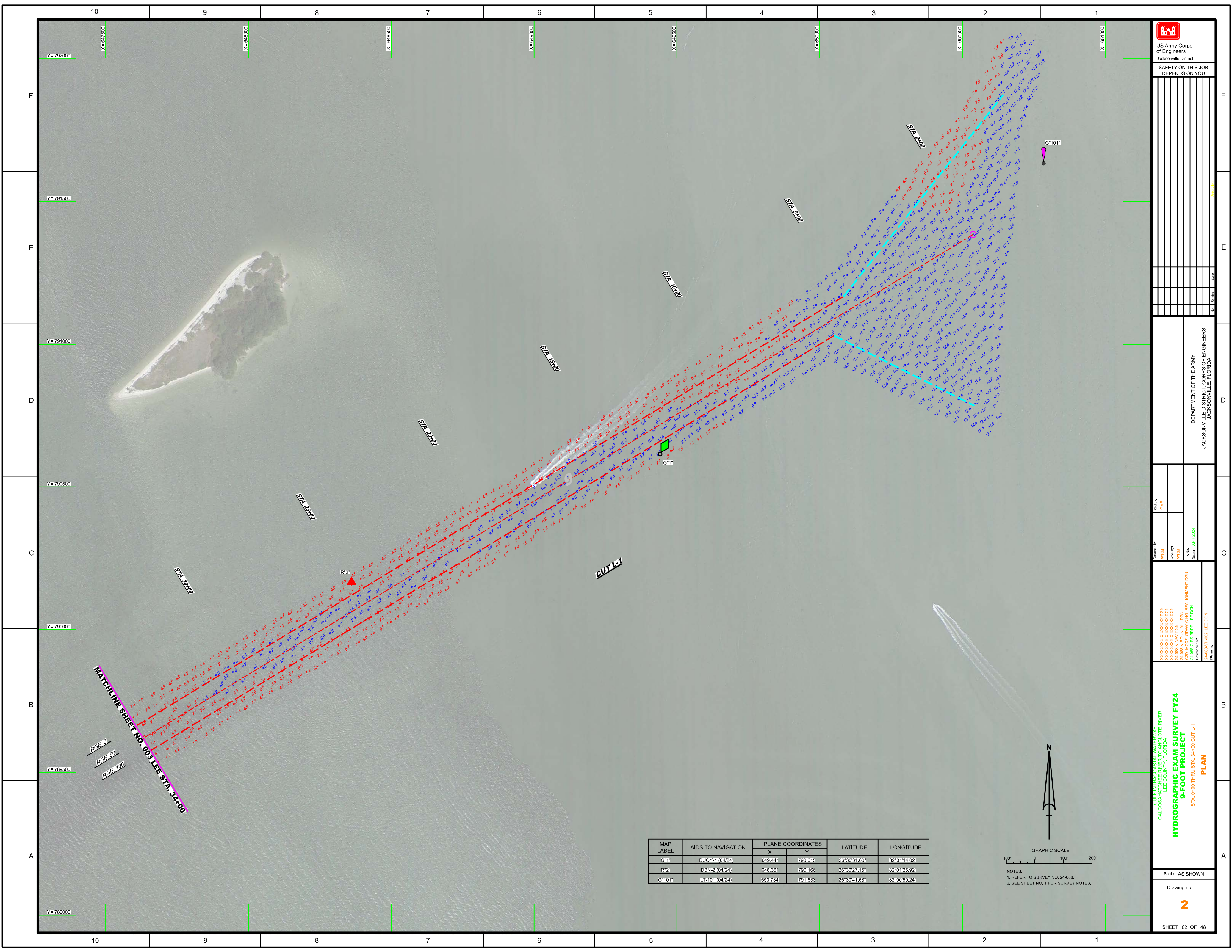

US Army Corps of Engineers

 Jacksonville District

SAFETY ON THIS JOB DEPENDS ON YOU

DEPARTMENT OF THE ARMY

 JACKSONVILLE DISTRICT, CORPS OF ENGINEERS

 JACKSONVILLE, FLORIDA

MAP LABEL	AIDS TO NAVIGATION	PLANE COORDINATES		LATITUDE	LONGITUDE
		X	Y		
G*1*	BUOY-1 (04/24)	649,441	790,615	26°30'31.60"	82°01'14.02"
R*2	DBN-2 (04/24)	648,361	790,166	26°30'27.15"	82°01'25.92"
G*101*	L=101 (04/24)	650,784	791,633	26°30'41.65"	82°00'59.24"

GRAPHIC SCALE
 0 100' 200'

NOTES:
 1. REFER TO SURVEY NO. 24-088.
 2. SEE SHEET NO. 1 FOR SURVEY NOTES.

GULF INTRACOSTAL WATERWAY
 CALOOSAHEE RIVER
 CALOOSAHEE COUNTY, FLORIDA

HYDROGRAPHIC EXAM SURVEY FY24
9-FOOT PROJECT
 STA. 0+00 THRU STA. 34+00 CUT L-1
PLAN

Scale: AS SHOWN
 Drawing no. **2**
 SHEET 02 OF 48



US Army Corps
of Engineers
Jacksonville District

SAFETY ON THIS JOB
DEPENDS ON YOU

NO.	DATE	DESCRIPTION	BY	CHECKED

DEPARTMENT OF THE ARMY
JACKSONVILLE DISTRICT, CORPS OF ENGINEERS
JACKSONVILLE, FLORIDA

Checked By: GHR
Designed By: WRM
Drawn By: WRM
File No.: 24-088-03-BR-001-LEE
Date: APR 2024

XXXXXXXXXXXXXXXXXXXX.DGN
XXXXXXXXXXXXXXXXXXXX.DGN
XXXXXXXXXXXXXXXXXXXX.DGN
XXXXXXXXXXXXXXXXXXXX.DGN
XXXXXXXXXXXXXXXXXXXX.DGN
XXXXXXXXXXXXXXXXXXXX.DGN
XXXXXXXXXXXXXXXXXXXX.DGN
XXXXXXXXXXXXXXXXXXXX.DGN

GULF INTRACOSTAL WATERWAY
CALOOSAHATCHEE COUNTY, FLORIDA
HYDROGRAPHIC EXAM SURVEY FY24
9-FOOT PROJECT
STA. 72+00 THRU STA. 110+00 CUT L-1
PLAN

Scale: AS SHOWN
Drawing no.

4
SHEET 04 OF 48



MAP LABEL	AIDS TO NAVIGATION	PLANE COORDINATES		LATITUDE	LONGITUDE
		X	Y		
G°5'	DBNS (04/24)	642,812	786,621	26°29'52.02"	82°02'26.88"
R°6'	LT-6 (04/24)	642,733	786,749	26°29'53.29"	82°02'27.85"

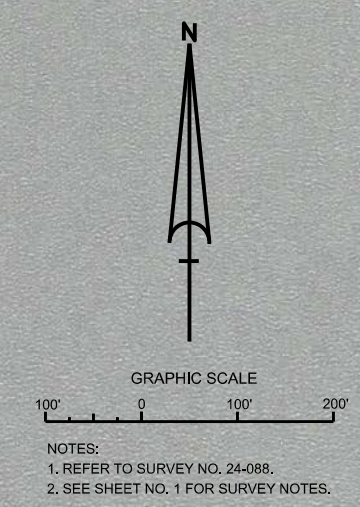

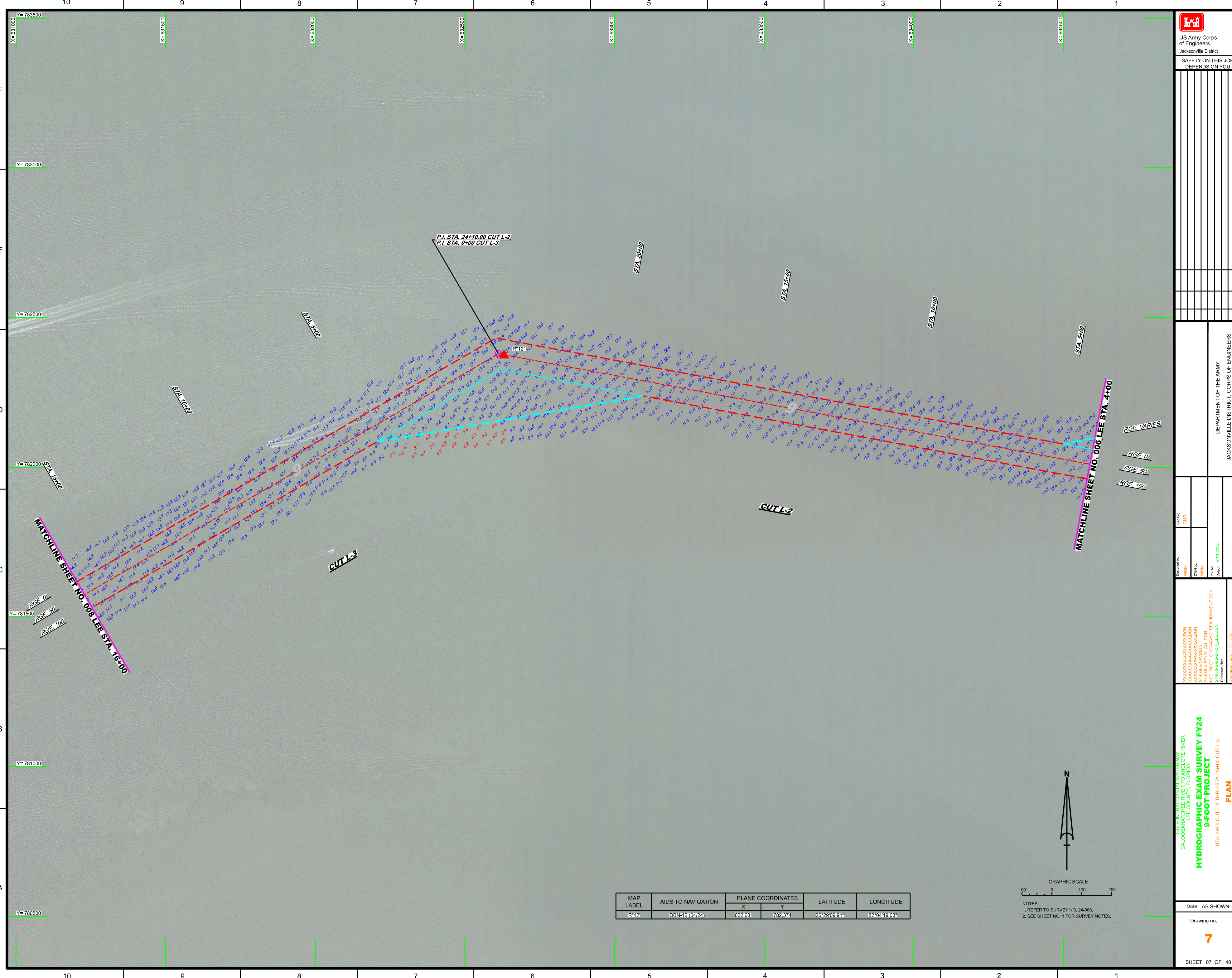

MAP LABEL	AIDS TO NAVIGATION	PLANE COORDINATES		LATITUDE	LONGITUDE
		X	Y		
R*12	DBN*12 (04/24)	632.631	782.374	23°29'09.91"	82°04'19.03"

GRAPHIC SCALE
 100' 0 100' 200'
 NOTES:
 1. REFER TO SURVEY NO. 24-088;
 2. SEE SHEET NO. 1 FOR SURVEY NOTES.

US Army Corps of Engineers
Jacksonville District

SAFETY ON THIS JOB
DEPENDS ON YOU

XXXXXXXXXXXXXXXXXXXX.DGN
 XXXXXXXXX\HW.DGN
 XXXXXXXXX\HW.DGN
 C:\D:\ACCS\G\M\C\ACS\REALIGNMENT.DGN
 C:\D:\ACCS\G\M\C\ACS\HW.DGN
 C:\D:\ACCS\G\M\C\ACS\HW.DGN
 XXXXXXX\HW.DGN

Checked by: GHR
 Drawn by: WRM
 Title: APR 2024

HYDROGRAPHIC EXAM SURVEY FY24
9-FOOT PROJECT
 STA. 4+00 CUT L-2 THRU STA. 16+00 CUT L-3
PLAN

Scale: AS SHOWN
 Drawing no. 7

SHEET 07 OF 48

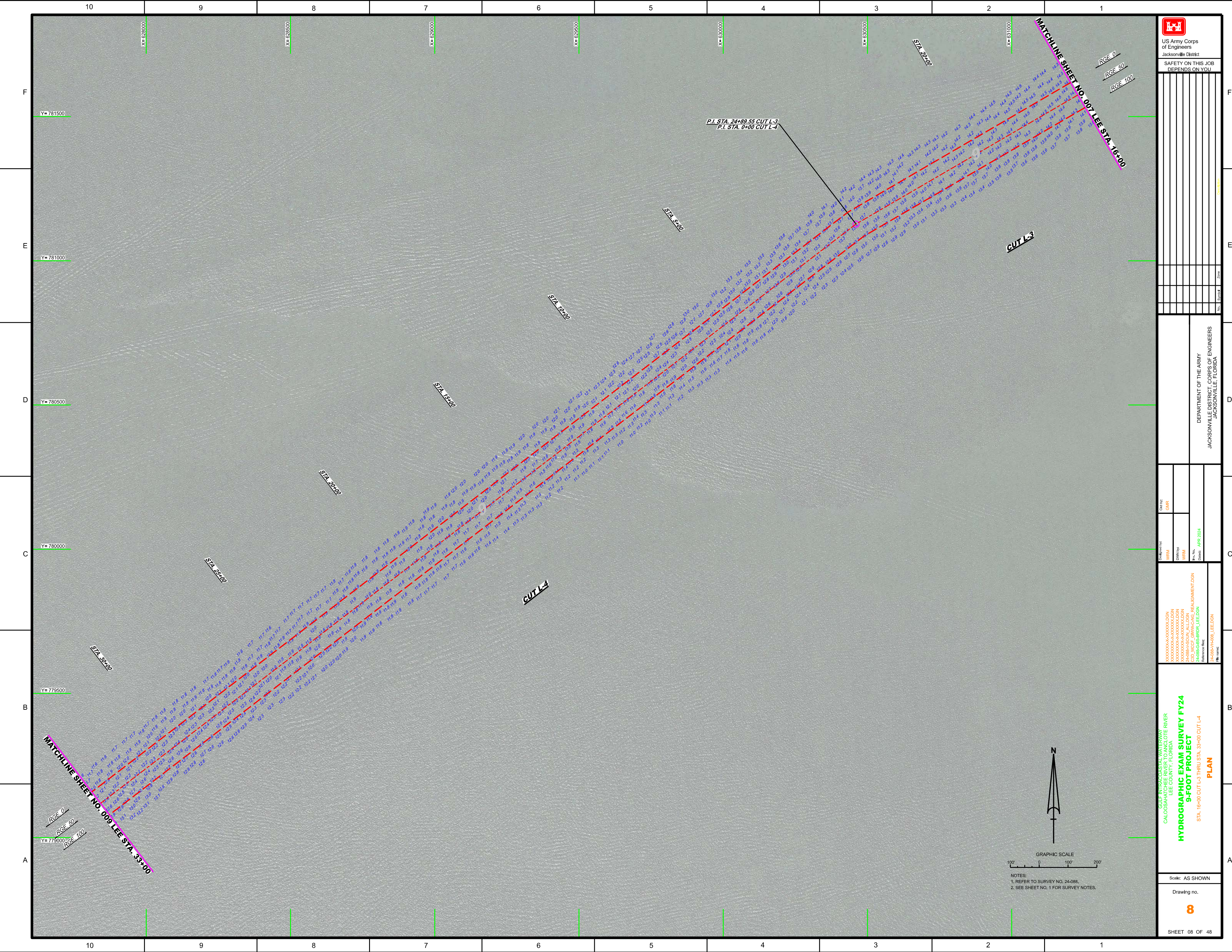

US Army Corps of Engineers
Jacksonville District
SAFETY ON THIS JOB DEPENDS ON YOU

NO.	REVISION	DATE

DEPARTMENT OF THE ARMY
JACKSONVILLE DISTRICT, CORPS OF ENGINEERS
JACKSONVILLE, FLORIDA

Checked by: GMR
Designed by: WRM
Drawn by: WRM
File No.: APR 2024
Drawing Date: APR 2024

XXXXXXXXXXXXXXXXXXXX.DGN
XXXXXXXXXXXXXXXXXXXX.DGN
XXXXXXXXXXXXXXXXXXXX.DGN
C:\D:\ACCS\GWR\ACCS_REALIGNMENT.DGN
#4088C-B3-BR01_LEE.DGN
#4088C-H0401_LEE.DGN

GULF INTRACOSTAL WATERWAY
CALOOSAHATCHEE COUNTY, FLORIDA
**HYDROGRAPHIC EXAM SURVEY FY24
9-FOOT PROJECT
STA. 16+00 CUT L-3 THRU STA. 33+00 CUT L-4
PLAN**

Scale: AS SHOWN
Drawing no. **8**
SHEET 08 OF 48

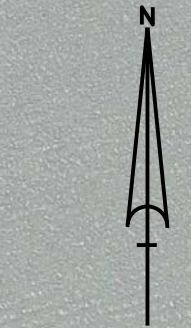

GRAPHIC SCALE
100' 0 100' 200'

NOTES:
1. REFER TO SURVEY NO. 24-088;
2. SEE SHEET NO. 1 FOR SURVEY NOTES.



<p>US Army Corps of Engineers Jacksonville District</p>	
<p>SAFETY ON THIS JOB DEPENDS ON YOU</p>	
<p>XXXXXXXXXXXXXXXXXXXX.DGN XXXXXXXXXXXXXXXXXXXX.DGN XXXXXXXXXXXXXXXXXXXX.DGN C:\D:\ACCS\GHWAC\ACS_REALIGNMENT.DGN 24-088-C-ES-RIPR_LEE.DGN 24-088-H\H06_L_EE.DGN</p>	<p>Checked by: GHR Designed by: WRM Drawn by: WRM File No: 24-088 Date: APR 2024</p>
<p>DEPARTMENT OF THE ARMY JACKSONVILLE DISTRICT, CORPS OF ENGINEERS JACKSONVILLE, FLORIDA</p>	
<p>HYDROGRAPHIC EXAM SURVEY FY24 9-FOOT PROJECT STA. 33+00 CUT L-4 THRU STA. 14+00 CUT L-5 PLAN</p>	
<p>Scale: AS SHOWN</p>	
<p>Drawing no. 9</p>	
<p>SHEET 09 OF 48</p>	

GRAPHIC SCALE
100' 0 100' 200'

NOTES:
1. REFER TO SURVEY NO. 24-088;
2. SEE SHEET NO. 1 FOR SURVEY NOTES.

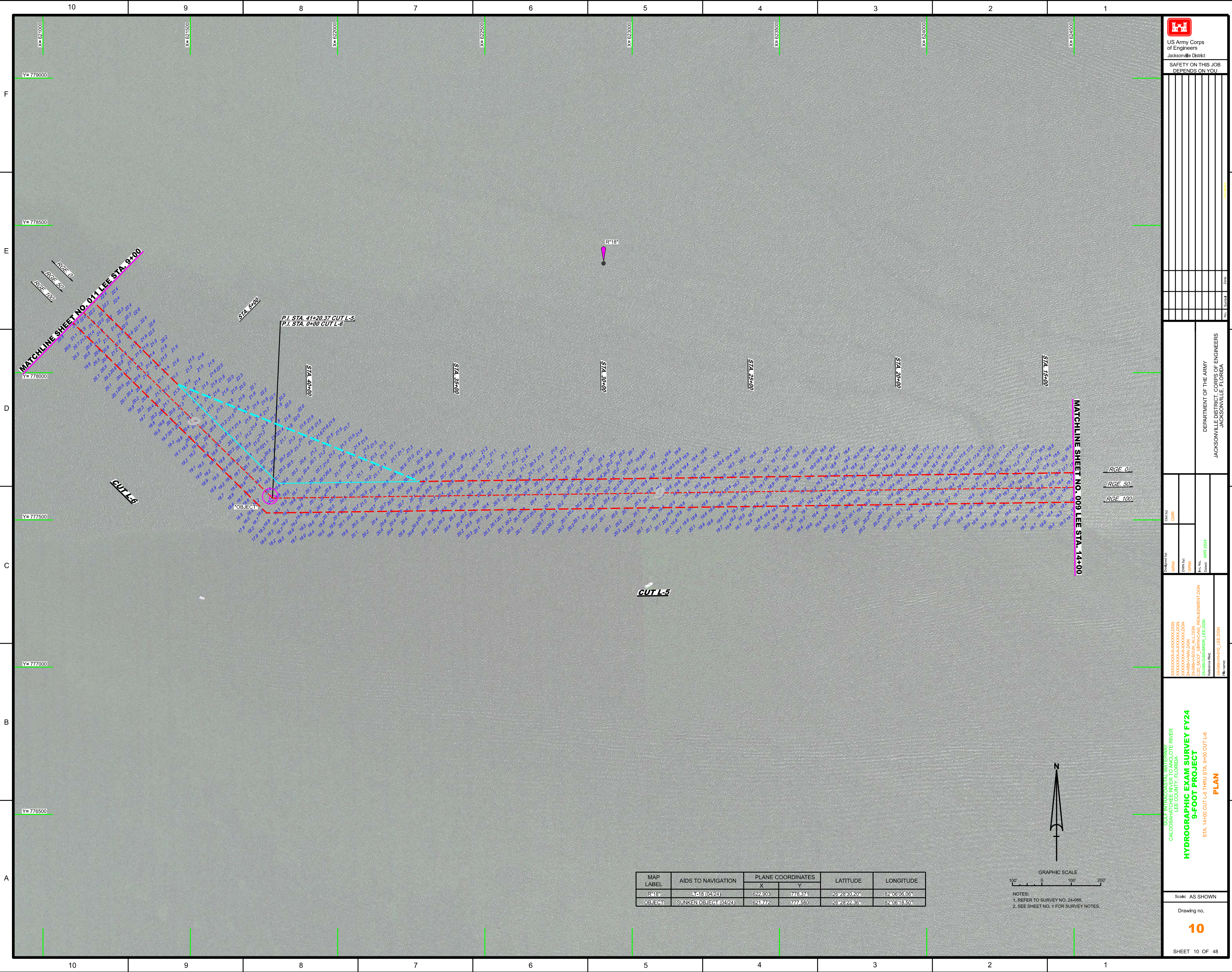



 US Army Corps of Engineers
 Jacksonville District
 SAFETY ON THIS JOB
 DEPENDS ON YOU

Checked By:	GHR
Designed By:	WRM
DRAWN BY:	WRM
File No.:	24-0886-09-009
Drawn Date:	APR 2024

GULF INTRACOSTAL WATERWAY
 CALOOSAHATCHEE COUNTY, FLORIDA
HYDROGRAPHIC EXAM SURVEY FY24
9-FOOT PROJECT
 STA. 14+00 CUT L-5 THRU STA. 9+00 CUT L-6
PLAN

MAP LABEL	AIDS TO NAVIGATION	PLANE COORDINATES		LATITUDE	LONGITUDE
		X	Y		
R*18"	LT-18 (04/24)	622,903	776,371	28°28'30.20"	82°06'06.06"
OBJECT	SUNKEN OBJECT (04/24)	621,772	777,580	28°28'22.35"	82°06'18.50"

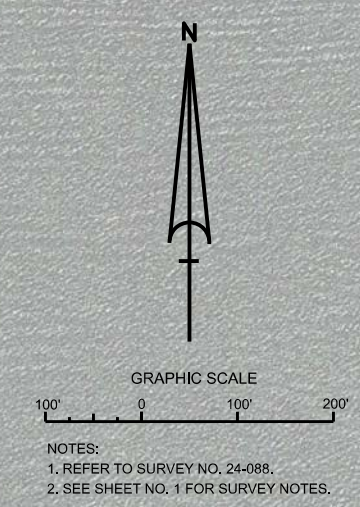

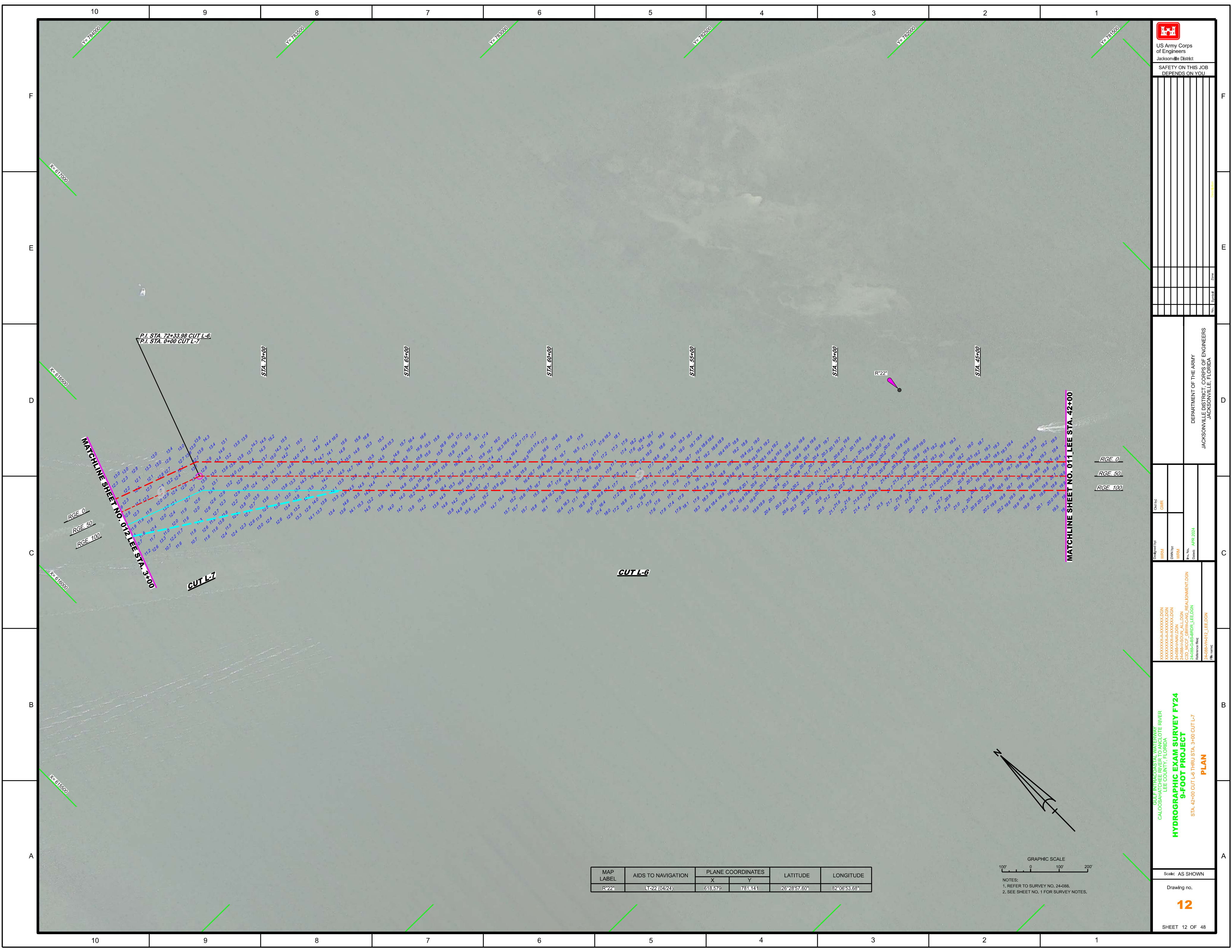

MAP LABEL	AIDS TO NAVIGATION	PLANE COORDINATES		LATITUDE	LONGITUDE
		X	Y		
R'22'	11222 (04/24)	618.579	781.141	28°28'57.60"	82°06'53.68"

GRAPHIC SCALE
 100' 0 100' 200'
 NOTES:
 1. REFER TO SURVEY NO. 24-088.
 2. SEE SHEET NO. 1 FOR SURVEY NOTES.

MATCHLINE SHEET NO. 012 LEE STA. 3+00
 CUT L-7
 RGE 0
 RGE 50
 RGE 100

MATCHLINE SHEET NO. 011 LEE STA. 42+00
 RGE 0
 RGE 50
 RGE 100

P.I. STA. 72+33.98 CUT L-6
 P.I. STA. 0+00 CUT L-7

STA. 70+00 STA. 65+00 STA. 60+00 STA. 55+00 STA. 50+00 STA. 45+00

CUT L-6

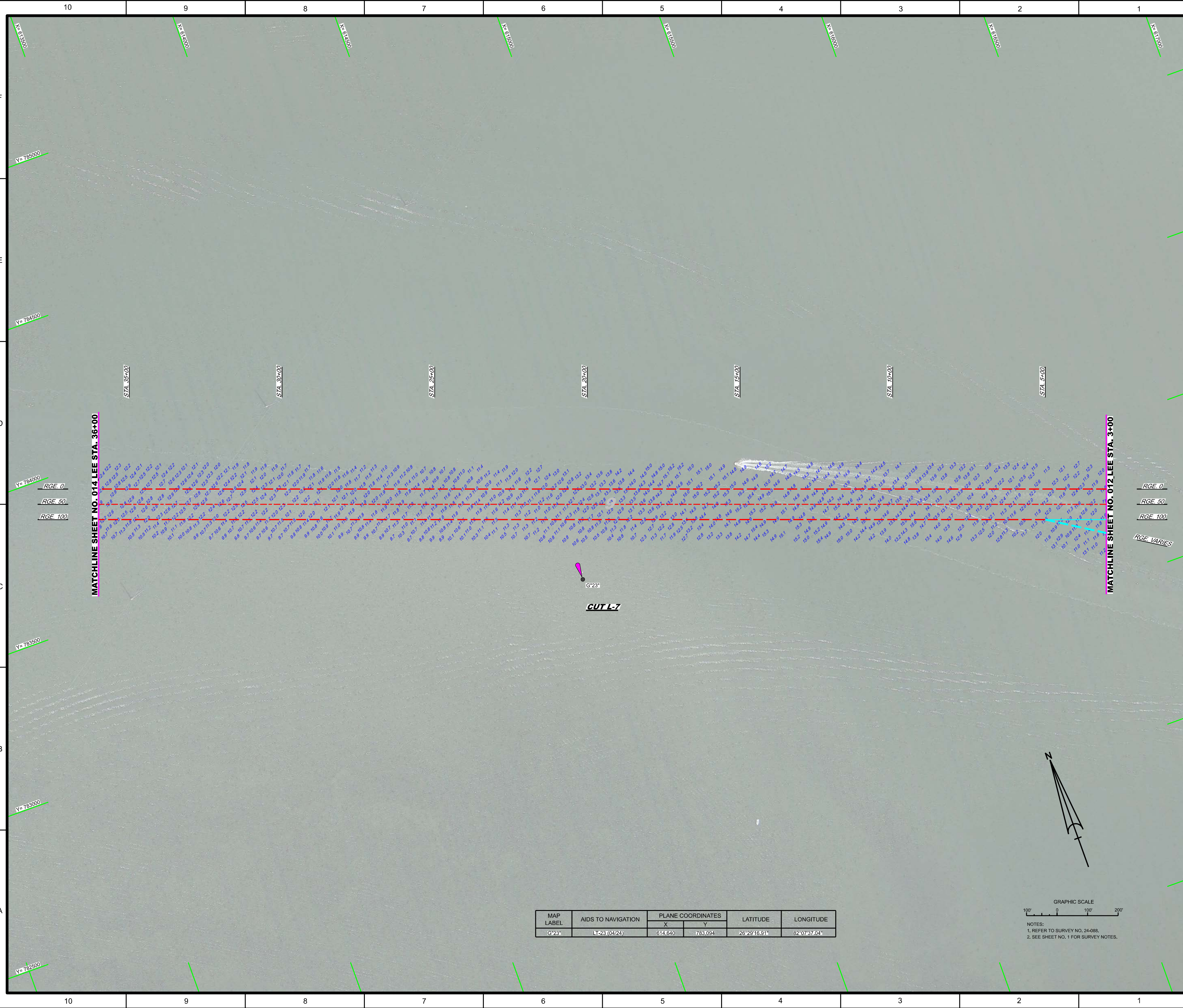



 US Army Corps

of Engineers

Jacksonville District

SAFETY ON THIS JOB

DEPENDS ON YOU

DEPARTMENT OF THE ARMY

JACKSONVILLE DISTRICT, CORPS OF ENGINEERS

JACKSONVILLE, FLORIDA

HYDROGRAPHIC EXAM SURVEY FY24

9-FOOT PROJECT

 STA. 3+00 THRU STA. 36+00 CUT L-7

PLAN

Scale: AS SHOWN

 Drawing no.

13

 SHEET 13 OF 48

MAP LABEL	AIDS TO NAVIGATION	PLANE COORDINATES		LATITUDE	LONGITUDE
		X	Y		
G*23*	LT-23 (04/24)	614.640	783.094	26°29'16.91"	82°07'37.04"

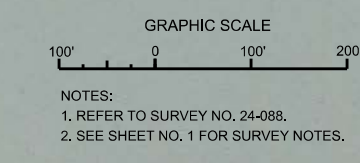

GULF INTRACOSTAL WATERWAY

CALCOOSON LEE COUNTY FLORIDA

 XXXXXXXXXXXXXXXXXXXX.DGN

XXXXXXXXXXXXXXXXXXXXX.DGN

XXXXXXXXXXXXXXXXXXXXX.DGN

XXXXXXXXXXXXXXXXXXXXX.DGN

XXXXXXXXXXXXXXXXXXXXX.DGN

XXXXXXXXXXXXXXXXXXXXX.DGN

XXXXXXXXXXXXXXXXXXXXX.DGN

 C:\D\ACCS\GWM\ACCS_REALIGNMENT.DGN

C:\D\ACCS\GWM\ACCS_REALIGNMENT.DGN

C:\D\ACCS\GWM\ACCS_REALIGNMENT.DGN

 Reference files:

 24-088-HA01-LEE.DGN

 File name:

MATCHLINE SHEET NO. 014 LEE STA. 36+00

MATCHLINE SHEET NO. 012 LEE STA. 3+00

10 9 8 7 6 5 4 3 2 1

F E D C B A

10 9 8 7 6 5 4 3 2 1

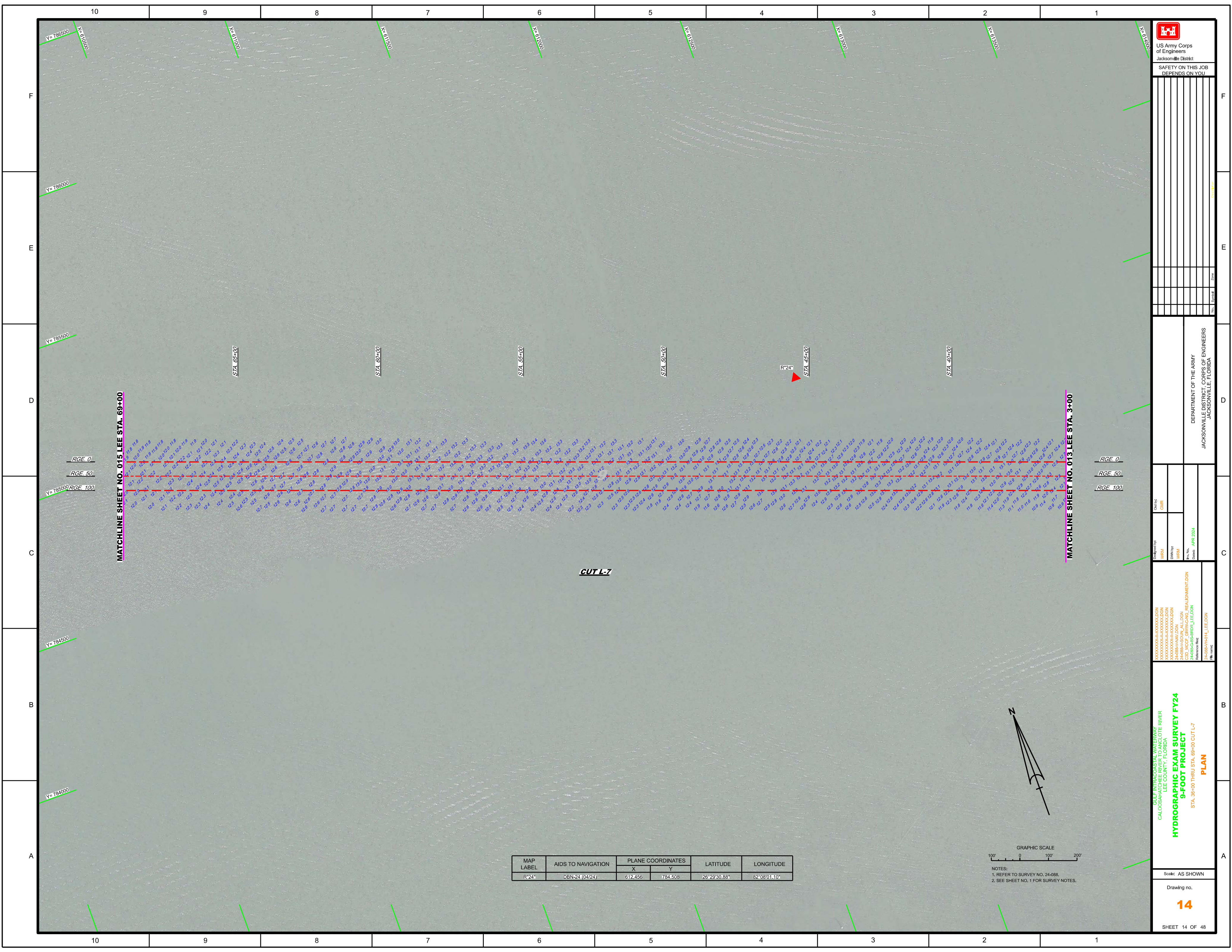

MAP LABEL	AIDS TO NAVIGATION	PLANE COORDINATES		LATITUDE	LONGITUDE
		X	Y		
R*24	DBN-24 (04/24)	612.456	784.508	26°29'30.88"	82°08'01.10"

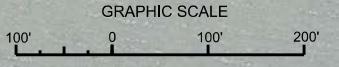

US Army Corps of Engineers
Jacksonville District
SAFETY ON THIS JOB DEPENDS ON YOU

DEPARTMENT OF THE ARMY
JACKSONVILLE DISTRICT, CORPS OF ENGINEERS
JACKSONVILLE, FLORIDA

Checked by: GHR
 Drawn by: WRM
 File No.: 24-088-G-BS-RR01-L-EE.DGN
 Date: APR 2024

GULF INTRACOUNTY WATERWAY
 CALOOSAHATCHEE COUNTY, FLORIDA
HYDROGRAPHIC EXAM SURVEY FY24
9-FOOT PROJECT
 STA. 38+00 THRU STA. 89+00 CUT L-7
PLAN

Scale: AS SHOWN
 Drawing no.
14
 SHEET 14 OF 48

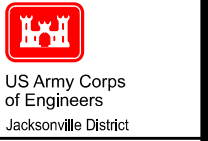

Jacksonville District

SAFETY ON THIS JOB
DEPENDS ON YOU

DEPARTMENT OF THE ARMY
JACKSONVILLE DISTRICT, CORPS OF ENGINEERS
JACKSONVILLE, FLORIDA

Checked By: GHR
Designed By: WRM
Drawn By: WRM
File No.: APR 2024
Revision: 1

XXXXXXXXXXXXXXXXXXXX.DGN
XXXXXXXXXXXXXXXXXXXX.DGN
XXXXXXXXXXXXXXXXXXXX.DGN
C:\projects\GHWACANS_REALIGNMENT.DGN
C:\projects\GHWACANS_REALIGNMENT.DGN
C:\projects\GHWACANS_REALIGNMENT.DGN

GULF INTRACOSTAL WATERWAY
CALOOSAHATCHEE COUNTY, FLORIDA
**HYDROGRAPHIC EXAM SURVEY FY24
9-FOOT PROJECT**
STA. 89+00 CUT L-7 THRU STA. 3+00 CUT L-9
PLAN

Scale: AS SHOWN

Drawing no.

15

SHEET 15 OF 48

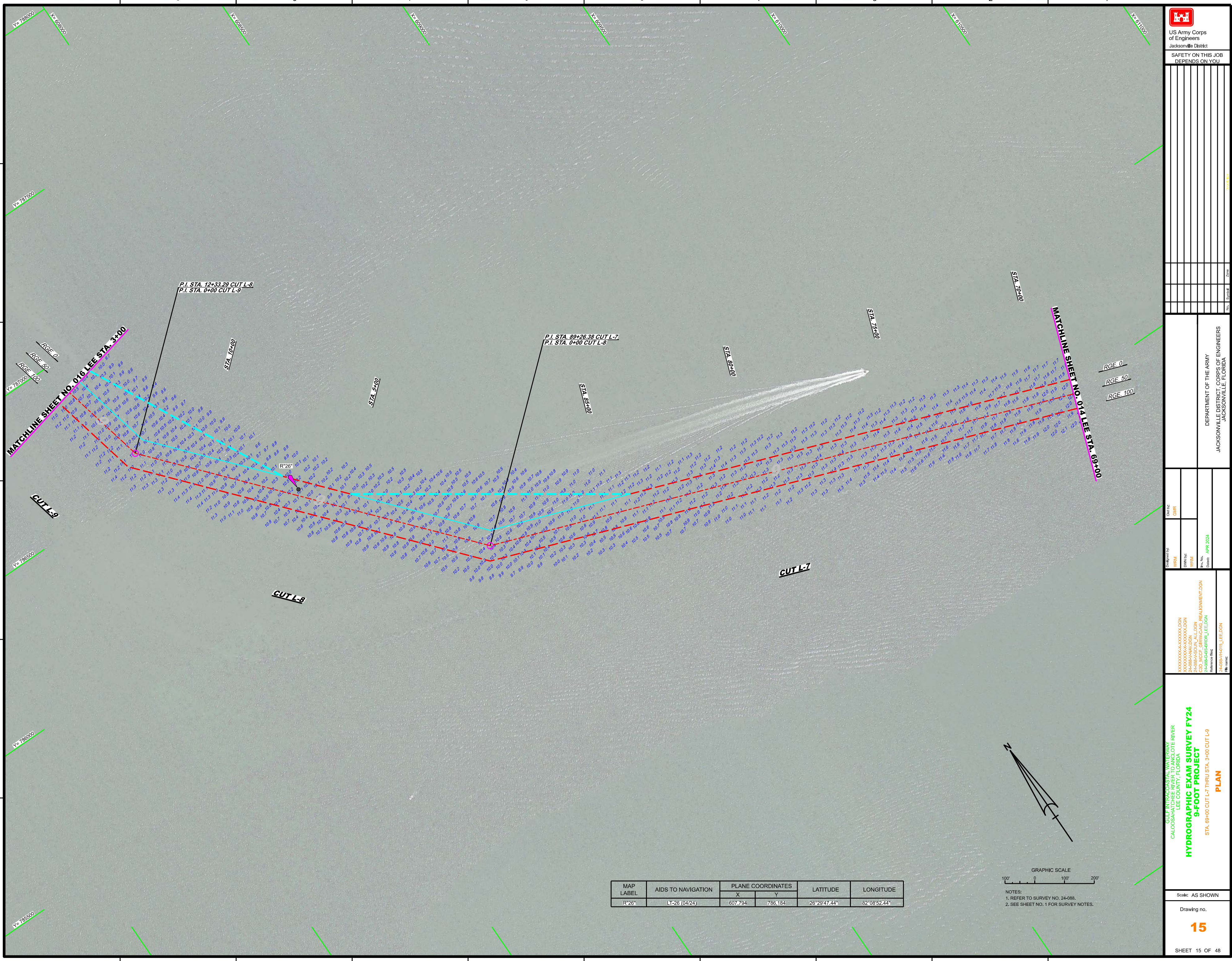

MAP LABEL	AIDS TO NAVIGATION	PLANE COORDINATES		LATITUDE	LONGITUDE
		X	Y		
R'26°	LT-26 (04/24)	607,794	786,184	26°29'47.44"	82°08'52.44"

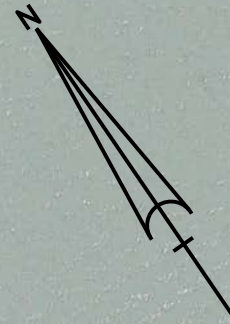

GRAPHIC SCALE
100' 0 100' 200'
NOTES:
1. REFER TO SURVEY NO. 24-088.
2. SEE SHEET NO. 1 FOR SURVEY NOTES.

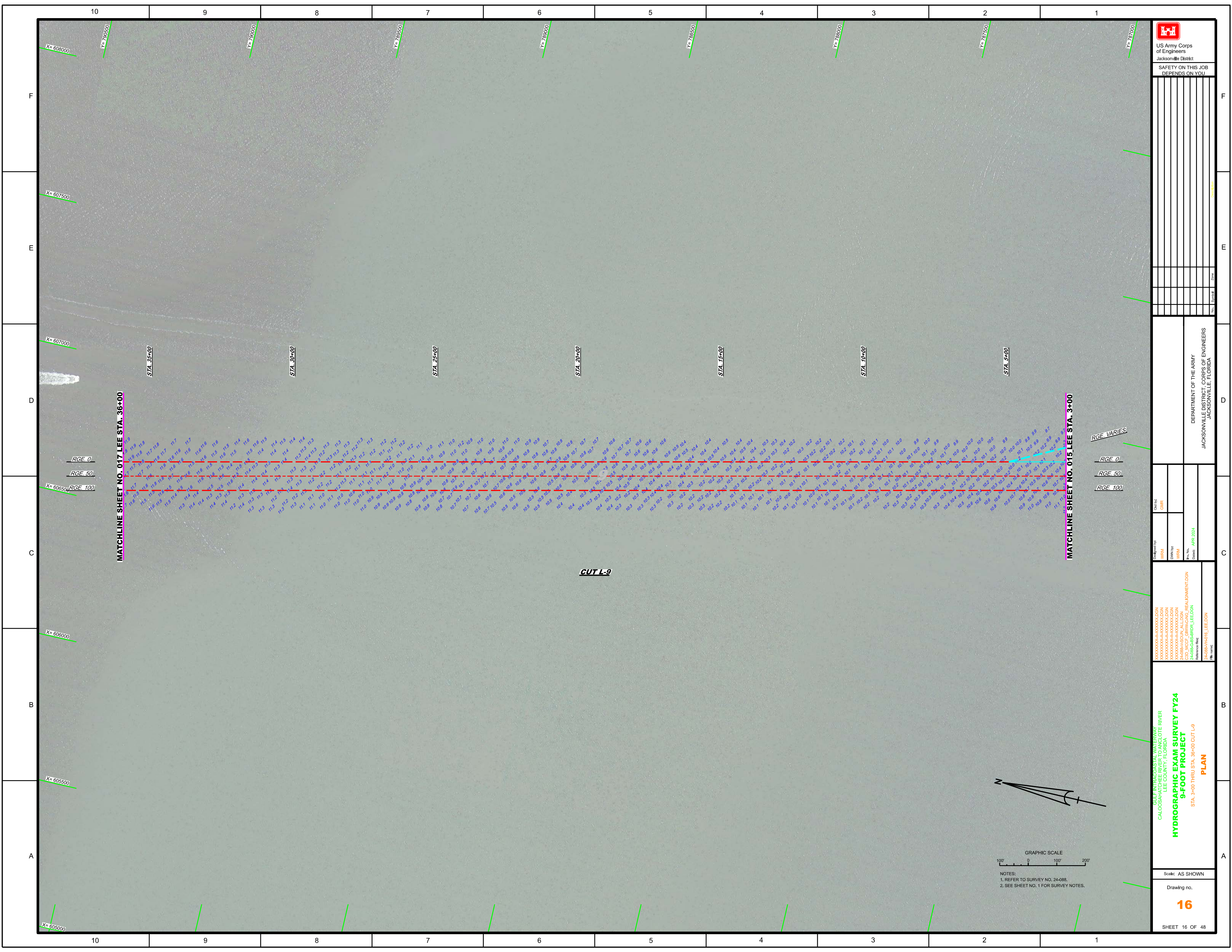

<p>US Army Corps of Engineers Jacksonville District SAFETY ON THIS JOB DEPENDS ON YOU</p>		
<p>DEPARTMENT OF THE ARMY JACKSONVILLE DISTRICT, CORPS OF ENGINEERS JACKSONVILLE, FLORIDA</p>		
<p>Designed by: WRM</p>	<p>Checked by: GHR</p>	<p>Date: APR 2024</p>
<p>XXXXXXXXXXXXXXXXXXXX.DGN XXXXXXXXXXXXXXXXXXXX.DGN XXXXXXXXXXXXXXXXXXXX.DGN XXXXXXXXXXXXXXXXXXXX.DGN XXXXXXXXXXXXXXXXXXXX.DGN C:\01_JACKSONVILLE\PROJECTS\REALIGNMENT\DWG\24-088-C-BR-01-01-LEE.DGN 24-088-C-BR-01-01-LEE.DGN Reference File: 24-088-H-01-LEE.DGN</p>		
<p>HYDROGRAPHIC EXAM SURVEY FY24 9-FOOT PROJECT STA. 3+00 THRU STA. 36+00 CUT L-9 PLAN</p>		
<p>Scale: AS SHOWN</p>		
<p>Drawing no.</p>		
<p>16</p>		
<p>SHEET 16 OF 48</p>		



NOTES:
1. REFER TO SURVEY NO. 24-088.
2. SEE SHEET NO. 1 FOR SURVEY NOTES.

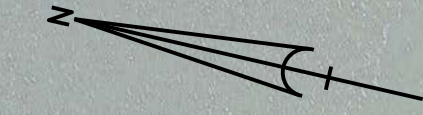

10 9 8 7 6 5 4 3 2 1

F
E
D
C
B
A



US Army Corps
of Engineers
Jacksonville District
SAFETY ON THIS JOB
DEPENDS ON YOU



MAP LABEL	AIDS TO NAVIGATION	PLANE COORDINATES		LATITUDE	LONGITUDE
		X	Y		
R-28*	DBN-28 (04/24)	607.262	750.449	26°30'29.67"	82°08'58.35"

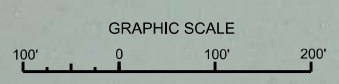

NOTES:
1. REFER TO SURVEY NO. 24-088.
2. SEE SHEET NO. 1 FOR SURVEY NOTES.

DEPARTMENT OF THE ARMY
JACKSONVILLE DISTRICT, CORPS OF ENGINEERS
JACKSONVILLE, FLORIDA

CHG BY:	GHR
DESIGNED BY:	WRM
DRAWN BY:	WRM
FILE NO.:	24-088-C-S-BR/06-LEE.DGN
DATE:	APR 2024

XXXXXXXXXXXXXXXXXXXX.DGN
24-088-H/M/DGN
24-088-H/M/DGN
24-088-C-S-BR/06-LEE.DGN
24-088-C-S-BR/06-LEE.DGN
24-088-H/RT/LEE.DGN

GULF INTRACOSTAL WATERWAY
CALOOSAHATCHEE COUNTY, FLORIDA

HYDROGRAPHIC EXAM SURVEY FY24
9-FOOT PROJECT
PLAN

STA. 36+00 CUT L-9 THRU STA. 6+00 CUT L-10

Scale: AS SHOWN

Drawing no.
17

SHEET 17 OF 48

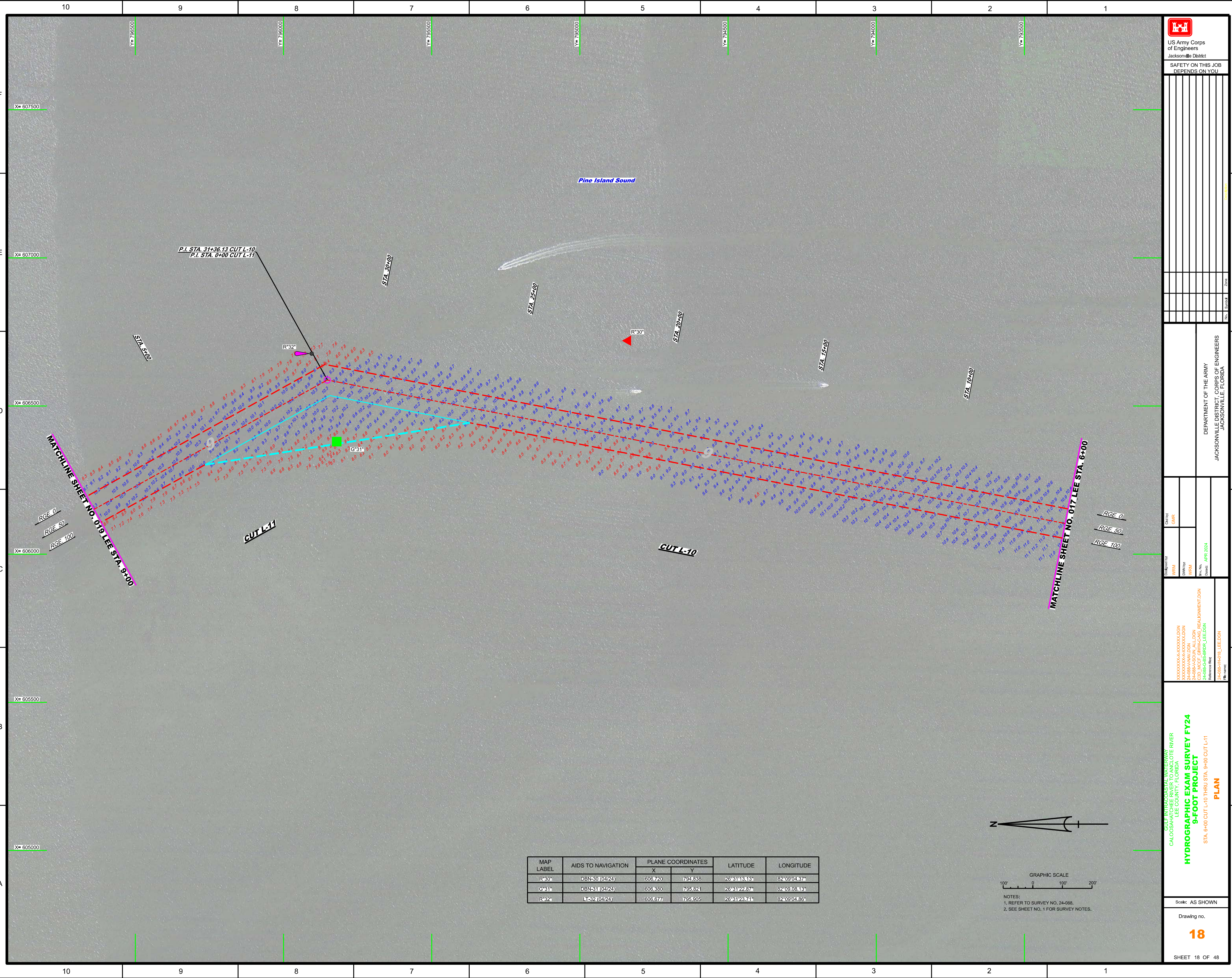

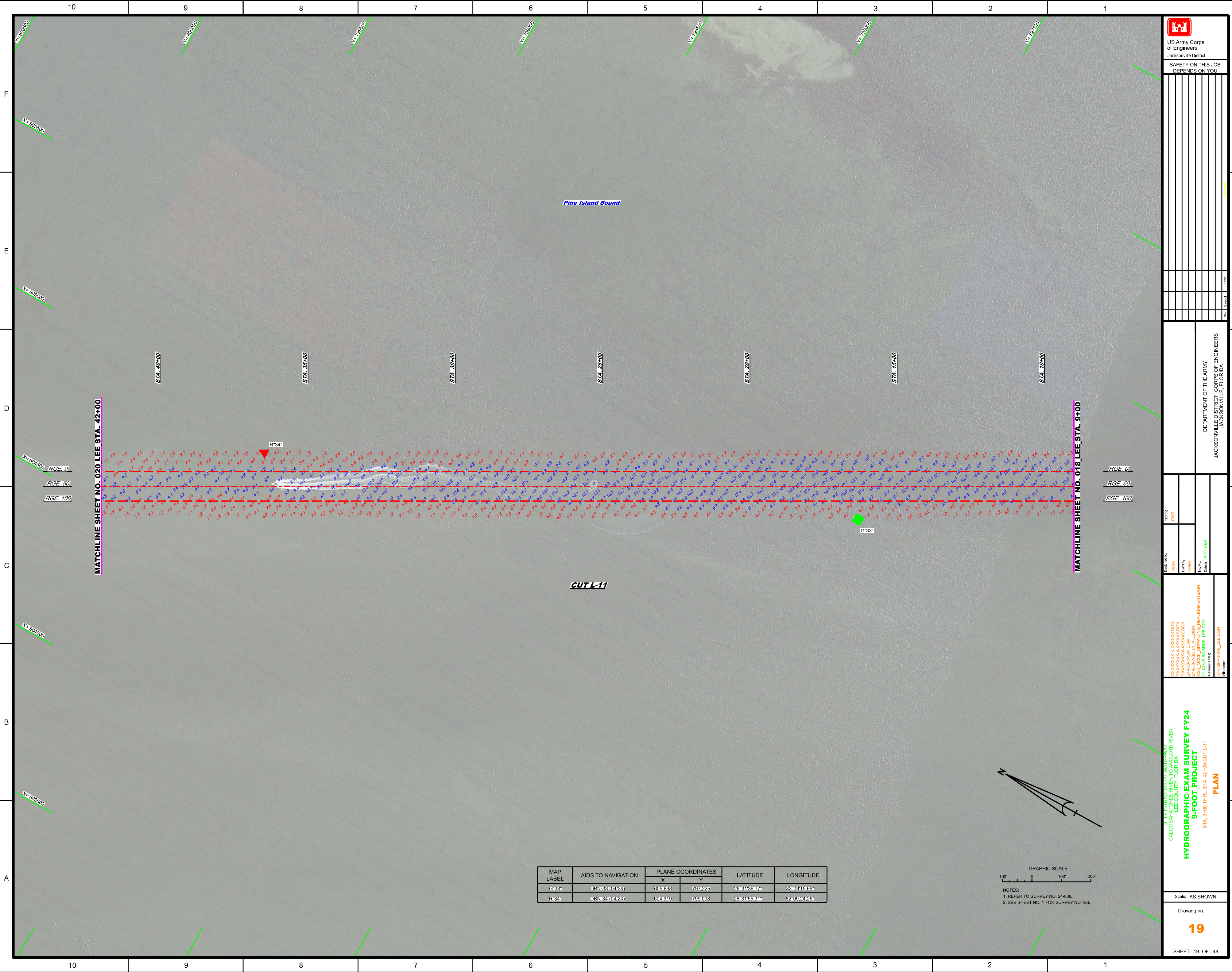



 US Army Corps of Engineers

 Jacksonville District

 SAFETY ON THIS JOB DEPENDS ON YOU

Checked by:	GHR
Designed by:	WRM
DWN by:	WRM
Date:	APR 2024

XXXXXXXXXXXXXXXXXXXX.DGN
XXXXXXXXXXXXXXXXXXXX.DGN
XXXXXXXXXXXXXXXXXXXX.DGN
XXXXXXXXXXXXXXXXXXXX.DGN
XXXXXXXXXXXXXXXXXXXX.DGN
XXXXXXXXXXXXXXXXXXXX.DGN
XXXXXXXXXXXXXXXXXXXX.DGN

GULF INTRACOASTAL WATERWAY
 CALICOOSA LEE COUNTY, FLORIDA
HYDROGRAPHIC EXAM SURVEY FY24
9-FOOT PROJECT
 STA. 9+00 THRU STA. 42+00 CUT L-11
PLAN

Scale: AS SHOWN
 Drawing no.
19
 SHEET 19 OF 48

MAP LABEL	AIDS TO NAVIGATION	PLANE COORDINATES		LATITUDE	LONGITUDE
		X	Y		
G*33*	DBN-33 (04/24)	605.698	797.225	26°31'35.77"	82°09'45.66"
R*34*	DBN-34 (04/24)	604.919	799.098	26°31'55.31"	82°09'24.25"

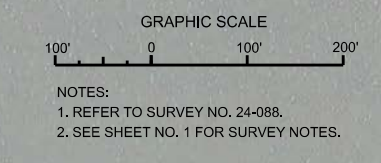

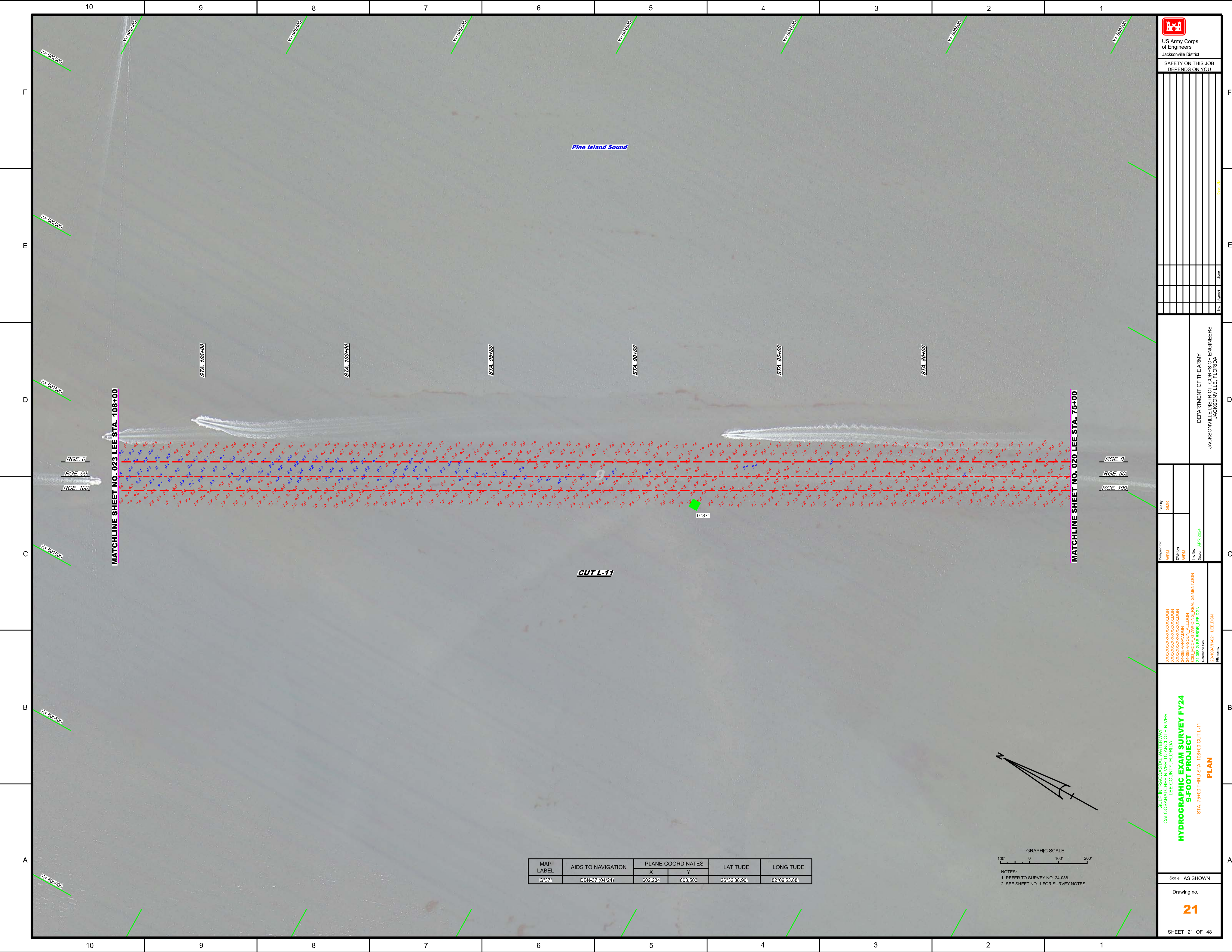

Pine Island Sound

CUT L-11

MATCHLINE SHEET NO. 023 LEE STA. 108+00

MATCHLINE SHEET NO. 020 LEE STA. 75+00

STA. 105+00

STA. 100+00

STA. 95+00

STA. 90+00

STA. 85+00

STA. 80+00

G-37

US Army Corps of Engineers
Jacksonville District
SAFETY ON THIS JOB DEPENDS ON YOU

Department of the Army
JACKSONVILLE DISTRICT, CORPS OF ENGINEERS
JACKSONVILLE, FLORIDA

Checked by:	GHR
Designed by:	WRM
DWN by:	WRM
File No.:	24-088-G-BS-RP-R1
Date:	APR 2024

XXXXXXXXXXXXXXXXXX.DGN
XXXXXXXXXXXXXXXXXX.DGN
XXXXXXXXXXXXXXXXXX.DGN
C:\02_INTCOASTAL_WATERWAY_PROJECT\CALCOUSA\LEE\PROJECT\020_LEE\CUT-L11\020_LEE\CUT-L11\24-088-G-BS-RP-R1.dgn
Reference File:
24-105A-H42 L_EE.DGN

GULF INTRACOASTAL WATERWAY PROJECT - CALOUSA RIVER, CALCOUSA LEE COUNTY, FLORIDA

HYDROGRAPHIC EXAM SURVEY FY24

9-FOOT PROJECT

STA. 75+00 THRU STA. 108+00 CUT-L-11
PLAN

Scale: AS SHOWN

Drawing no. **21**

SHEET 21 OF 48

MAP LABEL	AIDS TO NAVIGATION	PLANE COORDINATES		LATITUDE	LONGITUDE
		X	Y		
G-37	DBN-37 (04/24)	602,234	803,503	28°32'38.90"	82°09'53.88"

GRAPHIC SCALE
100' 0 100' 200'

NOTES:
1. REFER TO SURVEY NO. 24-088.
2. SEE SHEET NO. 1 FOR SURVEY NOTES.

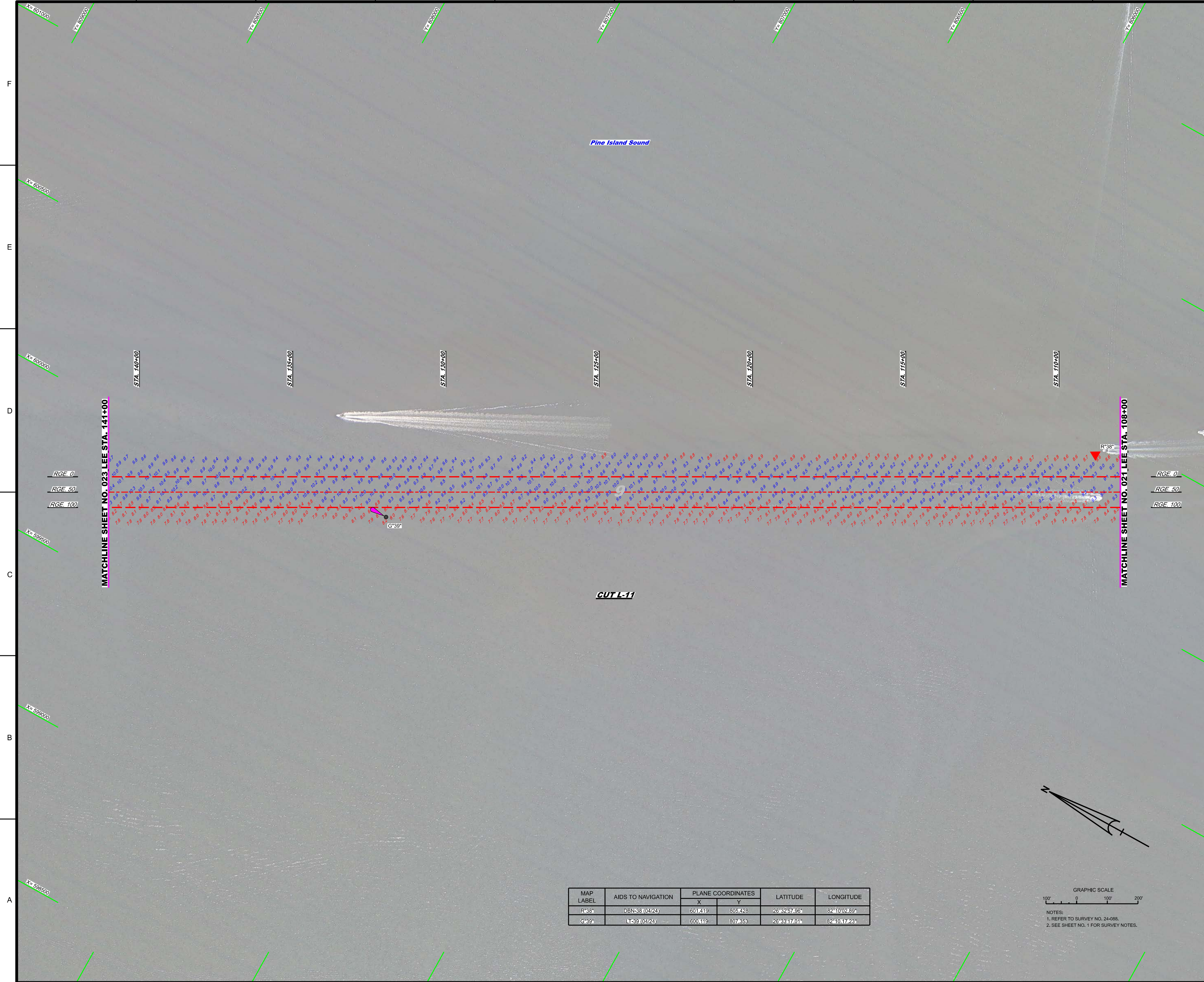



 US Army Corps

 of Engineers

 Jacksonville District

 SAFETY ON THIS JOB

 DEPENDS ON YOU

Date	By	Description

DEPARTMENT OF THE ARMY

 JACKSONVILLE DISTRICT, CORPS OF ENGINEERS

 JACKSONVILLE, FLORIDA

Checked By:	CHR
Designed By:	WRM
DWN By:	WRM
File No.:	24-088-HV-24
Date:	APR 2024

\XXXXXXXXXXXXXXXXXX.DGN

 \XXXXXXXXXXXXXXX.DGN

 \XXXXXXXXXXXXXXX.DGN

 \XXXXXXXXXXXXXXX.DGN

 \XXXXXXXXXXXXXXX.DGN

 \XXXXXXXXXXXXXXX.DGN

GULF INTERCOASTAL WATERWAY

 CALOOSAHATCHEE COUNTY, FLORIDA

HYDROGRAPHIC EXAM SURVEY FY24

9-FOOT PROJECT

 STA. 108+00 THRU STA. 141+00 CUT L-11

PLAN

Scale: AS SHOWN

 Drawing no.

MAP LABEL	AIDS TO NAVIGATION	PLANE COORDINATES		LATITUDE	LONGITUDE
		X	Y		
R-38	DBN-38 (04/24)	801.419	805.428	26°32'47.96"	82°10'02.89"
G-39	LT-39 (04/24)	800.119	807.353	26°33'17.01"	82°10'17.23"

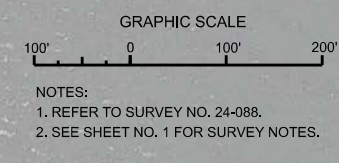

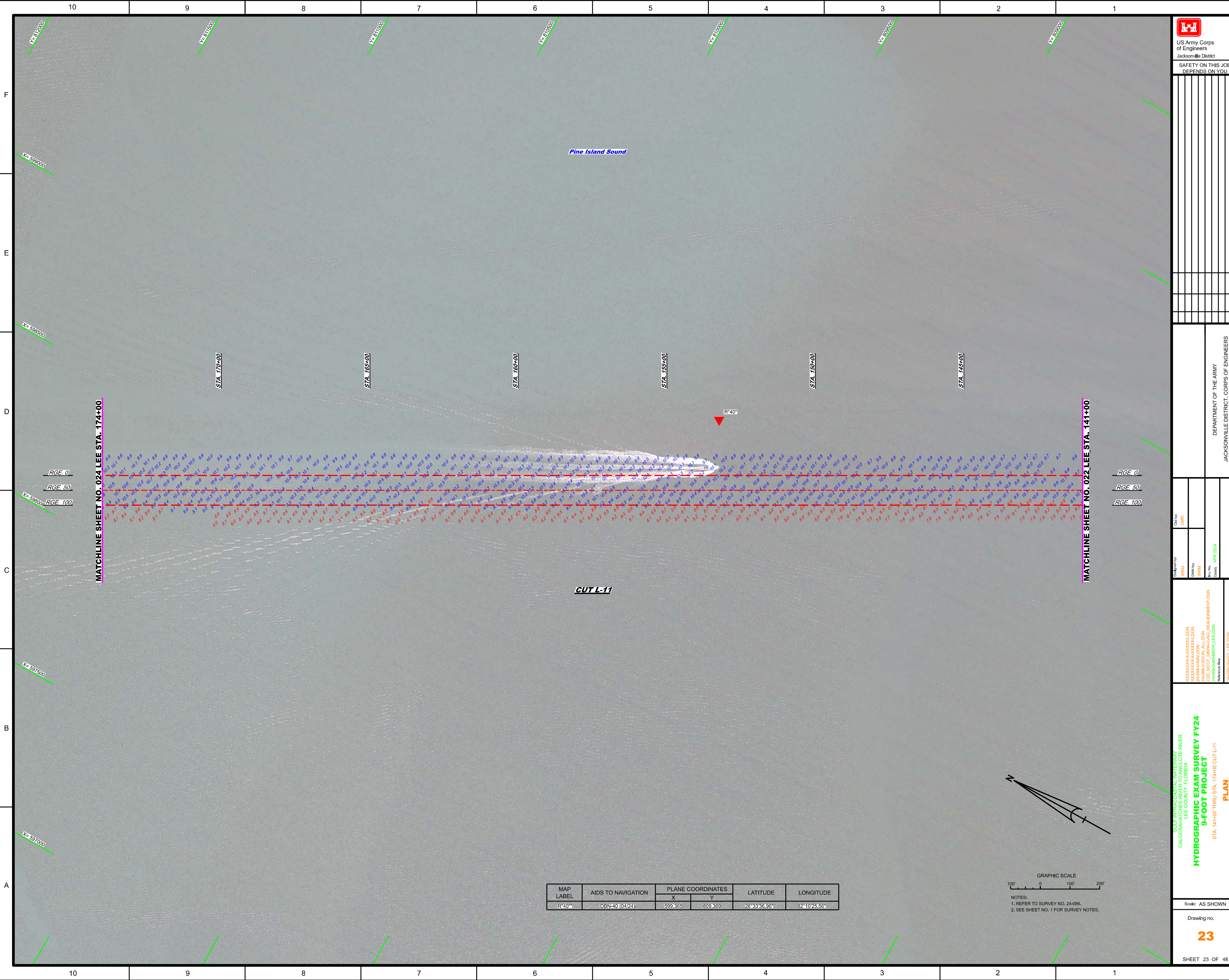

US Army Corps of Engineers
 Jacksonville District
 SAFETY ON THIS JOB DEPENDS ON YOU

DESIGNED BY
 WRM
 CHECKED BY
 GHR
 DATE: APR 2024

XXXXXXXXXXXXXXXXXXXXX
 XXXXXXXX-HW.DGN
 C:\D\MACE\GMA\CANS_REALIGNMENT.DGN
 24-088-GS-RRR-LEE.DGN
 24-088-HAZEL_LEE.DGN

DEPARTMENT OF THE ARMY
 JACKSONVILLE DISTRICT, CORPS OF ENGINEERS
 JACKSONVILLE, FLORIDA

STATION: STA. 141+00 THRU STA. 174+00 CUT L-11
9-FOOT PROJECT
PLAN

GULF INTRACOASTAL WATERWAY
 CALICOOSA LEE COUNTY FLORIDA
HYDROGRAPHIC EXAM SURVEY FY24

Scale: AS SHOWN
 Drawing no.
23

SHEET 23 OF 48

MAP LABEL	AIDS TO NAVIGATION	PLANE COORDINATES		LATITUDE	LONGITUDE
		X	Y		
R40	DBN-10 (04/24)	599,365	809,369	26°33'38.98"	82°10'25.58"

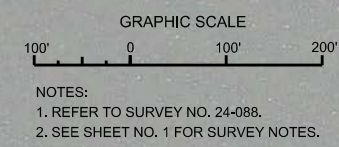

MATCHLINE SHEET NO. 024 LEE STA. 174+00

MATCHLINE SHEET NO. 022 LEE STA. 141+00

F
E
D
C
B
A

F
m
D
C
B
A

10 9 8 7 6 5 4 3 2 1

10 9 8 7 6 5 4 3 2 1

KC 817000
 KC 817500
 KC 818000
 KC 818500
 KC 819000
 KC 819500
 KC 820000
 STA 174+00
 STA 169+00
 STA 164+00
 STA 159+00
 STA 154+00
 STA 149+00
 STA 144+00
 Pine Island Sound
 R40
 RGE 0
 RGE 50
 RGE 100
 CUT L-11
 KC 597500
 KC 597000

