

# TAMPA HARBOR CUTS C, D AND E (TB) (ZONE 3) HILLSBOROUGH COUNTY, FLORIDA HYDROGRAPHIC EXAM SURVEY FY19 43-FOOT PROJECT

- SURVEY NOTES**
- REFER TO SURVEY NO. 19-065.
  - ELEVATIONS ARE IN FEET AND TENTHS AND REFER TO THE NOAA REPORTED MLLW TIDAL DATUM RELATIVE TO THE 1983-2001 TIDAL EPOCH.
  - TIDAL REDUCTIONS WERE OBTAINED UTILIZING A REAL-TIME KINEMATIC (RTK) GPS AND REFERENCED TO MLLW UTILIZING A HYPACK KINEMATIC TIDE DATUM (KTD) MODEL NAMED "SPC-FL-WEST-2010-12-07.KTD." THIS DATUM MODEL WAS USED AND CALIBRATED TO THE PUBLISHED MLLW HEIGHTS OF THE BENCHMARKS ASSOCIATED WITH THE GAGE SITES SPECIFIED BELOW:  
NOAA TIDAL STATION 872-6520, ST. PETERSBURG, TAMPA BAY, FLORIDA
  - ALL ELEVATIONS ARE BELOW THE CHART DATUM UNLESS PRECEDED BY A (+) SIGN.
  - PLANE COORDINATES ARE BASED ON THE TRANSVERSE MERCATOR PROJECTION FOR THE WEST ZONE OF FLORIDA AND REFERENCED TO NORTH AMERICAN DATUM OF 1983 (NAD83).
  - ALL STATIONING REFERS TO THE CENTERLINE OF THE CHANNEL.
  - THIS SURVEY WAS PERFORMED USING REAL-TIME KINEMATIC (RTK) GPS POSITIONING WITH THE FOLLOWING REFERENCE BASE LOCATIONS:  
REFERENCE BASE LOCATED AT "DILLMAN" (OPUS PID: BBDC48)  
TIDESTAFF LOCATED FROM "EDD 60 1935" (OPUS PID: AG5298)
  - VERTICAL MEASUREMENTS WERE MADE USING A ROSS SMARTSOUNDER DUAL-FREQUENCY 28/200 KHZ SINGLE-BEAM TRANSDUCER, A R2SONIC 2024 MULTI-BEAM SYSTEM OPERATING AT 240 KHZ AND AN EDGETECH 6205 OPERATING AT 550/900 KHZ. SOUNDINGS SHOWN ARE IN HIGH FREQUENCY.
- VESEL**
- | VESEL           | DATE OF SURVEY | CUT   |
|-----------------|----------------|-------|
| SB JACKSONVILLE | 26 NOV 2018    | CUT-C |
| SB JACKSONVILLE | 28 NOV 2018    | CUT-D |
| SB JACKSONVILLE | 16&30 NOV 2018 | CUT-E |
- AIDS TO NAVIGATION WERE LOCATED DURING THIS SURVEY.
  - THE INFORMATION DEPICTED ON THIS MAP REPRESENTS THE RESULTS OF SURVEYS MADE ON THE DATES INDICATED ABOVE AND CAN ONLY BE CONSIDERED AS INDICATING THE GENERAL CONDITIONS AT THAT TIME. THIS CHART IS SOLELY FOR THE DISTRIBUTION OF AVAILABLE DEPTHS AT THE TIME OF THE SURVEY.
  - SURVEY ACCURACY PERFORMANCE STANDARDS, QUALITY CONTROL AND QUALITY ASSURANCE REQUIREMENTS WERE FOLLOWED DURING THIS SURVEY IN ACCORDANCE WITH USACE EM 1110-2-1003, HYDROGRAPHIC SURVEYING, 30 NOV 2013.

SURVEY ZONE	CUTS
2	MULLET KEY CHANNEL, CUT-A (TB), CUT-B (TB)
3	CUT-C (TB), CUT-D (TB), CUT-E (TB)
4	CUT-F, CUT-G, GADSDEN POINT CUT
5	CUT-J, CUT-K, CUT-L
6	CUT-A (HB), CUT-C (HB), CUT-D (HB)

LEGEND	
△	MONUMENT
⚓	LIGHTED BEACON
■	GREEN DAYBEACON
▲	RED DAYBEACON
⚓	RED LIGHTED BUOY
⚓	GREEN LIGHTED BUOY
⚓	CAN BUOY
⚓	NUN BUOY
⚓	TIDE STAFF
8	PROJECT DEPTH

<p>DESIGNED BY: WRM DRAWN BY: WRM FILE NO.: TAMPA HARBOR-43-FOOT-2018.DGN DATE: NOV 2018</p>	<p>DEPARTMENT OF THE ARMY JACKSONVILLE DISTRICT, CORPS OF ENGINEERS JACKSONVILLE, FLORIDA</p>
<p>TAMPA HARBOR HILLSBOROUGH COUNTY, FLORIDA <b>HYDROGRAPHIC EXAM SURVEY FY19 43-FOOT PROJECT</b> INDEX, LOCATION AND VICINITY MAP</p>	
<p>Scale: AS SHOWN</p>	
<p>Drawing no. <b>1</b></p>	
<p>SHEET 01 OF 14</p>	

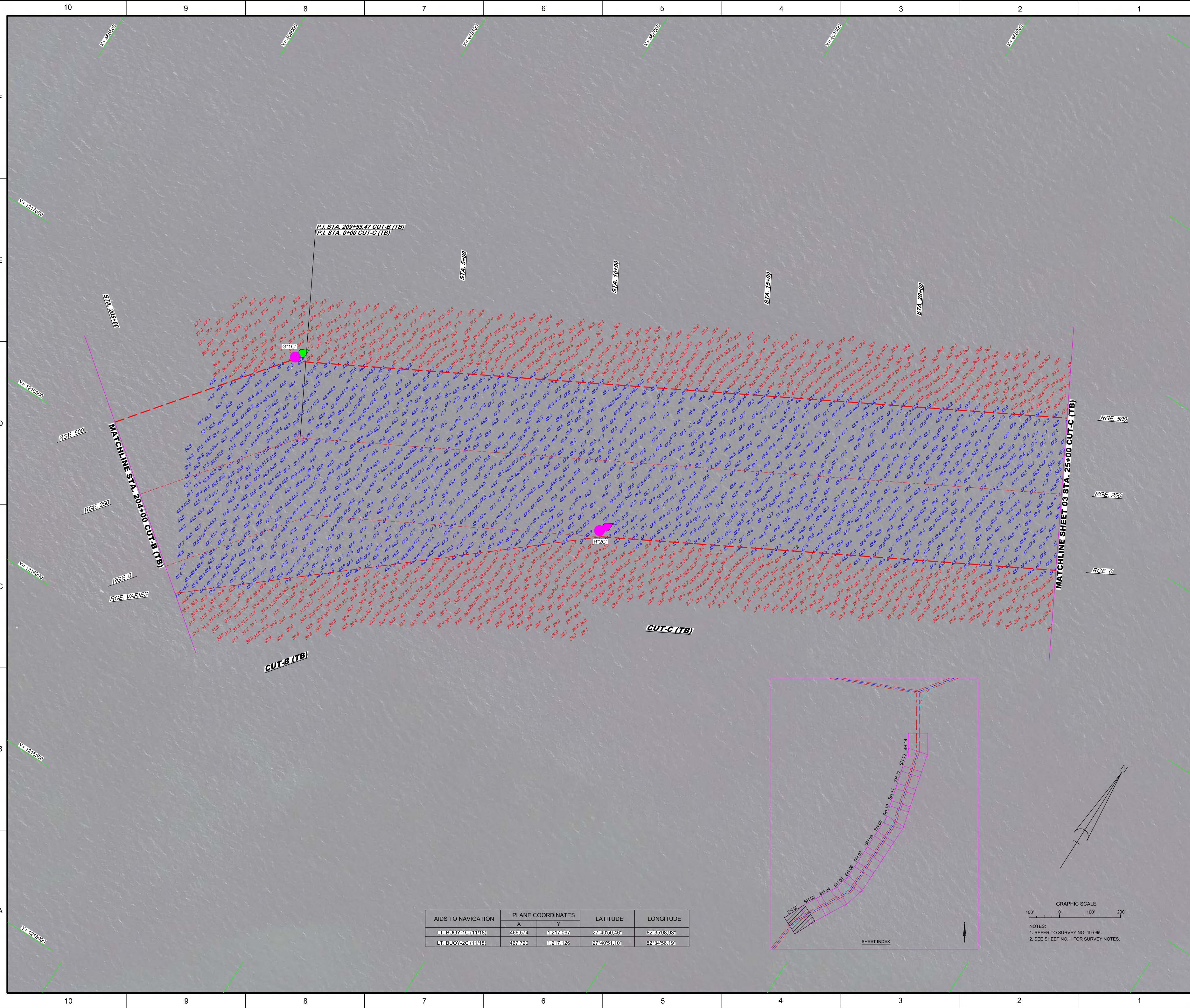

AIDS TO NAVIGATION	PLANE COORDINATES		LATITUDE	LONGITUDE
	X	Y		
LT BUOY-1C (11/18)	486574	11217067	27°40'50.46"	82°35'08.93"
LT BUOY-2C (11/18)	487720	11217426	27°40'51.10"	82°34'58.19"

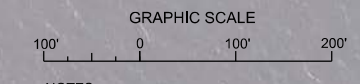

NOTES:  
1. REFER TO SURVEY NO. 18-065.  
2. SEE SHEET NO. 1 FOR SURVEY NOTES.



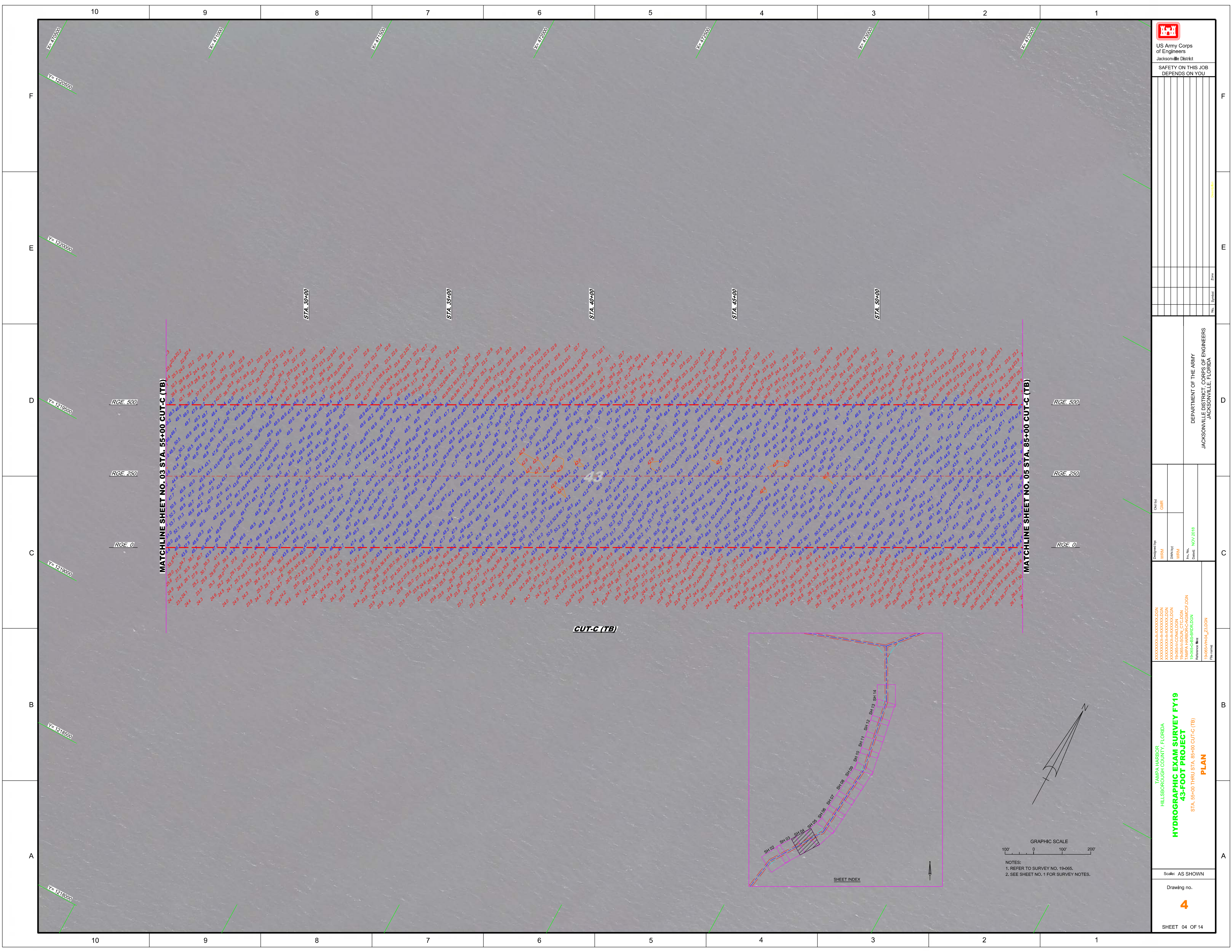

MATCHLINE SHEET NO. 03 STA. 55+00 CUT-C (TB)

MATCHLINE SHEET NO. 05 STA. 85+00 CUT-C (TB)

**CUT-C (TB)**

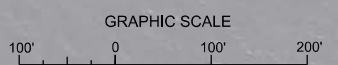

NOTES:  
1. REFER TO SURVEY NO. 19-065.  
2. SEE SHEET NO. 1 FOR SURVEY NOTES.



US Army Corps of Engineers  
Jacksonville District

SAFETY ON THIS JOB  
DEPENDS ON YOU

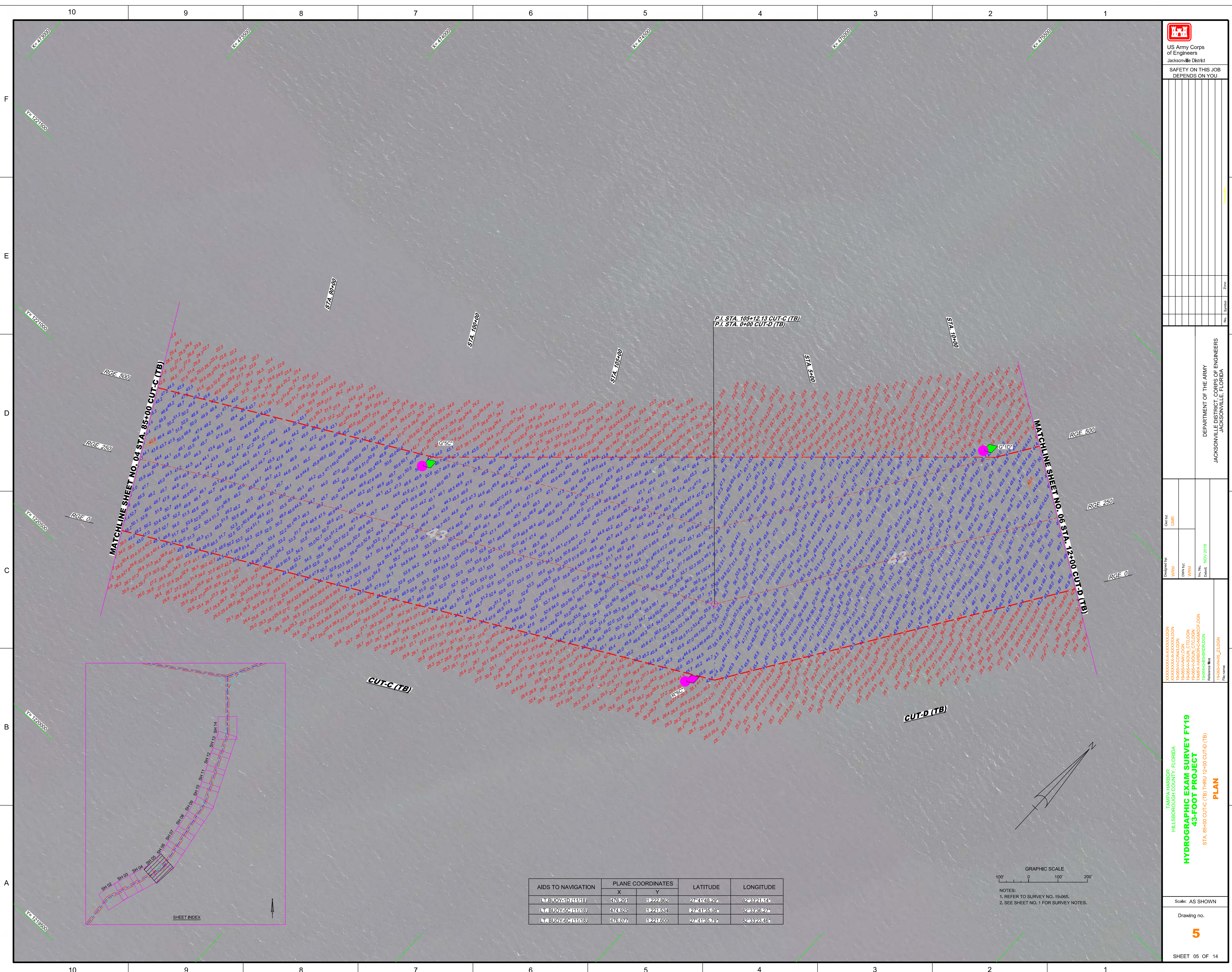

F  
E  
D  
C  
B  
A

F  
E  
D  
C  
B  
A

STA 0+00  
STA 100+00  
STA 200+00  
STA 300+00  
STA 400+00  
STA 500+00  
STA 600+00  
STA 700+00  
STA 800+00  
STA 900+00  
STA 1000+00  
STA 1100+00  
STA 1200+00

RGE 0  
RGE 250  
RGE 500

MATCHLINE SHEET NO. 04 STA. 85+00 CUT-C (TB)  
MATCHLINE SHEET NO. 06 STA. 12+00 CUT-D (TB)

AIDS TO NAVIGATION	PLANE COORDINATES		LATITUDE	LONGITUDE
	X	Y		
LT BUOY 510 (41/18)	476.231	11222.862	27°41'48.29"	82°33'21.41"
LT BUOY 530 (41/18)	478.925	11221.634	27°41'35.08"	82°33'36.22"
LT BUOY 550 (41/18)	478.077	11221.600	27°41'35.79"	82°33'23.45"

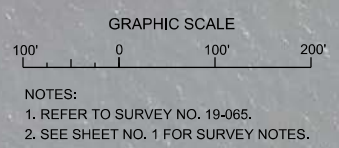

DEPARTMENT OF THE ARMY  
JACKSONVILLE DISTRICT, CORPS OF ENGINEERS  
JACKSONVILLE, FLORIDA

Checked By: GMR  
Designed By: WRM  
Drawn By: WRM  
Reference Map: 19485-1  
Date: NOV 2018

TAMPA HARBOR  
HILLSBOROUGH COUNTY, FLORIDA  
HYDROGRAPHIC EXAM SURVEY FY19  
43-FOOT PROJECT  
STA. 85+00 CUT-C (TB) THRU 12+00 CUT-D (TB)  
PLAN

Scale: AS SHOWN  
Drawing No. **5**  
SHEET 05 OF 14

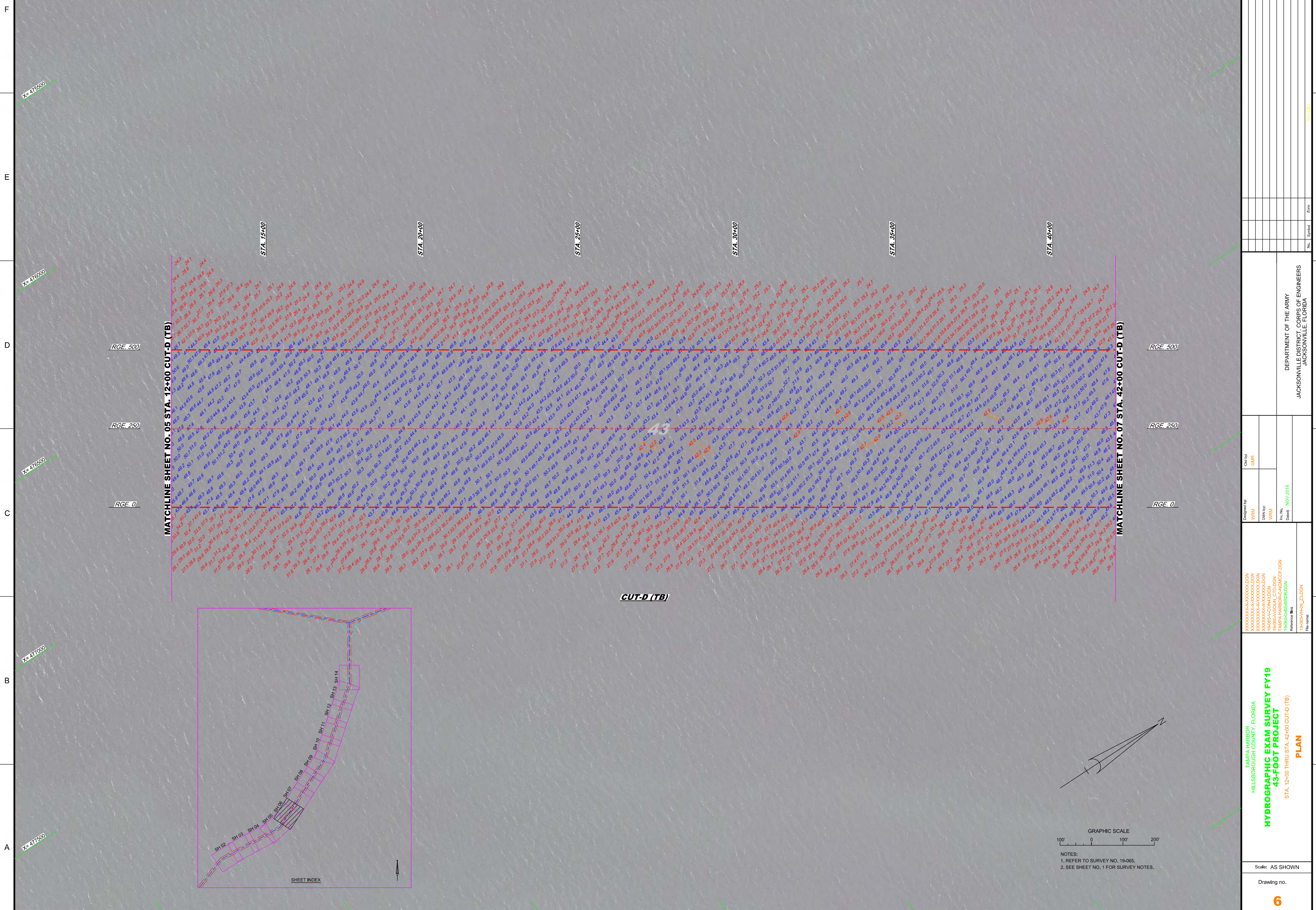

F  
E  
D  
C  
B  
A

$V=472850$   
 $V=476500$   
 $V=476900$   
 $V=471000$   
 $V=471900$

MATCHLINE SHEET NO. 05 STA. 12+00 CUT-D (TB)

MATCHLINE SHEET NO. 07 STA. 42+00 CUT-D (TB)

RGE. 500  
RGE. 250  
RGE. 0

RGE. 500  
RGE. 250  
RGE. 0

CUT-D (TB)

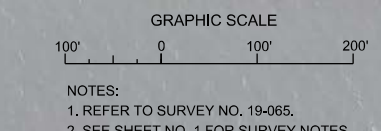

NOTES:  
1. REFER TO SURVEY NO. 19-065.  
2. SEE SHEET NO. 1 FOR SURVEY NOTES.

No.	Symbol	Zone

DEPARTMENT OF THE ARMY  
JACKSONVILLE DISTRICT, CORPS OF ENGINEERS  
JACKSONVILLE, FLORIDA

Designed by:	WRM
DWN by:	WRM
Checked by:	GHR
Reference File:	19-065-HR06_07.DGN
Date:	NOV 2018

TAMPA HARBOR  
HILLSBOROUGH COUNTY, FLORIDA  
**HYDROGRAPHIC EXAM SURVEY FY19**  
**43-FOOT PROJECT**  
STA. 12+00 THRU STA. 42+00 CUT-D (TB)  
**PLAN**

Scale: AS SHOWN

Drawing no.  
**6**



US Army Corps of Engineers  
 Jacksonville District  
 SAFETY ON THIS JOB  
 DEPENDS ON YOU

DEPARTMENT OF THE ARMY  
 JACKSONVILLE DISTRICT, CORPS OF ENGINEERS  
 JACKSONVILLE, FLORIDA

TAMPABAY COUNTY, FLORIDA  
**HYDROGRAPHIC EXAM SURVEY FY19**  
**43-FOOT PROJECT**  
 STA. 42+00 THRU STA. 72+00 CUT-D (TB)  
**PLAN**

Scale: AS SHOWN  
 Drawing no.  
**7**  
 SHEET 07 OF 14

MATCHLINE SHEET NO. 06 STA. 42+00 CUT-D (TB)

MATCHLINE SHEET NO. 08 STA. 72+00 CUT-D (TB)

CUT-D (TB)

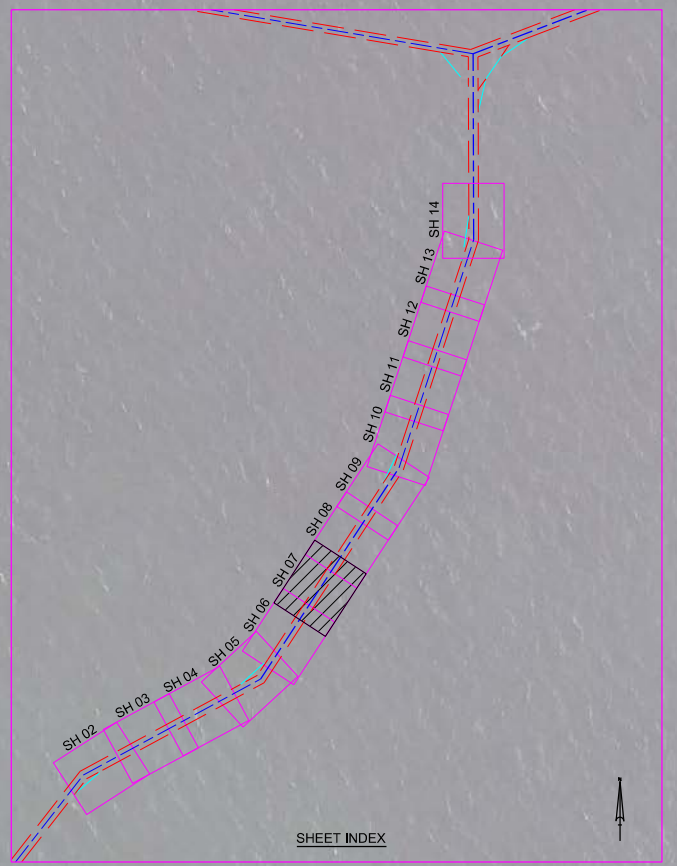

AIDS TO NAVIGATION	PLANE COORDINATES		LATITUDE	LONGITUDE
	X	Y		
BUOY 3D (11/18)	479607	1127889	27°42'38.22"	82°32'24.50"
BUOY 4D (11/18)	480026	1127693	27°42'35.30"	82°32'39.52"

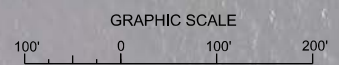

NOTES:  
 1. REFER TO SURVEY NO. 19-065.  
 2. SEE SHEET NO. 1 FOR SURVEY NOTES.

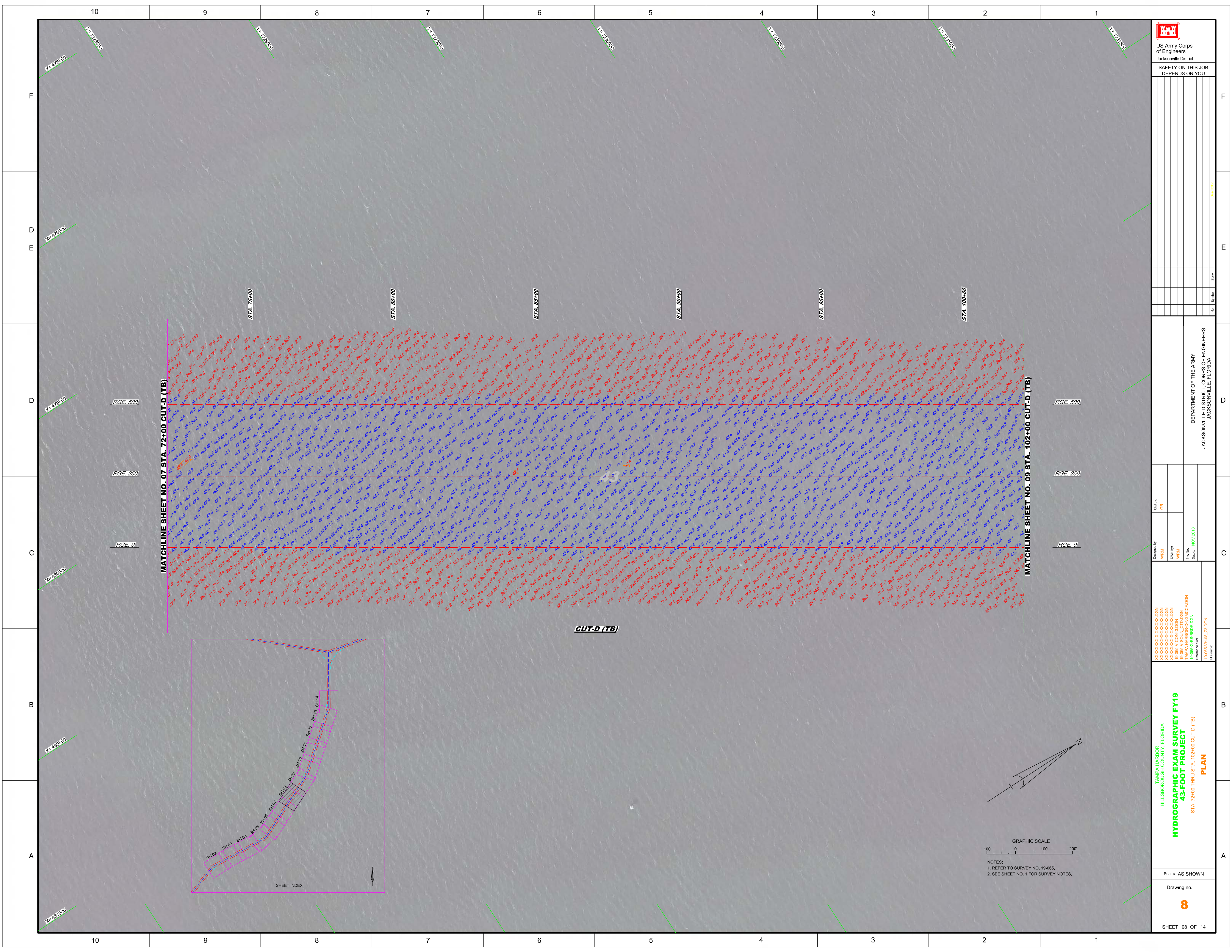



  
 US Army Corps of Engineers  
 Jacksonville District  
 SAFETY ON THIS JOB  
 DEPENDS ON YOU

DEPARTMENT OF THE ARMY  
 JACKSONVILLE DISTRICT, CORPS OF ENGINEERS  
 JACKSONVILLE, FLORIDA

Designed by: GRL  
 Drawn by: WRM  
 Checked by: WRM  
 Date: NOV 2018

TAMPA HARBOR  
 HILLSBOROUGH COUNTY, FLORIDA  
**HYDROGRAPHIC EXAM SURVEY FY19**  
**43-FOOT PROJECT**  
 STA. 72+00 THRU STA. 102+00 CUT-D (TB)  
**PLAN**

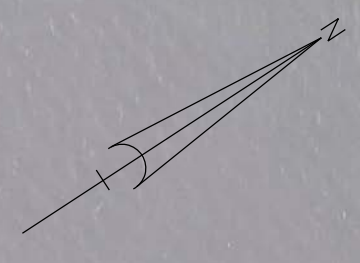
Scale: AS SHOWN  
 Drawing no. **8**  
 SHEET 08 OF 14



NOTES:  
 1. REFER TO SURVEY NO. 19-065.  
 2. SEE SHEET NO. 1 FOR SURVEY NOTES.



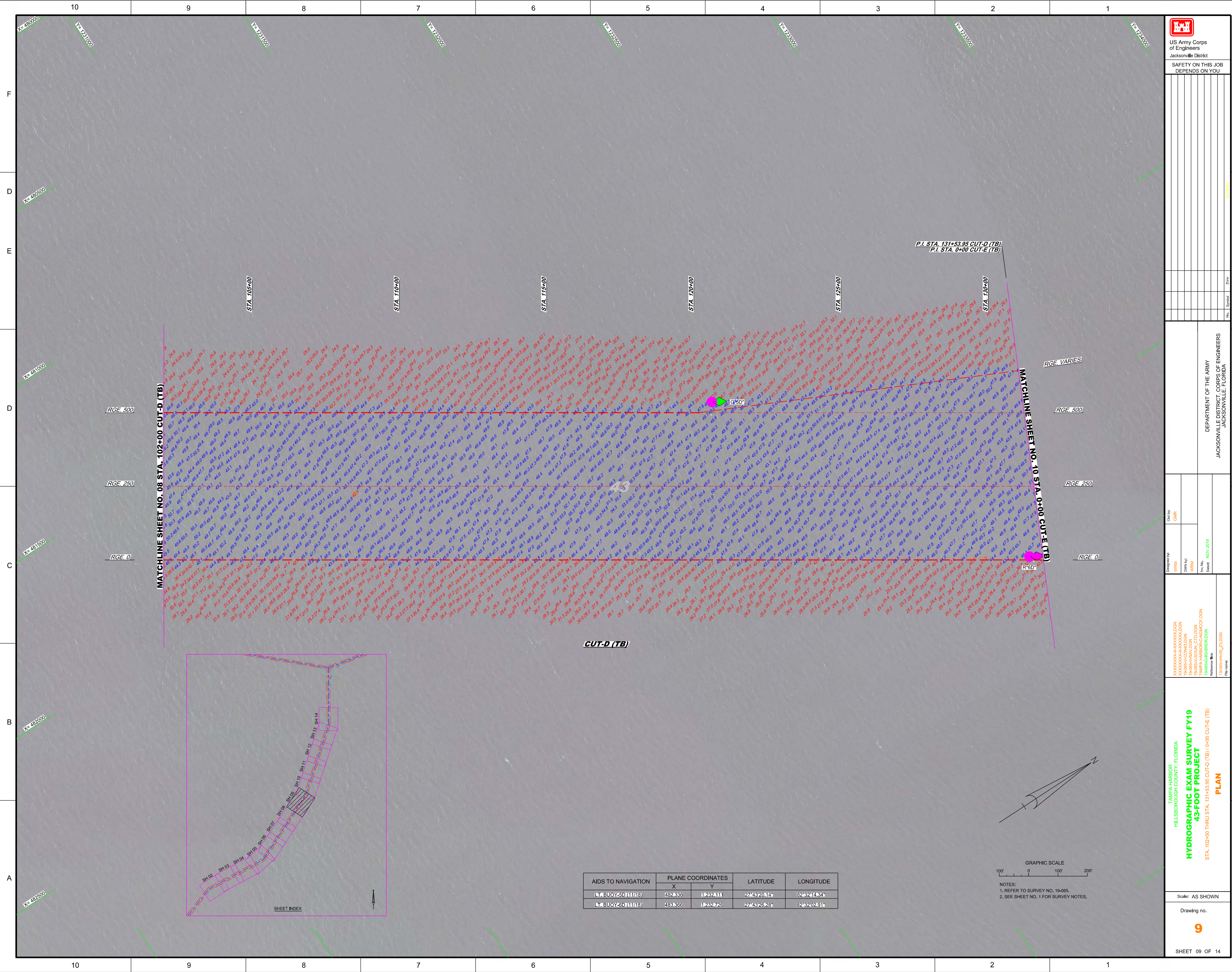

AIDS TO NAVIGATION	PLANE COORDINATES		LATITUDE	LONGITUDE
	X	Y		
LT. BUOY 5D (1118)	489,836	128,211	27.432014°	82.321434°
LT. BUOY 5D (1118)	488,366	128,276	27.432628°	82.320291°

GRAPHIC SCALE  
 100' 0 100' 200'

NOTES:  
 1. REFER TO SURVEY NO. 19-065.  
 2. SEE SHEET NO. 1 FOR SURVEY NOTES.

**US Army Corps of Engineers**  
Jacksonville District

SAFETY ON THIS JOB  
DEPENDS ON YOU

DESIGNED BY: WRM, DWM, WRM  
 CHECKED BY: WRM, DWM, WRM  
 DATE: NOV 2018

XXXXXXXXXXXXXXXXXXXX  
 19-065-043.DGN  
 19-065-043.DGN  
 19-065-043.DGN  
 19-065-043.DGN  
 19-065-043.DGN

TAMPA HARBOR  
 HILLSBOROUGH COUNTY, FLORIDA  
**HYDROGRAPHIC EXAM SURVEY FY19**  
**43-FOOT PROJECT**  
 STA. 102+00 THRU STA. 131+53.95 CUT-D (TB) / 0+00 CUT-E (TB)  
**PLAN**

Scale: AS SHOWN

Drawing no.  
**9**

SHEET 09 OF 14

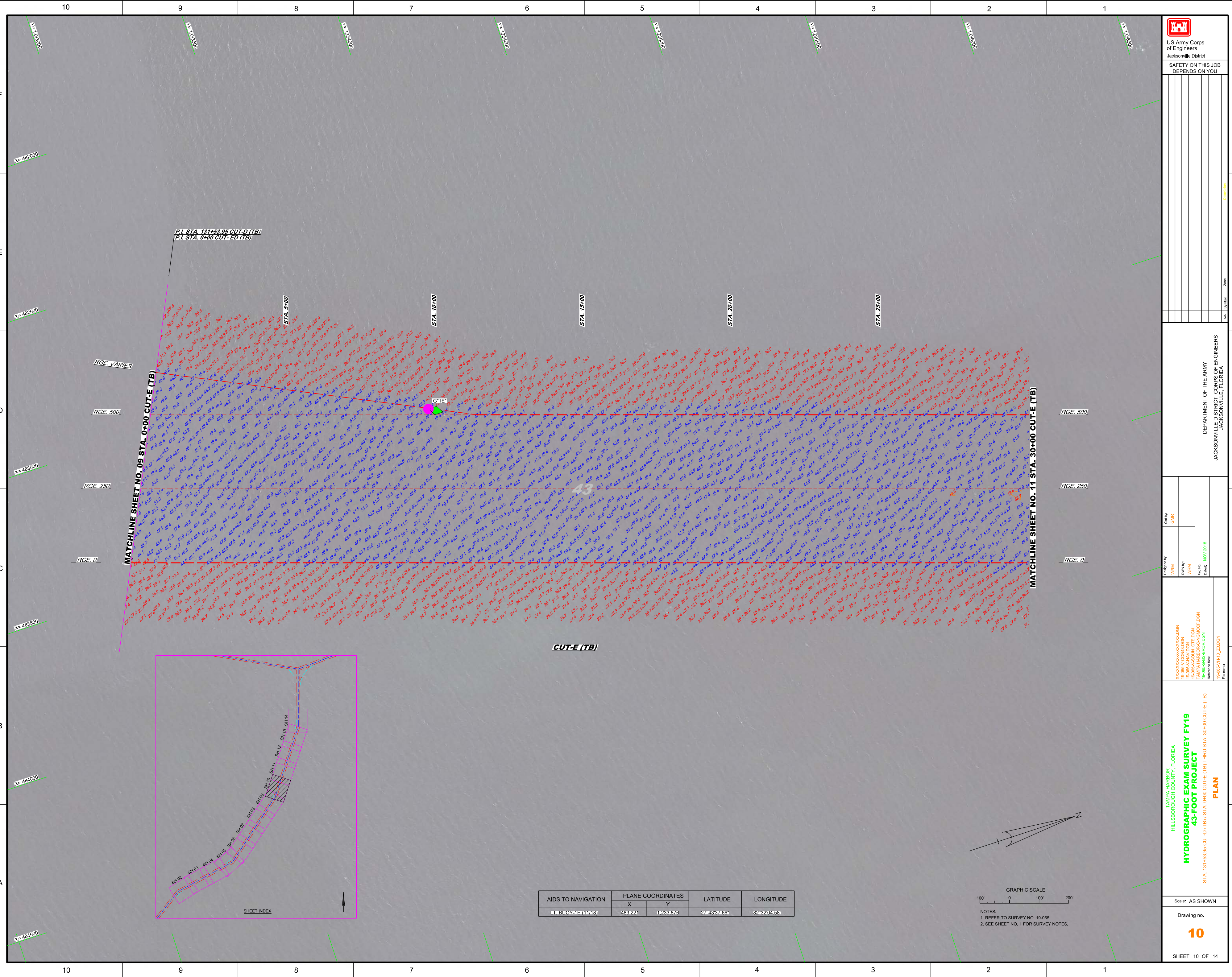

AIDS TO NAVIGATION	PLANE COORDINATES		LATITUDE	LONGITUDE
	X	Y		
LT. BUOY-1E (11/18)	483.221	1,233.876	27°43'37.66"	82°32'04.58"

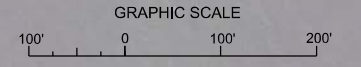

NOTES:  
1. REFER TO SURVEY NO. 19-065.  
2. SEE SHEET NO. 1 FOR SURVEY NOTES.

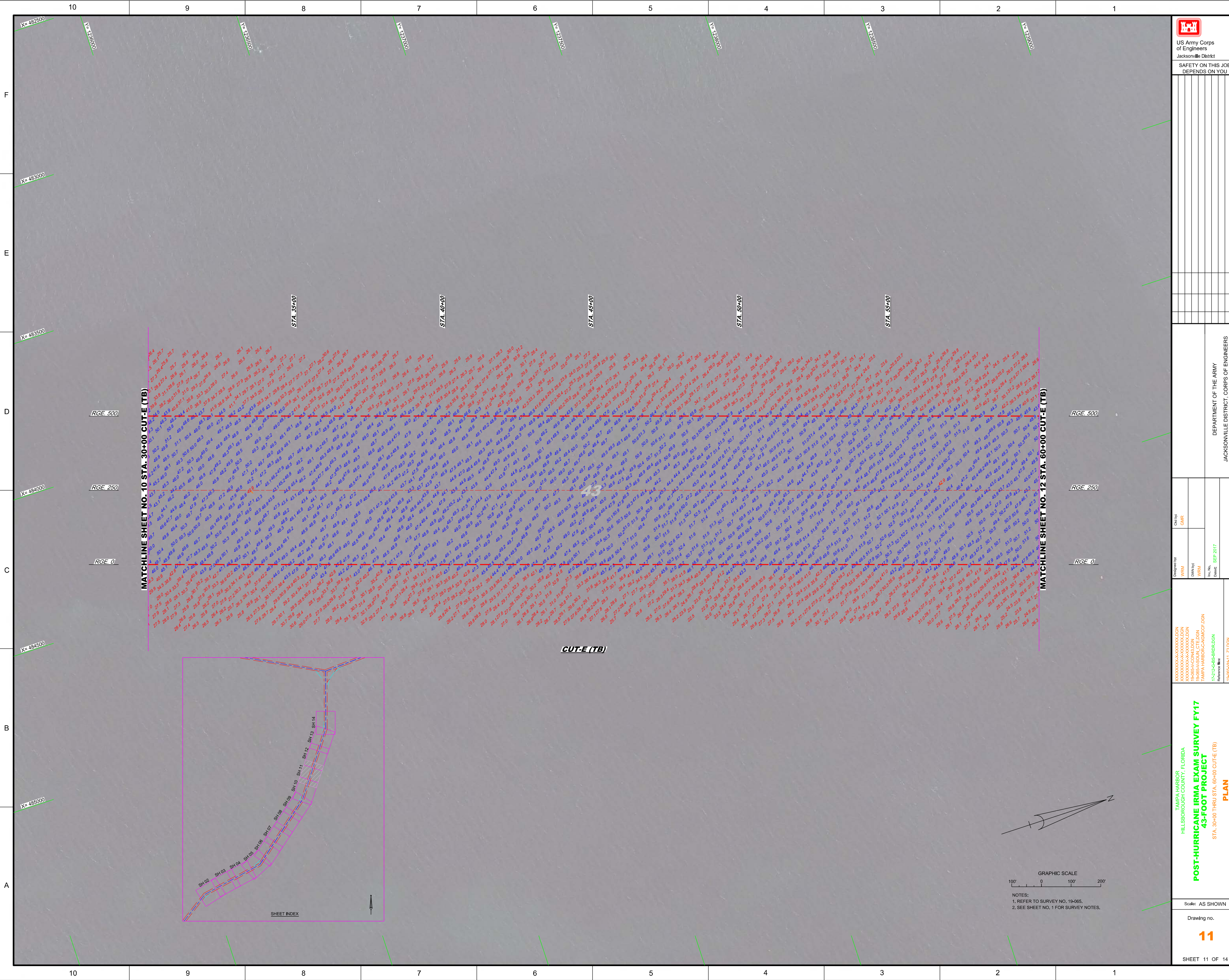

MATCHLINE SHEET NO. 10 STA. 30+00 CUT-E (TB)

MATCHLINE SHEET NO. 12 STA. 60+00 CUT-E (TB)

**CUT-E (TB)**

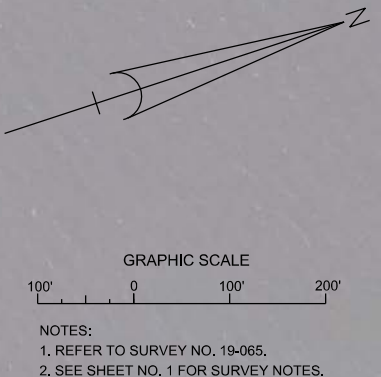
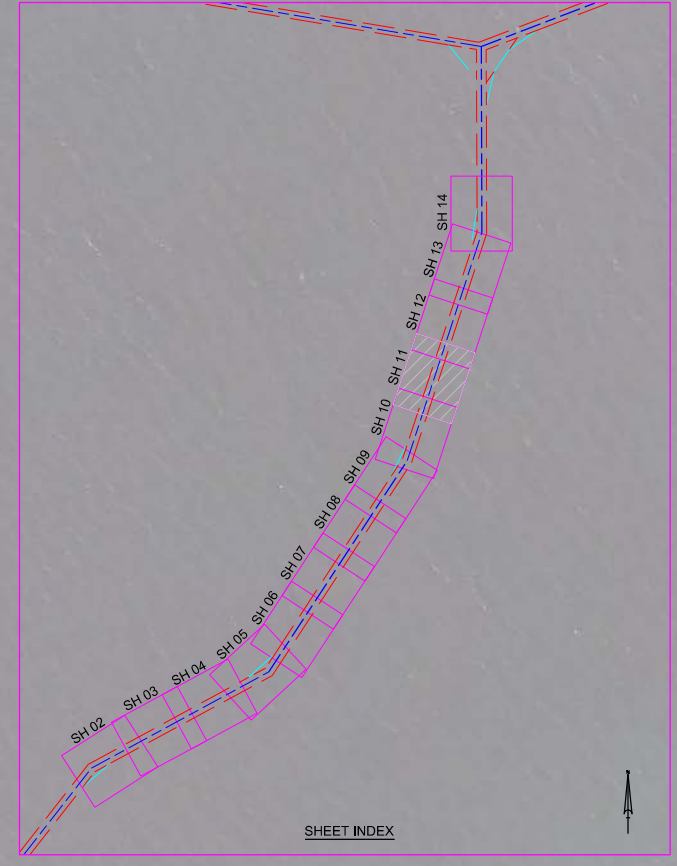

Designed by: **WRM**  
Checked by: **GHR**  
Drawn by: **WRM**  
Scale: **AS SHOWN**  
Date: **SEP 2017**

TAMPA HARBOR  
HILLSBOROUGH COUNTY, FLORIDA  
**POST-HURRICANE IRMA EXAM SURVEY FY17**  
**43-FOOT PROJECT**  
STA. 30+00 THRU STA. 60+00 CUT-E (TB)  
**PLAN**



US Army Corps of Engineers  
Jacksonville District

SAFETY ON THIS JOB  
DEPENDS ON YOU

No.	Symbol	Zone

No.	Symbol	Zone

DEPARTMENT OF THE ARMY  
JACKSONVILLE DISTRICT, CORPS OF ENGINEERS  
JACKSONVILLE, FLORIDA

Designed By: WRM  
Checked By: GMR  
Drawn By: WRM  
No. Rev. 11/18  
Date: NOV 2018

XXXXXXXXXXXXXXXXXXXX  
R-0655-CV-043.DGN  
R-0655-NAV.DGN  
R-0655-CV-043.DGN  
TAMPA HARBOR-CANAL.DGN  
R-0655-CV-043.DGN  
Reference: 11/18, 2/18, 12/18, 1/19, 2/19, 3/19, 4/19, 5/19, 6/19, 7/19, 8/19, 9/19, 10/19, 11/19, 12/19, 1/20, 2/20, 3/20, 4/20, 5/20, 6/20, 7/20, 8/20, 9/20, 10/20, 11/20, 12/20, 1/21, 2/21, 3/21, 4/21, 5/21, 6/21, 7/21, 8/21, 9/21, 10/21, 11/21, 12/21, 1/22, 2/22, 3/22, 4/22, 5/22, 6/22, 7/22, 8/22, 9/22, 10/22, 11/22, 12/22, 1/23, 2/23, 3/23, 4/23, 5/23, 6/23, 7/23, 8/23, 9/23, 10/23, 11/23, 12/23, 1/24, 2/24, 3/24, 4/24, 5/24, 6/24, 7/24, 8/24, 9/24, 10/24, 11/24, 12/24, 1/25, 2/25, 3/25, 4/25, 5/25, 6/25, 7/25, 8/25, 9/25, 10/25, 11/25, 12/25, 1/26, 2/26, 3/26, 4/26, 5/26, 6/26, 7/26, 8/26, 9/26, 10/26, 11/26, 12/26, 1/27, 2/27, 3/27, 4/27, 5/27, 6/27, 7/27, 8/27, 9/27, 10/27, 11/27, 12/27, 1/28, 2/28, 3/28, 4/28, 5/28, 6/28, 7/28, 8/28, 9/28, 10/28, 11/28, 12/28, 1/29, 2/29, 3/29, 4/29, 5/29, 6/29, 7/29, 8/29, 9/29, 10/29, 11/29, 12/29, 1/30, 2/30, 3/30, 4/30, 5/30, 6/30, 7/30, 8/30, 9/30, 10/30, 11/30, 12/30, 1/31, 2/31, 3/31, 4/31, 5/31, 6/31, 7/31, 8/31, 9/31, 10/31, 11/31, 12/31, 1/32, 2/32, 3/32, 4/32, 5/32, 6/32, 7/32, 8/32, 9/32, 10/32, 11/32, 12/32, 1/33, 2/33, 3/33, 4/33, 5/33, 6/33, 7/33, 8/33, 9/33, 10/33, 11/33, 12/33, 1/34, 2/34, 3/34, 4/34, 5/34, 6/34, 7/34, 8/34, 9/34, 10/34, 11/34, 12/34, 1/35, 2/35, 3/35, 4/35, 5/35, 6/35, 7/35, 8/35, 9/35, 10/35, 11/35, 12/35, 1/36, 2/36, 3/36, 4/36, 5/36, 6/36, 7/36, 8/36, 9/36, 10/36, 11/36, 12/36, 1/37, 2/37, 3/37, 4/37, 5/37, 6/37, 7/37, 8/37, 9/37, 10/37, 11/37, 12/37, 1/38, 2/38, 3/38, 4/38, 5/38, 6/38, 7/38, 8/38, 9/38, 10/38, 11/38, 12/38, 1/39, 2/39, 3/39, 4/39, 5/39, 6/39, 7/39, 8/39, 9/39, 10/39, 11/39, 12/39, 1/40, 2/40, 3/40, 4/40, 5/40, 6/40, 7/40, 8/40, 9/40, 10/40, 11/40, 12/40, 1/41, 2/41, 3/41, 4/41, 5/41, 6/41, 7/41, 8/41, 9/41, 10/41, 11/41, 12/41, 1/42, 2/42, 3/42, 4/42, 5/42, 6/42, 7/42, 8/42, 9/42, 10/42, 11/42, 12/42, 1/43, 2/43, 3/43, 4/43, 5/43, 6/43, 7/43, 8/43, 9/43, 10/43, 11/43, 12/43, 1/44, 2/44, 3/44, 4/44, 5/44, 6/44, 7/44, 8/44, 9/44, 10/44, 11/44, 12/44, 1/45, 2/45, 3/45, 4/45, 5/45, 6/45, 7/45, 8/45, 9/45, 10/45, 11/45, 12/45, 1/46, 2/46, 3/46, 4/46, 5/46, 6/46, 7/46, 8/46, 9/46, 10/46, 11/46, 12/46, 1/47, 2/47, 3/47, 4/47, 5/47, 6/47, 7/47, 8/47, 9/47, 10/47, 11/47, 12/47, 1/48, 2/48, 3/48, 4/48, 5/48, 6/48, 7/48, 8/48, 9/48, 10/48, 11/48, 12/48, 1/49, 2/49, 3/49, 4/49, 5/49, 6/49, 7/49, 8/49, 9/49, 10/49, 11/49, 12/49, 1/50, 2/50, 3/50, 4/50, 5/50, 6/50, 7/50, 8/50, 9/50, 10/50, 11/50, 12/50, 1/51, 2/51, 3/51, 4/51, 5/51, 6/51, 7/51, 8/51, 9/51, 10/51, 11/51, 12/51, 1/52, 2/52, 3/52, 4/52, 5/52, 6/52, 7/52, 8/52, 9/52, 10/52, 11/52, 12/52, 1/53, 2/53, 3/53, 4/53, 5/53, 6/53, 7/53, 8/53, 9/53, 10/53, 11/53, 12/53, 1/54, 2/54, 3/54, 4/54, 5/54, 6/54, 7/54, 8/54, 9/54, 10/54, 11/54, 12/54, 1/55, 2/55, 3/55, 4/55, 5/55, 6/55, 7/55, 8/55, 9/55, 10/55, 11/55, 12/55, 1/56, 2/56, 3/56, 4/56, 5/56, 6/56, 7/56, 8/56, 9/56, 10/56, 11/56, 12/56, 1/57, 2/57, 3/57, 4/57, 5/57, 6/57, 7/57, 8/57, 9/57, 10/57, 11/57, 12/57, 1/58, 2/58, 3/58, 4/58, 5/58, 6/58, 7/58, 8/58, 9/58, 10/58, 11/58, 12/58, 1/59, 2/59, 3/59, 4/59, 5/59, 6/59, 7/59, 8/59, 9/59, 10/59, 11/59, 12/59, 1/60, 2/60, 3/60, 4/60, 5/60, 6/60, 7/60, 8/60, 9/60, 10/60, 11/60, 12/60, 1/61, 2/61, 3/61, 4/61, 5/61, 6/61, 7/61, 8/61, 9/61, 10/61, 11/61, 12/61, 1/62, 2/62, 3/62, 4/62, 5/62, 6/62, 7/62, 8/62, 9/62, 10/62, 11/62, 12/62, 1/63, 2/63, 3/63, 4/63, 5/63, 6/63, 7/63, 8/63, 9/63, 10/63, 11/63, 12/63, 1/64, 2/64, 3/64, 4/64, 5/64, 6/64, 7/64, 8/64, 9/64, 10/64, 11/64, 12/64, 1/65, 2/65, 3/65, 4/65, 5/65, 6/65, 7/65, 8/65, 9/65, 10/65, 11/65, 12/65, 1/66, 2/66, 3/66, 4/66, 5/66, 6/66, 7/66, 8/66, 9/66, 10/66, 11/66, 12/66, 1/67, 2/67, 3/67, 4/67, 5/67, 6/67, 7/67, 8/67, 9/67, 10/67, 11/67, 12/67, 1/68, 2/68, 3/68, 4/68, 5/68, 6/68, 7/68, 8/68, 9/68, 10/68, 11/68, 12/68, 1/69, 2/69, 3/69, 4/69, 5/69, 6/69, 7/69, 8/69, 9/69, 10/69, 11/69, 12/69, 1/70, 2/70, 3/70, 4/70, 5/70, 6/70, 7/70, 8/70, 9/70, 10/70, 11/70, 12/70, 1/71, 2/71, 3/71, 4/71, 5/71, 6/71, 7/71, 8/71, 9/71, 10/71, 11/71, 12/71, 1/72, 2/72, 3/72, 4/72, 5/72, 6/72, 7/72, 8/72, 9/72, 10/72, 11/72, 12/72, 1/73, 2/73, 3/73, 4/73, 5/73, 6/73, 7/73, 8/73, 9/73, 10/73, 11/73, 12/73, 1/74, 2/74, 3/74, 4/74, 5/74, 6/74, 7/74, 8/74, 9/74, 10/74, 11/74, 12/74, 1/75, 2/75, 3/75, 4/75, 5/75, 6/75, 7/75, 8/75, 9/75, 10/75, 11/75, 12/75, 1/76, 2/76, 3/76, 4/76, 5/76, 6/76, 7/76, 8/76, 9/76, 10/76, 11/76, 12/76, 1/77, 2/77, 3/77, 4/77, 5/77, 6/77, 7/77, 8/77, 9/77, 10/77, 11/77, 12/77, 1/78, 2/78, 3/78, 4/78, 5/78, 6/78, 7/78, 8/78, 9/78, 10/78, 11/78, 12/78, 1/79, 2/79, 3/79, 4/79, 5/79, 6/79, 7/79, 8/79, 9/79, 10/79, 11/79, 12/79, 1/80, 2/80, 3/80, 4/80, 5/80, 6/80, 7/80, 8/80, 9/80, 10/80, 11/80, 12/80, 1/81, 2/81, 3/81, 4/81, 5/81, 6/81, 7/81, 8/81, 9/81, 10/81, 11/81, 12/81, 1/82, 2/82, 3/82, 4/82, 5/82, 6/82, 7/82, 8/82, 9/82, 10/82, 11/82, 12/82, 1/83, 2/83, 3/83, 4/83, 5/83, 6/83, 7/83, 8/83, 9/83, 10/83, 11/83, 12/83, 1/84, 2/84, 3/84, 4/84, 5/84, 6/84, 7/84, 8/84, 9/84, 10/84, 11/84, 12/84, 1/85, 2/85, 3/85, 4/85, 5/85, 6/85, 7/85, 8/85, 9/85, 10/85, 11/85, 12/85, 1/86, 2/86, 3/86, 4/86, 5/86, 6/86, 7/86, 8/86, 9/86, 10/86, 11/86, 12/86, 1/87, 2/87, 3/87, 4/87, 5/87, 6/87, 7/87, 8/87, 9/87, 10/87, 11/87, 12/87, 1/88, 2/88, 3/88, 4/88, 5/88, 6/88, 7/88, 8/88, 9/88, 10/88, 11/88, 12/88, 1/89, 2/89, 3/89, 4/89, 5/89, 6/89, 7/89, 8/89, 9/89, 10/89, 11/89, 12/89, 1/90, 2/90, 3/90, 4/90, 5/90, 6/90, 7/90, 8/90, 9/90, 10/90, 11/90, 12/90, 1/91, 2/91, 3/91, 4/91, 5/91, 6/91, 7/91, 8/91, 9/91, 10/91, 11/91, 12/91, 1/92, 2/92, 3/92, 4/92, 5/92, 6/92, 7/92, 8/92, 9/92, 10/92, 11/92, 12/92, 1/93, 2/93, 3/93, 4/93, 5/93, 6/93, 7/93, 8/93, 9/93, 10/93, 11/93, 12/93, 1/94, 2/94, 3/94, 4/94, 5/94, 6/94, 7/94, 8/94, 9/94, 10/94, 11/94, 12/94, 1/95, 2/95, 3/95, 4/95, 5/95, 6/95, 7/95, 8/95, 9/95, 10/95, 11/95, 12/95, 1/96, 2/96, 3/96, 4/96, 5/96, 6/96, 7/96, 8/96, 9/96, 10/96, 11/96, 12/96, 1/97, 2/97, 3/97, 4/97, 5/97, 6/97, 7/97, 8/97, 9/97, 10/97, 11/97, 12/97, 1/98, 2/98, 3/98, 4/98, 5/98, 6/98, 7/98, 8/98, 9/98, 10/98, 11/98, 12/98, 1/99, 2/99, 3/99, 4/99, 5/99, 6/99, 7/99, 8/99, 9/99, 10/99, 11/99, 12/99, 1/100, 2/100, 3/100, 4/100, 5/100, 6/100, 7/100, 8/100, 9/100, 10/100, 11/100, 12/100

TAMPA HARBOR  
HILLSBOROUGH COUNTY, FLORIDA  
**HYDROGRAPHIC EXAM SURVEY FY19**  
**43-FOOT PROJECT**  
STA. 60+00 THRU STA. 90+00 CUT-E (TB)  
**PLAN**

Scale: AS SHOWN

Drawing no.

**12**

SHEET 12 OF 14

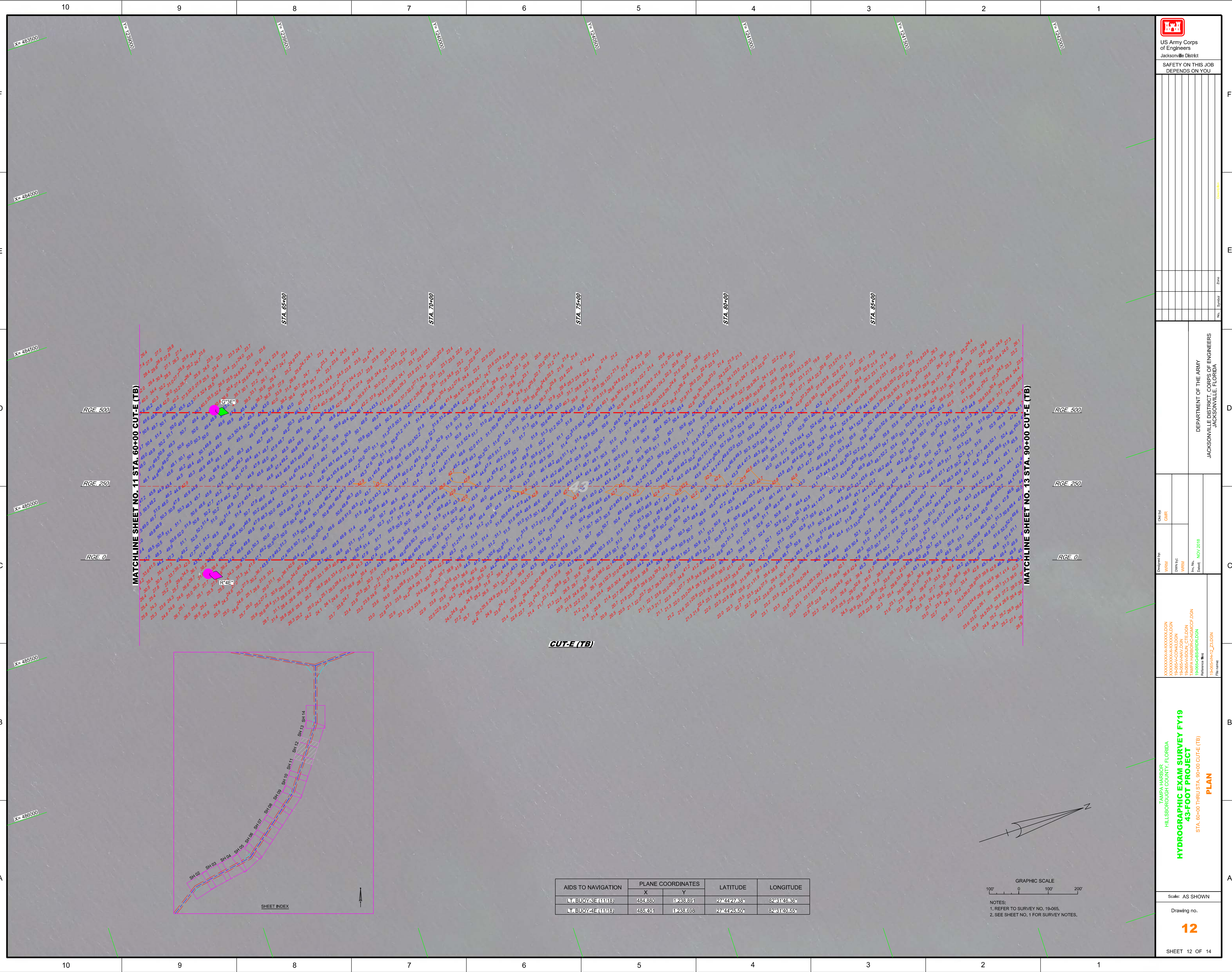

**CUT-E (TB)**

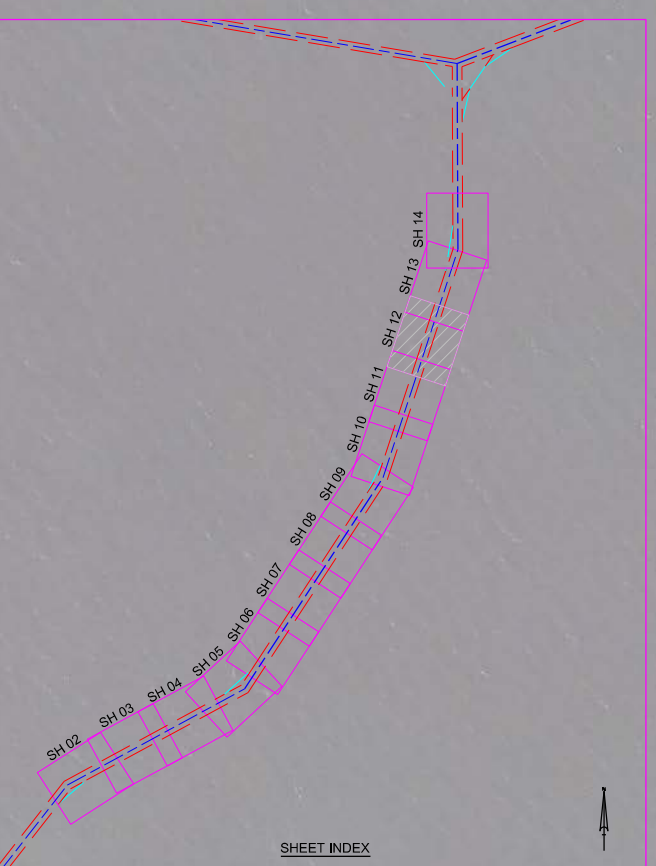

AIDS TO NAVIGATION	PLANE COORDINATES		LATITUDE	LONGITUDE
	X	Y		
LT, BUOY-3E (11/18)	484,880	11238,891	27°44'27.38"	82°31'46.36"
LT, BUOY-4E (11/18)	485,401	11238,638	27°44'25.50"	82°31'40.55"

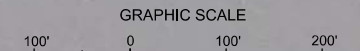

NOTES:  
1. REFER TO SURVEY NO. 19-065.  
2. SEE SHEET NO. 1 FOR SURVEY NOTES.

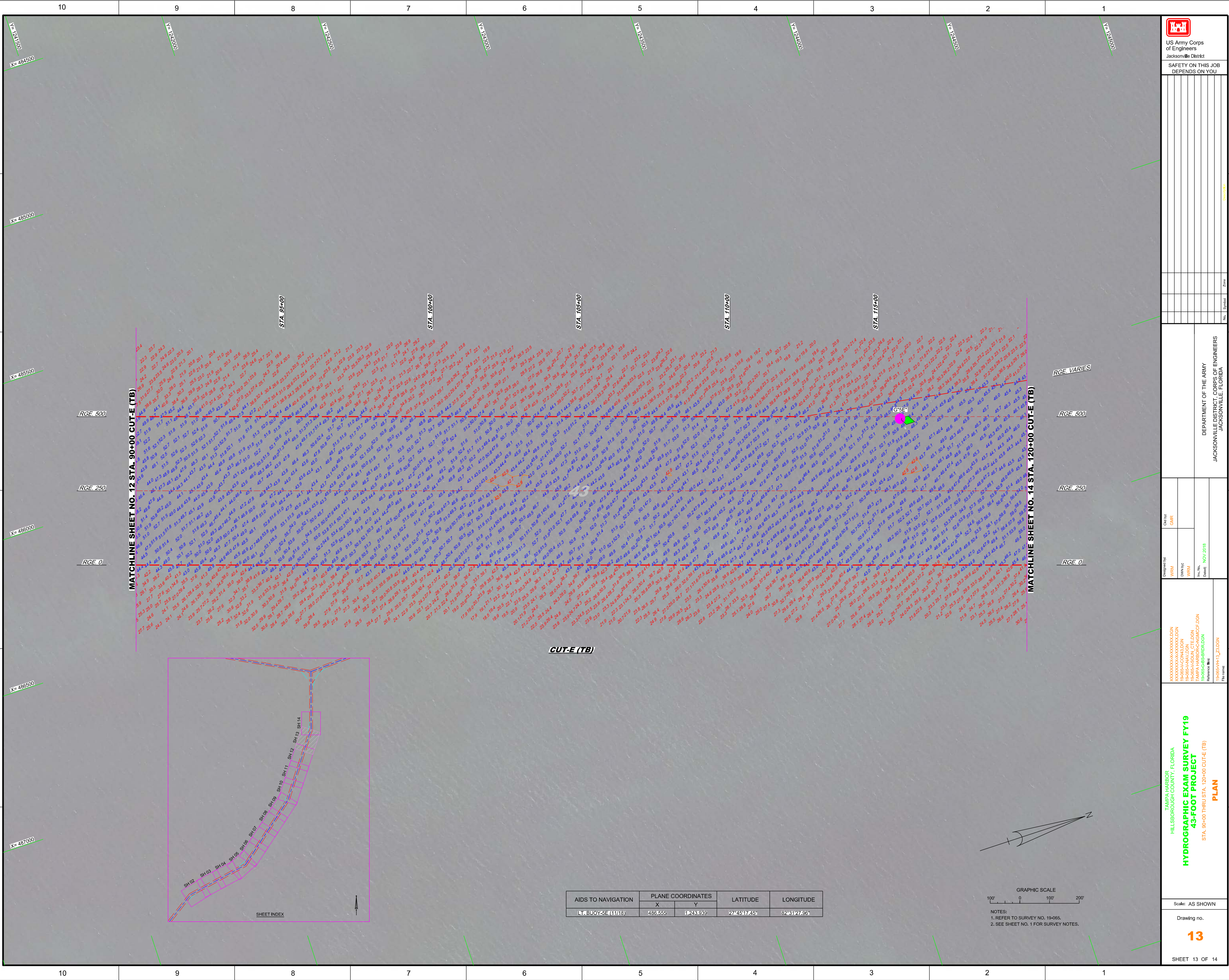

**CUT-E (TB)**

AIDS TO NAVIGATION	PLANE COORDINATES		LATITUDE	LONGITUDE
	X	Y		
LT. BUOY-5E (1118)	486.555	11243.839	27°45'17.45"	82°31'27.36"

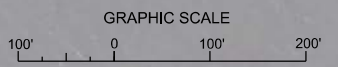

NOTES:  
1. REFER TO SURVEY NO. 19-065.  
2. SEE SHEET NO. 1 FOR SURVEY NOTES.

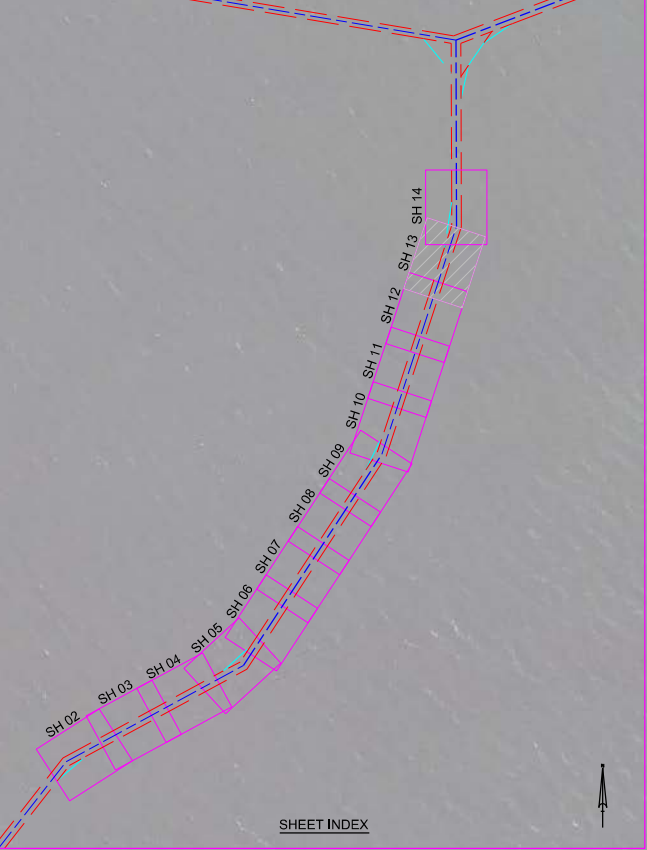

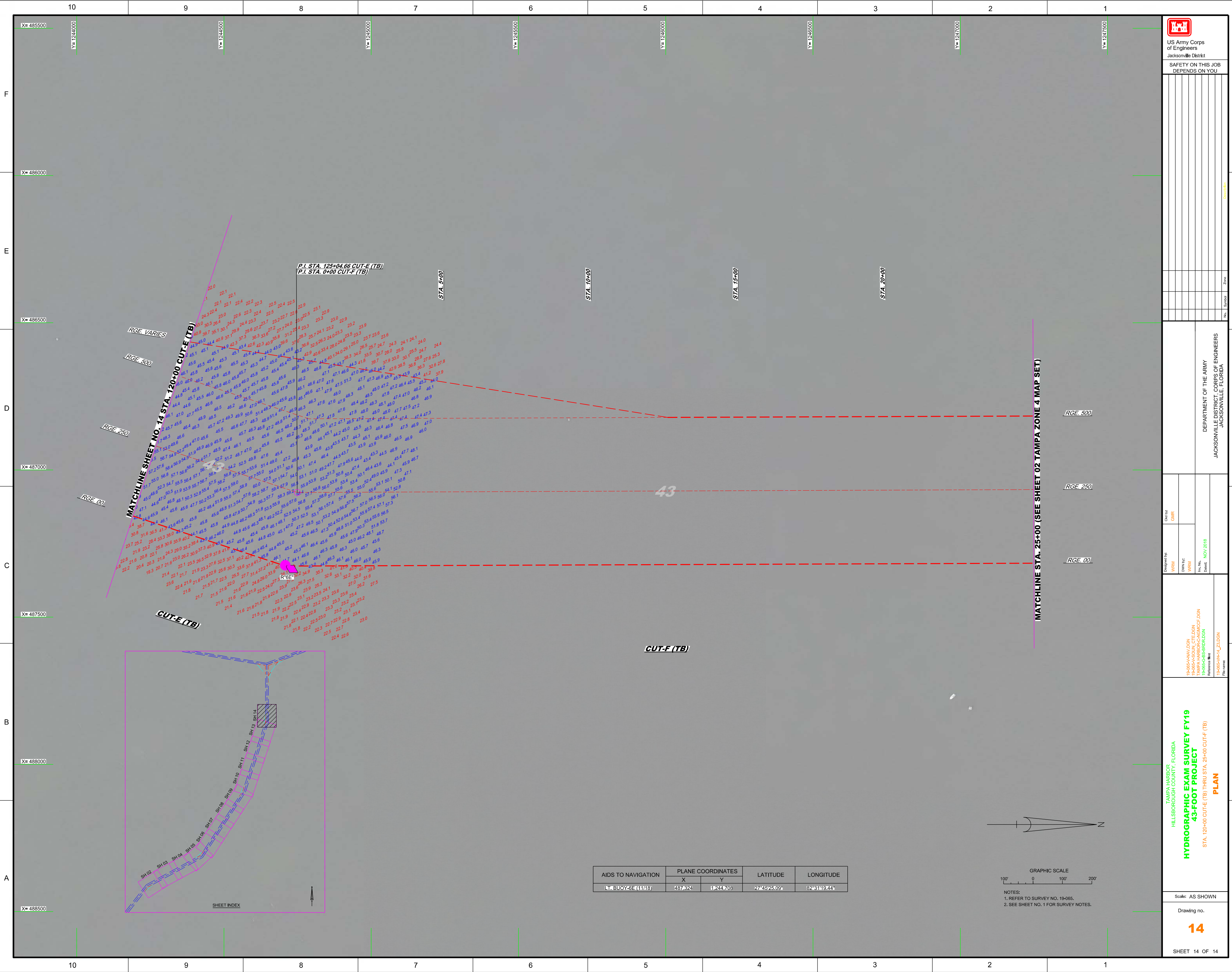

AIDS TO NAVIGATION	PLANE COORDINATES		LATITUDE	LONGITUDE
	X	Y		
LT. BUOY-58 (11/18)	487824	1247708	27°45'25.09"	82°31'19.44"

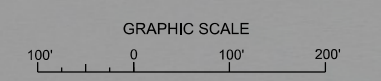

NOTES:  
1. REFER TO SURVEY NO. 19-065.  
2. SEE SHEET NO. 1 FOR SURVEY NOTES.