



DEPARTMENT OF THE ARMY
JACKSONVILLE DISTRICT CORPS OF ENGINEERS
P.O. BOX 4970
JACKSONVILLE, FLORIDA 32232-0019

May 14, 2014

REPLY TO
ATTENTION OF

Regulatory Division
North Permits Branch
Jacksonville Permits Section
SAJ-1991-02068 (SP-BAL)

Mr. Kim Weisenburger
United States Marine Corps
Blount Island Support Facility
5880 Channel View Blvd
Jacksonville, FL 32226

Dear Mr. Weisenburger:

The U.S. Army Corps of Engineers (Corps) is pleased to enclose the Department of the Army permit, which should be available at the construction site. Work may begin immediately but the Corps must be notified of:

- a. The date of commencement of the work,
- b. The dates of work suspensions and resumptions of work, if suspended over a week, and
- c. The date of final completion.

This information should be mailed to the Special Projects and Enforcement Branch of the Regulatory Division of the Jacksonville District at P.O. Box 4970, Jacksonville, FL 32232 (Attn: Ms. Dianne Griffin). The Special Projects and Enforcement Branch is also responsible for inspections to determine whether Permittees have strictly adhered to permit conditions.

IT IS NOT LAWFUL TO DEVIATE FROM
THE APPROVED PLANS ENCLOSED.

Sincerely,

Donald W. Kinard
Chief, Regulatory Division

Enclosure

cc: Kwg + Weatmby
CESAT-RD-PE

DEPARTMENT OF THE ARMY PERMIT

Permittee: United States Marine Corps (Marine Corps)
Attn: Mr. Kim Weisenburger
Blount Island Support Facility
5880 Channel View Blvd
Jacksonville, FL 32226

Permit No: SAJ-1991-02068(SP-BAL)

Issuing Office: U.S. Army Engineer District, Jacksonville

NOTE: The term "you" and its derivatives, as used in this permit, means the permittee or any future transferee. The term "this office" refers to the appropriate district or division office of the Corps of Engineers having jurisdiction over the permitted activity or the appropriate official of that office acting under the authority of the commanding officer.

You are authorized to perform work in accordance with the terms and conditions specified below.

Project Description: The permittee is authorized to annually maintenance dredge approximately 300,000 cubic yards of dredged material from the Marine Corps Slipway Channel at Blount Island. The work will be conducted by either using a cutter-suction, mechanical (excavator or clamshell) and/or hopper dredge. The channel will be maintenance dredged to -38 feet (ft) Mean Lower Low Water (MLLW) (plus -2 ft allowable overdepth). The dredged material will be disposed in the Dayson Island Dredged Material Management Area (DMMA). In addition, the return water from the two 30 inch outfall pipes in the DMMA is authorized under the permit. The work described above is to be completed in accordance with the 7 pages of drawings affixed at the end of this permit instrument.

Project Location: The project is located in navigable waters of the United States, the St. Johns River at the Marine Corps Slipway Channel at Blount Island in Sections 20 and 29, Township 01 South, Range 28 East, Jacksonville, Duval County, Florida.

Approximate Central Coordinates: Latitude: 30.39810°
Longitude: -81.52023°

Permit Conditions

General Conditions:

1. The time limit for completing the work authorized ends on **May 14, 2024**. If you find that you need more time to complete the authorized activity, submit your request for

PERMIT NUMBER: SAJ-1991-02068(SP-BAL)
PERMITTEE: United States Marine Corps
PAGE 2 of 10

a time extension to this office for consideration at least one month before the above date is reached.

2. You must maintain the activity authorized by this permit in good condition and in conformance with the terms and conditions of this permit. You are not relieved of this requirement if you abandon the permitted activity, although you may make a good faith transfer to a third party in compliance with General Condition 4 below. Should you wish to cease to maintain the authorized activity or should you desire to abandon it without a good faith transfer, you must obtain a modification of this permit from this office, which may require restoration of the area.

3. If you discover any previously unknown historic or archeological remains while accomplishing the activity authorized by this permit, you must immediately notify this office of what you have found. We will initiate the Federal and State coordination required to determine if the remains warrant a recovery effort or if the site is eligible for listing in the National Register of Historic Places.

4. If you sell the property associated with this permit, you must obtain the signature and the mailing address of the new owner in the space provided and forward a copy of the permit to this office to validate the transfer of this authorization.

5. If a conditioned water quality certification has been issued for your project, you must comply with the conditions specified in the certification as special conditions to this permit. For your convenience, a copy of the certification is attached if it contains such conditions.

6. You must allow representatives from this office to inspect the authorized activity at any time deemed necessary to ensure that it is being or has been accomplished in accordance with the terms and conditions of your permit.

Special Conditions:

1. Commencement & Completion Notification: The Permittee shall provide to the Corps a written notification of the date of commencement of work authorized by this permit at least 15 days before initiation of any dredging operations authorized by this permit and a completion notification no less than 15 days after the completion of the dredging operation. The notification should be sent to the following address: U.S. Army Corps of Engineers, Regulatory Division, **Enforcement Branch**, P.O. Box 4970, Jacksonville, FL 32232-0019 and shall reference this permit number, SAJ-1991-02068(SP-BAL), on all submittals.

2. Bathymetric Survey: The Permittee shall conduct a bathymetric survey of the

PERMIT NUMBER: SAJ-1991-02068(SP-BAL)

PERMITTEE: United States Marine Corps

PAGE 3 of 10

project area within 60 days following project completion and submit the survey to the Corps. The Permittee shall include information on the total volume of dredged material with the survey. The information shall be sent to the address listed in special condition 1 above.

3. Manatee Conditions: The Permittee shall comply with the "Standard Manatee Conditions for In-Water Work - 2011" attached to the permit.

4. Mooring Fenders or Buoys: The Permittee shall install and maintain mooring fenders or buoys to provide sufficient standoff space of at least four feet (under maximum compression) between vessels and bulkheads, and also between two vessels that are moored together to prevent the crushing of a manatee.

5. Clamshell Dredging Conditions:

a. Observers: The Permittee shall ensure that when in-water work is being performed or vessels are moving, at least one person will be designated as protected marine animal observer. Only individuals having previous, on-water experiences serving as dedicated, protected marine animal observers during daytime and nighttime dredging operations, including clamshell dredging, shall serve in this capacity for the proposed work. The Permittee shall retain a record that includes proof of the observer's qualifications, such as, the observer's name, previous observation experience (project title, location, date) and hours of dedicated observation per project, and make that record available upon request. Observers will be equipped with binoculars and polarized sunglasses to assist with observations during daylight operations, and advise personnel to cease operations upon sighting a manatee within 50 feet of any in-water construction. If the dedicated observers determine that detection of manatees during certain weather conditions (i.e. fog, rain, wind, etc.) is not possible, the Permittee will cease operation until weather conditions improve and detection is again possible.

b. Operations: For clamshell operations, the observer shall be stationed in a position to clearly observe the point of entry and exit of the clamshell bucket, as well as the waters surrounding that operation to a radius of 200 feet around the hoist line of the bucket. The dredge operator will gravity-release the clamshell bucket beginning at the water's surface, and only after confirmation that there are no manatees or marine turtles within the 50-foot safety distance identified in the standard conditions. In order to better observe manatees and marine turtles during nighttime clamshell operations, the Permittee shall install lighting, shielding and/or otherwise directed, which illuminates only the water surface within 200-foot radius of the clamshell bucket hoist line. Such lighting shall be installed to not represent a hazard to navigation, or violation of any other operational safety requirement.

PERMIT NUMBER: SAJ-1991-02068(SP-BAL)

PERMITTEE: United States Marine Corps

PAGE 4 of 10

c. Reporting: All observers shall maintain a daily log that details sightings, collisions, or injuries to protected marine animals, as well as specific information (such as work itinerary, weather, work shutdowns, observer shift changes, length of time of sightings, estimate distance of animal from the dredge/equipment/vessel, animal behavior during the sighting, and actions taken as a result of sightings, collisions or injuries). The logs and final summary report that includes the location and name of the project, and the dates and times of work shall be submitted within 30 days following project completion to the U.S. Fish and Wildlife Service at jaxregs@fws.gov.

6. Hopper Dredging Conditions:

a. Reporting: The Permittee shall ensure all reports, notifications, documentation and correspondence required by the general or special conditions of this Department of the Army (DA) permit are submitted to the Corps at the following email address: sajdredgenotice@usace.army.mil. Requests for documents, forms or information should also be submitted to the Corps at this email address. The Permittee shall reference this DA permit number, SAJ-1991-02068(SP-BAL), 'SARBO', and include the topic in the subject line of the email and on all submittals.

b. Deflector Device Submittal: No dredging shall be performed by a hopper dredge without the inclusion of an approved rigid sea turtle deflector device. The Permittee shall ensure that drawings of the proposed sea turtle deflector device and the Hopper Dredge Deflector Device Checklist are complete and all required documentation submitted to the Corps, at least 30 days prior to initiating the authorized work. The Permittee shall not commence hopper dredging until approval of the sea turtle deflector device has been granted by the Corps. A copy of the approved drawings, calculations and signed Hopper Dredge Deflector Device Checklist form shall be available on the vessel during dredging operations.

c. Pre-Dredging Inspection Submittal: The Permittee shall submit the completed Hopper Dredge Pre-Dredge Inspection Checklist form to the Corps, at least 5 days prior to initiating the authorized work.

d. Dredging Quality Management: Dredging and dredged material disposal and monitoring of dredging projects using the Dredging Quality Management (DQM) system shall be implemented for this DA permit. The Permittee shall ensure that each hopper dredge assigned to the work authorized by this DA permit is equipped with DQM, previously known as 'Silent Inspector', for hopper dredge monitoring. The Permittee's DQM system must have been certified by the DQM Support Team within one calendar year prior to the initiation of the dredging/disposal. Questions regarding certification should be addressed to the DQM Support Center at 251-690-3011. Additional information about the DQM System can be found at <http://dqm.usace.army.mil>. The

PERMIT NUMBER: SAJ-1991-02068(SP-BAL)

PERMITTEE: United States Marine Corps

PAGE 5 of 10

Permittee is responsible for insuring that the DQM system is operational throughout the dredging and disposal project and that project data are submitted to the DQM National Support Center in accordance with the specifications provided at the aforementioned website. The data collected by the DQM system shall, upon request, be made available to the Regulatory Division of the U.S. Army Corps of Engineers - Jacksonville District.

e. Commencement Notification: Within 3 days from the date of initiating the authorized work, the Permittee shall provide to the Corps, the completed Hopper Dredge Startup Inspection Checklist form (Attachment 3) with a written notification of the date of commencement of work authorized by this DA permit. An inspection of the hopper dredge will be scheduled and performed by the Corps after receipt of the notification of commencement.

7. Regional Biological Opinion: Dredging is approved under the current National Marine Fisheries Service (NMFS) South Atlantic Regional Biological Opinion (SARBO) and its references which can be viewed on the following web site: <http://el.erdc.usace.army.mil/seaturtles/refs-bo.cfm>. The permittee is responsible for obtaining and complying with the SARBO. If the permittee is unable to view the SARBO at this website the permittee shall contact the Corps to receive a copy of the SARBO. The permittee shall implement all reasonable and prudent measures identified in the SARBO. NMFS has issued the SARBO to the Corps of Engineers for hopper dredge projects that limit the take of listed turtles, sturgeon, and any other species listed in the SARBO. Authorization under this DA permit is conditional upon compliance with all of the mandatory terms and conditions associated with the SARBO, which terms and conditions are incorporated by reference in this DA permit. Failure to comply with the terms and conditions associated with the SARBO, where a take of the listed species occurs, would constitute non-compliance with this DA permit. Failure to comply with this DA permit will be the basis for suspension and revocation of this DA permit and may be the basis for other enforcement action. NMFS has directed that this SARBO issued to the Corps serve as the formal consultation for all hopper dredge projects in the area covered by the SARBO, however, where the terms and conditions of the SARBO differ from the Special Conditions of this DA permit, the Special Conditions of this DA permit will take precedence as the more stringent condition.

Further Information:

1. Congressional Authorities: You have been authorized to undertake the activity described above pursuant to:

(x) Section 10 of the Rivers and Harbors Act of 1899
(33 U.S.C. 403).

PERMIT NUMBER: SAJ-1991-02068(SP-BAL)
PERMITTEE: United States Marine Corps
PAGE 6 of 10

(x) Section 404 of the Clean Water Act (33 U.S.C. 1344).

() Section 103 of the Marine Protection, Research and Sanctuaries Act of 1972 (33 U.S.C. 1413).

2. Limits of this authorization.

a. This permit does not obviate the need to obtain other Federal, State, or local authorizations required by law.

b. This permit does not grant any property rights or exclusive privileges.

c. This permit does not authorize any injury to the property or rights of others.

d. This permit does not authorize interference with any existing or proposed Federal projects.

3. Limits of Federal Liability. In issuing this permit, the Federal Government does not assume any liability for the following:

a. Damages to the permitted project or uses thereof as a result of other permitted or unpermitted activities or from natural causes.

b. Damages to the permitted project or uses thereof as a result of current or future activities undertaken by or on behalf of the United States in the public interest.

c. Damages to persons, property, or to other permitted or unpermitted activities or structures caused by the activity authorized by this permit.

d. Design or construction deficiencies associated with the permitted work.

e. Damage claims associated with any future modification, suspension, or revocation of this permit.

4. Reliance on Applicant's Data: The determination of this office that issuance of this permit is not contrary to the public interest was made in reliance on the information you provided.

5. Reevaluation of Permit Decision: This office may reevaluate its decision on this permit at any time the circumstances warrant. Circumstances that could require a reevaluation include, but are not limited to, the following:

PERMIT NUMBER: SAJ-1991-02068(SP-BAL)

PERMITTEE: United States Marine Corps

PAGE 7 of 10

- a. You fail to comply with the terms and conditions of this permit.
- b. The information provided by you in support of your permit application proves to have been false, incomplete, or inaccurate (see 4 above).
- c. Significant new information surfaces which this office did not consider in reaching the original public interest decision.

Such a reevaluation may result in a determination that it is appropriate to use the suspension, modification, and revocation procedures contained in 33 CFR 325.7 or enforcement procedures such as those contained in 33 CFR 326.4 and 326.5. The referenced enforcement procedures provide for the issuance of an administrative order requiring you comply with the terms and conditions of your permit and for the initiation of legal action where appropriate. You will be required to pay for any corrective measures ordered by this office, and if you fail to comply with such directive, this office may in certain situations (such as those specified in 33 CFR 209.170) accomplish the corrective measures by contract or otherwise and bill you for the cost.

6. Extensions: General Condition 1 establishes a time limit for the completion of the activity authorized by this permit. Unless there are circumstances requiring either a prompt completion of the authorized activity or a reevaluation of the public interest decision, the Corps will normally give favorable consideration to a request for an extension of this time limit.

PERMIT NUMBER: SAJ-1991-02068(SP-BAL)
PERMITTEE: United States Marine Corps
PAGE 8 of 10

Your signature below, as permittee, indicates that you accept and agree to comply with the terms and conditions of this permit.

Kim Weisenburger
(PERMITTEE)

9 May 2014
(DATE)

KIM WEISENBURGER
(PERMITTEE NAME-PRINTED)

This permit becomes effective when the Federal official, designated to act for the Secretary of the Army, has signed below.

Randy L. Turner
(DISTRICT ENGINEER)

14 MAY 2014
(DATE)

Alan M. Dodd
Alan M. Dodd,
Colonel, U.S. Army
District Commander

PERMIT NUMBER: SAJ-1991-02068(SP-BAL)
PERMITTEE: United States Marine Corps
PAGE 9 of 10

When the structures or work authorized by this permit are still in existence at the time the property is transferred, the terms and conditions of this permit will continue to be binding on the new owner(s) of the property. To validate the transfer of this permit and the associated liabilities associated with compliance with its terms and conditions, have the transferee sign and date below.

(TRANSFEREE-SIGNATURE)

(DATE)

(NAME-PRINTED)

(ADDRESS)

(CITY, STATE, AND ZIP CODE)

PERMIT NUMBER: SAJ-1991-02068(SP-BAL)
PERMITTEE: United States Marine Corps
PAGE 10 of 10

***Attachments to Department of the Army
Permit Number SAJ-1991-02068(SP-BAL)***

1. PERMIT DRAWINGS: 8 pages, dated May 5, 2014
2. WATER QUALITY CERTIFICATION: Specific Conditions of the water quality permit/certification in accordance with General Condition number 5 on page 2 of this DA permit. 2 pages
3. MANATEE CONDITIONS: 2 pages, *Standard Manatee Conditions for In-Water Work – 2011*
4. HOPPER DREDGE DEFLECTOR DEVICE CHECKLIST: 2 pages, undated
5. HOPPER DREDGE PRE-DREDGE INSPECTION CHECKLIST: 2 pages, undated
6. HOPPER DREDGE STARTUP INSPECTION CHECKLIST: 2 pages, undated

MARINE CORPS SUPPORT FACILITY BLOUNT ISLAND SLIPWAY CHANNEL BLOUNT ISLAND, DUVAL COUNTY, FL.

38-FOOT MAINTENANCE DREDGING PROJECT

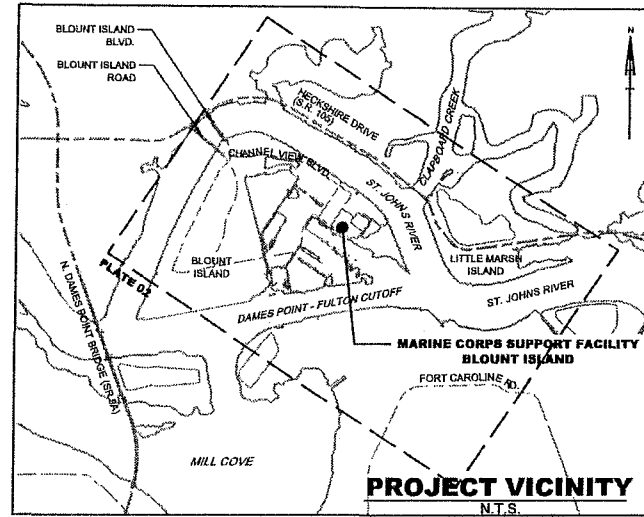
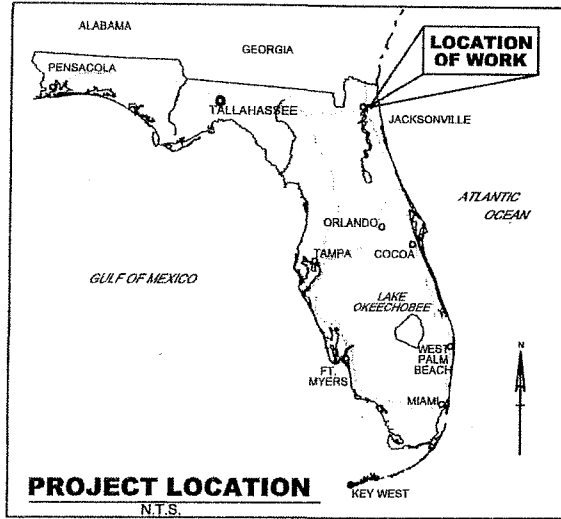

ABBREVIATIONS:

APPROX. = APPROXIMATE
 D/A = DISPOSAL AREA
 DWG. = DRAWING
 CONC. = CONCRETE
 E. = EAST
 ELEV. = ELEVATION
 FT. = FOOT/FEET
 HDPE. = HIGH DENSITY POLYETHYLENE
 MAX. = MAXIMUM
 MCS = MARINE CORPS SLIPWAY
 MIN. = MINIMUM
 M.H.W. = MEAN HIGH WATER
 M.L.W. = MEAN LOW WATER
 M.L.L.W. = MEAN LOWER LOW WATER
 N. = NORTH
 NO. = NUMBER
 NOS. = NUMBERS
 N.T.S. = NOT TO SCALE
 RGE. = RANGE
 S. = SOUTH
 STA. = STATIONING
 TYP. = TYPICAL
 USACE. = UNITED STATES ARMY CORPS OF ENGINEERS
 USCG. = UNITED STATES COAST GUARD
 W. = WEST
 W/ = WITH

LEGEND:

- PROJECT CHANNEL
- AREA TO BE DREDGED
- BOULDERS/RIPRAP
- DREDGED MATERIAL MANAGEMENT AREA (DMMA)
- DREDGE PIPELINE ROUTE
- VERTICAL CONTROL POINT
- HORIZONTAL CONTROL POINT
- AIDS TO NAVIGATION
- 24.5 - ELEVATION AND LOCATION

INDEX TO DRAWINGS

PLATE	TITLE
01	COVER SHEET
02	SLIPWAY- PROJECT SITE
03	SLIPWAY CHANNEL CONTROL DATA
04	SLIPWAY DREDGING PLAN (STA. 0+00 TO STA.28+00)
05	SLIPWAY DREDGING PLAN (STA. 28+00 TO STA. 56+09.1)
06	TYPICAL CHANNEL CROSS-SECTION
07	EXISTING DAYSON ISLAND DMMA
08	TYPICAL DMMA CROSS SECTIONS

U.S. ARMY CORPS OF ENGINEERS
 SAJ-1991-02068(SP-BAL)
 US Marine Corps - Blount Island
 PAGE 1 OF 8 5 May 2014



US Army Corps
 of Engineers
 Jacksonville District

WQC PERMIT PLATE
 NOT FOR CONSTRUCTION

DEPARTMENT OF THE ARMY
 JACKSONVILLE DISTRICT, CORPS OF ENGINEERS
 JACKSONVILLE, FLORIDA

Dsn by:	JWL	DATE	4/04/14	APPROVED	REVISION
Dwn by:	MR2			L.R.P.	
Ckd by:	LRP				
Dated:	APRIL 2014				

MARINE CORPS SUPPORT FACILITY BLOUNT ISLAND
 DUVAL COUNTY, FLORIDA
 MAINTENANCE DREDGING PROJECT
 WQC PERMIT PLATE
 COVER SHEET

PLATE

01

OF 8

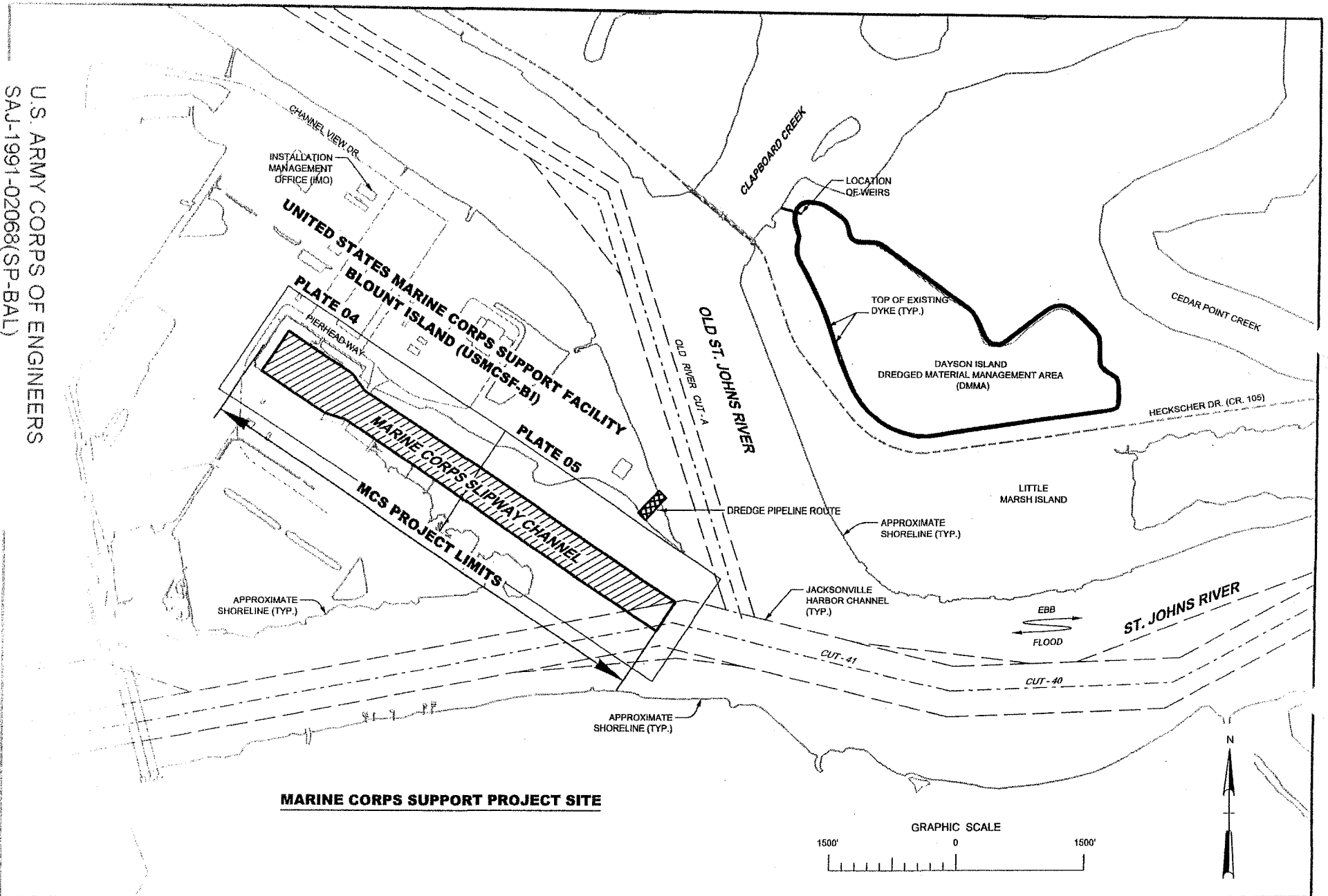

MARINE CORPS SUPPORT PROJECT SITE



US Army Corps
of Engineers
Jacksonville District

WQC PERMIT PLATE
NOT FOR CONSTRUCTION

DEPARTMENT OF THE ARMY
JACKSONVILLE DISTRICT, CORPS OF ENGINEERS
JACKSONVILLE, FLORIDA

Dsn by:	JWL	DATE	4/04/14	APPROVED	REVISION
Dwn by:	MR2			L.R.P.	
Ckd by:	LRP				
Dated:	APRIL 2014				

**MARINE CORPS SUPPORT FACILITY BLOUNT ISLAND
 DUVAL COUNTY, FLORIDA
 MAINTENANCE DREDGING PROJECT
 WQC PERMIT PLATE
 SLIPWAY- PROJECT SITE**

PLATE
02
OF 8

PROJECT SURVEY CONTROL:

PID	DESIGNATION	X COORDINATE	Y COORDINATE	ELEVATION	
				NAVD88	MLLW
BBBX61	BIMT-101	495,094.96	2,204,048.87	12.01	14.37

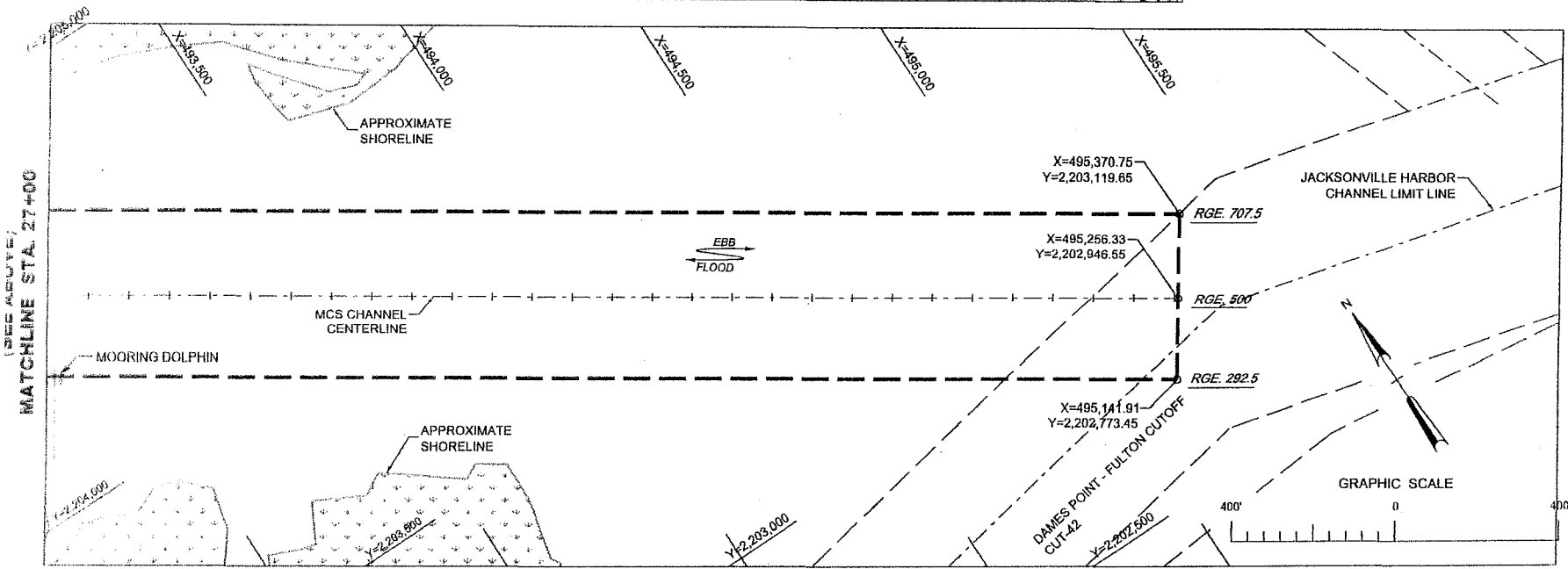
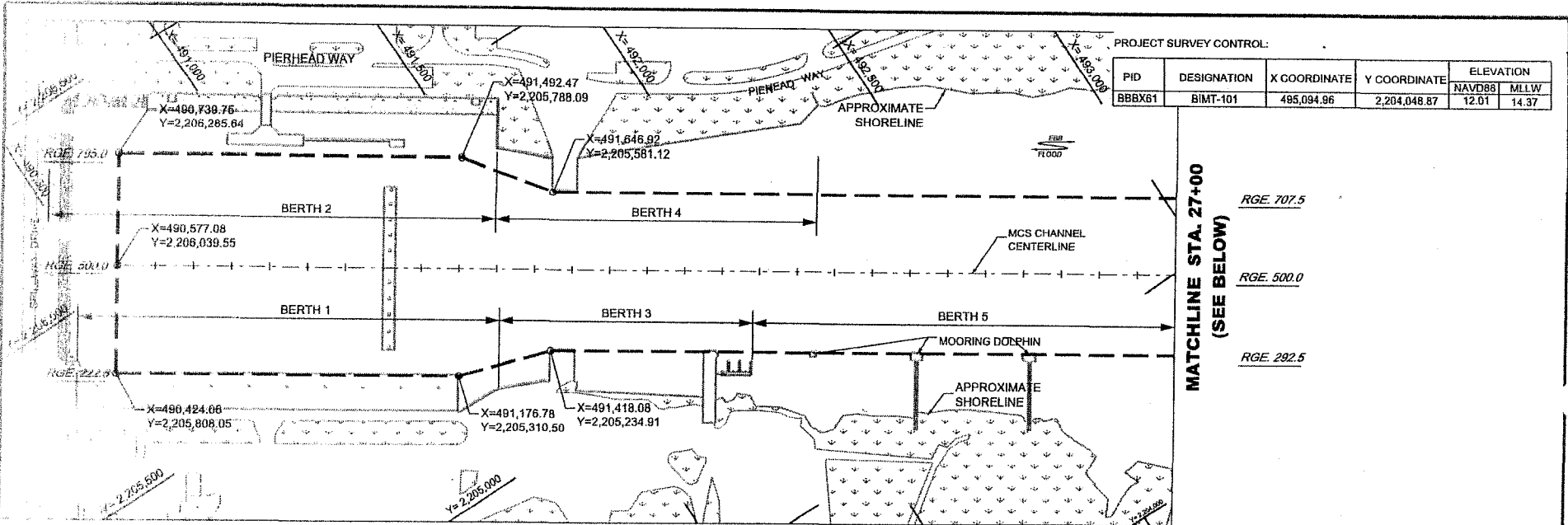

<p>U.S. ARMY CORPS OF ENGINEERS SAJ-1991-02068(SP-BAL) U.S. Marine Corps - Blount Island PAGE 3 OF 8 5 May 2014</p>	<p>WQC PERMIT PLATE NOT FOR CONSTRUCTION</p>		<p>Dsn by: JWL</p>	<p>DATE 4/04/14</p>	<p>APPROVED L.R.P.</p>	<p>REVISION</p>	<p>MARINE CORPS SUPPORT FACILITY BLOUNT ISLAND DUVAL COUNTY, FLORIDA MAINTENANCE DREDGING PROJECT WQC PERMIT PLATE SLIPWAY CHANNEL CONTROL DATA</p>	<p>PLATE 03 OF 8</p>
	<p>DEPARTMENT OF THE ARMY JACKSONVILLE DISTRICT, CORPS OF ENGINEERS JACKSONVILLE, FLORIDA</p>		<p>Dwn by: MR2</p>					
			<p>Ckd by: LRP</p>					
			<p>Dated: APRIL 2014</p>					

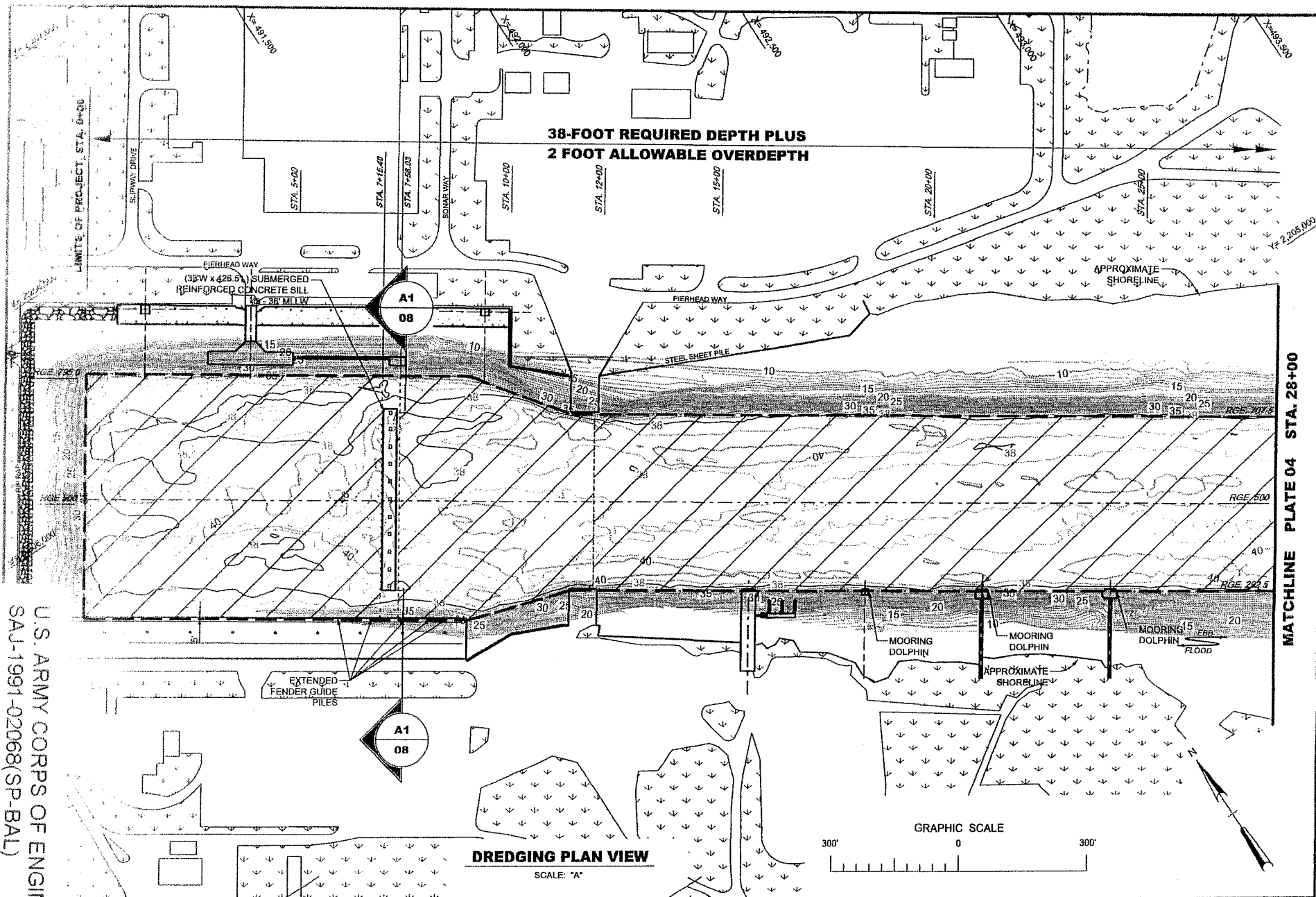

U.S. ARMY CORPS OF ENGINEERS
 SAJ-1991-02068(SP-BAL)
 U.S. Marine Corps - Blount Island
 PAGE 4 OF 8 5 May 2014

 U.S. ARMY CORPS OF ENGINEERS JACKSONVILLE DISTRICT, CORPS OF ENGINEERS JACKSONVILLE, FLORIDA	WQC PERMIT PLATE NOT FOR CONSTRUCTION	Dsn by: JWJ Dwn by: MR2 Ckd by: LRP Dated: APRIL 2014	DATE: 4/04/14 APPROVED: L.R.P. REVISION:	MARINE CORPS SUPPORT FACILITY BLOUNT ISLAND DUVAL COUNTY, FLORIDA MAINTENANCE DREDGING PROJECT WQC PERMIT PLATE SLIPWAY DREDGING PLAN (STA. 0+00 TO STA. 28+00)	PLATE 04 OF 8

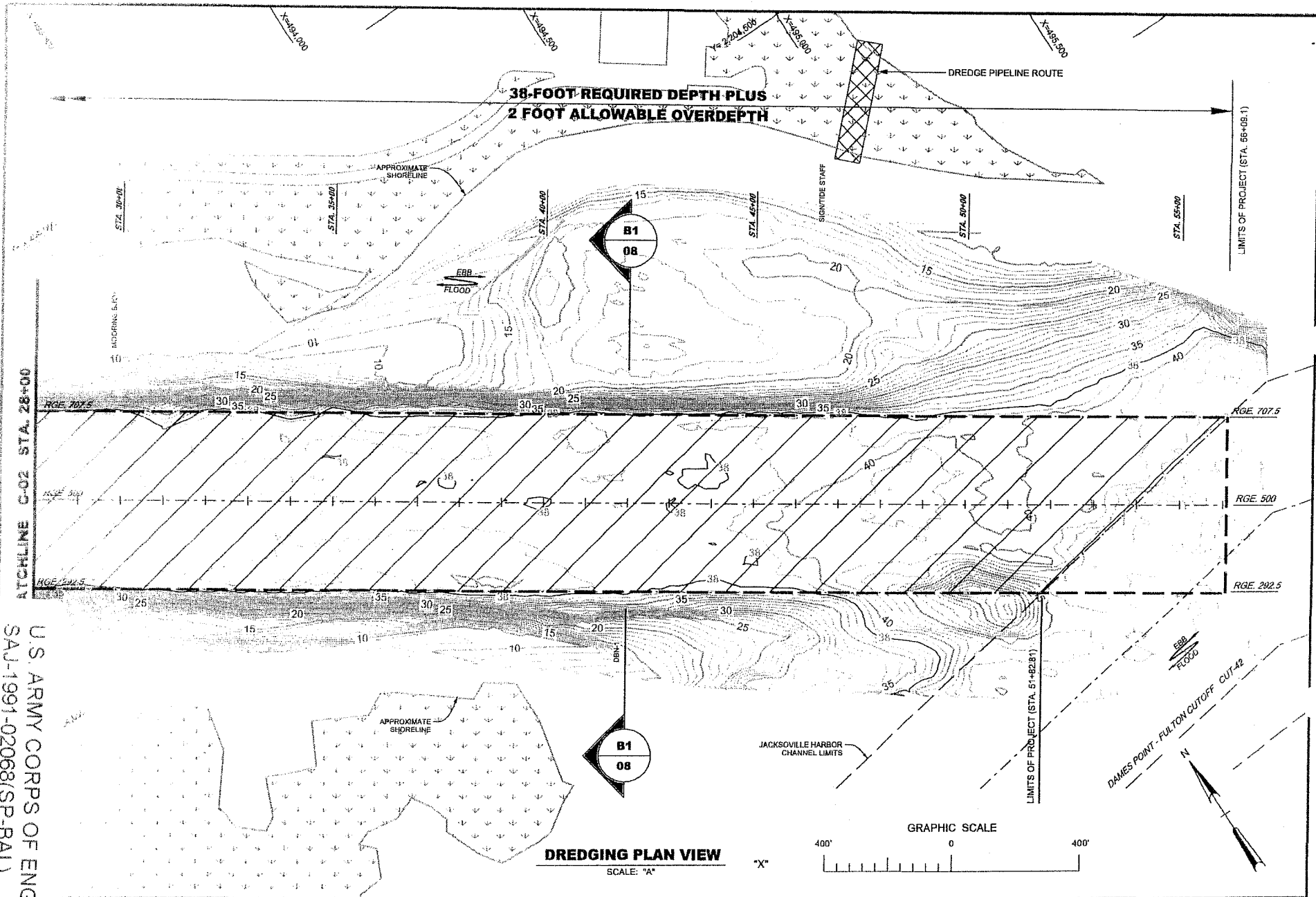

DREDGING PLAN VIEW
SCALE: "A"

U.S. ARMY CORPS OF ENGINEERS
 SAJ-1991-02068(SP-BAL)
 U.S. Marine Corps - Blount Island
 PAGE 5 OF 8 5 May 2014

 U.S. Army Corps of Engineers Jacksonville District, Corps of Engineers Jacksonville, Florida	WQC PERMIT PLATE NOT FOR CONSTRUCTION	Dsn by: JWJ Dwn by: MR2 Ckd by: LRP Dated: APRIL 2014	DATE: 4/04/14 APPROVED: L.R.P. REVISION:	MARINE CORPS SUPPORT FACILITY BLOUNT ISLAND DUVAL COUNTY, FLORIDA MAINTENANCE DREDGING PROJECT WQC PERMIT PLATE SLIPWAY DREDGING PLAN (STA.28+00 TO STA.56+09.1)	PLATE 05 OF 8
	DEPARTMENT OF THE ARMY JACKSONVILLE DISTRICT, CORPS OF ENGINEERS JACKSONVILLE, FLORIDA				

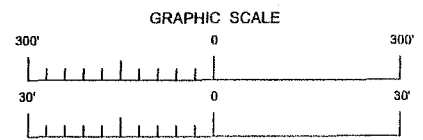
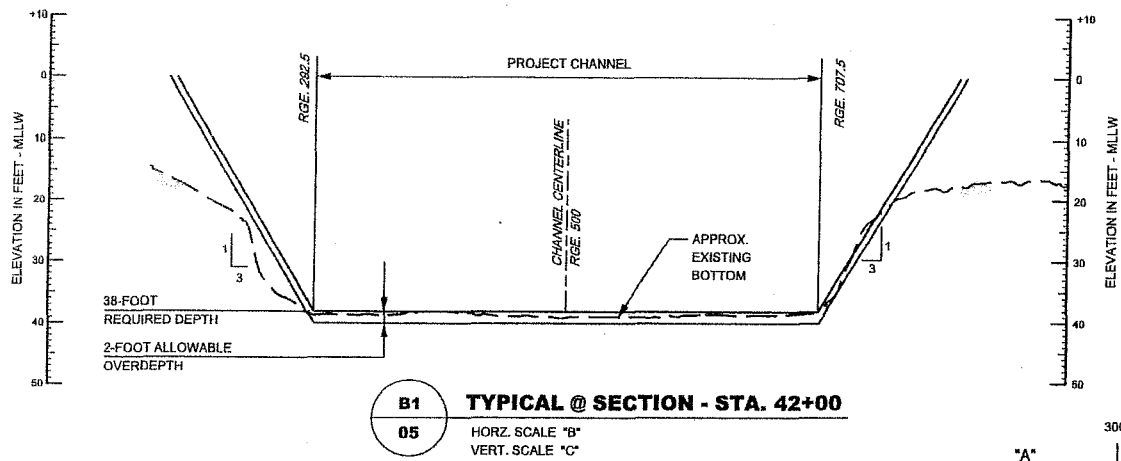
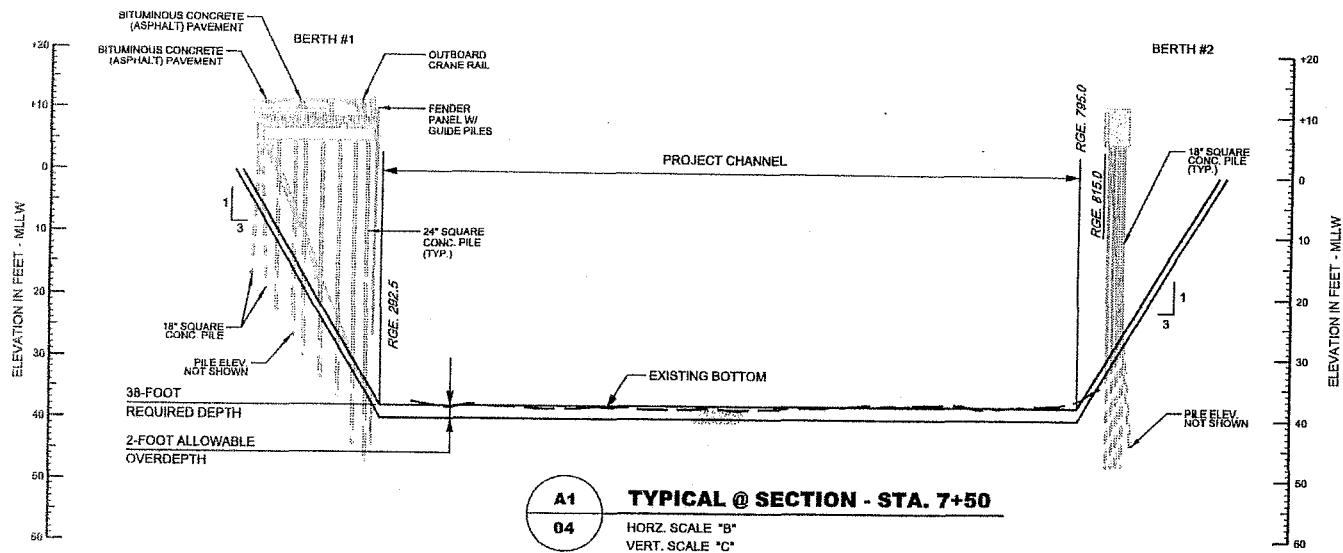

U.S. ARMY CORPS OF ENGINEERS
 SAJ-1991-02068(SP-BAL)
 US Marine Corps - Blount Island
 PAGE 6 OF 8 5 May 2014



US Army Corps of Engineers
 US Army Corps of Engineers
 US Army Corps of Engineers

WQC PERMIT PLATE
 NOT FOR CONSTRUCTION
 DEPARTMENT OF THE ARMY
 JACKSONVILLE DISTRICT, CORPS OF ENGINEERS
 JACKSONVILLE, FLORIDA

Dsn by:	DATE	APPROVED	REVISION
JWL	4/04/14	L.R.P.	
Dwn by:			
MR2			
Ckd by:			
LRP			
Dated:			
APRIL 2014			

MARINE CORPS SUPPORT FACILITY BLOUNT ISLAND
 DUVAL COUNTY, FLORIDA
 MAINTENANCE DREDGING PROJECT
 WQC PERMIT PLATE
 TYPICAL CHANNEL CROSS SECTIONS

PLATE
 06
 OF 8

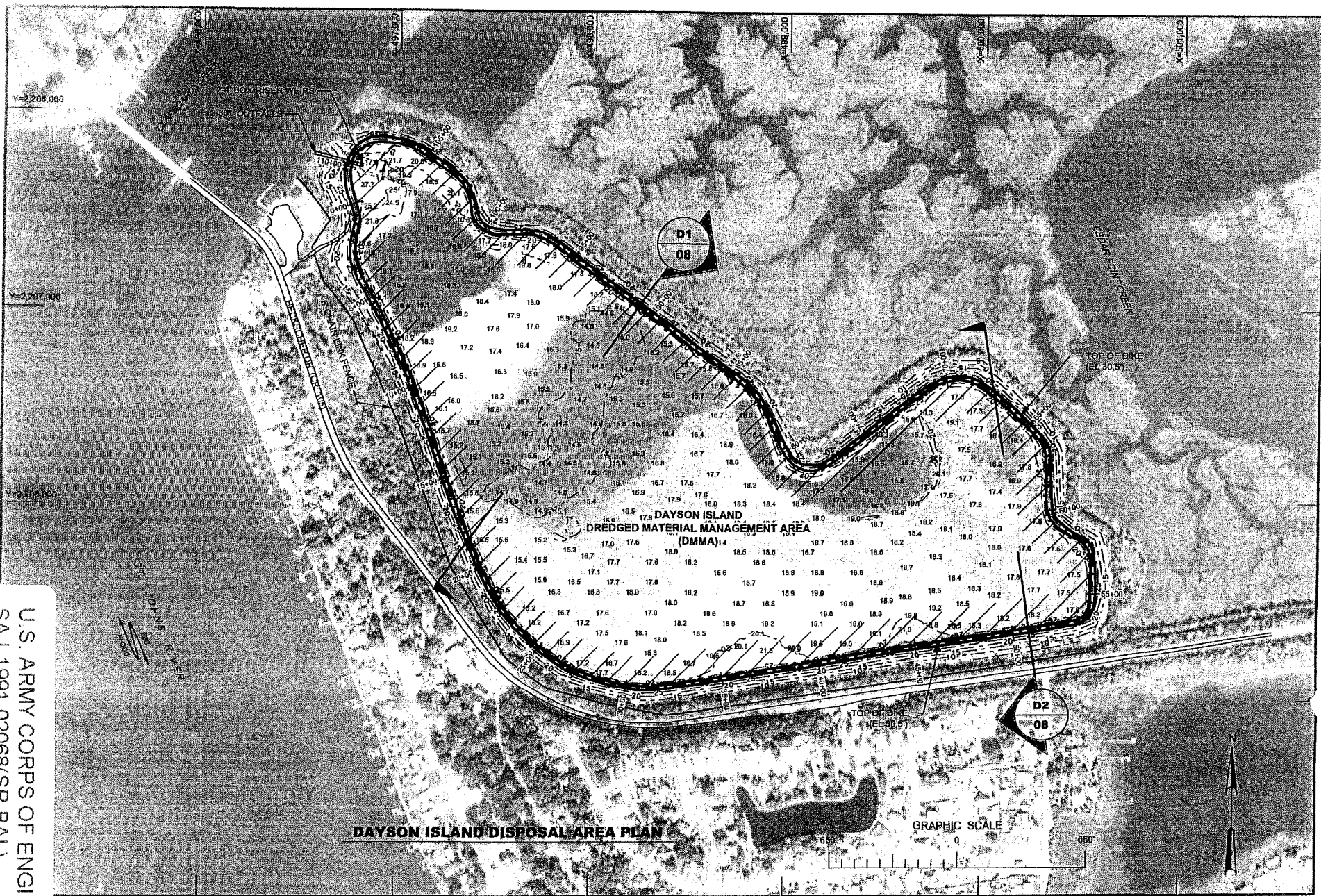

U.S. ARMY CORPS OF ENGINEERS
 SAJ-1991-02068(SP-BAL)
 US Marine Corps - Blount Island
 PAGE 7 OF 8 5 May 2014



WQC PERMIT PLATE
 NOT FOR CONSTRUCTION

DEPARTMENT OF THE ARMY
 JACKSONVILLE DISTRICT, CORPS OF ENGINEERS
 JACKSONVILLE, FLORIDA

Dsn by: JWL	DATE 4/04/14	APPROVED LRP.	REVISION
Dwn by: MR2			
Ckd by: LRP			
Dated: APRIL 2014			

**MARINE CORPS SUPPORT FACILITY BLOUNT ISLAND
 DUVAL COUNTY, FLORIDA
 MAINTENANCE DREDGING PROJECT
 WQC PERMIT PLATE
 EXISTING DAYSON ISLAND DMMA**

PLATE
07
 OF 8

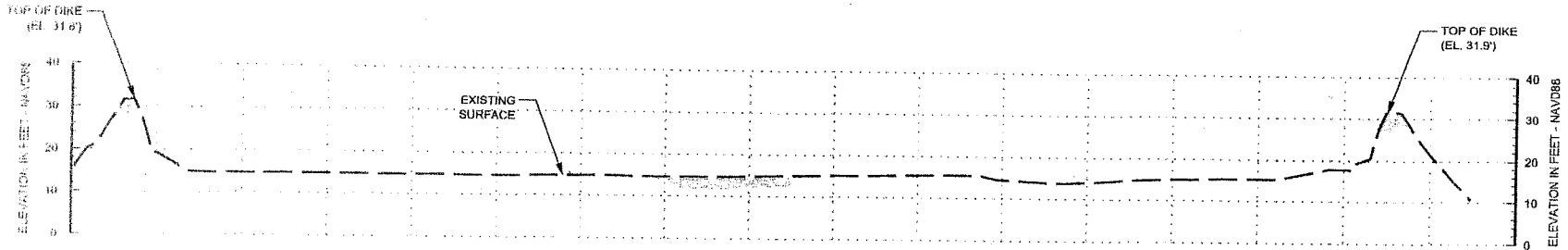

D1 **TYPICAL DMMA SECTION THRU DIKE**
06 HORIZ. SCALE "A"
 VERT. SCALE "B"

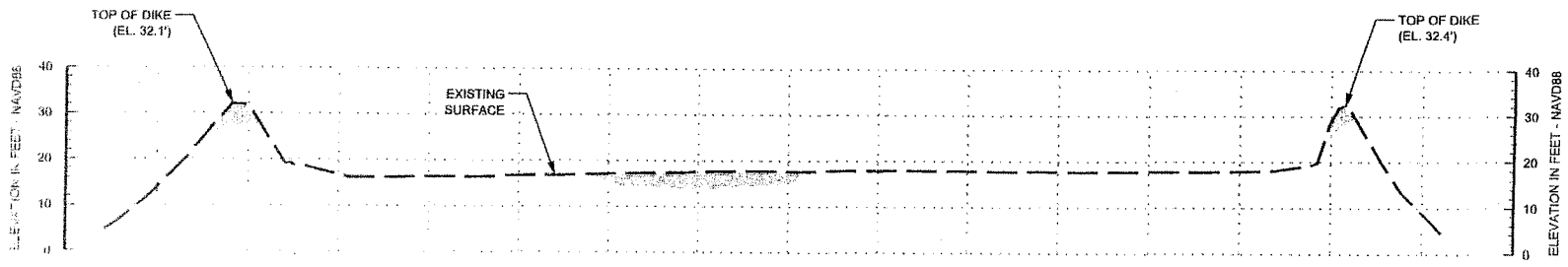

D2 **TYPICAL DMMA SECTION THRU DIKE**
06 HORIZ. SCALE "A"
 VERT. SCALE "B"

NOTES:
 1. ELEVATIONS ARE IN FEET AND TENTHS AND REFER TO THE NAVD88 DATUM AND ARE ABOVE REFERENCE DATUM UNLESS PRECEDED BY A (-) SIGN. THIS VERTICAL DATUM IS DIFFERENT THAN THE CHANNEL HYDRO SURVEY. REFER TO SPECIFIC SURVEY NOTES FOR DATUM REFERENCES.

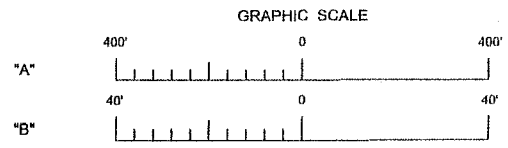

U.S. ARMY CORPS OF ENGINEERS
 SAJ-1991-02068(SP-BAL)
 US Marine Corps - Blount Island
 PAGE 8 OF 8 5 May 2014



WQC PERMIT PLATE
 NOT FOR CONSTRUCTION

DEPARTMENT OF THE ARMY
 JACKSONVILLE DISTRICT, CORPS OF ENGINEERS
 JACKSONVILLE, FLORIDA

Dsn by:	JWL	DATE	4/04/14	APPROVED	L.R.P.	REVISION
Dwn by:	MR2					
Ckd by:	LRP					
Dated:	APRIL 2014					

MARINE CORPS SUPPORT FACILITY BLOUNT ISLAND
DUVAL COUNTY, FLORIDA
MAINTENANCE DREDGING PROJECT
WQC PERMIT PLATE
TYPICAL DMMA CROSS SECTIONS

PLATE
08
 OF 8

403.813 Permits issued at district centers; exceptions.

- (3) A permit is not required under this chapter, chapter 373, chapter 61-691, Laws of Florida, or chapter 25214 or chapter 25270, 1949, Laws of Florida, for maintenance dredging conducted under this section by the seaports of Jacksonville, Port Canaveral, Fort Pierce, Palm Beach, Port Everglades, Miami, Port Manatee, St. Petersburg, Tampa, Port St. Joe, Panama City, Pensacola, Key West, and Fernandina or by inland navigation districts if the dredging to be performed is no more than is necessary to restore previously dredged areas to original design specifications or configurations, previously undisturbed natural areas are not significantly impacted, and the work conducted does not violate the protections for manatees under s. 379.2431(2)(d). In addition:
- (a) A mixing zone for turbidity is granted within a 150-meter radius from the point of dredging while dredging is ongoing, except that the mixing zone may not extend into areas supporting wetland communities, submerged aquatic vegetation, or hardbottom communities.
 - (b) The discharge of the return water from the site used for the disposal of dredged material shall be allowed only if such discharge does not result in a violation of water quality standards in the receiving waters. The return-water discharge into receiving waters shall be granted a mixing zone for turbidity within a 150-meter radius from the point of discharge into the receiving waters during and immediately after the dredging, except that the mixing zone may not extend into areas supporting wetland communities, submerged aquatic vegetation, or hardbottom communities. Ditches, pipes, and similar types of linear conveyances may not be considered receiving waters for the purposes of this paragraph.
 - (c) The state may not exact a charge for material that this subsection allows a public port or an inland navigation district to remove. In addition, consent to use any sovereignty submerged lands pursuant to this section is hereby granted.
 - (d) The use of flocculants at the site used for disposal of the dredged material is allowed if the use, including supporting documentation, is coordinated in advance with the department and the department has determined that the use is not harmful to water resources.
 - (e) The spoil material from maintenance dredging may be deposited in a self-contained, upland disposal site. The site is not required to be permitted if:
 - 1. The site exists as of January 1, 2011;
 - 2. A professional engineer certifies that the site has been designed in accordance with generally accepted engineering standards for such disposal sites;
 - 3. The site has adequate capacity to receive and retain the dredged material; and
 - 4. The site has operating and maintenance procedures established that allow for discharge of return flow of water and to prevent the escape of the spoil material into the waters of the state.
 - (f) The department must be notified at least 30 days before the commencement of maintenance dredging. The notice shall include, if applicable, the professional engineer certification required by paragraph (e).
 - (g) This subsection does not prohibit maintenance dredging of areas where the loss of original design function and constructed configuration has been caused by a storm event, provided that the dredging is performed as soon as practical after the storm event. Maintenance dredging that commences within 3 years after the storm event shall be presumed to satisfy this provision. If more than 3 years are needed to commence the maintenance dredging after the storm event, a request for a specific time extension to perform the maintenance dredging shall be submitted to

STANDARD MANATEE CONDITIONS FOR IN-WATER WORK
2011

The permittee shall comply with the following conditions intended to protect manatees from direct project effects:

- a. All personnel associated with the project shall be instructed about the presence of manatees and manatee speed zones, and the need to avoid collisions with and injury to manatees. The permittee shall advise all construction personnel that there are civil and criminal penalties for harming, harassing, or killing manatees which are protected under the Marine Mammal Protection Act, the Endangered Species Act, and the Florida Manatee Sanctuary Act.
- b. All vessels associated with the construction project shall operate at "Idle Speed/No Wake" at all times while in the immediate area and while in water where the draft of the vessel provides less than a four-foot clearance from the bottom. All vessels will follow routes of deep water whenever possible.
- c. Siltation or turbidity barriers shall be made of material in which manatees cannot become entangled, shall be properly secured, and shall be regularly monitored to avoid manatee entanglement or entrapment. Barriers must not impede manatee movement.
- d. All on-site project personnel are responsible for observing water-related activities for the presence of manatee(s). All in-water operations, including vessels, must be shutdown if a manatee(s) comes within 50 feet of the operation. Activities will not resume until the manatee(s) has moved beyond the 50-foot radius of the project operation, or until 30 minutes elapses if the manatee(s) has not reappeared within 50 feet of the operation. Animals must not be herded away or harassed into leaving.
- e. Any collision with or injury to a manatee shall be reported immediately to the Florida Fish and Wildlife Conservation Commission (FWC) Hotline at 1-888-404-3922. Collision and/or injury should also be reported to the U.S. Fish and Wildlife Service in Jacksonville (1-904-731-3336) for north Florida or in Vero Beach (1-772-562-3909) for south Florida, and emailed to FWC at ImperiledSpecies@myFWC.com.
- f. Temporary signs concerning manatees shall be posted prior to and during all in-water project activities. All signs are to be removed by the permittee upon completion of the project. Temporary signs that have already been approved for this use by the FWC must be used. One sign which reads *Caution: Boaters* must be posted. A second sign measuring at least 8½" by 11" explaining the requirements for "Idle Speed/No Wake" and the shut down of in-water operations must be posted in a location prominently visible to all personnel engaged in water-related activities. These signs can be viewed at http://www.myfwc.com/WILDLIFEHABITATS/manatee_sign_vendors.htm. Questions concerning these signs can be forwarded to the email address listed above.

CAUTION: MANATEE HABITAT

All project vessels

IDLE SPEED / NO WAKE

When a manatee is within 50 feet of work
all in-water activities must

SHUT DOWN

Report any collision with or injury to a manatee

Wildlife Alert:

1-888-404-FWCC(3922)

call *FWC or #FWC



HOPPER DREDGE DEFLECTOR DEVICE CHECKLIST

Dept. of the Army Permit Number: SAJ- _____ - _____

Project Name: _____

Project Location: _____

Dredging Company Name (Contractor): _____

Vessel Name: _____

1. _____ Dredging contractor has received a copy of and read the Dept. of the Army Permit for this project.
2. _____ Permittee and dredging contractor has reviewed the applicable Biological Opinion located at: <http://el.erdc.usace.army.mil/seaturtles/refs-bo.cfm>
3. _____ Dredging depth(s) for the project:
Starting Depth(s): _____
Final Depth(s): _____
4. _____ Turtle Deflector Device Submittal. Attach a detailed drawing showing structural design and soundness (see attached example drawing) of the Sea Turtle Deflector Device.
The drawing shall include the following information:
 - a. _____ Deflector leading edge angle (90 degrees or less).
 - b. _____ Forward vertical face measurement of the deflector (minimum height of 15").
 - c. _____ The approach angle(s) for this project dredging depths.
 - d. _____ The opening between deflector and draghead (maximum of 4"x4").
 - e. _____ The aft rigid deflector attachment to the draghead (hinged or trunnion).
 - f. _____ The forward deflector attachment link length described for the project dredging depths and project approach angles.

COMMENTS: _____

(Permittee Signature)

(Date)

(Name and Title - Printed)

(Dredging Contractor Signature)

(Date)

(Name and Title - Printed)

Hopper dredging shall not commence until this submittal is approved and signed by the Corps:

(District Engineer)

(Date)

HOPPER DREDGE PRE-DREDGE INSPECTION CHECKLIST

Dept. of the Army Permit No.: SAJ-_____ - _____

Project Name: _____

Project Location: _____

Dredging Company Name (Contractor): _____

Vessel Name: _____

Inspector's Name and Title: _____

Date of Inspection: _____

Dredging contractor pre-dredge inspection requirements:

1. _____ Has the dredging contractor read the Department of the Army Permit to determine the permit requirements for the protection of endangered sea turtles?
2. _____ Is a copy of the Department of the Army permit on board the vessel?
3. _____ Has the dredging contractor reviewed the applicable Biological Opinion located at: <http://el.erdc.usace.army.mil/seaturtles/refs-bo.cfm>
4. _____ Has the Turtle Deflector Device been approved by the Corps? (Dredging shall not start until the Turtle Deflector Device is approved and the Initial Hopper Dredge Submittal form has been signed by the Corps).
5. _____ Is a copy of the approved Turtle Deflector Device submittal on board the vessel?
6. _____ Is the approved Turtle Deflector Device submittal being used to perform this pre-dredge inspection?
7. _____ Is the Turtle Deflector Device that is on the dredge the same as the approved submitted Turtle Deflector Device?
8. _____ Is the Turtle Deflector Device structurally sound?
9. _____ Is the leading edge angle of the Turtle Deflector Device 90 degrees or less.
10. _____ Is the forward vertical face of the Turtle Deflector Device a minimum of 15" tall?
11. _____ Are the approach angles submitted for this project dredging depths.
12. _____ Are the opening between Turtle Deflector Device and draghead no more than 4"X4"?
13. _____ Is the aft deflector attachment to the draghead rigid (hinged or trunnion)?
14. _____ Is the forward deflector attachment link length measurement the same length as shown on the approved Turtle Deflector Device submittal for this project dredging depth and project approach angle?

- 15. _____ Are inflow screens and overflow screens installed?
- 16. _____ Are inflow basket screen openings no more than 4"X4"?
- 17. _____ Is there adequate lighting of inflow and overflow screens and proper access for cleaning.
- 18. _____ Is turtle trawling required by the DA permit?
- 19. _____ Is the dredging data recording system (DQM/Silent Inspector) operational and the certification current?

COMMENTS: _____

I certify that the above components are properly installed and operational in accordance with the SARBO and the DA permit for the referenced project.

(Dredging Contractor Signature)

(Date)

HOPPER DREDGE STARTUP INSPECTION CHECKLIST

Dept. of the Army Permit Number: SAJ- _____ - _____

Project Name: _____

Project Location: _____

Dredging Company Name (Contractor): _____

Vessel Name: _____

Inspector's Name and Title: _____

Date of Inspection: _____

Dredging contractor startup dredge inspection requirements:

1. _____ Is the Turtle Deflector Device submittal approved?
2. _____ Is the approved Turtle Deflector Device submittal being used to perform this startup-dredge inspection?
3. _____ Are the turtle observers onboard the vessel during dredging operations?
4. _____ Is dredging data recording system (DQM/Silent Inspector) turned on and recording draghead elevation, slurry density & velocity and is data being submitted?
5. _____ Was a paint test performed to assure the deflector is plowing at least 6" into the dredge material while the dragtender is consistently maintaining the submitted and approved approach angle to a tolerance of + 0 to - 4 degrees.

DATE: _____, TIME: _____

6. _____ Is the drag tender operating the dredge pump in accordance with the Hopper Dredging Terms and Conditions as follows:
 - a. _____ Starting the dredge pump only when the draghead is firmly on the bottom by watching the slurry specific gravity & swell compensator.
 - b. _____ Reducing the slurry velocity to less than 5 feet per second by reducing the dredge pump RPM to idle speed before raising the draghead off the bottom. Raising the draghead off the bottom to increase suction velocities is strictly prohibited.
 - c. _____ Consistently maintaining the approach angle to a tolerance of + 0 to - 4 degrees whenever the draghead is on the bottom and the dredge pump is operating

- d. _____ Watch the dragtender through one cycle minimum to see if the draghead is being raised off the bottom because:
- i. _____ Plugging of the draghead.
 - ii. _____ Ship crabbing.
 - iii. _____ Draghead tracking under or away from the dredge.

COMMENTS: _____

(Dredging Contractor Signature)

(Date)