

DESIGN AUTHENTICATION

PROJECT: Shore Protection Project, Nassau County, Florida

ATTACHED PLAN SHEETS: 22 Plates

The attached plan was prepared by the Jacksonville District, U.S. Army Corps of Engineers (USACE). The initials or signatures and registrations designations of the signatory below or that appear on these project documents are within the scope of employment as required by USACE Engineering Regulation 1110-1-8152, PROFESSIONAL REGISTRATION, 8 Aug 1995, and are not made in the individual capacity of the signatories.

USACE employee signatures are provided in support of the "Interagency Coordination Agreement for Civil Works Projects", signed 28 Feb 2006 by the Florida Department of Environmental Protection, the USACE Jacksonville District, and USACE Mobile District.

These plans are for permitting purposes only, and are not for construction.



David Dudley P.E.
Chief, Design Branch (CH EN-D)
Engineering Division

02 OCT '14
DATE

22 plates dated Mar. 2014.

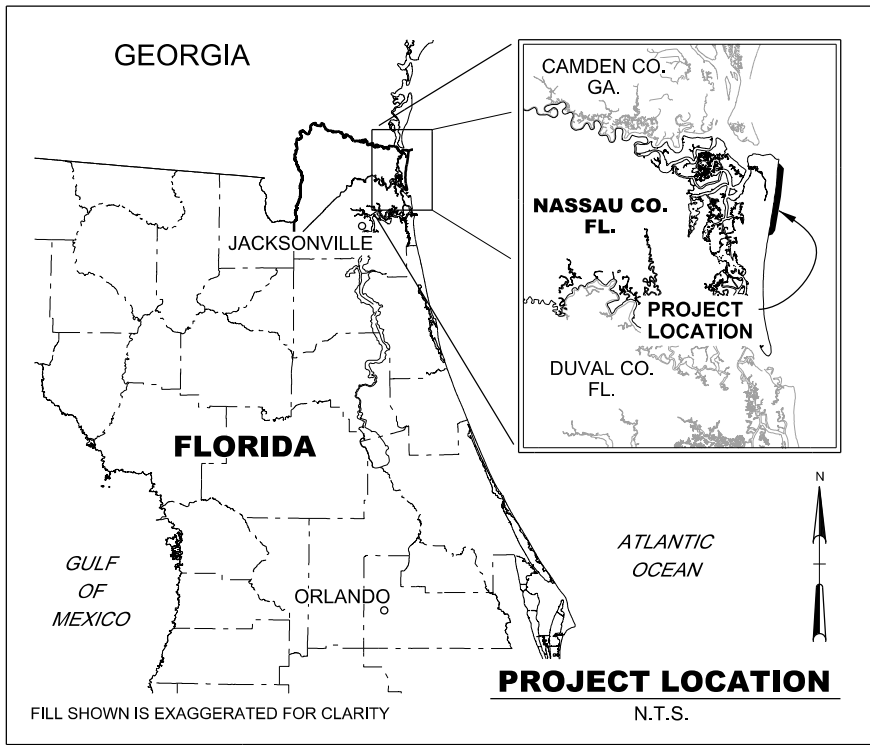

INDEX TO DRAWINGS

PLATE	TITLE
01	PROJECT LOCATION, PLATE INDEX, ABBREVIATIONS, AND LEGEND
02	PROJECT VICINITY
03	FORT CLINCH STATE PARK ACCESS AREA
04 - 10	BEACH FILL - PLANE VIEW
11 - 18	BEACH FILL - PROFILE VIEW
19	BORROW AREA
20 - 22	BORROW AREA SECTIONS

ABBREVIATIONS

B/N	=	BETWEEN
CBL	=	CONSTRUCTION BASELINE
EL.	=	ELEVATION
ECL.	=	EROSION CONTROL LINE
FDEP.	=	FLORIDA DEPARTMENT OF ENV. PROTECTION
FDOT.	=	FLORIDA DEPARTMENT OF TRANSPORTATION
FT.	=	FOOT/FEET
MHW.	=	MEAN HIGH WATER
MLW.	=	MEAN LOW WATER
NAD.	=	NORTH AMERICAN DATUM
NAVD88.	=	NORTH ATLANTIC VERTICAL DATUM OF 1988.
NTS.	=	NOT TO SCALE
TYP.	=	TYPICAL
W.	=	WITH

GENERAL NOTES:

1. THE PLANE COORDINATES SHOWN ARE BASED ON THE FLORIDA STATE PLANE EAST COORDINATE SYSTEM (0901) AND REFERENCED TO THE 1990 ADJUSTMENT OF THE NAD OF 1983 (NAD83(90)).
2. ELEVATIONS SHOWN ON ALL PLATES ARE IN FEET AND ARE BASED ON NAVD88. ELEVATIONS ARE BELOW THE DATUM UNLESS PRECEDED BY A (+) SIGN.
3. FDOT SURVEY AND MAPPING OFFICE PROVIDED THE 2011 AERIAL PHOTOGRAPHY SHOWN ON THESE PLATES.
4. THE PROJECT WILL USE THE CONSTRUCTION BASELINE (CBL) SHOWN ON THESE PLATES.
5. THE REQUIRED BERM HEIGHT FOR THE PROJECT WILL BE 9.6' REFERENCING NAVD88.
6. TIDAL RELATIONSHIPS SHOWN IN THE PROFILES IS BASED ON NOAA TIDE GAUGE AT FERNANDINA (#872 0030). REFER TO PLATE 02 FOR OTHER TIDAL RELATIONSHIPS.
7. REFER TO PLATE 03 FOR BEACH SURVEY NOTES AND FOR BORROW AREA SURVEY NOTES REFER TO PLATE 19.

LEGEND

	BEACH FILL AREA (PLAN VIEW)
	BEACH FILL AREA (PROFILE VIEW)
	STAGING AND ACCESS AREA
	EXISTING GROUND (PROFILE VIEW)
	DNR RANGE MONUMENT
	SLOPE INDICATOR SYMBOL W/ FILL
	CONSTRUCTION BASELINE W. STATIONING
	EROSION CONTROL LINE
	FORT CLINCH BOUNDARY LINE
	FDEP AZIMUTH BEARING
	MEAN HIGH WATER LINE
	FORT CLINCH AQUATIC PRESERVE



NOT FOR CONSTRUCTION PERMIT DRAWINGS

DEPARTMENT OF THE ARMY
JACKSONVILLE DISTRICT, CORPS OF ENGINEERS
JACKSONVILLE, FLORIDA

SHORE PROTECTION PROJECT
NASSAU COUNTY, FLORIDA

**NASSAU SHORE PROTECTION PROJECT
PROJECT LOCATION, PLATE INDEX,
ABBREVIATIONS AND LEGEND**

DATE	APPROVED	REVISION	DATE:
2/18/14	L.R.P.		MAR. 2014
8/28/14	L.R.P.	M.P.N.	DWN BY: J.W.L.
			PLATE: 01 OF 22

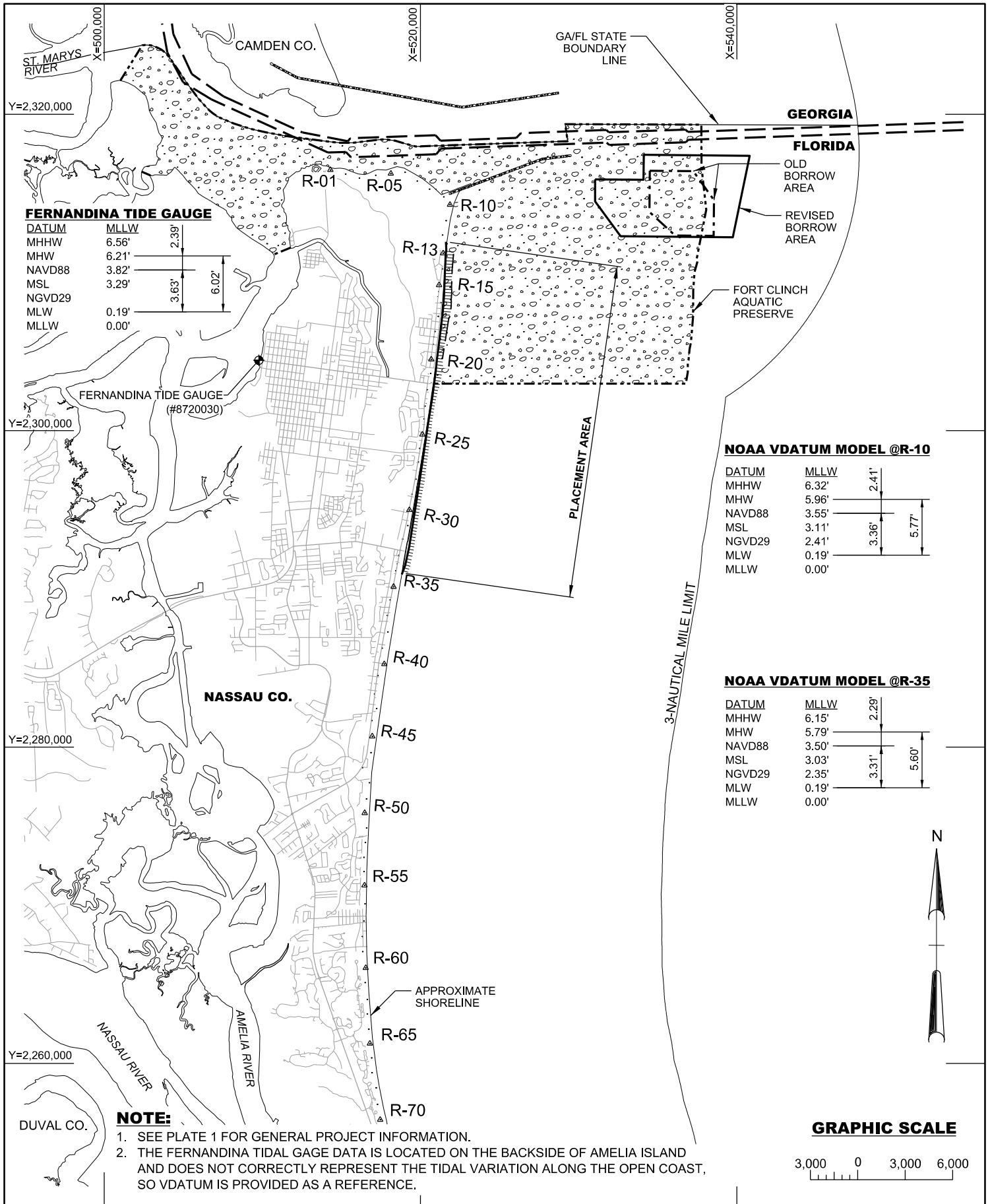

FERNANDINA TIDE GAUGE

DATUM	MLLW
MHHW	6.56'
MHW	6.21'
NAVD88	3.82'
MSL	3.29'
NGVD29	
MLW	0.19'
MLLW	0.00'

Vertical dimensions: 2.39' (between MHHW and MHW), 3.63' (between MHW and MSL), 6.02' (between MSL and MLLW).

NOAA VDATUM MODEL @R-10

DATUM	MLLW
MHHW	6.32'
MHW	5.96'
NAVD88	3.55'
MSL	3.11'
NGVD29	2.41'
MLW	0.19'
MLLW	0.00'

Vertical dimensions: 2.41' (between MHW and MSL), 3.36' (between MSL and MLLW), 5.77' (between MHHW and MLLW).

NOAA VDATUM MODEL @R-35

DATUM	MLLW
MHHW	6.15'
MHW	5.79'
NAVD88	3.50'
MSL	3.03'
NGVD29	2.35'
MLW	0.19'
MLLW	0.00'

Vertical dimensions: 2.29' (between MHW and MSL), 3.31' (between MSL and MLLW), 5.60' (between MHHW and MLLW).

NOTE:

1. SEE PLATE 1 FOR GENERAL PROJECT INFORMATION.
2. THE FERNANDINA TIDAL GAGE DATA IS LOCATED ON THE BACKSIDE OF AMELIA ISLAND AND DOES NOT CORRECTLY REPRESENT THE TIDAL VARIATION ALONG THE OPEN COAST, SO VDATUM IS PROVIDED AS A REFERENCE.



**NOT FOR CONSTRUCTION
PERMIT DRAWINGS**

DEPARTMENT OF THE ARMY
JACKSONVILLE DISTRICT, CORPS OF ENGINEERS
JACKSONVILLE, FLORIDA

SHORE PROTECTION PROJECT
NASSAU COUNTY, FLORIDA

**NASSAU SHORE PROTECTION PROJECT
PROJECT VICINITY**

DATE	APPROVED	REVISION	DATE:
2/18/14	L.R.P.		MAR. 2014
8/28/14	L.R.P.	M.P.N.	DWN BY: J.W.L.
			PLATE: 02 OF 22

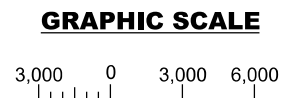

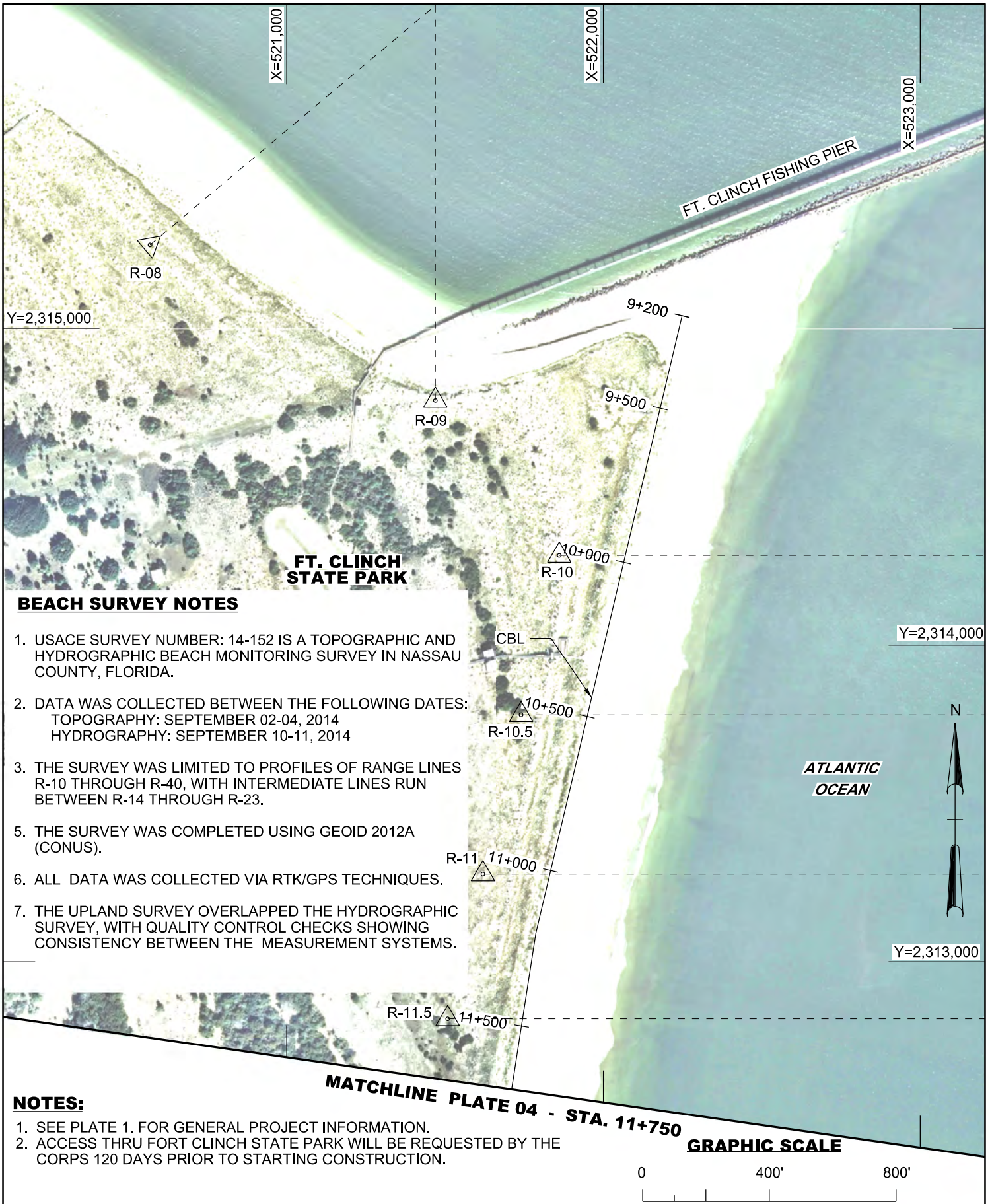

BEACH SURVEY NOTES

1. USACE SURVEY NUMBER: 14-152 IS A TOPOGRAPHIC AND HYDROGRAPHIC BEACH MONITORING SURVEY IN NASSAU COUNTY, FLORIDA.
2. DATA WAS COLLECTED BETWEEN THE FOLLOWING DATES:
 TOPOGRAPHY: SEPTEMBER 02-04, 2014
 HYDROGRAPHY: SEPTEMBER 10-11, 2014
3. THE SURVEY WAS LIMITED TO PROFILES OF RANGE LINES R-10 THROUGH R-40, WITH INTERMEDIATE LINES RUN BETWEEN R-14 THROUGH R-23.
5. THE SURVEY WAS COMPLETED USING GEOID 2012A (CONUS).
6. ALL DATA WAS COLLECTED VIA RTK/GPS TECHNIQUES.
7. THE UPLAND SURVEY OVERLAPPED THE HYDROGRAPHIC SURVEY, WITH QUALITY CONTROL CHECKS SHOWING CONSISTENCY BETWEEN THE MEASUREMENT SYSTEMS.

NOTES:

1. SEE PLATE 1. FOR GENERAL PROJECT INFORMATION.
2. ACCESS THRU FORT CLINCH STATE PARK WILL BE REQUESTED BY THE CORPS 120 DAYS PRIOR TO STARTING CONSTRUCTION.

MATCHLINE PLATE 04 - STA. 11+750

GRAPHIC SCALE



US Army Corps of Engineers
Jacksonville District

**NOT FOR CONSTRUCTION
PERMIT DRAWINGS**

DEPARTMENT OF THE ARMY
JACKSONVILLE DISTRICT, CORPS OF ENGINEERS
JACKSONVILLE, FLORIDA

SHORE PROTECTION PROJECT
NASSAU COUNTY, FLORIDA

**NASSAU SHORE PROTECTION PROJECT
FORT CLINCH STATE PARK ACCESS AREA**

DATE	APPROVED	REVISION	DATE:
2/18/14	L.R.P.		MAR. 2014
8/28/14	L.R.P.	M.P.N.	DWN BY: J.W.L.
			PLATE: 03 OF 22

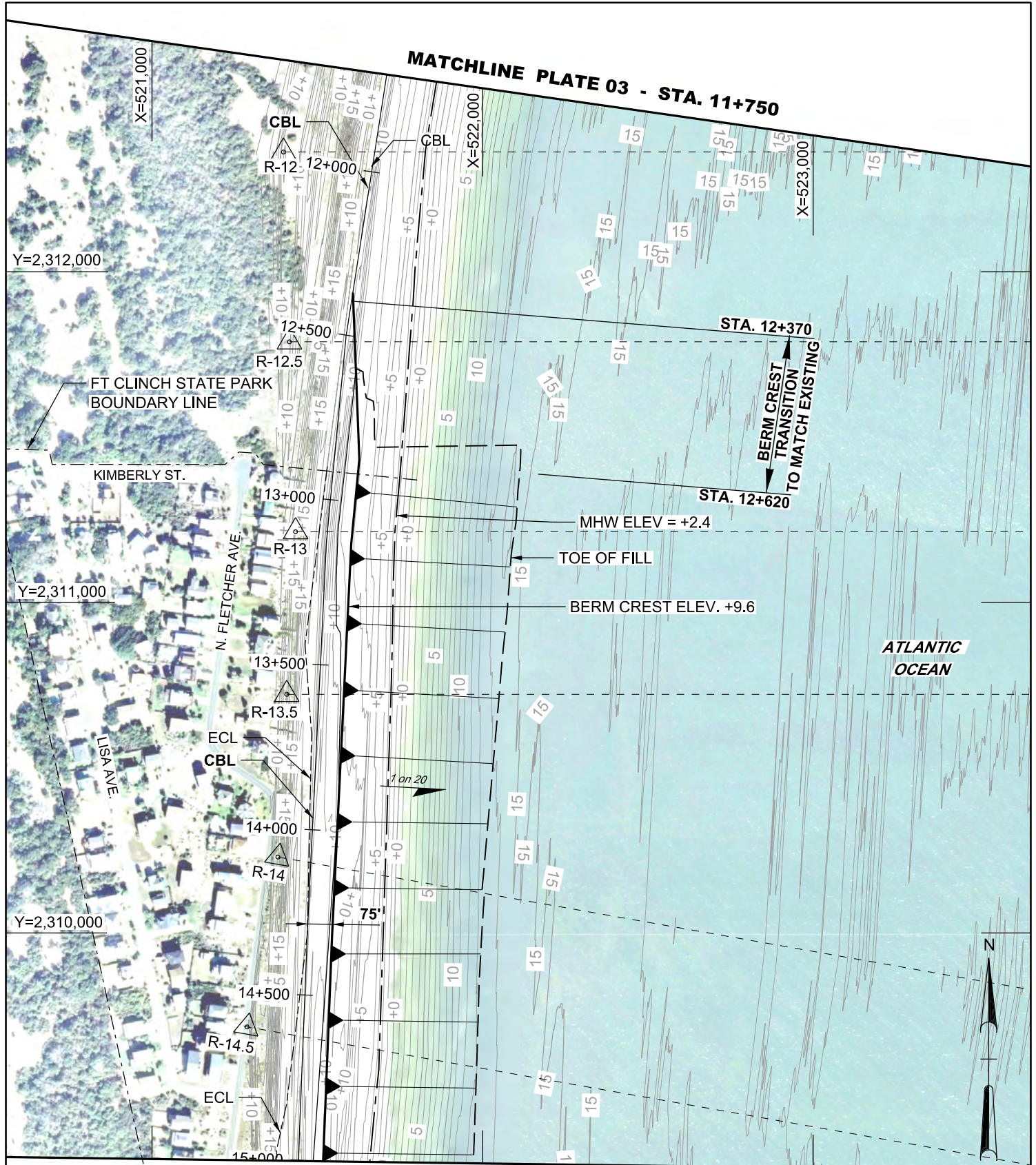

NOTES:

1. SEE PLATE 1. FOR GENERAL PROJECT INFORMATION
2. BERM CREST WIDTH IS MEASURED 75' SEAWARD FROM THE CBL.

MATCHLINE PLATE 05 - STA. 15+000

GRAPHIC SCALE

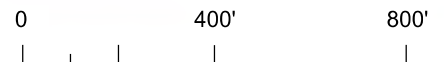

US Army Corps of Engineers
Jacksonville District

NOT FOR CONSTRUCTION PERMIT DRAWINGS

DEPARTMENT OF THE ARMY
JACKSONVILLE DISTRICT, CORPS OF ENGINEERS
JACKSONVILLE, FLORIDA

SHORE PROTECTION PROJECT
NASSAU COUNTY, FLORIDA

NASSAU SHORE PROTECTION PROJECT
BEACH FILL - PLAN VIEW

DATE	APPROVED	REVISION	DATE:
2/18/14	L.R.P.		MAR. 2014
8/28/14	L.R.P.	M.P.N.	DWN BY: J.W.L.
			PLATE: 04 OF 22

MATCHLINE PLATE 04 - STA. 15+000

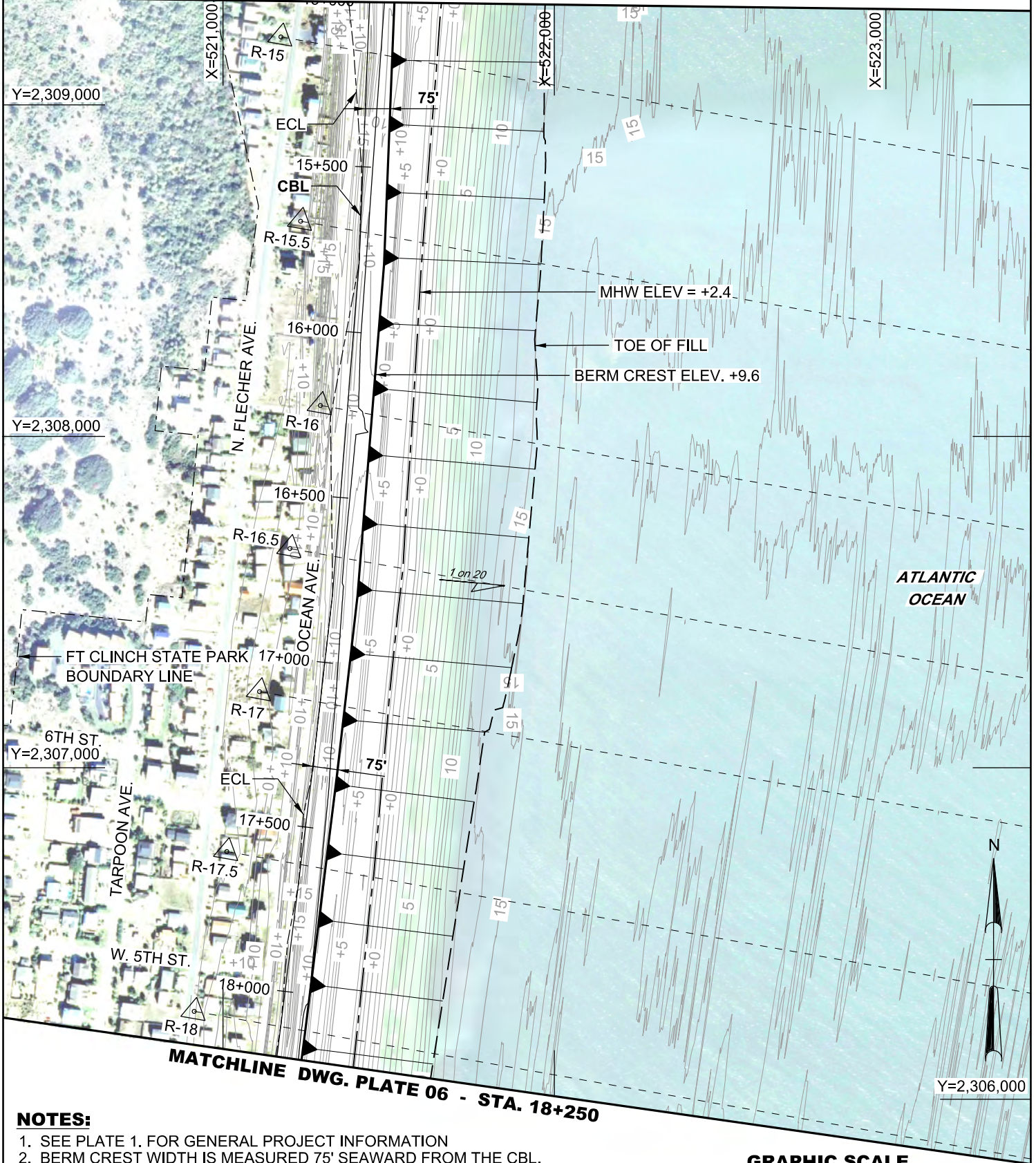

NOTES:

1. SEE PLATE 1. FOR GENERAL PROJECT INFORMATION
2. BERM CREST WIDTH IS MEASURED 75' SEAWARD FROM THE CBL.

GRAPHIC SCALE



**NOT FOR CONSTRUCTION
PERMIT DRAWINGS**

DEPARTMENT OF THE ARMY
JACKSONVILLE DISTRICT, CORPS OF ENGINEERS
JACKSONVILLE, FLORIDA

SHORE PROTECTION PROJECT
NASSAU COUNTY, FLORIDA

NASSAU SHORE PROTECTION PROJECT
BEACH FILL - PLAN VIEW

DATE	APPROVED	REVISION	DATE:
2/18/14	L.R.P.		MAR. 2014
8/28/14	L.R.P.	M.P.N.	DWN BY: J.W.L.
			PLATE: 05 OF 22

MATCHLINE PLATE 05 - STA. 18+250

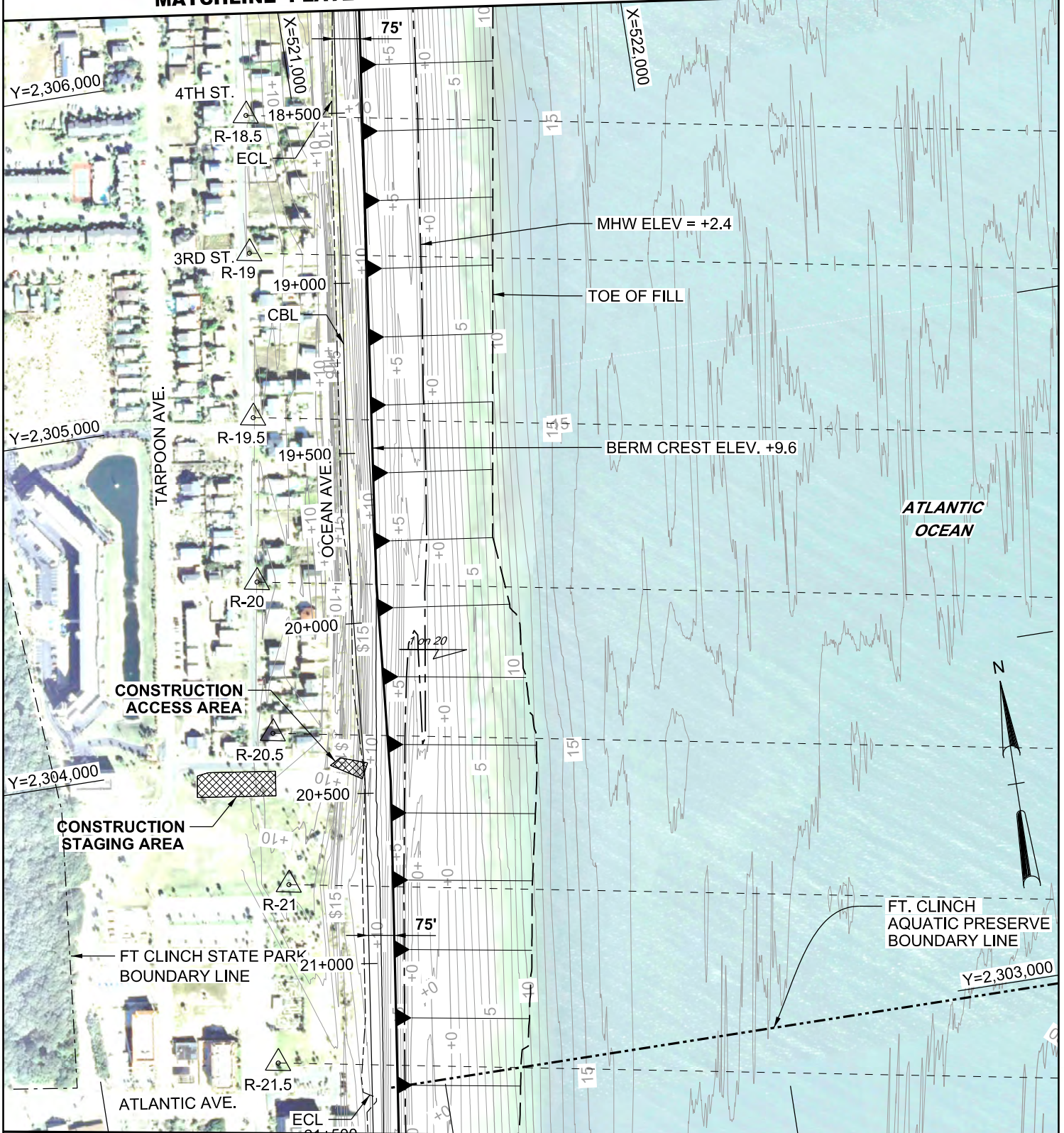

MATCHLINE PLATE 07 - STA. 21+500

NOTES:

1. SEE PLATE 1. FOR GENERAL PROJECT INFORMATION
2. BERM CREST WIDTH IS MEASURED 75' SEAWARD FROM THE CBL.

GRAPHIC SCALE

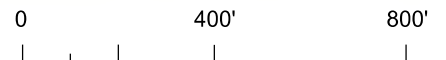

US Army Corps of Engineers
Jacksonville District

NOT FOR CONSTRUCTION PERMIT DRAWINGS

DEPARTMENT OF THE ARMY
JACKSONVILLE DISTRICT, CORPS OF ENGINEERS
JACKSONVILLE, FLORIDA

SHORE PROTECTION PROJECT
NASSAU COUNTY, FLORIDA

NASSAU SHORE PROTECTION PROJECT
BEACH FILL - PLAN VIEW

DATE	APPROVED	REVISION	DATE:
2/18/14	L.R.P.		MAR. 2014
8/28/14	L.R.P.	M.P.N.	DWN BY: J.W.L.
			PLATE: 06 of 22

MATCHLINE PLATE 06 - STA. 21+500

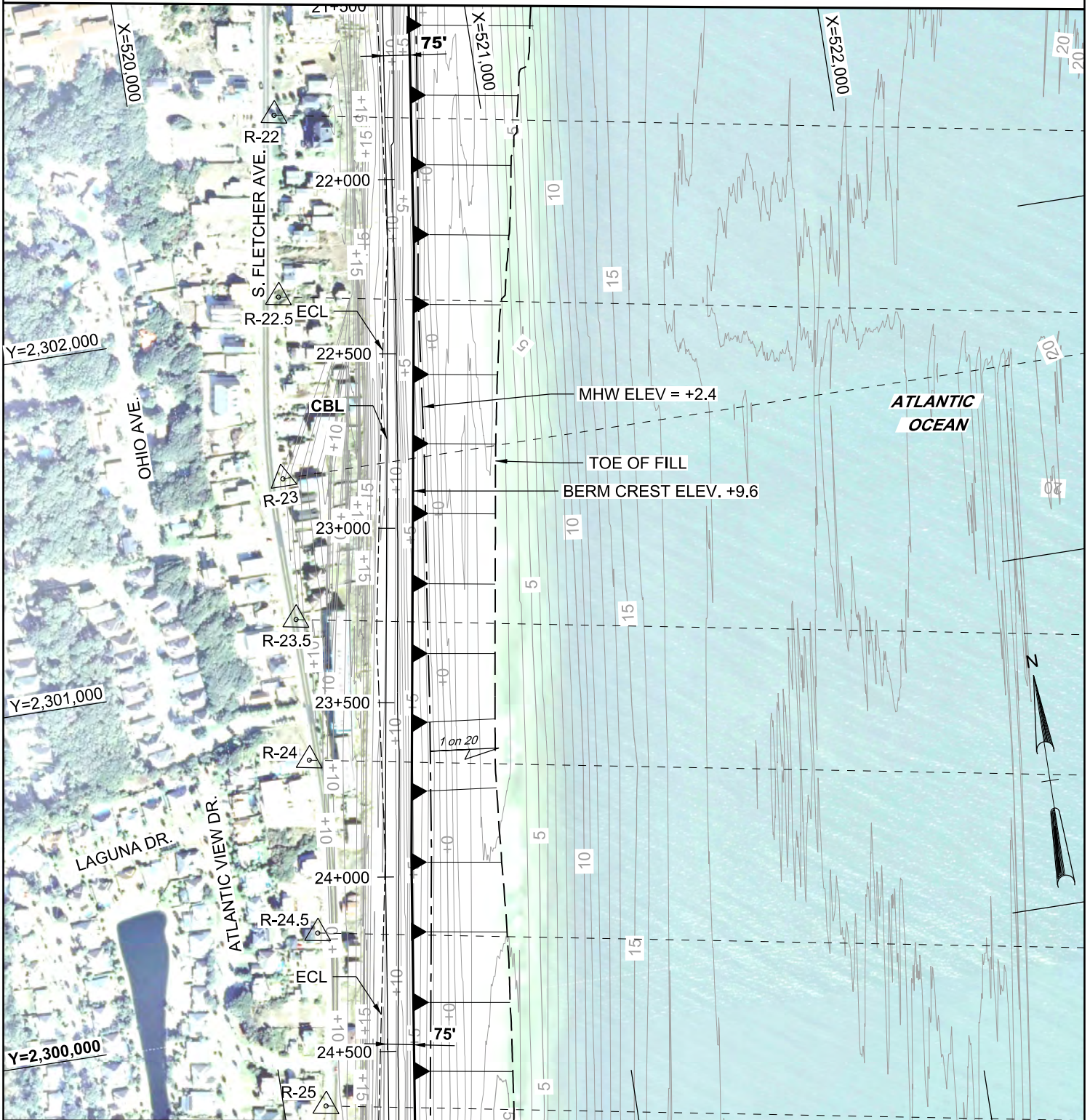

MATCHLINE PLATE 08 - STA. 24+750

NOTES:

1. SEE PLATE 1, FOR GENERAL PROJECT INFORMATION
2. BERM CREST WIDTH IS MEASURED 75' SEAWARD FROM THE CBL.

GRAPHIC SCALE

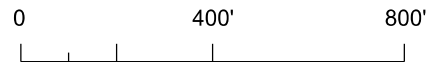

**NOT FOR CONSTRUCTION
PERMIT DRAWINGS**

DEPARTMENT OF THE ARMY
JACKSONVILLE DISTRICT, CORPS OF ENGINEERS
JACKSONVILLE, FLORIDA

SHORE PROTECTION PROJECT
NASSAU COUNTY, FLORIDA

NASSAU SHORE PROTECTION PROJECT
BEACH FILL - PLAN VIEW

DATE	APPROVED	REVISION	DATE:
2/18/14	L.R.P.		MAR. 2014
8/28/14	L.R.P.	M.P.N.	DWN BY: J.W.L.
			PLATE: 07 OF 22

US Army Corps
of Engineers
Jacksonville District

MATCHLINE PLATE 07 - STA. 24+750

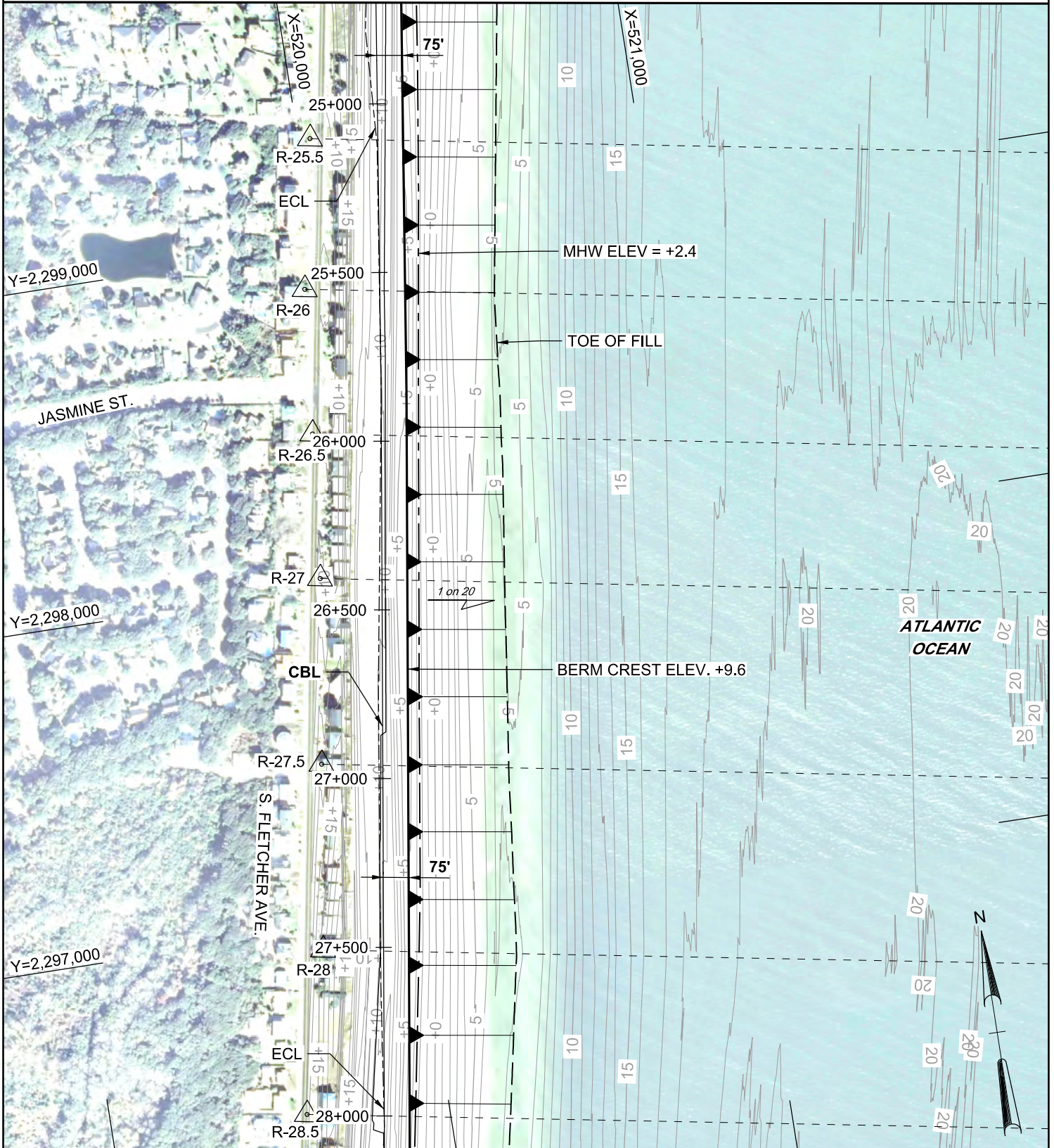

MATCHLINE PLATE 09 - STA. 28+100

GRAPHIC SCALE



NOTES:

1. SEE PLATE 1. FOR GENERAL PROJECT INFORMATION
2. BERM CREST WIDTH IS MEASURED 75' SEAWARD FROM THE CBL.



US Army Corps of Engineers
Jacksonville District

**NOT FOR CONSTRUCTION
PERMIT DRAWINGS**

DEPARTMENT OF THE ARMY
JACKSONVILLE DISTRICT, CORPS OF ENGINEERS
JACKSONVILLE, FLORIDA

SHORE PROTECTION PROJECT
NASSAU COUNTY, FLORIDA

**NASSAU SHORE PROTECTION PROJECT
BEACH FILL PLAN VIEW**

DATE	APPROVED	REVISION	DATE:
2/18/14	L.R.P.		MAR. 2014
8/28/14	L.R.P.	M.P.N.	DWN BY: J.W.L.
			PLATE: 08 of 22

MATCHLINE PLATE 08 - STA. 28+100

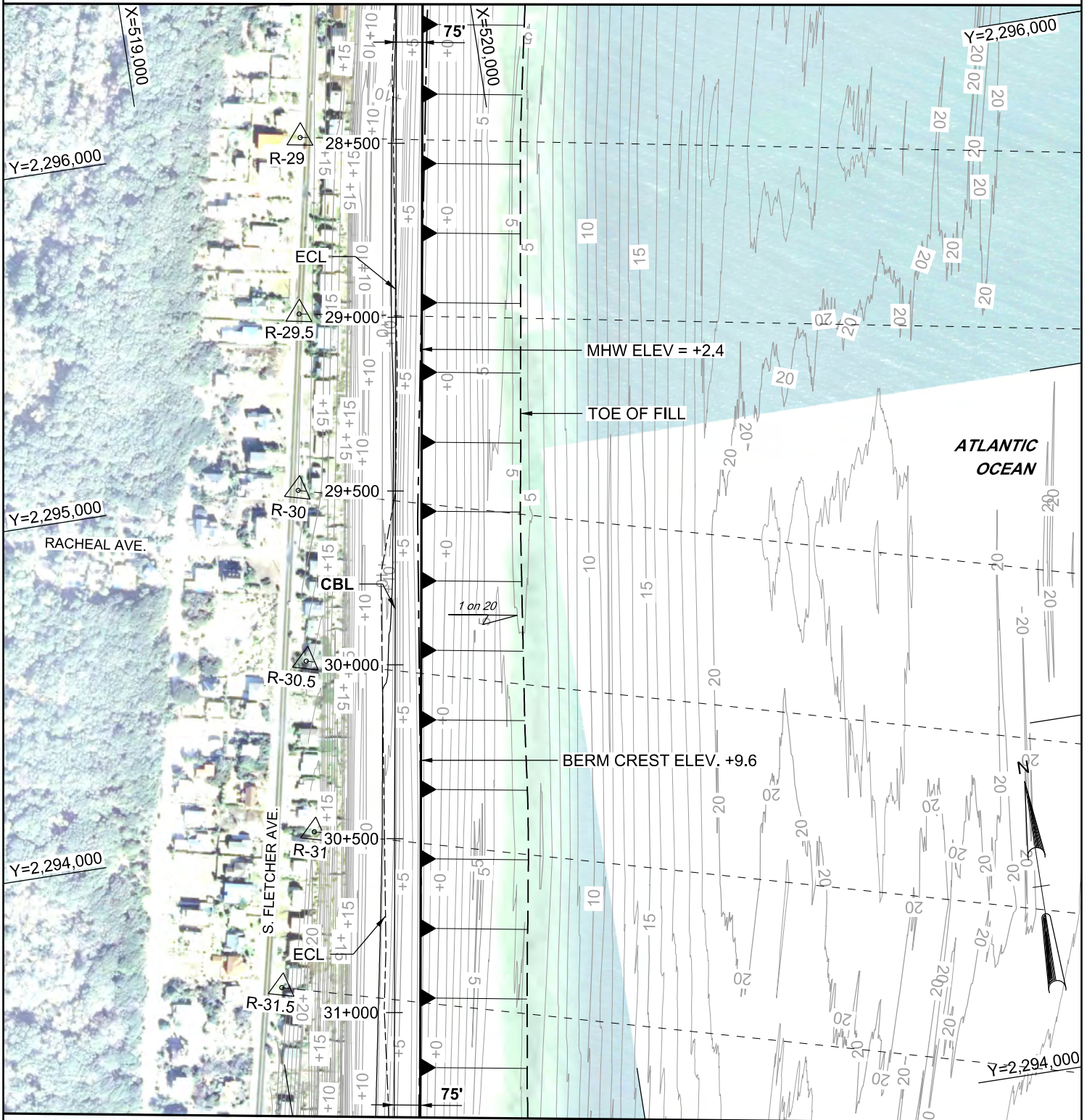

MATCHLINE PLATE 10 - STA. 31+300

NOTES:

1. SEE PLATE 1. FOR GENERAL PROJECT INFORMATION
2. BERM CREST WIDTH IS MEASURED 75' SEAWARD FROM THE CBL.

GRAPHIC SCALE



US Army Corps of Engineers
Jacksonville District

**NOT FOR CONSTRUCTION
PERMIT DRAWINGS**

DEPARTMENT OF THE ARMY
JACKSONVILLE DISTRICT, CORPS OF ENGINEERS
JACKSONVILLE, FLORIDA

SHORE PROTECTION PROJECT
NASSAU COUNTY, FLORIDA

NASSAU SHORE PROTECTION PROJECT
BEACH FILL PLAN VIEW

DATE	APPROVED	REVISION	DATE:
2/18/14	L.R.P.		MAR. 2014
8/28/14	L.R.P.	M.P.N.	DWN BY: J.W.L.
			PLATE: 09 OF 22

MATCHLINE PLATE 09 - STA. 31+300

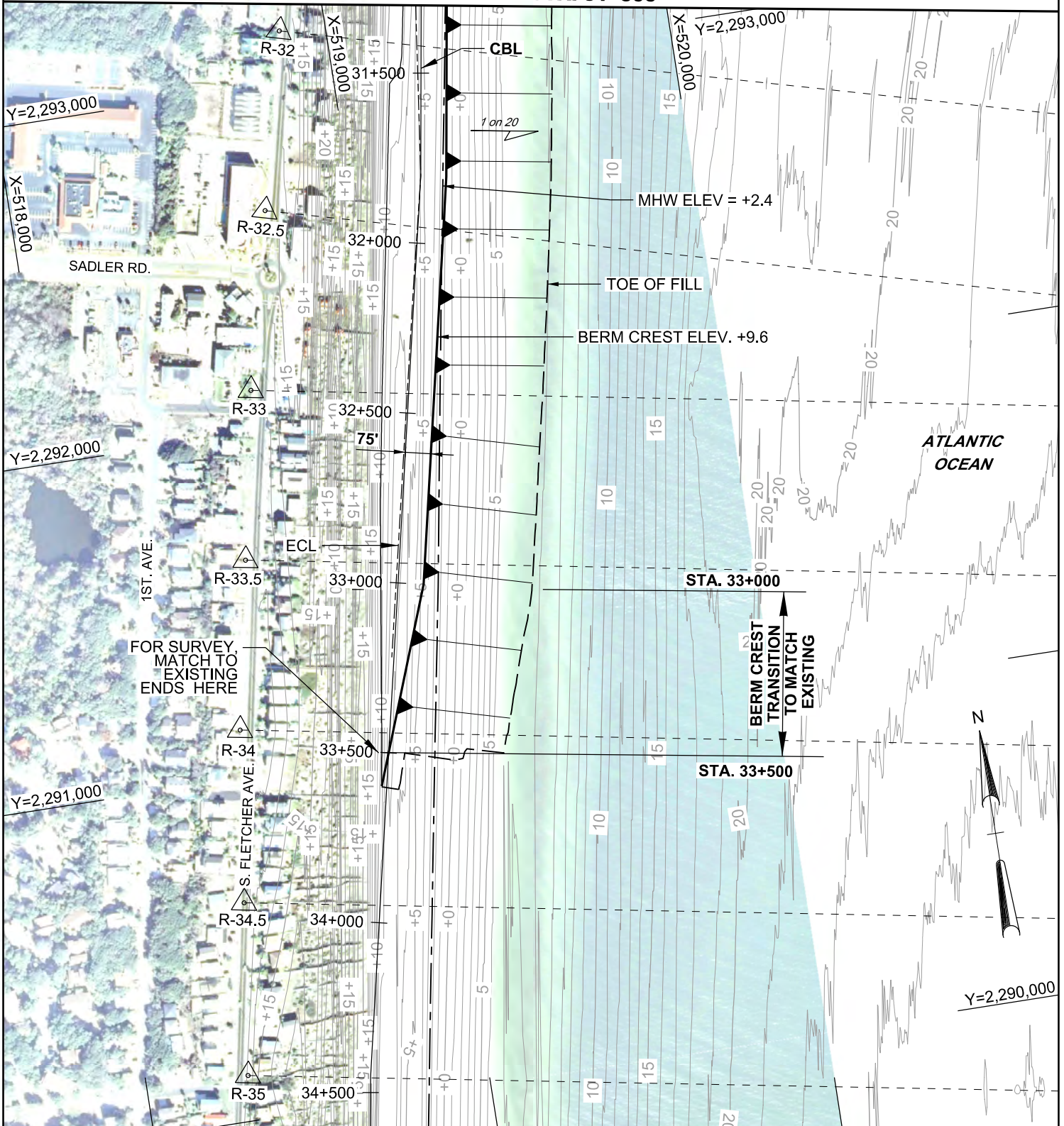

NOTES:

1. SEE PLATE 1. FOR GENERAL PROJECT INFORMATION
2. BERM CREST WIDTH IS MEASURED 75' SEAWARD OF CBL.

GRAPHIC SCALE



US Army Corps of Engineers
Jacksonville District

**NOT FOR CONSTRUCTION
PERMIT DRAWINGS**

DEPARTMENT OF THE ARMY
JACKSONVILLE DISTRICT, CORPS OF ENGINEERS
JACKSONVILLE, FLORIDA

SHORE PROTECTION PROJECT
NASSAU COUNTY, FLORIDA

NASSAU SHORE PROTECTION PROJECT

BEACH FILL PLAN VIEW

DATE	APPROVED	REVISION	DATE:
2/18/14	L.R.P.		MAR. 2014
8/28/14	L.R.P.	M.P.N.	DWN BY: J.W.L.
			PLATE: 10 OF 22

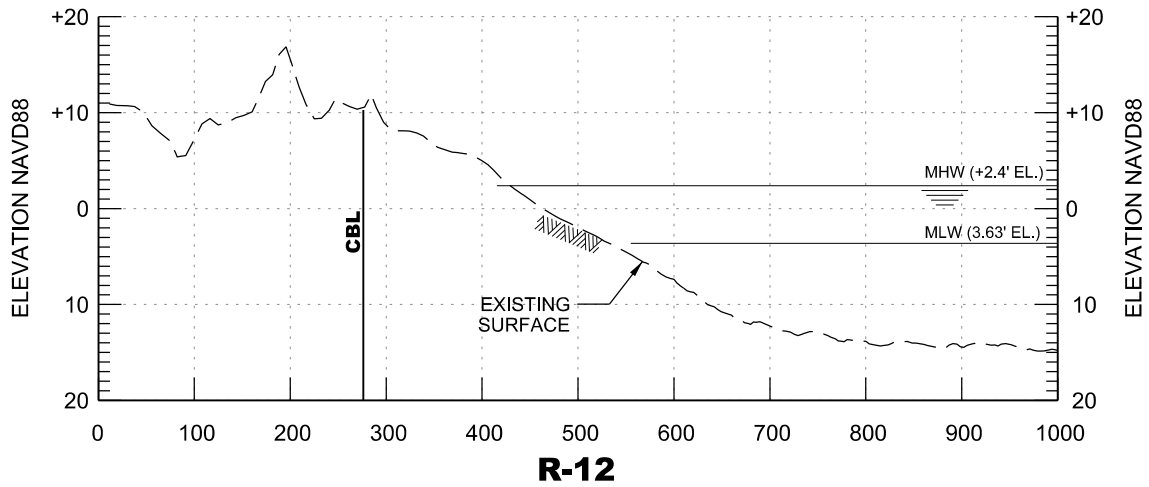

R-12

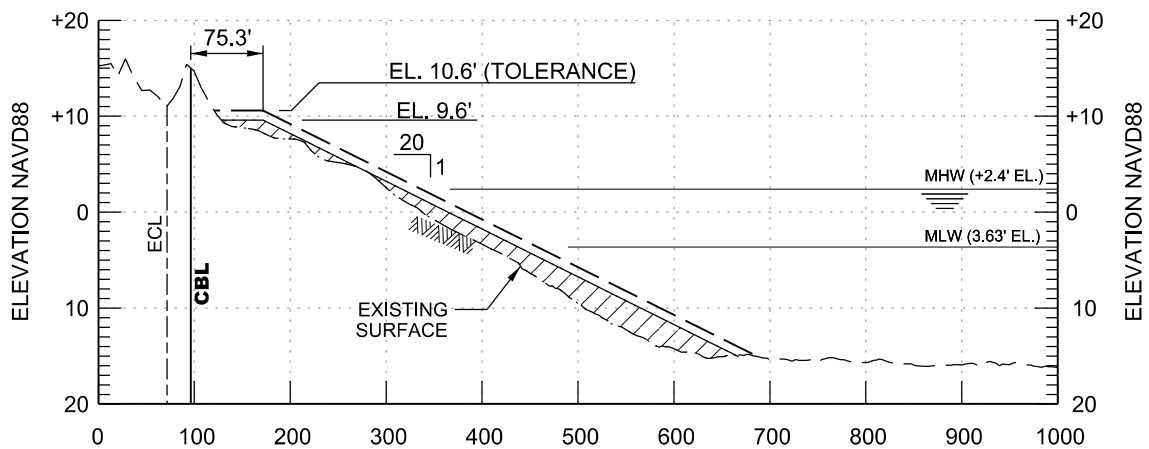

R-13

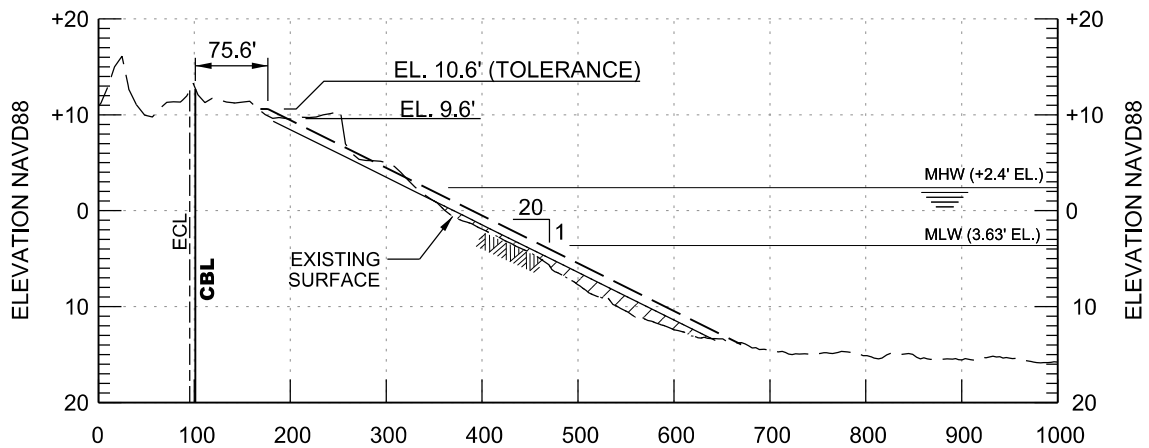

R-14

PLATE NOTES:

1. SEE PLATE 1 FOR PROJECT LOCATION, INDEX TO PLATES, ABBREVIATIONS AND LEGEND.
2. THE HORIZONTAL DISTANCES ARE IN FEET AND FOLLOW FDEP RANGE MONUMENT AZIMUTH.

GRAPHIC SCALES

HORIZONTAL 50' 0 50' 100'

VERTICAL 5' 0 5' 10'



US Army Corps of Engineers
Jacksonville District

**NOT FOR CONSTRUCTION
PERMIT DRAWINGS**

DEPARTMENT OF THE ARMY
JACKSONVILLE DISTRICT, CORPS OF ENGINEERS
JACKSONVILLE, FLORIDA

SHORE PROTECTION PROJECT
NASSAU COUNTY, FLORIDA

NASSAU SHORE PROTECTION PROJECT

BEACH FILL - PROFILE VIEW

DATE	APPROVED	REVISION	DATE:
2/18/14	L.R.P.		MAR. 2014
8/28/14	L.R.P.	M.P.N.	DWN BY: J.W.L.
			PLATE: 11 OF 22

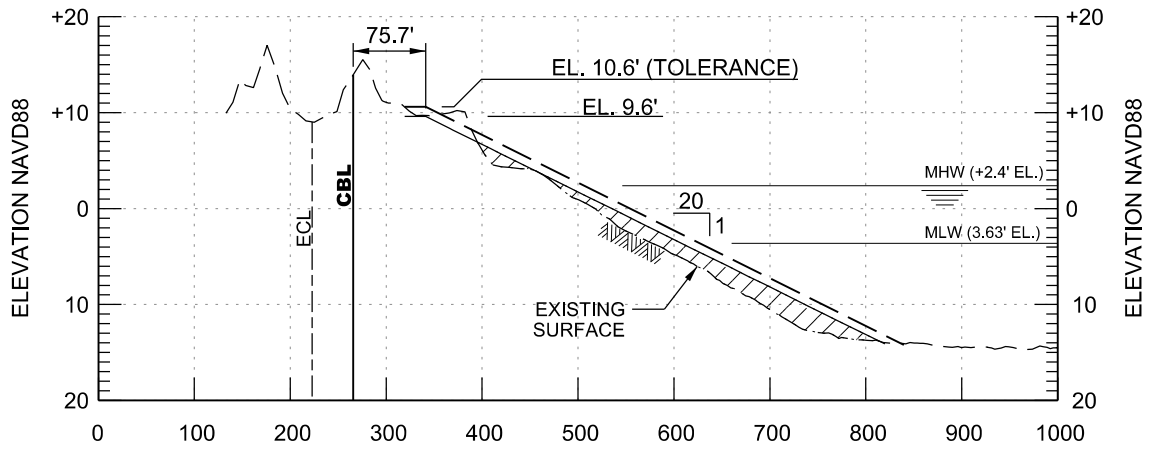

R-15

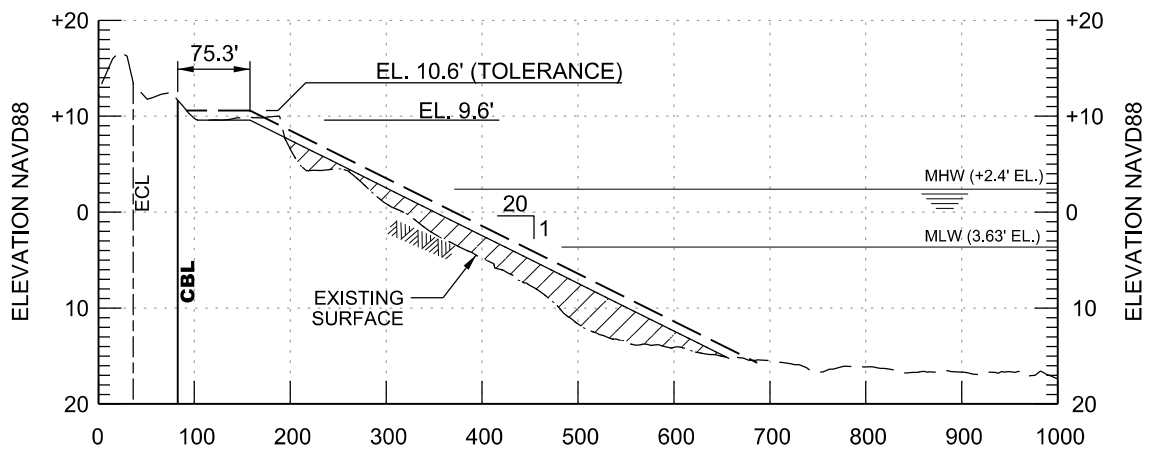

R-16

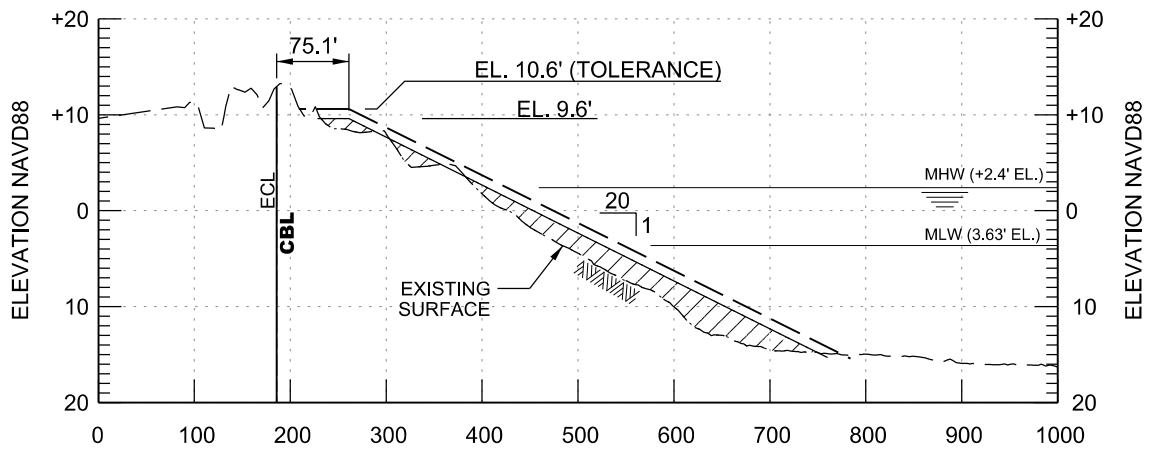

R-17

PLATE NOTES:

1. SEE PLATE 1 FOR PROJECT LOCATION, INDEX TO PLATES, ABBREVIATIONS AND LEGEND.
2. THE HORIZONTAL DISTANCES ARE IN FEET AND FOLLOW FDEP RANGE MONUMENT AZIMUTH.

GRAPHIC SCALES

HORIZONTAL 50' 0 50' 100'

VERTICAL 5' 0 5' 10'



US Army Corps of Engineers
Jacksonville District

**NOT FOR CONSTRUCTION
PERMIT DRAWINGS**

DEPARTMENT OF THE ARMY
JACKSONVILLE DISTRICT, CORPS OF ENGINEERS
JACKSONVILLE, FLORIDA

SHORE PROTECTION PROJECT
NASSAU COUNTY, FLORIDA

NASSAU SHORE PROTECTION PROJECT

BEACH FILL - PROFILE VIEW

DATE	APPROVED	REVISION	DATE:
2/18/14	L.R.P.		MAR. 2014
8/28/14	L.R.P.	M.P.N.	DWN BY: J.W.L.
			PLATE: 12 OF 22

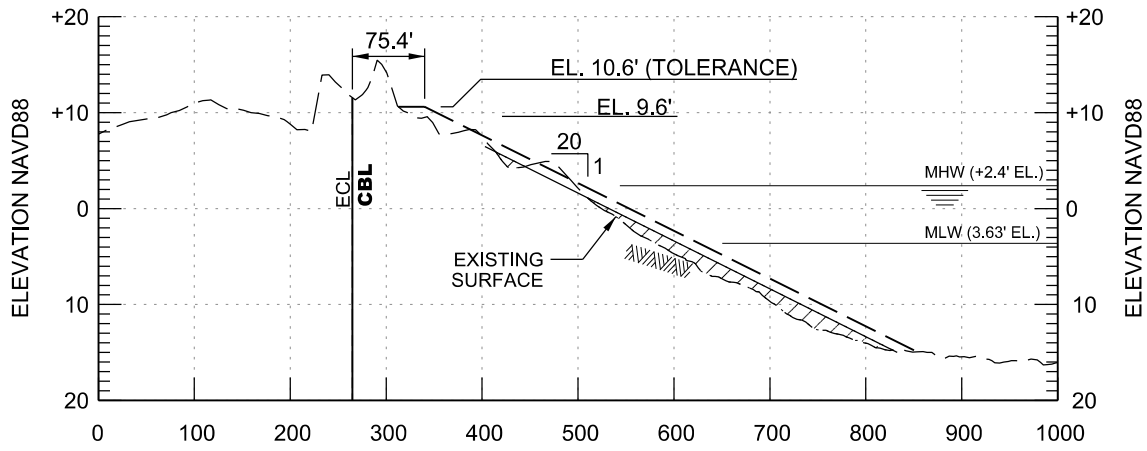

R-18

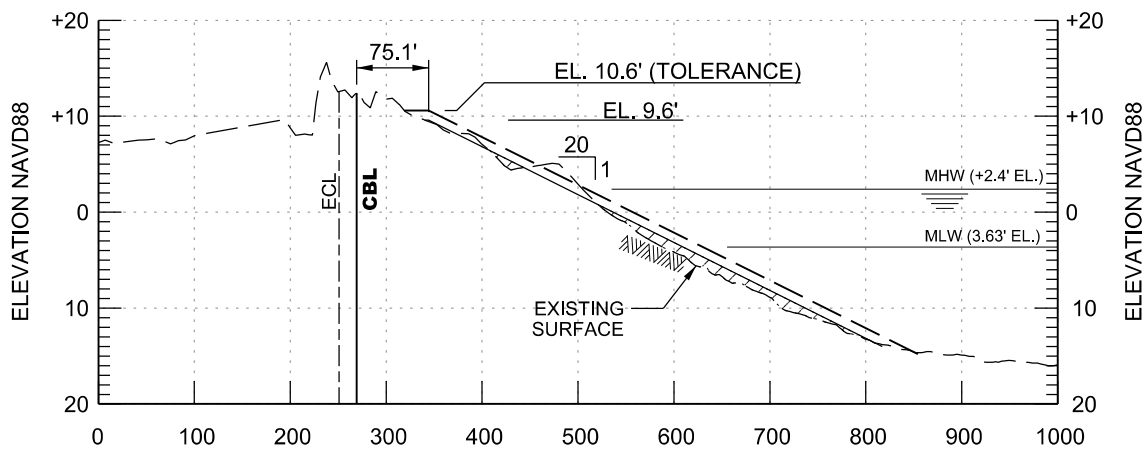

R-19

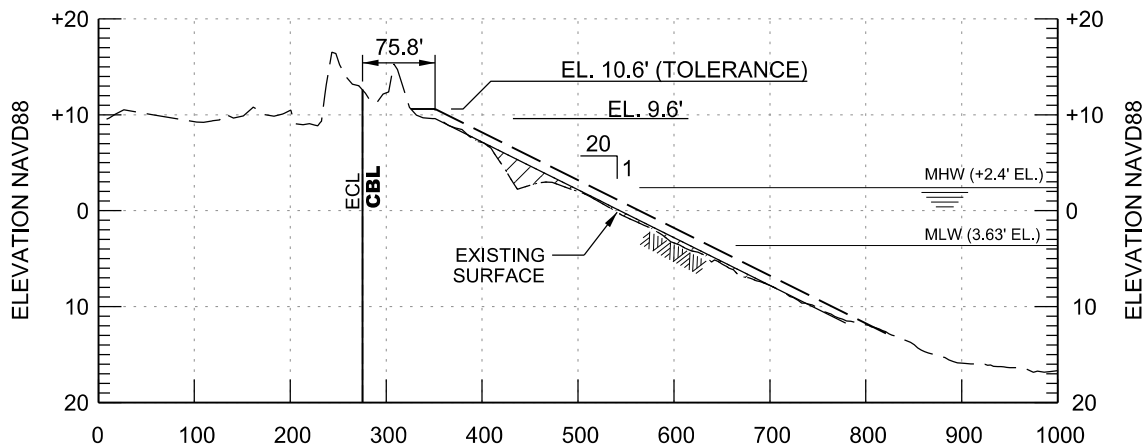

R-20

PLATE NOTES:

1. SEE PLATE 1 FOR PROJECT LOCATION, INDEX TO PLATES, ABBREVIATIONS AND LEGEND.
2. THE HORIZONTAL DISTANCES ARE IN FEET AND FOLLOW FDEP RANGE MONUMENT AZIMUTH.

GRAPHIC SCALES

HORIZONTAL 50' 0 50' 100'

VERTICAL 5' 0 5' 10'



US Army Corps of Engineers
Jacksonville District

**NOT FOR CONSTRUCTION
PERMIT DRAWINGS**

DEPARTMENT OF THE ARMY
JACKSONVILLE DISTRICT, CORPS OF ENGINEERS
JACKSONVILLE, FLORIDA

SHORE PROTECTION PROJECT
NASSAU COUNTY, FLORIDA

NASSAU SHORE PROTECTION PROJECT

BEACH FILL - PROFILE VIEW

DATE	APPROVED	REVISION	DATE:
2/18/14	L.R.P.		MAR. 2014
8/28/14	L.R.P.	M.P.N.	DWN BY: J.W.L.
			PLATE: 13 OF 22

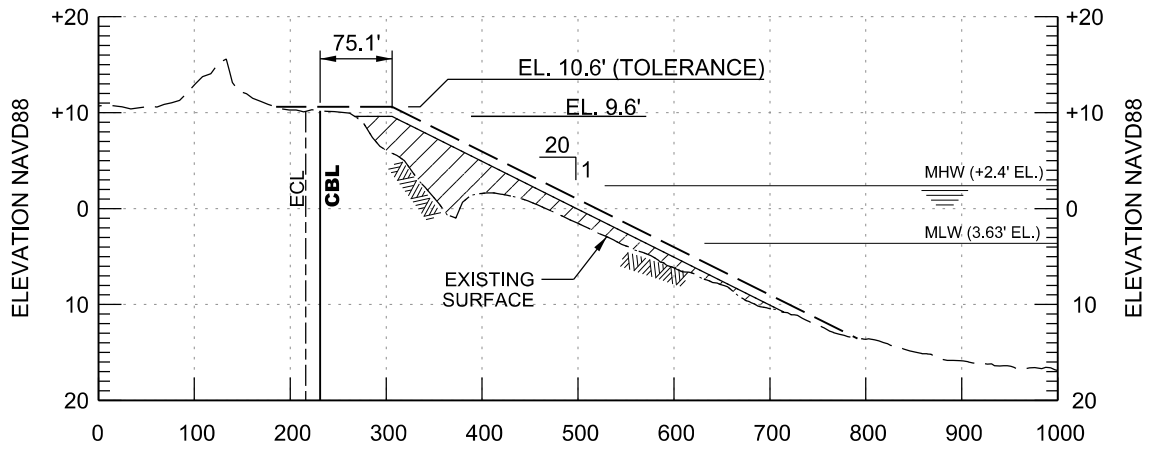

R-21

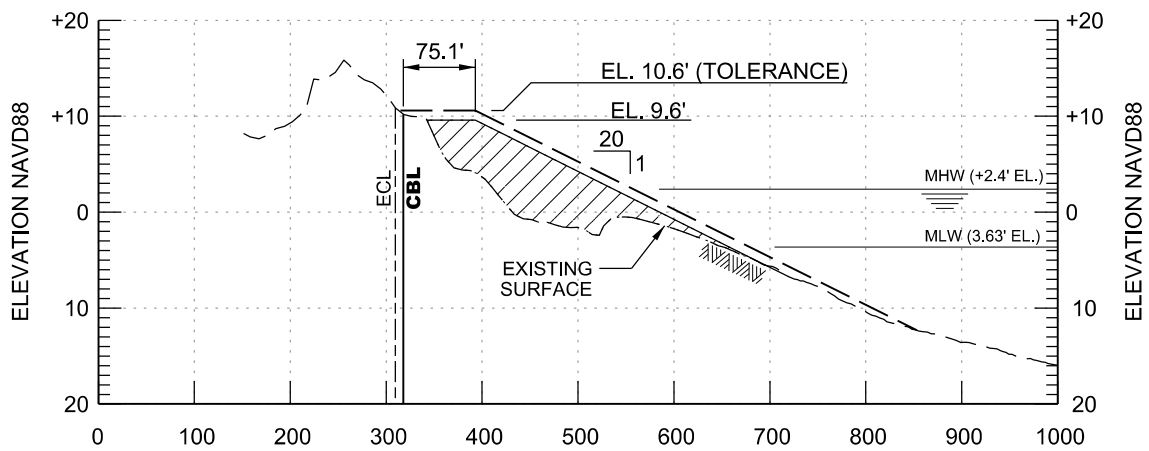

R-22

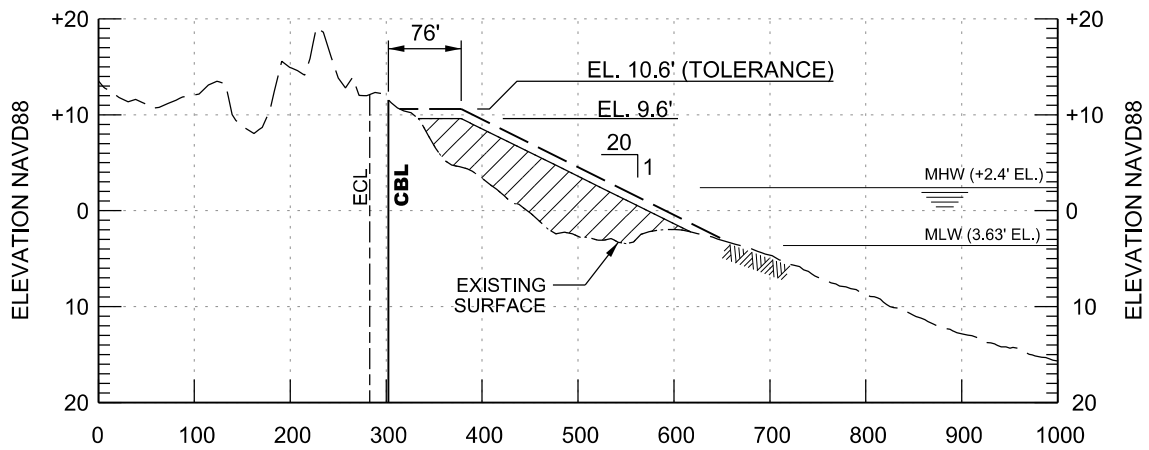

R-23

PLATE NOTES:

1. SEE PLATE 1 FOR PROJECT LOCATION, INDEX TO PLATES, ABBREVIATIONS AND LEGEND.
2. THE HORIZONTAL DISTANCES ARE IN FEET AND FOLLOW FDEP RANGE MONUMENT AZIMUTH.

GRAPHIC SCALES

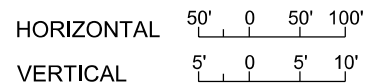

US Army Corps
of Engineers
Jacksonville District

**NOT FOR CONSTRUCTION
PERMIT DRAWINGS**

DEPARTMENT OF THE ARMY
JACKSONVILLE DISTRICT, CORPS OF ENGINEERS
JACKSONVILLE, FLORIDA

SHORE PROTECTION PROJECT
NASSAU COUNTY, FLORIDA

NASSAU SHORE PROTECTION PROJECT

BEACH FILL - PROFILE VIEW

DATE	APPROVED	REVISION	DATE:
2/18/14	L.R.P.		MAR. 2014
8/28/14	L.R.P.	M.P.N.	DWN BY: J.W.L.
			PLATE: 14 OF 22

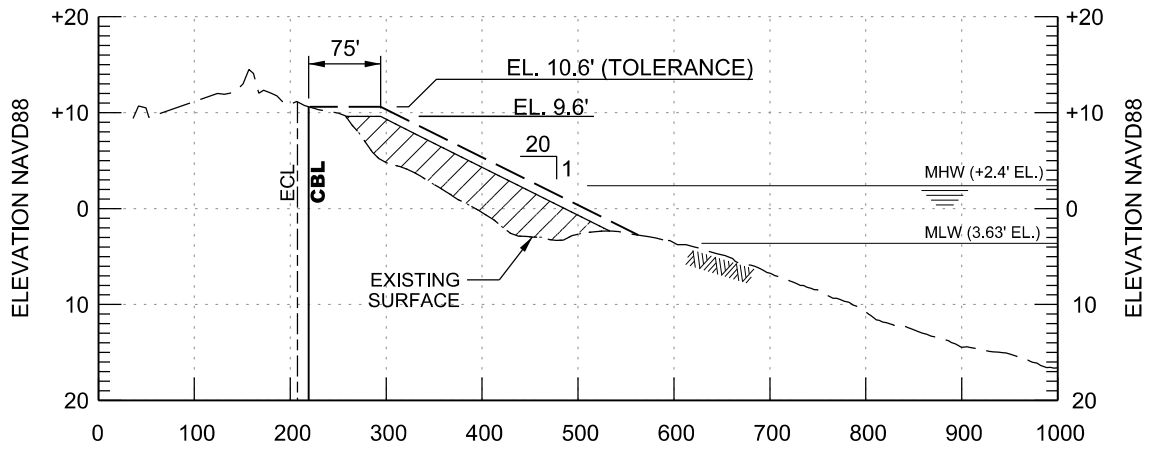

R-24

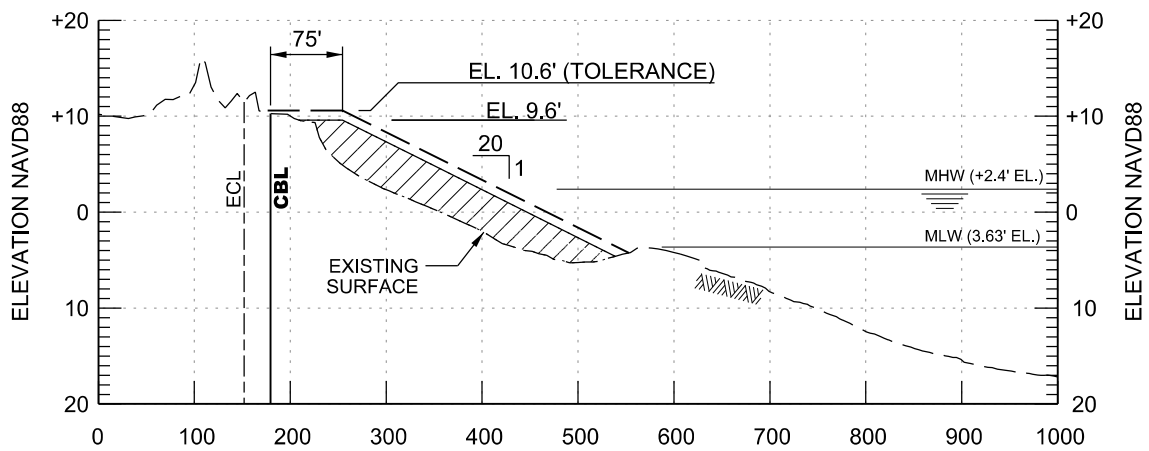

R-25

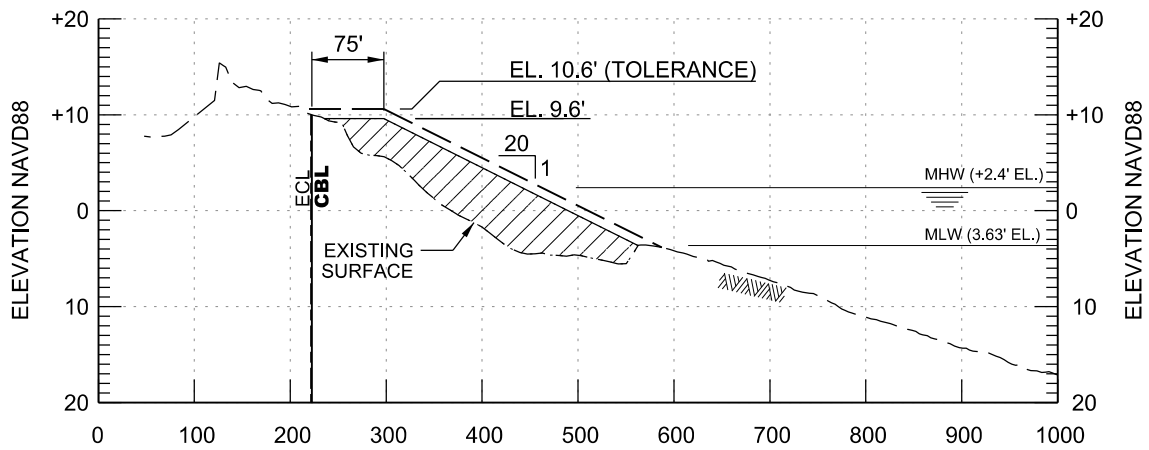

R-26

GRAPHIC SCALES

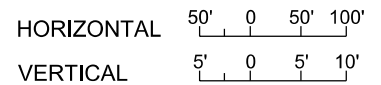

PLATE NOTES:

1. SEE PLATE 1 FOR PROJECT LOCATION, INDEX TO PLATES, ABBREVIATIONS AND LEGEND.
2. THE HORIZONTAL DISTANCES ARE IN FEET AND FOLLOW FDEP RANGE MONUMENT AZIMUTH.



**NOT FOR CONSTRUCTION
PERMIT DRAWINGS**

DEPARTMENT OF THE ARMY
JACKSONVILLE DISTRICT, CORPS OF ENGINEERS
JACKSONVILLE, FLORIDA

SHORE PROTECTION PROJECT
NASSAU COUNTY, FLORIDA

NASSAU SHORE PROTECTION PROJECT

BEACH FILL - PROFILE VIEW

DATE	APPROVED	REVISION	DATE:
2/18/14	L.R.P.		MAR. 2014
8/28/14	L.R.P.	M.P.N.	DWN BY: J.W.L.
			PLATE: 15 OF 22

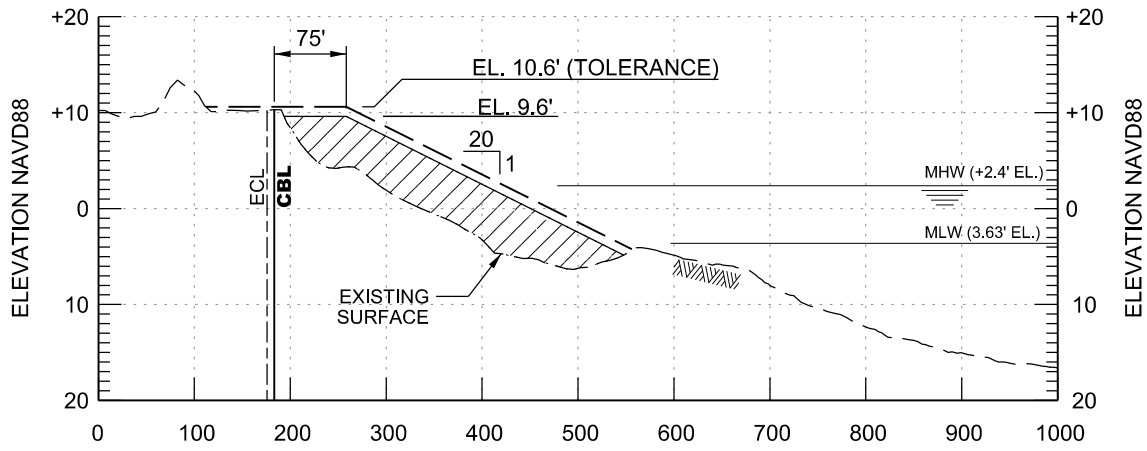

R-27

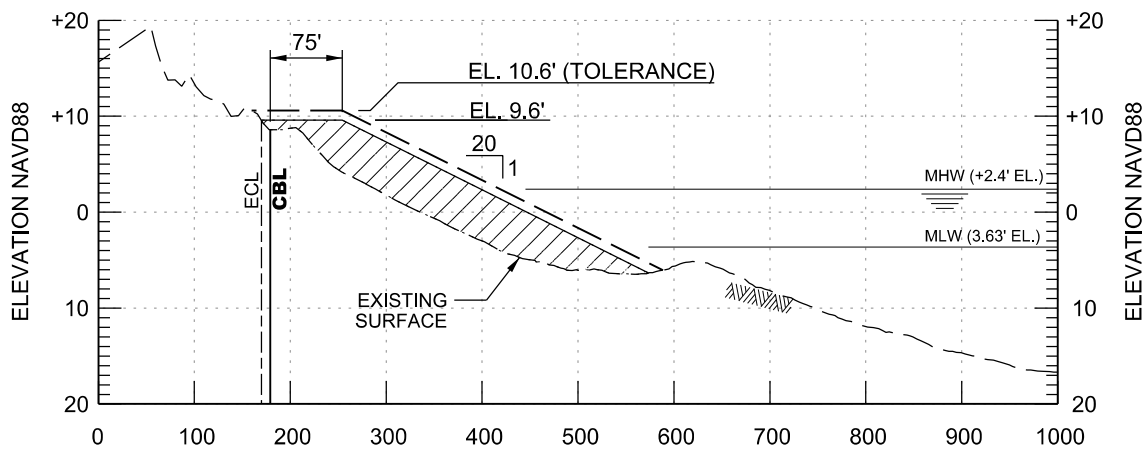

R-28

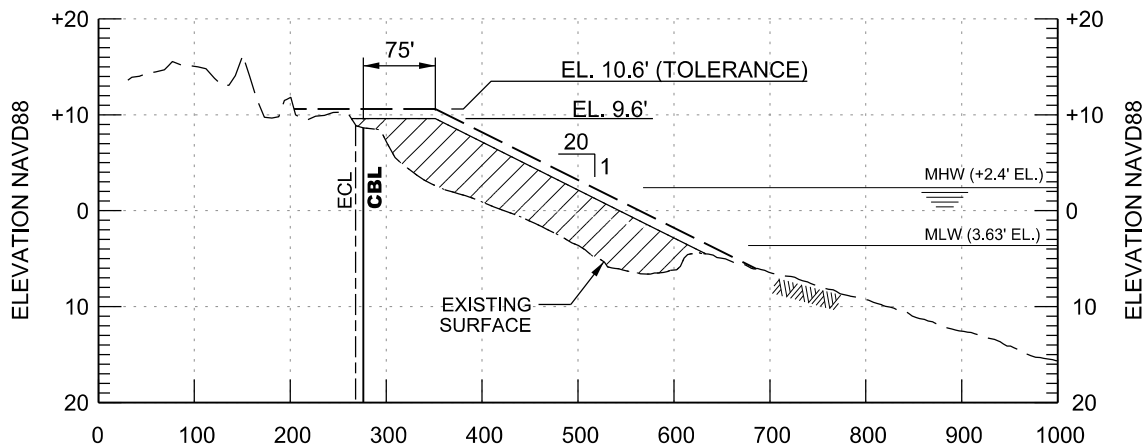

R-29

PLATE NOTES:

1. SEE PLATE 1 FOR PROJECT LOCATION, INDEX TO PLATES, ABBREVIATIONS AND LEGEND.
2. THE HORIZONTAL DISTANCES ARE IN FEET AND FOLLOW FDEP RANGE MONUMENT AZIMUTH.

GRAPHIC SCALES

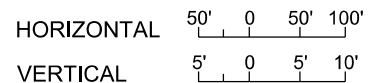

**NOT FOR CONSTRUCTION
 PERMIT DRAWINGS**

DEPARTMENT OF THE ARMY
 JACKSONVILLE DISTRICT, CORPS OF ENGINEERS
 JACKSONVILLE, FLORIDA

SHORE PROTECTION PROJECT
 NASSAU COUNTY, FLORIDA

NASSAU SHORE PROTECTION PROJECT

BEACH FILL - PROFILE VIEW

DATE	APPROVED	REVISION	DATE:
2/18/14	L.R.P.		MAR. 2014
8/28/14	L.R.P.	M.P.N.	DWN BY: J.W.L.
			PLATE: 16 OF 22

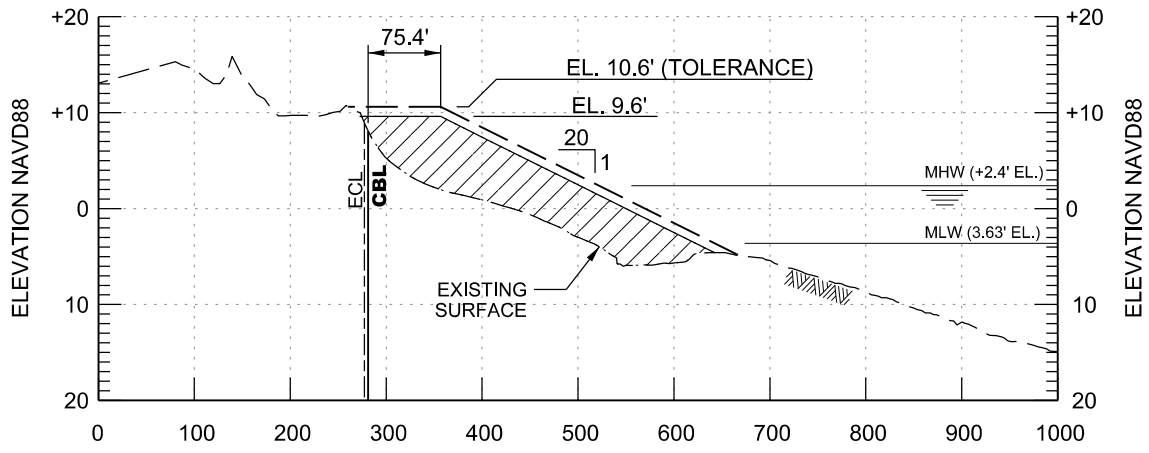

R-30

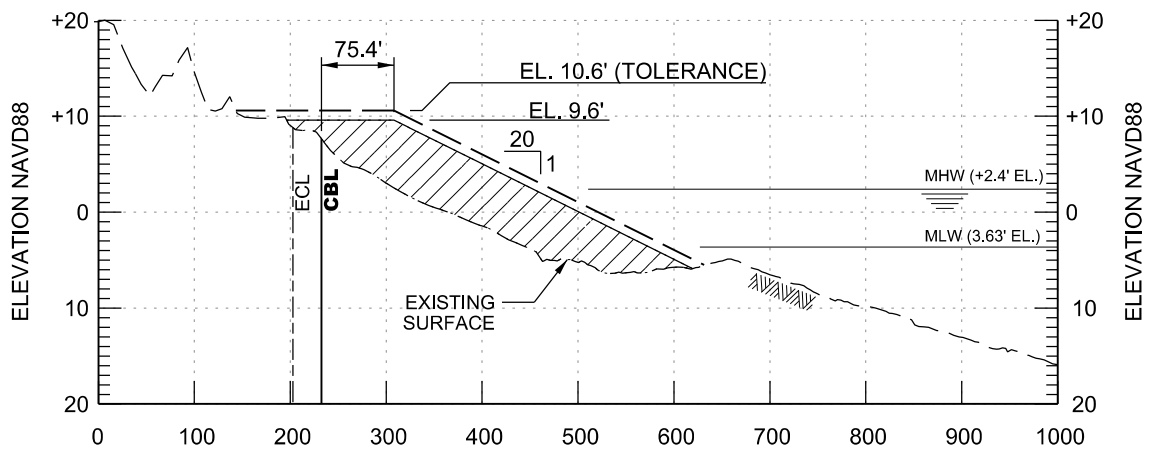

R-31

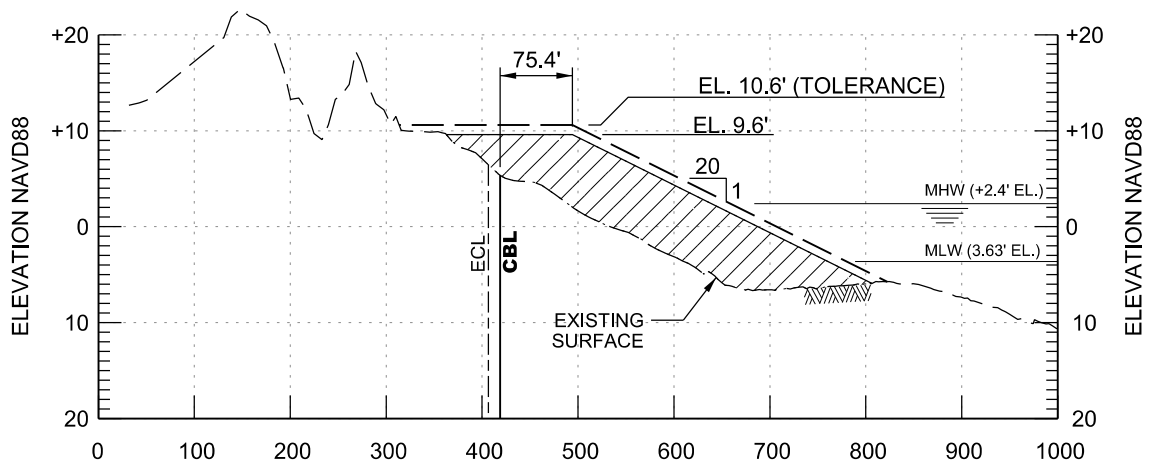

R-32

PLATE NOTES:

1. SEE PLATE 1 FOR PROJECT LOCATION, INDEX TO PLATES, ABBREVIATIONS AND LEGEND.
2. THE HORIZONTAL DISTANCES ARE IN FEET AND FOLLOW FDEP RANGE MONUMENT AZIMUTH.

GRAPHIC SCALES

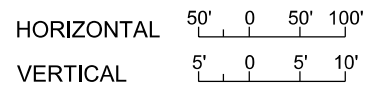

**NOT FOR CONSTRUCTION
PERMIT DRAWINGS**

DEPARTMENT OF THE ARMY
JACKSONVILLE DISTRICT, CORPS OF ENGINEERS
JACKSONVILLE, FLORIDA

SHORE PROTECTION PROJECT
NASSAU COUNTY, FLORIDA
NASSAU SHORE PROTECTION PROJECT
BEACH FILL - PROFILE VIEW

DATE	APPROVED	REVISION	DATE:
2/18/14	L.R.P.		MAR. 2014
8/28/14	L.R.P.	M.P.N.	DWN BY: J.W.L.
			PLATE: 17 OF 22

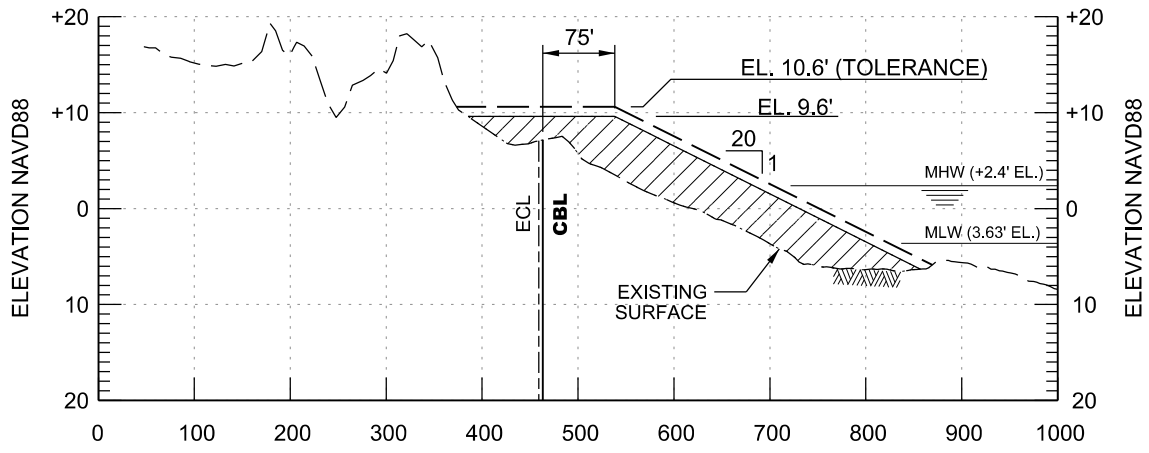

R-33

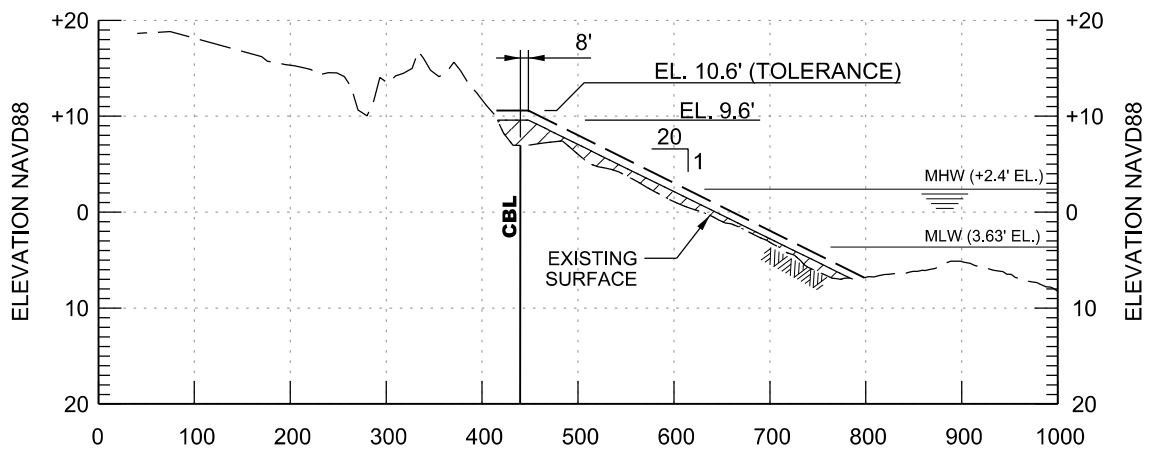

R-34

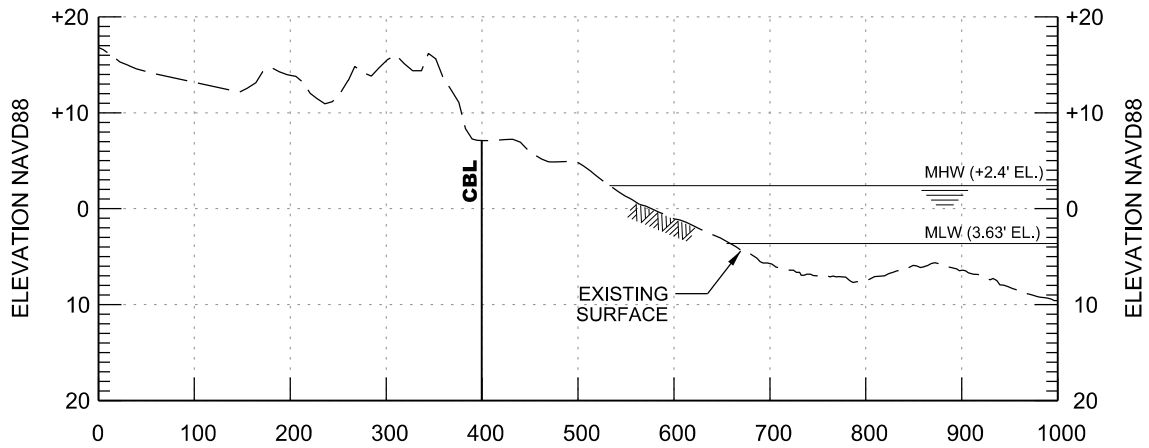

R-35

PLATE NOTES:

1. SEE PLATE 1 FOR PROJECT LOCATION, INDEX TO PLATES, ABBREVIATIONS AND LEGEND.
2. THE HORIZONTAL DISTANCES ARE IN FEET AND FOLLOW FDEP RANGE MONUMENT AZIMUTH.

GRAPHIC SCALES

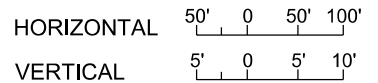

US Army Corps of Engineers
Jacksonville District

**NOT FOR CONSTRUCTION
PERMIT DRAWINGS**

DEPARTMENT OF THE ARMY
JACKSONVILLE DISTRICT, CORPS OF ENGINEERS
JACKSONVILLE, FLORIDA

SHORE PROTECTION PROJECT
NASSAU COUNTY, FLORIDA

NASSAU SHORE PROTECTION PROJECT

BEACH FILL - PROFILE VIEW

DATE	APPROVED	REVISION	DATE:
2/18/14	L.R.P.		MAR. 2014
8/28/14	L.R.P.	M.P.N.	DWN BY: J.W.L.
			PLATE: 18 OF 22

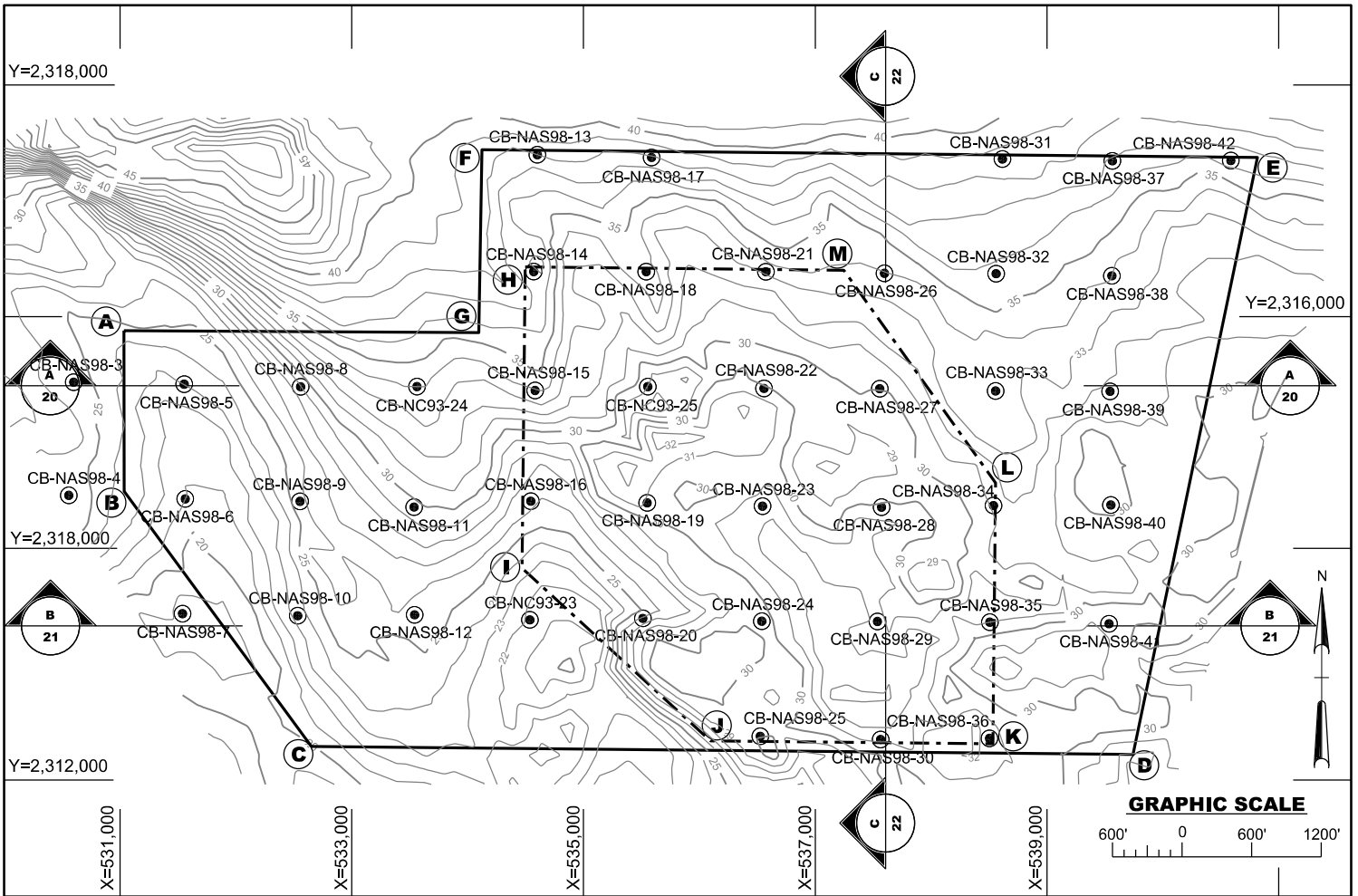

CUT AREA COORDINATES					
POINT	X	Y	POINT	X	Y
A.	531,034.65	2,315,879.08	H.	534,497.03	2,316,429.25
B.	531,035.60	2,314,492.87	I.	534,470.03	2,313,829.25
C.	532,650.81	2,312,290.18	J.	536,097.03	2,312,339.25
D.	539,743.58	2,312,221.50	K.	538,534.03	2,312,313.25
E.	540,817.10	2,317,373.36	L.	538,557.03	2,314,566.25
F.	534,123.43	2,317,441.10	M.	537,246.03	2,316,400.25
G.	534,096.67	2,315,861.63			

PLATE LEGEND:

- BORROW AREA
- PREVIOUSLY USED BORROW AREA
- EXISTING BORING LOCATIONS
- CUT AREA COORDINATE POINT

PLATE NOTES:

1. SEE PL. #01 FOR PROJECT LOCATION, INDEX TO PLATES, ABBREVIATIONS AND LEGEND.
2. CONTOURS GENERATED FROM SURVEY #13-171 COMPLETED BETWEEN 8/19/13 TO 8/22/13.
3. THE APPROXIMATE BORROW AREA SURFACE USED FOR ESTIMATING THE VOLUME WAS DEVELOPED FROM THE DEPTH OF BEACH QUALITY MATERIAL AT EACH BORING. PLEASE REFER TO SEDIMENT COMPATIBILITY ANALYSIS.



**NOT FOR CONSTRUCTION
PERMIT DRAWINGS**

DEPARTMENT OF THE ARMY
JACKSONVILLE DISTRICT, CORPS OF ENGINEERS
JACKSONVILLE, FLORIDA

SHORE PROTECTION PROJECT
NASSAU COUNTY, FLORIDA

**NASSAU SHORE PROTECTION PROJECT
BORROW AREA**

DATE	APPROVED	REVISION	DATE:
2/18/14	L.R.P.		MAR. 2014
8/28/14	L.R.P.	M.P.N.	DWN BY: J.W.L.
			PLATE: 19 OF 22

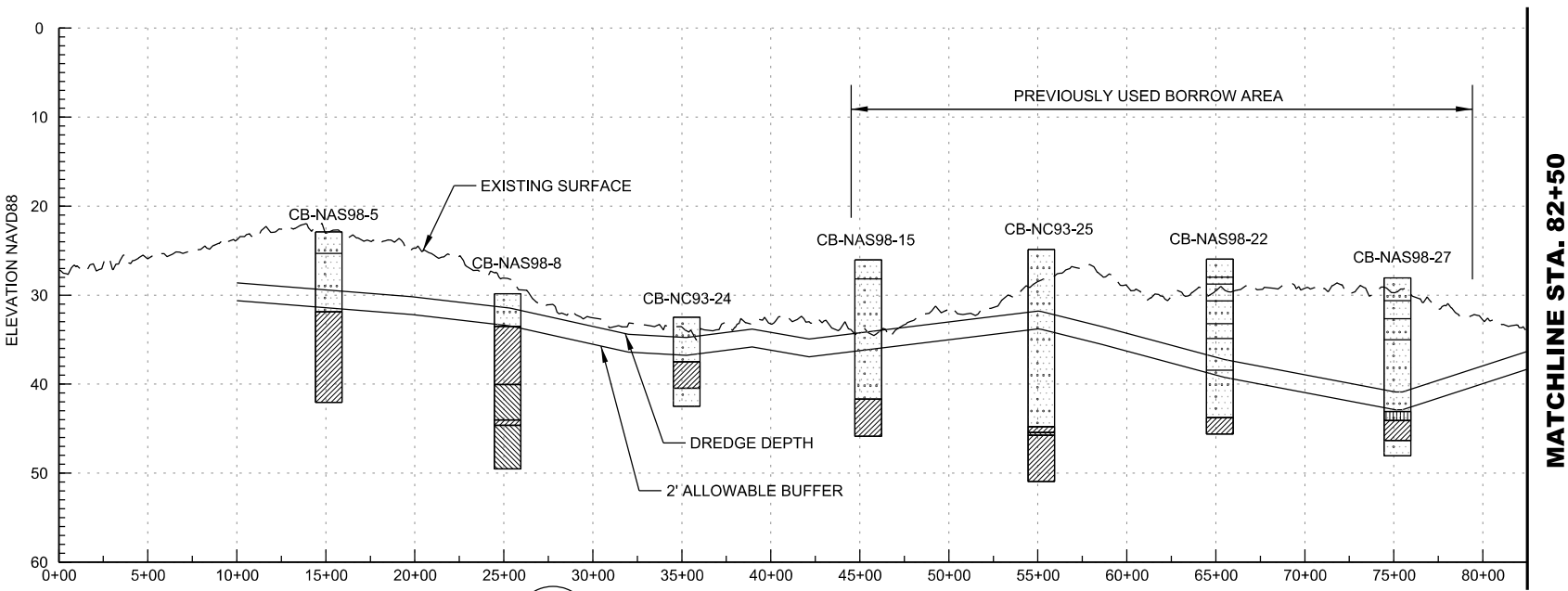

A
19
BORROW AREA SECTION DETAIL

MATCHLINE STA. 82+50

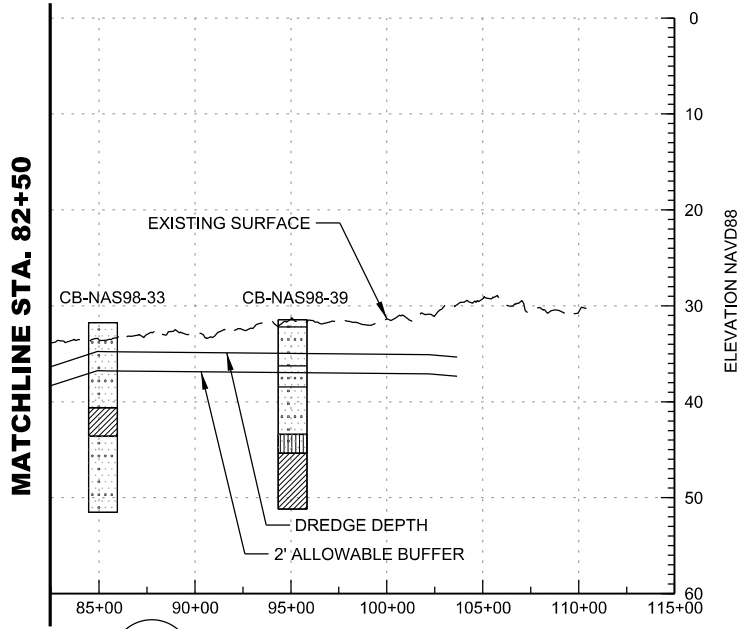

A
19
BORROW AREA SECTION DETAIL

MATCHLINE STA. 82+50

LEGEND

	SAND (SP)		SILTY SAND (SM)		CLAYEY SAND (SC)
	CLAY (CH)		SAND W/ SILT (SP-SM)		

PLATE NOTES:

1. SEE PLATE 1 FOR PROJECT LOCATION, INDEX TO PLATES, ABBREVIATIONS AND GENERAL NOTES.
2. THE APPROXIMATE BORROW AREA SURFACE USED FOR ESTIMATING THE VOLUME WAS DEVELOPED USING THE DEPTH OF BEACH QUALITY MATERIAL AT EACH BORING. PLEASE REFER TO SEDIMENT COMPATIBILITY ANALYSIS FOR BORROW CUT DEPTHS.

GRAPHIC SCALES

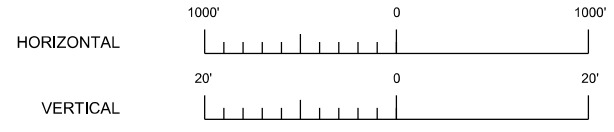

NOT FOR CONSTRUCTION PERMIT DRAWINGS

DEPARTMENT OF THE ARMY
JACKSONVILLE DISTRICT, CORPS OF ENGINEERS
JACKSONVILLE, FLORIDA

NASSAU SHORE PROTECTION PROJECT

SHORE PROTECTION PROJECT
NASSAU COUNTY, FLORIDA

BORROW AREA SECTIONS

DATE	APPROVED	REVISION	DATE
2/18/14	L.R.P.	M.P.N.	MAR. 2014
8/28/14	L.R.P.	J.W.L.	
PLATE:	DATE:		
21 OF 22	MAR. 2014		

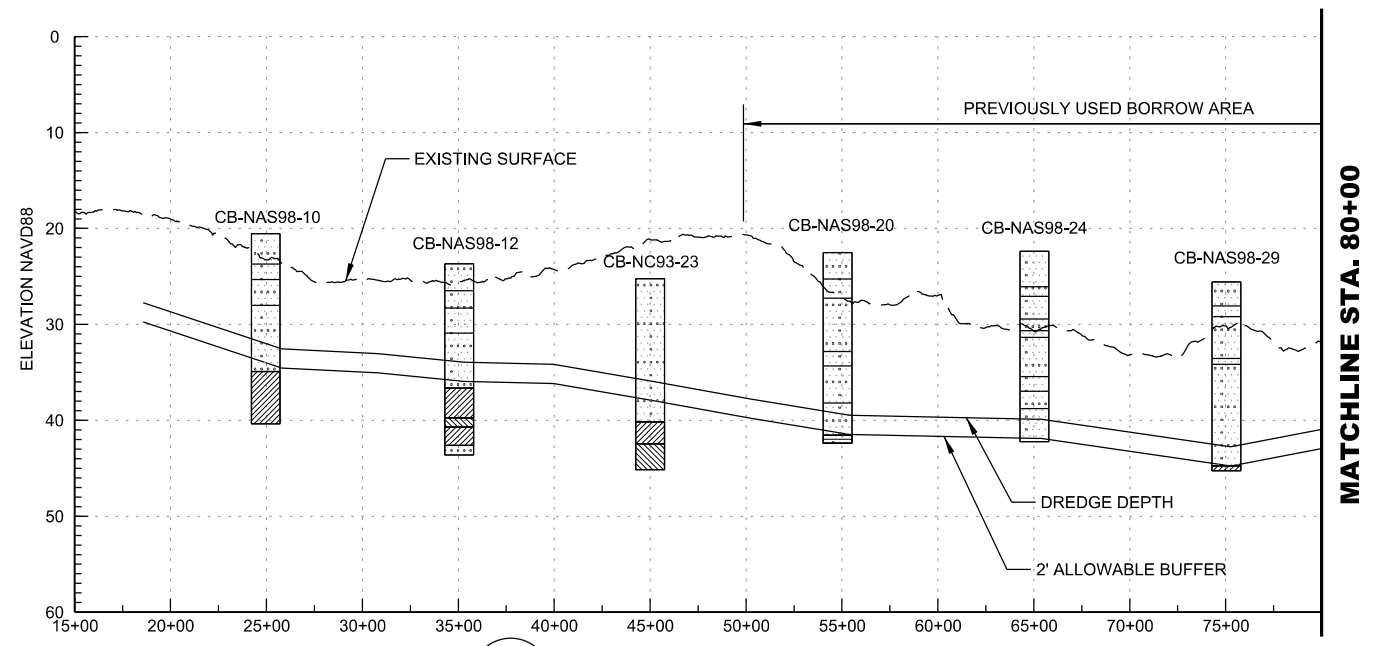

B 19 BORROW AREA SECTION DETAIL

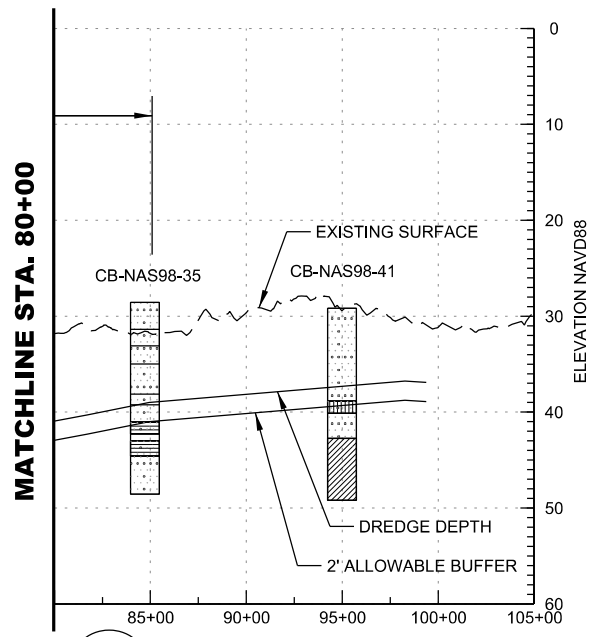

B 19 BORROW AREA SECTION DETAIL

LEGEND

	SAND (SP)		SILTY SAND (SM)		CLAYEY SAND (SC)
	CLAY (CH)		SAND W/ SILT (SP-SM)		

PLATE NOTES:

1. SEE PLATE 1 FOR PROJECT LOCATION, INDEX TO PLATES, ABBREVIATIONS AND GENERAL NOTES.
2. THE APPROXIMATE BORROW AREA SURFACE USED FOR ESTIMATING THE VOLUME WAS DEVELOPED FROM THE DEPTH OF BEACH QUALITY MATERIAL AT EACH BORING. PLEASE REFER TO SEDIMENT COMPATIBILITY ANALYSIS.

GRAPHIC SCALES

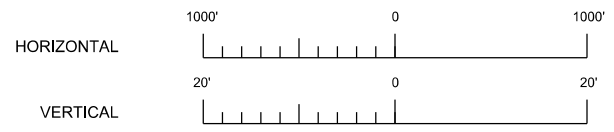

NOT FOR CONSTRUCTION PERMIT DRAWINGS

DEPARTMENT OF THE ARMY
JACKSONVILLE DISTRICT, CORPS OF ENGINEERS
JACKSONVILLE, FLORIDA

NASSAU SHORE PROTECTION PROJECT

SHORE PROTECTION PROJECT
NASSAU COUNTY, FLORIDA

BORROW AREA SECTIONS

DATE	2/18/14	APPROVED	L.R.P.	REVISION	DATE
	8/28/14		L.R.P.		
			M.P.N.		
PLATE:	22 OF 22	DATE:	MAR. 2014	OWN BY:	J.W.L.

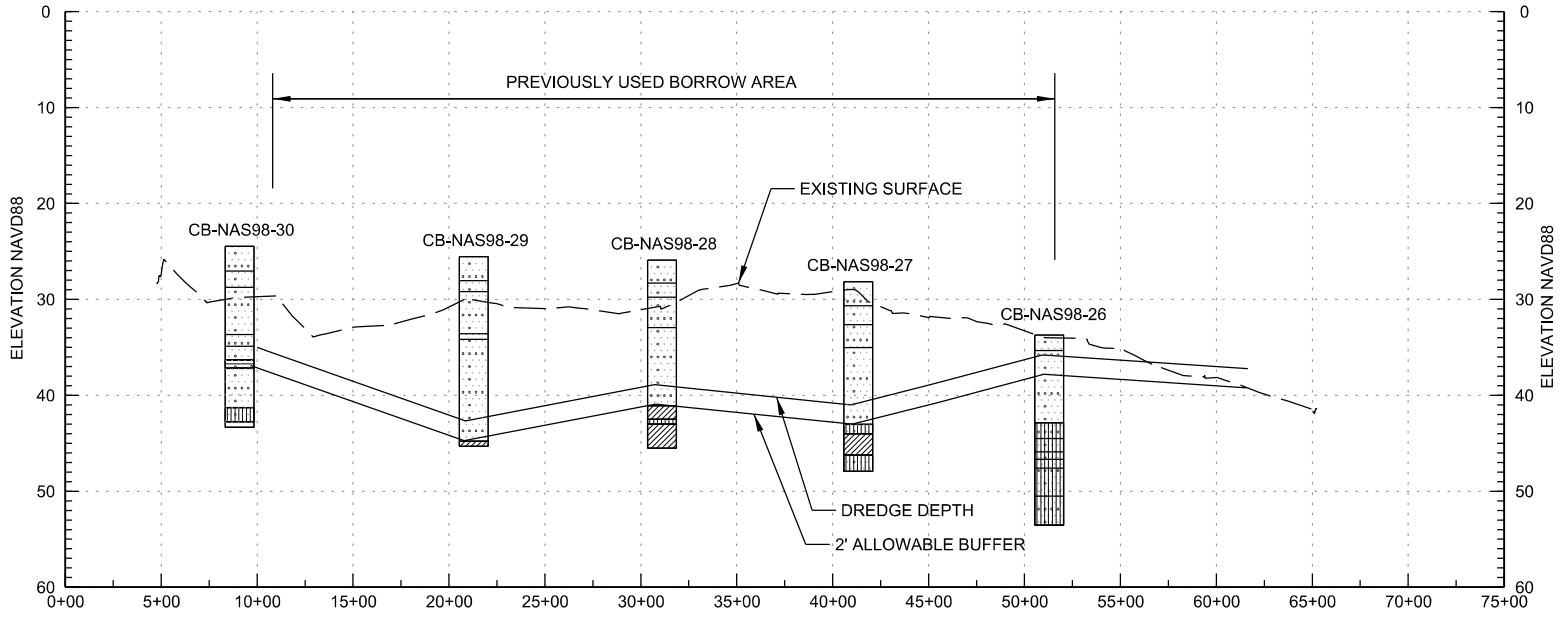

C
19
BORROW AREA SECTION DETAIL

LEGEND

	SAND (SP)		SILTY SAND (SM)		CLAYEY SAND (SC)
	CLAY (CH)		SAND W/ SILT (SP-SM)		

PLATE NOTES:

- SEE PLATE 1 FOR PROJECT LOCATION, INDEX TO PLATES, ABBREVIATIONS AND GENERAL NOTES.
- THE APPROXIMATE BORROW AREA SURFACE USED FOR ESTIMATING THE VOLUME WAS DEVELOPED FROM THE DEPTH OF BEACH QUALITY MATERIAL AT EACH BORING. PLEASE REFER TO SEDIMENT COMPATIBILITY ANALYSIS.

GRAPHIC SCALES

