

FT. PIERCE HARBOR ST. LUCIE COUNTY, FLORIDA POST-HURRICANE MATTHEW EXAMINATION SURVEY FY17 28 & 30-FOOT PROJECT

SURVEY NOTES

- REFER TO SURVEY NO. 17-013.
 - SOUNDINGS ARE IN FEET AND TENTHS AND REFER TO NOAA'S REPORTED MEAN LOWER LOW WATER (MLLW) OF THE 1983-2001 TIDAL EPOCH.
 - TIDAL REDUCTIONS WERE OBTAINED UTILIZING A REAL-TIME KINEMATIC (RTK) GPS AND REFERENCED TO MLLW UTILIZING A HYPACK KINEMATIC TIDE DATUM (KTD) MODEL. KTD FILE NAME IS: "INDIANRIVER-STLUCIE-MARTIN_20140527.KTD".
 - ALL ELEVATIONS ARE BELOW THE CHART DATUM UNLESS PRECEDED BY A (+) SIGN.
 - PLANE COORDINATES ARE BASED ON THE TRANSVERSE MERCATOR PROJECTION FOR THE EAST ZONE OF FLORIDA AND REFERENCED TO NORTH AMERICAN DATUM OF 1983 (NAD83).
 - ALL STATIONING REFERS TO THE CENTERLINE OF THE CHANNEL.
 - THIS SURVEY WAS PERFORMED USING REAL-TIME KINEMATIC (RTK) GPS POSITIONING WITH THE FOLLOWING REFERENCE BASE LOCATIONS:
REFERENCE BASE LOCATED AT "872 2213 K" (PID: DI3923)
TIDE STAFF LOCATED AT "872 2213 K" (PID: DI3923)
 - DEPTHS DEPICTED BY THIS SURVEY ARE REFERENCED TO MLLW, TIDAL EPOCH 1983-2001 AS REPORTED BY THE NATIONAL OCEANIC AND ATMOSPHERIC ADMINISTRATION (NOAA). NOAA'S VDATUM MODEL WAS USED AND CALIBRATED TO THE PUBLISHED MLLW HEIGHTS OF THE BENCHMARKS ASSOCIATED WITH THE TIDE GAGE SITES SPECIFIED BELOW:
NOAA TIDAL STATION 872-2213 FOR ALL CUTS.
VERTICAL MEASUREMENTS WERE MADE USING AN EDGETECH 6205 COMBINED MULTIBEAM AND SIDESCAN MULTI-BEAM SOUNDER. ALL SOUNDINGS SHOWN ARE IN HIGH FREQUENCY.
- | VESSEL | DATE OF SURVEY | CUT |
|--------|----------------|---------------------|
| SB-48 | 01-02 NOV 2016 | 1, 2, TURNING BASIN |
- AIDS TO NAVIGATION WERE LOCATED DURING THIS SURVEY.
 - THE INFORMATION DEPICTED ON THIS MAP REPRESENTS THE RESULTS OF SURVEYS MADE ON THE DATES INDICATED ABOVE AND CAN ONLY BE CONSIDERED AS INDICATING THE GENERAL CONDITIONS AT THAT TIME. THIS CHART IS SOLELY FOR THE DISTRIBUTION OF AVAILABLE DEPTHS AT THE TIME OF THE SURVEY.
 - SURVEY ACCURACY PERFORMANCE STANDARDS, QUALITY CONTROL, AND QUALITY ASSURANCE REQUIREMENTS WERE FOLLOWED DURING THIS SURVEY IN ACCORDANCE WITH USACE EM 1110-2-1003, HYDROGRAPHIC SURVEYING, 30 NOV 13.

LEGEND	
	MONUMENT
	LIGHTED BEACON
	GREEN DAYBEACON
	RED DAYBEACON
	RED LIGHTED BUOY
	GREEN LIGHTED BUOY
	CAN BUOY
	NUN BUOY
	TIDE STAFF
	PROJECT DEPTH

US Army Corps of Engineers
Jacksonville District

SAFETY ON THIS JOB
DEPENDS ON YOU

DEPARTMENT OF THE ARMY JACKSONVILLE DISTRICT, CORPS OF ENGINEERS JACKSONVILLE, FLORIDA	Drawn by: GHR Checked by: GHR Date: NOV 2016
PROJECT: FT. PIERCE HARBOR, ST. LUCIE COUNTY, FLORIDA SURVEY: POST-HURRICANE MATTHEW EXAMINATION SURVEY FY17 MAP: INDEX, LOCATION AND VICINITY	Scale: AS SHOWN Drawing no. 1
SHEET 01 OF 08	

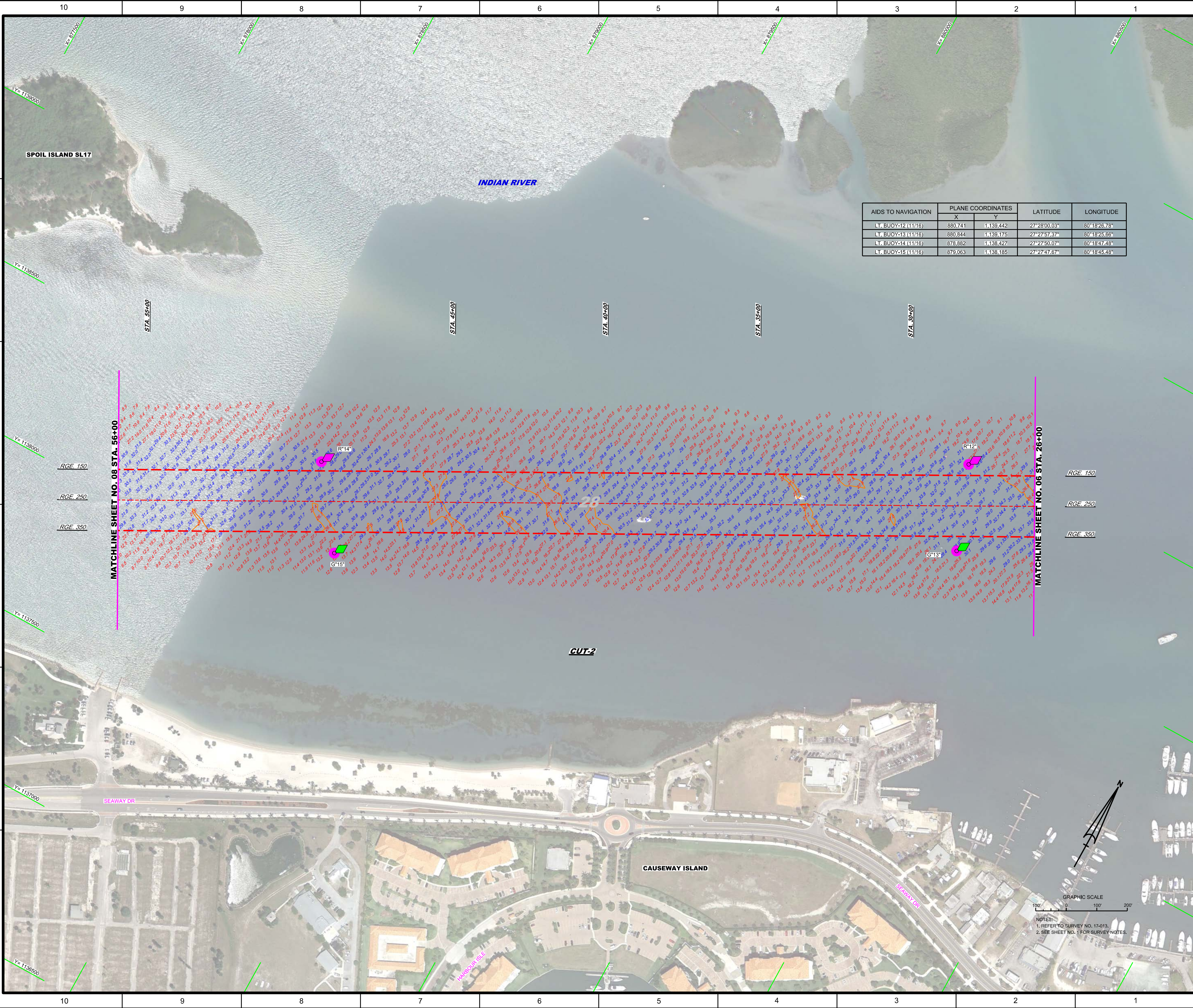

AIDS TO NAVIGATION	PLANE COORDINATES		LATITUDE	LONGITUDE
	X	Y		
LT. BUOY-12 (11/16)	880,741	1,139,442	27°28'00.03"	80°18'26.78"
LT. BUOY-13 (11/16)	880,844	1,139,175	27°27'57.37"	80°18'25.66"
LT. BUOY-14 (11/16)	878,882	1,138,427	27°27'50.07"	80°18'47.48"
LT. BUOY-15 (11/16)	879,063	1,138,185	27°27'47.67"	80°18'45.48"

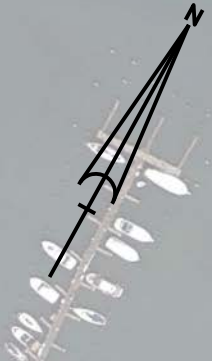

NOTES:
1. REFER TO SURVEY NO. 17-013.
2. SEE SHEET NO. 1 FOR SURVEY NOTES.

