

SHEET INDEX

# TAMPA HARBOR CUTS J, J2 AND K HILLSBOROUGH COUNTY, FLORIDA EXAMINATION SURVEY FY16 34-FOOT PROJECT

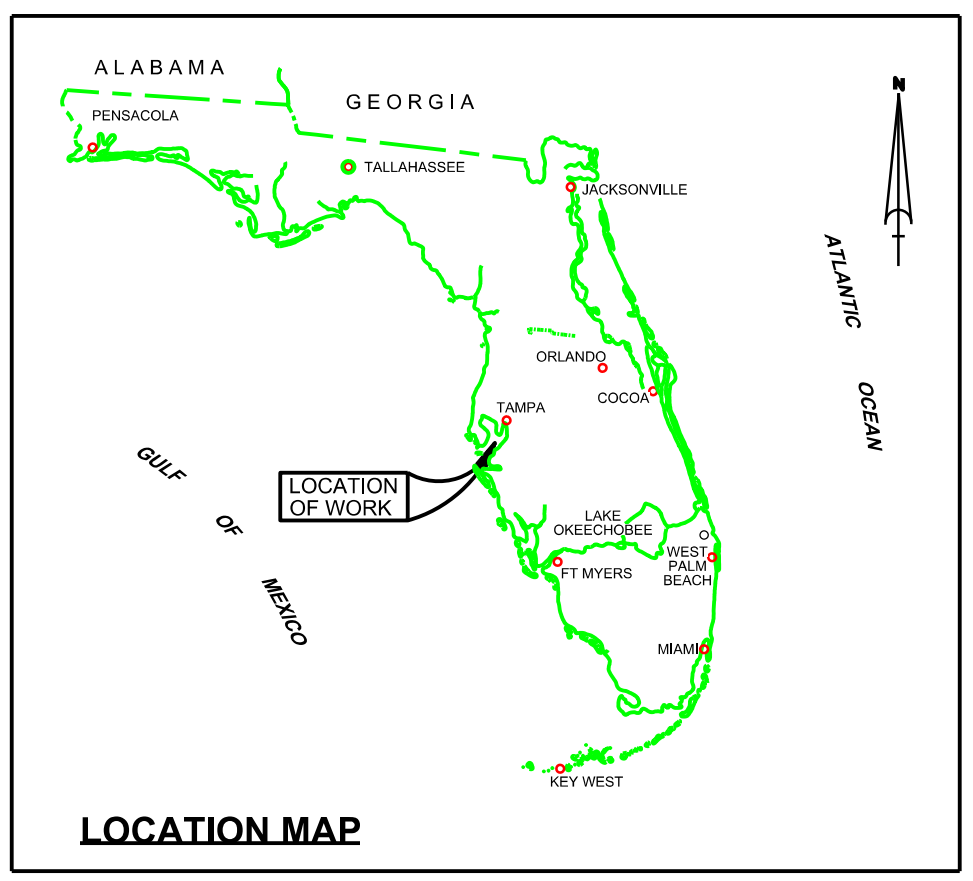

**SURVEY NOTES**

- REFER TO SURVEY NO. 16-082. DATA FOR THIS SURVEY ALSO CAME FROM AFTER-DREDGE SURVEY 15-193.
- SOUNDINGS ARE IN FEET AND TENTHS AND REFER TO THE NOAA REPORTED MLLW TIDAL DATUM RELATIVE TO THE 1983-2001 TIDAL EPOCH.
- TIDAL REDUCTIONS WERE OBTAINED UTILIZING A REAL-TIME KINEMATIC (RTK) GPS AND REFERENCED TO MLLW UTILIZING A HYPACK KINEMATIC TIDE DATUM (KT) MODEL NAMED "SPC-FL-WEST-2010-12-07.KT"
- ALL ELEVATIONS ARE BELOW THE CHART DATUM UNLESS PRECEDED BY A (+) SIGN.
- PLANE COORDINATES ARE BASED ON THE TRANSVERSE MERCATOR PROJECTION FOR THE WEST ZONE OF FLORIDA AND REFERENCED TO NORTH AMERICAN DATUM OF 1983 (NAD83).
- ALL STATIONING REFERS TO THE CENTERLINE OF THE CHANNEL.
- THIS SURVEY WAS PERFORMED USING REAL-TIME KINEMATIC (RTK) GPS POSITIONING WITH THE FOLLOWING REFERENCE BASE LOCATIONS:  
REFERENCE BASE LOCATED AT "DILLMAN" (OPUS PID: BBDC48)  
REFERENCE BASE LOCATED AT "872 6607 D" (OPUS PID: BBDM29)
- DEPTHS DEPICTED BY THIS SURVEY ARE REFERENCED TO MLLW TIDAL EPOCH 1983-2001, AS REPORTED BY THE NATIONAL OCEANIC AND ATMOSPHERIC ADMINISTRATION (NOAA). A MODIFIED VERSION OF NOAA'S DATUM MODEL WAS USED TO CALIBRATE TO THE PUBLISHED MLLW HEIGHTS OF THE BENCH MARKS BELOW:  
NOAA TIDAL STATION 872 6607 D USED FOR CUT-K (PID: BBDM29)  
NOAA TIDAL STATION 872 6520 MONUMENT EDD 60 FOR CUT-J THRU CUT-J2 (PID: AGS298)
- VERTICAL MEASUREMENTS WERE MADE USING AN EDGETECH 6205 COMBINED MULT-BEAM SIDE SCAN SONAR. SOUNDINGS SHOWN ARE IN HIGH FREQUENCY.  

VESSEL	DATE OF SURVEY	CUT
SB JACKSONVILLE	07 APR 2016	CUT-J
SB-44	08 APR 2016	CUT-K
SB JACKSONVILLE	11 APR 2016	CUT-J2
- AIDS TO NAVIGATION WERE LOCATED DURING THIS SURVEY.
- THE INFORMATION DEPICTED ON THIS MAP REPRESENTS THE RESULTS OF SURVEYS MADE ON THE DATES INDICATED ABOVE AND CAN ONLY BE CONSIDERED AS INDICATING THE GENERAL CONDITIONS AT THAT TIME. THIS CHART IS SOLELY FOR THE DISTRIBUTION OF AVAILABLE DEPTHS AT THE TIME OF THE SURVEY.
- SURVEY ACCURACY PERFORMANCE STANDARDS, QUALITY CONTROL, AND QUALITY ASSURANCE REQUIREMENTS WERE FOLLOWED DURING THIS SURVEY IN ACCORDANCE WITH USACE EM 1110-2-1003, HYDROGRAPHIC SURVEYING, 30 NOV 13.

SURVEY ZONE	CUTS
4	CUT-F, CUT-G, GADSDEN POINT CUT
5	CUT-J, CUT-J2, CUT-K
6	CUT-A (HB), CUT-C (HB), CUT-D (HB)
7	LOWER & UPPER SPARKMAN, YBOR CH, SEDDON CH, PORT SUTTON CH, PORT SUTTON T.B., PORT SUTTON TERMINAL CH, EAST BAY CH, EAST BAY EXTENSIONS 1 & 2

LEGEND	
	MONUMENT
	LIGHTED BEACON
	GREEN DAYBEACON
	RED DAYBEACON
	RED LIGHTED BUOY
	GREEN LIGHTED BUOY
	CAN BUOY
	NUN BUOY
	TIDE STAFF
	PROJECT DEPTH

US Army Corps of Engineers  
Jacksonville District  
SAFETY ON THIS JOB DEPENDS ON YOU

DESIGNED BY: WRM  
CHECKED BY: GHR  
DRAWN BY: WRM  
DATE: 00/00/00  
PROJECT: TAMPA HARBOR CUTS J, J2 AND K  
SCALE: AS SHOWN

TAMPA HARBOR HILLSBOROUGH/PINELLAS COUNTIES, FLORIDA  
**HYDROGRAPHIC EXAM SURVEY FY16 34-FOOT PROJECT**  
INDEX, LOCATION AND VICINITY MAP

DEPARTMENT OF THE ARMY  
JACKSONVILLE DISTRICT, CORPS OF ENGINEERS  
JACKSONVILLE, FLORIDA

Scale: AS SHOWN  
Drawing no. **1**  
SHEET 01 OF 11

AIDS TO NAVIGATION	PLANE COORDINATES		LATITUDE	LONGITUDE
	X	Y		
BUOY-7G(0416)	472495	1257528	27°47'21.70"	82°41'00.52"
BUOY-8G(0416)	472528	1257039	27°47'23.66"	82°41'00.29"
BUOY-10J(0416)	471633	1257820	27°47'35.23"	82°41'14.75"

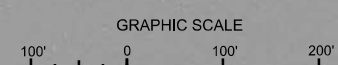

NOTES:  
1. REFER TO SURVEY NO. 16-092.  
2. SEE SHEET NO. 1 FOR SURVEY NOTES.

DEPARTMENT OF THE ARMY  
JACKSONVILLE DISTRICT, CORPS OF ENGINEERS  
JACKSONVILLE, FLORIDA

Checked By: <b>GHK</b>
Designed By: <b>VRM</b>
Drawn By: <b>VRM</b>
In Use: <b>DD/WW/YYYY</b>
Reference File: <b>16-092-GS-BRIDG.DGN</b>
File Name: <b>16-092-H402_Z.DGN</b>

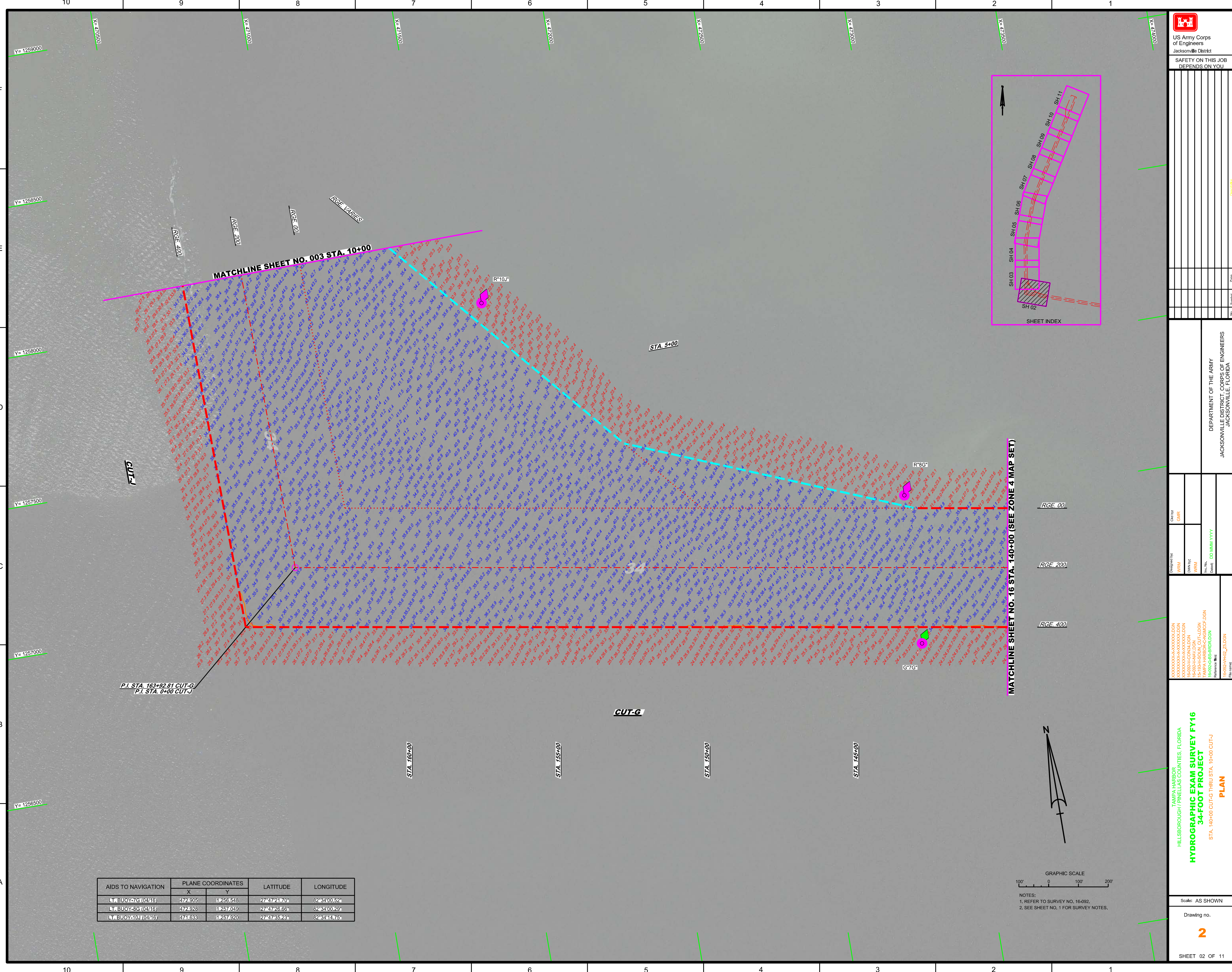
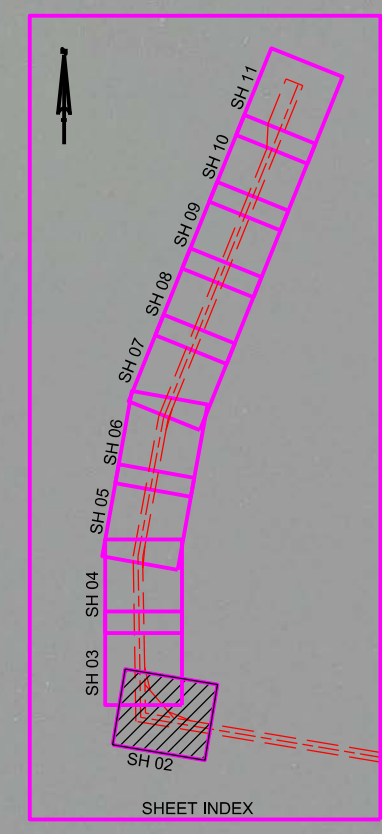

MATCHLINE SHEET NO. 003 STA. 10+00

MATCHLINE SHEET NO. 16 STA. 140+00 (SEE ZONE 4 MAP SET)

CUT-G

P.I. STA. 163+92.81 CUT-G  
P.I. STA. 0+00 CUT-J

STA. 160+00

STA. 155+00

STA. 150+00

STA. 145+00

RGE 00

RGE 200

RGE 400

STA. 5+00

R10J

R9G

G7G

Y=1259000

Y=1258500

Y=1258000

Y=1257500

Y=1257000

Y=1256500

10

9

8

7

6

5

4

3

2

1

F

E

D

C

B

A

F

E

D

C

B

A

**US Army Corps of Engineers**  
Jacksonville District

SAFETY ON THIS JOB  
DEPENDS ON YOU

DEPARTMENT OF THE ARMY  
JACKSONVILLE DISTRICT, CORPS OF ENGINEERS  
JACKSONVILLE, FLORIDA

Checked By: GHR  
Designed By: WRM  
Drawn By: WRM  
Title: DD-MM-YYYY  
Graphic: DD-MM-YYYY

TAMPA HARBOR  
HILLSBOROUGH / PINELLAS COUNTIES, FLORIDA  
**HYDROGRAPHIC EXAM SURVEY FY16  
34-FOOT PROJECT**  
STA. 10+00 THRU STA. 40+00 CUT-J  
**PLAN**

Scale: AS SHOWN  
Drawing no. **3**  
SHEET 03 OF 11

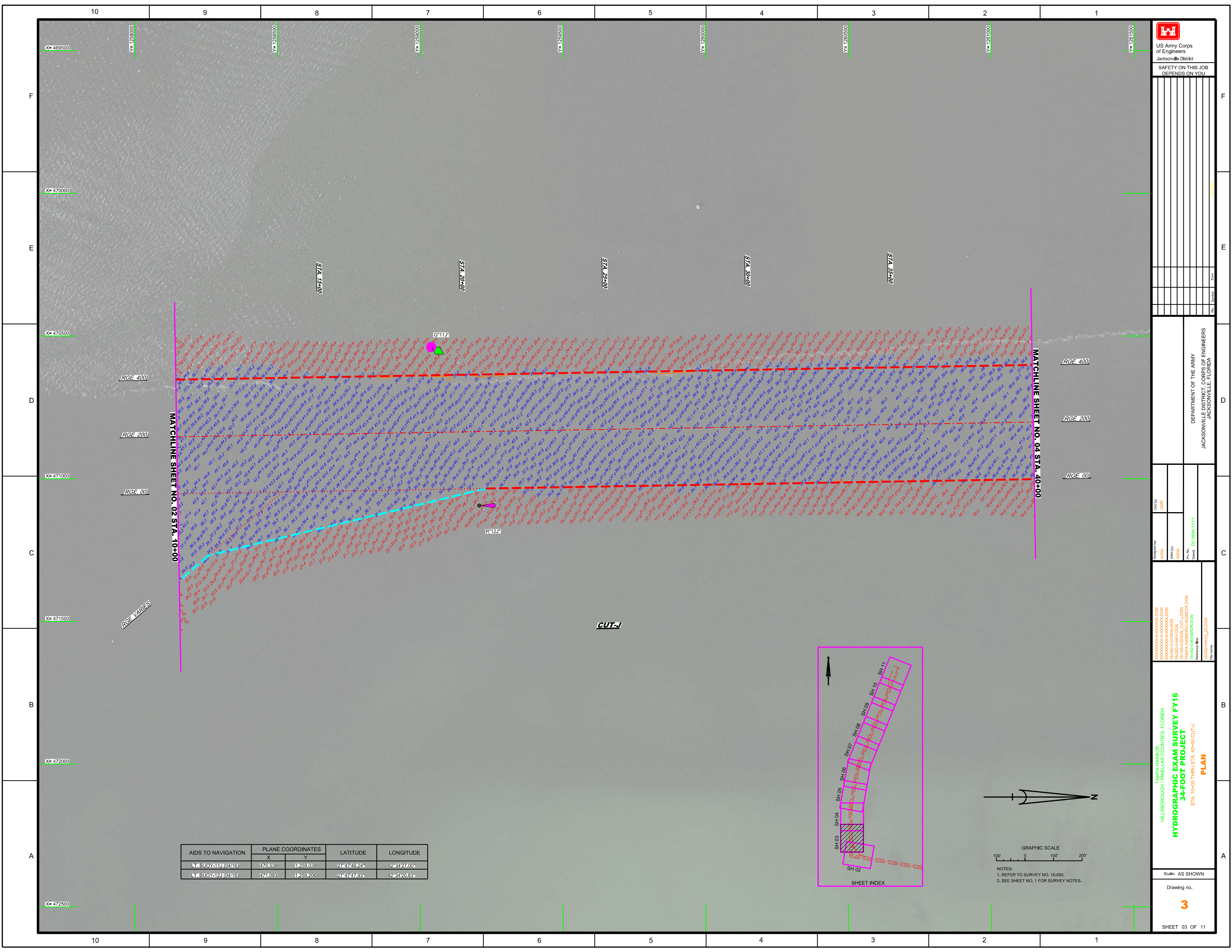

AIDS TO NAVIGATION	PLANE COORDINATES		LATITUDE	LONGITUDE
	X	Y		
L BUOY 51N (0416)	470538	1259038	27°47'46.24"	82°42'27.00"
L BUOY 51S (0416)	474093	1259206	27°47'41.95"	82°42'20.83"

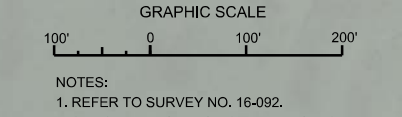



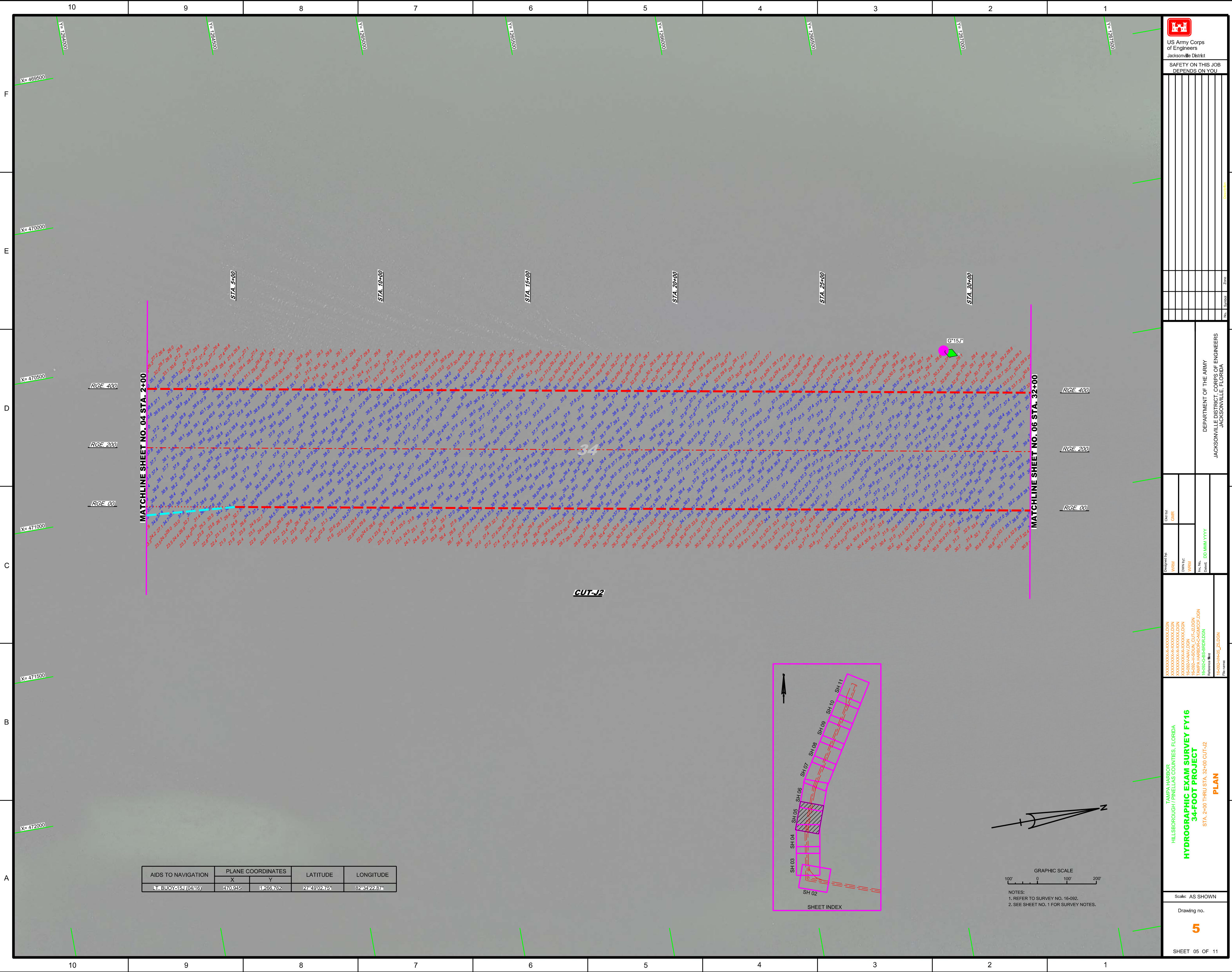

MATCHLINE SHEET NO. 04 STA. 2+00

MATCHLINE SHEET NO. 06 STA. 32+00

RGE 400

RGE 200

RGE 00

RGE 400

RGE 200

RGE 00

STA 5+00

STA 10+00

STA 15+00

STA 20+00

STA 25+00

STA 30+00

**CUT-12**

G\*15J

X=469500

X=470000

X=470500

X=471000

X=471500

X=472000

F

E

D

C

B

A

F

E

D

C

B

A

AIDS TO NAVIGATION	PLANE COORDINATES		LATITUDE	LONGITUDE
	X	Y		
L <sub>1</sub> BUOY 15J (0416)	470345	1268762	27°49'02.75"	82°34'22.87"

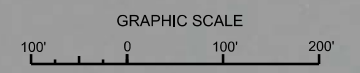
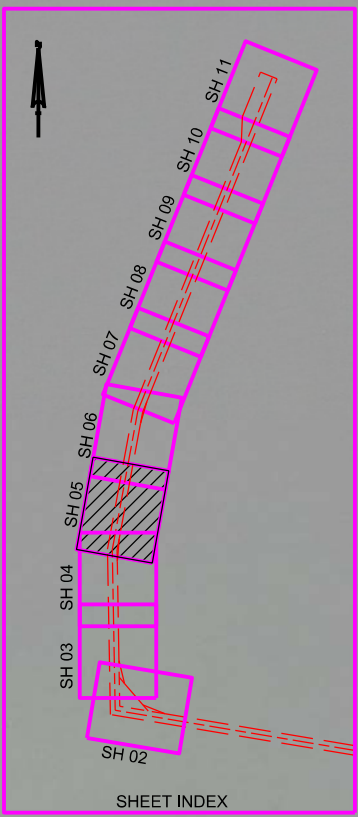

NOTES:  
 1. REFER TO SURVEY NO. 16-092.  
 2. SEE SHEET NO. 1 FOR SURVEY NOTES.

Designed by: WRM	Check by: GHR
Drawn by: WRM	
File No. 16-092-C-BB-BIRDSON	
Contract DDMMYYYY	

TAMPABAY \ HILLSBOROUGH \ PINELLAS COUNTIES, FLORIDA  
**HYDROGRAPHIC EXAM SURVEY FY16**  
**34-FOOT PROJECT**  
 STA. 2+00 THRU STA. 32+00 CUT-12  
**PLAN**

Scale: AS SHOWN

Drawing no.

**5**

SHEET 05 OF 11

DEPARTMENT OF THE ARMY  
 JACKSONVILLE DISTRICT, CORPS OF ENGINEERS  
 JACKSONVILLE, FLORIDA



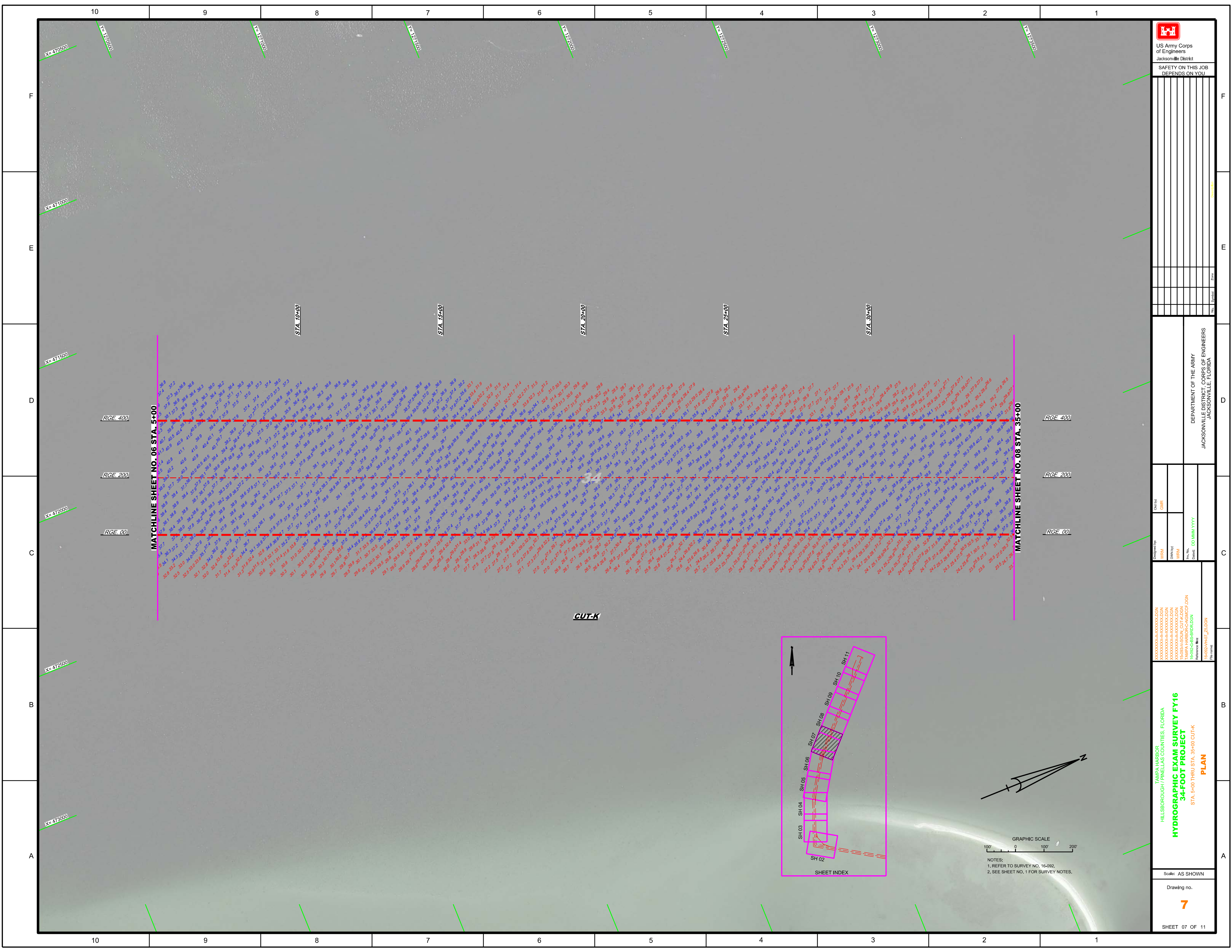



  
 US Army Corps of Engineers  
 Jacksonville District  
 SAFETY ON THIS JOB  
 DEPENDS ON YOU

DEPARTMENT OF THE ARMY  
 JACKSONVILLE DISTRICT, CORPS OF ENGINEERS  
 JACKSONVILLE, FLORIDA

Drawn by: GHR  
 Checked: DO/AMM/YYY

TAMPABOROUGH/PINELLAS COUNTIES, FLORIDA  
 HYDROGRAPHIC EXAM SURVEY FY16  
 34-FOOT PROJECT  
 STA. 5+00 THRU STA. 35+00 CUT-K  
 PLAN

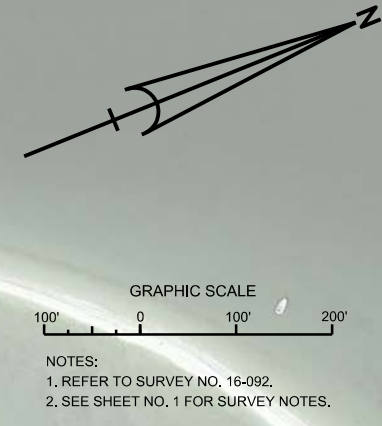
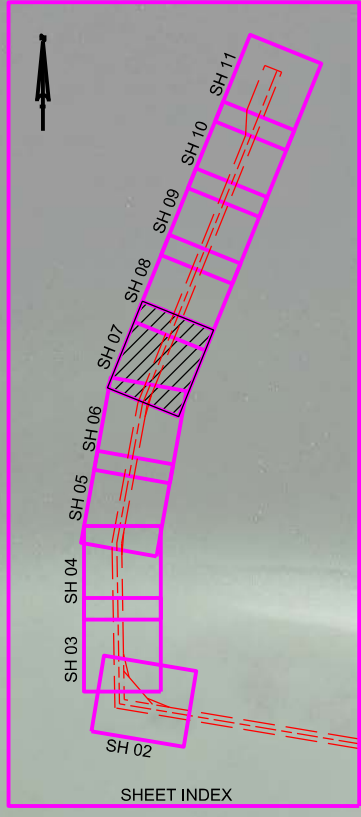
Scale: AS SHOWN  
 Drawing no. **7**  
 SHEET 07 OF 11



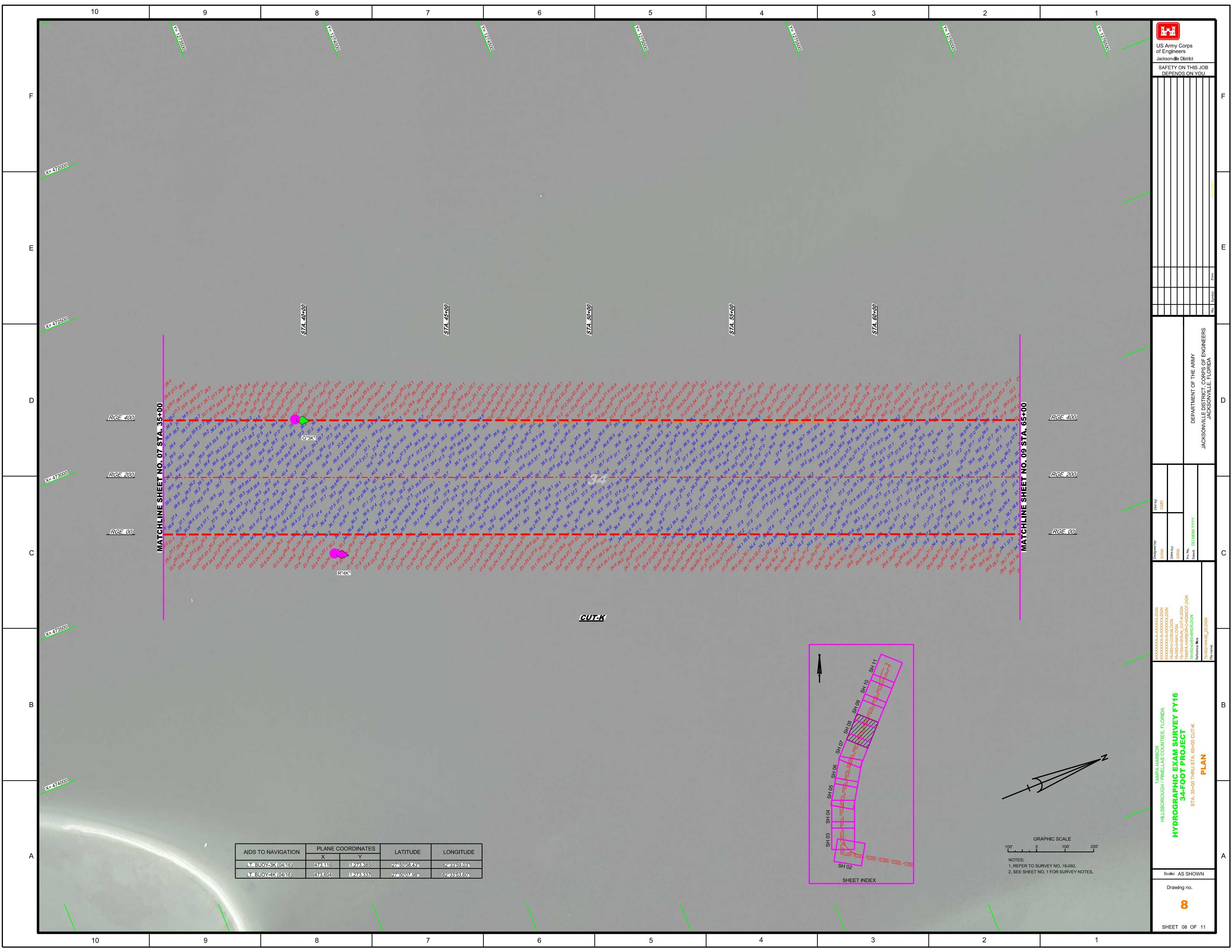

MATCHLINE SHEET NO. 07 STA. 35+00

MATCHLINE SHEET NO. 09 STA. 65+00

STA. 40+00

STA. 45+00

STA. 50+00

STA. 55+00

STA. 60+00

AIDS TO NAVIGATION	PLANE COORDINATES		LATITUDE	LONGITUDE
	X	Y		
LT. BUOY-3K (0416)	478.116	11278.385	27°50'08.43"	82°33'53.03"
LT. BUOY-4K (0416)	478.604	11278.337	27°50'07.89"	82°33'53.60"

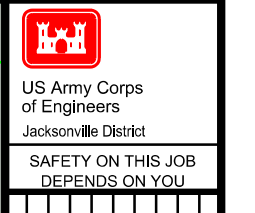
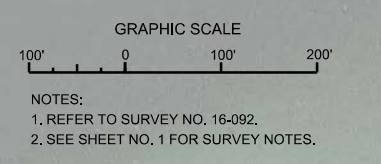
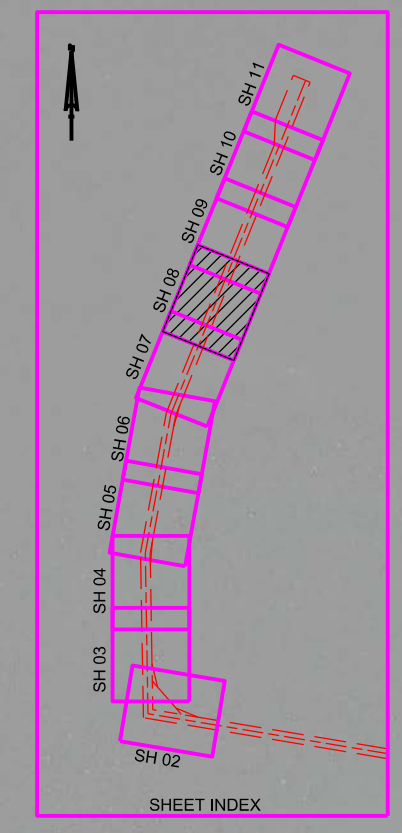

DEPARTMENT OF THE ARMY  
JACKSONVILLE DISTRICT, CORPS OF ENGINEERS  
JACKSONVILLE, FLORIDA

Designed by: VPM  
Checked by: GHR  
Drawn by: VPM  
Field Notes: TAMPA HARBOR-CANAL-CDON  
Reference files: H-6925-HAR-25.DGN

TAMPA HARBOR  
HILLSBOROUGH/PINELLAS COUNTIES, FLORIDA  
**HYDROGRAPHIC EXAM SURVEY FY16**  
**34-FOOT PROJECT**  
STA. 35+00 THRU STA. 65+00 CUT-K  
**PLAN**



AIDS TO NAVIGATION	PLANE COORDINATES		LATITUDE	LONGITUDE
	X	Y		
LT BUOY-5K (0416)	474,632	11277,232	27°50'46.59"	82°33'42.84"
LT BUOY-6K (0416)	475,044	11277,016	27°50'44.47"	82°33'37.74"

