

# U.S. NAVY SUBMARINE BASE KINGS BAY, GEORGIA KINGS BAY INNER CHANNEL BIMONTHLY EXAMINATION SURVEY - JULY 2015

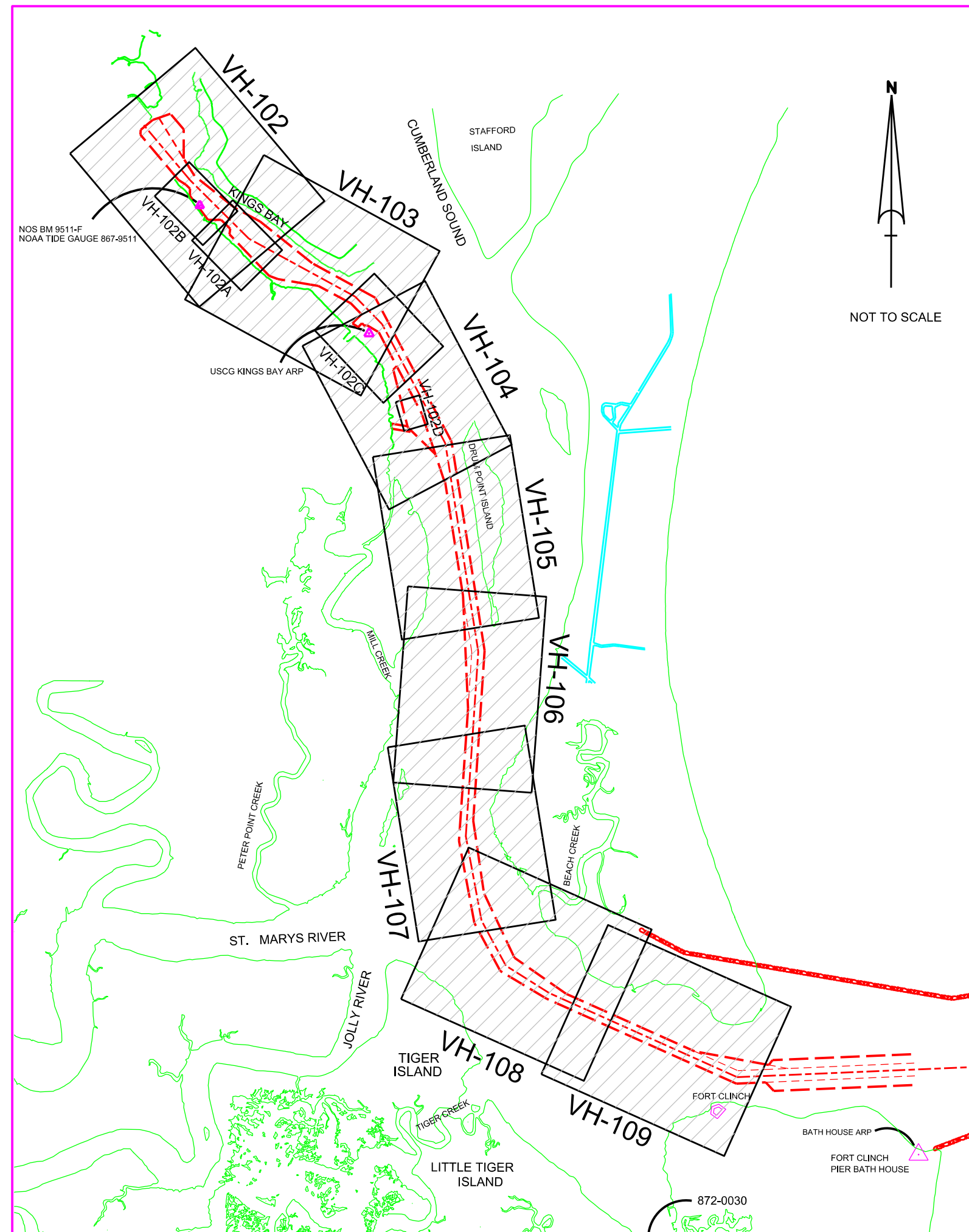

LEGEND	
	MONUMENT
	LIGHTED BEACON
	GREEN DAY BEACON
	RED DAY BEACON
	RED LIGHTED BUOY
	GREEN LIGHTED BUOY
	CAN BUOY
	NUN BUOY
	TIDE STAFF
	MAJOR CONTOUR
	MINOR CONTOUR
	MAJOR DEPRESSION
	MINOR DEPRESSION

DEPTH COLOR CODE	
≤ 39.9	
40.0 - 41.9	
42.0 - 45.9	
46.0 - 48.9	
≥ 49.0	



**SURVEY NOTES:**

- REFER TO SURVEY NO. 15-161. ALSO SHOWN IN THIS SURVEY ARE SOUNDINGS FROM BEFORE-DREDGE SURVEY NO. 15-092 AND AFTER-DREDGE SURVEY NO. 15-093.
- SOUNDINGS ARE IN FEET AND TENTHS AND REFER TO MEAN LOWER LOW WATER (MLLW) TIDAL DATUM.
- ALL ELEVATIONS ARE BELOW THE CHART DATUM UNLESS PRECEDED BY A (+) SIGN.
- TIDAL REDUCTIONS WERE OBTAINED UTILIZING REAL-TIME KINEMATIC (RTK) GPS USING A HYPACK KINEMATIC TIDAL DATUM MODEL (KINGSBAY-2013 06 26.KTD).
- PLANE COORDINATES ARE BASED ON THE TRANSVERSE MERCATOR PROJECTION FOR THE EAST ZONE OF GEORGIA AND REFERENCED TO NORTH AMERICAN DATUM OF 1983 (NAD83).
- ALL STATIONING REFERS TO THE CENTERLINE OF THE CHANNEL.
- THIS SURVEY WAS PERFORMED USING REAL-TIME KINEMATIC (RTK) GPS POSITIONING WITH THE FOLLOWING REFERENCE BASE LOCATIONS:  
 REFERENCE BASE LOCATED AT "BATH HOUSE ARP" (OPUS PID # BBCK08), FOR RANGE-A THRU RANGE-C.  
 REFERENCE BASE LOCATED AT "USCG KINGS BAY ARP" (OPUS PID # BBDK29), FOR RANGE-D THRU RANGE-I.
- DEPTHS DEPICTED BY THIS SURVEY ARE REFERENCED TO MLLW, AS REPORTED BY THE NATIONAL OCEANIC AND ATMOSPHERIC ADMINISTRATION (NOAA). NOAA'S VDATUM MODEL WAS USED AND CALIBRATED TO THE PUBLISHED MLLW HEIGHTS OF THE BENCH MARKS ASSOCIATED WITH THE TIDE GAUGE SITES SPECIFIED BELOW:  
 NOAA TIDAL STATION 872-0030, FERNANDINA, FL, FOR RANGE-A THRU RANGE-G (OUTSIDE WRA)  
 NOAA TIDAL STATION 867-9511, KINGS BAY, GA, FOR RGE-G THRU RGE-I (INSIDE WRA)
- VERTICAL MEASUREMENTS WERE MADE USING A RESON MODEL 7101 MULTIBEAM SYSTEM AND A ROSS MODEL 835C SMARTSOUNDER WITH A DUAL-FREQUENCY (28/200KHZ) TRANSDUCER. SOUNDINGS SHOWN ARE IN HIGH FREQUENCY FROM RANGE-A THRU RANGE-D, SITE-6, MSF, EHW-1 AND WARPING WHARF AND LOW FREQUENCY FROM RANGE-E THRU RANGE-I.

VESSEL	DATE OF SURVEY	AREA SURVEYED
SB-36	15 JUN 2015	REFIT WHARFS
SB-36	14 JUL 2015	MSF
SB-36	29 JUL 2015	RGE-G, STA 39+100 THRU 41+900
SB-36	30 JUL 2015	SITE-6 & RANGE-F
SB-36	30-31 JUL 2015	RGE-E, STA 30+748 TO 35+999
SB-36	31 JUL 2015	RGE-G, STA 37+504 TO 39+000
SB-36	1 AUG 2015	RGE-A THRU RGE-A2, STA 12+005
SB-36	2 AUG 2015	RGE-B THRU RGE-C, STA 22+547
SB-36	3 AUG 2015	EHW-1 & WARPING WHARF
SB-36	5 AUG 2015	RGE-D, STA 22+547 TO 30+748
SB-36	7 AUG 2015	RGE-I, STA 47+000 TO 48+175
SB-36	15 AUG 2015	RGE-G, STA 42+00 THRU RGE-I, STA 46+900

- AIDS TO NAVIGATION WERE LOCATED DURING THIS SURVEY.
- THE INFORMATION DEPICTED ON THIS MAP REPRESENTS THE RESULTS OF SURVEYS MADE ON THE DATES INDICATED ABOVE AND CAN ONLY BE CONSIDERED AS INDICATING THE GENERAL CONDITIONS AT THAT TIME. THIS CHART IS SOLELY FOR THE DISTRIBUTION OF AVAILABLE DEPTHS AT THE TIME OF THE SURVEY AND IS NOT TO BE USED FOR NAVIGATION.
- SURVEY ACCURACY PERFORMANCE STANDARDS, QUALITY CONTROL, AND QUALITY ASSURANCE REQUIREMENTS WERE FOLLOWED IN ACCORDANCE WITH USACE EM 1110-2-1003, HYDROGRAPHIC SURVEYING, 30 NOV 2013 AND EM 1110-2-6056, STANDARDS AND PROCEDURES FOR REFERENCING PROJECT ELEVATION GRADES TO NATIONWIDE VERTICAL DATUMS, 31 DEC 2010.

US Army Corps of Engineers  
Jacksonville District

SAFETY ON THIS JOB  
DEPENDS ON YOU

---

DEPARTMENT OF THE ARMY  
JACKSONVILLE DISTRICT, CORPS OF ENGINEERS  
JACKSONVILLE, FLORIDA

---

INDEX LOGBOOK  
5-16 I-65-BR-10-10-10  
Reference Sheet  
15-16 I-65-BR-10-10-10  
15-16 I-65-BR-10-10-10

---

U.S. NAVY INNER CHANNEL  
KINGS BAY, GEORGIA

**BIMONTHLY EXAMINATION SURVEY - JUL 2015**  
**44, 45 & 46-FOOT PROJECT**

INDEX, LOCATION AND VICINITY  
**MAP**

---

Scale: AS SHOWN

Drawing no.  
**V-101**

SHEET 01 OF 12

**Big Crab Island Disposal Area**

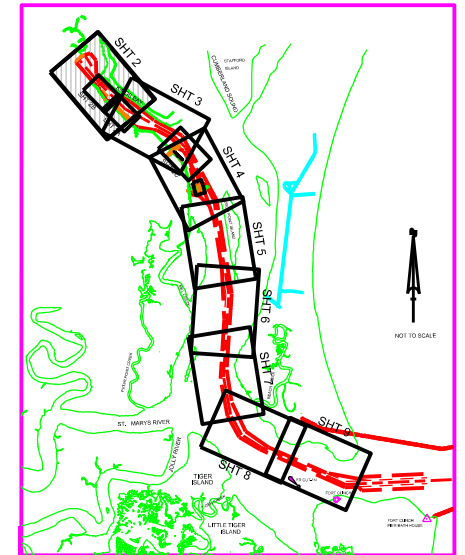
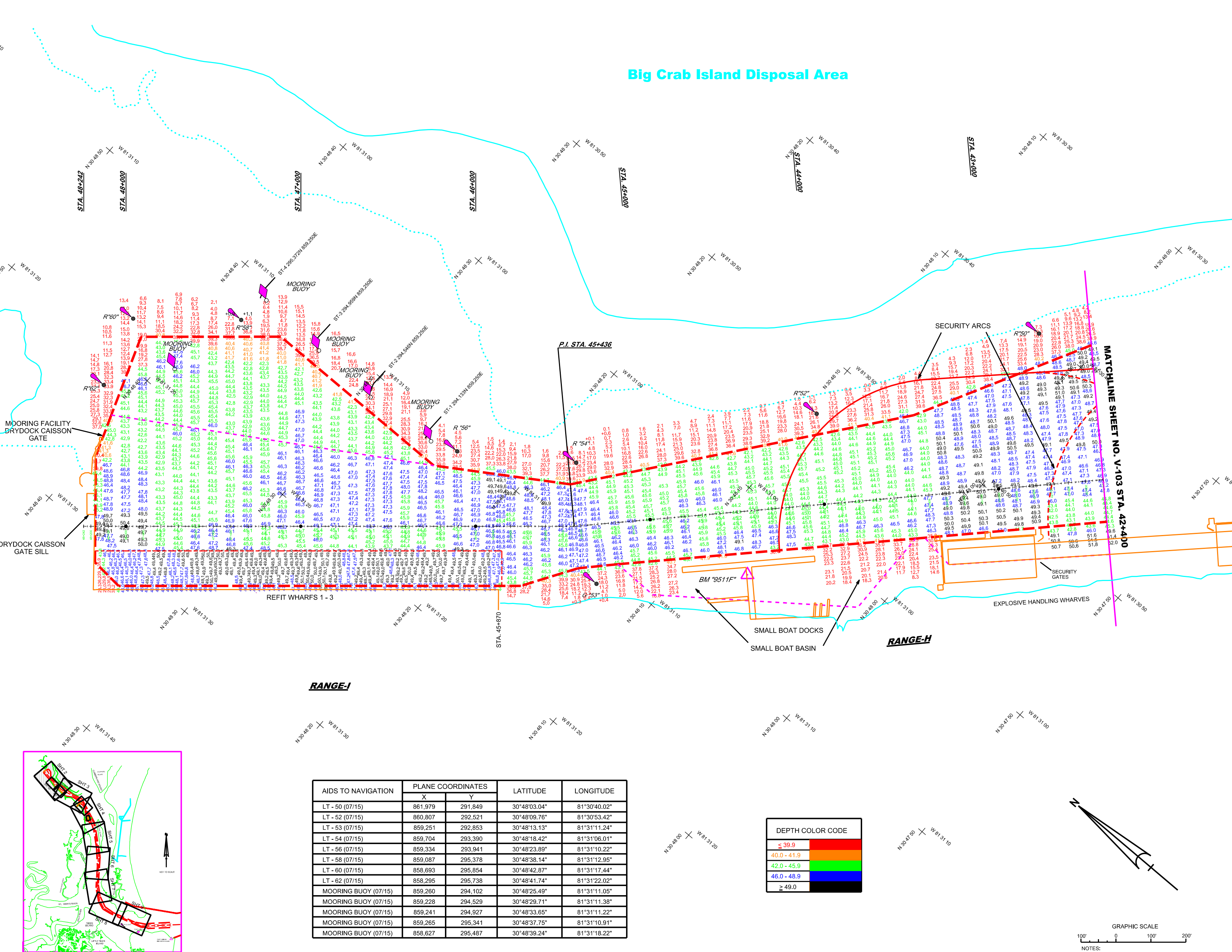

AIDS TO NAVIGATION	PLANE COORDINATES		LATITUDE	LONGITUDE
	X	Y		
LT - 50 (07/15)	861,979	291,849	30°48'03.04"	81°30'40.02"
LT - 52 (07/15)	860,807	292,521	30°48'09.76"	81°30'53.42"
LT - 53 (07/15)	859,251	292,853	30°48'13.13"	81°31'11.24"
LT - 54 (07/15)	859,704	293,390	30°48'18.42"	81°31'06.01"
LT - 56 (07/15)	859,334	293,941	30°48'23.89"	81°31'10.22"
LT - 58 (07/15)	859,087	295,378	30°48'38.14"	81°31'12.95"
LT - 60 (07/15)	858,693	295,854	30°48'42.87"	81°31'17.44"
LT - 62 (07/15)	858,295	295,738	30°48'41.74"	81°31'22.02"
MOORING BUOY (07/15)	859,260	294,102	30°48'25.49"	81°31'11.05"
MOORING BUOY (07/15)	859,228	294,529	30°48'29.71"	81°31'11.38"
MOORING BUOY (07/15)	859,241	294,927	30°48'33.65"	81°31'11.22"
MOORING BUOY (07/15)	859,265	295,341	30°48'37.75"	81°31'10.91"
MOORING BUOY (07/15)	858,627	295,487	30°48'39.24"	81°31'18.22"

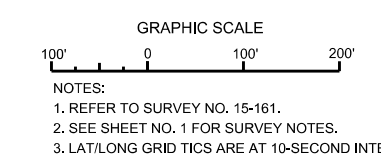
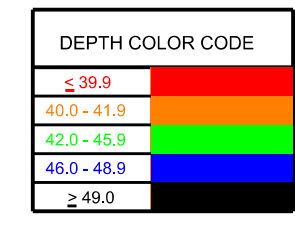













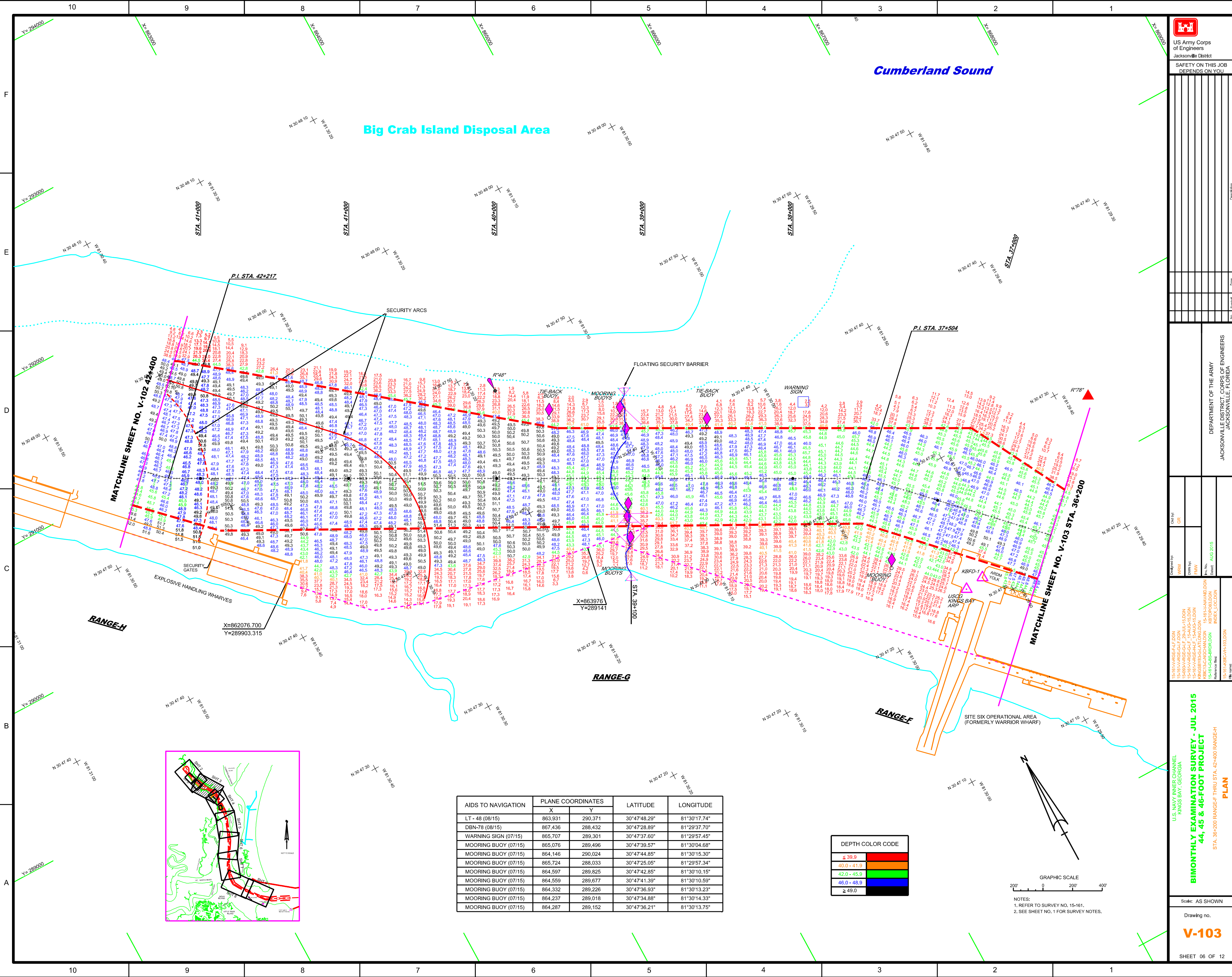

AIDS TO NAVIGATION	PLANE COORDINATES	LATITUDE	LONGITUDE	
	X	Y		
LT - 48 (08/15)	863,931	290,371	30°47'48.29"	81°30'17.74"
DBN-78 (08/15)	867,436	288,432	30°47'28.89"	81°29'37.70"
WARNING SIGN (07/15)	865,707	289,301	30°47'37.60"	81°29'57.45"
MOORING BUOY (07/15)	865,076	289,496	30°47'39.57"	81°30'04.68"
MOORING BUOY (07/15)	864,146	290,024	30°47'44.85"	81°30'15.30"
MOORING BUOY (07/15)	865,724	288,033	30°47'25.05"	81°29'57.34"
MOORING BUOY (07/15)	864,597	289,825	30°47'42.85"	81°30'10.15"
MOORING BUOY (07/15)	864,559	289,677	30°47'41.39"	81°30'10.59"
MOORING BUOY (07/15)	864,332	289,226	30°47'36.93"	81°30'13.23"
MOORING BUOY (07/15)	864,237	289,018	30°47'34.88"	81°30'14.33"
MOORING BUOY (07/15)	864,287	289,152	30°47'36.21"	81°30'13.75"

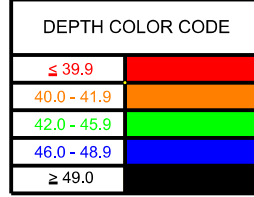

GRAPHIC SCALE  
0 200' 400'

NOTES:  
1. REFER TO SURVEY NO. 15-161.  
2. SEE SHEET NO. 1 FOR SURVEY NOTES.



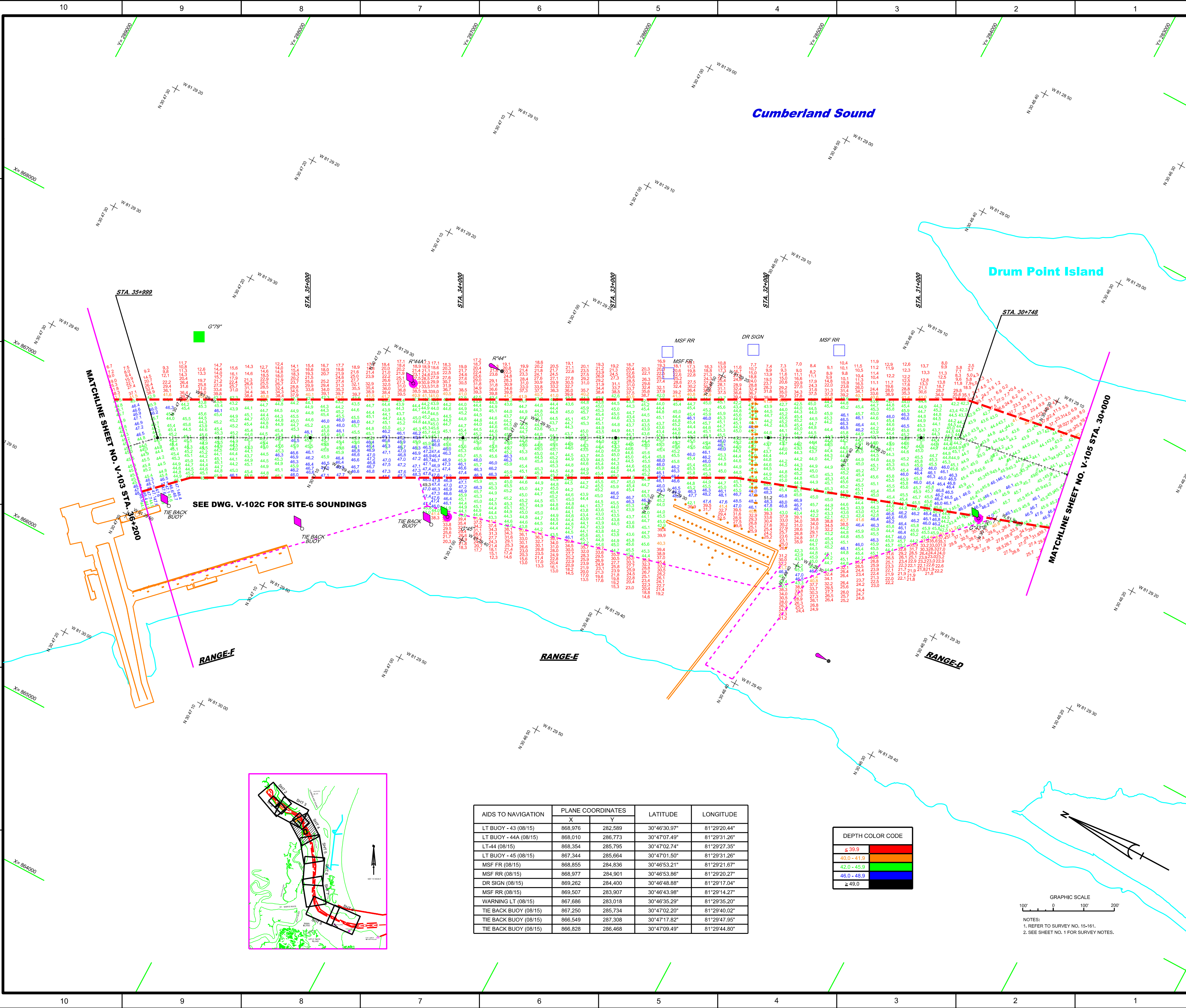

AIDS TO NAVIGATION	PLANE COORDINATES		LATITUDE	LONGITUDE
	X	Y		
LT BUOY - 43 (08/15)	868,976	282,589	30°46'30.97"	81°29'20.44"
LT BUOY - 44A (08/15)	868,010	286,773	30°47'07.49"	81°29'31.26"
LT-44 (08/15)	868,354	285,795	30°47'02.74"	81°29'27.35"
LT BUOY - 45 (08/15)	867,344	285,664	30°47'01.50"	81°29'31.26"
MSF RR (08/15)	868,855	284,836	30°46'53.21"	81°29'21.67"
MSF RR (08/15)	868,977	284,901	30°46'53.86"	81°29'20.27"
DR SIGN (08/15)	869,262	284,400	30°46'48.88"	81°29'17.04"
MSF RR (08/15)	869,507	283,907	30°46'43.98"	81°29'14.27"
WARNING LT (08/15)	867,686	283,018	30°46'35.29"	81°29'35.20"
TIE BACK BUOY (08/15)	867,250	285,734	30°47'02.20"	81°29'40.02"
TIE BACK BUOY (08/15)	866,549	287,308	30°47'17.82"	81°29'47.95"
TIE BACK BUOY (08/15)	866,828	286,468	30°47'09.49"	81°29'44.80"

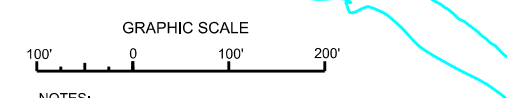
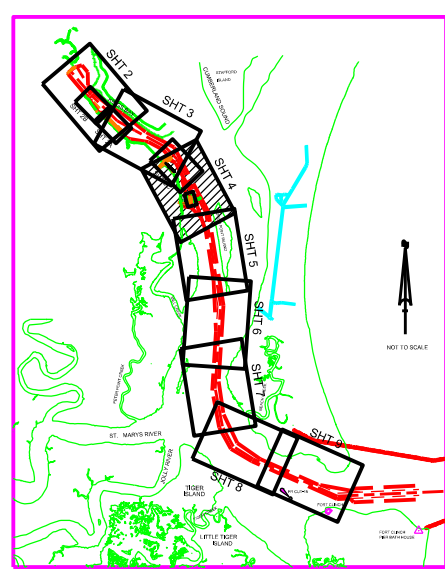
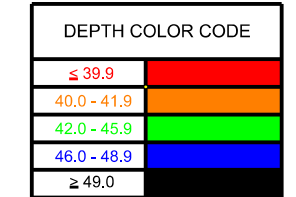

NOTES:  
1. REFER TO SURVEY NO. 15-161.  
2. SEE SHEET NO. 1 FOR SURVEY NOTES.











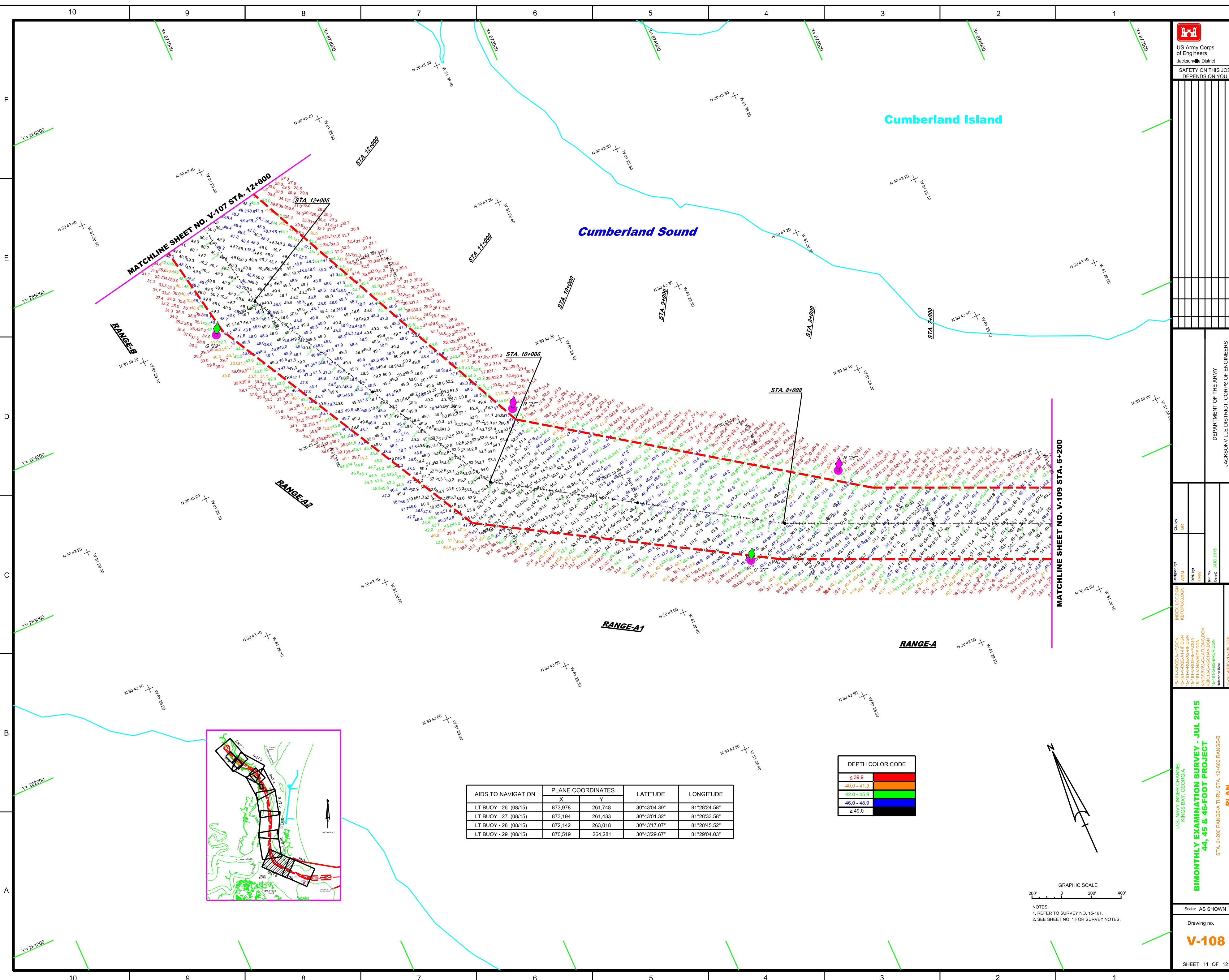

AIDS TO NAVIGATION	PLANE COORDINATES		LATITUDE	LONGITUDE
	X	Y		
LT BUOY - 26 (08/15)	873,978	261,748	30°43'04.39"	81°28'24.58"
LT BUOY - 27 (08/15)	873,194	261,433	30°43'01.32"	81°28'33.58"
LT BUOY - 28 (08/15)	872,142	263,018	30°43'17.07"	81°28'45.52"
LT BUOY - 29 (08/15)	870,519	264,281	30°43'29.67"	81°29'04.03"

DEPTH COLOR CODE	
≤ 39.9	Red
40.0 - 41.9	Orange
42.0 - 45.9	Yellow
46.0 - 49.9	Green
≥ 49.0	Blue

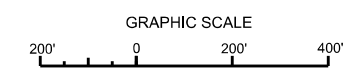
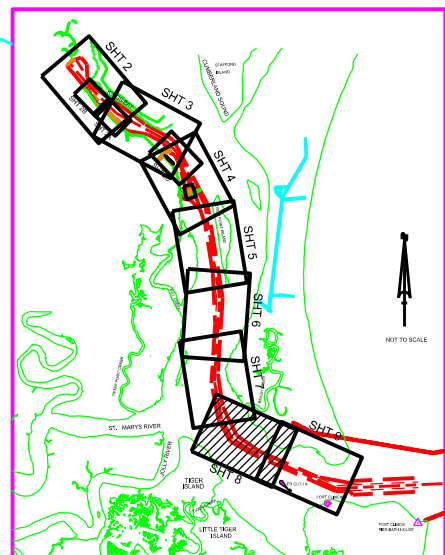

NOTES:  
1. REFER TO SURVEY NO. 15-161.  
2. SEE SHEET NO. 1 FOR SURVEY NOTES.

