

US Army Corps
of Engineers
Jacksonville District

SAFETY ON THIS JOB
DEPENDS ON YOU

No.	Symbol	Name

DEPARTMENT OF THE ARMY
JACKSONVILLE DISTRICT, CORPS OF ENGINEERS
JACKSONVILLE, FLORIDA

Checked by	GR

Designed by	DRM
Checked by	GR
DRAWN BY	WRM
DATE	DD MM YYYY
DATE	DD MM YYYY

TAMPA HARBOR
HILLSBOROUGH COUNTY, FLORIDA
**HYDROGRAPHIC EXAM SURVEY FY15
43-FOOT PROJECT**
STA. 169+00 THRU STA. 199+00 MULLET KEY CHANNEL
PLAN

Scale: AS SHOWN
Drawing no.
8
SHEET 08 OF 22

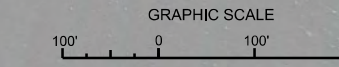
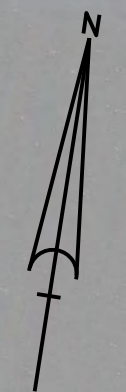

NOTES:
1. REFER TO SURVEY NO. 14-170.
2. SEE SHEET NO. 1 FOR SURVEY NOTES.

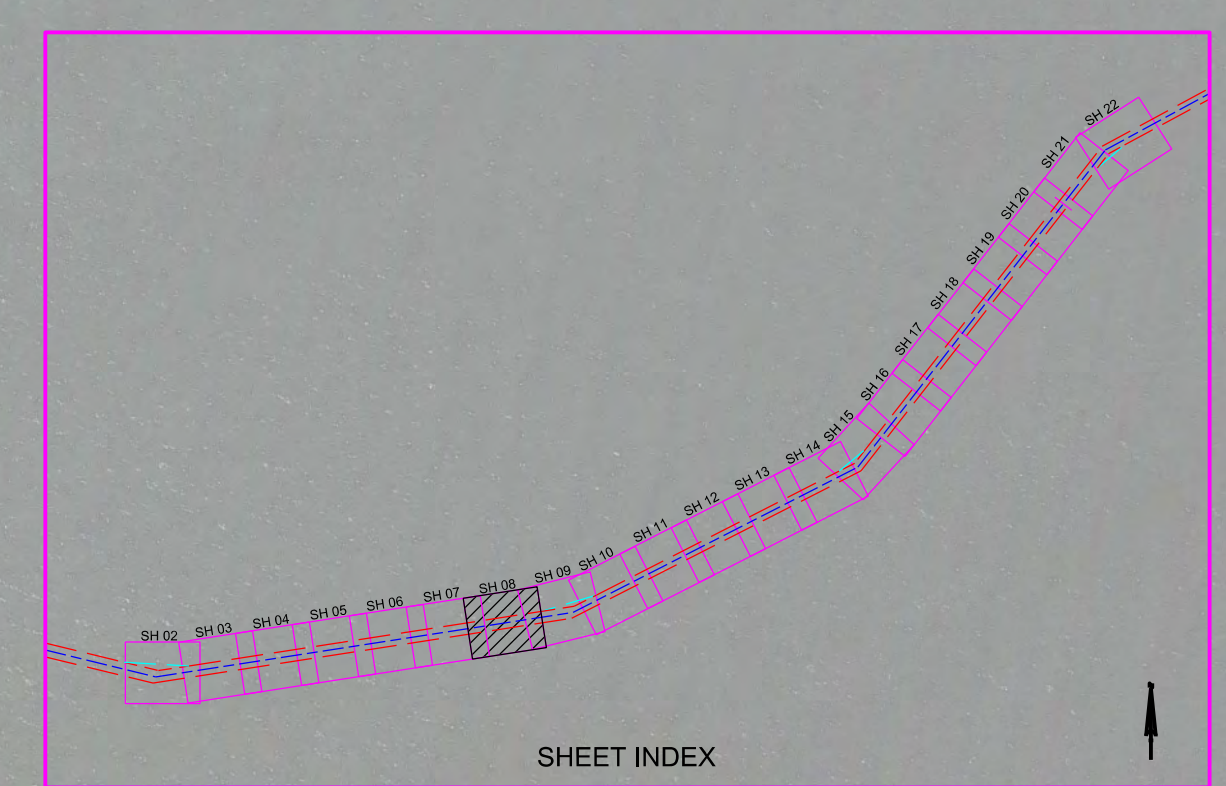

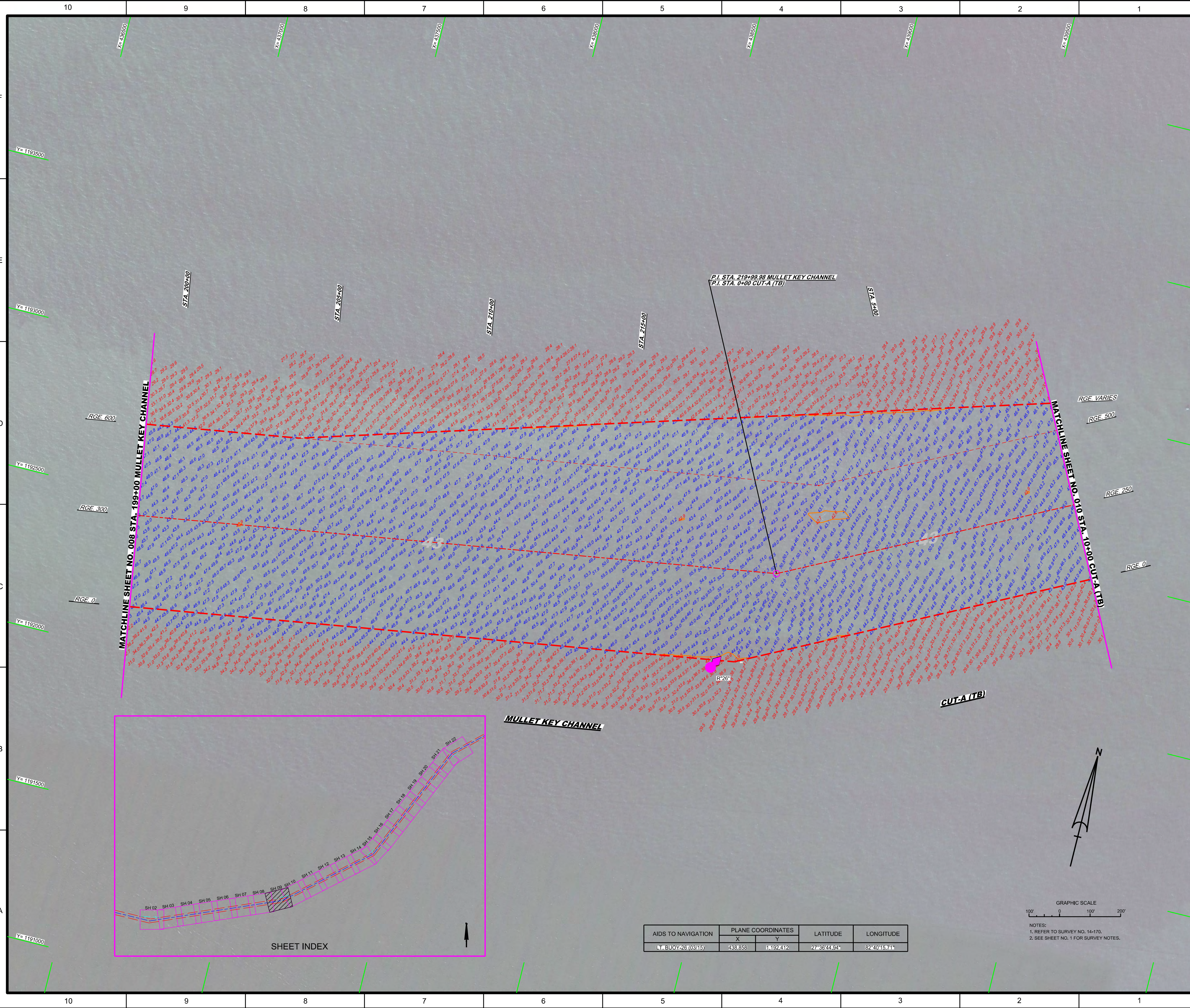

MULLET KEY CHANNEL

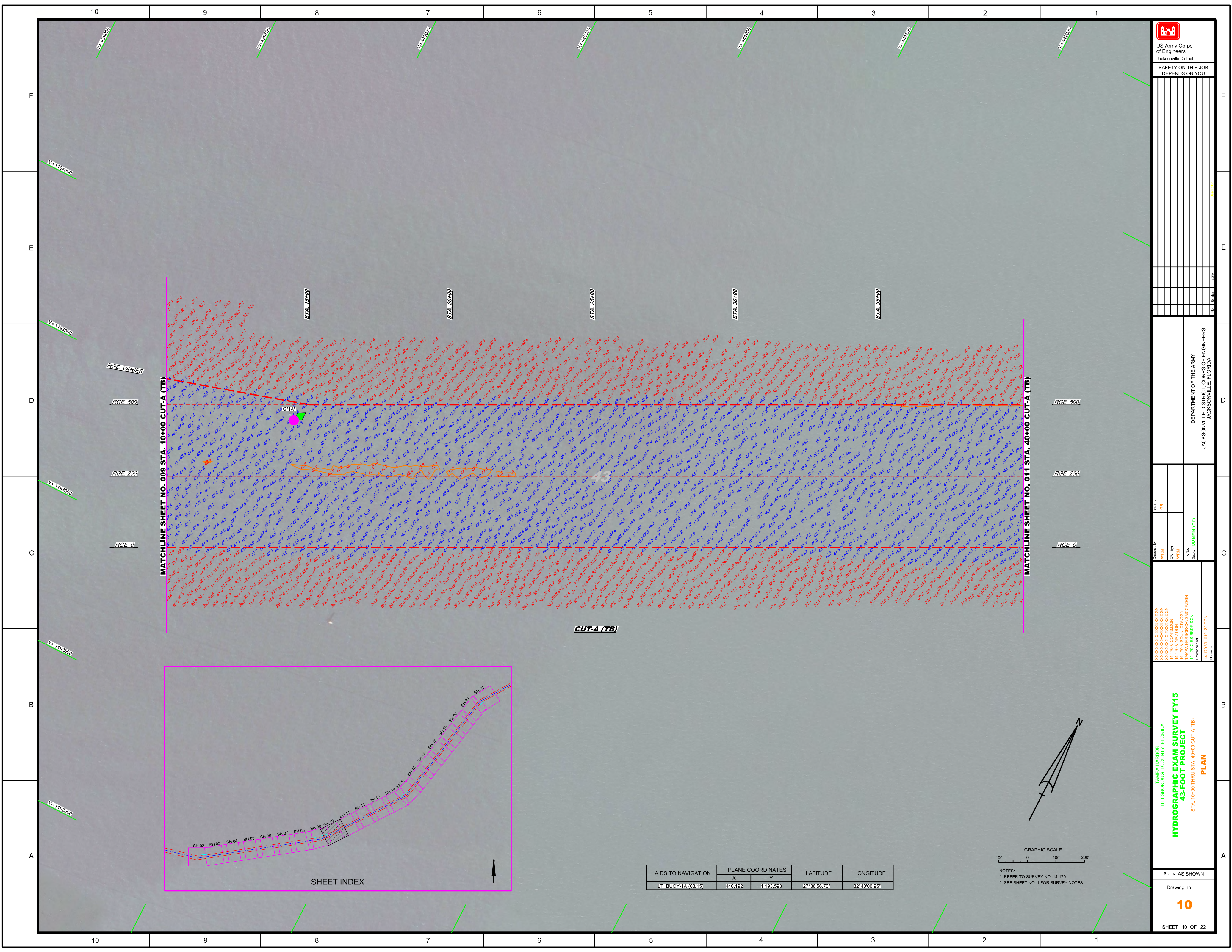

AIDS TO NAVIGATION	PLANE COORDINATES		LATITUDE	LONGITUDE
	X	Y		
LT. BUOY-26 (03/15)	438.858	1192.412	27°38'44.94"	82°40'15.71"

NOTES:
1. REFER TO SURVEY NO. 14-170.
2. SEE SHEET NO. 1 FOR SURVEY NOTES.





 US Army Corps of Engineers
 Jacksonville District
 SAFETY ON THIS JOB
 DEPENDS ON YOU

DEPARTMENT OF THE ARMY
 JACKSONVILLE DISTRICT, CORPS OF ENGINEERS
 JACKSONVILLE, FLORIDA

Call by: GRL
 Designed by: WRM
 Drawn by: WRM
 In Charge: DO/WW/YYY
 Reference files:
 H:\1704\H01\Z\LDN
 H:\1704\H01\Z\LDN

TAMPA HARBOR
 HILLSBOROUGH COUNTY, FLORIDA
HYDROGRAPHIC EXAM SURVEY FY15
43-FOOT PROJECT
 STA. 10+00 THRU STA. 40+00 CUT-A (TB)
PLAN

Scale: AS SHOWN
 Drawing no.
10
 SHEET 10 OF 22

MATCHLINE SHEET NO. 009 STA. 10+00 CUT-A (TB)

MATCHLINE SHEET NO. 011 STA. 40+00 CUT-A (TB)

CUT-A (TB)

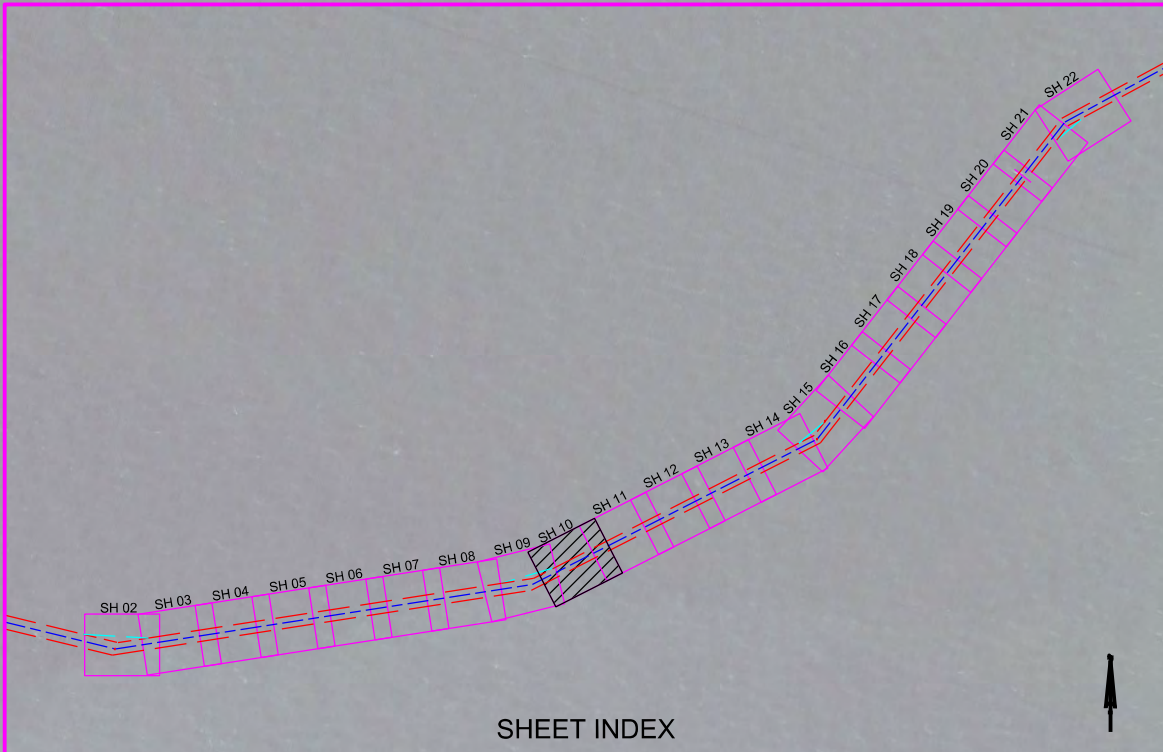

AIDS TO NAVIGATION	PLANE COORDINATES		LATITUDE	LONGITUDE
	X	Y		
LT. BUOY-1A (03/15)	440.192	1,193.593	27° 36' 56.70"	82° 40' 00.95"

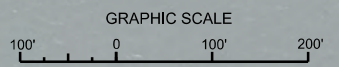

NOTES:
 1. REFER TO SURVEY NO. 14-170.
 2. SEE SHEET NO. 1 FOR SURVEY NOTES.

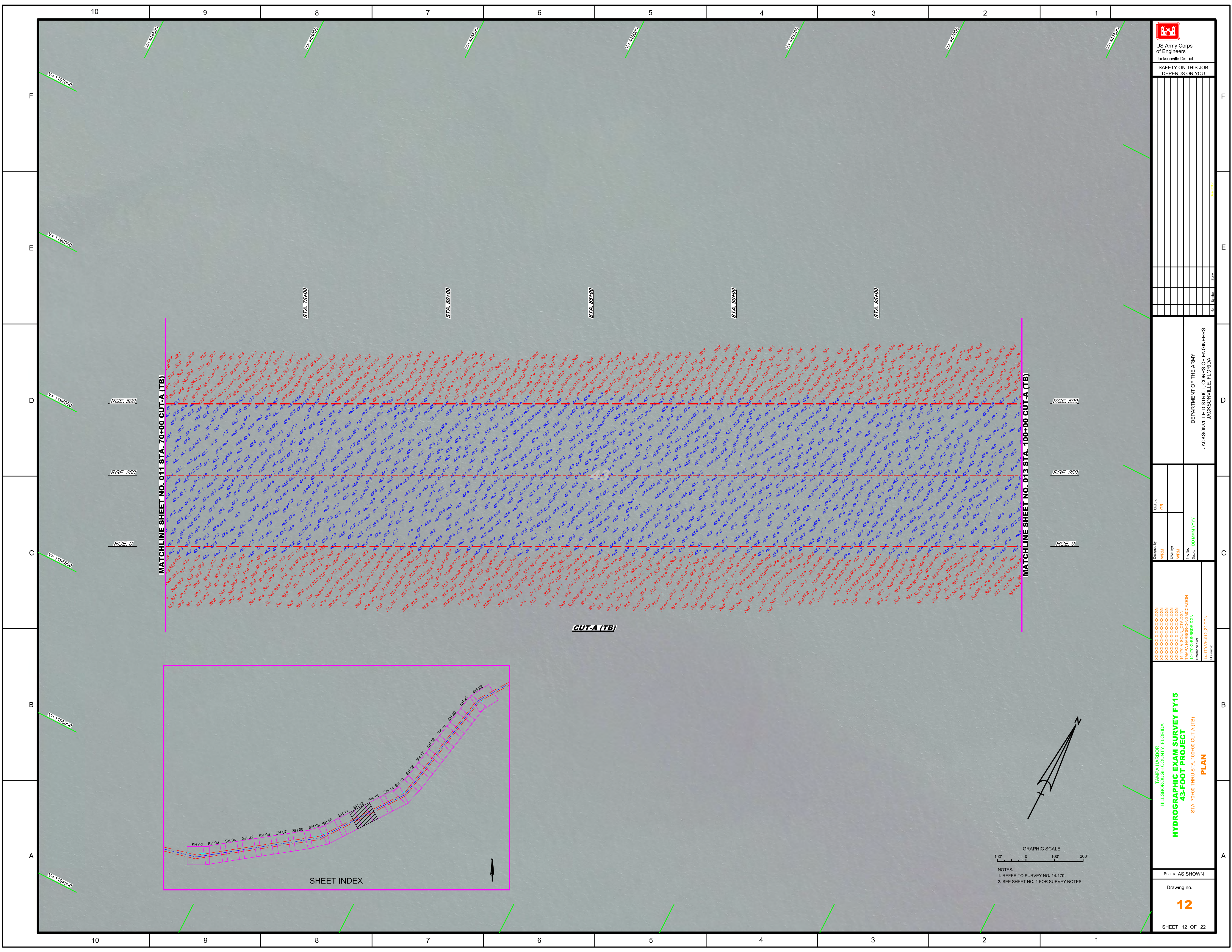

MATCHLINE SHEET NO. 011 STA. 70+00 CUT-A (TB)

MATCHLINE SHEET NO. 013 STA. 100+00 CUT-A (TB)

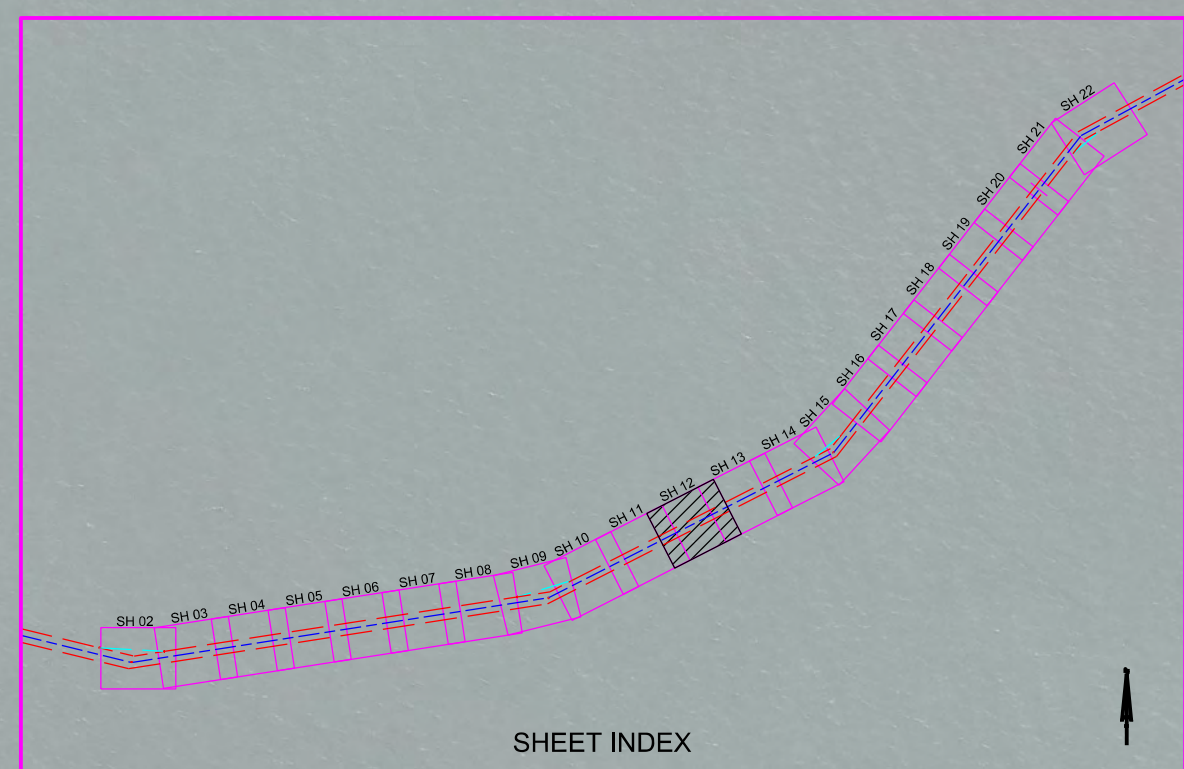

SHEET INDEX

CUT-A (TB)

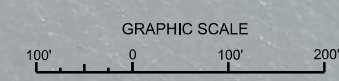

NOTES:
 1. REFER TO SURVEY NO. 14-170.
 2. SEE SHEET NO. 1 FOR SURVEY NOTES.



US Army Corps of Engineers
 Jacksonville District

SAFETY ON THIS JOB
 DEPENDS ON YOU

DEPARTMENT OF THE ARMY
 JACKSONVILLE DISTRICT, CORPS OF ENGINEERS
 JACKSONVILLE, FLORIDA

Designed by: WRM
 Drawn by: WRM
 Checked: DD/MM/YYYY
 Reference files:
 H:\170\H412_Z\LDN
 File name:

TAMPA HARBOR
 HILLSBOROUGH COUNTY, FLORIDA
**HYDROGRAPHIC EXAM SURVEY FY15
 43-FOOT PROJECT**
 STA. 70+00 THRU STA. 100+00 CUT-A (TB)
PLAN

Scale: AS SHOWN
 Drawing no.

12
 SHEET 12 OF 22

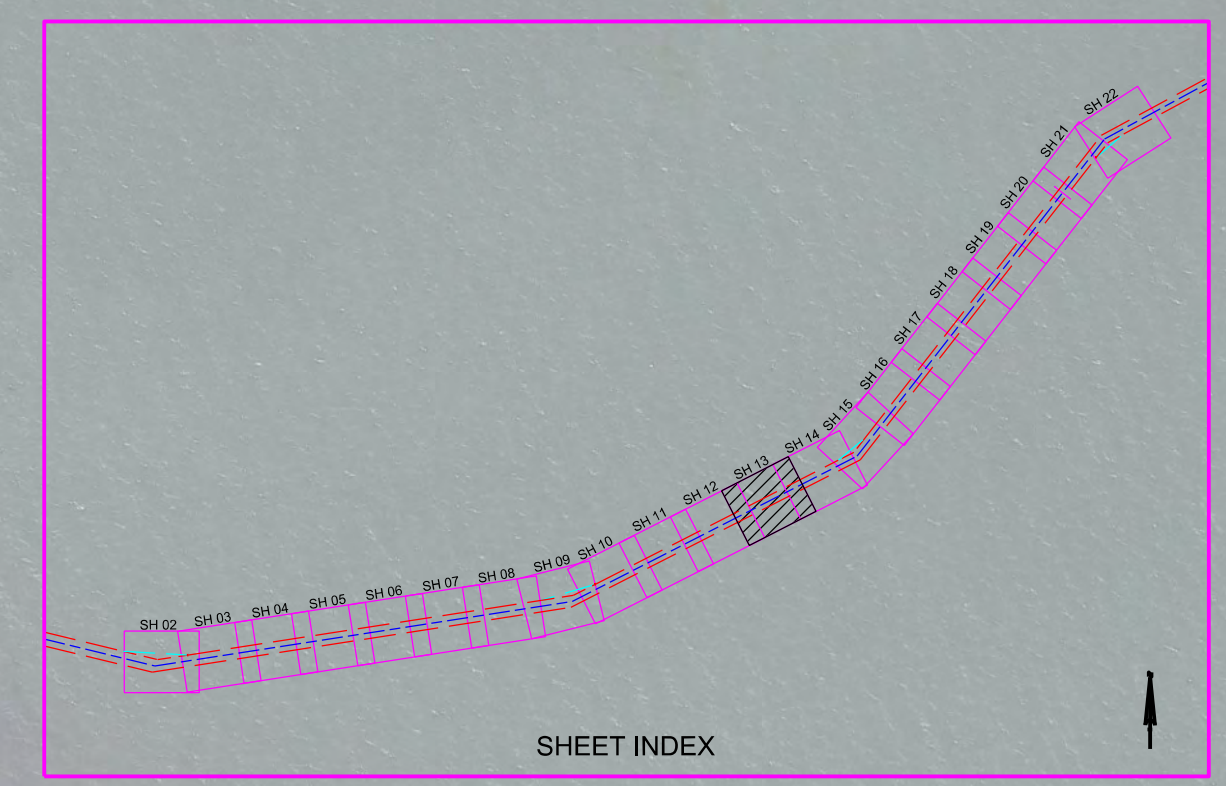
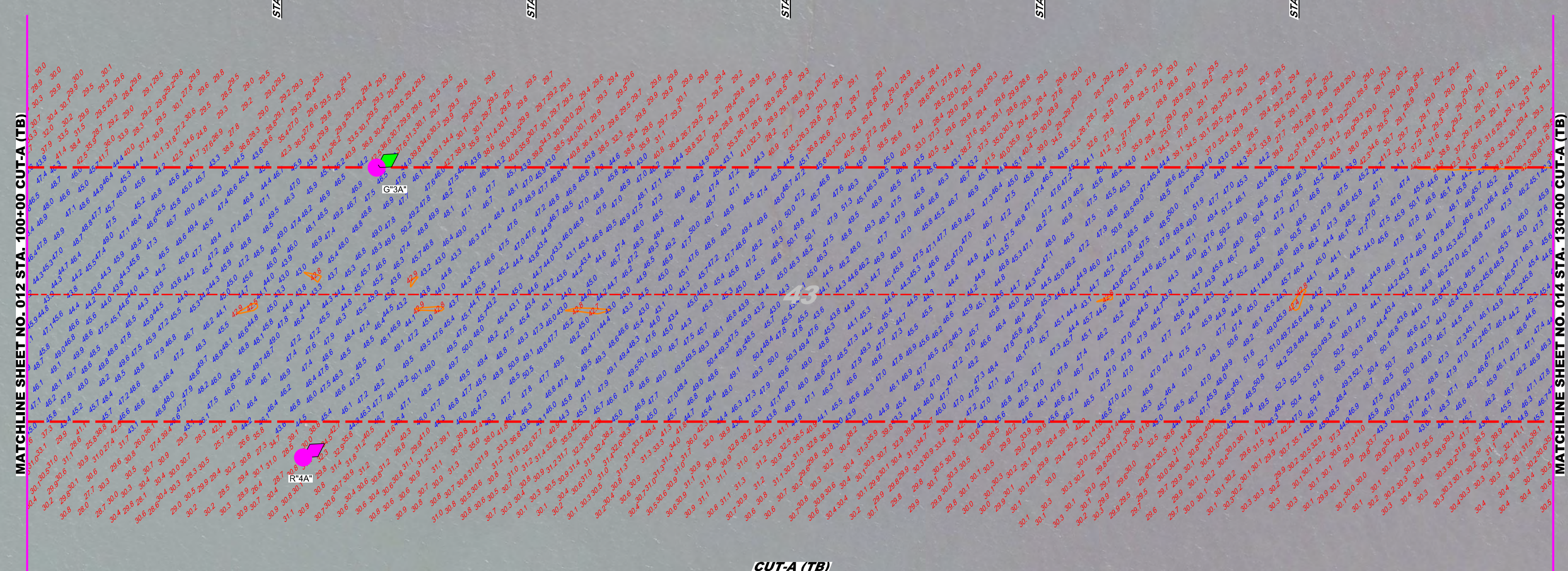

AIDS TO NAVIGATION	PLANE COORDINATES		LATITUDE	LONGITUDE
	X	Y		
LT BUOY-3A (03/15)	448,400	1,197,841	27°37'39.20"	82°38'29.95"
LT BUOY-4A (03/15)	448,350	1,197,268	27°37'33.52"	82°38'28.47"

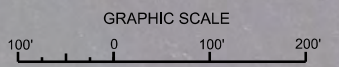

NOTES:
1. REFER TO SURVEY NO. 14-170.
2. SEE SHEET NO. 1 FOR SURVEY NOTES.

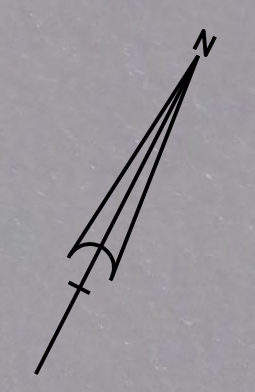

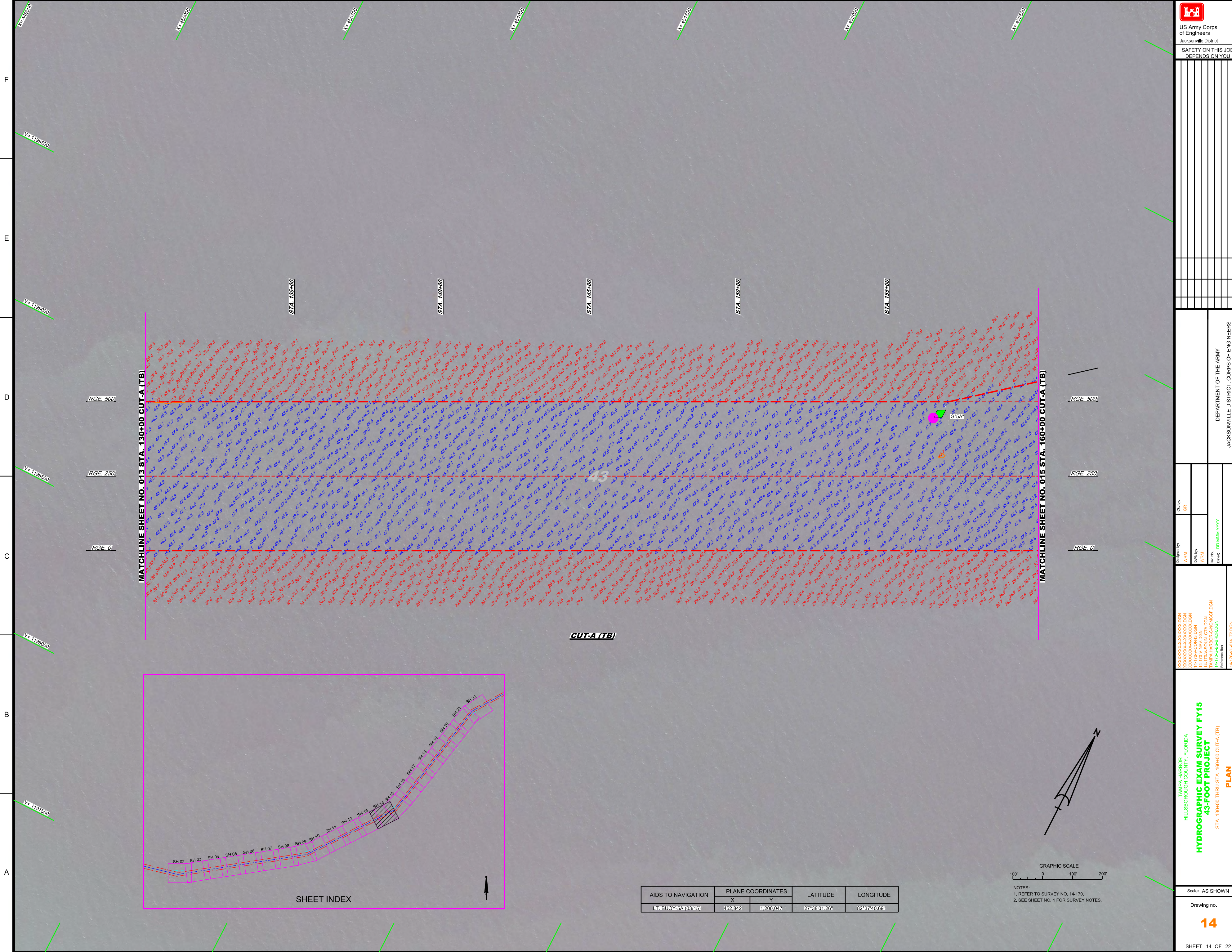

US Army Corps of Engineers
Jacksonville District

SAFETY ON THIS JOB DEPENDS ON YOU

NO.	SYMBOL

DEPARTMENT OF THE ARMY
JACKSONVILLE DISTRICT, CORPS OF ENGINEERS
JACKSONVILLE, FLORIDA

Checked by: GRL
Designed by: WRM
Drawn by: WRM
File No.: DD/AMM/YYY
Reference Map: 44-1704-HR1-LZ-DGN
File name:

TAMPA HARBOR
HILLSBOROUGH COUNTY, FLORIDA
HYDROGRAPHIC EXAM SURVEY FY15
43-FOOT PROJECT
STA. 130+00 THRU STA. 160+00 CUT-A (TB)
PLAN

Scale: AS SHOWN
Drawing no.
14

SHEET 14 OF 22

MATCHLINE SHEET NO. 013 STA. 130+00 CUT-A (TB)

MATCHLINE SHEET NO. 015 STA. 160+00 CUT-A (TB)

RGE. 500

RGE. 250

RGE. 0

STA. 135+00

STA. 140+00

STA. 145+00

STA. 150+00

STA. 155+00

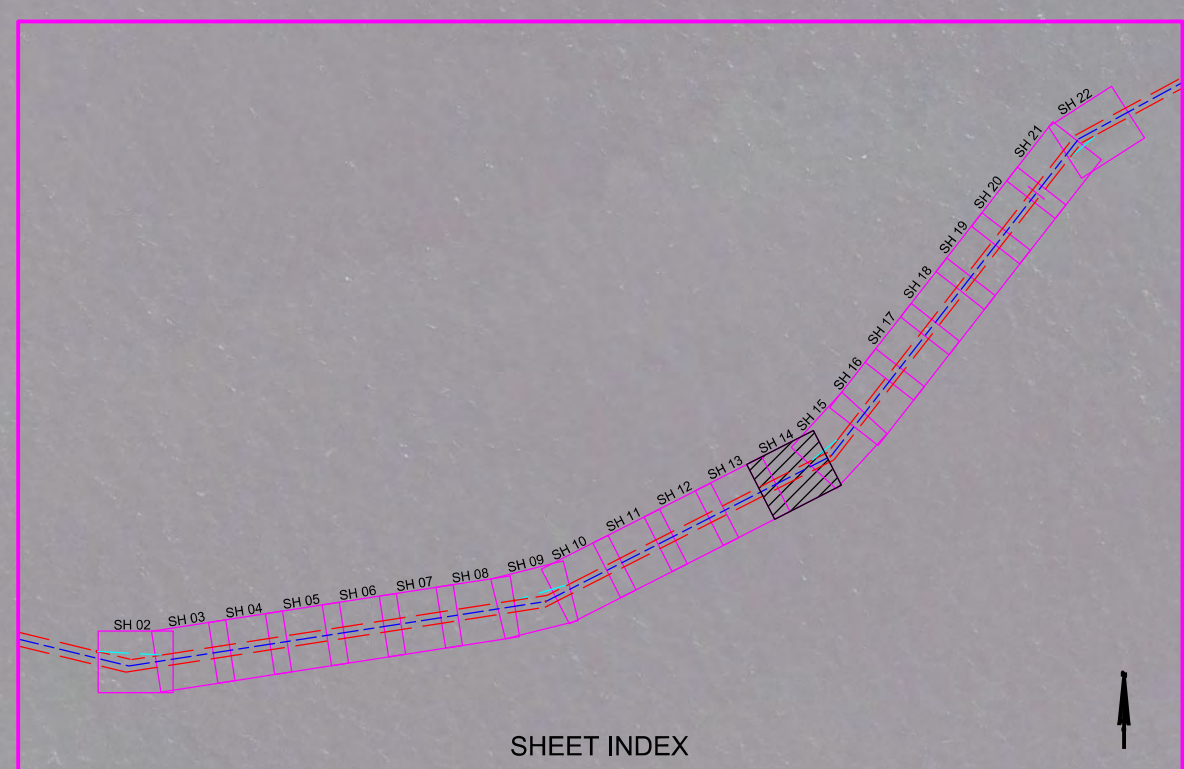

AIDS TO NAVIGATION	PLANE COORDINATES		LATITUDE	LONGITUDE
	X	Y		
LT BUOY 5A (03/15)	492,842	1,200,047	27°38'01.26"	82°37'40.69"

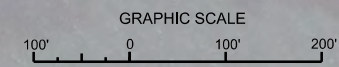

NOTES:
1. REFER TO SURVEY NO. 14-170.
2. SEE SHEET NO. 1 FOR SURVEY NOTES.