

SHEET INDEX

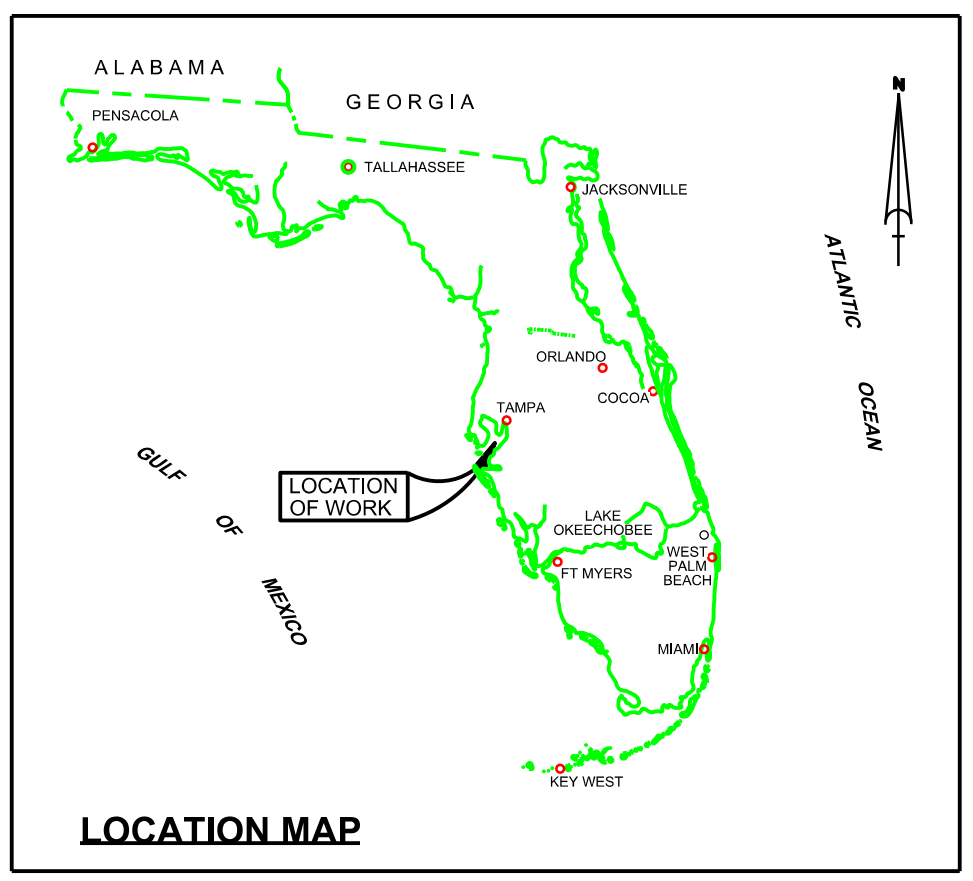

TAMPA HARBOR CUTS J, J2 AND K HILLSBOROUGH COUNTY, FLORIDA EXAMINATION SURVEY FY14 34-FOOT PROJECT

SURVEY ZONE	CUTS
4	CUT-F, CUT-G, GADSDEN POINT CUT
5	CUT-J, CUT-J2, CUT-K
6	CUT-A (HB), CUT-C (HB), CUT-D (HB)
7	LOWER & UPPER SPARKMAN, YBOR CH, SEDDON CH, PORT SUTTON CH, PORT SUTTON T.B., PORT SUTTON TERMINAL CH, EAST BAY CH, EAST BAY EXTENSIONS 1 & 2

LEGEND	
	MONUMENT
	LIGHTED BEACON
	GREEN DAYBEACON
	RED DAYBEACON
	RED LIGHTED BUOY
	GREEN LIGHTED BUOY
	CAN BUOY
	NUN BUOY
	TIDE STAFF
	PROJECT DEPTH

SURVEY NOTES

- REFER TO SURVEY NO. 14-066.
- ELEVATIONS ARE IN FEET AND TENTHS AND REFER TO THE NOAA REPORTED MLLW TIDAL DATUM RELATIVE TO THE 1983-2001 TIDAL EPOCH.
NOAA TIDAL STATION 872-6520, ST. PETERSBURG, TAMPA BAY, FLORIDA
- TIDAL REDUCTIONS WERE OBTAINED UTILIZING A REAL-TIME KINEMATIC (RTK) GPS AND REFERENCED TO MLLW UTILIZING A HYPACK KINEMATIC TIDE DATUM (KTD) MODEL NAMED "SPC-FL-WEST-2010-12-07.KTD"
- ALL ELEVATIONS ARE BELOW THE CHART DATUM UNLESS PRECEDED BY A (+) SIGN.
- PLANE COORDINATES ARE BASED ON THE TRANSVERSE MERCATOR PROJECTION FOR THE WEST ZONE OF FLORIDA AND REFERENCED TO NORTH AMERICAN DATUM OF 1983 (NAD83).
- ALL AZIMUTHS ARE GRID; RECKONED CLOCKWISE FROM SOUTH.
- ALL STATIONING REFERS TO THE CENTERLINE OF THE CHANNEL.
- THIS SURVEY WAS PERFORMED USING REAL-TIME KINEMATIC GPS POSITIONING WITH THE FOLLOWING REFERENCE BASE LOCATIONS:
REFERENCE BASE LOCATED AT "DILLMAN" (OPUS PID: BBGD48)
TIDE STAFF LOCATED FROM "EDD 60" (OPUS PID: AG5298)
- VERTICAL MEASUREMENTS WERE MADE USING A R2SONIC 2024 MULTI-BEAN TRANSDUCER OPERATING AT 240 KHZ. SOUNDINGS SHOWN ARE IN HIGH FREQUENCY.
- VESSEL** **DATE OF SURVEY** **CUT**
SB JACKSONVILLE 10, 11 MAR 2014 CUT-J
SB JACKSONVILLE 11 MAR 2014 CUT-J2
SB JACKSONVILLE 14, 15 MAR 2014 CUT-K
- AIDS TO NAVIGATION WERE LOCATED DURING THIS SURVEY.
- THE INFORMATION DEPICTED ON THIS MAP REPRESENTS THE RESULTS OF SURVEYS MADE ON THE DATES INDICATED ABOVE AND CAN ONLY BE CONSIDERED AS INDICATING THE GENERAL CONDITIONS AT THAT TIME. THIS CHART IS SOLELY FOR THE DISTRIBUTION OF AVAILABLE DEPTHS AT THE TIME OF THE SURVEY AND IS NOT TO BE USED FOR NAVIGATION.
- SURVEY ACCURACY PERFORMANCE STANDARDS, QUALITY CONTROL, AND QUALITY ASSURANCE REQUIREMENTS WERE FOLLOWED DURING THIS SURVEY IN ACCORDANCE WITH USACE EM 1110-2-1003, HYDROGRAPHIC SURVEYING, 1 JAN 02.

US Army Corps of Engineers
Jacksonville District
SAFETY ON THIS JOB DEPENDS ON YOU

Checked by:	GR	Designed by:	WRM	Drawn by:	WRM	File No.:	DD/MM/YYYY	Reference File:	H-0666-HQ1_Z.DGN
<p>DEPARTMENT OF THE ARMY JACKSONVILLE DISTRICT, CORPS OF ENGINEERS JACKSONVILLE, FLORIDA</p>									
<p>TAMPA HARBOR HILLSBOROUGH/PINELLAS COUNTIES, FLORIDA HYDROGRAPHIC EXAM SURVEY FY14 34-FOOT PROJECT INDEX, LOCATION AND VICINITY MAP</p>									
<p>Scale: AS SHOWN</p>									
<p>Drawing no. 1</p>									
<p>SHEET 01 OF 11</p>									

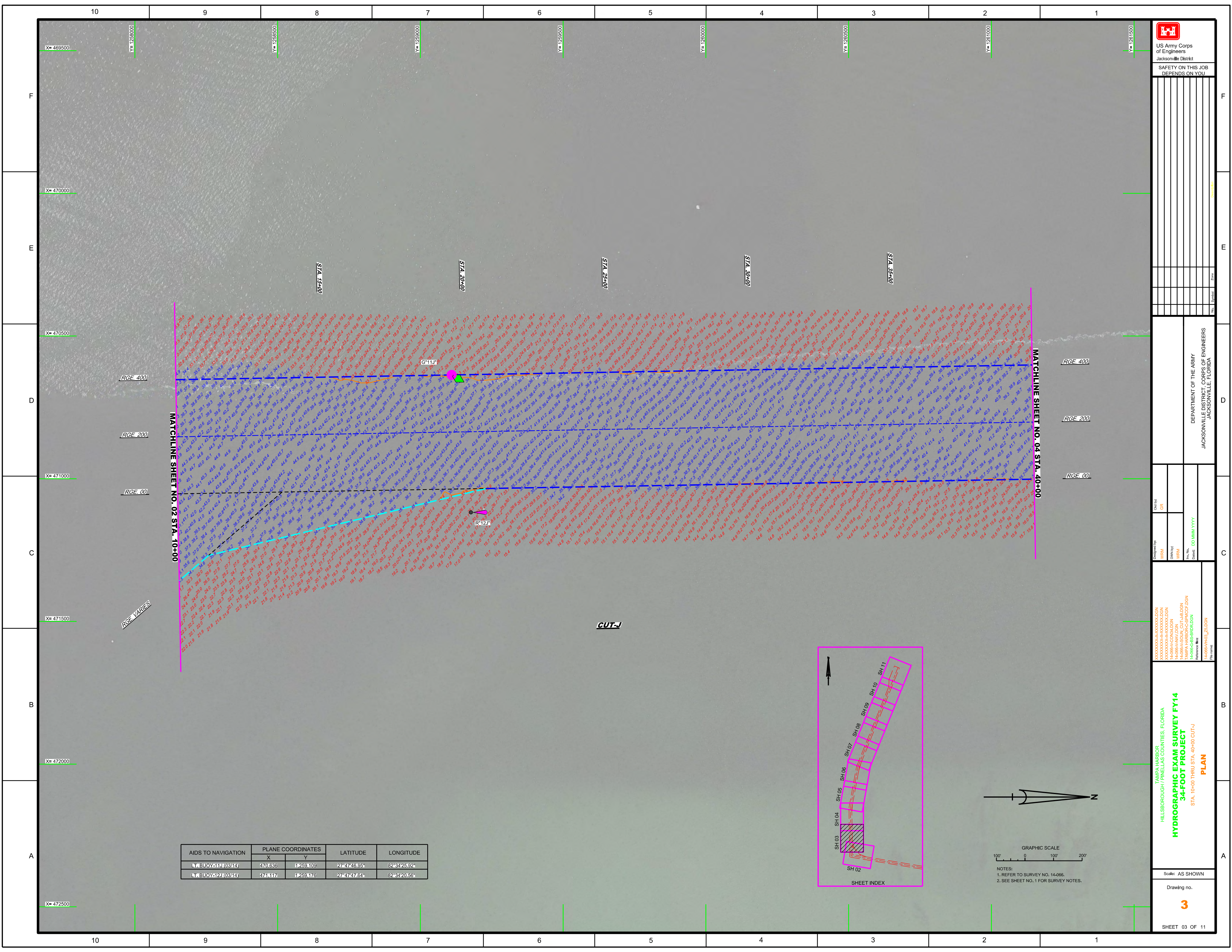

X=469500 X=470000 X=470500 X=471000 X=471500 X=472000 X=472500

Y=1265000 Y=1265500 Y=1266000 Y=1266500 Y=1267000 Y=1267500

STA 15+00 STA 20+00 STA 25+00 STA 30+00 STA 35+00

RGE 400
RGE 200
RGE 00

RGE VARIES

CUT-J

MATCHLINE SHEET NO. 02 STA. 10+00

MATCHLINE SHEET NO. 04 STA. 40+00

AIDS TO NAVIGATION	PLANE COORDINATES		LATITUDE	LONGITUDE
	X	Y		
BUOY 11J (0314)	470636	1259109	27°47'48.95"	82°24'25.92"
BUOY 12J (0314)	471117	1259176	27°47'47.64"	82°24'20.56"

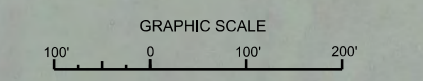
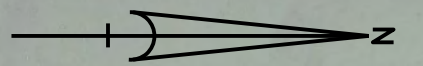
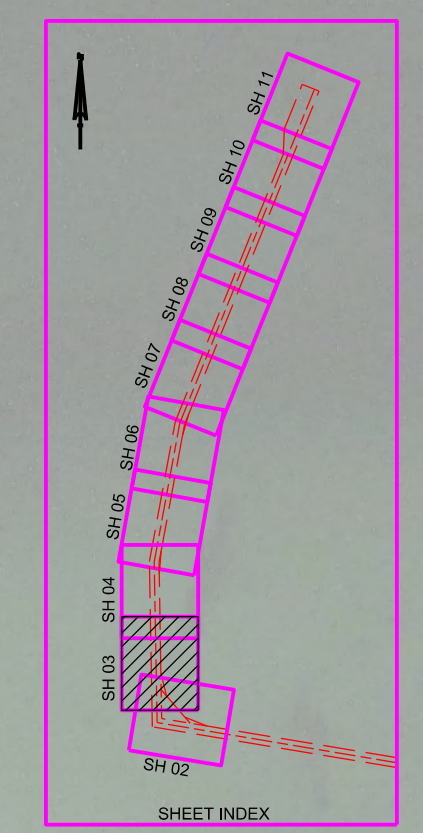

NOTES:
1. REFER TO SURVEY NO. 14-066.
2. SEE SHEET NO. 1 FOR SURVEY NOTES.



US Army Corps of Engineers
Jacksonville District
SAFETY ON THIS JOB
DEPENDS ON YOU

DEPARTMENT OF THE ARMY
JACKSONVILLE DISTRICT, CORPS OF ENGINEERS
JACKSONVILLE, FLORIDA

Drawn by: GRL
Checked by: GRL
Designed by: GRL
Title: HYDROGRAPHIC EXAM SURVEY FY14
Scale: AS SHOWN
Drawing no. 3
Reference files: TAMPA HARBOR / PINELLAS COUNTIES, FLORIDA
HYDROGRAPHIC EXAM SURVEY FY14
34-FOOT PROJECT
STA. 10+00 THRU STA. 40+00 CUT-J
PLAN
SHEET 03 OF 11

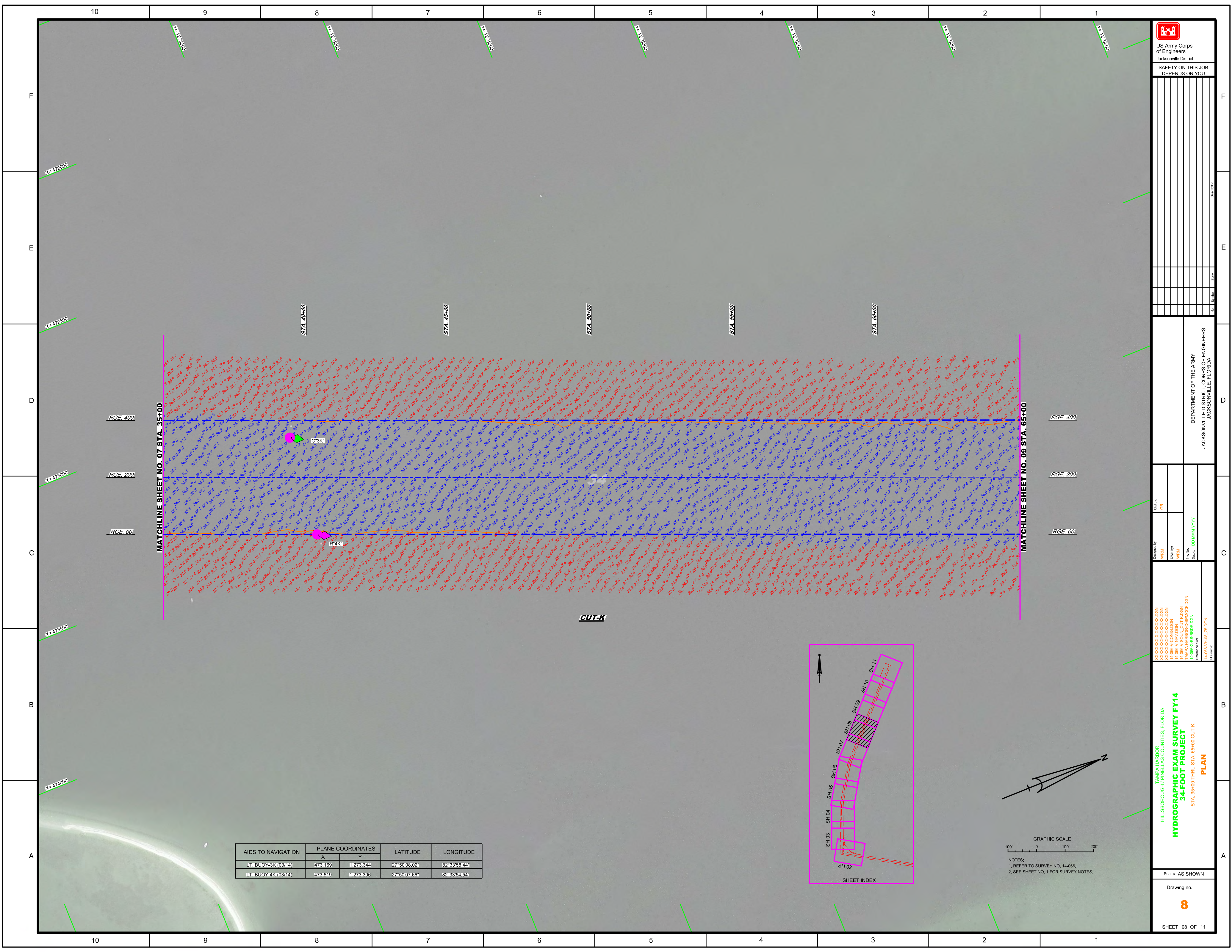

US Army Corps of Engineers
 Jacksonville District
 SAFETY ON THIS JOB
 DEPENDS ON YOU

DEPARTMENT OF THE ARMY
 JACKSONVILLE DISTRICT, CORPS OF ENGINEERS
 JACKSONVILLE, FLORIDA

Designed by: **WRM**
 Drawn by: **GR**
 Checked by: **WRM**
 Date: **00/00/00**

TAMPABOROUGH/PINELLAS COUNTIES, FLORIDA
HYDROGRAPHIC EXAM SURVEY FY14
34-FOOT PROJECT
 STA. 35+00 THRU STA. 65+00 CUT-K
PLAN

Scale: AS SHOWN
 Drawing no. **8**
 SHEET 08 OF 11

AIDS TO NAVIGATION	PLANE COORDINATES		LATITUDE	LONGITUDE
	X	Y		
LT. BUOY-3K (03/14)	478169	11278344	27°50'08.02"	82°33'58.44"
LT. BUOY-4K (03/14)	478519	11278305	27°50'07.65"	82°33'54.54"

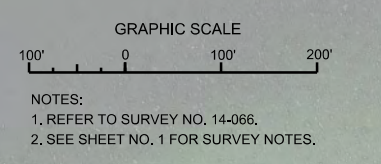
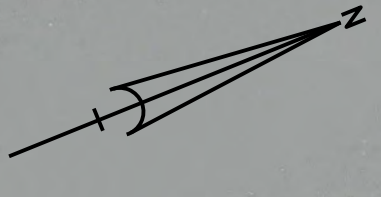
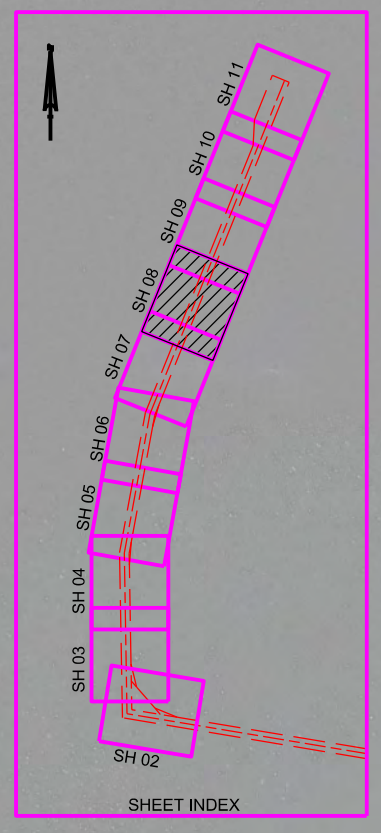

AIDS TO NAVIGATION	PLANE COORDINATES		LATITUDE	LONGITUDE
	X	Y		
BUOY 410K (09/14)	477429	1228279	27°51'33.66"	82°08'43.66"
CAN BUOY 11K (03/14)	477410	1228367	27°51'50.92"	82°08'15.06"

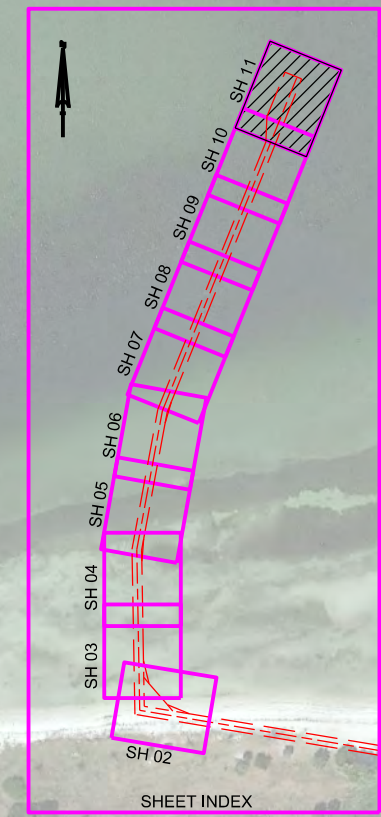
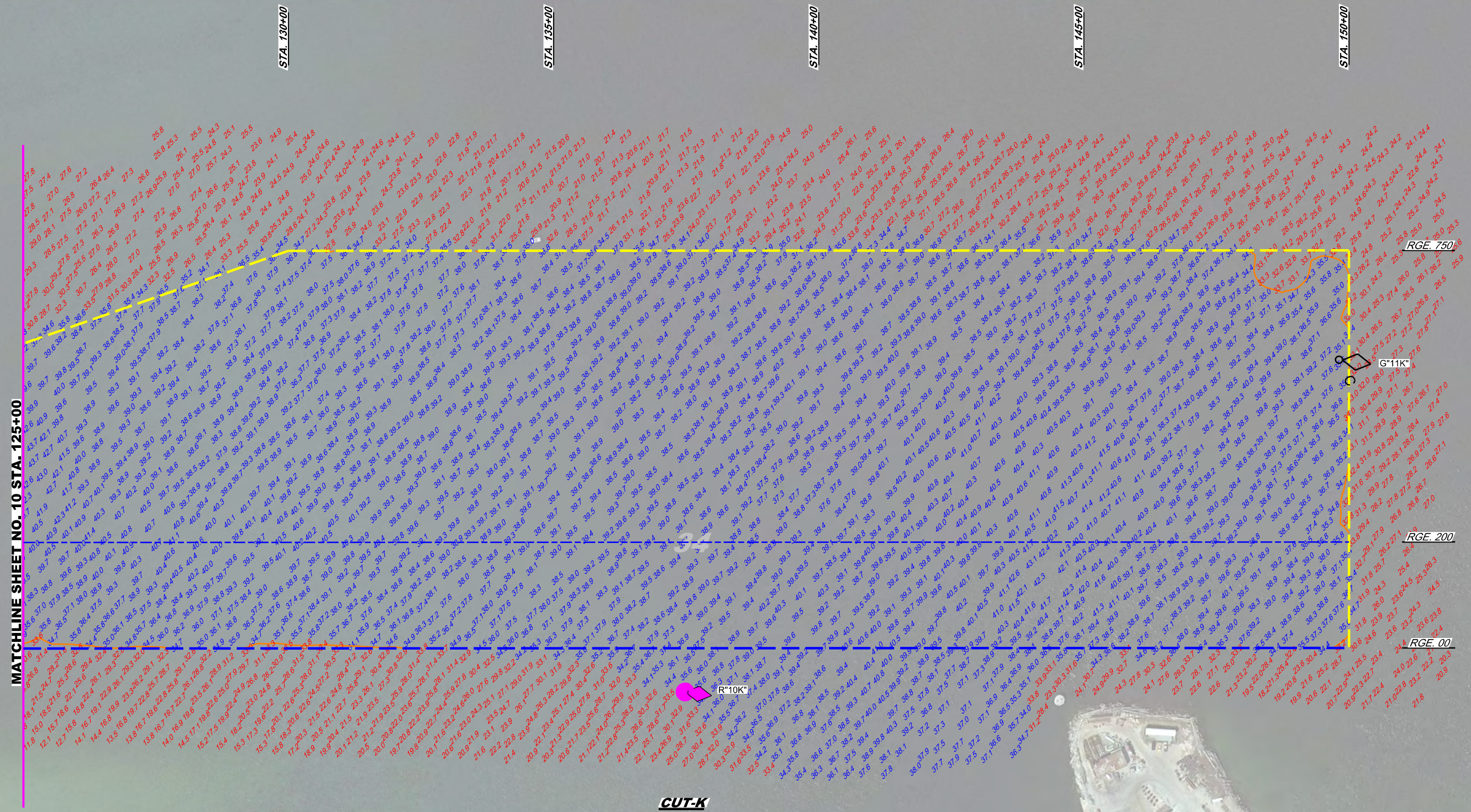

CUT-K

Motiva Enterprises

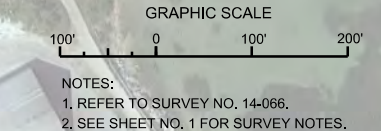

NOTES:
1. REFER TO SURVEY NO. 14-066.
2. SEE SHEET NO. 1 FOR SURVEY NOTES.

Designed by: WRM
Checked by: GRL
Drawn by: WRM
In Charge: DD/AMM/VVYV
Reference files: H:\066\H1_75.DGN
File name: H:\066\H1_75.DGN

TAMPA HARBOR
HILLSBOROUGH / PINELLAS COUNTIES, FLORIDA
**HYDROGRAPHIC EXAM SURVEY FY14
34-FOOT PROJECT**
STA. 125+00 THRU STA. 150+00 CUT-K
PLAN

DEPARTMENT OF THE ARMY
JACKSONVILLE DISTRICT, CORPS OF ENGINEERS
JACKSONVILLE, FLORIDA