

JACKSONVILLE HARBOR, FLORIDA NAVY FUEL PIER EXAMINATION SURVEY FY14

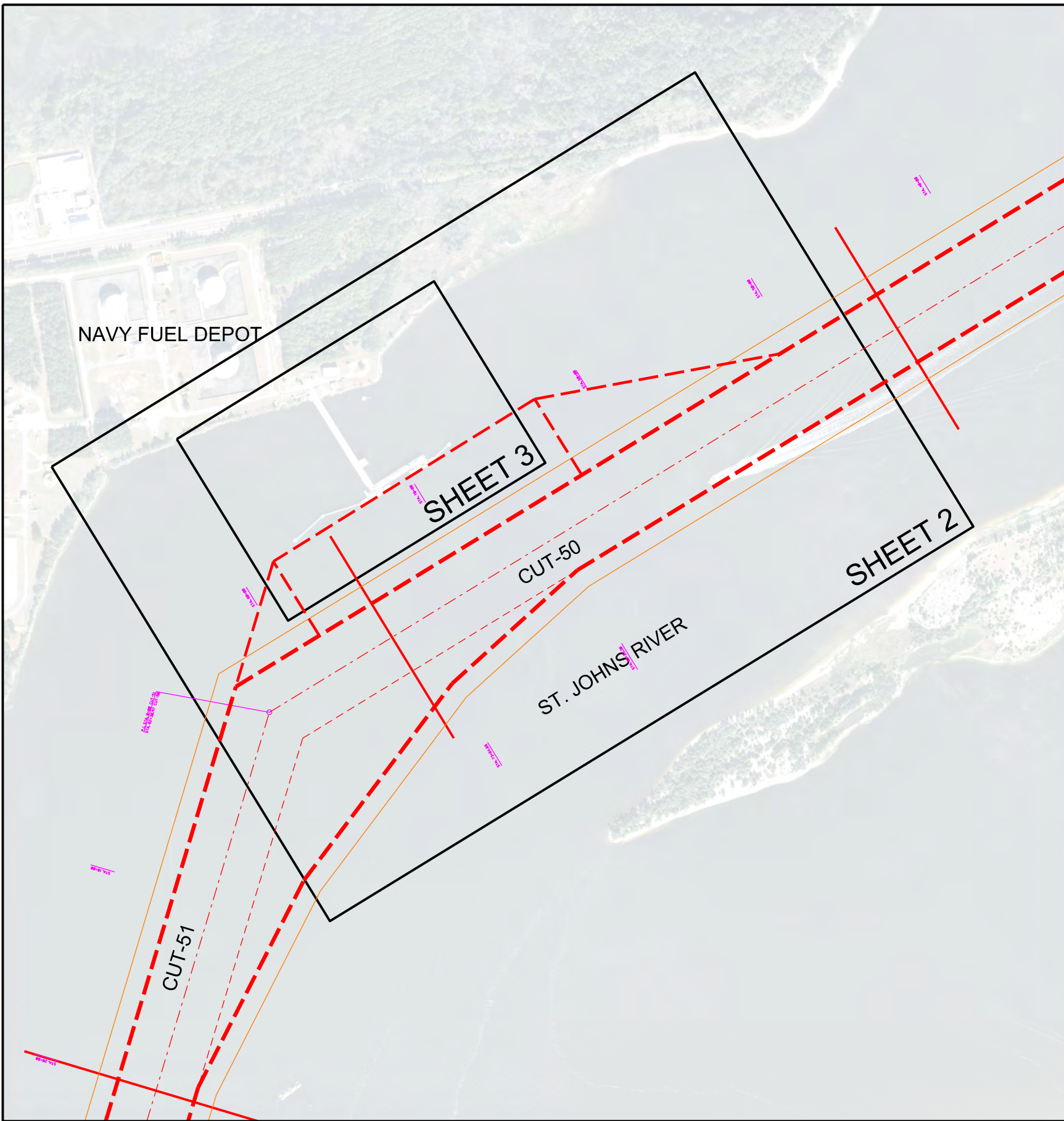

MAP SHEET NOTES:

- REFER TO SURVEY NO. 14-015.
 - DEPTHS DEPICTED BY THIS SURVEY ARE REFERENCED TO MLLW, TIDAL EPOCH 1983-2001, AS REPORTED BY THE NATIONAL OCEANIC AND ATMOSPHERIC ADMINISTRATION (NOAA). NOAA'S VDATUM MODEL WAS USED AND CALIBRATED TO THE PUBLISHED MLLW HEIGHTS OF THE BENCH MARKS ASSOCIATED WITH THE TIDE GAGES SITES SPECIFIED BELOW:

NOAA TIDAL STATION 872-0215, JACKSONVILLE, NAVY FUEL DEPOT
 - ALL ELEVATIONS ARE BELOW THE CHART DATUM UNLESS PRECEDED BY A (+) SIGN.
 - TIDAL REDUCTIONS WERE OBTAINED USING REAL-TIME KINEMATIC (RTK) GPS AND UTILIZING THE LATEST HYPACK KINEMATIC TIDAL DATUM (KTD) MODEL BASED ON NOAA VDATUM. FILE NAME: CAMDENGA-NASSAU-DUVAL-STJOHNS-FLAGLER_01FEB2011.KTD.
 - PLANE COORDINATES ARE BASED ON THE TRANSVERSE MERCATOR PROJECTION FOR THE EAST ZONE OF FLORIDA AND REFERENCED TO NORTH AMERICAN DATUM OF 1983 (NAD83).
 - ALL AZIMUTHS ARE GRID; RECKONED CLOCKWISE FROM SOUTH.
 - ALL STATIONING REFERS TO THE CENTERLINE OF THE CHANNEL.
 - THIS SURVEY WAS PERFORMED USING REAL-TIME KINEMATIC (RTK) GPS POSITIONING WITH THE FOLLOWING REFERENCE BASE LOCATION:

REFERENCE STATION LOCATED AT "DUNNS CREEK" (OPUS PID BBCT64)

TIDE STAFF LOCATED AT NAVY FUEL PIER FROM 872-0215 TIDAL NO. 3 (BC0275)
 - VERTICAL MEASUREMENTS WERE MADE USING AN R2 SONIC 2024 MULTI-BEAM SYSTEM OPERATING AT 240 KHZ. DEPTHS SHOWN ARE IN HIGH FREQUENCY.
- | SURVEY VESSEL | DATE OF SURVEY | AREA |
|---------------|----------------|-----------------------|
| SB-46 | 22 JAN 2014 | NAVY FUEL PIER/CUT-50 |
- AIDS TO NAVIGATION WERE NOT LOCATED DURING THIS SURVEY.
 - THE INFORMATION DEPICTED ON THIS MAP REPRESENTS THE RESULTS OF SURVEYS MADE ON THE DATES INDICATED ABOVE AND CAN ONLY BE CONSIDERED AS INDICATING THE GENERAL CONDITIONS AT THAT TIME. THIS CHART IS SOLELY FOR THE DISTRIBUTION OF AVAILABLE DEPTHS AT THE TIME OF THE SURVEY AND IS NOT TO BE USED FOR NAVIGATION.
 - SURVEY ACCURACY PERFORMANCE STANDARDS, QUALITY CONTROL, AND QUALITY ASSURANCE REQUIREMENTS WERE FOLLOWED IN ACCORDANCE WITH USACE EM 1110-2-1003, HYDROGRAPHIC SURVEYING, 1 JAN 02.

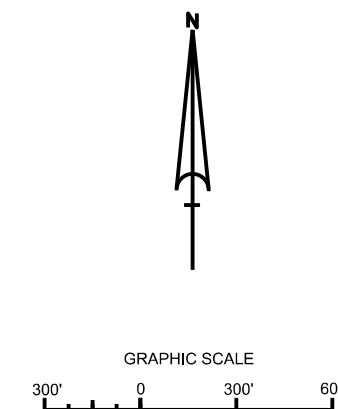

LEGEND	
• BM	BENCHMARK
⚓	LIGHTED BEACON
■	GREEN DAYBEACON
▲	RED DAYBEACON
⬢	RED LIGHTED BUOY
⬢	GREEN LIGHTED BUOY
⬢	CAN BUOY
⬢	NUN BUOY
⊕	TIDE STAFF
⊗	PROJECT DEPTH

US Army Corps of Engineers
Jacksonville District
SAFETY ON THIS JOB
DEPENDS ON YOU

DEPARTMENT OF THE ARMY JACKSONVILLE DISTRICT, CORPS OF ENGINEERS JACKSONVILLE, FLORIDA	DESIGNED BY: W.R.M.J. DRAWN BY: F.H.W. DATE: JAN 2014
JACKSONVILLE HARBOR, FLORIDA EXAMINATION SURVEY FY14 38 - FOOT PROJECT COVER, INDEX AND PLAN SHEET NAVY FUEL PIER PLAN	Scale: AS SHOWN Drawing no. 1 SHEET 1 OF 3

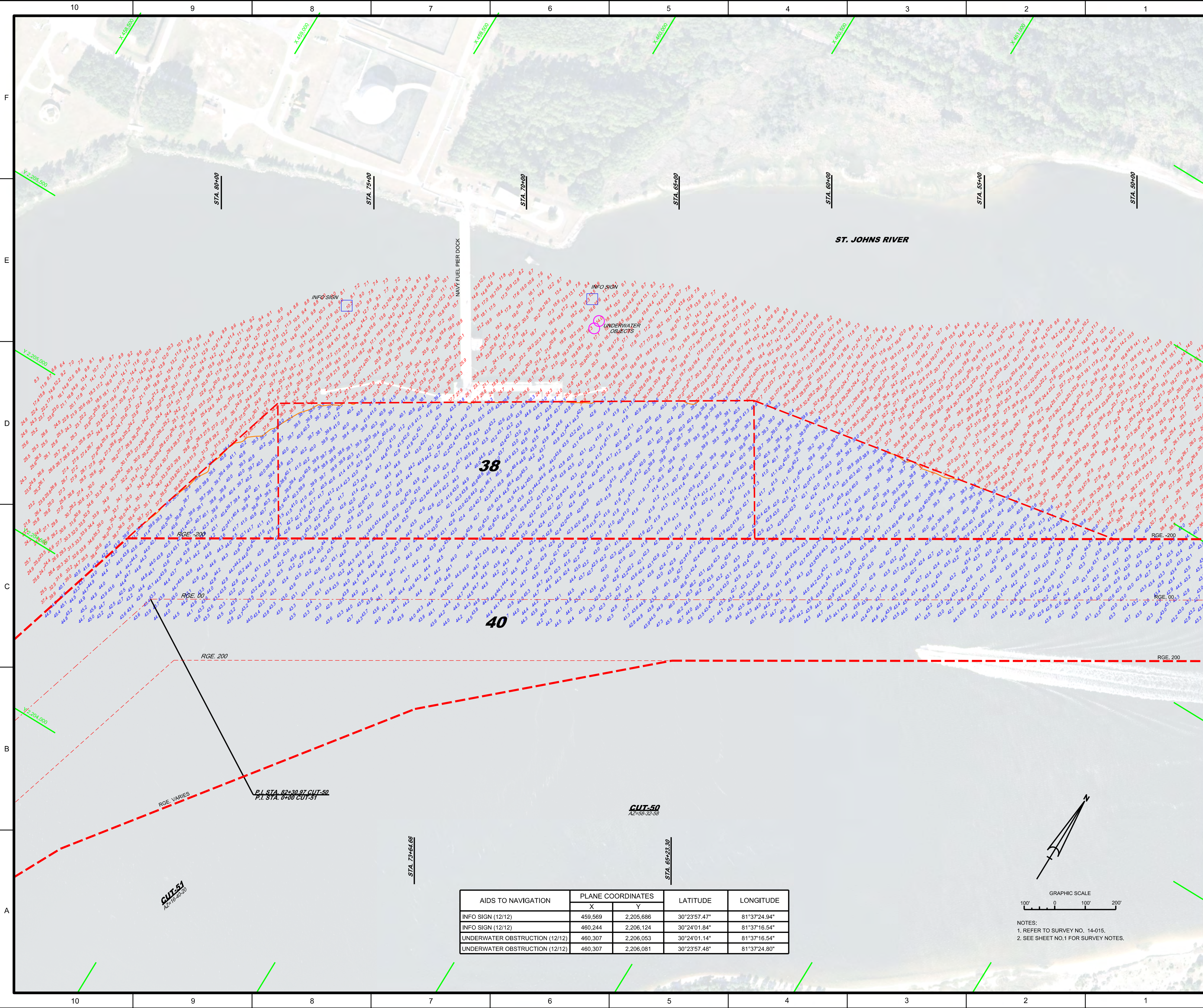

AIDS TO NAVIGATION	PLANE COORDINATES		LATITUDE	LONGITUDE
	X	Y		
INFO SIGN (12/12)	459,569	2,205,686	30°23'57.47"	81°37'24.94"
INFO SIGN (12/12)	460,244	2,206,124	30°24'01.84"	81°37'16.54"
UNDERWATER OBSTRUCTION (12/12)	460,307	2,206,053	30°24'01.14"	81°37'16.54"
UNDERWATER OBSTRUCTION (12/12)	460,307	2,206,081	30°23'57.48"	81°37'24.80"

GRAPHIC SCALE
100' 0 100' 200'

NOTES:
1. REFER TO SURVEY NO. 14-015.
2. SEE SHEET NO.1 FOR SURVEY NOTES.

<p>DEPARTMENT OF THE ARMY JACKSONVILLE DISTRICT, CORPS OF ENGINEERS JACKSONVILLE, FLORIDA</p>	<p>Drawn by: W.R.J.M. Checked by: G.R.</p>
<p>Project: EXAMINATION SURVEY FY 14 38 - FOOT PROJECT STA. 45+00 THRU STA. 75+00 CUT 50 NAVY FUEL PIER PLAN</p>	<p>Scale: AS SHOWN</p>
<p>Sheet: 2 OF 3</p>	<p>Drawn by: W.R.J.M. Checked by: G.R.</p>

AIDS TO NAVIGATION	PLANE COORDINATES		LATITUDE	LONGITUDE
	X	Y		
INFO SIGN (12/12)	459,569	2,205,686	30°23'57.47"	81°37'24.94"
INFO SIGN (12/12)	460,244	2,206,124	30°24'01.84"	81°37'17.26"
UNDERWATER OBJECT (12/12)	460,307	2,206,053	30°24'01.14"	81°37'16.54"
UNDERWATER OBJECT (12/12)	460,307	2,206,081	30°24'57.47"	81°37'24.94"

ST. JOHNS RIVER

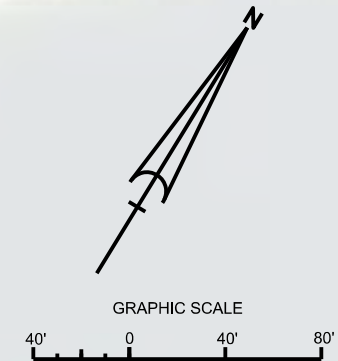

NOTES:
 1. REFER TO SURVEY NO. 14-015.
 2. SEE SHEET NO.1 FOR SURVEY NOTES.

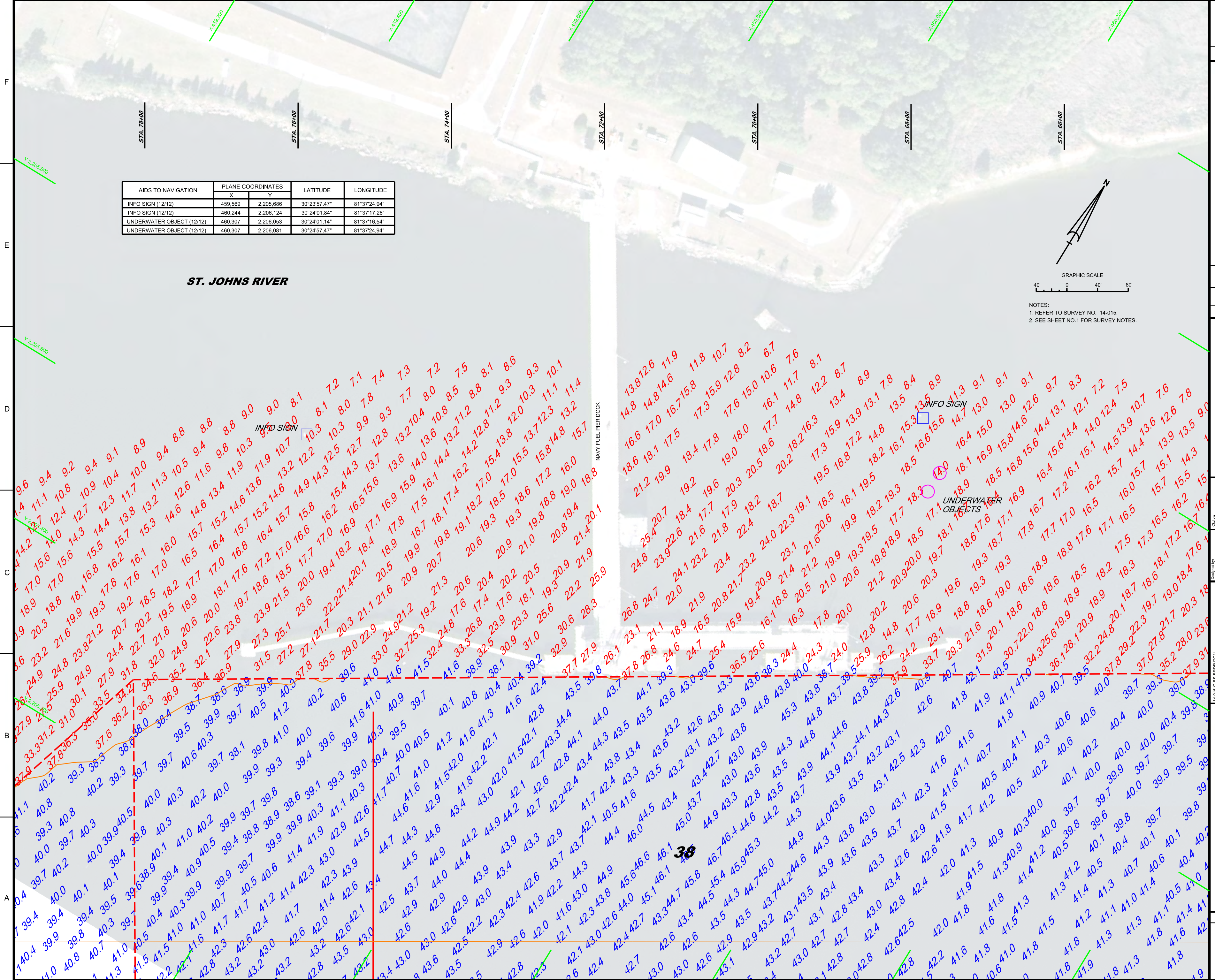

US Army Corps of Engineers
 Jacksonville District
 SAFETY ON THIS JOB
 DEPENDS ON YOU

14-015-38-BR-01-000
 JACKSONVILLE
 14-015-38-0000
 14-015-38-0000
 14-015-38-0000

Checked by: W.R.JAL
 GR

Drawn by: FHW
 Date: JAN 2014

Reference file:
 14-015-38-0000

JACKSONVILLE HARBOR, FLORIDA
EXAMINATION SURVEY FY14
38 - FOOT PROJECT
 STA. 65+00 THRU STA. 75+00 CUT 5
NAVY FUEL PIER
 PLAN

Scale: AS SHOWN

Drawing no.
3

SHEET 3 OF 3