

 US Army Corps of Engineers
 Jacksonville District
 SAFETY ON THIS JOB
 DEPENDS ON YOU

DEGREE SURVEYORS, INC.
 2151 LOCKWOOD BLVD.
 JACKSONVILLE, FLORIDA
 DEPARTMENT OF THE ARMY
 JACKSONVILLE DISTRICT, CORPS OF ENGINEERS
 JACKSONVILLE, FLORIDA

Designed by: BDC
 Drawn by: BDC
 Check by: GRN
 File No.: ACCE-15-186
 Date: 19 NOV 2013

CEDAR KEY HARBOR, FLORIDA
PROJECT CONDITION SURVEY
8 - FOOT AND 10.5 - FOOT PROJECT
 STA. 0+00 CUT - NW1 THRU STA. 30+00 CUT - NW11
 PLAN

Scale: AS SHOWN
 Drawing no.
VH-101

ABBREVIATIONS

RGE.	=	RANGE
STA.	=	STATION
AZ.	=	AZIMUTH
P.I.	=	POINT OF INTERSECTION
R	=	RED
G	=	GREEN

LEGEND

	CHANNEL CENTERLINE
	CONTOUR W/ ANNOTATION
	BENCHMARK
	LIGHTED BEACON
	GREEN DAYBEACON
	RED DAYBEACON
	RED LIGHTED BUOY
	GREEN LIGHTED BUOY
	CAN BUOY
	NUN BUOY
	NO WAKE SIGN
	TIDE STAFF

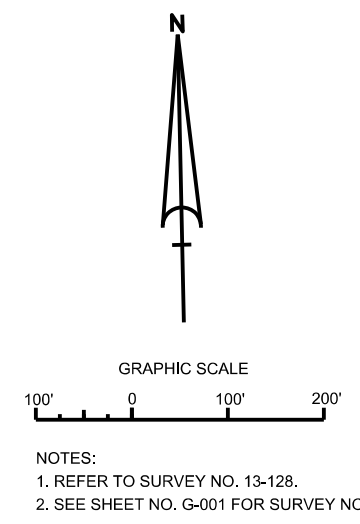

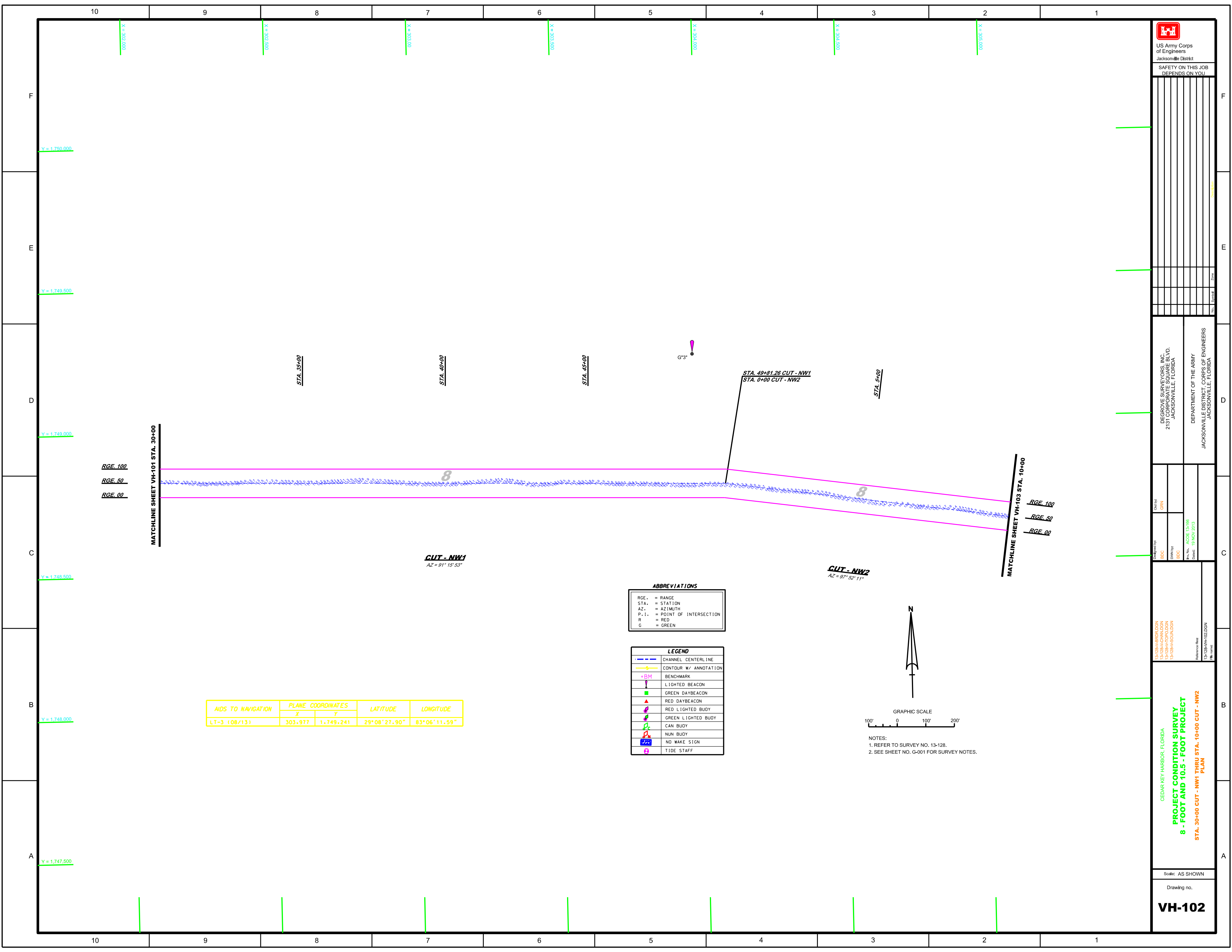

AIDS TO NAVIGATION	PLANE COORDINATES		LATITUDE	LONGITUDE
	X	Y		
LT-3 (08/13)	303,977	1,749,241	29°08'27.90"	83°06'11.59"

ABBREVIATIONS

RGE.	= RANGE
STA.	= STATION
AZ.	= AZIMUTH
P. I.	= POINT OF INTERSECTION
R	= RED
G	= GREEN

LEGEND

	CHANNEL CENTERLINE
	CONTOUR W/ ANNOTATION
	BENCHMARK
	LIGHTED BEACON
	GREEN DAYBEACON
	RED DAYBEACON
	RED LIGHTED BUOY
	GREEN LIGHTED BUOY
	CAN BUOY
	NUN BUOY
	NO WAKE SIGN
	TIDE STAFF

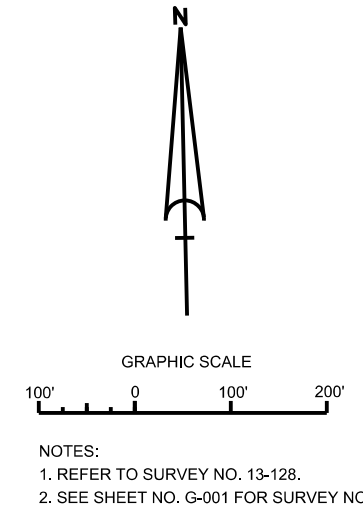

US Army Corps of Engineers
Jacksonville District
SAFETY ON THIS JOB
DEPENDS ON YOU

DEGROVE SURVEYORS, INC.
1000 W. UNIVERSITY BLVD.
JACKSONVILLE, FLORIDA

DEPARTMENT OF THE ARMY
JACKSONVILLE DISTRICT, CORPS OF ENGINEERS
JACKSONVILLE, FLORIDA

Checked by: GRN
Designed by: BDC
Drawn by: BDC
File No.: ACDE 13-108
Date: 19 NOV 2013

13-128-A-BR/DL/DGN
13-128-A-C/DL/DGN
13-128-A-S/DL/DGN

CEDAR KEY HARBOR, FLORIDA
PROJECT CONDITION SURVEY
8 - FOOT AND 10.5 - FOOT PROJECT
STA. 30+00 CUT - NW1 THRU STA. 10+00 CUT - NW2
PLAN

Scale: AS SHOWN
Drawing no.
VH-102

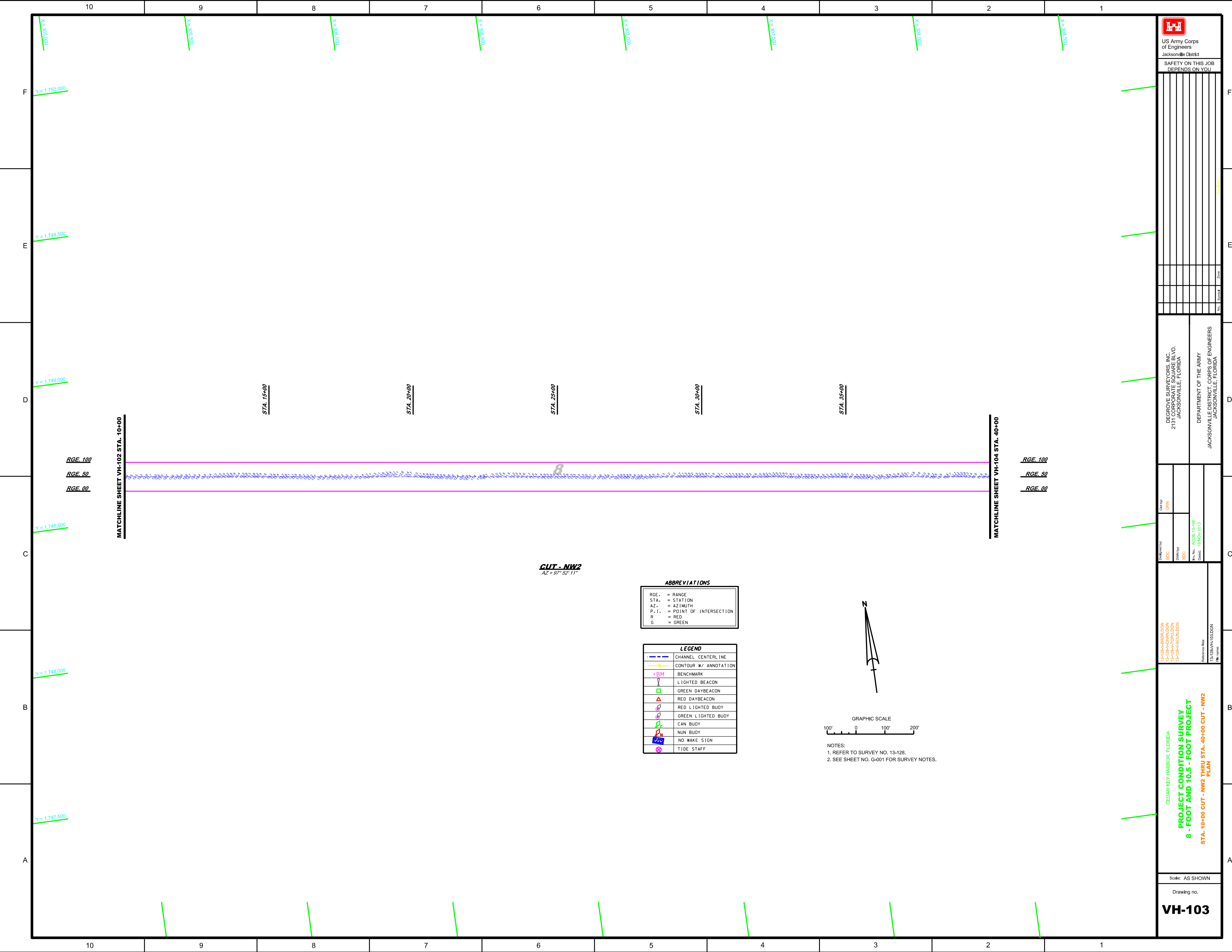

CUT - NW2
AZ = 97° 52' 11"

ABBREVIATIONS	
RGE.	= RANGE
STA.	= STATION
AZ.	= AZIMUTH
P.I.	= POINT OF INTERSECTION
R	= RED
G	= GREEN

LEGEND	
	CHANNEL CENTERLINE
	CONTOUR W/ ANNOTATION
	BENCHMARK
	LIGHTED BEACON
	GREEN DAYBEACON
	RED DAYBEACON
	RED LIGHTED BUDY
	GREEN LIGHTED BUDY
	CAN BUDY
	NUN BUDY
	NO WAKE SIGN
	TIDE STAFF

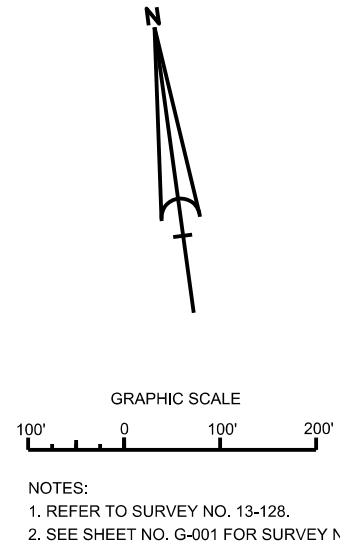

US Army Corps of Engineers
Jacksonville District
SAFETY ON THIS JOB DEPENDS ON YOU

<p>DESIGNED BY: BDC</p> <p>DRAWN BY: BDC</p> <p>CHECKED BY: GRN</p> <p>DATE: 19 NOV 2013</p> <p>PROJECT: 8 - FOOT AND 10.5 - FOOT PROJECT</p> <p>STATIONING: STA. 10+00 CUT - NW2 THRU STA. 40+00 CUT - NW2 PLAN</p> <p>Scale: AS SHOWN</p> <p>Drawing no. VH-103</p>	<p>DEGREE SURVEYORS, INC. 2151 LOCKWOOD BLVD. JACKSONVILLE, FLORIDA</p> <p>DEPARTMENT OF THE ARMY JACKSONVILLE DISTRICT, CORPS OF ENGINEERS JACKSONVILLE, FLORIDA</p>
--	---

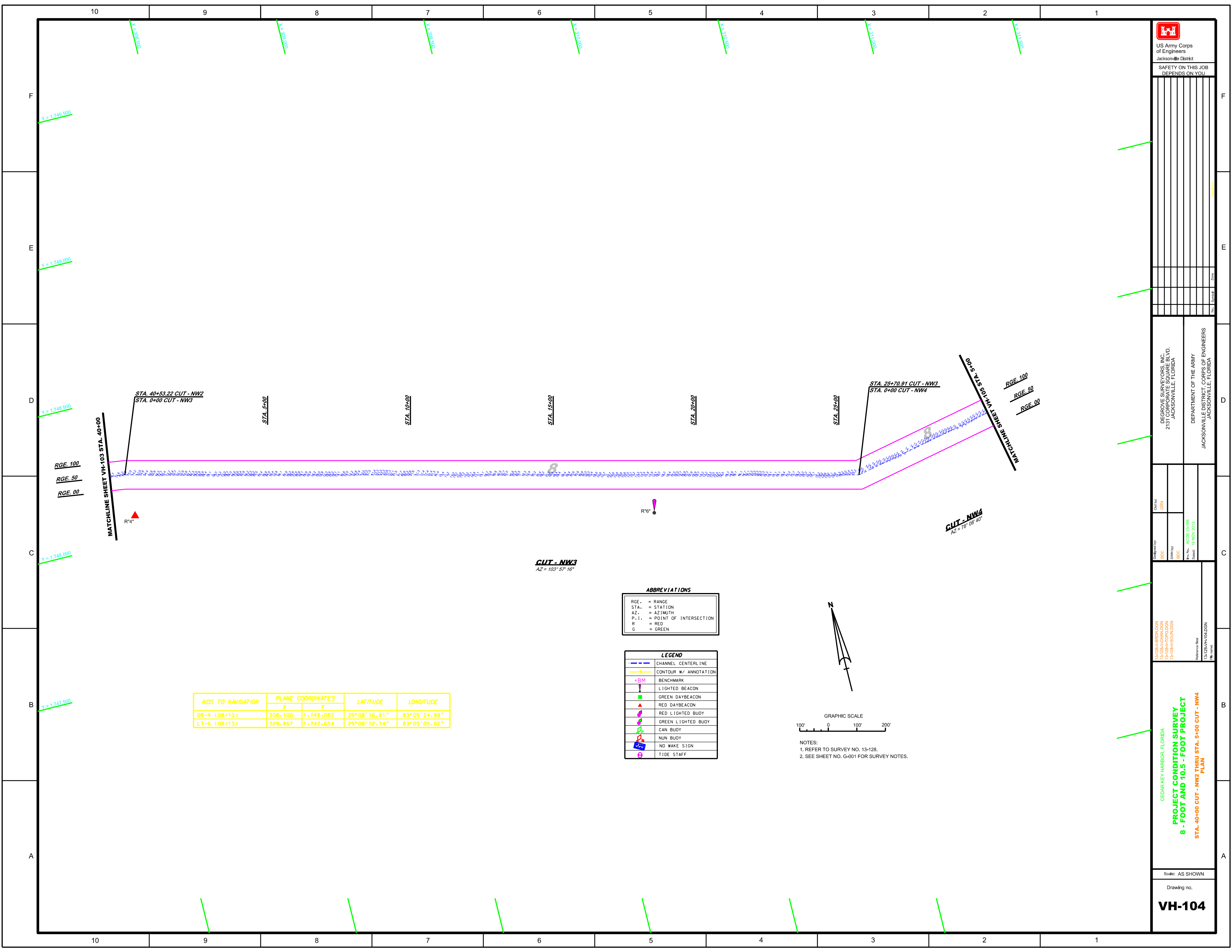

AIDS TO NAVIGATION	PLANE COORDINATES		LATITUDE	LONGITUDE
	X	Y		
DB-4 (08/13)	308.100	1,748.082	29°08'16.81"	83°05'24.99"
LT-6 (08/13)	309.867	1,747.654	29°08'12.74"	83°05'05.02"

ABBREVIATIONS

- RGE. = RANGE
- STA. = STATION
- AZ. = AZIMUTH
- P.I. = POINT OF INTERSECTION
- R = RED
- G = GREEN

LEGEND

- CHANNEL CENTERLINE
- CONTOUR W/ ANNOTATION
- +BM BENCHMARK
- ▲ LIGHTED BEACON
- GREEN DAYBEACON
- ▲ RED DAYBEACON
- ▲ RED LIGHTED BUOY
- ▲ GREEN LIGHTED BUOY
- ▲ CAN BUOY
- ▲ NUN BUOY
- ▲ NO WAKE SIGN
- ▲ TIDE STAFF

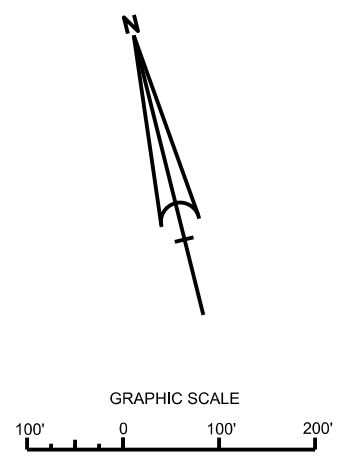

NOTES:
 1. REFER TO SURVEY NO. 13-128.
 2. SEE SHEET NO. G-001 FOR SURVEY NOTES.



US Army Corps of Engineers
 Jacksonville District
 SAFETY ON THIS JOB
 DEPENDS ON YOU

DEGROVE SURVEYORS, INC.
 2131 LOCKPORT BLVD.
 JACKSONVILLE, FLORIDA

DEPARTMENT OF THE ARMY
 JACKSONVILLE DISTRICT, CORPS OF ENGINEERS
 JACKSONVILLE, FLORIDA

Designed by: BDC
 Drawn by: BDC
 Checked by: BDC

Scale: AS SHOWN

PROJECT CONDITION SURVEY
8 - FOOT AND 10.5 - FOOT PROJECT
STA. 40+00 CUT - NW2 THRU STA. 5+00 CUT - NW4
PLAN

Drawing no.
VH-104

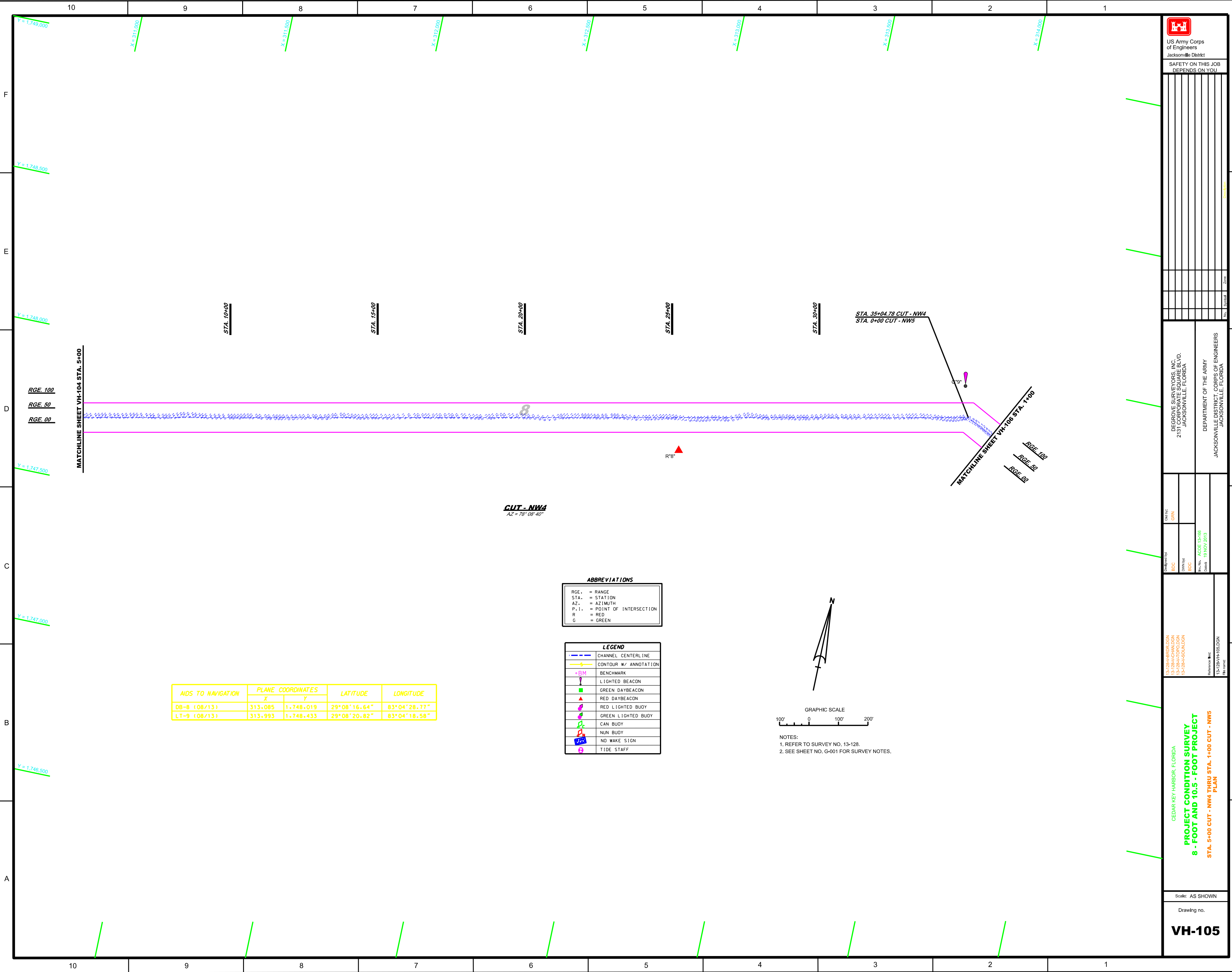

AIDS TO NAVIGATION	PLANE COORDINATES		LATITUDE	LONGITUDE
	X	Y		
OB-8 (08/13)	313.085	1,748.019	29°08'16.64"	83°04'28.77"
LT-9 (08/13)	313.993	1,748.433	29°08'20.82"	83°04'18.58"

ABBREVIATIONS

RGE.	=	RANGE
STA.	=	STATION
AZ.	=	AZIMUTH
P.I.	=	POINT OF INTERSECTION
R	=	RED
G	=	GREEN

LEGEND

	CHANNEL CENTERLINE
	CONTOUR W/ ANNOTATION
	BENCHMARK
	LIGHTED BEACON
	GREEN DAYBEACON
	RED DAYBEACON
	RED LIGHTED BODY
	GREEN LIGHTED BODY
	CAN BODY
	NUN BODY
	NO WAKE SIGN
	TIDE STAFF

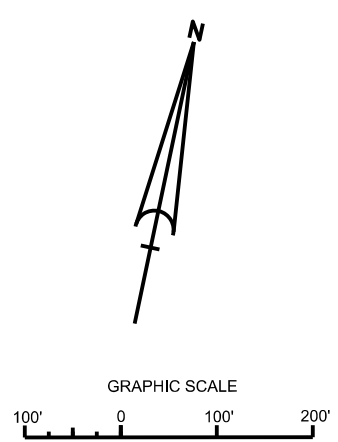

NOTES:
1. REFER TO SURVEY NO. 13-128.
2. SEE SHEET NO. G-001 FOR SURVEY NOTES.

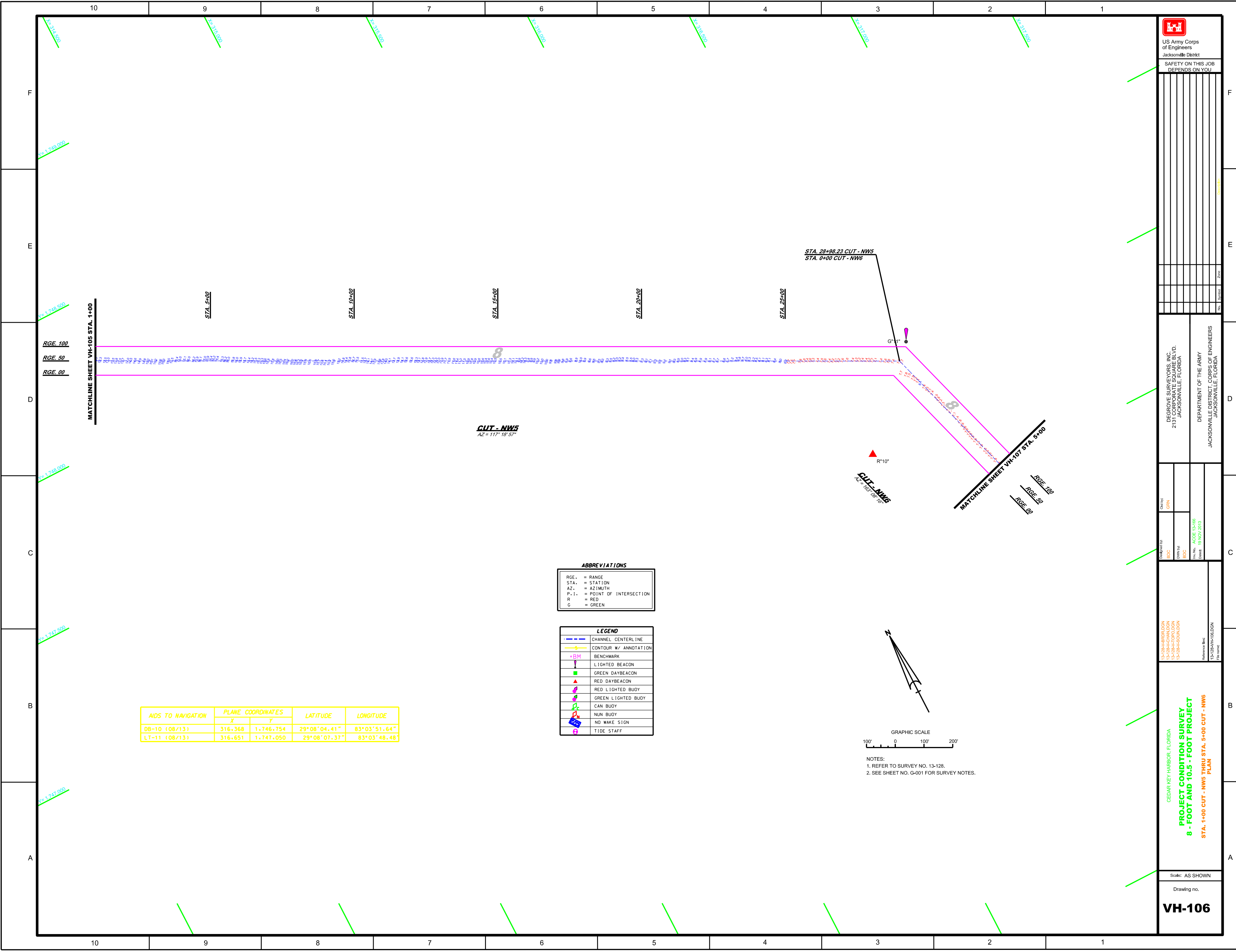

AIDS TO NAVIGATION	PLANE COORDINATES		LATITUDE	LONGITUDE
	X	Y		
DB-10 (08/13)	316.368	1,746,754	29°08'04.41"	83°03'51.64"
LT-11 (08/13)	316.651	1,747,050	29°08'07.37"	83°03'48.48"

RGE.	=	RANGE
STA.	=	STATION
AZ.	=	AZIMUTH
P. I.	=	POINT OF INTERSECTION
R	=	RED
G	=	GREEN

(Blue dashed line)	CHANNEL CENTERLINE
(Black line with 'X')	CONTOUR W/ ANNOTATION
(Purple 'BM' symbol)	BENCHMARK
(Pink buoy symbol)	LIGHTED BUOY
(Green buoy symbol)	GREEN DAYBEACON
(Red buoy symbol)	RED DAYBEACON
(Red buoy symbol with light)	RED LIGHTED BUOY
(Green buoy symbol with light)	GREEN LIGHTED BUOY
(Green buoy symbol with 'P')	CAN BUOY
(Red buoy symbol with 'N')	NUN BUOY
(Blue buoy symbol with 'S')	NO WAKE SIGN
(Blue buoy symbol with 'T')	TIDE STAFF

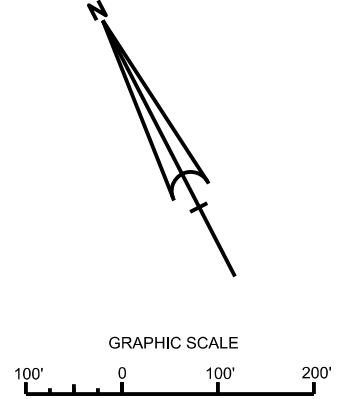

NOTES:
 1. REFER TO SURVEY NO. 13-128.
 2. SEE SHEET NO. G-001 FOR SURVEY NOTES.

US Army Corps of Engineers
 Jacksonville District

SAFETY ON THIS JOB
 DEPENDS ON YOU

No.	Symbol	Zone	

DEGREE SURVEYORS, INC. 2151 LOCKWOOD BLVD. JACKSONVILLE, FLORIDA	DEPARTMENT OF THE ARMY JACKSONVILLE DISTRICT CORPS OF ENGINEERS JACKSONVILLE, FLORIDA
--	---

Checked by: GIN	Date:
Drawn by: BDC	Date:
Designated by: BDC	Date:
Design No.: AGCE 15-086	Date: 19 NOV 2013
Checked:	Date:

PROJECT CONDITION SURVEY

8 - FOOT AND 10.5 - FOOT PROJECT

STA. 1+00 CUT - NW5 THRU STA. 5+00 CUT - NW6 PLAN

CEDAR KEY HARBOR, FLORIDA

Scale: AS SHOWN

Drawing no.
VH-106

DEGROVE SURVEYORS, INC.
2151 LOCKWOOD BLVD.
JACKSONVILLE, FLORIDA

DEPARTMENT OF THE ARMY
JACKSONVILLE DISTRICT, CORPS OF ENGINEERS
JACKSONVILLE, FLORIDA

Designed by: BDC	Checked by: GRN
DRAWN BY: BDC	DATE: 19 NOV 2013
PROJECT NO.: 13-128-AH-107-DGN	DATE: 19 NOV 2013

13-128-AH-107-DGN
13-128-AH-107-DGN
13-128-AH-107-DGN

Reference files:
13-128-AH-107-DGN

CEDAR KEY HARBOR, FLORIDA
**PROJECT CONDITION SURVEY
8 - FOOT AND 10.5 - FOOT PROJECT
STA. 5+00 CUT - NW6 THRU STA. 5+00 CUT - NW7
PLAN**

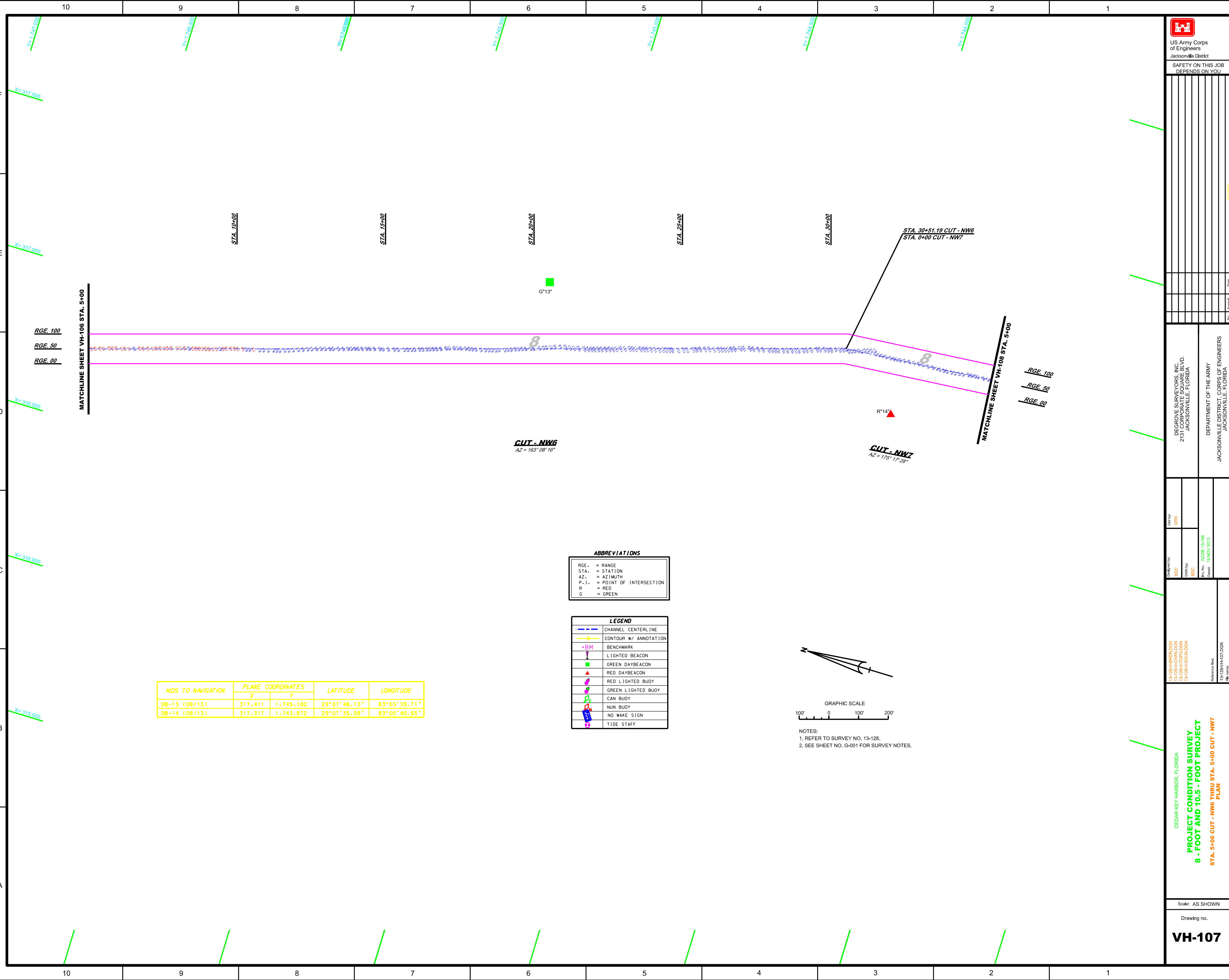

ABBREVIATIONS

RGE.	= RANGE
STA.	= STATION
AZ.	= AZIMUTH
P. I.	= POINT OF INTERSECTION
R	= RED
G	= GREEN

LEGEND

	CHANNEL CENTERLINE
	CONTOUR W/ ANNOTATION
	BENCHMARK
	LIGHTED BEACON
	GREEN DAYBEACON
	RED DAYBEACON
	RED LIGHTED BUOY
	GREEN LIGHTED BUOY
	CAN BUOY
	NUN BUOY
	NO WAKE SIGN
	TIDE STAFF

AIDS TO NAVIGATION	PLANE COORDINATES		LATITUDE	LONGITUDE
	X	Y		
DB-13 (08/13)	317.411	1.745.100	29°07'48.13"	83°03'39.71"
DB-14 (08/13)	317.317	1.743.872	29°07'35.98"	83°00'40.65"

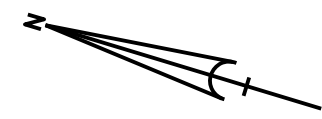

NOTES:
1. REFER TO SURVEY NO. 13-128.
2. SEE SHEET NO. G-001 FOR SURVEY NOTES.

US Army Corps
of Engineers
Jacksonville District
SAFETY ON THIS JOB
DEPENDS ON YOU

DEGROVE SURVEYORS, INC.
2151 CORPORATE BLVD.
JACKSONVILLE, FLORIDA
DEPARTMENT OF THE ARMY
JACKSONVILLE DISTRICT, CORPS OF ENGINEERS
JACKSONVILLE, FLORIDA

Checked By: GRN
Designed By: BDC
Drawn By: BDC
File No.: ACDE 15-108
Date: 19 NOV 2013
Reference files:
13-128A-PR108.DGN
13-128A-CAD108.DGN
13-128A-SO108.DGN

PROJECT CONDITION SURVEY
8 - FOOT AND 10.5 - FOOT PROJECT
STA. 5+00 CUT - NW7 THRU STA. 15+00 CUT - NW9
PLAN

Scale: AS SHOWN
Drawing no.
VH-108

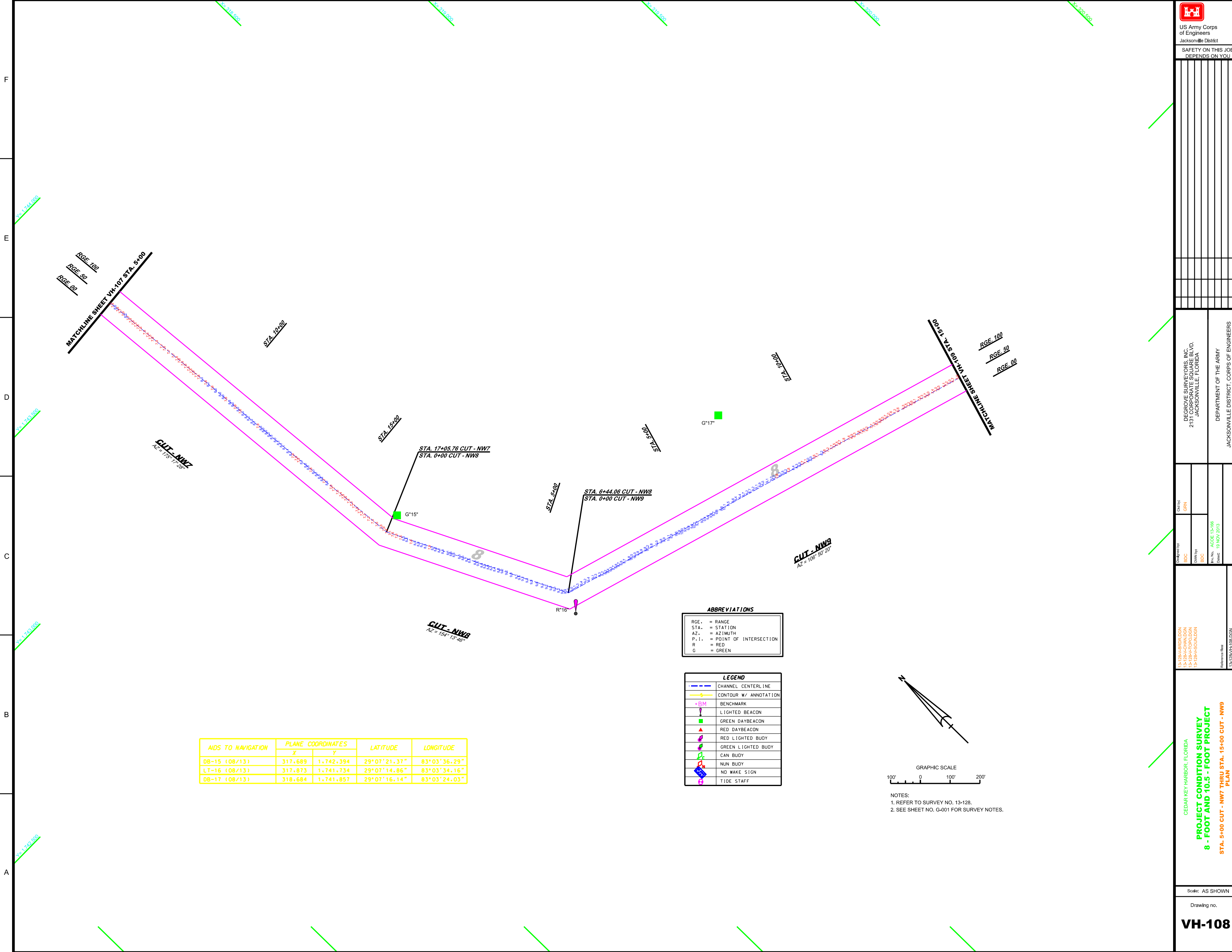

AIDS TO NAVIGATION	PLANE COORDINATES		LATITUDE	LONGITUDE
	X	Y		
DB-15 (08/13)	317.689	1,742,394	29°07'21.37"	83°03'36.29"
LT-16 (08/13)	317.873	1,741,734	29°07'14.86"	83°03'34.16"
DB-17 (08/13)	318.684	1,741,857	29°07'16.14"	83°03'24.03"

RGE.	=	RANGE
STA.	=	STATION
AZ.	=	AZIMUTH
P.I.	=	POINT OF INTERSECTION
R	=	RED
G	=	GREEN

	CHANNEL CENTERLINE
	CONTOUR W/ ANNOTATION
	BENCHMARK
	LIGHTED BEACON
	GREEN DAYBEACON
	RED DAYBEACON
	RED LIGHTED BUOY
	GREEN LIGHTED BUOY
	CAN BUOY
	NUN BUOY
	NO WAKE SIGN
	TIDE STAFF

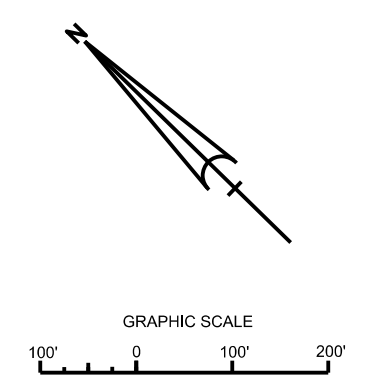

NOTES:
1. REFER TO SURVEY NO. 13-128.
2. SEE SHEET NO. G-001 FOR SURVEY NOTES.

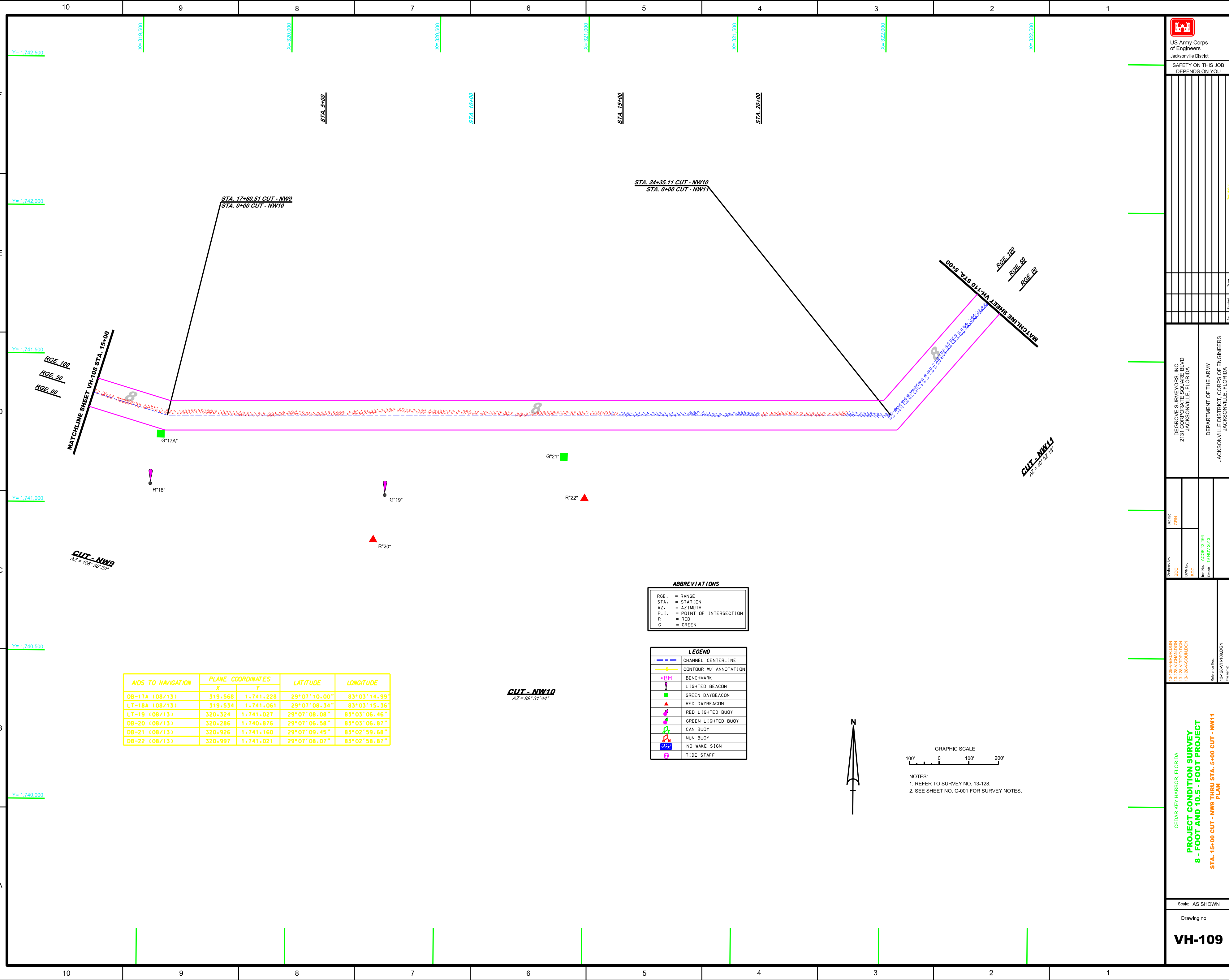

AIDS TO NAVIGATION	PLANE COORDINATES		LATITUDE	LONGITUDE
	X	Y		
DB-17A (08/13)	319.568	1,741.228	29°07'10.00"	83°03'14.99"
LT-18A (08/13)	319.554	1,741.061	29°07'08.34"	83°03'15.36"
LT-19 (08/13)	320.324	1,741.027	29°07'08.08"	83°03'06.46"
DB-20 (08/13)	320.286	1,740.876	29°07'06.58"	83°03'06.87"
DB-21 (08/13)	320.926	1,741.160	29°07'09.45"	83°02'59.68"
DB-22 (08/13)	320.997	1,741.021	29°07'08.07"	83°02'58.87"

ABBREVIATIONS

RGE.	=	RANGE
STA.	=	STATION
AZ.	=	AZIMUTH
P. I.	=	POINT OF INTERSECTION
R	=	RED
G	=	GREEN

LEGEND

	CHANNEL CENTERLINE
	CONTOUR W/ ANNOTATION
	BENCHMARK
	LIGHTED BEACON
	GREEN DAYBEACON
	RED DAYBEACON
	RED LIGHTED BUOY
	GREEN LIGHTED BUOY
	CAN BUOY
	NUN BUOY
	NO WAKE SIGN
	TIDE STAFF

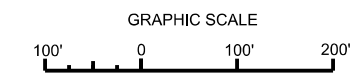

NOTES:
1. REFER TO SURVEY NO. 13-128.
2. SEE SHEET NO. G-001 FOR SURVEY NOTES.

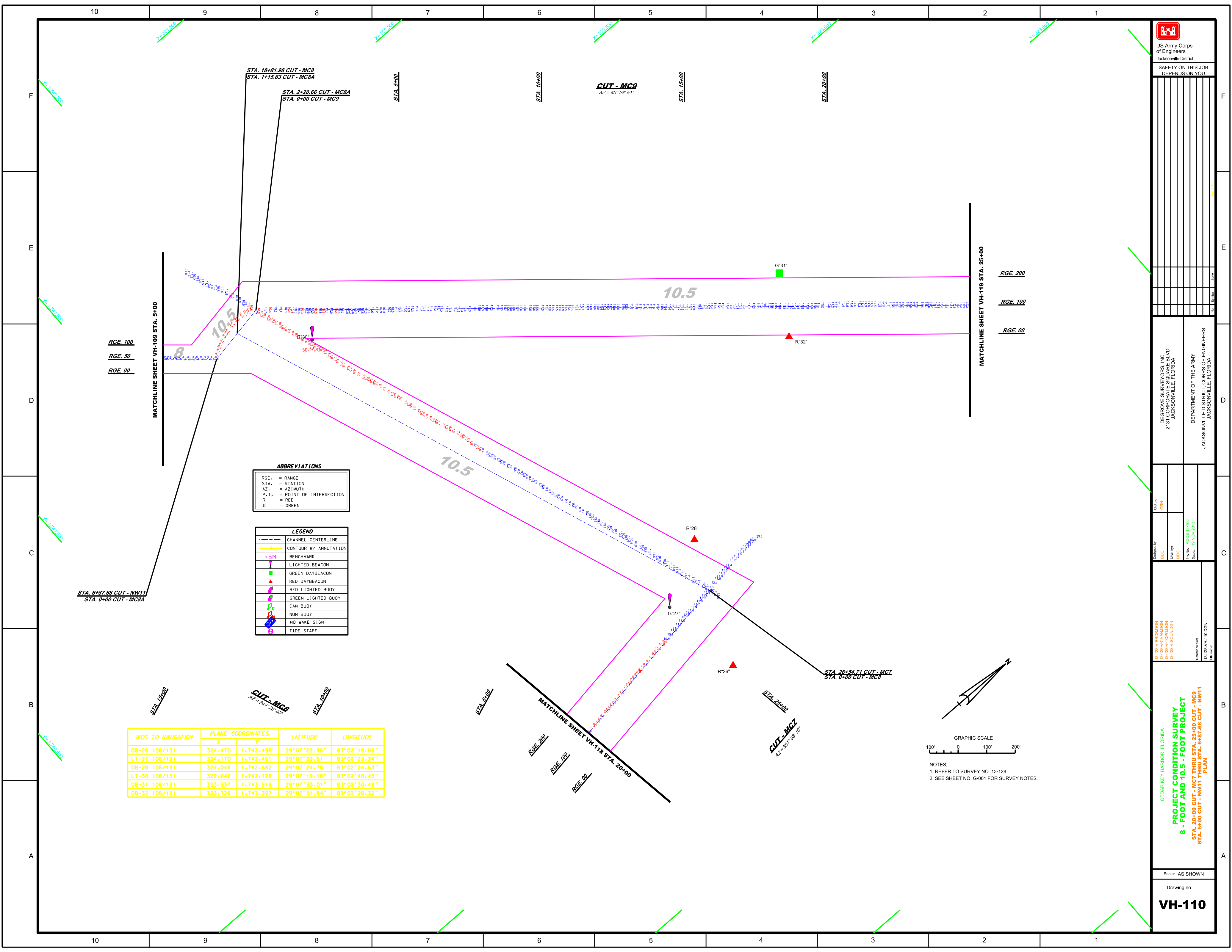

ABBREVIATIONS

RGE.	= RANGE
STA.	= STATION
AZ.	= AZIMUTH
P.I.	= POINT OF INTERSECTION
R	= RED
G	= GREEN

LEGEND

	CHANNEL CENTERLINE
	CONTOUR W/ ANNOTATION
	BENCHMARK
	LIGHTED BUOY
	GREEN DAYBEACON
	RED DAYBEACON
	RED LIGHTED BUOY
	GREEN LIGHTED BUOY
	CAN BUOY
	NUN BUOY
	NO WAKE SIGN
	TIDE STAFF

AIDS TO NAVIGATION	PLANE COORDINATES		LATITUDE	LONGITUDE
	X	Y		
08-26 (08/13)	324.470	1.742.496	29°07'22.98"	83°02'19.86"
LT-27 (08/13)	324.170	1.742.461	29°07'22.61"	83°02'23.24"
08-28 (08/13)	324.048	1.742.682	29°07'24.78"	83°02'24.63"
LT-30 (08/13)	322.642	1.742.128	29°07'19.18"	83°02'40.43"
08-31 (08/13)	323.537	1.743.518	29°07'33.01"	83°02'30.48"
08-32 (08/13)	323.728	1.743.397	29°07'31.84"	83°02'28.32"

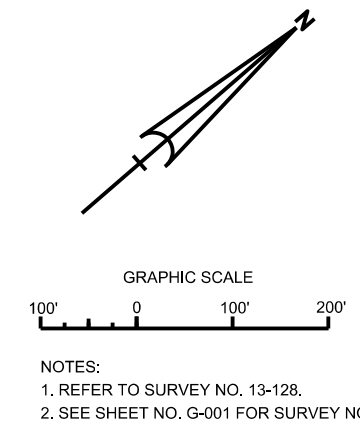

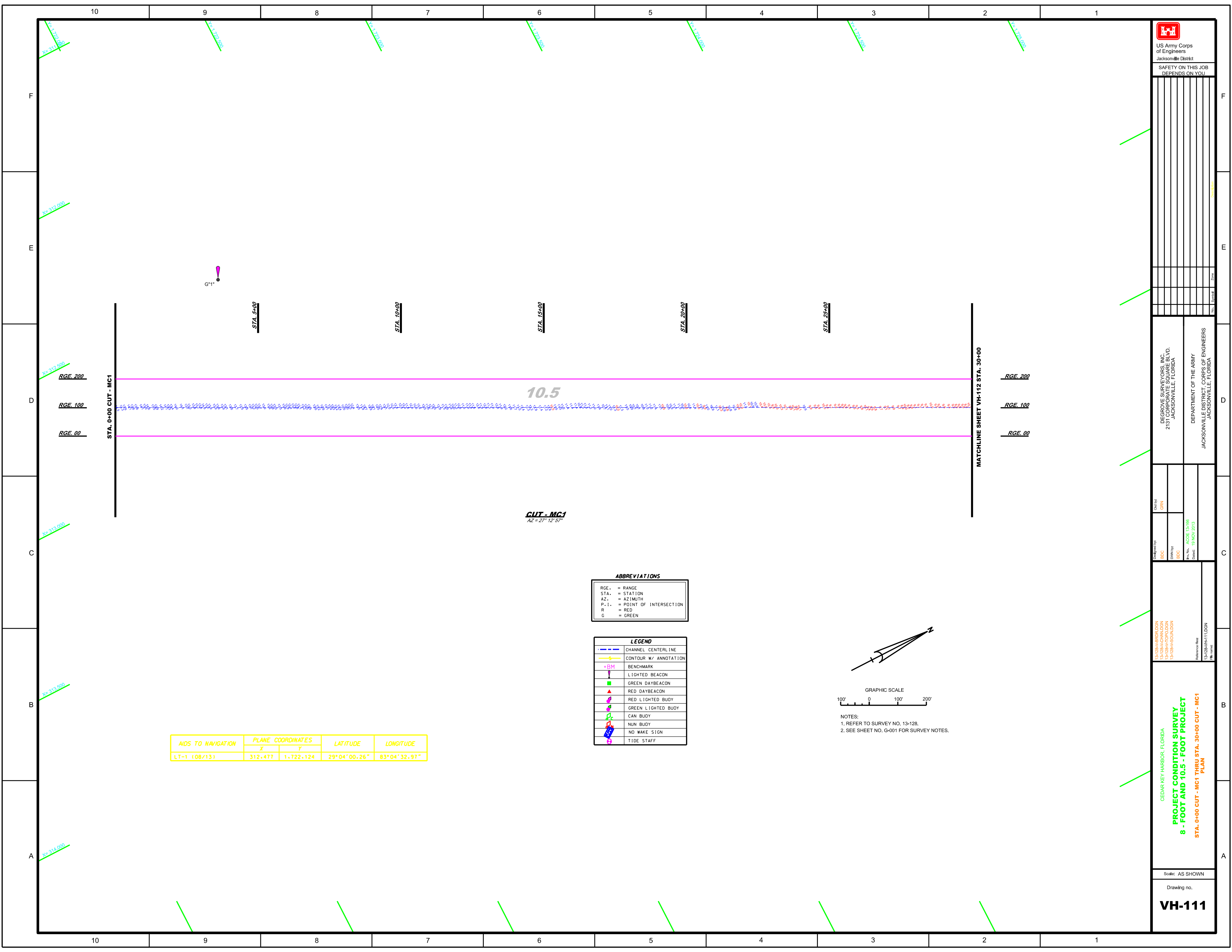

AIDS TO NAVIGATION	PLANE COORDINATES		LATITUDE	LONGITUDE
	X	Y		
LT-1 (08/13)	312.477	1.722.124	29°04'00.26"	83°04'32.97"

ABBREVIATIONS

RGE.	=	RANGE
STA.	=	STATION
AZ.	=	AZIMUTH
P.I.	=	POINT OF INTERSECTION
R	=	RED
G	=	GREEN

LEGEND

	CHANNEL CENTERLINE
	CONTOUR W/ ANNOTATION
	BENCHMARK
	LIGHTED BEACON
	GREEN DAYBEACON
	RED DAYBEACON
	RED LIGHTED BUOY
	GREEN LIGHTED BUOY
	CAN BUOY
	NUN BUOY
	NO WAKE SIGN
	TIDE STAFF

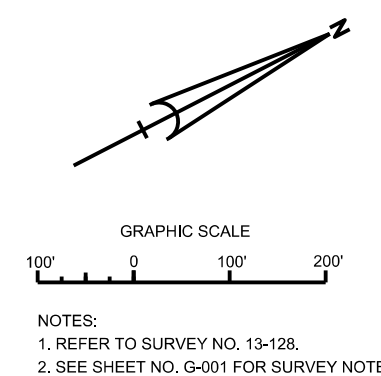

 US Army Corps of Engineers Jacksonville District SAFETY ON THIS JOB DEPENDS ON YOU	
DEGREE SURVEYORS, INC. 2131 LOCKPORT BLVD. JACKSONVILLE, FLORIDA	
DEPARTMENT OF THE ARMY JACKSONVILLE DISTRICT, CORPS OF ENGINEERS JACKSONVILLE, FLORIDA	
Checked By: GBN	Drawn By: BPC
Designed By: BPC	File No.: AGCE 13-128
13-128-ABR/DLGN 13-128-ACH/DLGN 13-128-ASO/DLGN	Reference File: 13-128-VH-111.DGN File Name:
CEDAR KEY HARBOR, FLORIDA PROJECT CONDITION SURVEY 8 - FOOT AND 10.5 - FOOT PROJECT STA. 0+00 CUT - MC1 THRU STA. 30+00 CUT - MC1 PLAN	
Scale: AS SHOWN Drawing no. VH-111	

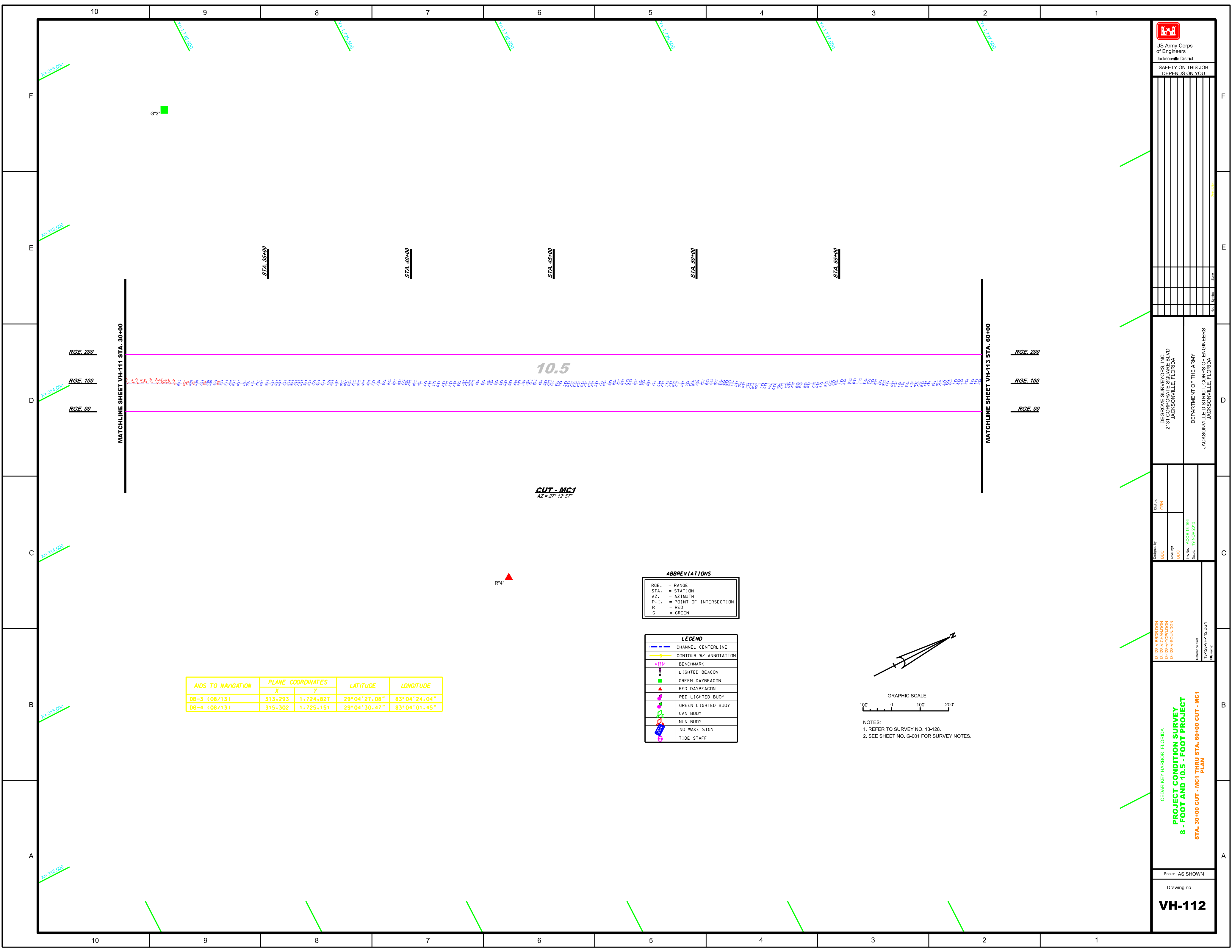

AIDS TO NAVIGATION	PLANE COORDINATES		LATITUDE	LONGITUDE
	X	Y		
DB-3 (08/13)	313,293	1,724,827	29°04'27.08"	83°04'24.04"
DB-4 (08/13)	315,302	1,725,151	29°04'30.47"	83°04'01.45"

ABBREVIATIONS

RGE.	= RANGE
STA.	= STATION
AZ.	= AZIMUTH
P. I.	= POINT OF INTERSECTION
R	= RED
G	= GREEN

LEGEND

	CHANNEL CENTERLINE
	CONTOUR W/ ANNOTATION
	BENCHMARK
	LIGHTED BEACON
	GREEN DAYBEACON
	RED DAYBEACON
	RED LIGHTED BUOY
	GREEN LIGHTED BUOY
	CAN BUOY
	NUN BUOY
	NO WAKE SIGN
	TIDE STAFF

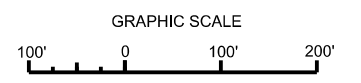
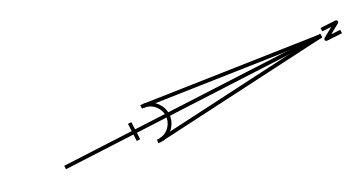

NOTES:
 1. REFER TO SURVEY NO. 13-128.
 2. SEE SHEET NO. G-001 FOR SURVEY NOTES.



US Army Corps of Engineers
 Jacksonville District

SAFETY ON THIS JOB
 DEPENDS ON YOU

DEGROVE SURVEYORS, INC.
 2131 LOCKPORT BLVD.
 JACKSONVILLE, FLORIDA

DEPARTMENT OF THE ARMY
 JACKSONVILLE DISTRICT, CORPS OF ENGINEERS
 JACKSONVILLE, FLORIDA

Checked by: GRN
 Designed by: BDC
 DWN by: BDC
 File No.: ACCE-15-188
 Date: 19 NOV 2013

13-128A-BRDLDGN
 13-128A-CHANDGN
 13-128A-SOULDGN

CEDAR KEY HARBOR, FLORIDA
PROJECT CONDITION SURVEY
8 - FOOT AND 10.5 - FOOT PROJECT
 STA. 30+00 CUT - MC1 THRU STA. 60+00 CUT - MC1
 PLAN

Scale: AS SHOWN
 Drawing no.
VH-112

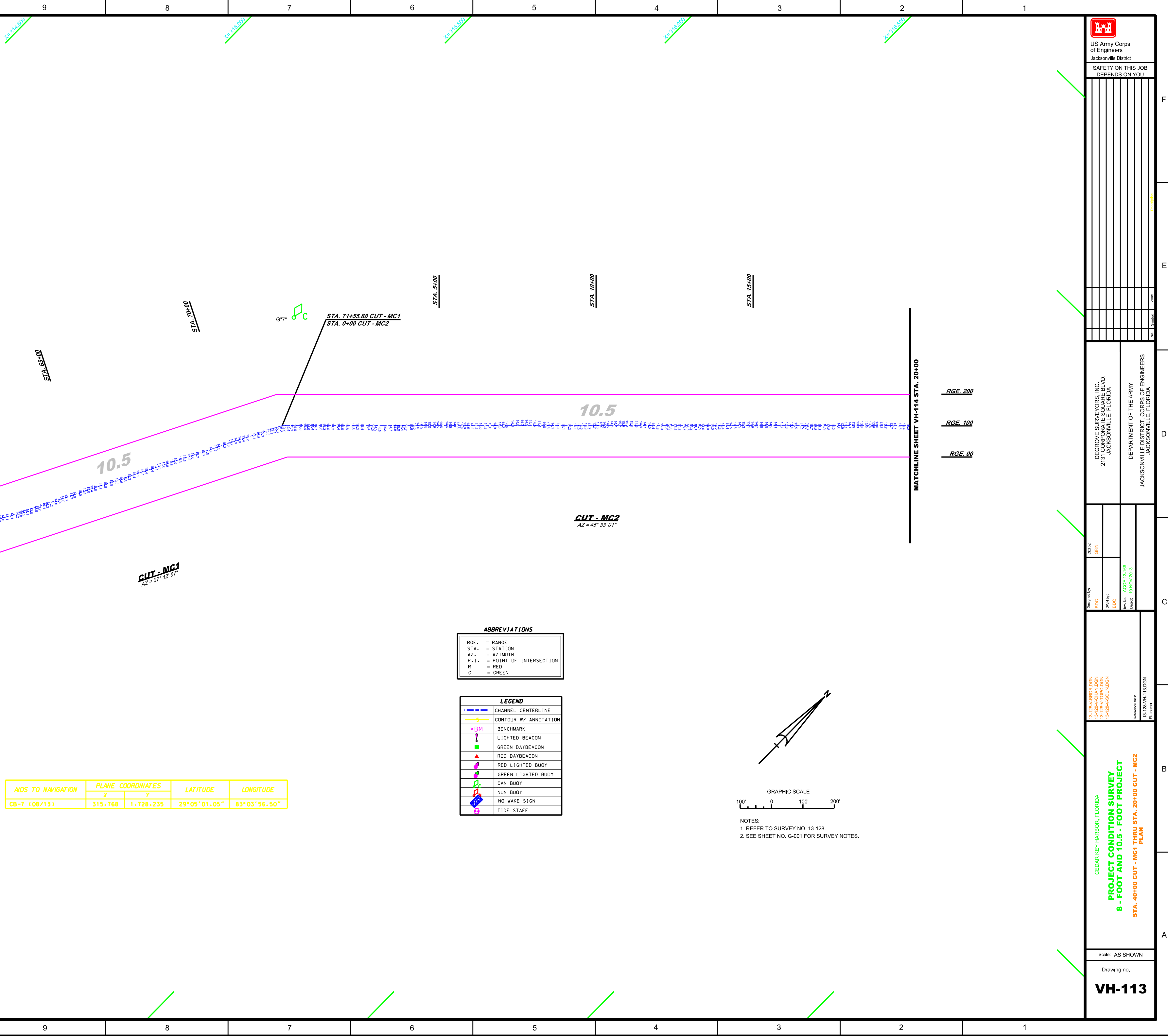

ABBREVIATIONS

RGE.	= RANGE
STA.	= STATION
AZ.	= AZIMUTH
P.I.	= POINT OF INTERSECTION
R.	= RED
G.	= GREEN

LEGEND

---	CHANNEL CENTERLINE
---	CONTOUR W/ ANNOTATION
+BM	BENCHMARK
⚓	LIGHTED BEACON
■	GREEN DAYBEACON
▲	RED DAYBEACON
⚓	RED LIGHTED BUOY
⚓	GREEN LIGHTED BUOY
⚓	CAN BUOY
⚓	NUN BUOY
⚓	NO WAKE SIGN
⚓	TIDE STAFF

AIDS TO NAVIGATION	PLANE COORDINATES		LATITUDE	LONGITUDE
	X	Y		
CB-7 (08/13)	315.768	1.728.235	29°05'01.05"	83°03'56.50"

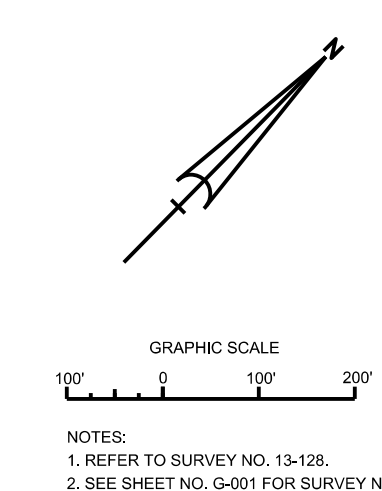



US Army Corps of Engineers
Jacksonville District

SAFETY ON THIS JOB
DEPENDS ON YOU

No.	Revised	By	Date
1			
2			
3			
4			
5			
6			
7			
8			
9			
10			

RESOLVE SURVEYORS, INC.
213 CORPORATE SQUARE BLVD.
JACKSONVILLE, FLORIDA
DEPARTMENT OF THE ARMY
JACKSONVILLE DISTRICT, CORPS OF ENGINEERS
JACKSONVILLE, FLORIDA

Scale: AS SHOWN
Drawing no.

CEDAR KEY HARBOR, FLORIDA
PROJECT CONDITION SURVEY
8 - FOOT AND 10.5 - FOOT PROJECT
STA. 20+00 CUT - MC3 THRU STA. 15+00 CUT - MC3
PLAN

13-128-A-BR/BD/CD
13-128-A-TO/PO/CD
13-128-A-SOUND/CD
13-128-B-VH-114/DGN

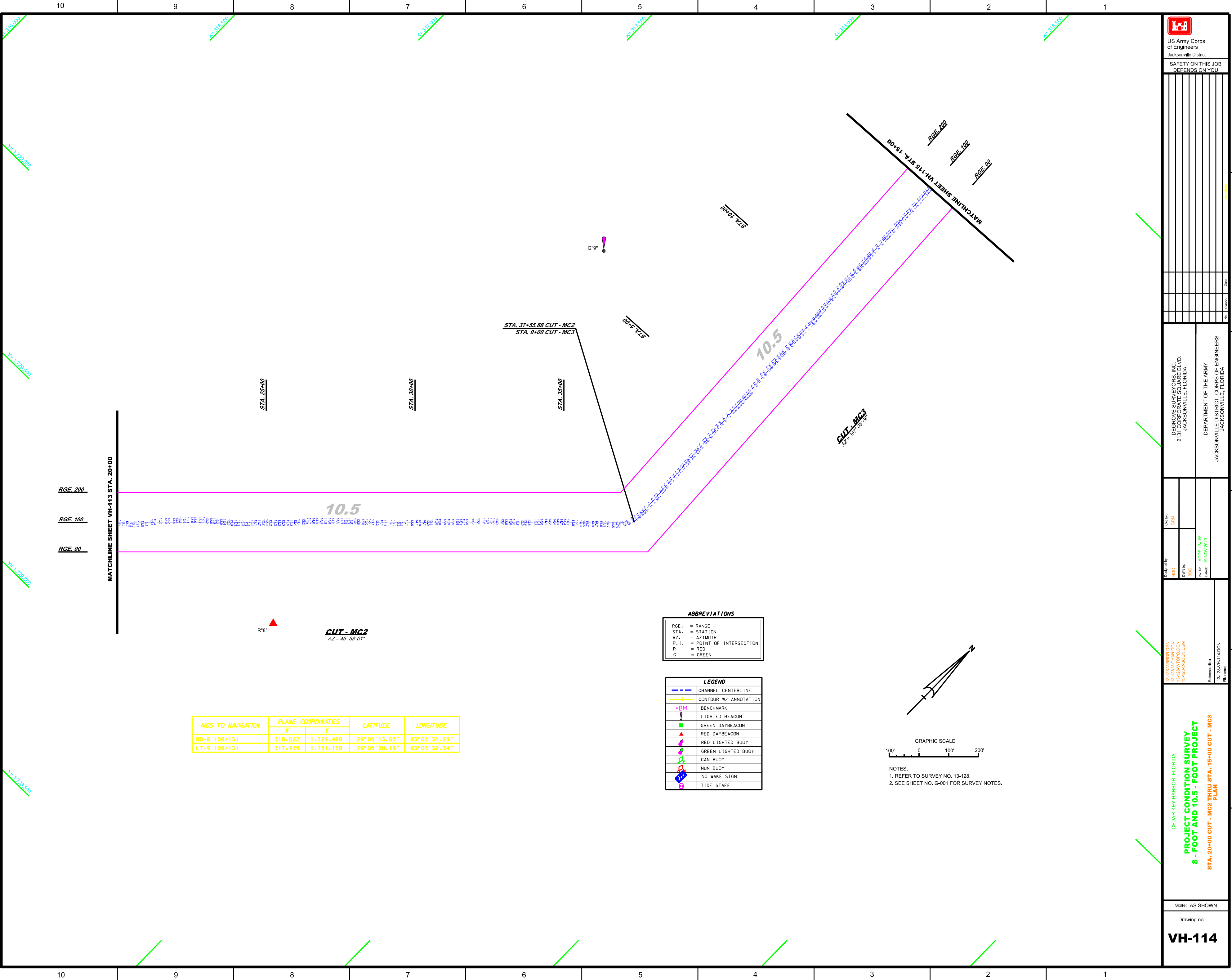

AIDS TO NAVIGATION	PLANE COORDINATES		LATITUDE	LONGITUDE
	X	Y		
OB-8 (08/13)	318.022	1.729.488	29°05'13.65"	83°03'31.23"
LT-9 (08/13)	317.939	1.731.158	29°05'30.18"	83°03'32.34"

RGE.	= RANGE
STA.	= STATION
AZ.	= AZIMUTH
P. I.	= POINT OF INTERSECTION
R	= RED
G	= GREEN

[Blue dashed line]	CHANNEL CENTER LINE
[Yellow dashed line]	CONTOUR W/ ANNOTATION
[+BM]	BENCHMARK
[L]	LIGHTED BEACON
[Green square]	GREEN DAYBEACON
[Red triangle]	RED DAYBEACON
[Red circle]	RED LIGHTED BUOY
[Green circle]	GREEN LIGHTED BUOY
[Can buoy]	CAN BUOY
[Mun buoy]	MUN BUOY
[No wake sign]	NO WAKE SIGN
[Tide staff]	TIDE STAFF

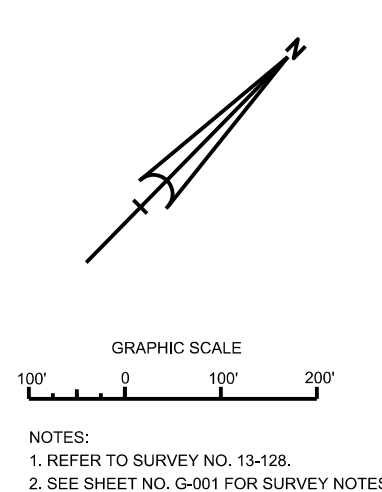

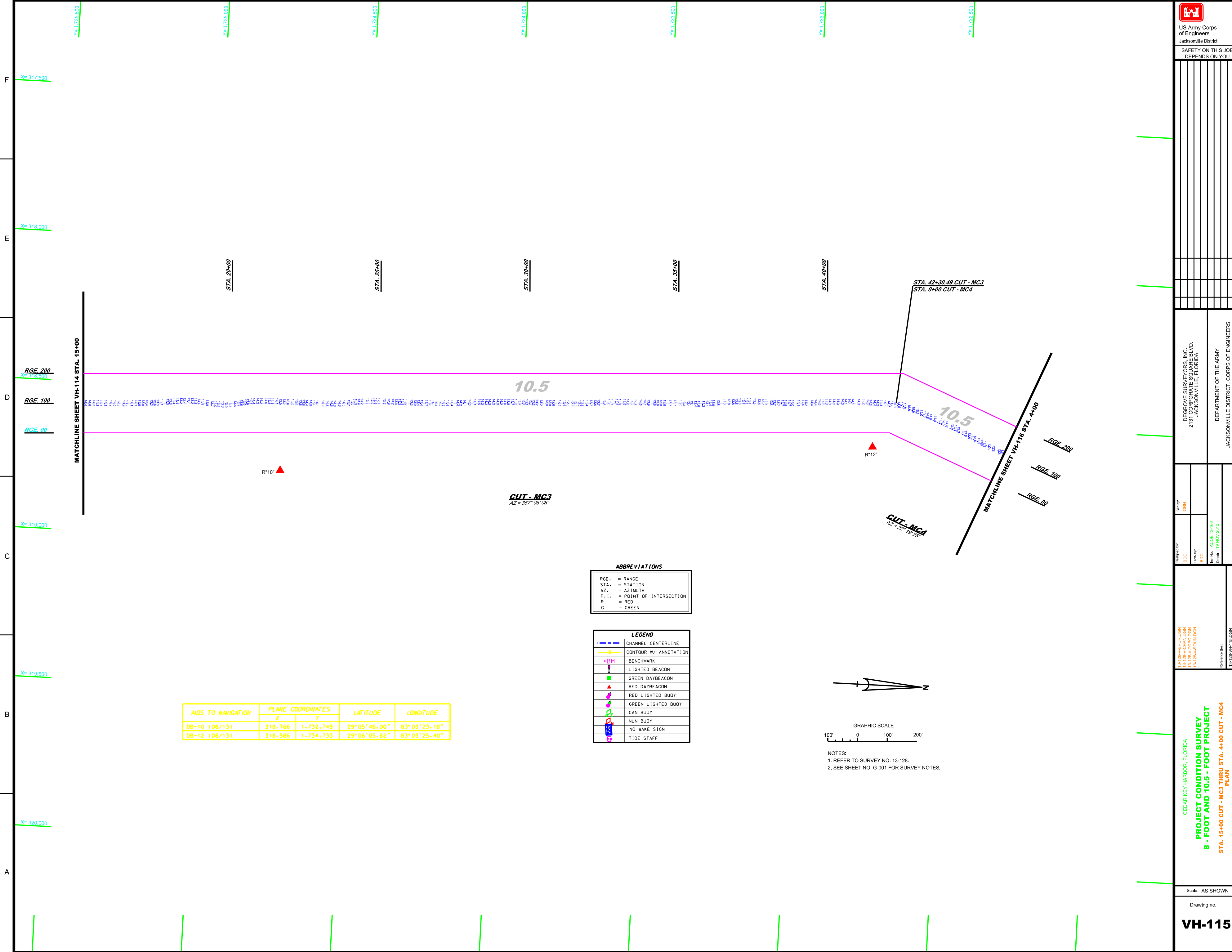

AIDS TO NAVIGATION	PLANE COORDINATES		LATITUDE	LONGITUDE
	X	Y		
08-10 (08/13)	318,766	1,732,749	29°05'46.00"	83°03'23.18"
08-12 (08/13)	318,586	1,734,733	29°06'05.62"	83°03'25.40"

ABBREVIATIONS

- RGE. = RANGE
- STA. = STATION
- AZ. = AZIMUTH
- P.I. = POINT OF INTERSECTION
- R = RED
- G = GREEN

LEGEND

- CHANNEL CENTERLINE
- CONTOUR W/ ANNOTATION
- BENCHMARK
- LIGHTED BEACON
- GREEN DAYBEACON
- RED DAYBEACON
- RED LIGHTED BUOY
- GREEN LIGHTED BUOY
- CAN BUOY
- NUN BUOY
- NO WAKE SIGN
- TIDE STAFF

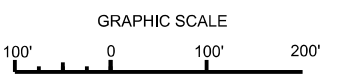

NOTES:
 1. REFER TO SURVEY NO. 13-128.
 2. SEE SHEET NO. G-001 FOR SURVEY NOTES.

US Army Corps of Engineers
 Jacksonville District
 SAFETY ON THIS JOB
 DEPENDS ON YOU

No.	Symbol	Zone

DESIGNEE:
 DEGREVE SURVEYORS, INC.
 213 S. W. 12th St.
 JACKSONVILLE, FLORIDA

DESIGNED BY:
 BDC

DRAWN BY:
 BDC

DATE:
 19 NOV 2013

CEDAR KEY HARBOR, FLORIDA
PROJECT CONDITION SURVEY
8 - FOOT AND 10.5 - FOOT PROJECT
STA. 15+00 CUT - MC3 THRU STA. 44+00 CUT - MC4
PLAN

Scale: AS SHOWN
 Drawing no.
VH-115

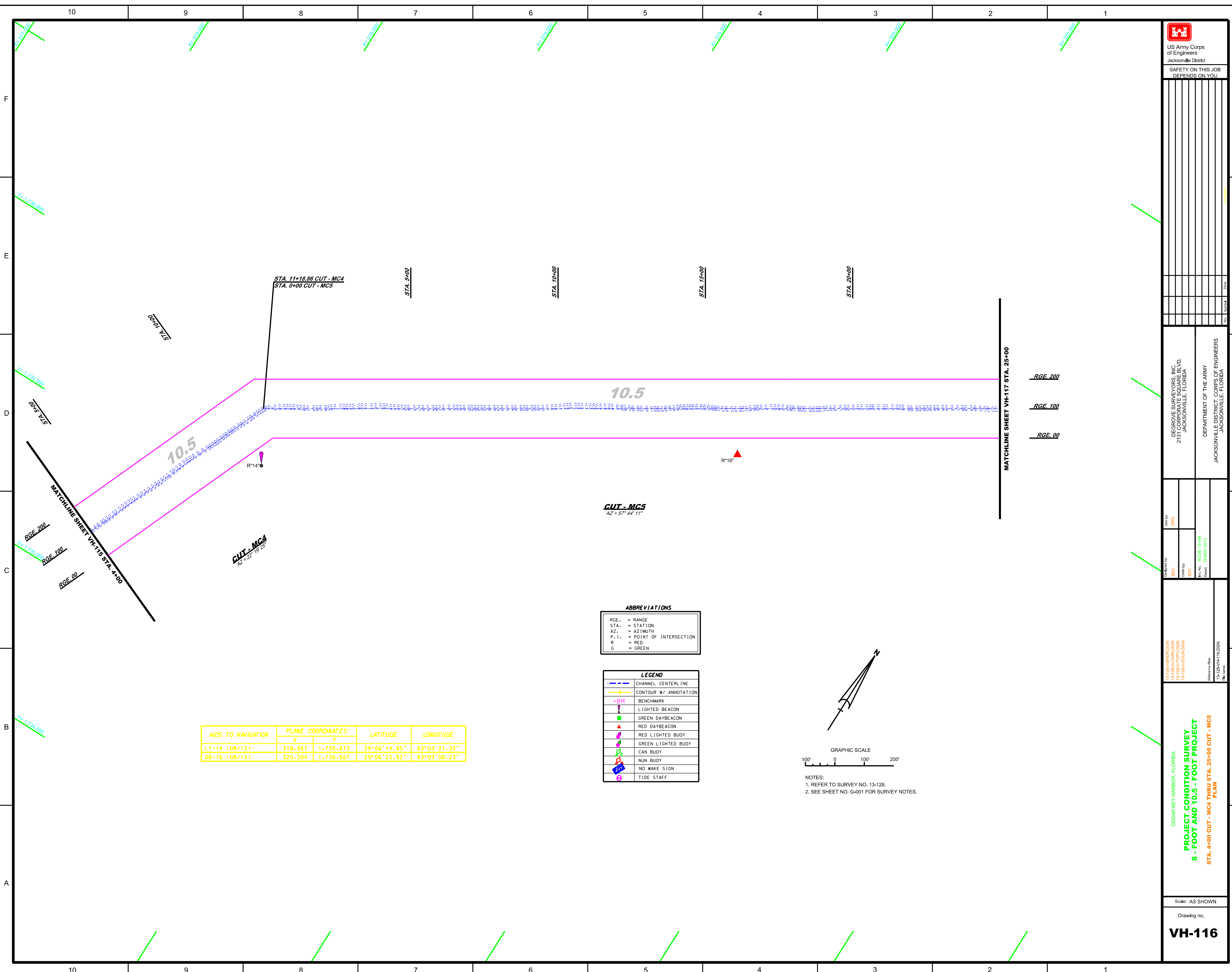

AIDS TO NAVIGATION	PLANE COORDINATES		LATITUDE	LONGITUDE
	X	Y		
LT-14 (08/13)	318,957	1,735,673	29°06'14.95"	83°03'21.32"
OB-16 (08/13)	320,304	1,736,567	29°06'23.92"	83°03'06.23"

ABBREVIATIONS

RGE.	= RANGE
STA.	= STATION
AZ.	= AZIMUTH
P.I.	= POINT OF INTERSECTION
R	= RED
G	= GREEN

LEGEND

	CHANNEL CENTERLINE
	CONTOUR W/ ANNOTATION
	BENCHMARK
	LIGHTED BEACON
	GREEN DAYBEACON
	RED DAYBEACON
	RED LIGHTED BUOY
	GREEN LIGHTED BUOY
	CAN BUDY
	NUN BUDY
	NO WAKE SIGN
	TIDE STAFF

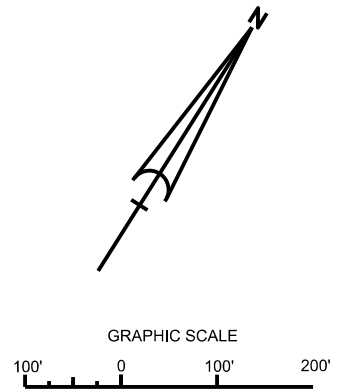

NOTES:
 1. REFER TO SURVEY NO. 13-128.
 2. SEE SHEET NO. G-001 FOR SURVEY NOTES.

 US Army Corps of Engineers Jacksonville District SAFETY ON THIS JOB DEPENDS ON YOU	
<p style="font-size: small;">DESIGNED BY: BDC DRAWN BY: BDC CHECKED BY: BDC DATE: 19 NOV 2013</p> <p style="font-size: x-small;">13-128A-BR/OLDON 13-128A-C/D/OLDON 13-128A-S/D/OLDON</p> <p style="font-size: x-small;">Reference files: 13-128A-H-16.DGN 13-128A-H-16.DGN</p>	<p style="font-size: small;">CHECKED BY: GRN DATE: 19 NOV 2013</p> <p style="font-size: small;">DEGREE SURVEYORS, INC. 2131 LOCKPORT BLVD. JACKSONVILLE, FLORIDA</p> <p style="font-size: small;">DEPARTMENT OF THE ARMY JACKSONVILLE DISTRICT, CORPS OF ENGINEERS JACKSONVILLE, FLORIDA</p>
<p>PROJECT CONDITION SURVEY 8 - FOOT AND 10.5 - FOOT PROJECT STA. 4+00 CUT - MC4 THRU STA. 25+00 CUT - MC5 PLAN</p> <p style="font-size: x-small;">CEDAR KEY HARBOR, FLORIDA</p> <p style="font-size: x-small;">Scale: AS SHOWN</p> <p style="font-size: x-small;">Drawing no. VH-116</p>	

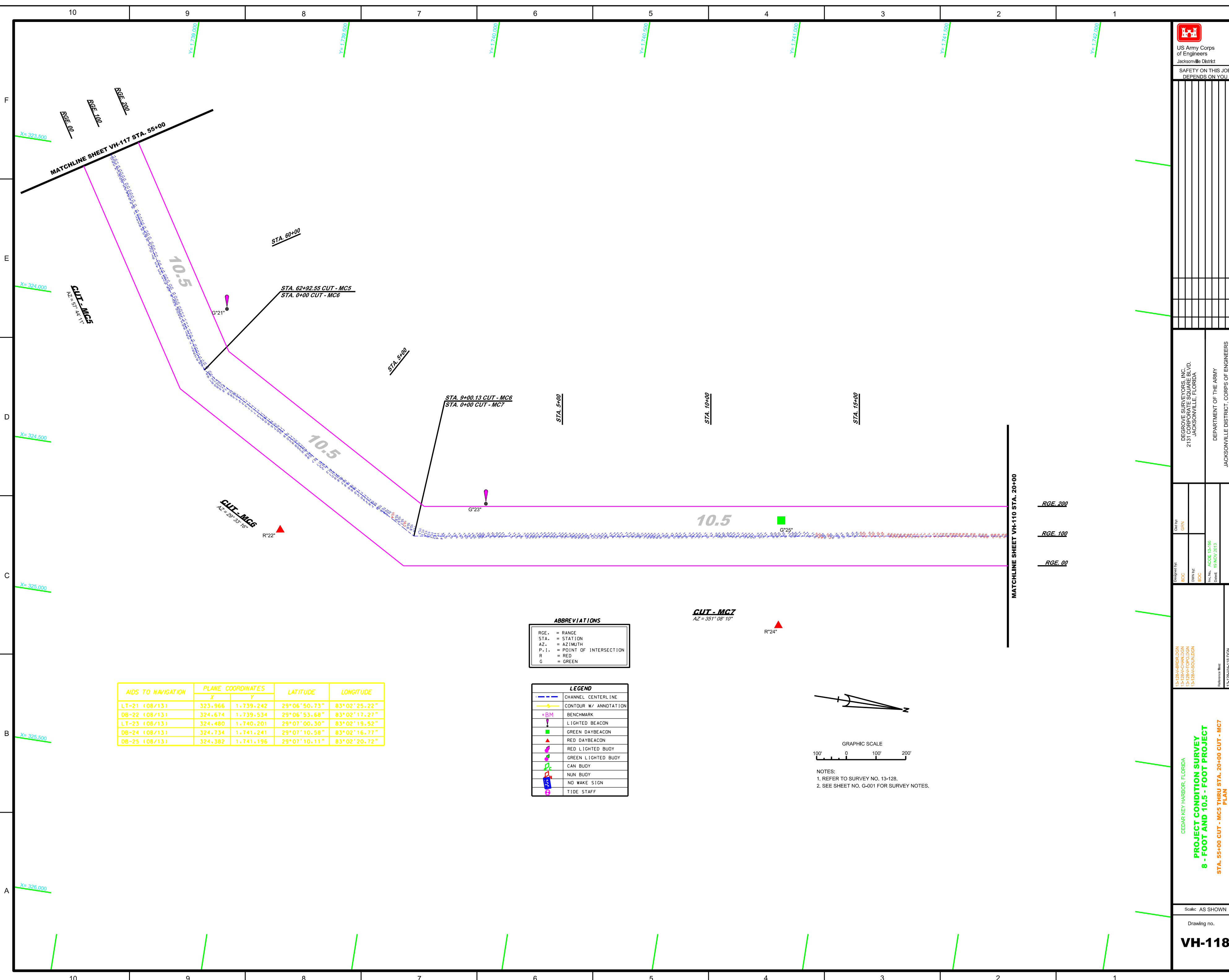

AIDS TO NAVIGATION	PLANE COORDINATES		LATITUDE	LONGITUDE
	X	Y		
LT-21 (08/13)	323.966	1.739.242	29°06'50.73"	83°02'25.22"
DB-22 (08/13)	324.674	1.739.534	29°06'53.68"	83°02'17.27"
LT-23 (08/13)	324.480	1.740.201	29°07'00.30"	83°02'19.52"
DB-24 (08/13)	324.734	1.741.241	29°07'10.58"	83°02'16.77"
DB-25 (08/13)	324.382	1.741.196	29°07'10.11"	83°02'20.72"

ABBREVIATIONS

RGE.	=	RANGE
STA.	=	STATION
AZ.	=	AZIMUTH
P.I.	=	POINT OF INTERSECTION
R	=	RED
G	=	GREEN

LEGEND

[Symbol]	CHANNEL CENTERLINE
[Symbol]	CONTOUR W/ ANNOTATION
[Symbol]	BENCHMARK
[Symbol]	LIGHTED BEACON
[Symbol]	GREEN DAYBEACON
[Symbol]	RED DAYBEACON
[Symbol]	RED LIGHTED BUOY
[Symbol]	GREEN LIGHTED BUOY
[Symbol]	CAN BUOY
[Symbol]	NUN BUOY
[Symbol]	NO WAKE SIGN
[Symbol]	TIDE STAFF

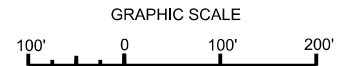

- NOTES:
 1. REFER TO SURVEY NO. 13-128.
 2. SEE SHEET NO. G-001 FOR SURVEY NOTES.

 US Army Corps of Engineers Jacksonville District SAFETY ON THIS JOB DEPENDS ON YOU	<table border="0" style="width:100%;"> <tr> <td style="width:50%; font-size: 8px;"> DESIGNED BY: BDC CHECKED BY: BDC DATE: 19 NOV 2013 </td> <td style="width:50%; font-size: 8px;"> DRAWN BY: GRN DATE: 19 NOV 2013 </td> </tr> </table>	DESIGNED BY: BDC CHECKED BY: BDC DATE: 19 NOV 2013	DRAWN BY: GRN DATE: 19 NOV 2013
DESIGNED BY: BDC CHECKED BY: BDC DATE: 19 NOV 2013	DRAWN BY: GRN DATE: 19 NOV 2013		
CEDAR KEY HARBOR, FLORIDA PROJECT CONDITION SURVEY 8 - FOOT AND 10.5 - FOOT PROJECT STA. 55+00 CUT - MC5 THRU STA. 20+00 CUT - MC7 PLAN			
<table border="0" style="width:100%;"> <tr> <td style="width:50%;"> DEGREE SURVEYORS, INC. 2131 CORKROWE SQUARE BLVD. JACKSONVILLE, FLORIDA </td> <td style="width:50%;"> DEPARTMENT OF THE ARMY JACKSONVILLE DISTRICT, CORPS OF ENGINEERS JACKSONVILLE, FLORIDA </td> </tr> </table>		DEGREE SURVEYORS, INC. 2131 CORKROWE SQUARE BLVD. JACKSONVILLE, FLORIDA	DEPARTMENT OF THE ARMY JACKSONVILLE DISTRICT, CORPS OF ENGINEERS JACKSONVILLE, FLORIDA
DEGREE SURVEYORS, INC. 2131 CORKROWE SQUARE BLVD. JACKSONVILLE, FLORIDA	DEPARTMENT OF THE ARMY JACKSONVILLE DISTRICT, CORPS OF ENGINEERS JACKSONVILLE, FLORIDA		
<table border="0" style="width:100%;"> <tr> <td style="width:40%;"> Scale: AS SHOWN </td> <td style="width:60%;"> Drawing no. </td> </tr> </table>		Scale: AS SHOWN	Drawing no.
Scale: AS SHOWN	Drawing no.		
VH-118			

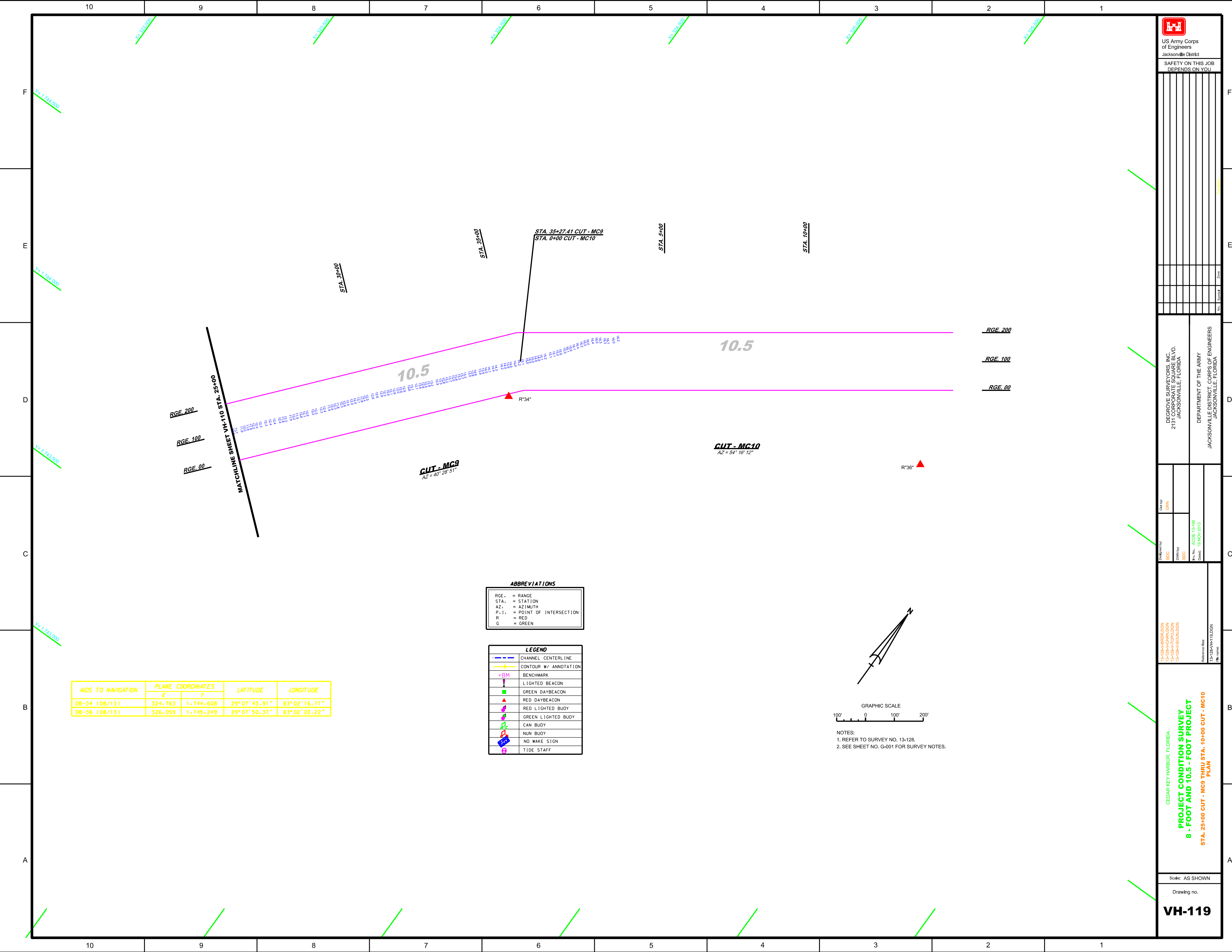

AIDS TO NAVIGATION	PLANE COORDINATES		LATITUDE	LONGITUDE
	X	Y		
DB-34 (08/13)	324.763	1.744.608	29°07'43.91"	83°02'16.77"
DB-36 (08/13)	326.059	1.745.249	29°07'50.37"	83°02'02.22"

ABBREVIATIONS

RGE.	= RANGE
STA.	= STATION
AZ.	= AZIMUTH
P.I.	= POINT OF INTERSECTION
R	= RED
G	= GREEN

LEGEND

	CHANNEL CENTER LINE
	CONTOUR W/ ANNOTATION
	BENCHMARK
	LIGHTED BEACON
	GREEN DAYBEACON
	RED DAYBEACON
	RED LIGHTED BUOY
	GREEN LIGHTED BUOY
	CAN BUOY
	NUN BUOY
	NO WAKE SIGN
	TIDE STAFF

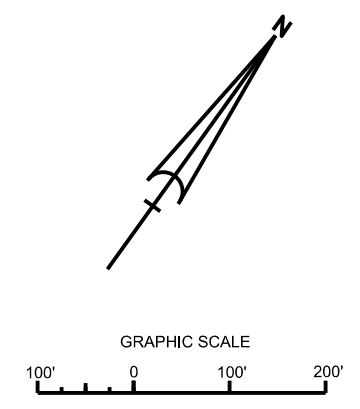

NOTES:
1. REFER TO SURVEY NO. 13-128.
2. SEE SHEET NO. G-001 FOR SURVEY NOTES.

US Army Corps of Engineers
Jacksonville District
SAFETY ON THIS JOB
DEPENDS ON YOU

DEGROVE SURVEYORS, INC.
2151 LOCKPORT BLVD.
JACKSONVILLE, FLORIDA
DEPARTMENT OF THE ARMY
JACKSONVILLE DISTRICT, CORPS OF ENGINEERS
JACKSONVILLE, FLORIDA

Checked By: GPN
Designed By: BDC
Drawn By: BDC
File No: AGCE 13-128
Date: 19 NOV 2013

13-128-ABR/DLGN
13-128-AC/HDLGN
13-128-AS/DLGN
Reference File:
13-128-AH-11E/DGN
File Name:

CEDAR KEY HARBOR, FLORIDA
PROJECT CONDITION SURVEY
8 - FOOT AND 10.5 - FOOT PROJECT
STA. 25+00 CUT - MC9 THRU STA. 10+00 CUT - MC10
PLAN

Scale: AS SHOWN
Drawing no.
VH-119