

**EGMONT CUT-2**  
AZ-283-42-22

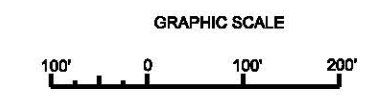

NOTES:  
1. REFER TO SURVEY NO. 13-085.  
2. SEE SHEET NO.1 FOR SURVEY NOTES.



US Army Corps of Engineers  
Jacksonville District  
SAFETY ON THIS JOB  
DEPENDS ON YOU

No.	Symbol	Description
1	N	Zone
2	A-N	ABCD

DEPARTMENT OF THE ARMY  
JACKSONVILLE DISTRICT, CORPS OF ENGINEERS  
JACKSONVILLE, FLORIDA

Designed by:	Checked by:
WALM	DVT
Drawn by:	Reviewed by:
WRM	WRM
Scale:	As Shown

LOWER TAMPA BAY  
TAMPA HARBOR, FLORIDA  
**EXAMINATION SURVEY FY13  
43 & 45 FOOT PROJECT  
PLAN**  
STA. 80+00 THRU STA. 110+00 EGMONT CUT-2







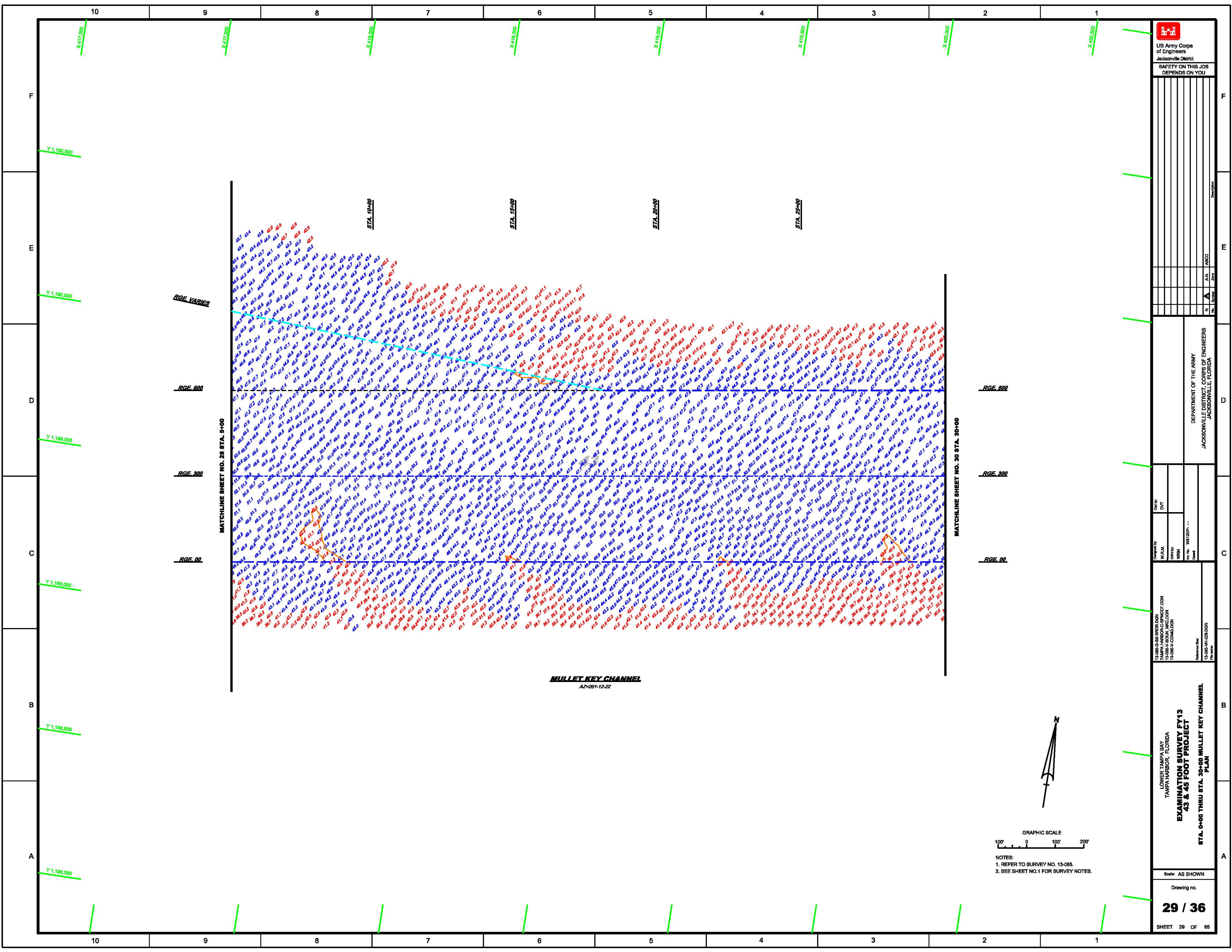

US Army Corps of Engineers  
Jacksonville District  
SAFETY ON THIS JOB  
DEPENDS ON YOU

No.	Symbol	Zone	Description
1	N	A-N	ABCD

DEPARTMENT OF THE ARMY  
JACKSONVILLE DISTRICT, CORPS OF ENGINEERS  
JACKSONVILLE, FLORIDA

Designed by: WJL/JAL  
Checked by: DVT  
Drawn by: WJL  
For Use: WJL/2013-08-14  
Date: 13-08-14

LOWER TAMPA BAY  
TAMPA HARBOR, FLORIDA  
**EXAMINATION SURVEY FY13  
43 & 45 FOOT PROJECT**  
PLAN  
STA. 0+00 THRU STA. 30+00 MULLET KEY CHANNEL

Scale: AS SHOWN  
Drawing no.  
**29 / 36**  
SHEET 29 OF 65

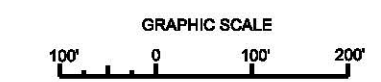
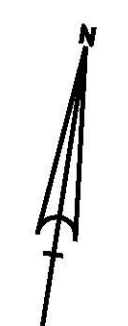

NOTES:  
1. REFER TO SURVEY NO. 13-085.  
2. SEE SHEET NO.1 FOR SURVEY NOTES.



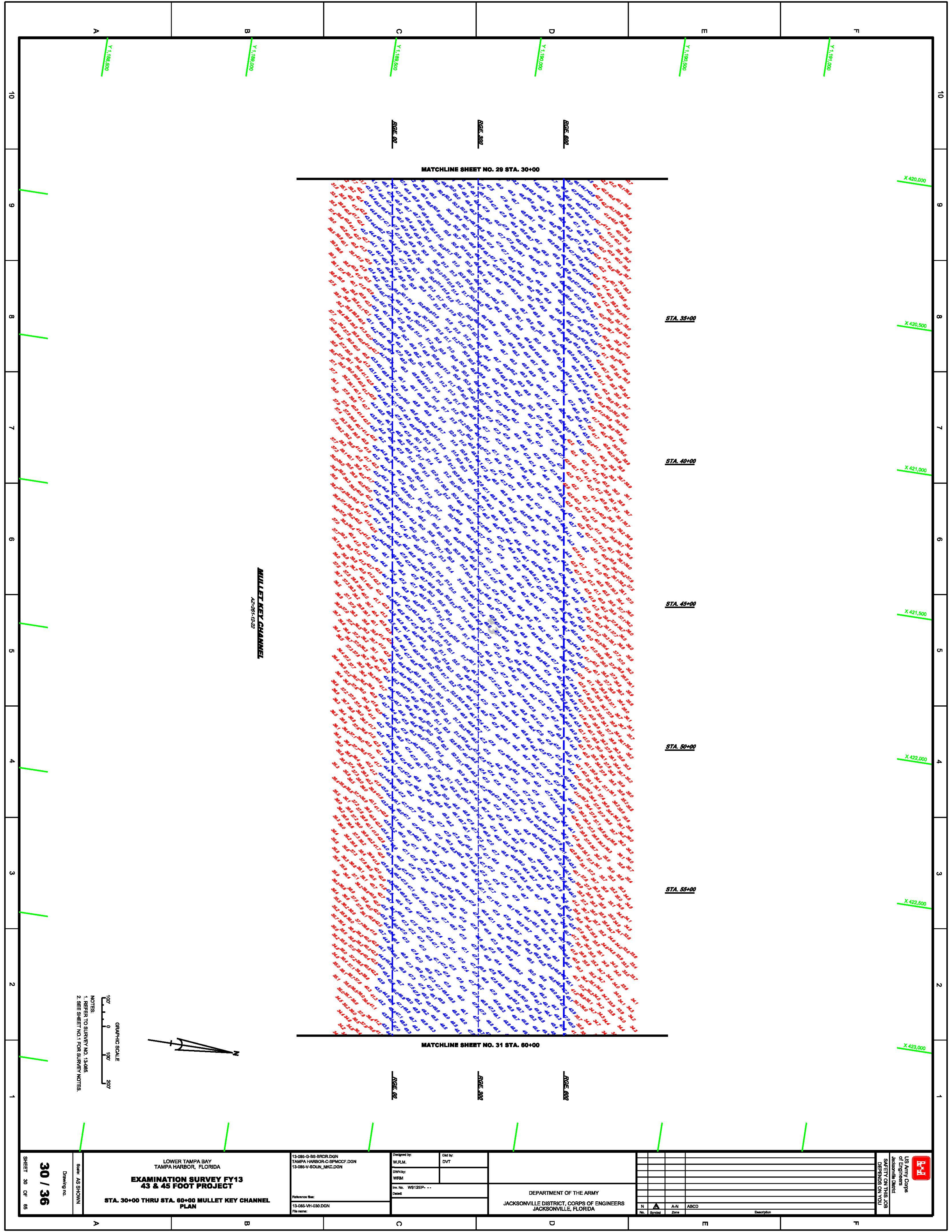

MATCHLINE SHEET NO. 29 STA. 30+00

MATCHLINE SHEET NO. 31 STA. 60+00

MULLET KEY CHANNEL  
AS-201-12-22

STA. 35+00

STA. 40+00

STA. 45+00

STA. 50+00

STA. 55+00

Y 1,188,000

Y 1,189,000

Y 1,190,000

Y 1,191,000

Y 1,192,000

Y 1,193,000

X 420,000

X 420,500

X 421,000

X 421,500

X 422,000

X 422,500

X 423,000

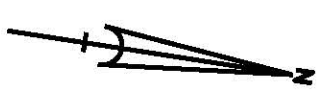

NOTES:  
1. REFER TO SURVEY NO. 13-085  
2. SEE SHEET NO. 1 FOR SURVEY NOTES.

SHEET 30 OF 36 <b>30 / 36</b>	Drawing no. Issue: AS SHOWN	LOWER TAMPA BAY TAMPA HARBOR, FLORIDA <b>EXAMINATION SURVEY FY13          43 &amp; 45 FOOT PROJECT</b> STA. 30+00 THRU STA. 60+00 MULLET KEY CHANNEL PLAN		Reference file: 13-085-VH-030.DGN File name:	Designed by: W.R.M. DWN by: WRM Inv. No: W612EP-... Date:	Ckd by: DVT	DEPARTMENT OF THE ARMY JACKSONVILLE DISTRICT, CORPS OF ENGINEERS JACKSONVILLE, FLORIDA		US Army Corps of Engineers Jacksonville District SAFETY ON THIS JOB DEPENDS ON YOU
		13-085-G-86-BRDR.DGN TAMPA HARBOR-C-SPMCCF.DGN 13-085-V-80UR_MKC.DGN	No. System Zone Description	N A-N ABCD					























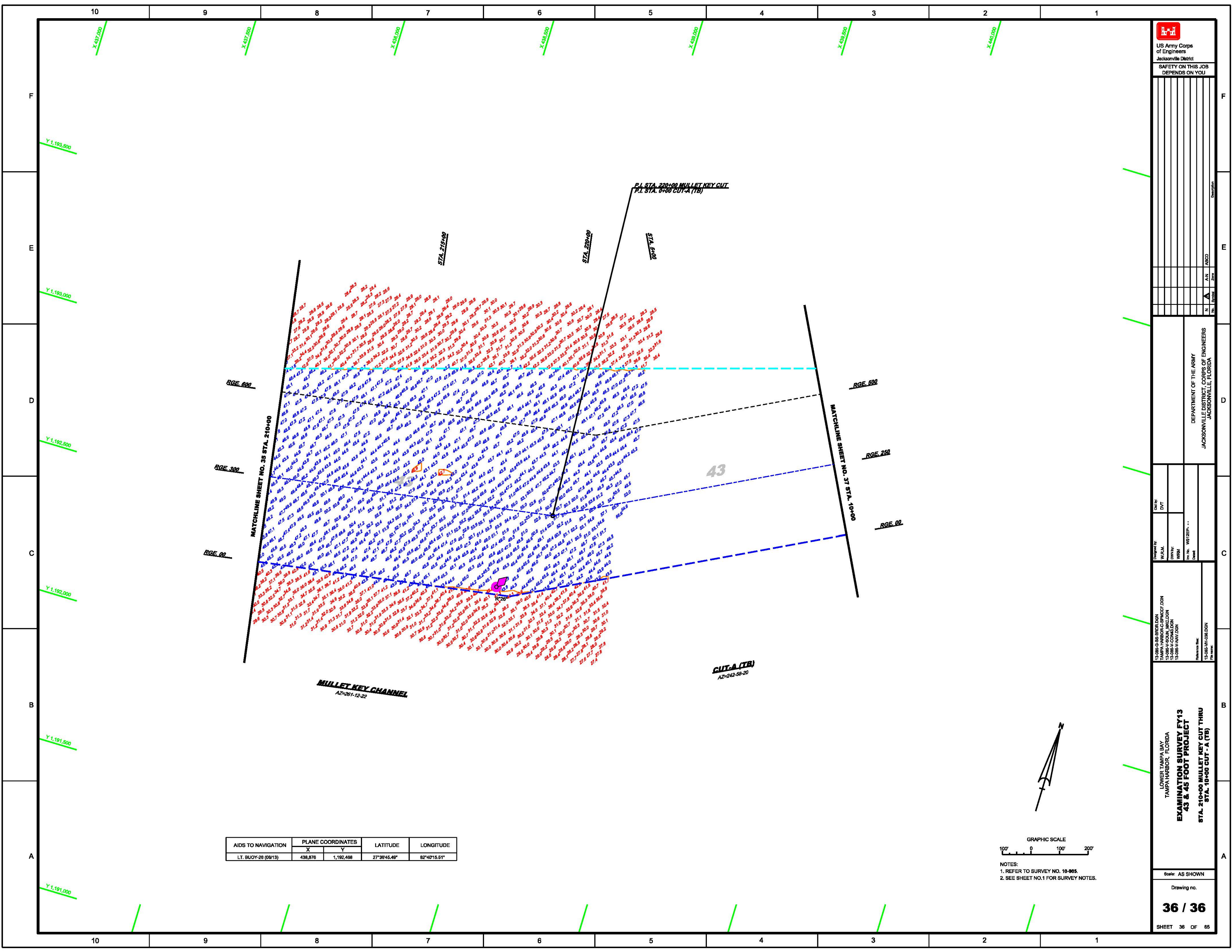

AIDS TO NAVIGATION	PLANE COORDINATES		LATITUDE	LONGITUDE
	X	Y		
LT. BUOY-28 (0813)	438,876	1,192,488	27°38'45.46"	82°40'15.51"

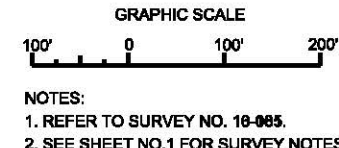

US Army Corps of Engineers  
 Jacksonville District  
**SAFETY ON THIS JOB DEPENDS ON YOU**

Zone	N	A-N	ABCD	Zone	N	A-N	ABCD	Zone	N
DEPARTMENT OF THE ARMY JACKSONVILLE DISTRICT, CORPS OF ENGINEERS JACKSONVILLE, FLORIDA									
Checked by:	DVT	Designed by:	WJL/AL	DRY/RY	WJL/AL	WJL/AL	WJL/AL	WJL/AL	WJL/AL
13-086-C-BB-SRDLGDN TAMPA HARBOR-CORPORATION 13-086-A-COMM-DON 13-086-A-NAV-DON									
<b>LOWER TAMPA BAY          TAMPA HARBOR, FLORIDA          EXAMINATION SURVEY FY13          43 &amp; 45 FOOT PROJECT          STA. 210+00 MULLET KEY CUT THRU          STA. 18+00 CUT - A (TB)</b>									
Scale: AS SHOWN									
Drawing no.									
<b>36 / 36</b>									
SHEET 36 OF 65									