

EGMONT CUT-1
AZ-263-07-00

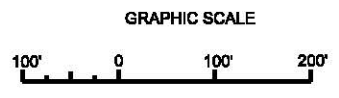
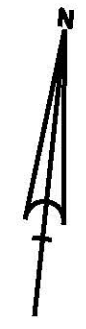

NOTES:
1. REFER TO SURVEY NO. 13-085.
2. SEE SHEET NO. 1 FOR SURVEY NOTES.

US Army Corps
of Engineers
Jacksonville District
SAFETY ON THIS JOB
DEPENDS ON YOU

No.	Symbol	Zone	Description
1	N	A-N	ABCD
2			
3			
4			
5			
6			
7			
8			
9			
10			

DEPARTMENT OF THE ARMY
JACKSONVILLE DISTRICT, CORPS OF ENGINEERS
JACKSONVILLE, FLORIDA

Designed by: WJL/JAL
Checked by: DVT
Drawn by: WJL
Reviewed by: WJL
Date: 08/13/08

13-085-C-88-BRIDLEDEN
TAMPA HARBOR-CORPORATION
13-085-A-CORPORATION

LOWER TAMPA BAY
TAMPA HARBOR, FLORIDA
**EXAMINATION SURVEY FY13
43 & 45 FOOT PROJECT
PLAN**
STA. 330+00 THRU STA. 360+00 EGMONT CUT - 1

Scale: AS SHOWN
Drawing no.
13 / 36
SHEET 13 OF 65

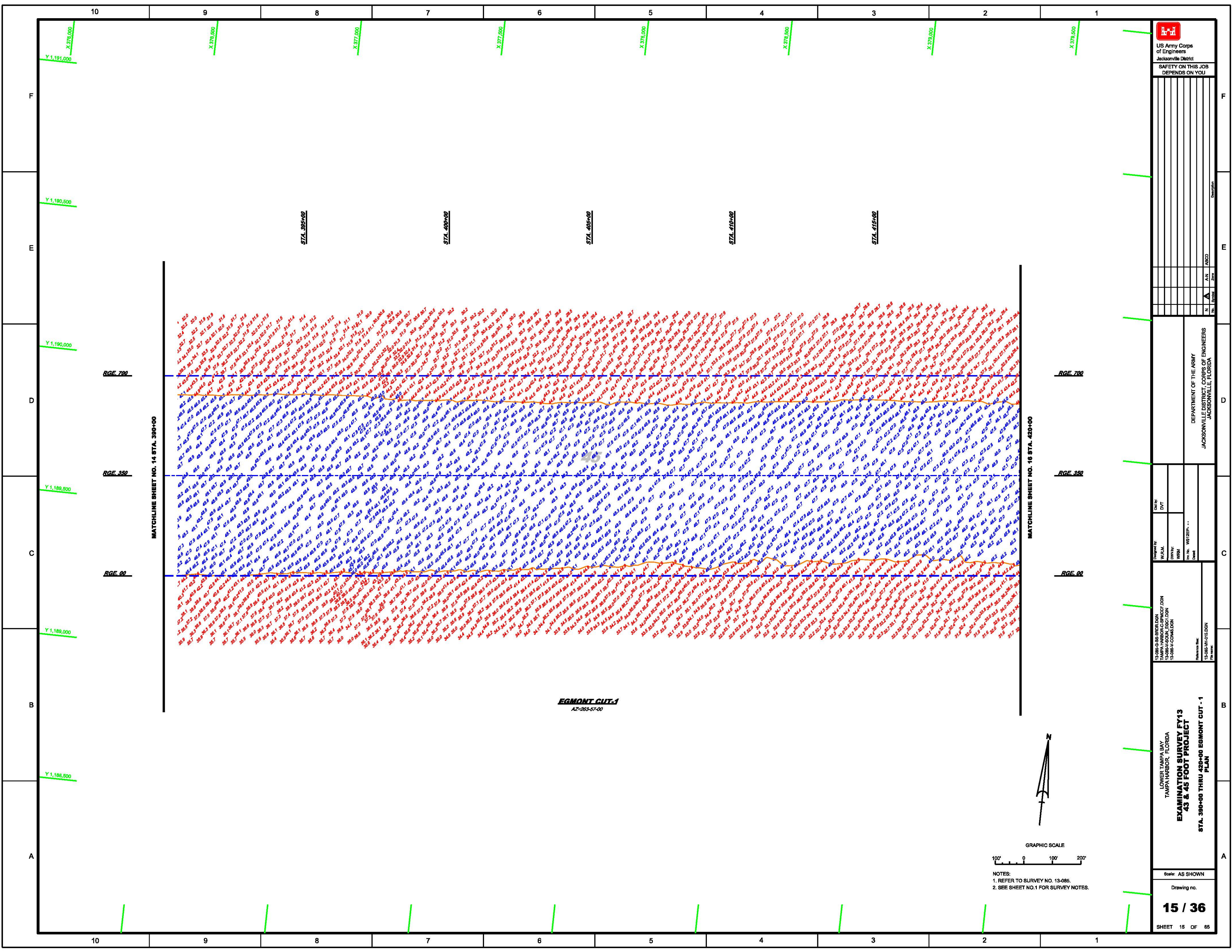

US Army Corps of Engineers
Jacksonville District
SAFETY ON THIS JOB
DEPENDS ON YOU

No.	Symbol	Zone	Description

DEPARTMENT OF THE ARMY
JACKSONVILLE DISTRICT, CORPS OF ENGINEERS
JACKSONVILLE, FLORIDA

Designed by: WJL:JAL	Checked by: DVT
Drawn by: WJM	Reviewed by: WJL:JAL
Project No.: 13-085-4-COM-10N	Scale: AS SHOWN

LOWER TAMPA BAY
TAMPA HARBOR, FLORIDA
**EXAMINATION SURVEY FY13
43 & 45 FOOT PROJECT**
PLAN
STA. 390+00 THRU 420+00 EGMONT CUT-1

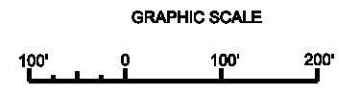

NOTES:
1. REFER TO SURVEY NO. 13-085.
2. SEE SHEET NO.1 FOR SURVEY NOTES.

10 9 8 7 6 5 4 3 2 1

F
E
D
C
B
A

10 9 8 7 6 5 4 3 2 1

MATCHLINE SHEET NO. 14 STA. 390+00

MATCHLINE SHEET NO. 16 STA. 420+00

RGE.700

RGE.390

RGE.00

RGE.700

RGE.390

RGE.00

Y 1,191,000

Y 1,180,500

Y 1,190,000

Y 1,189,500

Y 1,189,000

Y 1,188,500

X 378,000

X 378,000

X 377,000

X 377,000

X 378,000

X 378,000

X 379,000

X 378,000

STA. 395+00

STA. 400+00

STA. 405+00

STA. 410+00

STA. 415+00

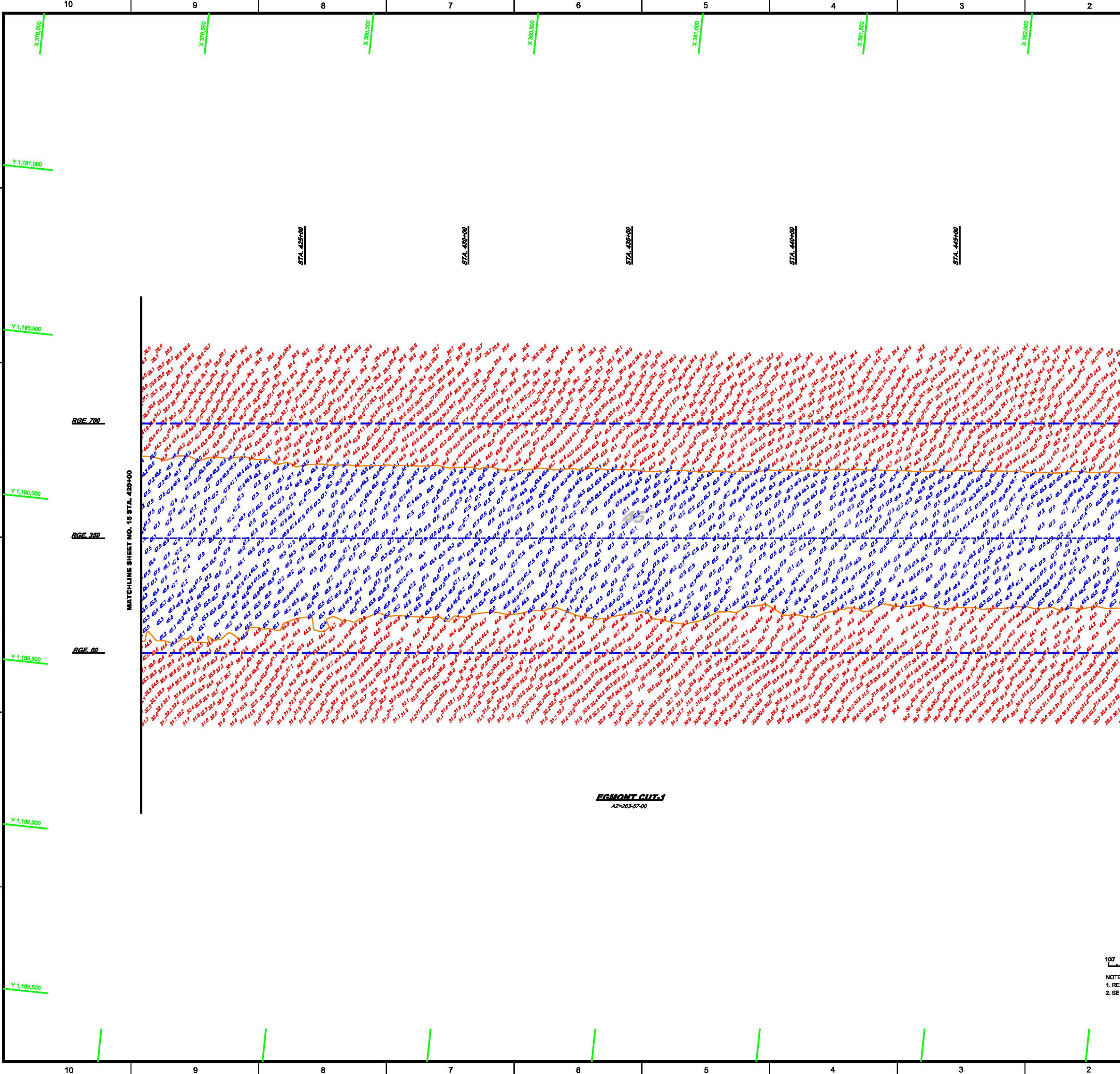

MATCHLINE SHEET NO. 15 STA. 420+00

MATCHLINE SHEET NO. 17 STA. 460+00

EGMONT CUT-1
A2-263-57-00

RGE 700

RGE 350

RGE 00

RGE 700

RGE 350

RGE 00

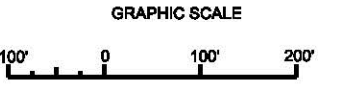
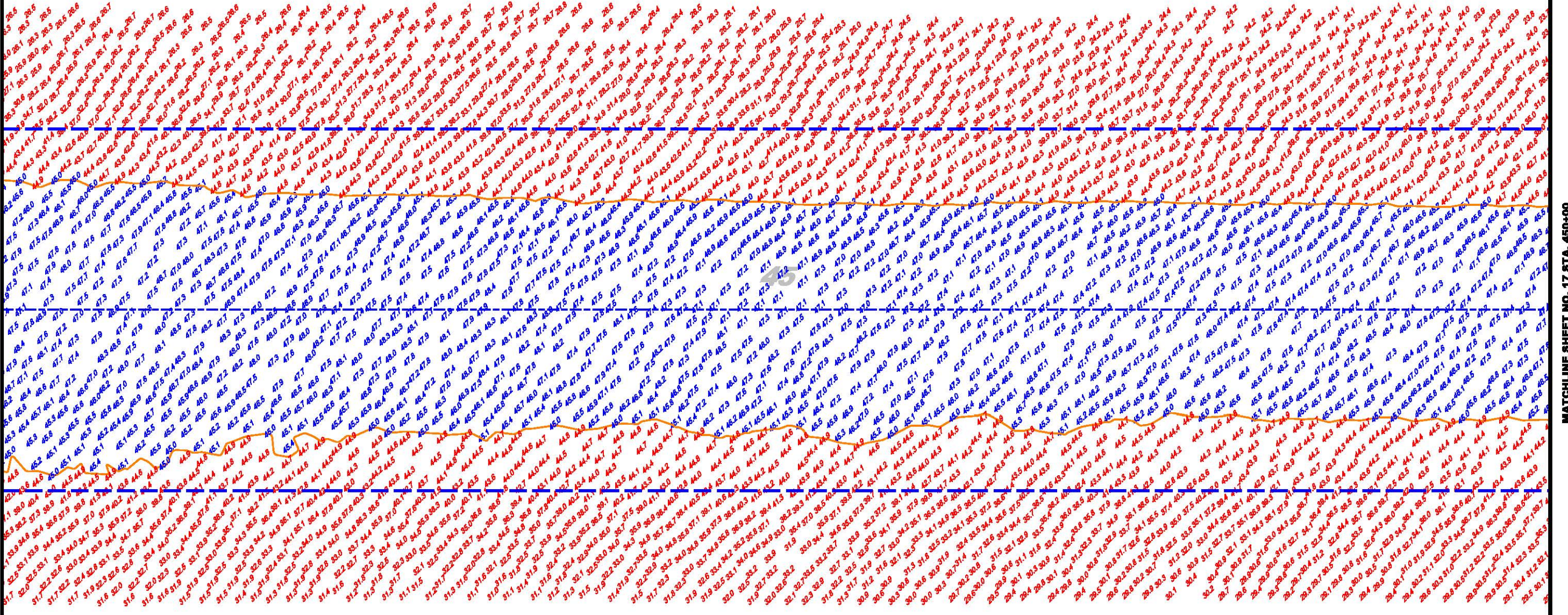

NOTES:
1. REFER TO SURVEY NO. 13-085.
2. SEE SHEET NO.1 FOR SURVEY NOTES.

US Army Corps of Engineers
Jacksonville District

SAFETY ON THIS JOB
DEPENDS ON YOU

No.	Symbol	Description

DEPARTMENT OF THE ARMY
JACKSONVILLE DISTRICT, CORPS OF ENGINEERS
JACKSONVILLE, FLORIDA

Designed by: WALUI	Checked by: WYB
Drawn by: WYB	Reviewed by: WYB
Scale:	

LOWER TAMPA BAY
TAMPA HARBOR, FLORIDA

**EXAMINATION SURVEY FY13
43 & 45 FOOT PROJECT**

STA. 420+00 THRU STA. 460+00 EGMONT CUT - 1
PLAN

Scale: AS SHOWN

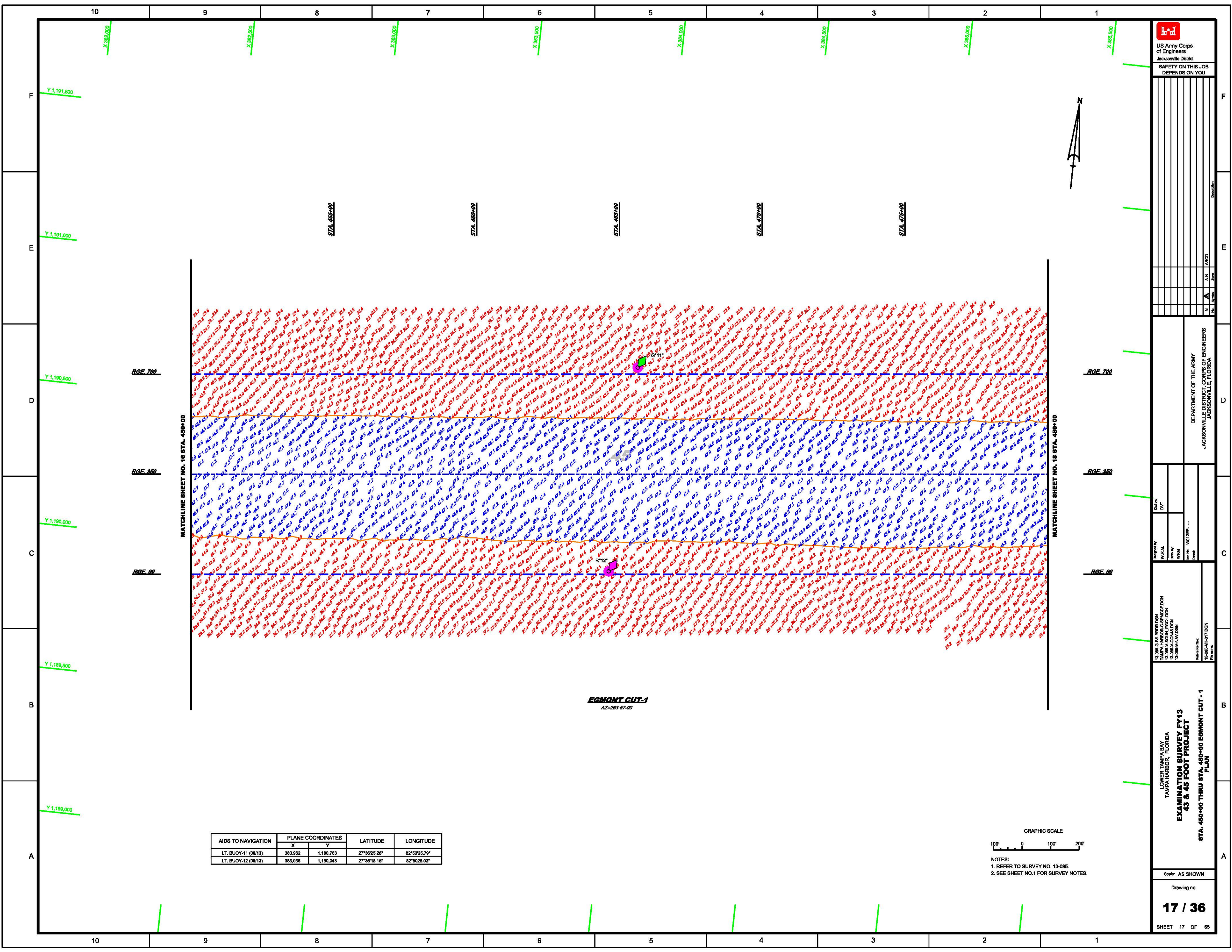

US Army Corps of Engineers
Jacksonville District
SAFETY ON THIS JOB
DEPENDS ON YOU

No.	Zone	ASCD	ASND

DEPARTMENT OF THE ARMY
JACKSONVILLE DISTRICT, CORPS OF ENGINEERS
JACKSONVILLE, FLORIDA

Designed by: WJL/AL
Checked by: DVT
Drawn by: WRN
For Use: WPT/2015-...
Contract: 13-085-4-CONV-001
13-085-4-NAV-001

LOWER TAMPA BAY
TAMPA HARBOR, FLORIDA
**EXAMINATION SURVEY FY13
43 & 45 FOOT PROJECT
PLAN**
STA. 450+00 THRU STA. 480+00 EGMONT CUT - 1

Scale: AS SHOWN
Drawing no.
17 / 36
SHEET 17 OF 65

AIDS TO NAVIGATION	PLANE COORDINATES		LATITUDE	LONGITUDE
	X	Y		
LT. BUOY-11 (06/13)	383,982	1,190,763	27°36'25.28"	82°50'25.79"
LT. BUOY-12 (06/13)	383,836	1,190,043	27°36'16.15"	82°50'28.03"

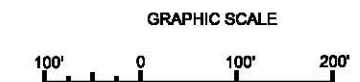

NOTES:
1. REFER TO SURVEY NO. 13-085.
2. SEE SHEET NO.1 FOR SURVEY NOTES.

EGMONT CUT-1
AZ-263-57-00

MATCHLINE SHEET NO. 16 STA. 450+00

MATCHLINE SHEET NO. 18 STA. 480+00

RGE 700

RGE 700

RGE 300

RGE 300

RGE 00

RGE 00

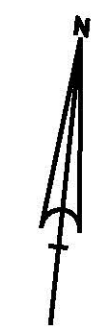

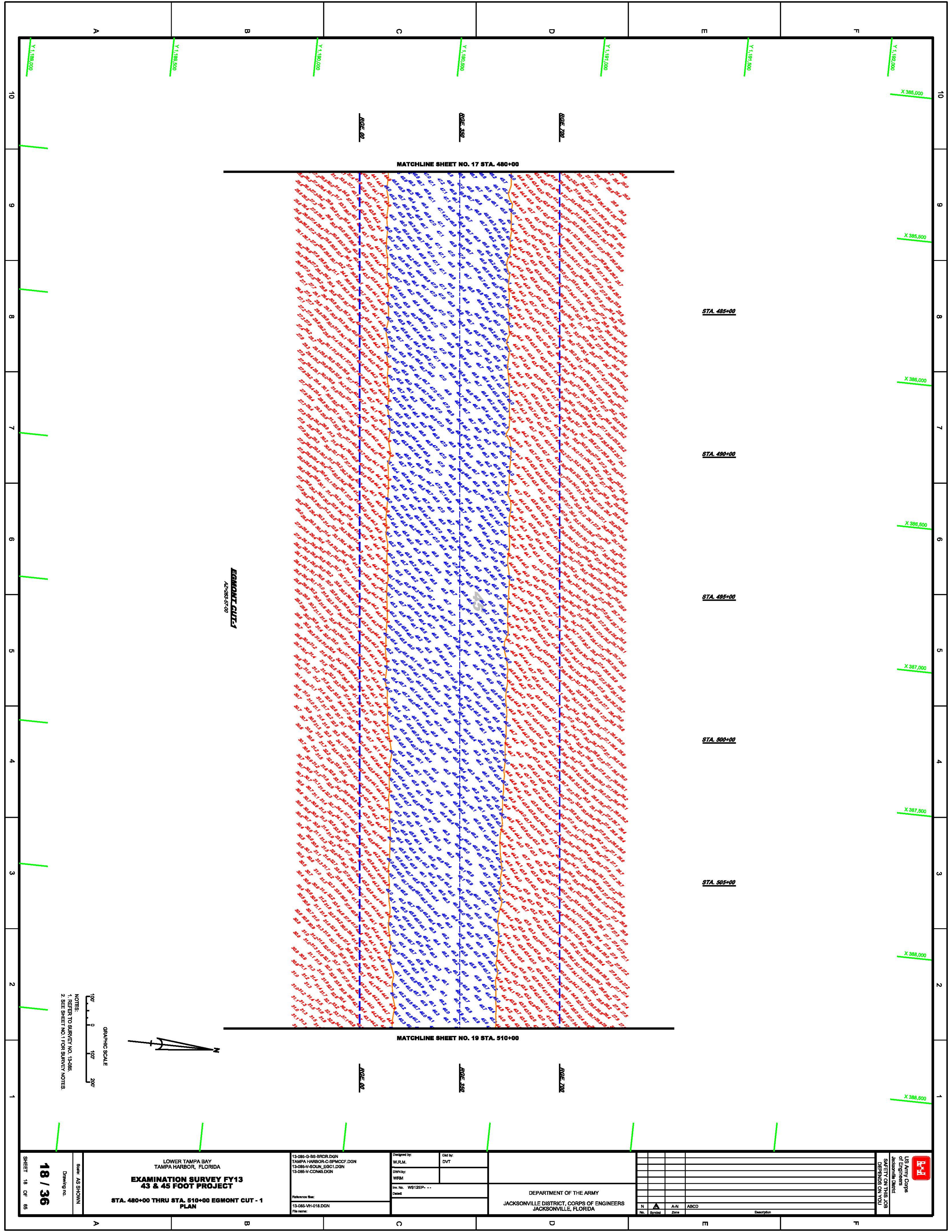

MATCHLINE SHEET NO. 17 STA. 480+00

MATCHLINE SHEET NO. 19 STA. 510+00

EGMONT CUT
42-285-57-20

STA. 485+00

STA. 490+00

STA. 495+00

STA. 500+00

STA. 505+00

GRAPHIC SCALE
100' 0 100' 200'

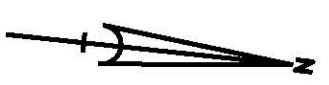

NOTES:
1. REFER TO SURVEY NO. 13-085.
2. SEE SHEET NO. 1 FOR SURVEY NOTES.

SHEET 18 OF 36 18 / 36	LOWER TAMPA BAY TAMPA HARBOR, FLORIDA EXAMINATION SURVEY FY13 43 & 45 FOOT PROJECT STA. 480+00 THRU STA. 510+00 EGMONT CUT - 1 PLAN	13-085-G-86-BRDR.DGN 13-085-V-001N_EG01.DGN 13-085-V-001N.DGN	Designed by: W.R.M. DWN by: WRM	Ckd by: DVT	DEPARTMENT OF THE ARMY JACKSONVILLE DISTRICT, CORPS OF ENGINEERS JACKSONVILLE, FLORIDA	<table border="1"> <tr> <th>No.</th> <th>Symbol</th> <th>Zone</th> <th>Description</th> </tr> <tr> <td> </td> <td> </td> <td> </td> <td> </td> </tr> <tr> <td> </td> <td> </td> <td> </td> <td> </td> </tr> <tr> <td> </td> <td> </td> <td> </td> <td> </td> </tr> </table>	No.	Symbol	Zone	Description													
		No.	Symbol	Zone			Description																
Reference file: 13-085-VH-018.DGN File name:	Inv. No: W612EP-... Desc:	US Army Corps of Engineers Jacksonville District SAFETY ON THIS JOB DEPENDS ON YOU																					

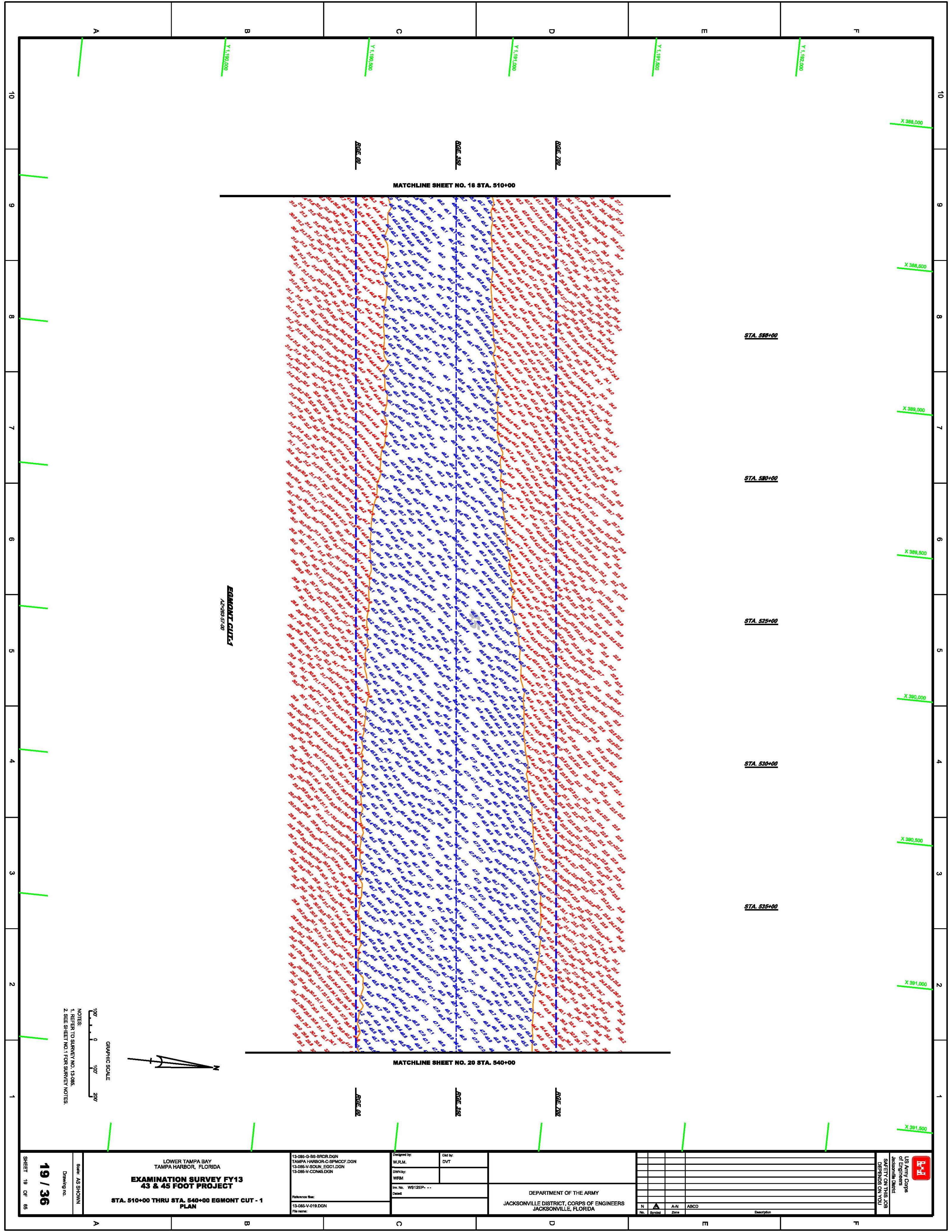

MATCHLINE SHEET NO. 18 STA. 510+00

MATCHLINE SHEET NO. 20 STA. 540+00

EGMONT CUT #1
A-Z-588-57-00

STA. 530+00

STA. 525+00

STA. 535+00

STA. 530+00

STA. 535+00

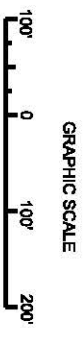

NOTES:
1. REFER TO SURVEY NO. 13-085.
2. SEE SHEET NO. 1 FOR SURVEY NOTES.

SHEET 19 OF 36 19 / 36	LOWER TAMPA BAY TAMPA HARBOR, FLORIDA EXAMINATION SURVEY FY13 43 & 45 FOOT PROJECT STA. 510+00 THRU STA. 540+00 EGMONT CUT - 1 PLAN	13-085-G-86-BRDR.DGN 13-085-V-030M_EGCT.DGN 13-085-V-019.DGN File name:	Designed by: W.R.M. DWN by: WRM Inv. No: W612EP-... Date:	Ckd by: DVT	DEPARTMENT OF THE ARMY JACKSONVILLE DISTRICT, CORPS OF ENGINEERS JACKSONVILLE, FLORIDA	<table border="1"> <tr> <th>No.</th> <th>Symbol</th> <th>Zone</th> <th>Description</th> </tr> <tr> <td> </td> <td> </td> <td> </td> <td> </td> </tr> <tr> <td> </td> <td> </td> <td> </td> <td> </td> </tr> <tr> <td> </td> <td> </td> <td> </td> <td> </td> </tr> </table>	No.	Symbol	Zone	Description													
		No.	Symbol	Zone			Description																
Reference file: 13-085-V-019.DGN File name:	Safety on this job depends on you																						

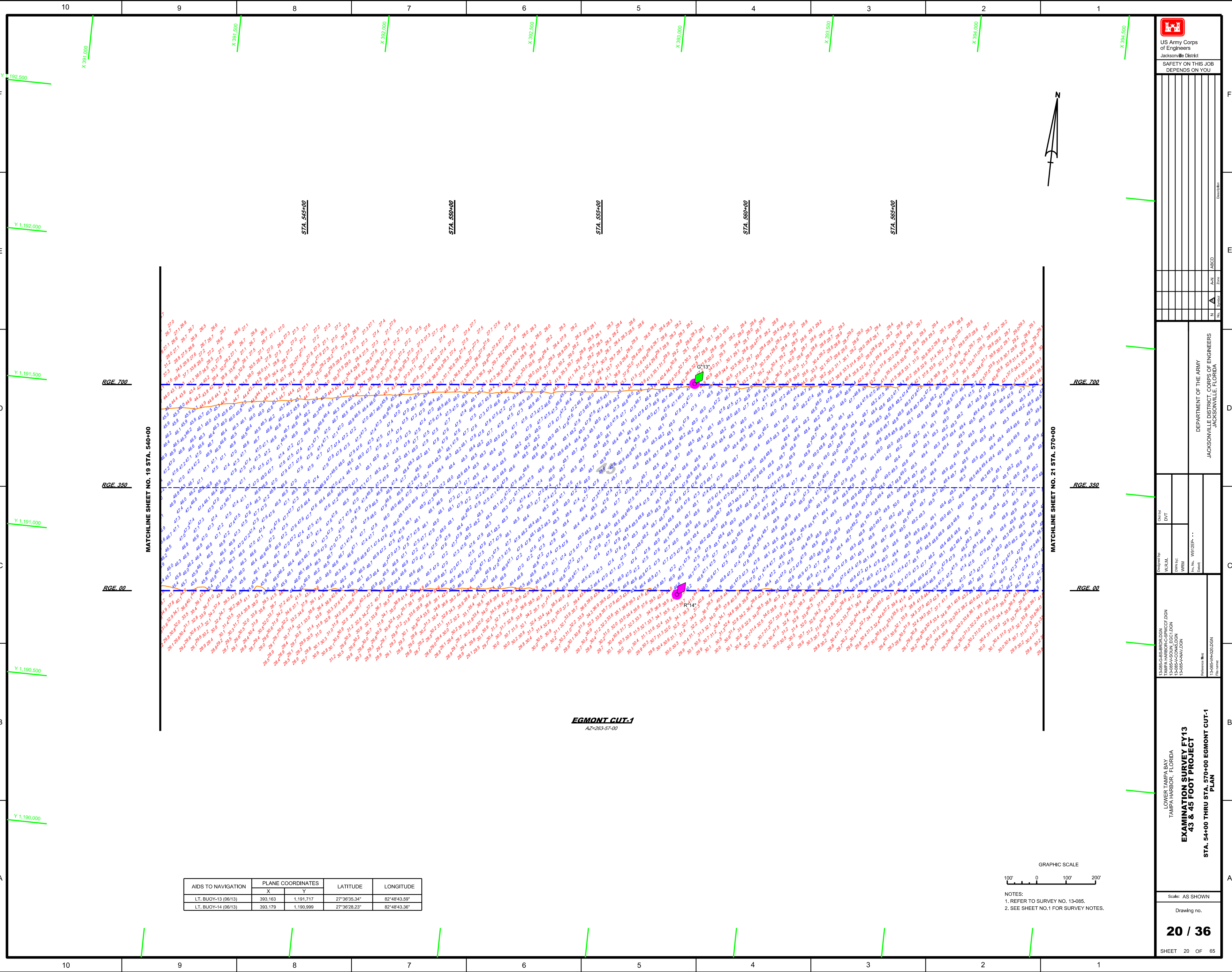

AIDS TO NAVIGATION	PLANE COORDINATES		LATITUDE	LONGITUDE
	X	Y		
LT. BUOY-13 (06/13)	393.163	1,191,717	27°36'35.34"	82°48'43.59"
LT. BUOY-14 (06/13)	393.179	1,190,999	27°36'28.23"	82°48'43.36"

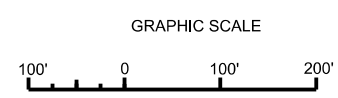

NOTES:
1. REFER TO SURVEY NO. 13-085.
2. SEE SHEET NO.1 FOR SURVEY NOTES.

EGMONT CUT-1
AZ-263-57-00

MATCHLINE SHEET NO. 19 STA. 540+00

MATCHLINE SHEET NO. 21 STA. 570+00

RGE 700

RGE 700

RGE 350

RGE 350

RGE 00

RGE 00

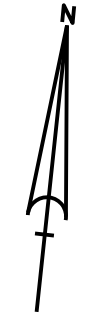

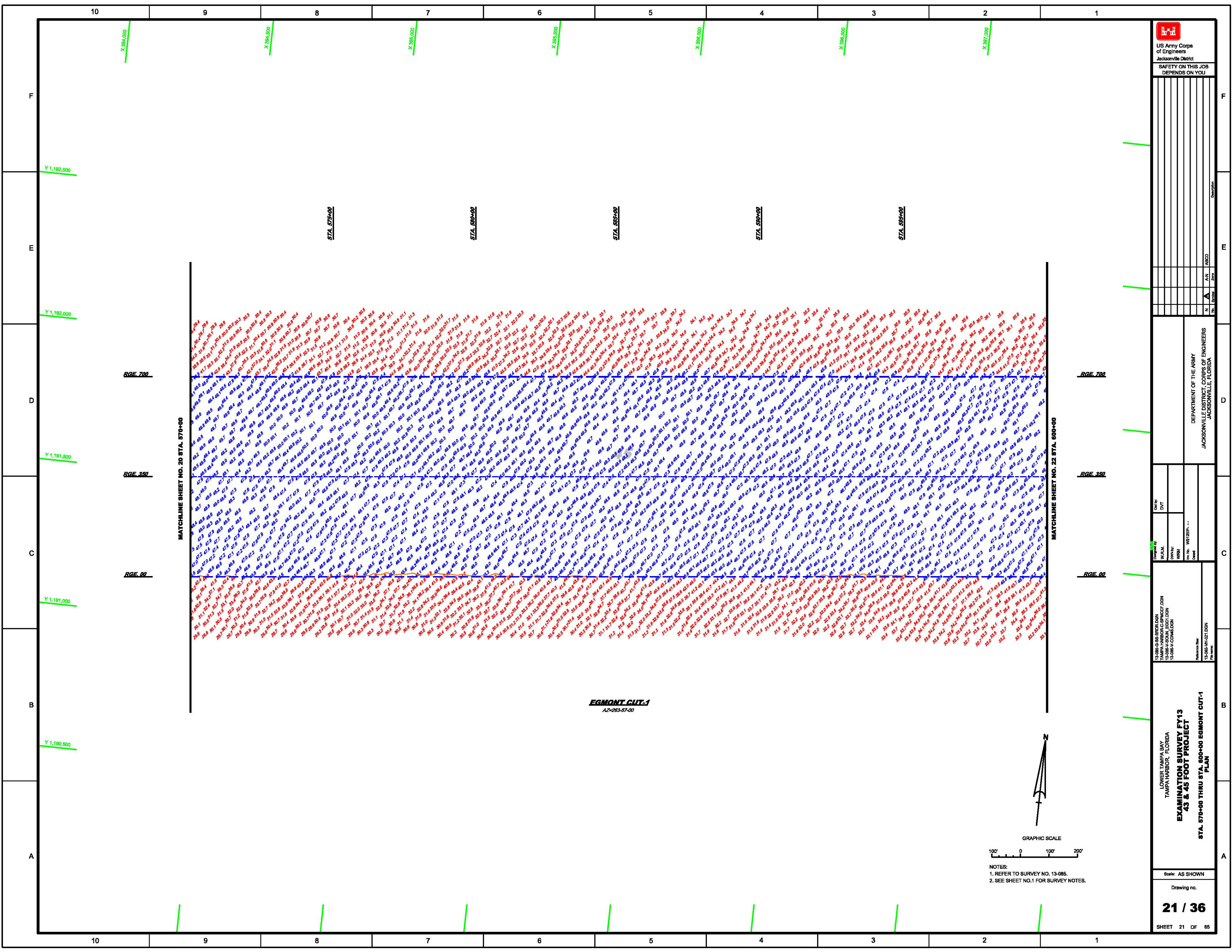

EGMONT CUT-1
AZ-263-57-01

MATCHLINE SHEET NO. 20 STA. 570+00

MATCHLINE SHEET NO. 22 STA. 600+00

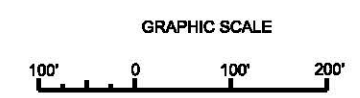
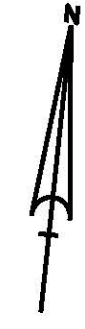

NOTES:
1. REFER TO SURVEY NO. 13-085.
2. SEE SHEET NO.1 FOR SURVEY NOTES.



US Army Corps
of Engineers
Jacksonville District
SAFETY ON THIS JOB
DEPENDS ON YOU

No.	Symbol	Zone	Description
1	N	A-N	ABCD

DEPARTMENT OF THE ARMY
JACKSONVILLE DISTRICT, CORPS OF ENGINEERS
JACKSONVILLE, FLORIDA

Designed by: WJL/DL
Checked by: WJL/DL
Drawn by: WJL/DL
Scale: AS SHOWN

LOWER TAMPA BAY
TAMPA HARBOR, FLORIDA
**EXAMINATION SURVEY FY13
43 & 45 FOOT PROJECT**
PLAN
STA. 570+00 THRU STA. 600+00 EGMONT CUT-1

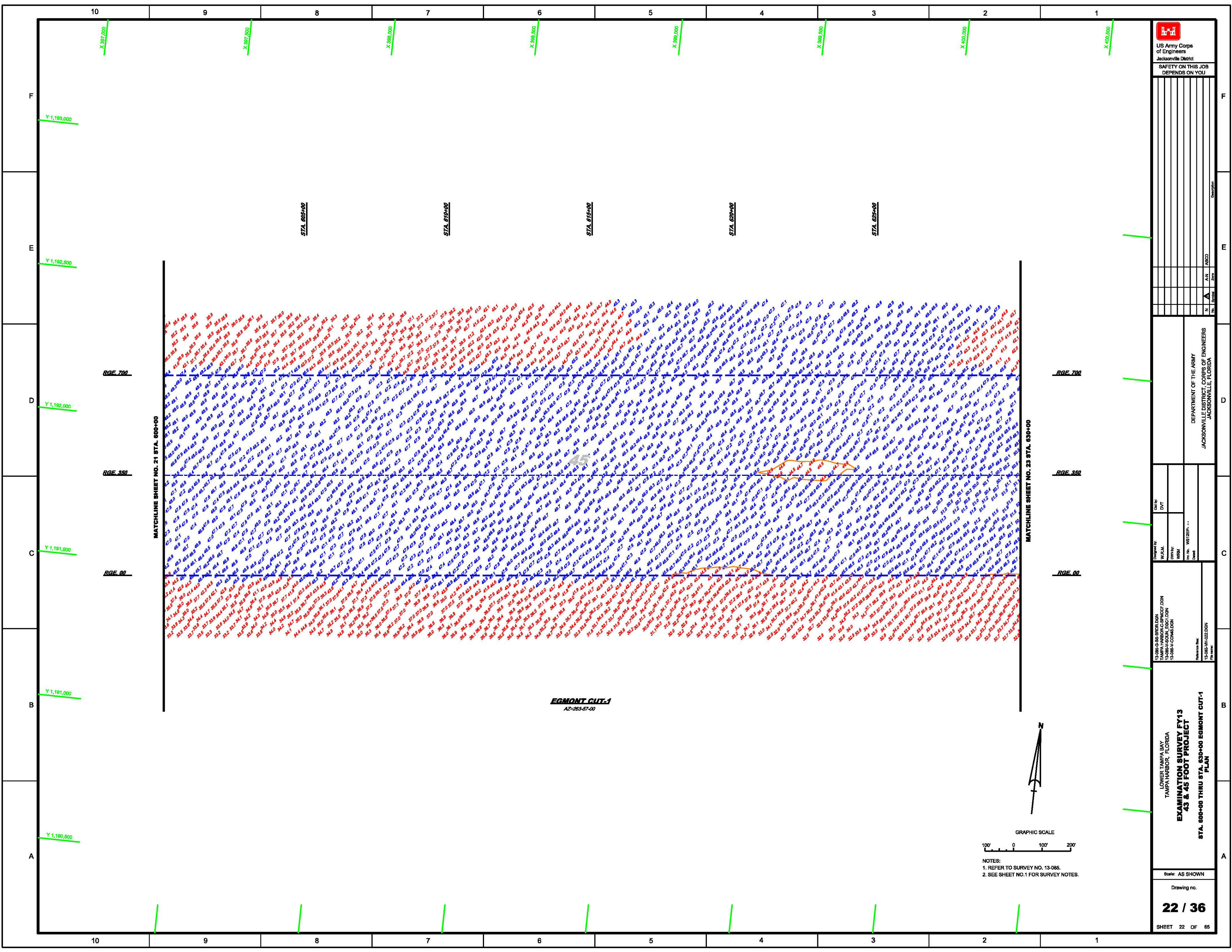

EGMONT CUT-1
A2-263-57-00

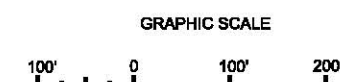
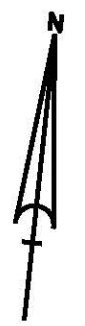

NOTES:
1. REFER TO SURVEY NO. 13-085.
2. SEE SHEET NO. 1 FOR SURVEY NOTES.

US Army Corps
of Engineers
Jacksonville District
SAFETY ON THIS JOB
DEPENDS ON YOU

Zone	Symbol	Zone	Symbol
N	▲	A-N	ABCD
N	▲	N	ABCD

DEPARTMENT OF THE ARMY
JACKSONVILLE DISTRICT, CORPS OF ENGINEERS
JACKSONVILLE, FLORIDA

Designed by:
WJL/AL DVT
OWNY
WRM
For Use: WPT/2025-...
Checked: _____

13-085-G-88-BR/BLD/EN
TAMPA HARBOR CORP/EN/CD/EN
13-085-H-COM/EN/EN

Reference No.:
13-085-VH-022/EN
File Name: _____

LOWER TAMPA BAY
TAMPA HARBOR, FLORIDA
**EXAMINATION SURVEY FY13
43 & 45 FOOT PROJECT**
PLAN
STA. 600+00 THRU STA. 630+00 EGMONT CUT-1

Scale: AS SHOWN
Drawing no.
22 / 36
SHEET 22 OF 65

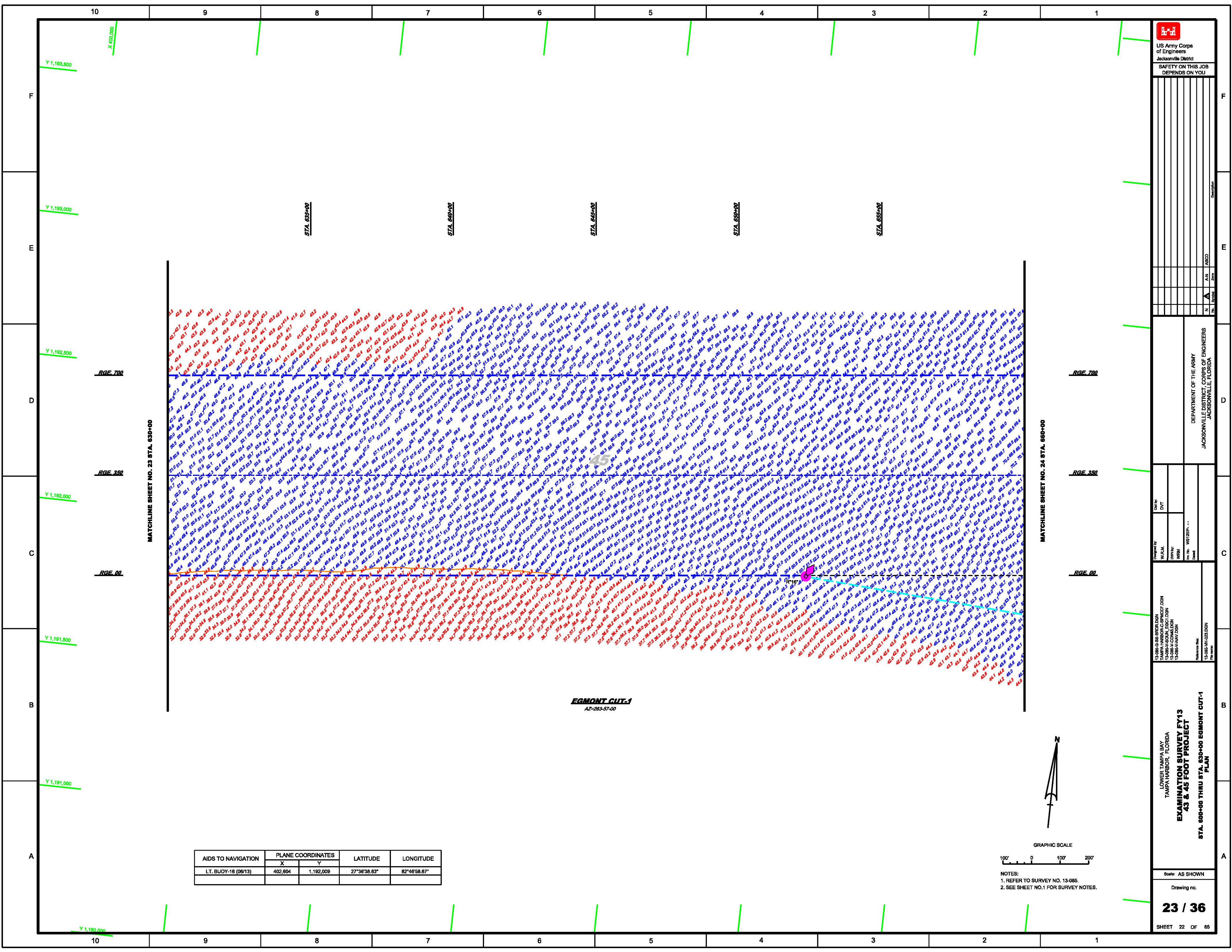

MATCHLINE SHEET NO. 23 STA. 630+00

MATCHLINE SHEET NO. 24 STA. 660+00

EGMONT CUT-1
 AZ-263-57-00

AIDS TO NAVIGATION	PLANE COORDINATES		LATITUDE	LONGITUDE
	X	Y		
LT. BUOY-16 (08/13)	402,804	1,182,009	27°36'38.83"	82°46'58.67"

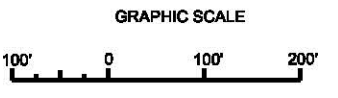

NOTES:
 1. REFER TO SURVEY NO. 13-085.
 2. SEE SHEET NO.1 FOR SURVEY NOTES.

DEPARTMENT OF THE ARMY
 JACKSONVILLE DISTRICT, CORPS OF ENGINEERS
 JACKSONVILLE, FLORIDA

Designed by:
 WJL/AL
 DVT
 Drawn by:
 WRM
 For Use: WY 2025...

13-085-C-BB-SRICH/DGN
 TAMPA HARBOR-CORP/CFD/DGN
 13-085-A-COM/DGN
 13-085-A-NAV/DGN

LOWER TAMPA BAY
 TAMPA HARBOR, FLORIDA
**EXAMINATION SURVEY FY13
 43 & 45 FOOT PROJECT**
 PLAN
 STA. 600+00 THRU STA. 630+00 EGMONT CUT-1

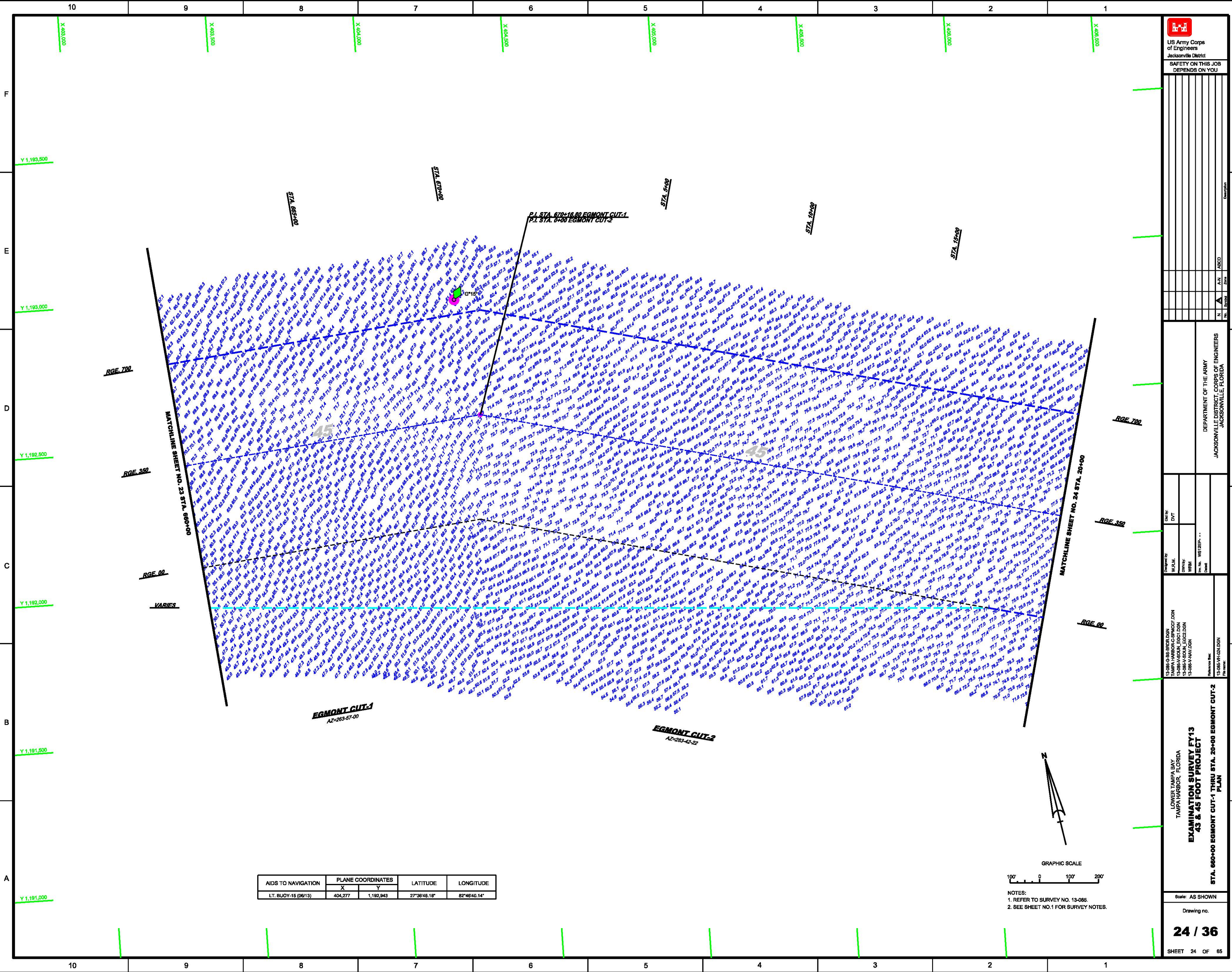

AIDS TO NAVIGATION	PLANE COORDINATES		LATITUDE	LONGITUDE
	X	Y		
L.T. BUOY-15 (06/13)	404,277	1,192,943	27°38'48.16"	82°46'40.14"

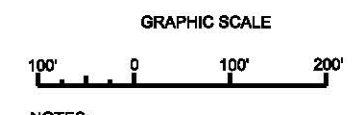

NOTES:
1. REFER TO SURVEY NO. 13-085.
2. SEE SHEET NO.1 FOR SURVEY NOTES.

US Army Corps of Engineers
Jacksonville District
SAFETY ON THIS JOB DEPENDS ON YOU

DEPARTMENT OF THE ARMY JACKSONVILLE DISTRICT, CORPS OF ENGINEERS JACKSONVILLE, FLORIDA	Drawing no. 24 / 36 SHEET 24 OF 65
--	---