

INTRACOASTAL WATERWAY, CUT DA-9 AND BAKERS HAULOVER INLET DADE COUNTY, FLORIDA PROJECT CONDITION SURVEY

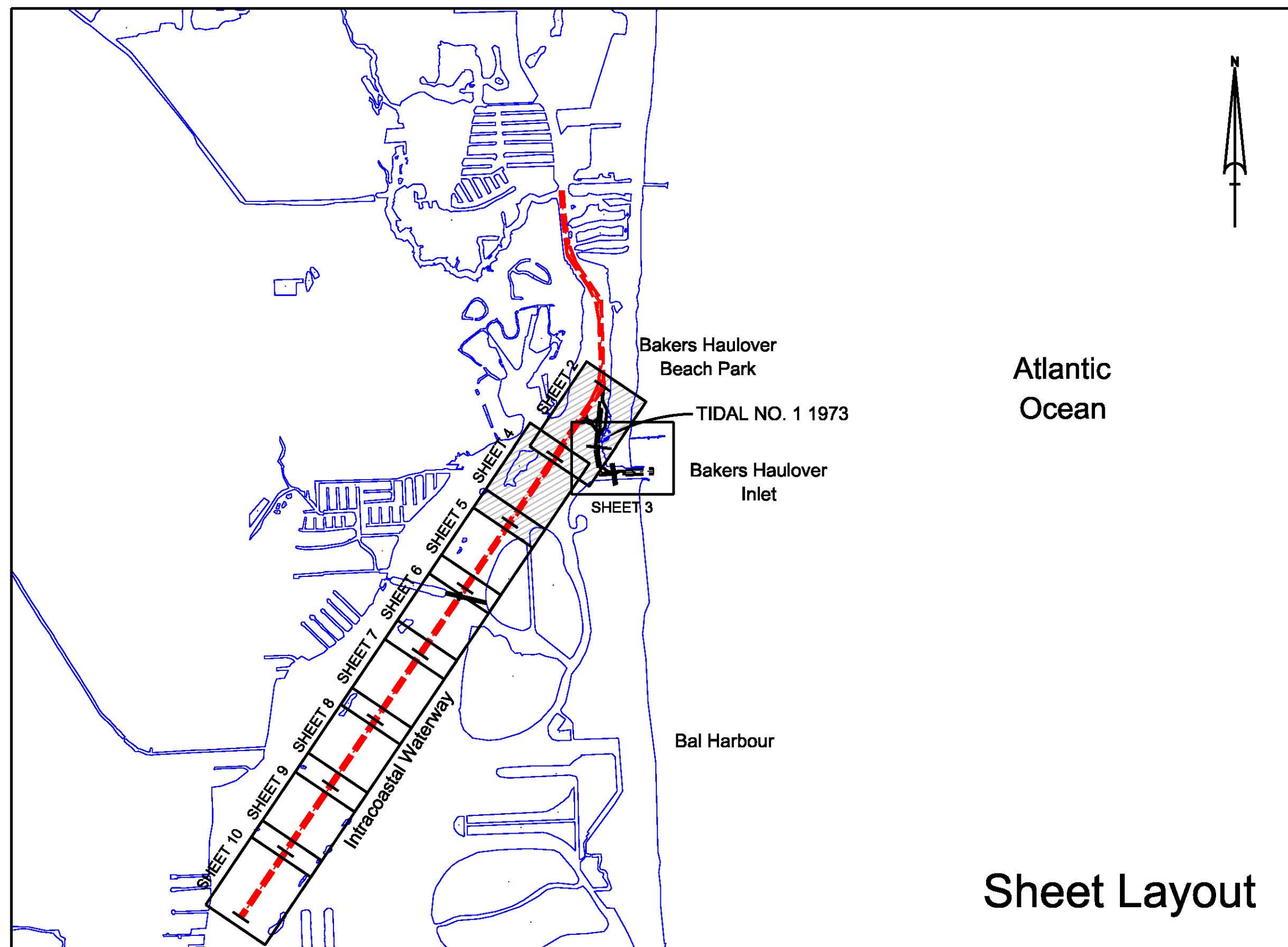

CHANNEL SURVEY NOTES:

1. REFER TO SURVEY NO. 11-032.
2. SOUNDINGS ARE IN FEET AND TENTHS AND REFER TO THE NOAA REPORTED MEAN LOWER LOW WATER (MLLW) RELATIVE TO THE 1983-2001 TIDAL EPOCH.
3. ALL ELEVATIONS ARE BELOW THE CHART DATUM UNLESS PRECEDED BY A (+) SIGN.
4. TIDAL REDUCTIONS WERE OBTAINED UTILIZING REAL-TIME KINEMATIC GPS (RTK) AND REFERENCED TO MLLW. A HYPACK KINEMATIC TIDAL DATA FILE WAS CREATED AND USED FOR TIDE REDUCTIONS. FILE NAME: KTD_HAULOVER.KTD
5. STATE PLANE COORDINATES ARE BASED ON THE TRANSVERSE MERCATOR PROJECTION FOR THE EAST ZONE OF FLORIDA AND REFERENCED TO NORTH AMERICAN DATUM OF 1983 (NAD83).
6. ALL STATIONING REFERS TO THE CENTERLINE OF THE CHANNEL.
7. SURVEY WAS PERFORMED USING REAL-TIME KINEMATIC GPS FOR POSITIONING WITH THE FOLLOWING REFERENCE BASE LOCATIONS:
 *REFERENCE BASE LOCATED AT BENCHMARK, "TIDAL NO 1 1973"
 X: 943,636.80'
 Y: 571,891.04'
 NAVD88 ELEVATION: 2.65'
 *TIDE STAFF LOCATED AT TIDAL NO 1 1973"
8. AIDS TO NAVIGATION WERE LOCATED DURING THIS SURVEY.
9. THE INFORMATION DEPICTED ON THIS MAP REPRESENTS THE RESULTS OF SURVEYS MADE ON THE DATES INDICATED ABOVE AND CAN ONLY BE CONSIDERED AS INDICATING THE GENERAL CONDITIONS AT THAT TIME. THIS CHART IS SOLELY FOR THE DISTRIBUTION OF AVAILABLE DEPTHS AT THE TIME OF THE SURVEY AND IS NOT TO BE USED FOR NAVIGATION.
10. SURVEY ACCURACY PERFORMANCE STANDARDS, QUALITY CONTROL, AND QUALITY ASSURANCE REQUIREMENTS WERE FOLLOWED DURING THIS SURVEY IN ACCORDANCE WITH USACE EM 1110-2-1003, HYDROGRAPHIC SURVEYING, 1 JAN 02.

VESSEL	DATE OF SURVEY	AREA
WB-32	19 JAN 2011	CUT IWW, DA-8, STA 23+00 TO 37+00
WB-32	4 FEB 2011	CUT IWW, DA-9, STA 37+00 TO 57+00

LEGEND	
+BM	BENCHMARK
	LIGHTED BEACON
	GREEN DAYBEACON
	RED DAYBEACON
	RED LIGHTED BUOY
	GREEN LIGHTED BUOY
	CAN BUOY
	NUN BUOY
	TIDE STAFF
	PROJECT DEPTH

US Army Corps of Engineers
 Jacksonville District
SAFETY ON THIS JOB DEPENDS ON YOU

No.	Symbol	Zone	A-N	ABCD	Description

DEPARTMENT OF THE ARMY
JACKSONVILLE DISTRICT, CORPS OF ENGINEERS
JACKSONVILLE, FLORIDA

Drawn by: W.R.M.	DVT	W.F.M.	W.P.ZEP...
---------------------	-----	--------	------------

11-281-C-BB-BRDLD.DGN
 11-281-C-BB-PCRD.DGN
 11-281-C-BB-PCRD.DGN
 11-281-C-BB-PCRD.DGN
 11-281-C-BB-PCRD.DGN
 11-281-C-BB-PCRD.DGN
 11-281-C-BB-PCRD.DGN

INTRACOASTAL WATERWAY
JACKSONVILLE TO MIAMI, FLORIDA
BAKERS HAULOVER INLET, FLORIDA
PROJECT CONDITION SURVEY FY11
10 - FOOT PROJECT
PLAN

Scale: AS SHOWN

Drawing no.

1 / 10

SHEET 1 OF 10

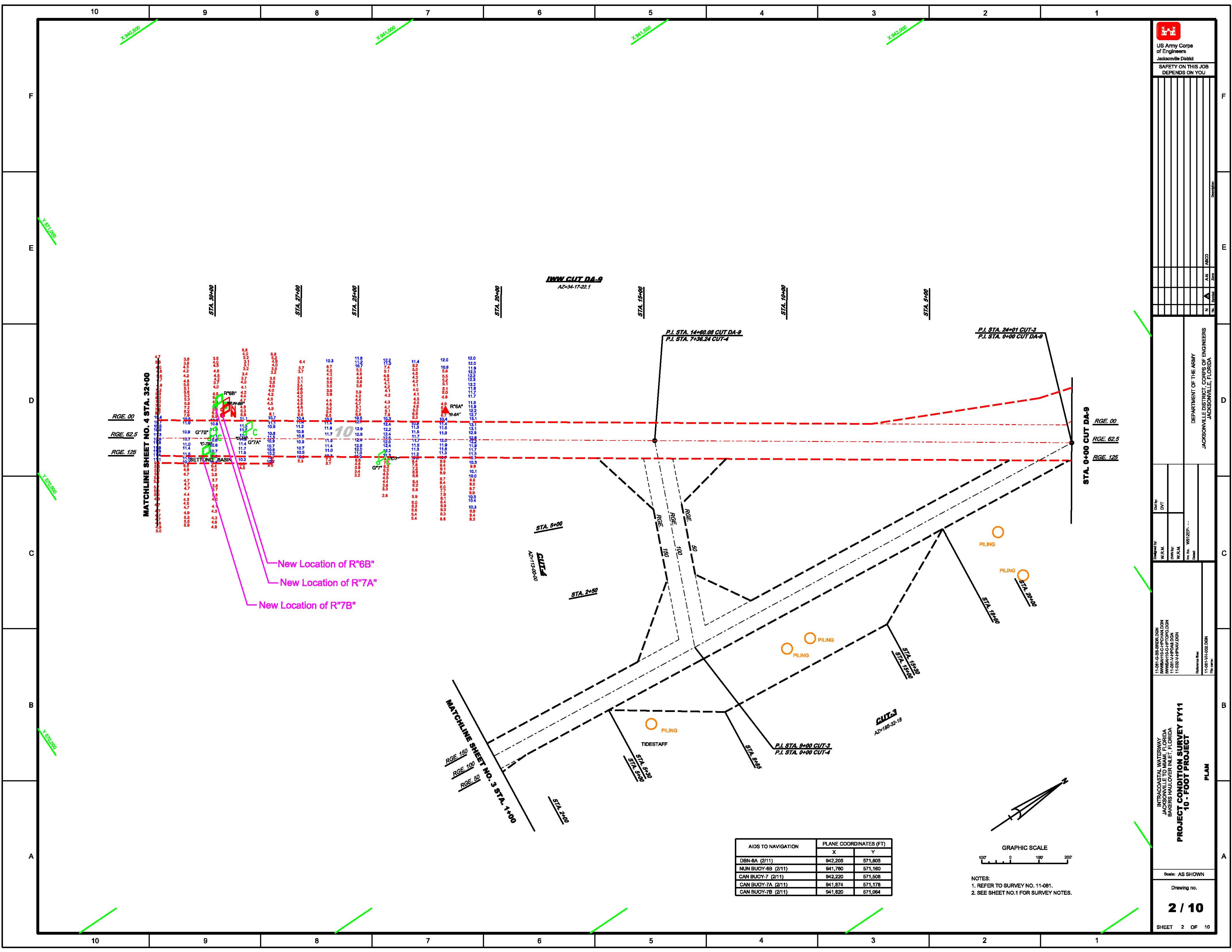

MATCHLINE SHEET NO. 4 STA. 32+00

RGE 00	4.7	3.8	3.8	5.8	6.4	10.3	11.5	12.2	11.4	12.0	12.0
RGE 62.5	1.0	1.0	1.0	1.0	1.0	1.0	1.0	1.0	1.0	1.0	1.0
RGE 125	1.0	1.0	1.0	1.0	1.0	1.0	1.0	1.0	1.0	1.0	1.0

New Location of R"6B"
New Location of R"7A"
New Location of R"7B"

AIDS TO NAVIGATION	PLANE COORDINATES (FT)	
	X	Y
DBN-8A (2/11)	942,205	571,805
NUN BUOY-8B (2/11)	941,760	571,180
CAN BUOY-7 (2/11)	942,220	571,508
CAN BUOY-7A (2/11)	941,874	571,178
CAN BUOY-7B (2/11)	941,820	571,064

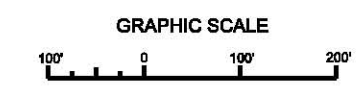

NOTES:
1. REFER TO SURVEY NO. 11-081.
2. SEE SHEET NO.1 FOR SURVEY NOTES.

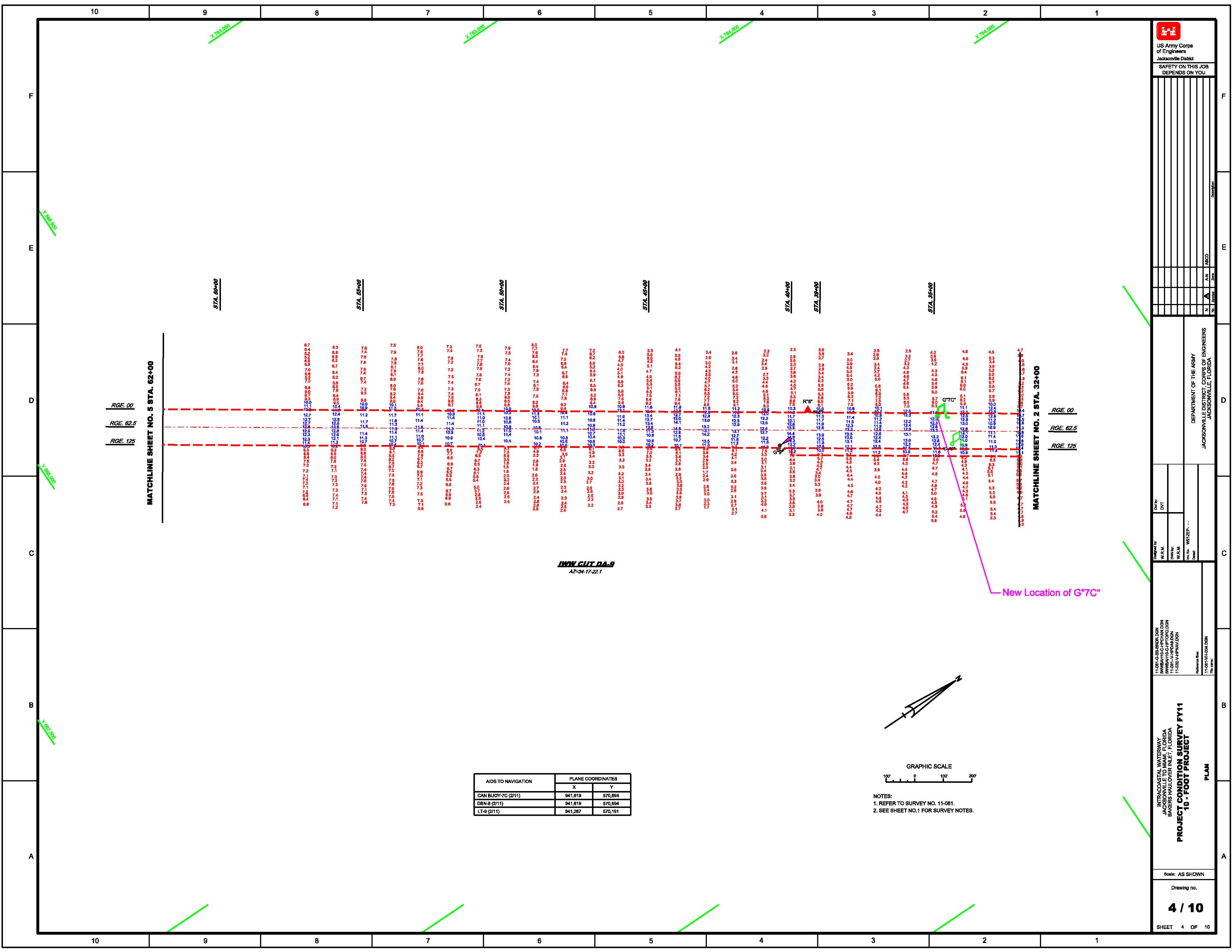

MATCHLINE SHEET NO. 5 STA. 62+00

MATCHLINE SHEET NO. 2 STA. 32+00

IWW CUT DA-9
A2-34-17-22.1

New Location of G"7C"

AIDS TO NAVIGATION	PLANE COORDINATES	
	X	Y
CAN BUOY-7C (2/11)	941,819	570,894
DBN-8 (2/11)	941,819	570,894
LT-9 (2/11)	941,287	570,181

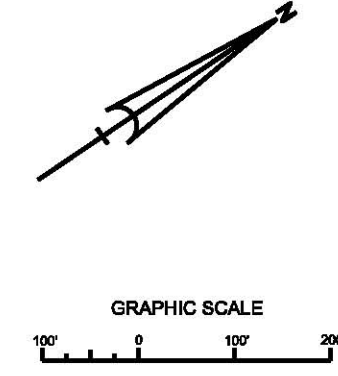

NOTES:
1. REFER TO SURVEY NO. 11-081.
2. SEE SHEET NO.1 FOR SURVEY NOTES.