

# OKEECHOBEE WATERWAY LAKE OKEECHOBEE ROUTES 1 & 2 HYDRO EXAMINATION SURVEY FY11 6 AND 8-FOOT PROJECT

LEGEND	
	BENCHMARK
	LIGHTED BEACON
	GREEN DAYBEACON
	RED DAYBEACON
	RED LIGHTED BUOY
	GREEN LIGHTED BUOY
	CAN BUOY
	NUN BUOY
	TIDE STAFF
	PROJECT DEPTH

**SURVEY NOTES**

- REFER TO SURVEY NO. 11-019.
  - SOUNDINGS ARE IN FEET AND TENTHS AND REFER TO MEAN LAKE LEVEL WHICH IS 12.56' ABOVE NGVD29.
  - ALL ELEVATIONS ARE BELOW THE CHART DATUM UNLESS PRECEDED BY A (+) SIGN.
  - PLANE COORDINATES ARE BASED ON THE TRANSVERSE MERCATOR PROJECTION FOR THE EAST ZONE OF FLORIDA AND REFERENCED TO NORTH AMERICAN DATUM OF 1983 (NAD83).
  - ALL AZIMUTHS ARE GRID; RECKONED CLOCKWISE FROM SOUTH.
  - THIS SURVEY WAS PERFORMED USING POST-PROCESSED KINEMATIC GPS POSITIONING.
- VERTICAL MEASUREMENTS WERE MADE USING A ROSS SMARTS-SOUNDER 835 FREQUENCY 28 & 200 KHZ SINGLE-BEAM TRANSDUCER. ALL SOUNDINGS SHOWN ARE IN HIGH FREQUENCY.
- | VESSEL | DATE OF SURVEY         | CUT          |
|--------|------------------------|--------------|
| SIB 32 | 28-30 JUN, 06 JUL 2011 | ROUTES 1 & 2 |
- AIDS TO NAVIGATION WERE LOCATED DURING THIS SURVEY.
  - THE INFORMATION DEPICTED ON THIS MAP REPRESENTS THE RESULTS OF SURVEYS MADE ON THE DATES INDICATED ABOVE AND CAN ONLY BE CONSIDERED AS INDICATING THE GENERAL CONDITIONS AT THAT TIME. THIS CHART IS SOLELY FOR THE DISTRIBUTION OF AVAILABLE DEPTHS AT THE TIME OF THE SURVEY AND IS NOT TO BE USED FOR NAVIGATION.
  - SURVEY ACCURACY PERFORMANCE STANDARDS, QUALITY CONTROL, AND QUALITY ASSURANCE REQUIREMENTS WERE FOLLOWED DURING THIS SURVEY IN ACCORDANCE WITH USACE EM 1110-2-1003, HYDROGRAPHIC SURVEYING, 1 JAN 02.
  - IMAGERY OBTAINED FROM GOOGLE EARTH DATED 22 DECEMBER 2010.

US Army Corps of Engineers  
Jacksonville District  
SAFETY ON THIS JOB DEPENDS ON YOU

---

DEPARTMENT OF THE ARMY  
JACKSONVILLE DISTRICT, CORPS OF ENGINEERS  
JACKSONVILLE, FLORIDA

---

Drawn by: DVT  
Checked by: WRM  
Date: 00 MM/YY

---

XXXXXXXXXXXXXXXXXXXX.DGN  
XXXXXXXXXXXXXXXXXXXX.DGN  
XXXXXXXXXXXXXXXXXXXX.DGN  
INTERNAL\_O\_873CHM8.DGN  
XXXXXXXXXXXXXXXXXXXX.DGN  
11-019-08.DGN  
11-019-08.DGN

---

OKEECHOBEE WATERWAY, FLORIDA  
**HYDRO EXAMINATION SURVEY FY11  
6 & 8-FOOT PROJECT**  
INDEX, LOCATION AND VICINITY  
**PLAN**

---

Scale: AS SHOWN  
Drawing no.  
**1/26**  
SHEET 01 OF 26





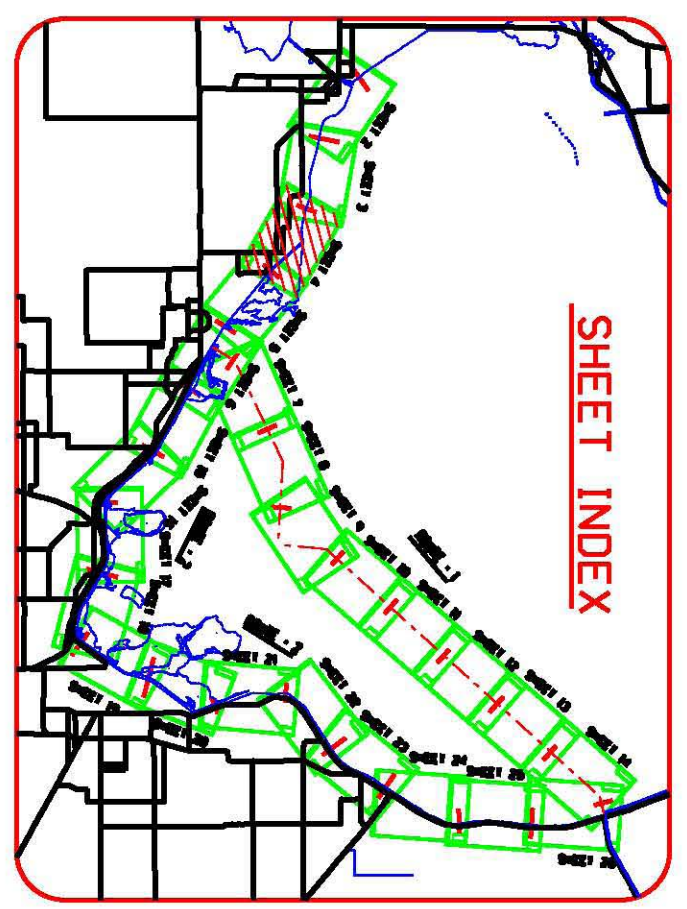
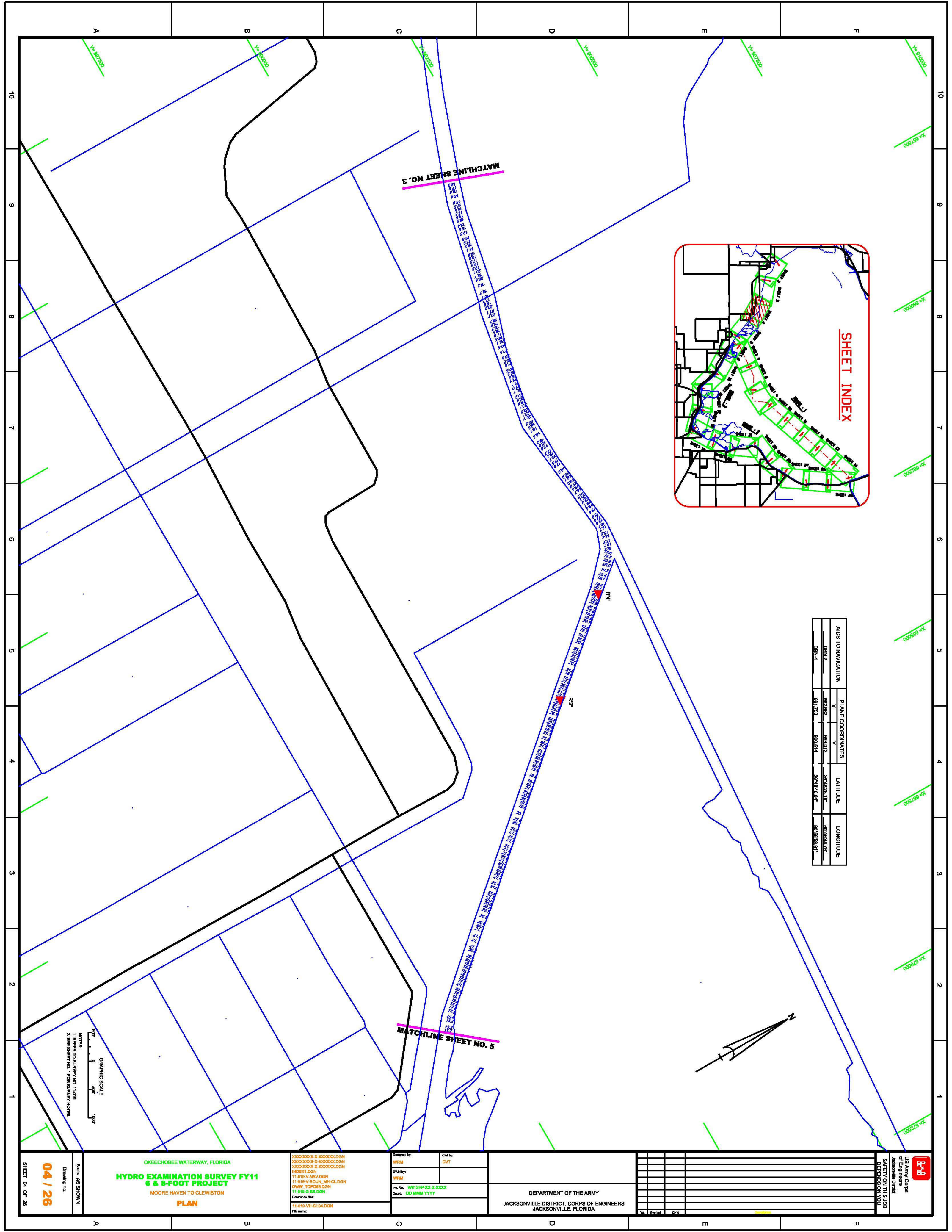

AIDS TO NAVIGATION	PLANE COORDINATES		LATITUDE	LONGITUDE
	X	Y		
DEN-2	692,592	899,012	28°46'23.16"	80°58'44.75"
DEN-4	691,700	900,514	28°46'40.04"	80°58'59.81"

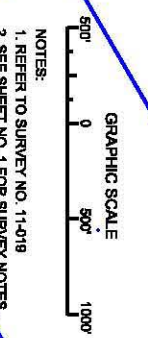

MATCHLINE SHEET NO. 3

MATCHLINE SHEET NO. 5

<p><b>04 / 26</b></p> <p>SHEET 04 OF 26</p>	<p>Drawing No.</p> <p>Scale: AS SHOWN</p>	<p>OKEECHOBEE WATERWAY, FLORIDA</p> <p><b>HYDRO EXAMINATION SURVEY FY11</b></p> <p><b>6 &amp; 8-FOOT PROJECT</b></p> <p>MOORE HAVEN TO CLEWISTON</p> <p><b>PLAN</b></p>	<p>00000000-X-000000.DGN</p> <p>00000000-X-000000.DGN</p> <p>00000000-X-000000.DGN</p> <p>INDEX1.DGN</p> <p>11-018-V-NAV.DGN</p> <p>11-018-V-SOUND_MH-CL.DGN</p> <p>DWW_TPO083.DGN</p> <p>11-018-Q-88.DGN</p> <p>Reference Base:</p> <p>11-018-VH-SH04.DGN</p> <p>File name:</p>	<p>Designed by:</p> <p>WFB</p> <p>DWN by:</p> <p>WFB</p> <p>Rev No: W812EP-300-0000X</p> <p>Desc: DD MMM YYYY</p>	<p>Clad by:</p> <p>DVT</p>	<p>DEPARTMENT OF THE ARMY</p> <p>JACKSONVILLE DISTRICT, CORPS OF ENGINEERS</p> <p>JACKSONVILLE, FLORIDA</p>	<table border="1"> <tr> <th>No.</th> <th>Symbol</th> <th>Zone</th> </tr> <tr> <td> </td> <td> </td> <td> </td> </tr> <tr> <td> </td> <td> </td> <td> </td> </tr> <tr> <td> </td> <td> </td> <td> </td> </tr> <tr> <td> </td> <td> </td> <td> </td> </tr> <tr> <td> </td> <td> </td> <td> </td> </tr> </table>	No.	Symbol	Zone																<p>US Army Corps of Engineers Jacksonville District</p> <p><b>SAFETY ON THIS JOB DEPENDS ON YOU</b></p>
			No.	Symbol	Zone																					
<p>00000000-X-000000.DGN</p> <p>00000000-X-000000.DGN</p> <p>00000000-X-000000.DGN</p> <p>INDEX1.DGN</p> <p>11-018-V-NAV.DGN</p> <p>11-018-V-SOUND_MH-CL.DGN</p> <p>DWW_TPO083.DGN</p> <p>11-018-Q-88.DGN</p> <p>Reference Base:</p> <p>11-018-VH-SH04.DGN</p> <p>File name:</p>																										















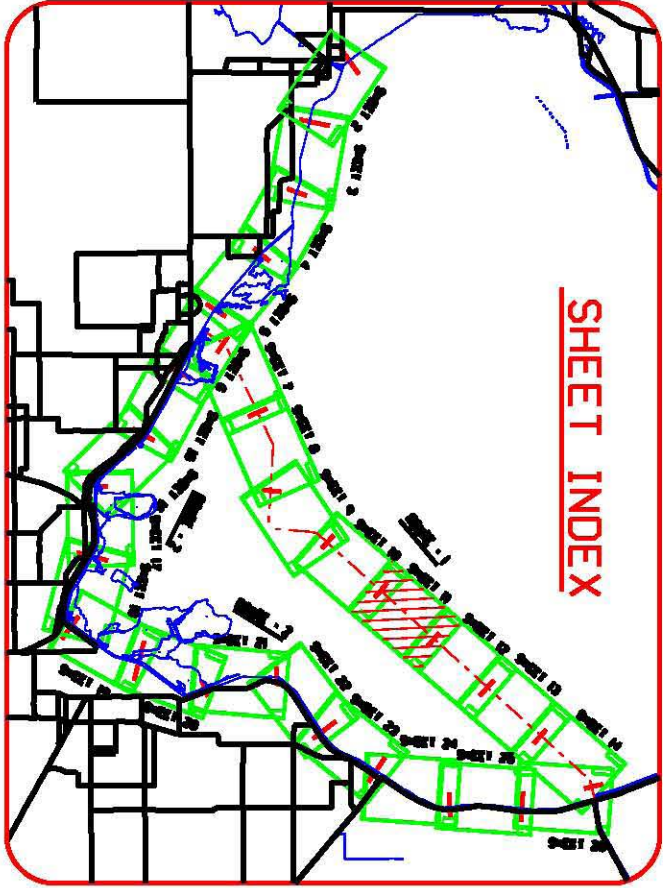
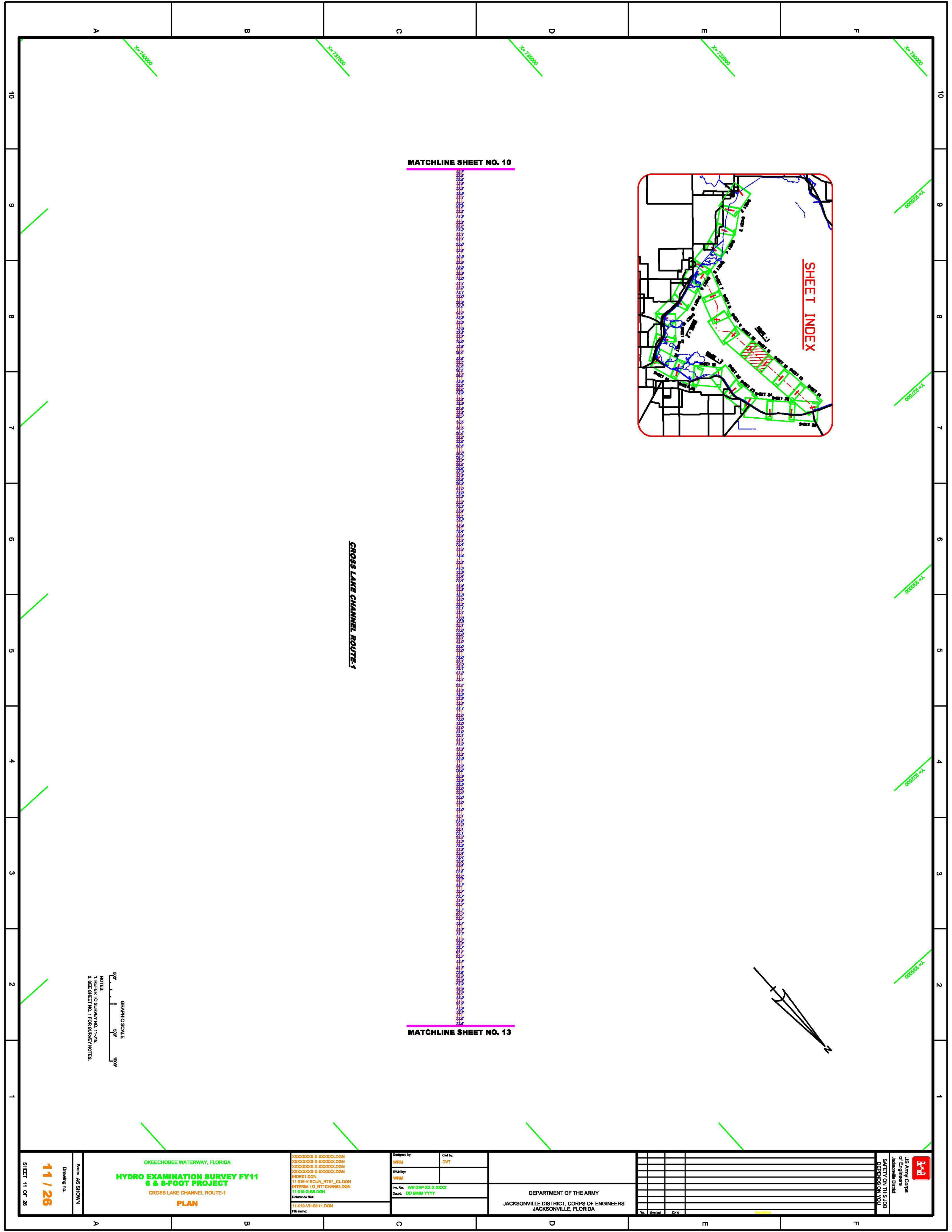

MATCHLINE SHEET NO. 10

MATCHLINE SHEET NO. 13

CROSS LAKE CHANNEL ROUTE-1

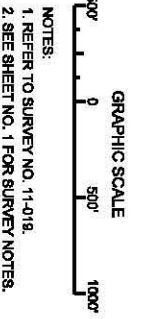

OKEECHOBEE WATERWAY, FLORIDA <b>HYDRO EXAMINATION SURVEY FY11          6 &amp; 8-FOOT PROJECT</b> CROSS LAKE CHANNEL ROUTE-1 <b>PLAN</b>	00000000X:000000L.DGN 00000000X:000000C.DGN 00000000X:000000L.DGN 00000000X:000000C.DGN INDEX1.DGN 11-018-V-SOLN_RTEY_CL.DGN INTERM-LO_RITCHANS3.DGN 11-018-Q-88.DGN Reference Base: 11-018-VH-SH11.DGN File name:	Designed by: WFSM DWTN by: WFSM Rev No: 0012EP-30C-X-0000 Desc: DD MMM YYYY	Cld by: DVT	DEPARTMENT OF THE ARMY JACKSONVILLE DISTRICT, CORPS OF ENGINEERS JACKSONVILLE, FLORIDA	<table border="1"> <tr> <th>No.</th> <th>Symbol</th> <th>Zone</th> </tr> <tr> <td> </td> <td> </td> <td> </td> </tr> <tr> <td> </td> <td> </td> <td> </td> </tr> <tr> <td> </td> <td> </td> <td> </td> </tr> <tr> <td> </td> <td> </td> <td> </td> </tr> <tr> <td> </td> <td> </td> <td> </td> </tr> </table>	No.	Symbol	Zone																
	No.	Symbol	Zone																					
Drawing no: <b>11 / 26</b> SHEET 11 OF 28	Date: AS SHOWN	SAFETY ON THIS JOB DEPENDS ON YOU		US Army Corps of Engineers Jacksonville District																				







US Army Corps  
of Engineers  
Jacksonville District

SAFETY ON THE WATER  
DEPENDS ON YOU

AIDS TO NAVIGATION	PLANE COORDINATES		LATITUDE	LONGITUDE
	X	Y		
DBN-3 (07/11)	777,790	963,128	26°58'58.37"	80°37'35.54"
DBN-4 (07/11)	777,148	963,186	26°58'58.86"	80°37'42.64"
LT-5 (07/11)	776,708	962,794	26°58'55.10"	80°37'47.62"

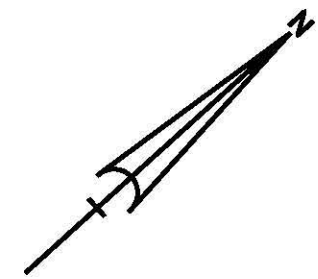
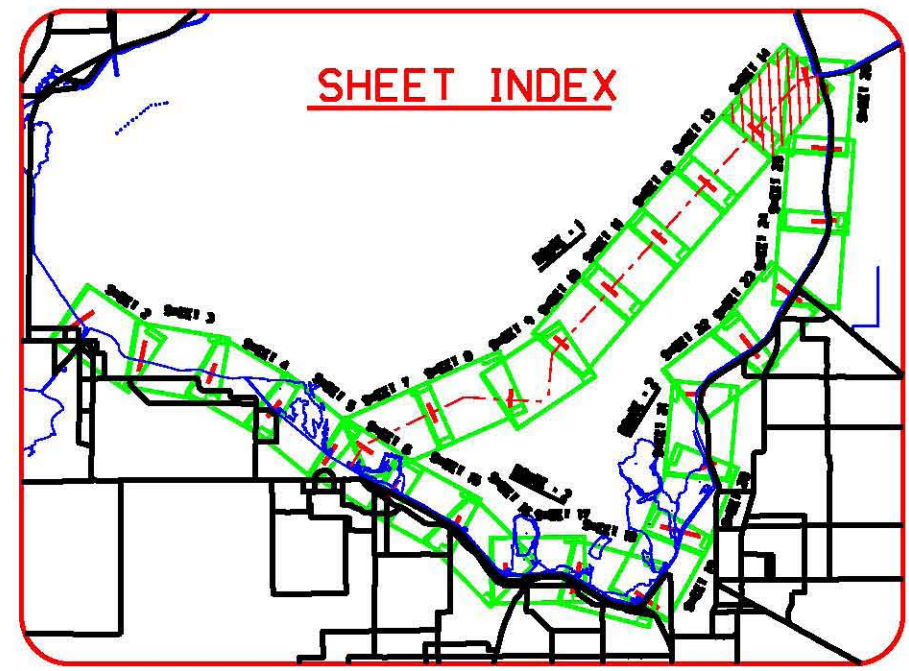

MATCHLINE SHEET NO. 13

MATCHLINE SHEET NO. 28

**CROSS LAKE CHANNEL ROUTE-1**

MARTIN COUNTY  
PALM BEACH COUNTY

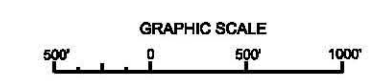

NOTES:  
1. REFER TO SURVEY NO. 11-018.  
2. SEE SHEET NO. 1 FOR SURVEY NOTES.

Checked by: DVT  
Designed by: WTR  
Drawn by: WTR  
Date: 07/11/11

OMEECHOBEE WATERWAY, FLORIDA  
**HYDRO EXAMINATION SURVEY FY11  
6 & 8-FOOT PROJECT**

Scale: AS S

Drawing no.

**14 /**

SHEET 14

