

MAP SHEET INDEX  
NOT TO SCALE

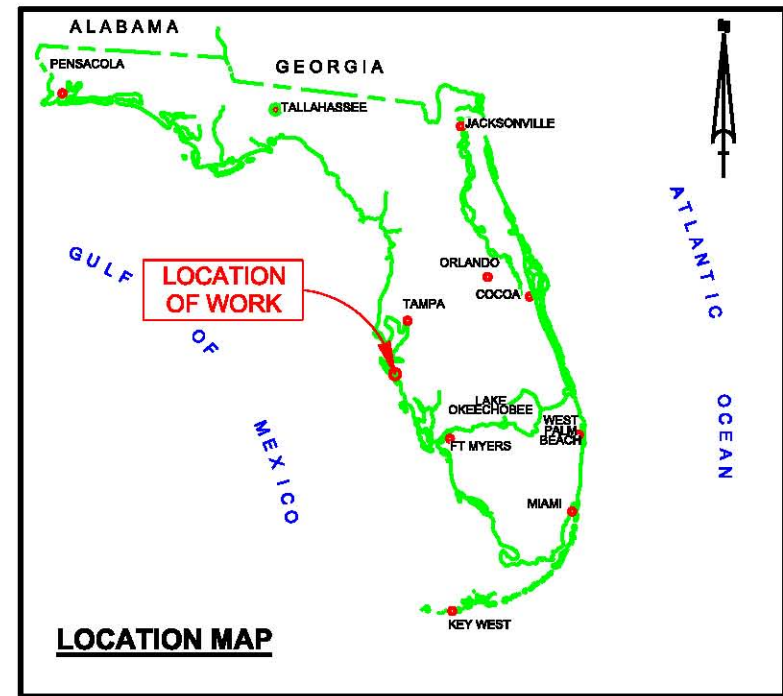

# GULF INTRACOASTAL WATERWAY CALOOSAHATCHEE RIVER TO ANCLOTE RIVER CUTS M-12 THRU M-14 PROJECT CONDITION SURVEY 9-FOOT PROJECT

**SURVEY NOTES:**

1. REFER TO SURVEY NO. 10-096.
2. SOUNDINGS ARE IN FEET AND TENTHS AND REFER TO NOAA'S REPORTED VDATUM MEAN LOWER LOW WATER (MLLW) OF THE 1985-2001 TIDAL EPOCH.
3. ALL ELEVATIONS ARE BELOW THE CHART DATUM UNLESS PRECEDED BY A (+) SIGN.
4. TIDAL REDUCTIONS WERE OBTAINED UTILIZING REAL-TIME KINEMATIC GPS AND REFERENCED TO MLLW (GNSS DATUM: NAD83/NOAA DATUM: 2011).
5. PLANE COORDINATES ARE BASED ON THE TRANSVERSE MERCATOR PROJECTION FOR THE WEST ZONE OF FLORIDA AND REFERENCED TO NORTH AMERICAN DATUM OF 1983 (NAD83).
6. ALL AZIMUTHS ARE GRID-RECKONED CLOCKWISE FROM SOUTH.
7. ALL STATIONING REFERS TO THE CENTERLINE OF THE CHANNEL.
8. SURVEY WAS PERFORMED USING REAL-TIME KINEMATIC GPS FOR POSITIONING WITH THE FOLLOWING REFERENCE BASE LOCATION:  
 \*REFERENCE BASE LOCATED AT "DESOTO C"  
 NORTHING: 193,476,007  
 EASTING: 47,888,840  
 NAVD83 ELEVATION: 32.96'  
 \*TIDE STAFF LOCATED FROM "6367 C TIDAL" (5.20' MLLW)  
 VERTICAL MEASUREMENTS WERE MADE A ROSS B35 SMARTSOUNDER DUAL-FREQUENCY 28/200KHZ SINGLE-BEAM TRANSDUCER. SOUNDINGS SHOWN ARE IN HIGH FREQUENCY (200KHZ).
9. AID TO NAVIGATION WERE LOCATED DURING THIS SURVEY.
10. THE INFORMATION DEPICTED ON THIS MAP REPRESENTS THE RESULTS OF SURVEYS MADE ON THE DATES INDICATED ABOVE AND CAN ONLY BE CONSIDERED AS INDICATING THE GENERAL CONDITIONS AT THAT TIME. THIS CHART IS SOLELY FOR THE DISTRIBUTION OF AVAILABLE DEPTHS AT THE TIME OF THE SURVEY AND IS NOT TO BE USED FOR NAVIGATION.
11. SURVEY ACCURACY PERFORMANCE STANDARDS, QUALITY CONTROL, AND QUALITY ASSURANCE REQUIREMENTS WERE FOLLOWED DURING THIS SURVEY IN ACCORDANCE WITH USACE EM 110-2-1003, HYDROGRAPHIC SURVEYING, 01 JAN 02.

VESSEL	DATE OF SURVEY	CUT
WB-34	05 AUG 2010	M-12, M-13, M-14

BENCHMARK	NAVD ELEV. (FT)
DESOTO C	32.96

LEGEND	
• BM	BENCHMARK
⊙	LIGHTED BEACON
□	GREEN DAYBEACON
△	RED DAYBEACON
⊙	RED LIGHTED BUOY
⊙	GREEN LIGHTED BUOY
⊙	CAN BUOY
⊙	NUN BUOY
⊙	TIDE STAFF
⊙	PROJECT DEPTH

US Army Corps of Engineers  
Jacksonville District

SAFETY ON THIS JOB  
DEPENDS ON YOU

DEPARTMENT OF THE ARMY  
CORPS OF ENGINEERS  
JACKSONVILLE DISTRICT

DESIGNED BY: [Name]  
CHECKED BY: [Name]  
DATE: [Date]  
SCALE: [Scale]  
PROJECT NO.: [Number]  
DRAWING NO.: [Number]

GULF INTRACOASTAL WATERWAY  
CALOOSAHATCHEE RIVER TO ANCLOTE RIVER  
EXAMINATION SURVEY FY10  
9-FOOT PROJECT  
PROJECT LOCATION AND VICINITY  
PLAN

DRAWING NO.  
**1/5**  
SHEET 1 of 33

US Army Corps of Engineers  
Jacksonville District

SAFETY ON THIS JOB  
DEPENDS ON YOU

DEPARTMENT OF THE ARMY  
CORPS OF ENGINEERS  
JACKSONVILLE DISTRICT

PROJECT NO. 10-00000000  
DRAWING NO. 10-00000000  
DATE 10/10/06  
SCALE AS SHOWN  
PROJECT NAME AS SHOWN  
DRAWING TITLE AS SHOWN

DESIGNED BY: [Name]  
CHECKED BY: [Name]  
DATE: [Date]

GULF INTRACOASTAL WATERWAY  
CALOOSAHATCHEE RIVER TO ANICLOTE RIVER  
EXAMINATION SURVEY FY10  
9-FOOT PROJECT  
STA. 6+00 THRU 36+00 CUT M-12  
PLAN

DRAWING NO.  
**2/5**

SHEET 20 OF 33

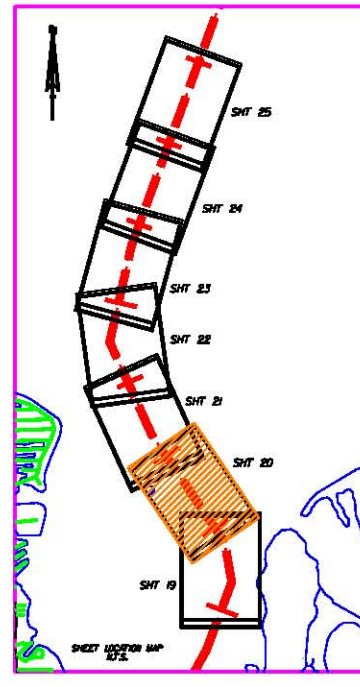

MATCHLINE SHEET NO. 21 STA. 36+00

MATCHLINE SHEET NO. 19 STA. 6+00

Y 1,157,898  
Y 1,159,898  
Y 1,159,898  
Y 1,159,898  
Y 1,157,898  
Y 1,157,898

6

5

4

3

2

1

X 431,000

X 430,500

X 430,000

X 429,500

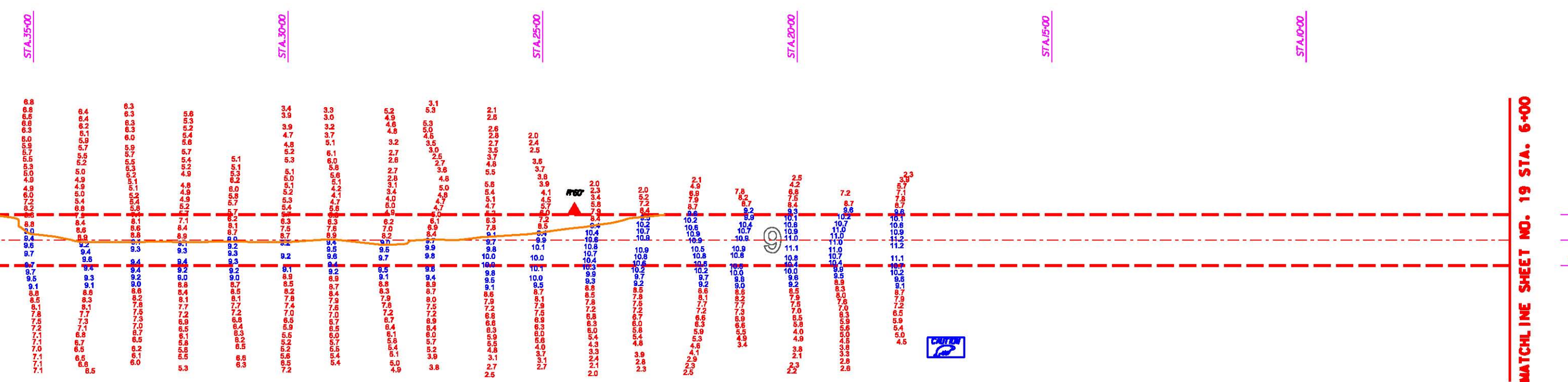

**CUT M-12**  
AZ-M5-49-53

AIDS TO NAVIGATION	PLANE COORDINATES		LATITUDE	LONGITUDE
	X	Y		
DBN-68 (88/18)	431,111	1,157,737	27°31'01.15"	82°41'39.66"
510N (88/18)	431,385	1,156,984	27°30'53.76"	82°41'37.46"

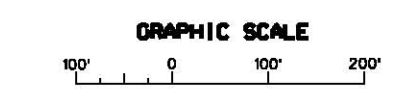

NOTES:  
1. REFER TO SURVEY NO. 10-096.  
2. SEE SHEET NO. J FOR SURVEY NOTES.





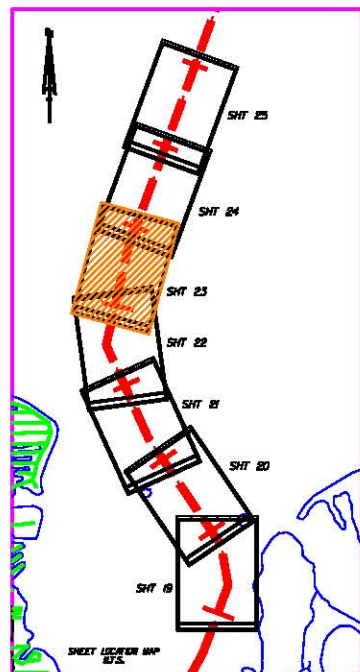

**US Army Corps of Engineers**  
Jacksonville District

**SAFETY ON THIS JOB  
DEPENDS ON YOU**

**DEPARTMENT OF THE ARMY**  
Jacksonville District

DESIGNED BY: [blank]  
CHECKED BY: [blank]  
DATE: [blank]

**GULF INTRACOASTAL WATERWAY  
CALOOSAHATCHEE RIVER TO ANGLOTE RIVER  
EXAMINATION SURVEY FY10  
9-FOOT PROJECT**

STA 9+00 CUT M-14 THRU STA 14+00 CUT M-15  
PLAN

DRAWING NO.  
**5/5**

SHEET 23 OF 33

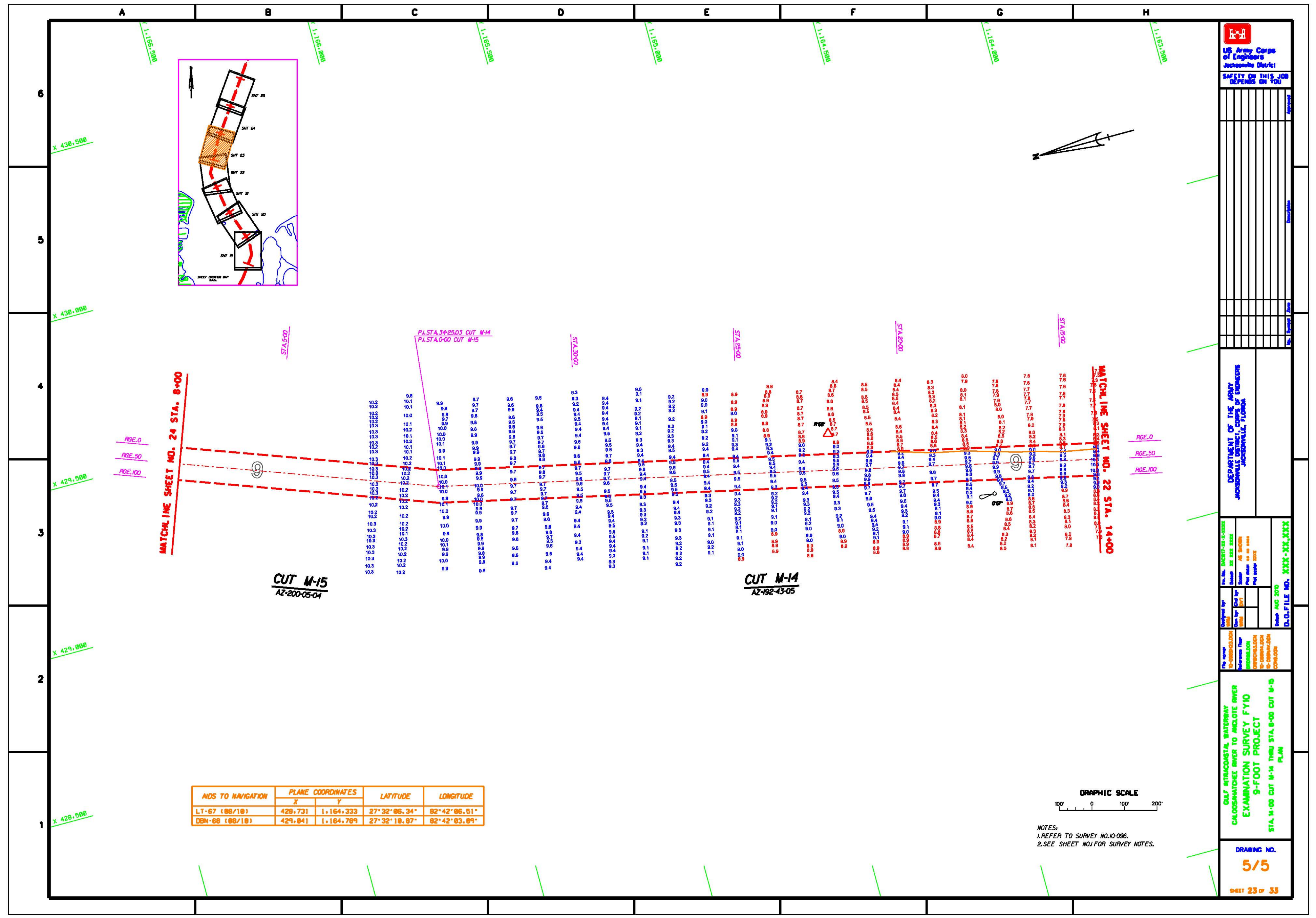

RGE.0  
RGE.50  
RGE.100

RGE.0  
RGE.50  
RGE.100

MATCHLINE SHEET NO. 24 STA. 8+00

MATCHLINE SHEET NO. 22 STA. 14+00

**CUT M-15**  
AZ:200-05-04

**CUT M-14**  
AZ:192-43-05

NDS TO NAVIGATION	PLANE COORDINATES		LATITUDE	LONGITUDE
	X	Y		
LT-67 (88/18)	428.731	1.164.333	27°32'06.34"	82°42'06.51"
DBN-68 (88/18)	429.841	1.164.789	27°32'18.87"	82°42'03.89"



NOTES:  
1. REFER TO SURVEY NO. 10-096.  
2. SEE SHEET NO. 1 FOR SURVEY NOTES.