

# INTRACOASTAL WATERWAY CALOOSAHATCHEE RIVER TO ANCLOTE RIVER CUTS M-4 THRU M-7 EXAM SURVEY

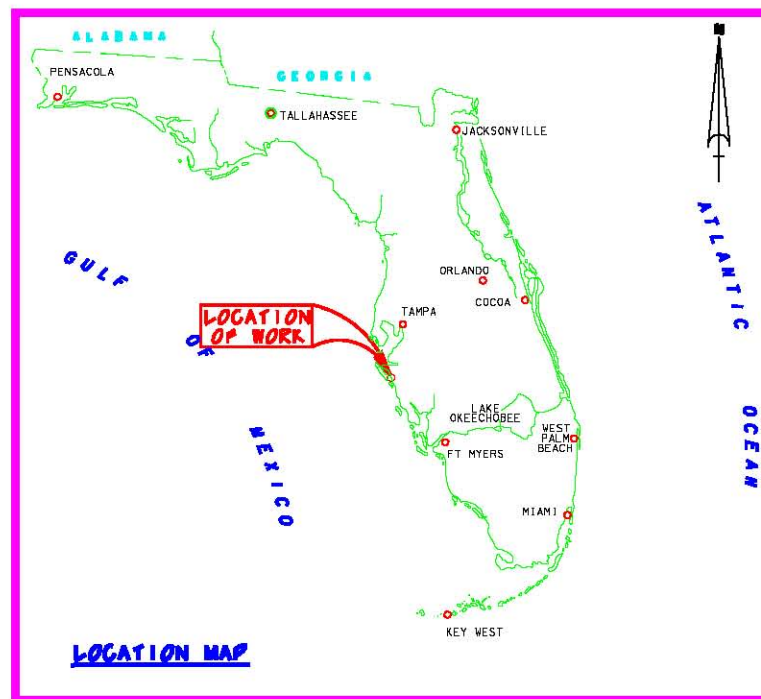

- SURVEY NOTES:**
1. REFER TO SURVEY NO. 08-130.
  2. SOUNDINGS ARE IN FEET AND TENTHS AND REFER TO MEAN LOWER LOW WATER (MLLW) WHICH IS 1.57 FEET BELOW NAVD 1988.
  3. ALL ELEVATIONS ARE BELOW THE CHART DATUM UNLESS PRECEDED BY A (+) SIGN.
  4. TIDAL REDUCTIONS WERE MADE FROM A STAFF SET ON A DOCK PILING IN THE VICINITY OF, AND REFERENCED FROM BENCHMARK \*NGS NO.1 1953\*.
  5. PLANE COORDINATES ARE BASED ON THE TRANSVERSE MERCATOR PROJECTION FOR THE WEST ZONE OF FLORIDA AND REFERENCED TO NORTH AMERICAN DATUM OF 1983 (NAD83).
  6. ALL AZIMUTHS ARE GRID; RECKONED CLOCKWISE FROM SOUTH.
  7. ALL STATOKING REFERS TO THE CENTERLINE OF THE CHANNEL.
  8. SURVEY WAS PERFORMED USING DIFFERENTIAL GPS FOR POSITIONING AND UTILIZING THE USCG NAVBEACON SYSTEM AS THE REFERENCE SITE. VERTICAL MEASUREMENTS WERE MADE USING A ROSS SMART SOUNDER DEPTH RECORDER WITH A 200KHZ (HIGH FREQUENCY) TRANSDUCER.
- | VESSEL     | DATE OF SURVEY | CUT          |
|------------|----------------|--------------|
| GANNETT II | 20-21 MAY 2008 | M-4 THRU M-7 |
9. AIDS TO NAVIGATION WERE LOCATED DURING THIS SURVEY.
  10. THE INFORMATION DEPICTED ON THIS MAP REPRESENTS THE RESULTS OF SURVEYS MADE ON THE DATES INDICATED ABOVE AND CAN ONLY BE CONSIDERED AS INDICATING THE GENERAL CONDITIONS AT THAT TIME. THIS CHART IS SOLELY FOR THE DISTRIBUTION OF AVAILABLE DEPTHS AT THE TIME OF THE SURVEY AND IS NOT TO BE USED FOR NAVIGATION.
  11. SURVEY ACCURACY PERFORMANCE STANDARDS, QUALITY CONTROL, AND QUALITY ASSURANCE REQUIREMENTS WERE FOLLOWED DURING THIS SURVEY IN ACCORDANCE WITH USACE EM 1110-2-1003, HYDROGRAPHIC SURVEYS, 01 APR 04.

BENCHMARK	NAVD ELEV. (FT)
NGS NO. 1 1953	3.18

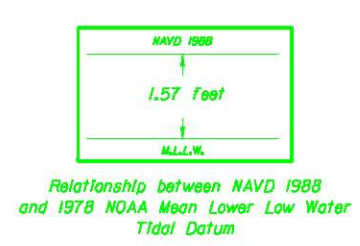

LEGEND	
• BM	BENCHMARK
⊕	LIGHTED BEACON
◻	GREEN DAYBEACON
◼	RED DAYBEACON
⊙	RED LIGHTED BUOY
⊙	GREEN LIGHTED BUOY
⊙	CAN BUOY
⊙	MIN BUOY
⊙	TIDE STAFF



**US Army Corps of Engineers**  
Jacksonville District  
SAFETY ON THIS JOB  
DEPENDS ON YOU

---

**DEPARTMENT OF THE ARMY**  
Corps of Engineers  
Jacksonville, Florida

---

**INTRACOASTAL WATERWAY  
CALOOSAHATCHEE RIVER TO ANCLOTE RIVER  
EXAM SURVEY  
9-FOOT PROJECT  
INDEX, LOCATION & VICINITY  
PLAN**

---

DRAWING NO.  
**1/14**

SHEET 1 of 14



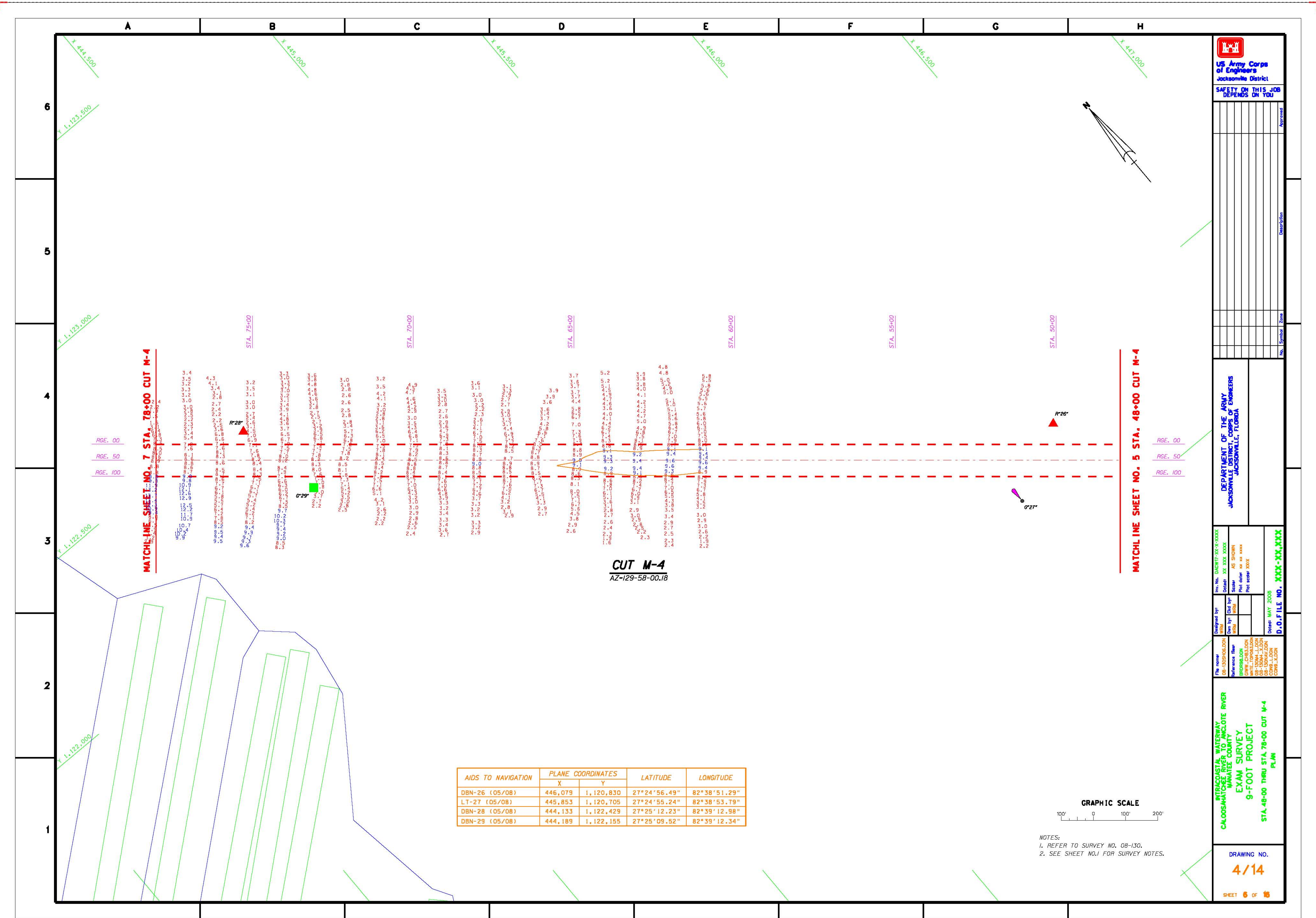

MATCHLINE SHEET NO. 7 STA. 78+00 CUT M-4

MATCHLINE SHEET NO. 5 STA. 48+00 CUT M-4

CUT M-4  
AZ-129-5B-00.1B

AIDS TO NAVIGATION	PLANE COORDINATES		LATITUDE	LONGITUDE
	X	Y		
DBN-26 (05/08)	446,079	1,120,830	27°24'56.49"	82°38'51.29"
LT-27 (05/08)	445,853	1,120,705	27°24'55.24"	82°38'53.79"
DBN-28 (05/08)	444,133	1,122,429	27°25'12.23"	82°39'12.98"
DBN-29 (05/08)	444,189	1,122,155	27°25'09.52"	82°39'12.34"



NOTES:  
1. REFER TO SURVEY NO. 08-130.  
2. SEE SHEET NO.1 FOR SURVEY NOTES.

US Army Corps of Engineers  
Jacksonville District  
SAFETY ON THIS JOB  
DEPENDS ON YOU

DEPARTMENT OF THE ARMY  
CORPS OF ENGINEERS  
JACKSONVILLE, FLORIDA

Drawn by: [Name]  
Checked by: [Name]  
Date: [Date]  
Scale: AS SHOWN  
Plot scale: 1" = 100'

INTRACOSTAL WATERWAY  
CALOOSAHATCHEE RIVER TO INDILOTE RIVER  
EXAM SURVEY  
9-FOOT PROJECT  
STA. 48+00 THRU STA. 78+00 CUT M-4  
PLAN

DRAWING NO.  
**4/14**

SHEET 6 OF 6





SAFETY ON THIS JOB DEPENDS ON YOU

No.	Symbol	Zone	Description

DEPARTMENT OF THE ARMY  
CORPS OF ENGINEERS  
JACKSONVILLE, FLORIDA

Rev. No.	DATE	BY	DESCRIPTION
01	06/07/2006	WEM	ISSUE FOR CONSTRUCTION
02	05/20/2008	WEM	ISSUE FOR CONSTRUCTION

INTRACASTAL WATERWAY  
CALOOSAHATCHEE RIVER TO INDILOTE RIVER  
EXAM SURVEY  
9-FOOT PROJECT  
STA. 48+00 THRU STA 78+00 CUT M-4  
PLAN

DRAWING NO.  
**5/14**  
SHEET **7** of **8**

AIDS TO NAVIGATION	PLANE COORDINATES		LATITUDE	LONGITUDE
	X	Y		
LT-30 (05/08)	442,871	1,123,463	27°25'22.40"	82°39'27.05"
DBN-31 (05/08)	442,769	1,123,372	27°25'21.50"	82°39'28.17"

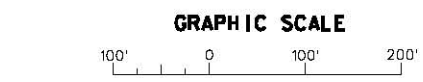
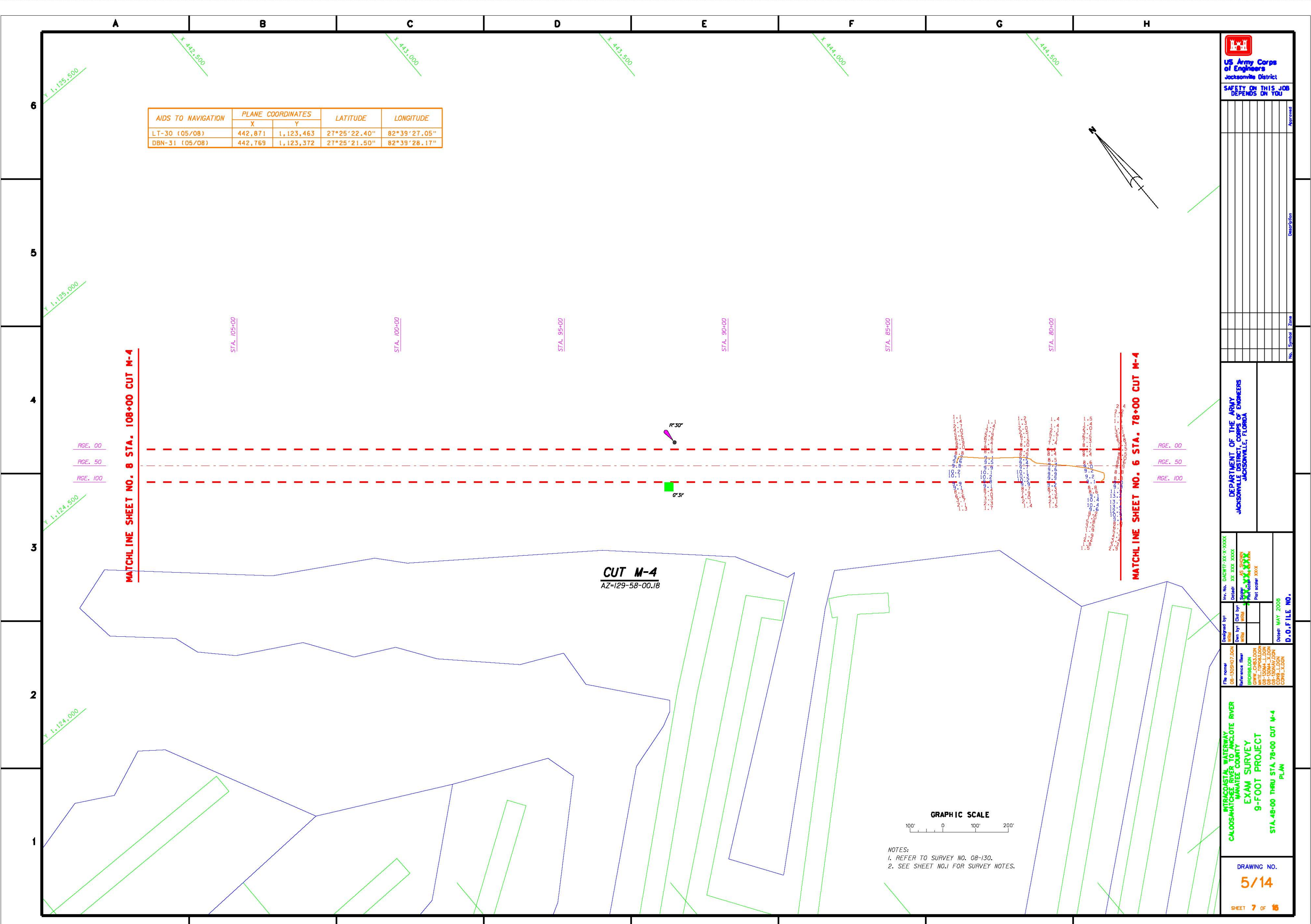

NOTES:  
1. REFER TO SURVEY NO. 08-130.  
2. SEE SHEET NO.1 FOR SURVEY NOTES.



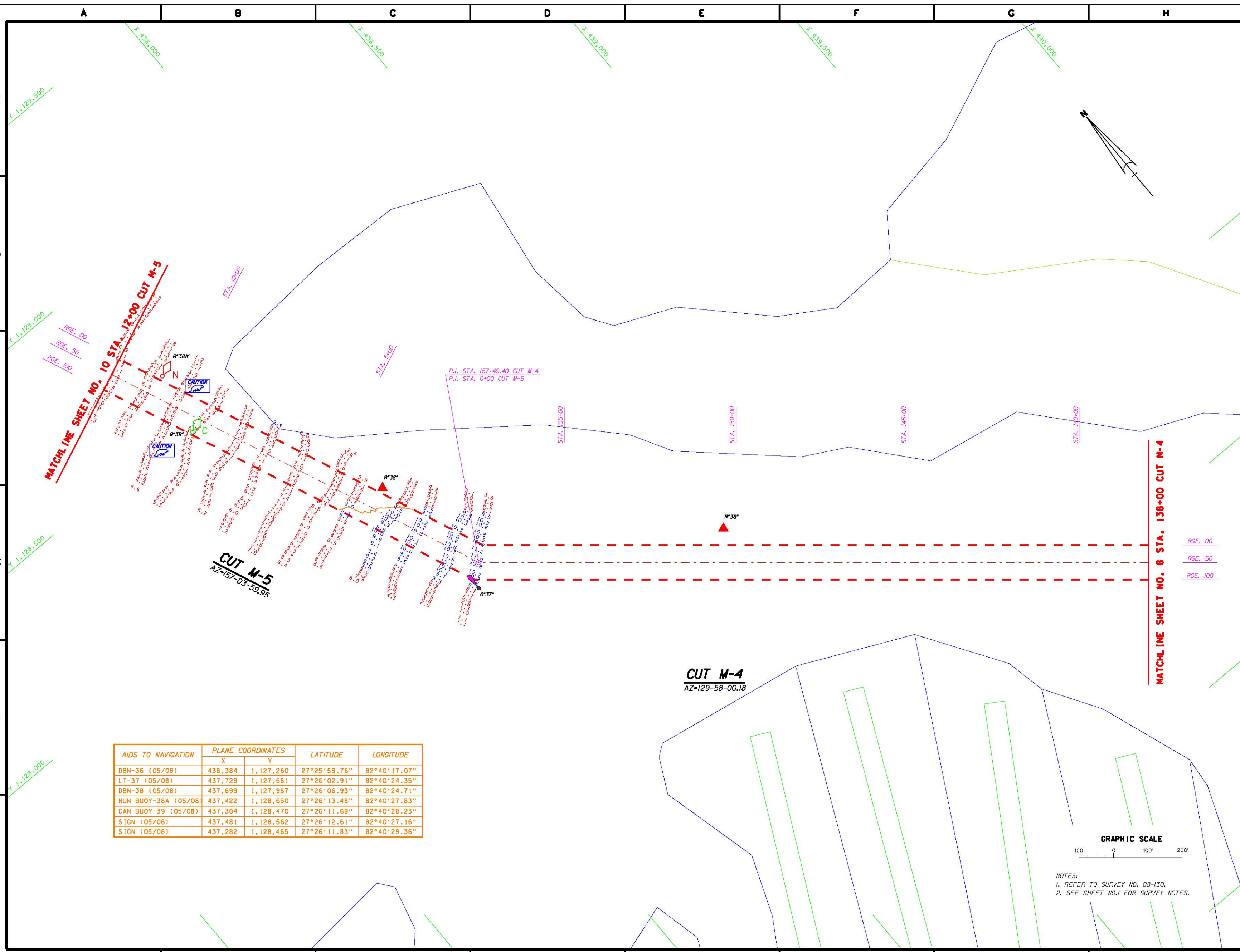

AIDS TO NAVIGATION	PLANE COORDINATES		LATITUDE	LONGITUDE
	X	Y		
DBN-36 (05/08)	438,384	1,127,260	27°25'59.76"	82°40'17.07"
LT-37 (05/08)	437,729	1,127,581	27°26'02.91"	82°40'24.35"
DBN-38 (05/08)	437,699	1,127,987	27°26'06.93"	82°40'24.71"
NUN BUOY-38A (05/08)	437,422	1,128,650	27°26'13.48"	82°40'27.83"
CAN BUOY-39 (05/08)	437,384	1,128,470	27°26'11.69"	82°40'28.23"
SIGN (05/08)	437,481	1,128,562	27°26'12.61"	82°40'27.16"
SIGN (05/08)	437,282	1,128,485	27°26'11.83"	82°40'29.36"

Rev.	By	Description

DEPARTMENT OF THE ARMY  
CORPS OF ENGINEERS  
JACKSONVILLE, FLORIDA

Drawn by: [Name]	Check by: [Name]	Scale: AS SHOWN

**INTRACASTAL WATERWAY  
CALOOSAHATCHEE RIVER TO INDILOTE RIVER  
EXAM SURVEY  
9-FOOT PROJECT  
STA 138+00 CUT M-4 THRU STA. 12+00 CUT M-5  
PLAN**

DRAWING NO.  
**7/14**



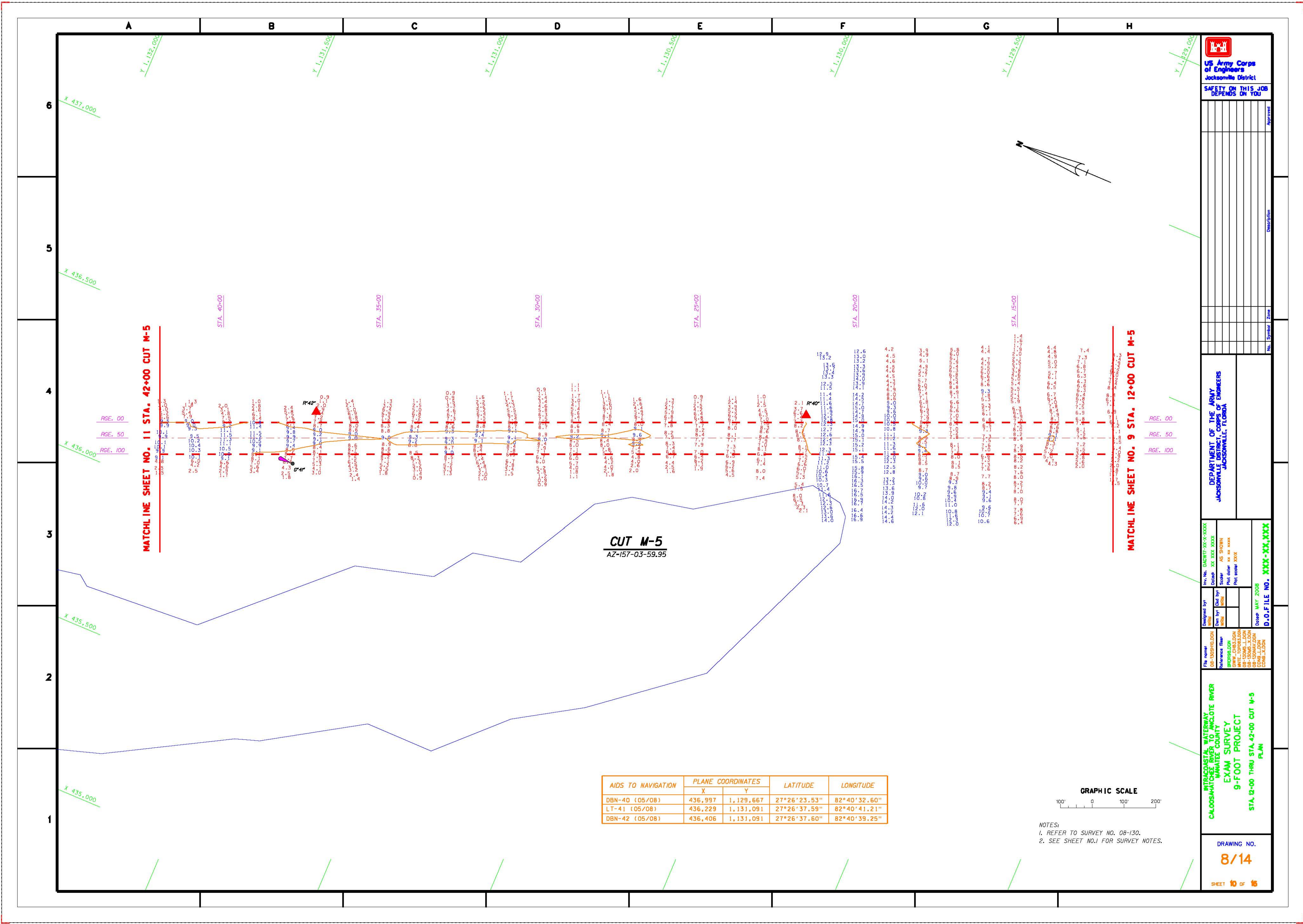

AIDS TO NAVIGATION	PLANE COORDINATES		LATITUDE	LONGITUDE
	X	Y		
DBN-40 (05/08)	436,997	1,129,667	27°26'23.53"	82°40'32.60"
LT-41 (05/08)	436,229	1,131,091	27°26'37.59"	82°40'41.21"
DBN-42 (05/08)	436,406	1,131,091	27°26'37.60"	82°40'39.25"



NOTES:  
1. REFER TO SURVEY NO. 08-130.  
2. SEE SHEET NO.1 FOR SURVEY NOTES.

**US Army Corps of Engineers**  
Jacksonville District

SAFETY ON THIS JOB  
DEPENDS ON YOU

No.	Symbol	Zone

DEPARTMENT OF THE ARMY  
CORPS OF ENGINEERS  
JACKSONVILLE DISTRICT

Designated by: Inv. No. DACR77-XX-X-XXXX  
Date for: 08-130-0000  
Scale: AS SHOWN  
Drawn by: BJK  
Plot scale: AS SHOWN  
Plot scale: AS SHOWN  
Date: MAY 2008  
D-0 FILE NO. XXX-XX,XXX

INTRACASTAL WATERWAY  
CALOOSAHATCHEE RIVER AND TOLUCLOTE RIVER  
EXAM SURVEY  
9-FOOT PROJECT  
STA. 12+00 THRU STA. 42+00 CUT M-5  
PLAN

DRAWING NO.  
**8/14**  
SHEET 8 OF 8



AIDS TO NAVIGATION	PLANE COORDINATES		LATITUDE	LONGITUDE
	X	Y		
DBN-43 (05/08)	435,774	1,132,361	27°26'50.13"	82°40'46.33"
DBN-44 (05/08)	435,793	1,132,561	27°26'52.12"	82°40'46.14"

**CUT M-5**  
AZ-157-03-59.95

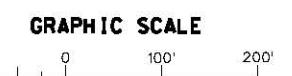

NOTES:  
1. REFER TO SURVEY NO. 08-130.  
2. SEE SHEET NO.1 FOR SURVEY NOTES.



**US Army Corps of Engineers**  
Jacksonville District

SAFETY ON THIS JOB  
DEPENDS ON YOU

No.	Symbol	Zone

**DEPARTMENT OF THE ARMY**  
CORPS OF ENGINEERS  
JACKSONVILLE, FLORIDA

Inv. No. DACR17-XX-9-XXXX  
Date: 00 000 0000  
Scale: AS SHOWN  
Plot scale: xx xx XXXX  
Plot scale: 0000

Designed by: [Redacted]  
Date for: [Redacted]

INTRACASTAL WATERWAY  
CALOOSAHATCHEE RIVER  
COUNTY  
EXAM SURVEY  
9-FOOT PROJECT  
STA. 12+00 THRU STA. 42+00 CUT M-5  
PLAN

DRAWING NO.  
**9/14**

SHEET 11 OF 15



Y 1,145,500

Y 1,145,000

Y 1,144,500

Y 1,144,000

Y 1,143,500

Y 1,143,000

Y 1,142,500

6

5

4

3

2

1

X 431,000

X 430,500

X 430,000

X 429,500

X 429,000

MATCHLINE SHEET NO. 16 STA. 70+00 CUT M-7

MATCHLINE SHEET NO. 14 STA. 40+00 CUT M-7

AIDS TO NAVIGATION	PLANE COORDINATES		LATITUDE	LONGITUDE
	X	Y		
DBN-50 (05/08)	430,409	1,144,297	27°28'48.04"	82°41'48.62"
SIGN (05/08)	430,599	1,144,314	27°28'48.21"	82°41'44.52"

CUT M-7  
AZ-163-49-41



NOTES:  
1. REFER TO SURVEY NO. 08-130.  
2. SEE SHEET NO.1 FOR SURVEY NOTES.



SAFETY ON THIS JOB  
DEPENDS ON YOU

No.	Symbol	Zone	Description

DEPARTMENT OF THE ARMY  
CORPS OF ENGINEERS  
JACKSONVILLE DISTRICT  
JACKSONVILLE, FLORIDA

Designated by: \_\_\_\_\_  
Date: \_\_\_\_\_  
Scale: AS SHOWN  
Plot scale: AS SHOWN

INTRACASTAL WATERWAY  
CALOOSAHATCHEE RIVER  
FLORIDA  
EXAM SURVEY  
9-FOOT PROJECT  
STA. 30+00 THRU STA. 40+00 CUT M-7  
PLAN

DRAWING NO.  
13/14

SHEET 13 OF 14