

NAD-83, STATE PLANE - FLORIDA EAST ZONE

PT	X	Y	STATION	RANGE
1	736,976.18	1,497,800.79	(-)0+07.10	50.00
2	736,987.93	1,497,751.67	0+00.00	0.00
3	736,967.17	1,498,107.10	0+12.61	335.81
4	737,105.75	1,497,523.56	0+56.95	(-)1235.23
5	737,327.03	1,497,884.00	3+50.00	100.00
6	737,336.39	1,497,784.44	3+50.00	0.00
7	745,389.10	1,498,642.15	84+47.66	100.00
8	745,524.40	1,498,805.54	85+47.67	250.00
9	746,071.99	1,498,857.03	91+47.67	250.00
10	746,095.39	1,498,609.13	91+47.67	0.00

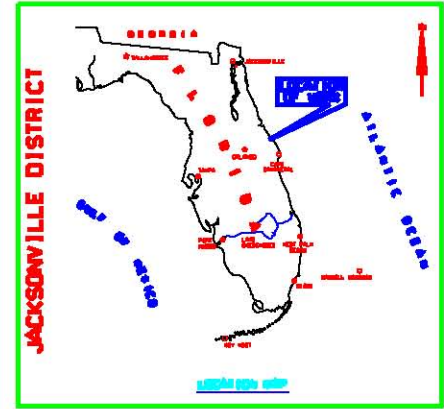

U.S. Army Corps of Engineers
Jacksonville District

SAFETY ON THIS JOB DEPENDS ON YOU

Frontenac

Courtenay

Williams Point

515

INTRACOSTAL WATERWAY CUT BV-16

INTRACOSTAL WATERWAY CUT BV-17

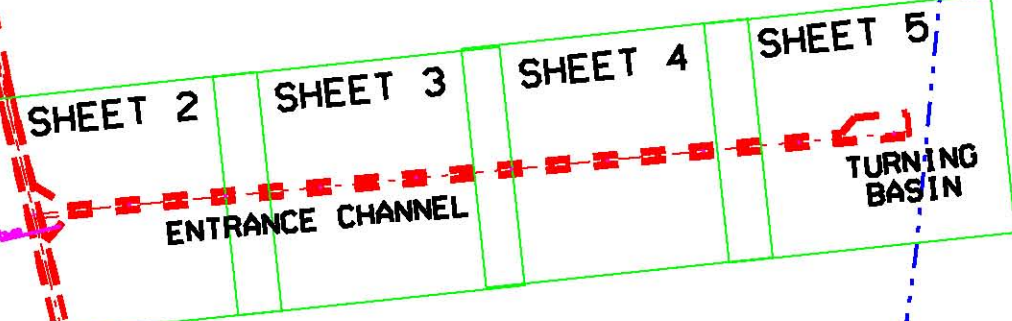

SURVEY NOTES:

- REFER TO SURVEY NO. 06-111.
- SOUNDINGS ARE IN FEET AND TENTHS AND REFER TO MEAN LOW WATER (MLW) WHICH IS 0.10 FEET BELOW NGVD 1929.
- ALL ELEVATIONS ARE BELOW THE CHART DATUM UNLESS PRECEDED BY A (-) SIGN.
- TIDAL REDUCTIONS WERE MADE FROM A STAFF NAILED TO A PILING ON AN INFO SIGN, AND REFERENCED FROM BENCHMARK 'CUT-4 EAST 1984'.
- PLANE COORDINATES ARE BASED ON THE TRANSVERSE MERCATOR PROJECTION FOR THE EAST ZONE OF FLORIDA AND REFERENCED TO NORTH AMERICAN DATUM OF 1983 (NAD83).
- ALL AZIMUTHS ARE GRID; RECKONED CLOCKWISE FROM SOUTH.
- ALL STATIONING REFERS TO THE CENTERLINE OF THE CHANNEL.
- SURVEY WAS PERFORMED USING DIFFERENTIAL GPS FOR POSITIONING AND UTILIZING THE USCG NAVBEACON SYSTEM AS THE REFERENCE SITE. VERTICAL MEASUREMENTS WERE MADE USING A ROSS SMART SOUNDER DEPTH RECORDER WITH A 200KHZ (HIGH FREQUENCY) TRANSDUCER.
- AIDS TO NAVIGATION WERE LOCATED DURING THIS SURVEY.
- THE INFORMATION DEPICTED ON THIS MAP REPRESENTS THE RESULTS OF SURVEYS MADE ON THE DATES INDICATED ABOVE AND CAN ONLY BE CONSIDERED AS INDICATING THE GENERAL CONDITIONS AT THAT TIME. THIS CHART IS SOLELY FOR THE DISTRIBUTION OF AVAILABLE DEPTHS AT THE TIME OF THE SURVEY AND IS NOT TO BE USED FOR NAVIGATION.
- SURVEY ACCURACY PERFORMANCE STANDARDS, QUALITY CONTROL, AND QUALITY ASSURANCE REQUIREMENTS WERE FOLLOWED DURING THIS SURVEY IN ACCORDANCE WITH USACE EM 1110-2-1003, HYDROGRAPHIC SURVEYING, 1 JAN 02.

VESSEL	DATE OF SURVEY	CUT
VB-34	06 JUL 2006	ENTRANCE CHANNEL & TURNING BASIN

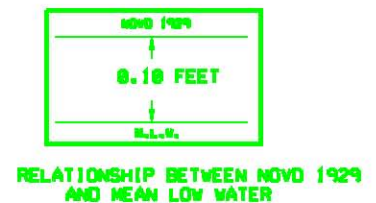

INDEX OF SHEETS	
SHEET NO.	DESCRIPTION
1	INDEX, LOCATION AND VICINITY MAP
2-5	PLAN VIEW OF PROJECT



U.S. Army Corps of Engineers Jacksonville District	
SAFETY ON THIS JOB DEPENDS ON YOU	
[Empty grid for metadata]	
DEPARTMENT OF THE ARMY Jacksonville District	
Drawn by: [Empty]	Checked by: [Empty]
Designed by: [Empty]	Reviewed by: [Empty]
Reviewed by: [Empty]	Checked by: [Empty]
Reviewed by: [Empty]	Checked by: [Empty]
Reviewed by: [Empty]	Checked by: [Empty]
D.O.P. FILE NO. XXX-XXX-XXX	
COURTENAY CHANNEL BREVARD COUNTY, FLORIDA PROJECT CONDITION SURVEY 8-FOOT PROJECT LOCATION AND INDEX PLAN	
DRAWING NO. 1/5	
SHEET 1 of 5	

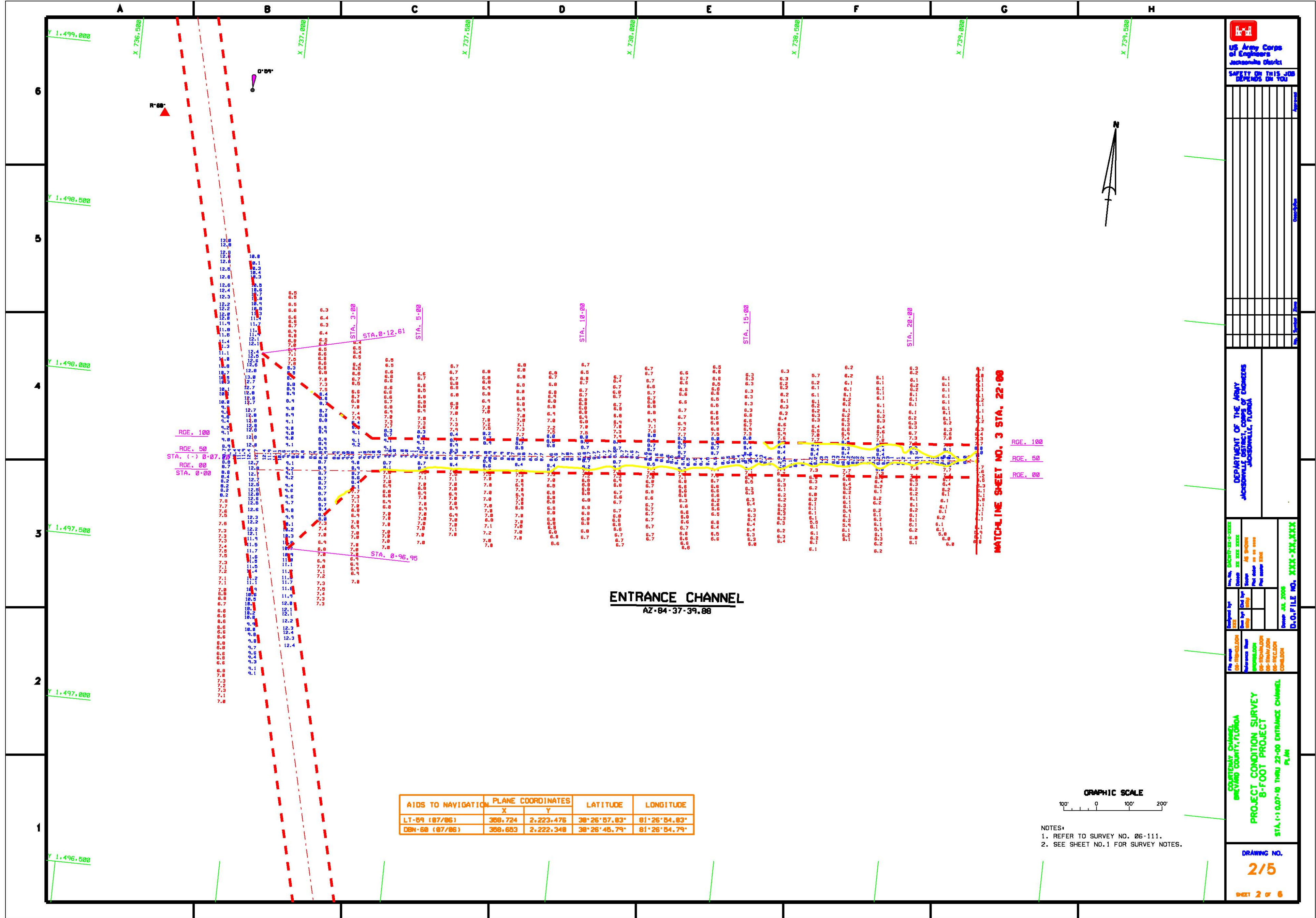

US Army Corps of Engineers
Jacksonville District

SAFETY ON THIS JOB
DEPENDS ON YOU

DEPARTMENT OF THE ARMY
Jacksonville District

PROJECT CONDITION SURVEY
8-FOOT PROJECT
STA. 0+00 THRU 22+00 ENTRANCE CHANNEL
PLAN

DRAWING NO.
2/5
SHEET 2 OF 6

AIDS TO NAVIGATION	PLANE COORDINATES		LATITUDE	LONGITUDE
	X	Y		
LT-69 (87/86)	368,724	2,223,476	38°26'57.83"	81°26'54.83"
DBN-68 (87/86)	368,653	2,222,348	38°26'46.79"	81°26'54.79"



NOTES:
1. REFER TO SURVEY NO. 06-111.
2. SEE SHEET NO.1 FOR SURVEY NOTES.

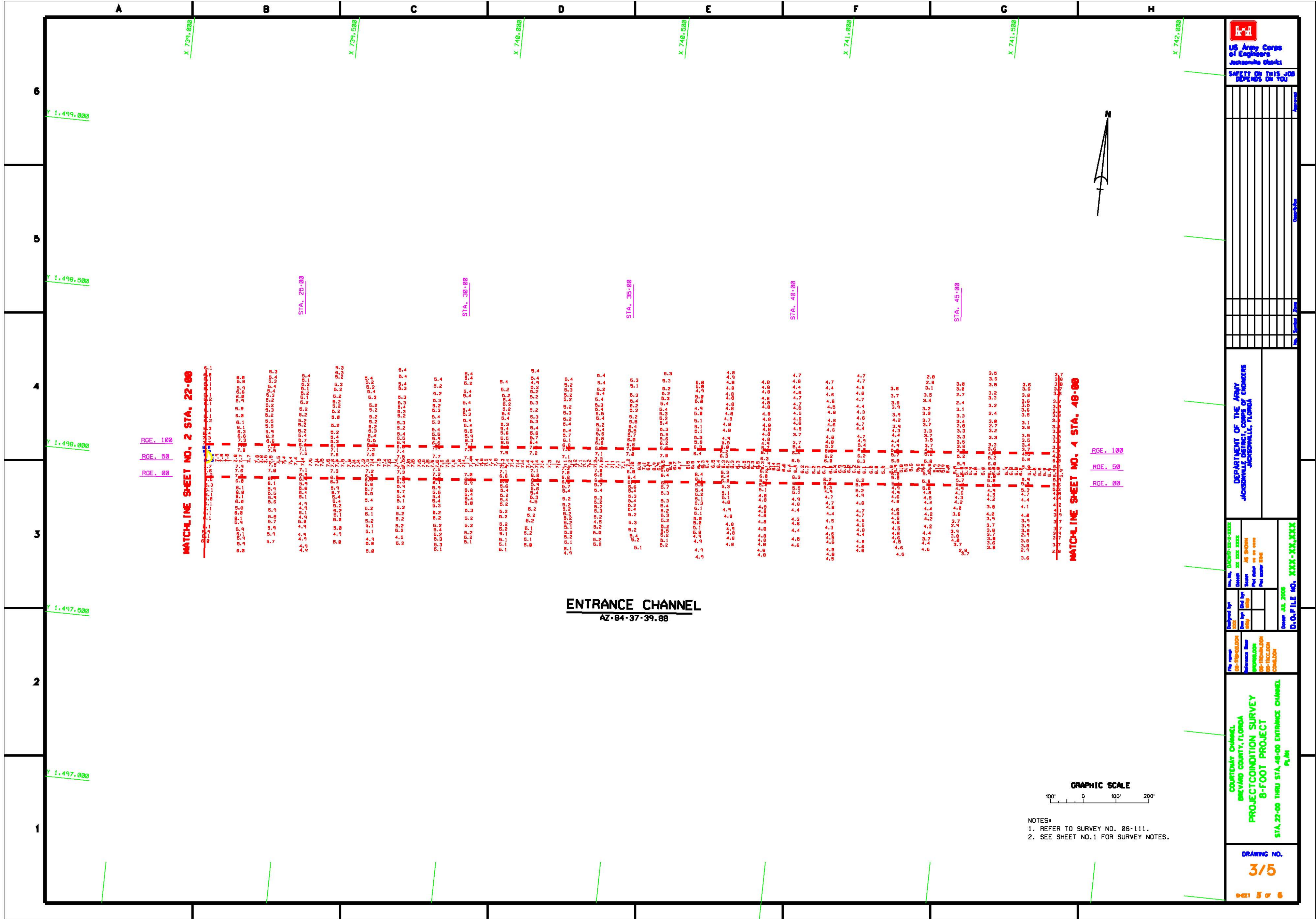

MATCHLINE SHEET NO. 2 STA. 22+00

MATCHLINE SHEET NO. 4 STA. 48+00

ENTRANCE CHANNEL
AZ-84-37-39.88

RGE. 100
RGE. 50
RGE. 00

RGE. 100
RGE. 50
RGE. 00



NOTES:
1. REFER TO SURVEY NO. 06-111.
2. SEE SHEET NO. 1 FOR SURVEY NOTES.



SAFETY ON THIS JOB DEPENDS ON YOU

DEPARTMENT OF THE ARMY
JACKSONVILLE DISTRICT

Drawn by: [Name]
Checked by: [Name]
Scale: As Shown
Plot Date: [Date]
Plot Scale: [Scale]

COURTESY CHANNEL
BREVARD COUNTY, FLORIDA
PROJECT CONDITION SURVEY
8-FOOT PROJECT
STA. 22+00 THRU STA. 48+00 ENTRANCE CHANNEL
PLAN

DRAWING NO.
3/5

SHEET 3 OF 6

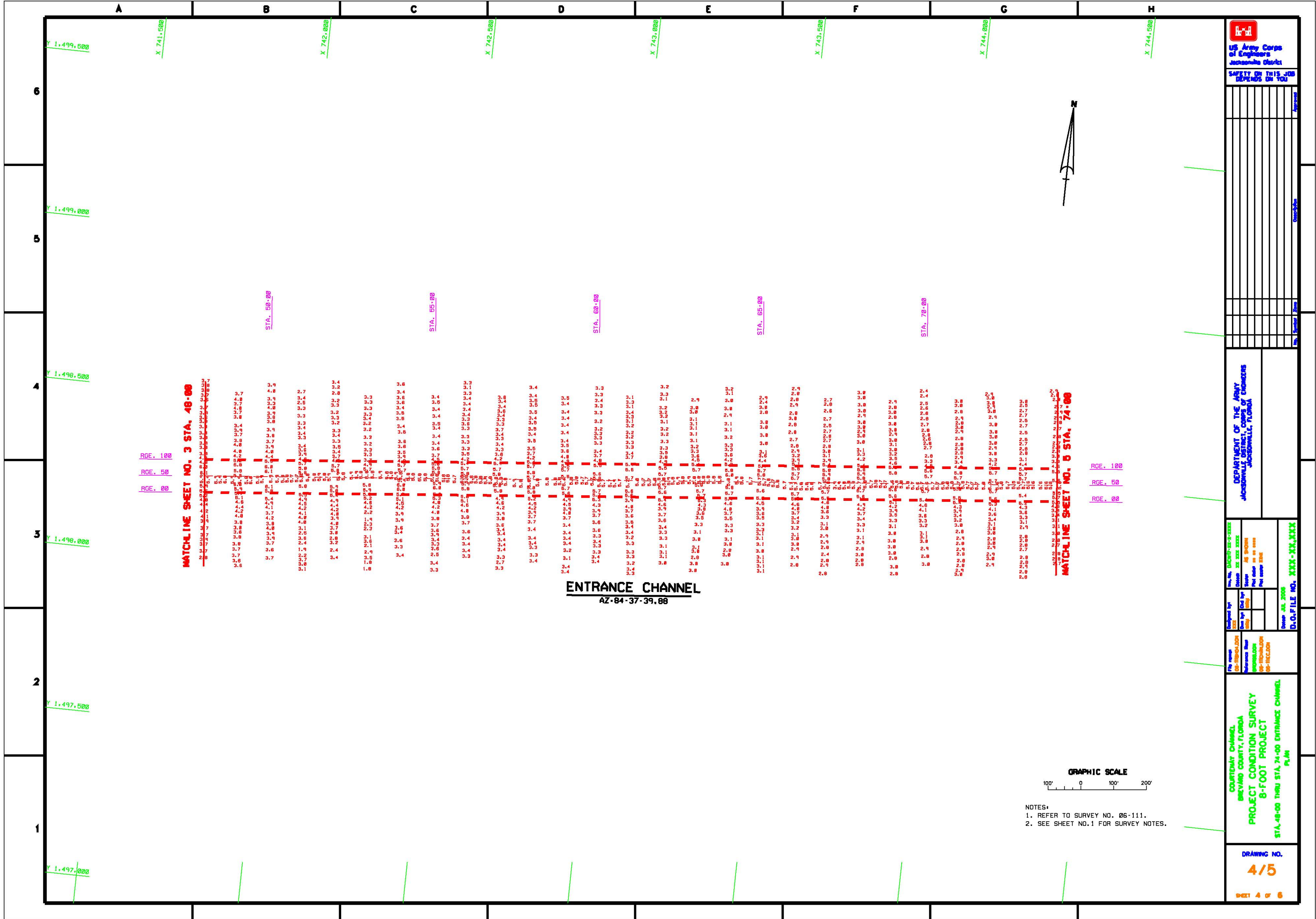

 US Army Corps of Engineers
 Jacksonville District
 SAFETY ON THIS JOB DEPENDS ON YOU

DEPARTMENT OF THE ARMY
 Jacksonville District
 Jacksonville, Florida

Project No. 06-111-0000
 Date 05/03/06
 Scale As Shown
 Plot Date 05/03/06
 Plot Scale 1:1

COURTESY CHANNEL
 BREVARD COUNTY, FLORIDA
 PROJECT CONDITION SURVEY
 8-FOOT PROJECT
 STA. 48+00 THRU STA. 74+00 ENTRANCE CHANNEL
 PLAN

DRAWING NO.
4/5
 SHEET 4 OF 6

GRAPHIC SCALE
 100' 0 100' 200'
 NOTES:
 1. REFER TO SURVEY NO. 06-111.
 2. SEE SHEET NO. 1 FOR SURVEY NOTES.

ENTRANCE CHANNEL
 AZ-84-37-39.88

Station	RGE. 100	RGE. 50	RGE. 00
48+00	3.7	4.8	3.4
48+01	3.7	4.8	3.4
48+02	3.7	4.8	3.4
48+03	3.7	4.8	3.4
48+04	3.7	4.8	3.4
48+05	3.7	4.8	3.4
48+06	3.7	4.8	3.4
48+07	3.7	4.8	3.4
48+08	3.7	4.8	3.4
48+09	3.7	4.8	3.4
48+10	3.7	4.8	3.4
48+11	3.7	4.8	3.4
48+12	3.7	4.8	3.4
48+13	3.7	4.8	3.4
48+14	3.7	4.8	3.4
48+15	3.7	4.8	3.4
48+16	3.7	4.8	3.4
48+17	3.7	4.8	3.4
48+18	3.7	4.8	3.4
48+19	3.7	4.8	3.4
48+20	3.7	4.8	3.4
48+21	3.7	4.8	3.4
48+22	3.7	4.8	3.4
48+23	3.7	4.8	3.4
48+24	3.7	4.8	3.4
48+25	3.7	4.8	3.4
48+26	3.7	4.8	3.4
48+27	3.7	4.8	3.4
48+28	3.7	4.8	3.4
48+29	3.7	4.8	3.4
48+30	3.7	4.8	3.4
48+31	3.7	4.8	3.4
48+32	3.7	4.8	3.4
48+33	3.7	4.8	3.4
48+34	3.7	4.8	3.4
48+35	3.7	4.8	3.4
48+36	3.7	4.8	3.4
48+37	3.7	4.8	3.4
48+38	3.7	4.8	3.4
48+39	3.7	4.8	3.4
48+40	3.7	4.8	3.4
48+41	3.7	4.8	3.4
48+42	3.7	4.8	3.4
48+43	3.7	4.8	3.4
48+44	3.7	4.8	3.4
48+45	3.7	4.8	3.4
48+46	3.7	4.8	3.4
48+47	3.7	4.8	3.4
48+48	3.7	4.8	3.4
48+49	3.7	4.8	3.4
48+50	3.7	4.8	3.4
48+51	3.7	4.8	3.4
48+52	3.7	4.8	3.4
48+53	3.7	4.8	3.4
48+54	3.7	4.8	3.4
48+55	3.7	4.8	3.4
48+56	3.7	4.8	3.4
48+57	3.7	4.8	3.4
48+58	3.7	4.8	3.4
48+59	3.7	4.8	3.4
48+60	3.7	4.8	3.4
48+61	3.7	4.8	3.4
48+62	3.7	4.8	3.4
48+63	3.7	4.8	3.4
48+64	3.7	4.8	3.4
48+65	3.7	4.8	3.4
48+66	3.7	4.8	3.4
48+67	3.7	4.8	3.4
48+68	3.7	4.8	3.4
48+69	3.7	4.8	3.4
48+70	3.7	4.8	3.4
48+71	3.7	4.8	3.4
48+72	3.7	4.8	3.4
48+73	3.7	4.8	3.4
48+74	3.7	4.8	3.4
48+75	3.7	4.8	3.4
48+76	3.7	4.8	3.4
48+77	3.7	4.8	3.4
48+78	3.7	4.8	3.4
48+79	3.7	4.8	3.4
48+80	3.7	4.8	3.4
48+81	3.7	4.8	3.4
48+82	3.7	4.8	3.4
48+83	3.7	4.8	3.4
48+84	3.7	4.8	3.4
48+85	3.7	4.8	3.4
48+86	3.7	4.8	3.4
48+87	3.7	4.8	3.4
48+88	3.7	4.8	3.4
48+89	3.7	4.8	3.4
48+90	3.7	4.8	3.4
48+91	3.7	4.8	3.4
48+92	3.7	4.8	3.4
48+93	3.7	4.8	3.4
48+94	3.7	4.8	3.4
48+95	3.7	4.8	3.4
48+96	3.7	4.8	3.4
48+97	3.7	4.8	3.4
48+98	3.7	4.8	3.4
48+99	3.7	4.8	3.4
49+00	3.7	4.8	3.4

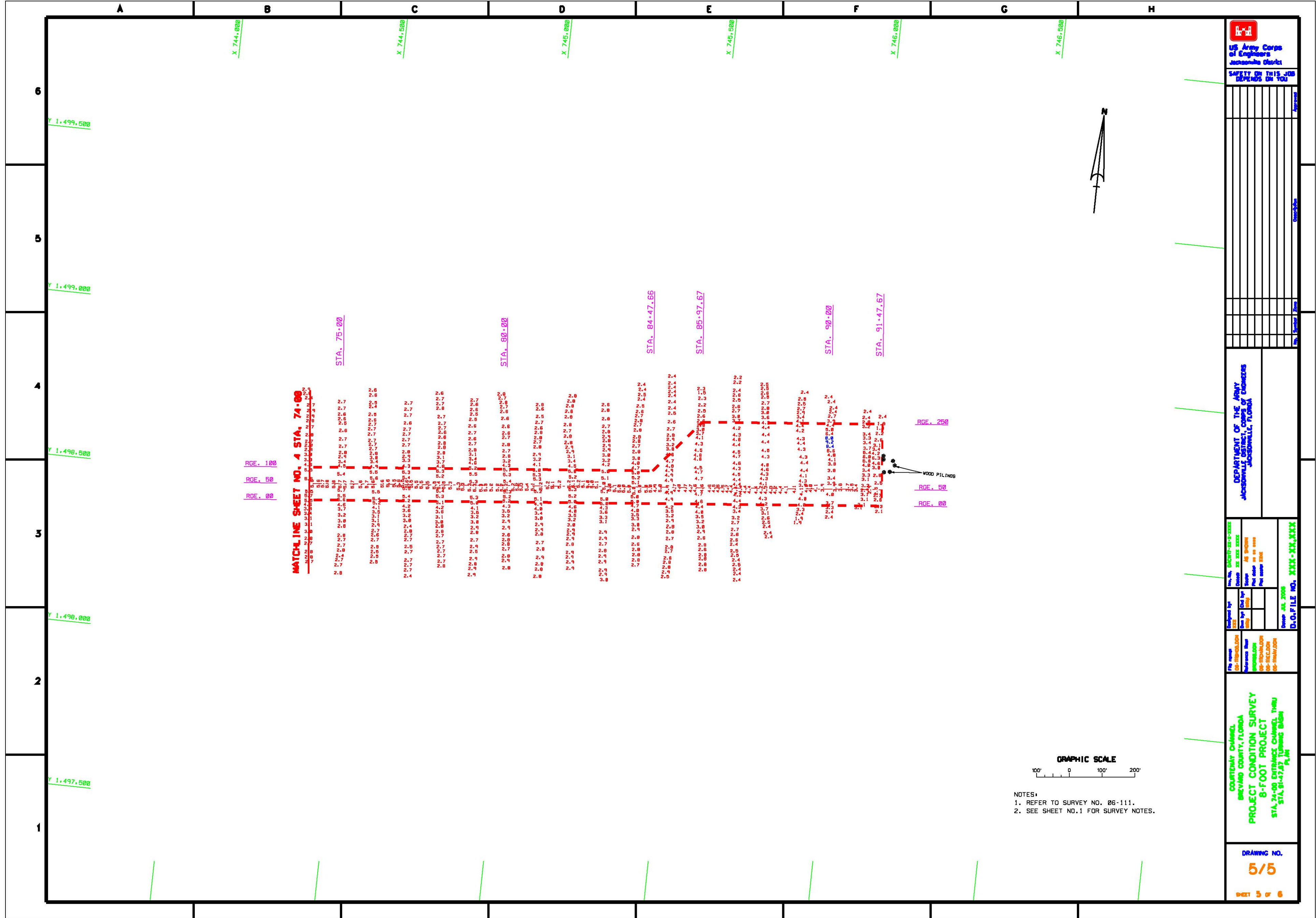

US Army Corps of Engineers
Jacksonville District

SAFETY ON THIS JOB DEPENDS ON YOU

DEPARTMENT OF THE ARMY
Jacksonville, Florida

Drawn by: [Name]
Checked by: [Name]
Scale: As Shown
Plot Date: [Date]
Plot Scale: [Scale]

PROJECT CONDITION SURVEY
8-FOOT PROJECT
STA. 24+00 ENTRANCE CHANNEL THRU
STA. 81+47.67 TURNING BARGE
PLAN

DRAWING NO.
5/5

NOTES:
1. REFER TO SURVEY NO. 06-111.
2. SEE SHEET NO.1 FOR SURVEY NOTES.