

VENICE INLET, CASEYS PASS INTRACOASTAL WATERWAY, CALOOSA HATCHEE RIVER TO ANCLOTE RIVER CUT S-15 THRU S-25 PROJECT CONDITION SURVEY

SHEET LAYOUT

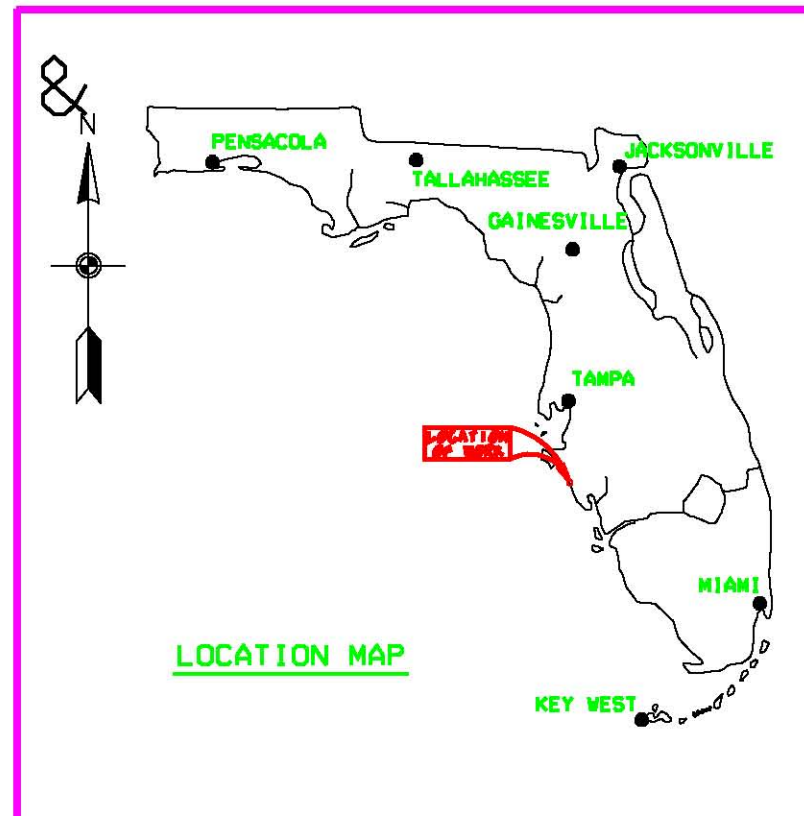
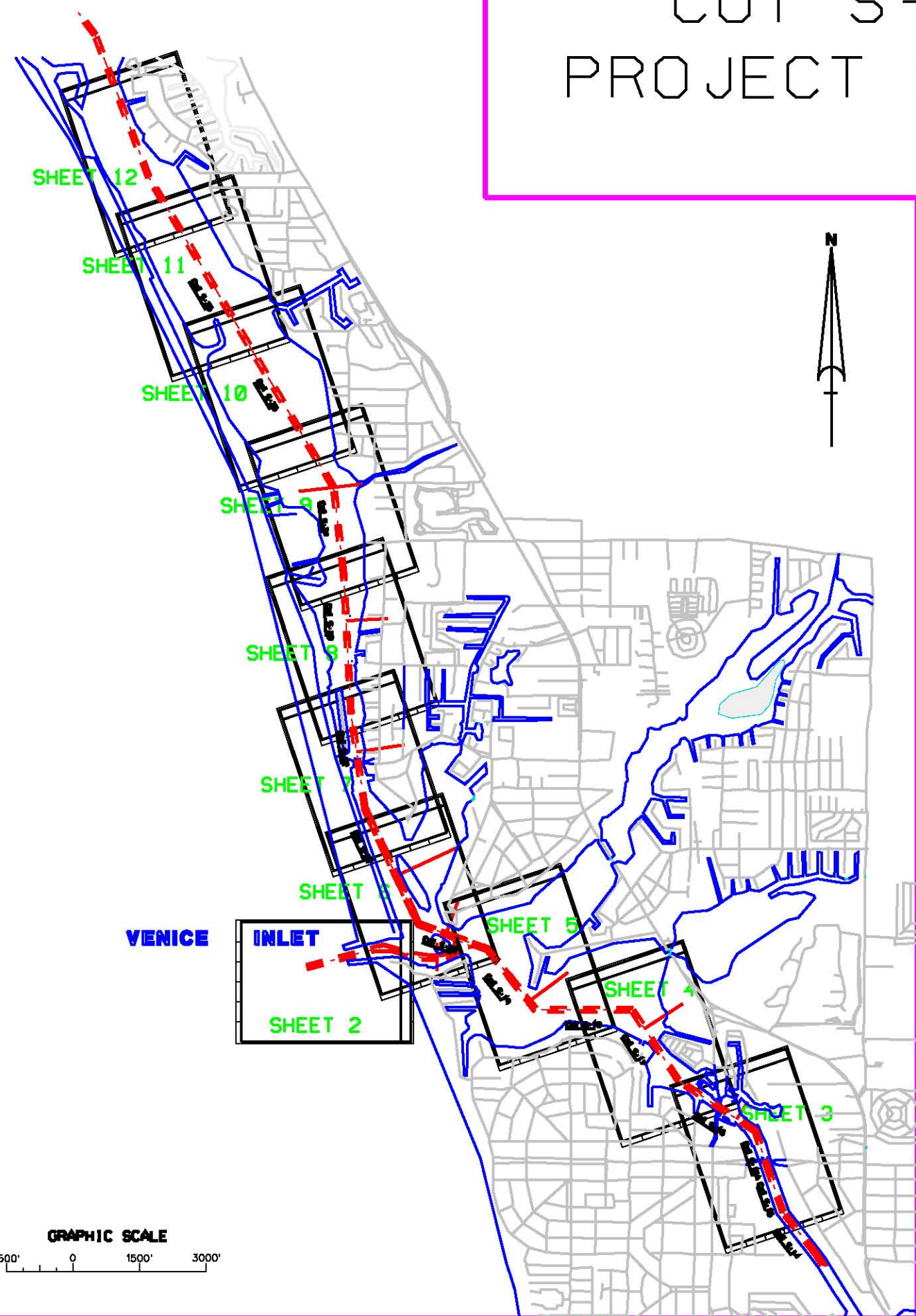

US Army Corps of Engineers
Jacksonville District
SAFETY ON THIS JOB
DEPENDS ON YOU

DEPARTMENT OF THE ARMY
CORPS OF ENGINEERS
JACKSONVILLE DISTRICT

Drawn by	Checked by	Scale	Date
		AS SHOWN	
Project No.	Contract No.	Sheet No.	Total Sheets

INTRACOASTAL WATERWAY
CALOOSA HATCHEE RIVER TO ANCLOTE RIVER, FL
PROJECT CONDITION SURVEY
9-FOOT PROJECT
WEST LOCATION AND VICINITY
PL/AM

DRAWING NO.
1/12
SHEET 1 OF 12

- SURVEY NOTES:**
- REFER TO SURVEY NO. 03-064.
 - SOUNDINGS ARE IN FEET AND TENTHS AND REFER TO MEAN LOWER LOW WATER (MLLW). REFER TO TABLES SHOWN FOR DIFFERENCES BELOW NGVD 1929.
 - ALL ELEVATIONS ARE BELOW THE CHART DATUM UNLESS PRECEDED BY A (-) SIGN.
 - TIDAL REDUCTIONS WERE MADE FROM STAFFS SET ON WOODEN PILING IN THE VICINITY OF AND REFERENCED FROM BENCHMARKS '1784 B15 (R-111)' '1WSA-85' AND 'NGS X-38'.
 - PLANE COORDINATES ARE BASED ON THE TRANSVERSE MERCATOR PROJECTION FOR THE WEST ZONE OF FLORIDA AND REFERENCED TO NORTH AMERICAN DATUM OF 1927 (NAD27).
 - ALL AZIMUTHS ARE GRID, RECKONED CLOCKWISE FROM SOUTH.
 - ALL STATIONING REFERS TO THE CENTERLINE OF THE CHANNEL.
 - SURVEY WAS PERFORMED USING DIFFERENTIAL GPS FOR POSITIONING AND UTILIZING THE USCG NAVBEACON SYSTEM AS THE REFERENCE SITE. VERTICAL MEASUREMENTS WERE MADE USING A ROSS SMART SOUNDER DEPTH RECORDER A 200KHZ (HIGH FREQUENCY) TRANSDUCER.
 - AIDS TO NAVIGATION WERE LOCATED DURING THIS SURVEY.
 - THE INFORMATION DEPICTED ON THIS MAP REPRESENTS THE RESULTS OF SURVEYS MADE ON THE DATES INDICATED ABOVE AND CAN ONLY BE CONSIDERED AS INDICATING THE GENERAL CONDITIONS AT THAT TIME.
 - SURVEY ACCURACY PERFORMANCE STANDARDS, QUALITY CONTROL, AND QUALITY ASSURANCE REQUIREMENTS WERE FOLLOWED DURING THIS SURVEY IN ACCORDANCE WITH USACE EM 1110-2-1003, HYDROGRAPHIC SURVEYS, 1 JAN 02.

LEGEND

• BM	BENCHMARK
! (with light)	LIGHTED BEACON
■ (green)	GREEN DAYBEACON
▲ (red)	RED DAYBEACON
⬠ (with light)	RED LIGHTED BUOY
⬠ (with light)	GREEN LIGHTED BUOY
⬠ (with light)	CAN BUOY
⬠ (with light)	NUN BUOY
⊕	TIDE STAFF

BENCHMARK	NGVD ELEV. (FT)
1784 B15(R-111)	6.40
1WSA-85	6.98
NGS X-38	7.60

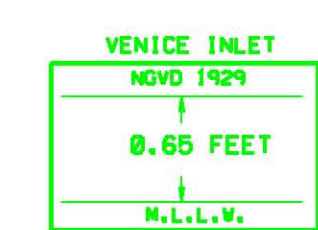

RELATIONSHIP BETWEEN NGVD 1929 AND NOAA MEAN LOWER LOW WATER TIDAL DATUM (1968-1978 EPOCH)

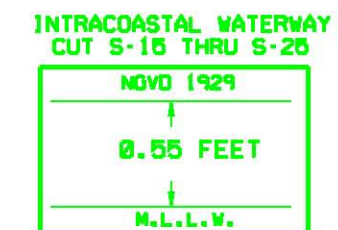

RELATIONSHIP BETWEEN NGVD 1929 AND NOAA MEAN LOWER LOW WATER TIDAL DATUM (1968-1978)

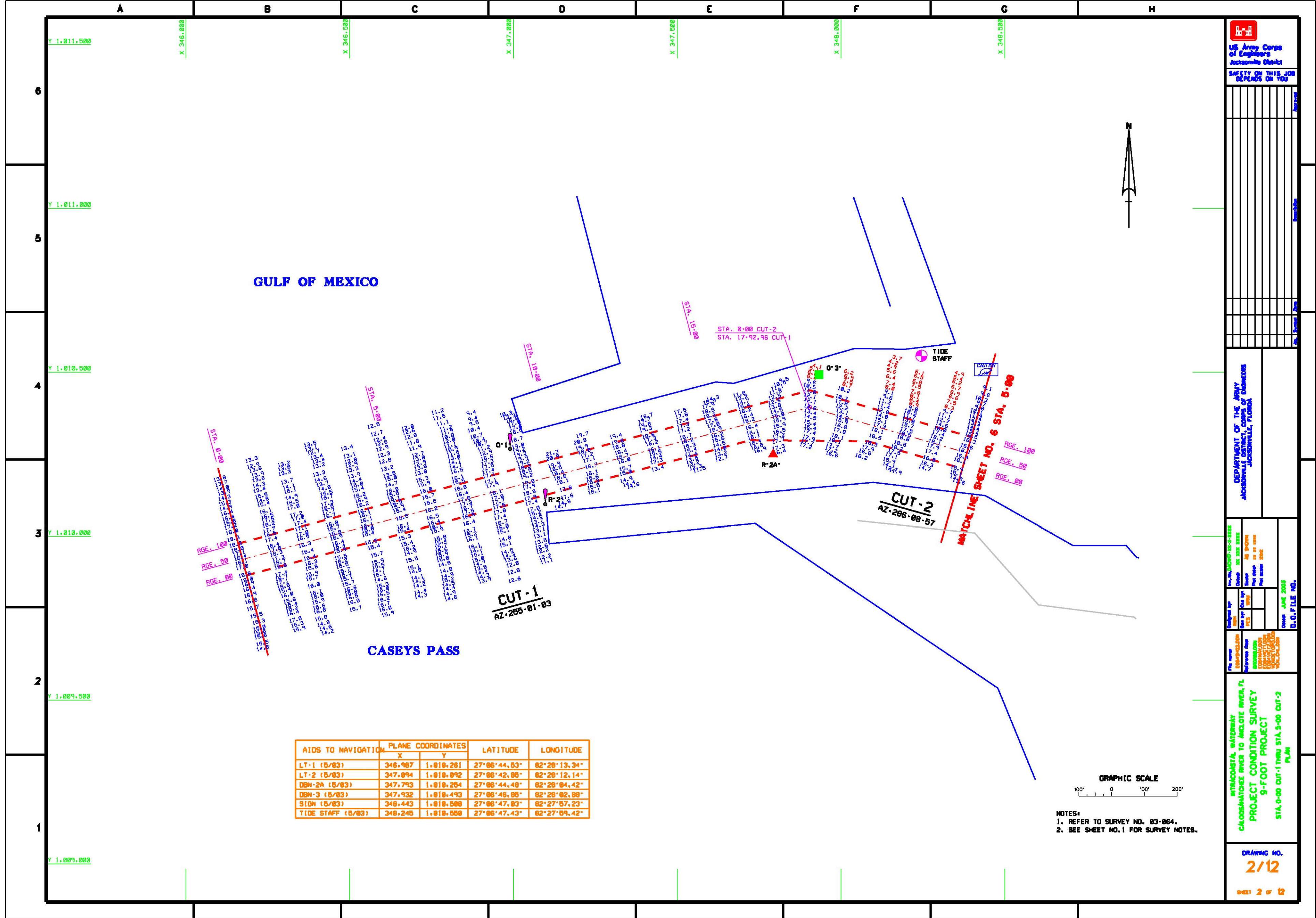

GULF OF MEXICO

CASEYS PASS

CUT-1
AZ:286-01-03

CUT-2
AZ:286-08-57

MATCH LINE SHEET NO. 6 STA. 5+00

AIDS TO NAVIGATION	PLANE COORDINATES		LATITUDE	LONGITUDE
	X	Y		
LT-1 (5/03)	346.987	1.010.261	27°06'44.53"	82°20'13.34"
LT-2 (5/03)	347.094	1.010.092	27°06'42.00"	82°20'12.14"
DBN-2A (5/03)	347.793	1.010.204	27°06'44.48"	82°20'04.42"
DBN-3 (5/03)	347.932	1.010.493	27°06'46.06"	82°20'02.00"
SIDN (5/03)	348.443	1.010.000	27°06'47.03"	82°27'57.23"
TIDE STAFF (5/03)	348.245	1.010.000	27°06'47.43"	82°27'59.42"

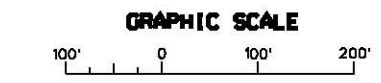

NOTES:
1. REFER TO SURVEY NO. 03-064.
2. SEE SHEET NO. 1 FOR SURVEY NOTES.

US Army Corps of Engineers
Jacksonville District
SAFETY ON THIS JOB
DEPENDS ON YOU

DEPARTMENT OF THE ARMY
Jacksonville District

Designed by: [Name]
Checked by: [Name]
Drawn by: [Name]
Scale: AS SHOWN
Date: [Date]
Sheet: 2 of 12
Drawing No. 2/12

INTRACOSTAL WATERWAY
CROSSMATCHES BRIDGE TO INCLUDE BRIDGE, FL
PROJECT CONDITION SURVEY
9-FOOT PROJECT
STA. 0+00 CUT-1 THRU STA. 5+00 CUT-2
FL/AM

DRAWING NO.
2/12
SHEET 2 OF 12

AIDS TO NAVIGATION	PLANE COORDINATES		LATITUDE	LONGITUDE
	X	Y		
SION (5/83)	355.264	1.086.878	27°06'18.88"	82°26'41.88"
SION (5/83)	355.531	1.086.348	27°06'56.13"	82°26'27.52"
SION (5/83)	355.653	1.085.362	27°05'56.36"	82°26'27.52"
TIDE STAFF (5/83)	355.385	1.086.268	27°06'05.32"	82°26'29.48"
SION (5/83)	355.826	1.086.522	27°06'05.32"	82°26'29.48"

US Army Corps of Engineers
Jacksonville District

SAFETY ON THIS JOB
DEPENDS ON YOU

DEPARTMENT OF THE ARMY
Jacksonville District, Corps of Engineers
Jacksonville, Florida

Designed by: [blank]
Checked by: [blank]
Drawn by: [blank]
Scale: AS SHOWN
Plot date: as built
Plot scale: 1"=50'

Author: JAC, 2005
D.G. FILE NO. [blank]

INTRACOSTAL WATERWAY
CALOOSAHATCHEE RIVER TO ANCLOTE RIVER, FL.
PROJECT CONDITION SURVEY
9-FOOT PROJECT
STA. 0+00 CUT-B THRU STA. 15+00 CUT-B
PLAN

DRAWING NO.
3/12

SHEET 3 OF 12

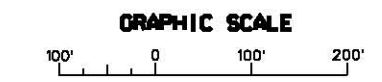

NOTES:
1. REFER TO SURVEY NO. 83-064.
2. SEE SHEET NO. 1 FOR SURVEY NOTES.

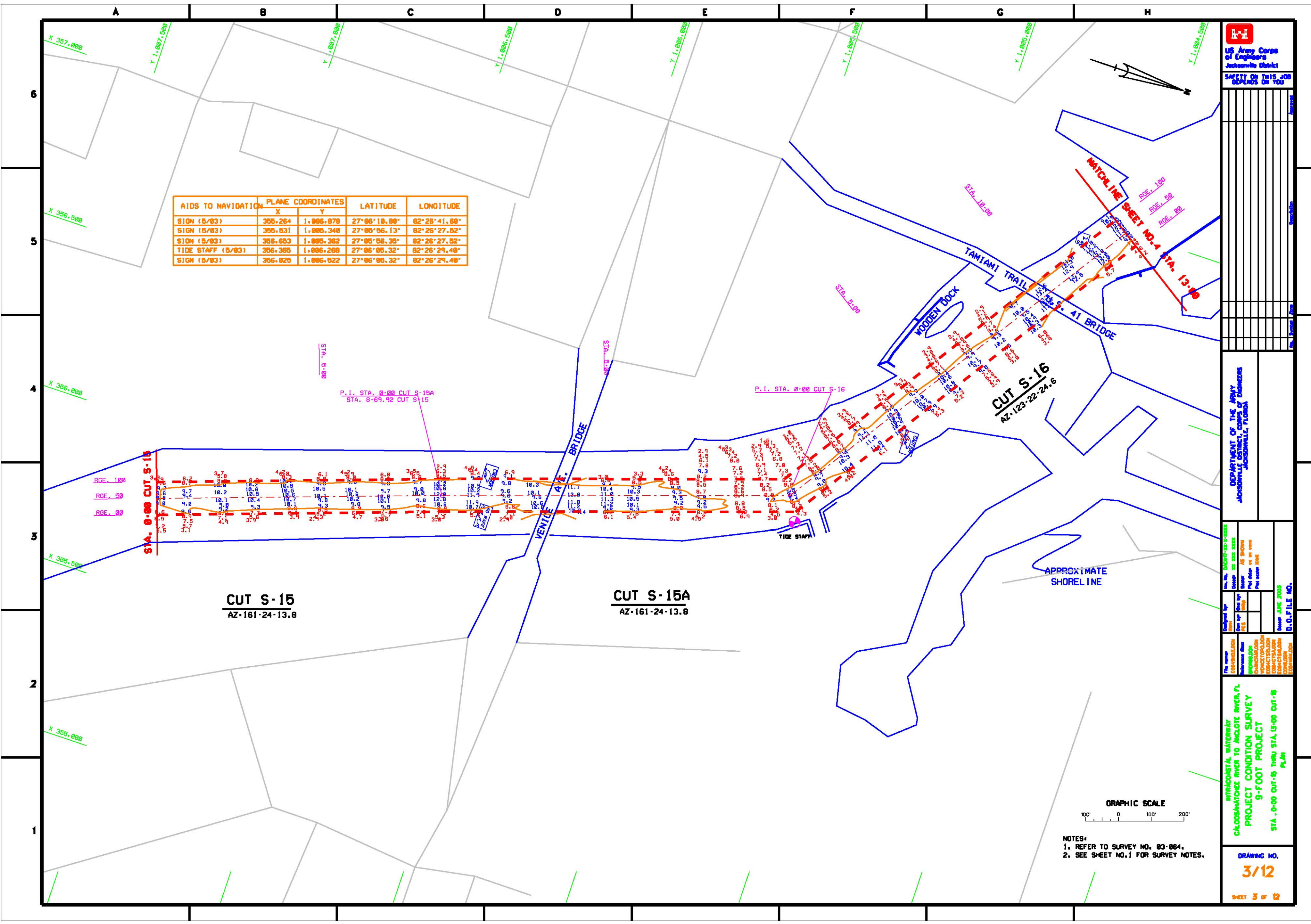

AIDS TO NAVIGATION	PLANE COORDINATES		LATITUDE	LONGITUDE
	X	Y		
DBN-4 (5/83)	354.856	1.887.291	27°06'15.40"	82°26'46.12"
LT-5 (5/83)	354.532	1.887.315	27°06'15.62"	82°26'49.73"
DBN-6 (5/83)	354.688	1.887.476	27°06'17.22"	82°26'48.88"
DBN-8 (5/83)	354.126	1.888.195	27°06'24.33"	82°26'54.24"
DBN-9 (5/83)	353.752	1.888.484	27°06'27.18"	82°26'58.48"
LT-18 (5/83)	353.662	1.889.854	27°06'32.81"	82°27'00.51"
DBN-11 (5/83)	353.838	1.888.917	27°06'31.43"	82°27'05.32"
SIGN (5/83)	353.988	1.888.138	27°06'23.75"	82°26'55.86"
SIGN (5/83)	353.446	1.889.169	27°06'33.95"	82°27'01.81"
PRIV. BUOY (5/83)	353.681	1.889.213	27°06'34.38"	82°27'00.18"
PRIV. BUOY (5/83)	353.639	1.889.122	27°06'33.49"	82°26'59.67"
PRIV. BUOY (5/83)	352.764	1.889.164	27°06'31.43"	82°27'09.35"

US Army Corps of Engineers
Jacksonville District

SAFETY ON THIS JOB
DEPENDS ON YOU

DEPARTMENT OF THE ARMY
Jacksonville, Florida

Drawn by	Checked by	Scale	Sheet No.
DESIGNED BY: J.E.S.	DESIGNED BY: J.E.S.	AS SHOWN	4 OF 12
DATE: 05/20/03	DATE: 05/20/03		

INTRACASTLE WATERWAY
CALOOSAHATCHEE RIVER TO ANCLOTE RIVER, FL.
PROJECT CONDITION SURVEY
9-FOOT PROJECT
STA. 15+00 CUT S-8 THRU STA. 8+00 CUT S-8
PLAN

DRAWING NO.
4/12
SHEET 4 OF 12

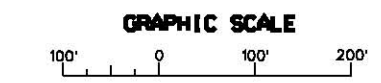

- NOTES:
1. REFER TO SURVEY NO. 83-064.
2. SEE SHEET NO. 1 FOR SURVEY NOTES.

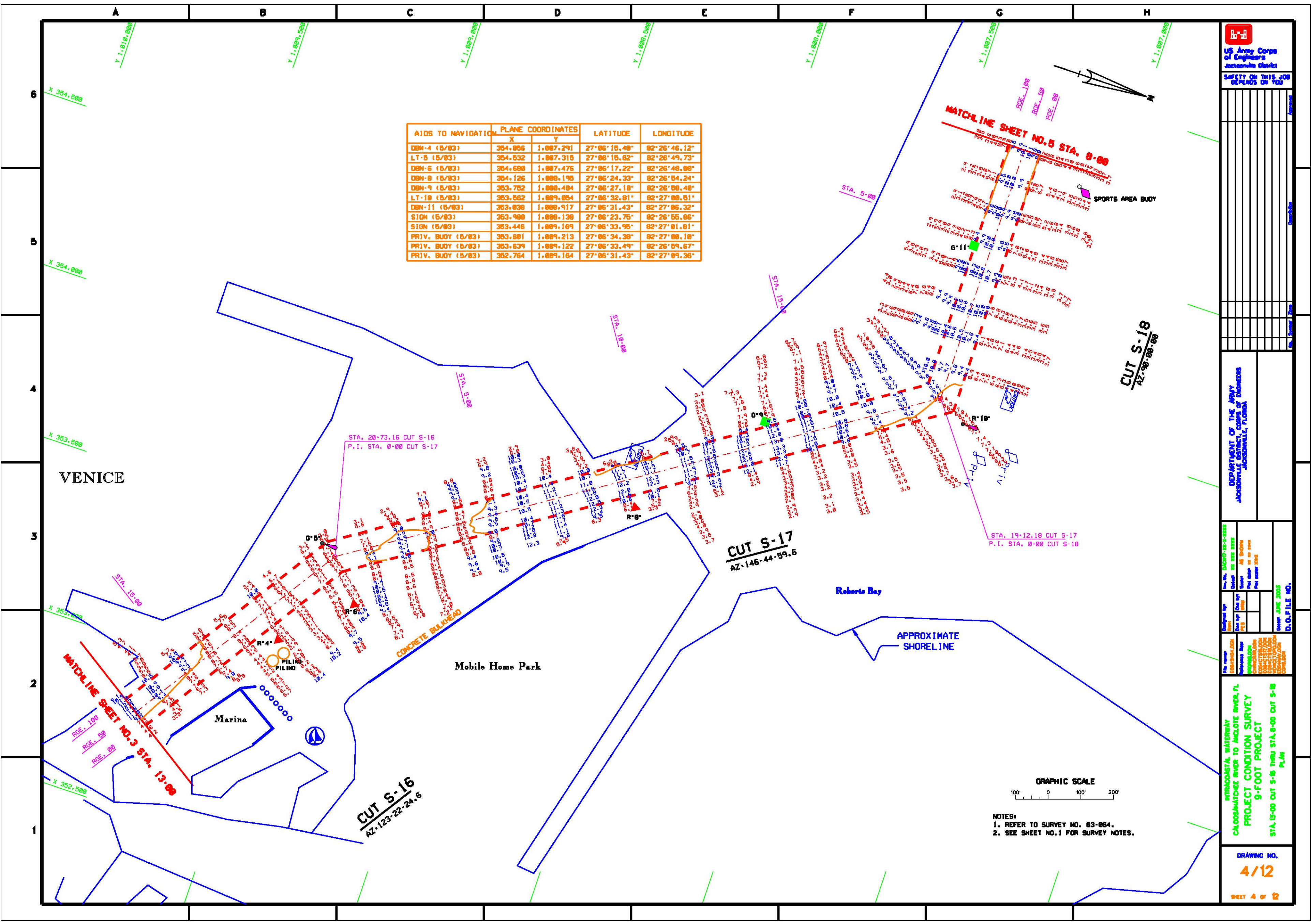

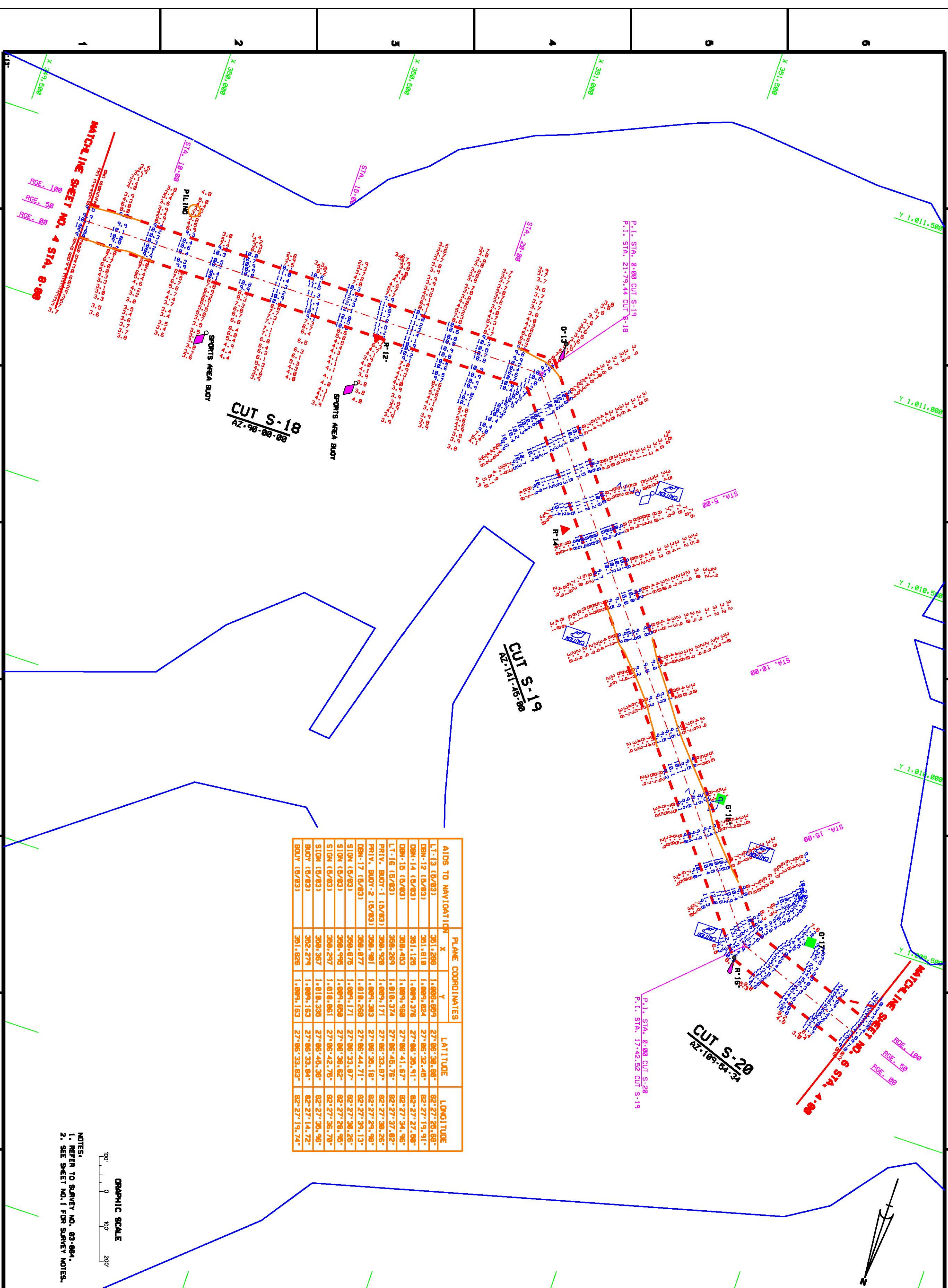

AIDS TO NAVIGATION	PLANE COORDINATES	LATITUDE	LONGITUDE
LT-13 (6/83)	301,288 1,089,893	27°06'38.08"	82°27'28.88"
DBN-12 (6/83)	301,818 1,089,824	27°06'32.48"	82°27'15.91"
DBN-14 (6/83)	301,120 1,089,378	27°06'30.91"	82°27'27.08"
DBN-16 (6/83)	306,403 1,089,468	27°06'41.67"	82°27'34.98"
LT-16 (6/83)	306,259 1,018,374	27°06'46.79"	82°27'37.02"
PRIV. BUOY-1 (6/83)	306,928 1,089,171	27°06'33.87"	82°27'38.26"
PRIV. BUOY-2 (6/83)	306,901 1,089,303	27°06'30.18"	82°27'38.13"
DBN-17 (6/83)	306,877 1,018,298	27°06'44.71"	82°27'38.13"
STON (6/83)	306,876 1,089,171	27°06'33.87"	82°27'38.26"
STON (6/83)	306,979 1,089,608	27°06'38.62"	82°27'38.70"
STON (6/83)	306,297 1,018,338	27°06'46.38"	82°27'38.98"
STON (6/83)	306,279 1,089,153	27°06'33.84"	82°27'14.72"
BUOY (6/83)	301,826 1,089,153	27°06'33.83"	82°27'14.74"

GRAPHIC SCALE
 0 100 200
 NOTES:
 1. REFER TO SURVEY NO. 03-884.
 2. SEE SHEET NO. 1 FOR SURVEY NOTES.

**INTRACOASTAL WATERWAY
 CALOOSAHATCHEE RIVER TO ANCLOTE RIVER, FL
 PROJECT CONDITION SURVEY
 9-FOOT PROJECT
 STA. 8+00 CUT S-18 THRU STA. 4+00 CUT S-20
 PLAN**

**DEPARTMENT OF THE ARMY
 JACKSONVILLE DISTRICT, CORPS OF ENGINEERS
 JACKSONVILLE, FLORIDA**

**US Army Corps of Engineers
 Jacksonville District
 JACKSONVILLE, FLORIDA**

5/12

DRIVING NO.

SHEET 5 OF 2

**DATE: JUNE 2003
 D.O. FILE NO.**

SAFETY ON THIS JOB
DEPENDS ON YOU

AIDS TO NAVIGATION	PLANE COORDINATES		LATITUDE	LONGITUDE
	X	Y		
LT-1 (5/83)	346,987	1,010,261	27°06'44.53"	82°28'13.34"
LT-4 (5/83)	349,193	1,010,029	27°06'58.22"	82°27'48.94"
LT-5 (5/83)	348,087	1,011,023	27°06'52.12"	82°27'55.65"
DBN-3 (5/83)	349,213	1,010,678	27°06'48.78"	82°27'48.72"
DBN-4A (5/83)	348,763	1,011,132	27°06'53.22"	82°27'53.72"
DBN-5 (5/83)	348,788	1,010,242	27°06'44.48"	82°27'53.78"
DBN-6 (5/83)	348,487	1,011,534	27°06'57.18"	82°27'56.78"
DBN-7 (5/83)	349,185	1,010,280	27°06'44.88"	82°27'49.33"
DBN-7 (5/83)	348,856	1,012,888	27°07'52.58"	82°28'01.57"
SIGN (5/83)	348,538	1,010,954	27°06'51.45"	82°27'56.28"
SIGN (5/83)	348,216	1,012,285	27°07'53.82"	82°27'59.85"
SIGN (5/83)	348,491	1,010,112	27°06'43.11"	82°27'56.68"
SIGN (5/83)	349,239	1,010,286	27°06'44.86"	82°27'48.41"

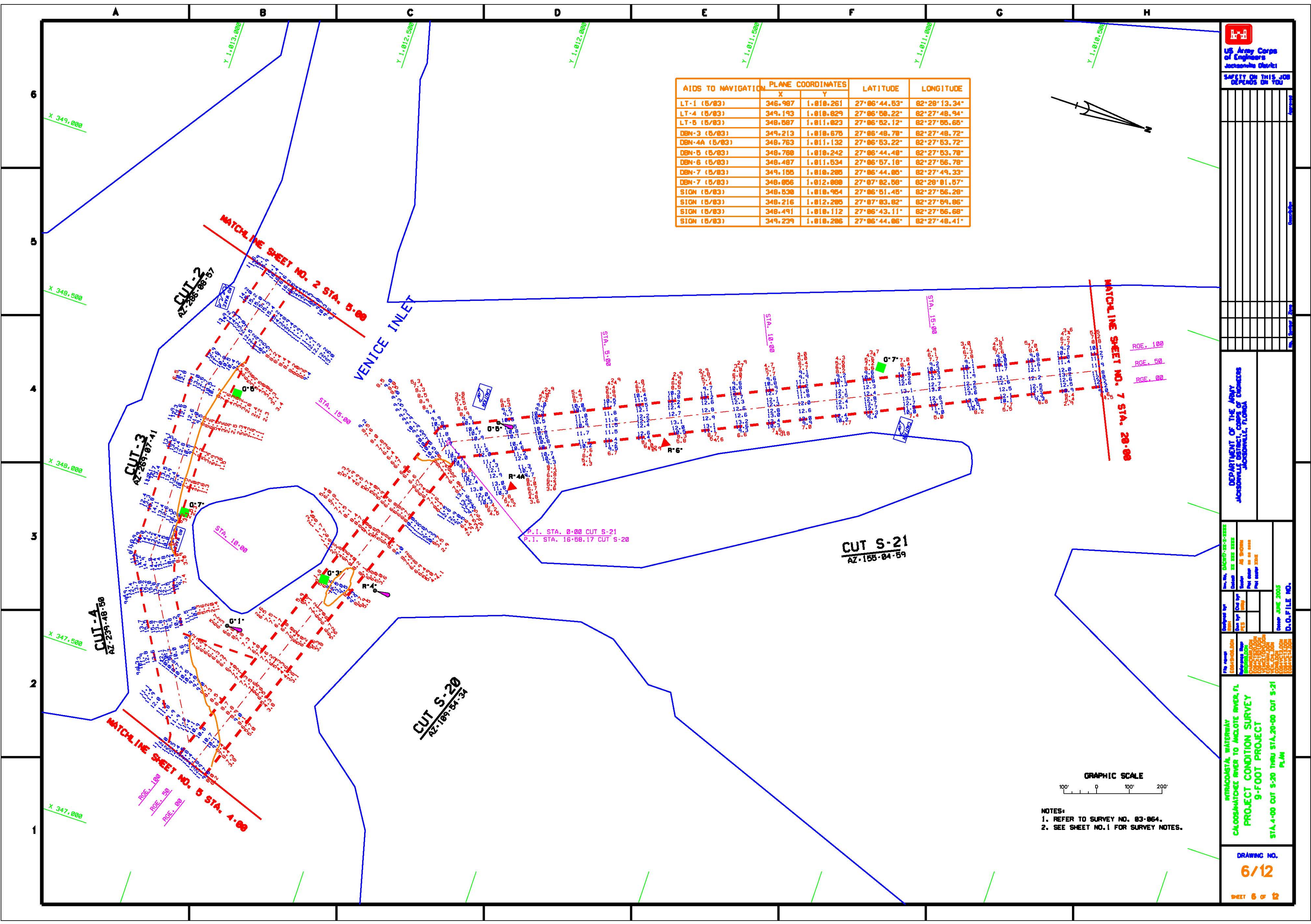
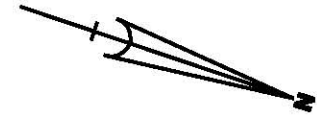

DEPARTMENT OF THE ARMY
Jacksonville District

Drawn by	Checked by	Scale
Designed by	Reviewed by	Date
Project No.	Sheet No.	Project Name

INTRACASTLE WATERWAY
CALOOSAHATCHEE RIVER TO ANCLOTE RIVER, FL.
PROJECT CONDITION SURVEY
9-FOOT PROJECT
STA. 4+00 CUT S-20 THRU STA. 20+00 CUT S-21
PLAN

GRAPHIC SCALE
100' 0 100' 200'

NOTES:
1. REFER TO SURVEY NO. 83-064.
2. SEE SHEET NO. 1 FOR SURVEY NOTES.

DRAWING NO.
6/12
SHEET 6 OF 12

AIDS TO NAVIGATION	PLANE COORDINATES		LATITUDE	LONGITUDE
	X	Y		
DBN-8 (5/83)	347.818	1.012.936	27°07'11.83"	82°28'04.28"
LT-9 (5/83)	347.419	1.013.477	27°07'16.39"	82°28'06.78"
DBN-10 (5/83)	347.893	1.013.893	27°07'17.54"	82°28'06.76"
LT-12 (5/83)	347.266	1.015.627	27°07'37.68"	82°28'10.46"
TIDESTAFF (5/83)	347.388	1.014.282	27°07'23.56"	82°28'10.83"
SIGN (5/83)	347.392	1.013.628	27°07'17.86"	82°28'08.98"
SIGN (5/83)	347.844	1.013.579	27°07'17.60"	82°28'06.19"
SIGN (5/83)	347.886	1.013.634	27°07'17.98"	82°28'06.84"

US Army Corps of Engineers
Jacksonville District

SAFETY ON THIS JOB
DEPENDS ON YOU

DEPARTMENT OF THE ARMY
JACKSONVILLE DISTRICT

Drawn by: [blank]
Checked by: [blank]
Reviewed by: [blank]
Date: 08-20-03
D.G. FILE NO.

INTRACASTA, WATERWAY
CALOOSAHATCHEE RIVER TO ANCLOTE RIVER, FL
PROJECT CONDITION SURVEY
9-FOOT PROJECT
STA. 20+00 CUT S-21 thru STA. 1+00 CUT S-23
PLAN

DRAWING NO.
7/12
SHEET 7 OF 12

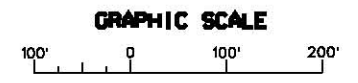
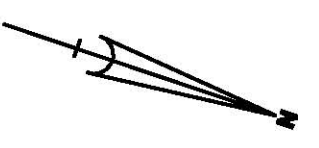

NOTES:
1. REFER TO SURVEY NO. 83-864.
2. SEE SHEET NO. 1 FOR SURVEY NOTES.

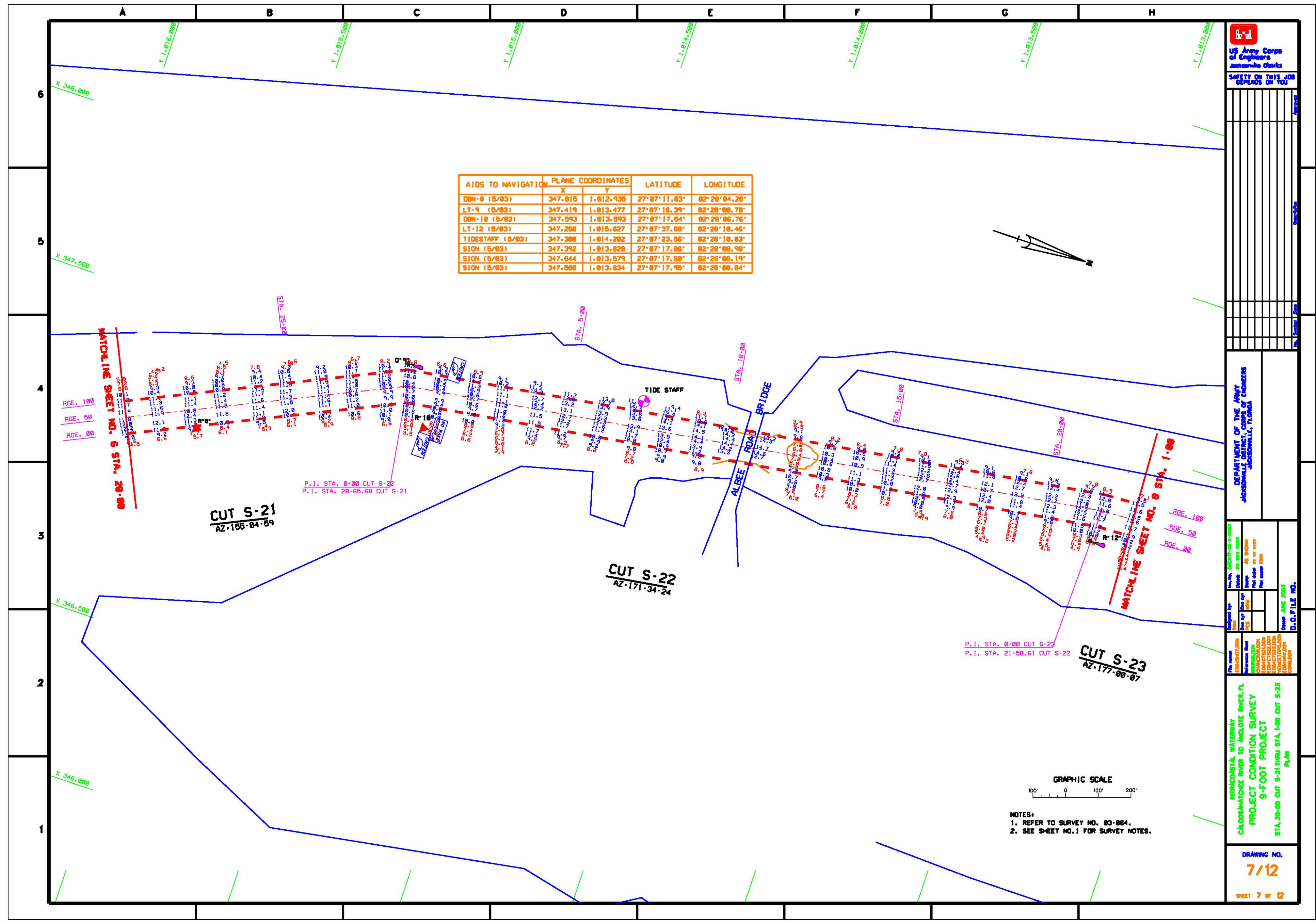

AIDS TO NAVIGATION	PLANE COORDINATES		LATITUDE	LONGITUDE
	X	Y		
CAN BUOY-13 (5/03)	347.038	1.017.186	27°07'53.11"	82°28'13.86"
SIGN (5/03)	347.188	1.017.101	27°07'52.28"	82°28'11.39"
SIGN (5/03)	347.085	1.017.082	27°07'52.98"	82°28'13.41"
DBN-14 (5/03)	347.078	1.018.646	27°08'08.86"	82°28'12.67"

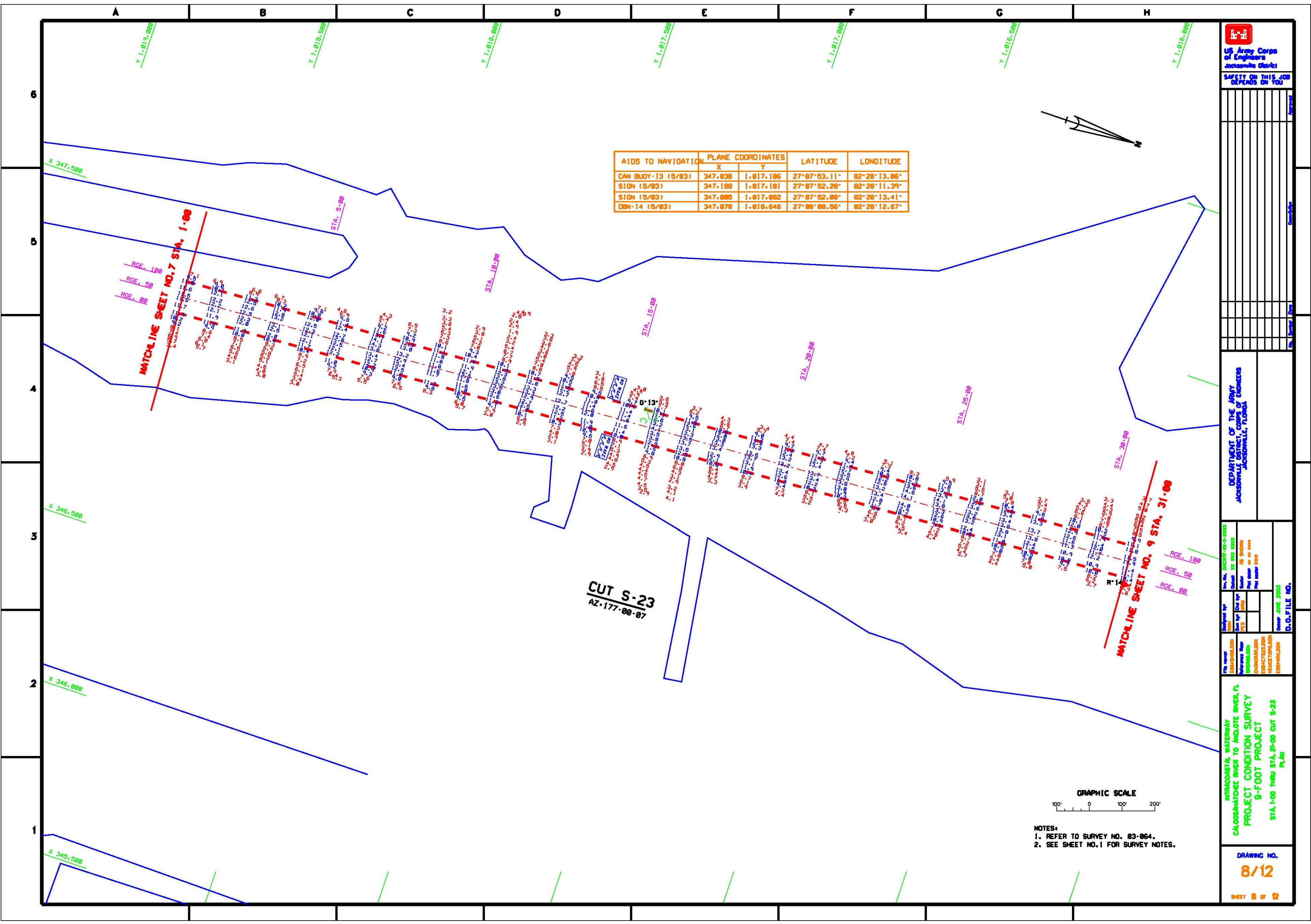

CUT S-23
AZ-177-00-07

MATCHLINE SHEET NO. 7 STA. 1+00

MATCHLINE SHEET NO. 9 STA. 31+00



NOTES:
1. REFER TO SURVEY NO. 83-064.
2. SEE SHEET NO. 1 FOR SURVEY NOTES.

US Army Corps of Engineers
Jacksonville District

SAFETY ON THIS JOB DEPENDS ON YOU

DEPARTMENT OF THE ARMY
CORPS OF ENGINEERS
JACKSONVILLE DISTRICT

Designed by	Checked by	Drawn by	Scale
Reviewed by	Approved by	Project No.	Sheet No.
Project No.	Scale	Sheet No.	Project No.

INTRACOUNTY WATERWAY
CALOOSAHATCHEE RIVER TO ANCLOTE RIVER, FL.
PROJECT CONDITION SURVEY
9-FOOT PROJECT
STA. 1+00 THRU STA. 31+00 CUT S-23
PLAN

DRAWING NO.
8/12

SHEET 8 OF 12

AIDS TO NAVIGATION	PLANE COORDINATES		LATITUDE	LONGITUDE
	X	Y		
DBN-14 (5/83)	347.878	1.018.745	27°08'08.55"	82°28'12.67"
DBN-15 (5/83)	346.764	1.020.326	27°08'24.28"	82°28'16.33"
LT-16 (5/83)	346.846	1.020.776	27°08'28.65"	82°28'15.33"
DBN-17 (5/83)	346.353	1.021.388	27°08'34.81"	82°28'28.81"



US Army Corps of Engineers
Jacksonville District

SAFETY ON THIS JOB
DEPENDS ON YOU

DEPARTMENT OF THE ARMY
Jacksonville District

PROJECT NO. 03-064
PROJECT TITLE
DATE
SCALE
DRAWN BY
CHECKED BY
APPROVED BY

INTRACAST/A WATERWAY
CALOOSAHATCHEE RIVER TO ANCLOTE RIVER, FL
PROJECT CONDITION SURVEY
9-FOOT PROJECT
STA. 31+00 CUT S-23 THRU STA. 14+00 CUT S-25
PLAN

DRAWING NO.
9/12

SHEET 9 OF 12

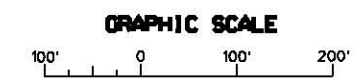

NOTES:
1. REFER TO SURVEY NO. 03-064.
2. SEE SHEET NO. 1 FOR SURVEY NOTES.

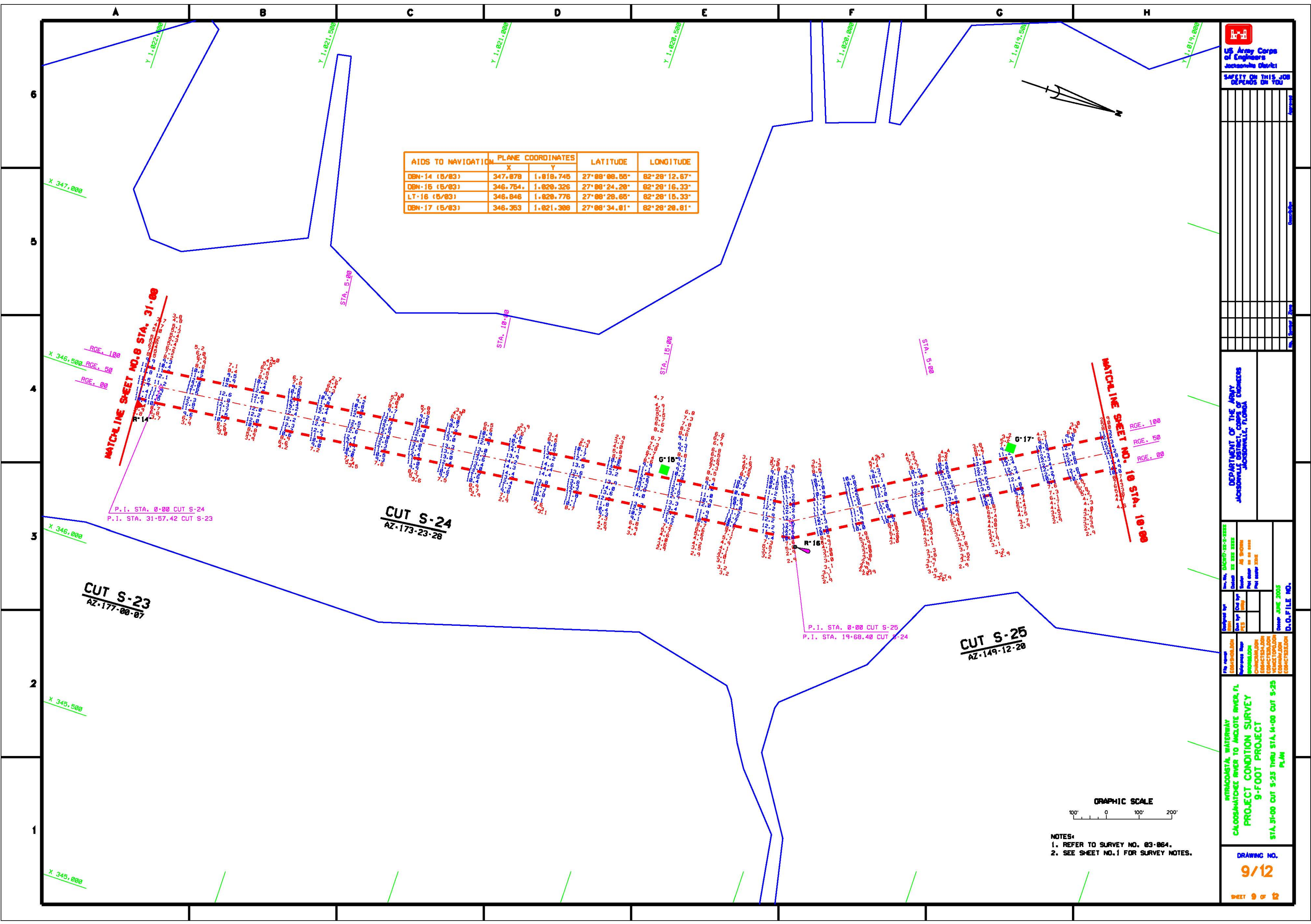

SAFETY ON THIS JOB
DEPENDS ON YOU

AID TO NAVIGATION	PLANE COORDINATES		LATITUDE	LONGITUDE
	X	Y		
DBN-19 (8/83)	345.647	1,822.664	27°08'47.31"	82°28'29.79"

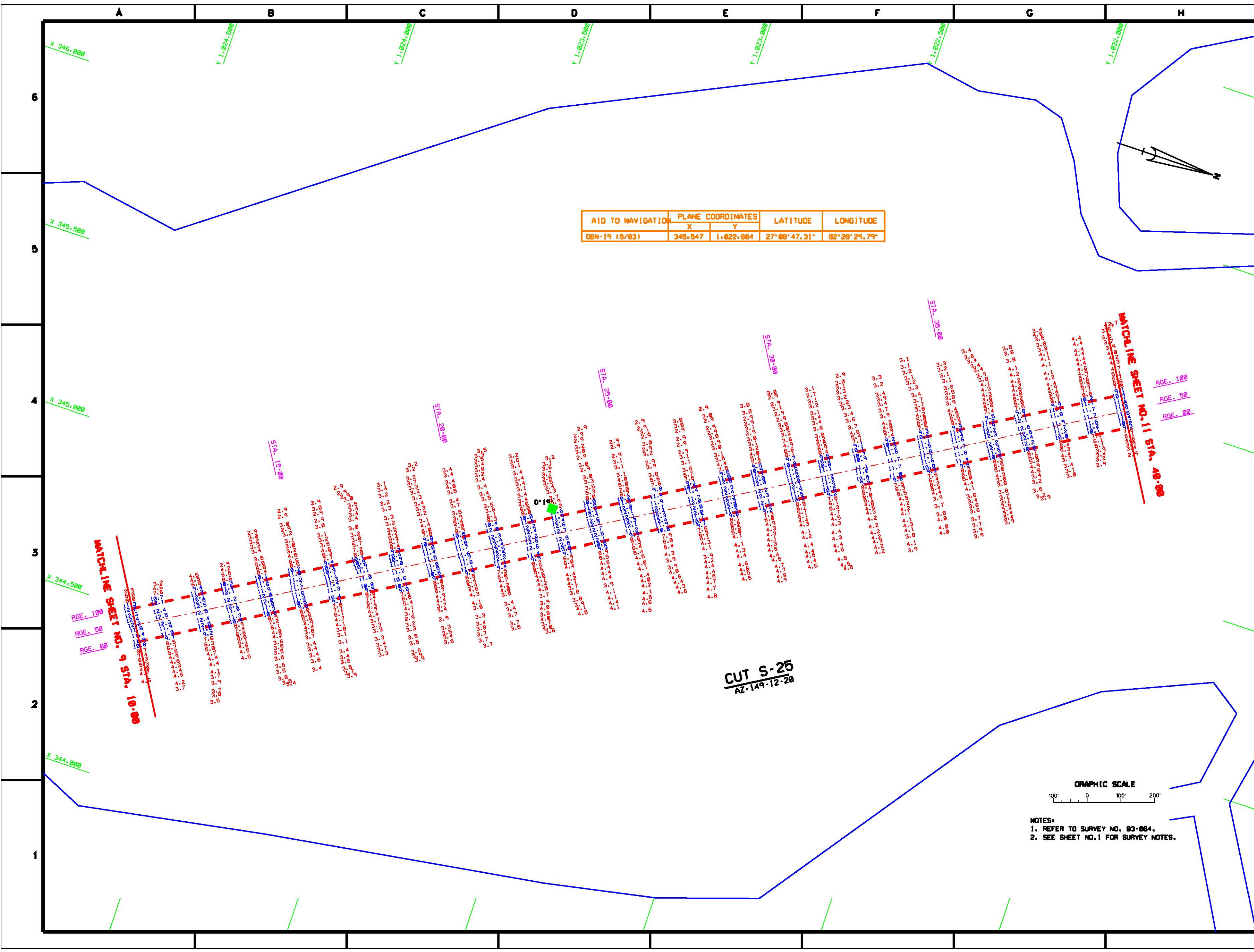

CUT S-25
AZ-149-12-26



NOTES:
1. REFER TO SURVEY NO. 83-864.
2. SEE SHEET NO. 1 FOR SURVEY NOTES.

DEPARTMENT OF THE ARMY
JACKSONVILLE DISTRICT

NO.	DATE	BY	DESCRIPTION

DESIGNED BY: [Name]
CHECKED BY: [Name]
DATE: 8-18-2015

INTRACOUNTY WATERWAY
CALOOSAHATCHEE RIVER TO ANCLOTE RIVER, FL.
PROJECT CONDITION SURVEY
9-FOOT PROJECT
STA. 0+00 THRU STA. 40+00 CUT S-25
PLAN

DRAWING NO.
10/12

AIDS TO NAVIGATION	PLANE COORDINATES		LATITUDE	LONGITUDE
	X	Y		
DBN-20 (5/83)	344.686	1.824.667	27°09'06.02"	82°28'48.27"
DBN-21 (5/83)	343.455	1.826.149	27°09'21.74"	82°29'01.66"
SIDN (5/83)	344.371	1.824.247	27°09'02.93"	82°28'42.87"



US Army Corps of Engineers
Jacksonville District

SAFETY ON THIS JOB
DEPENDS ON YOU

DEPARTMENT OF THE ARMY
Jacksonville District

Drawn by	Checked by	Scale	Date
DESIGNED BY	DESIGNED BY	AS SHOWN	AS SHOWN
DESIGNED BY	DESIGNED BY	AS SHOWN	AS SHOWN
DESIGNED BY	DESIGNED BY	AS SHOWN	AS SHOWN

INTRACASTLE WATERWAY
CALOOSAHATCHEE RIVER TO ANCLOTE RIVER, FL.
PROJECT CONDITION SURVEY
9-FOOT PROJECT
STA. 40+00 THRU STA. 70+00 CUT S-25
PLAN

DRAWING NO.
11/12



NOTES:
1. REFER TO SURVEY NO. 83-864.
2. SEE SHEET NO. 1 FOR SURVEY NOTES.

CUT S-25
AZ-149-12-28

MATCHLINE SHEET NO. 10 STA. 48+00

MATCHLINE SHEET NO. 12 STA. 70+00

RGE. 100
RGE. 50
RGE. 00

RGE. 100
RGE. 50
RGE. 00

0+21

STA. 55+00

STA. 60+00

STA. 65+00

STA. 45+00

X 344.500

Y 1.827.800

Y 1.826.500

Y 1.825.800

Y 1.825.500

Y 1.825.000

Y 1.824.500

X 344.000

X 343.500

X 343.000

X 342.500

6

5

4

3

2

1

A

B

C

D

E

F

G

H

SAFETY ON THIS JOB
DEPENDS ON YOU

AIDS TO NAVIGATION	PLANE COORDINATES		LATITUDE	LONGITUDE
	X	Y		
DBN-22 (5/03)	342.687	1.827.777	27°09'37.83"	82°29'01.66"
LT-23 (5/03)	342.641	1.827.784	27°09'37.18"	82°29'03.27"

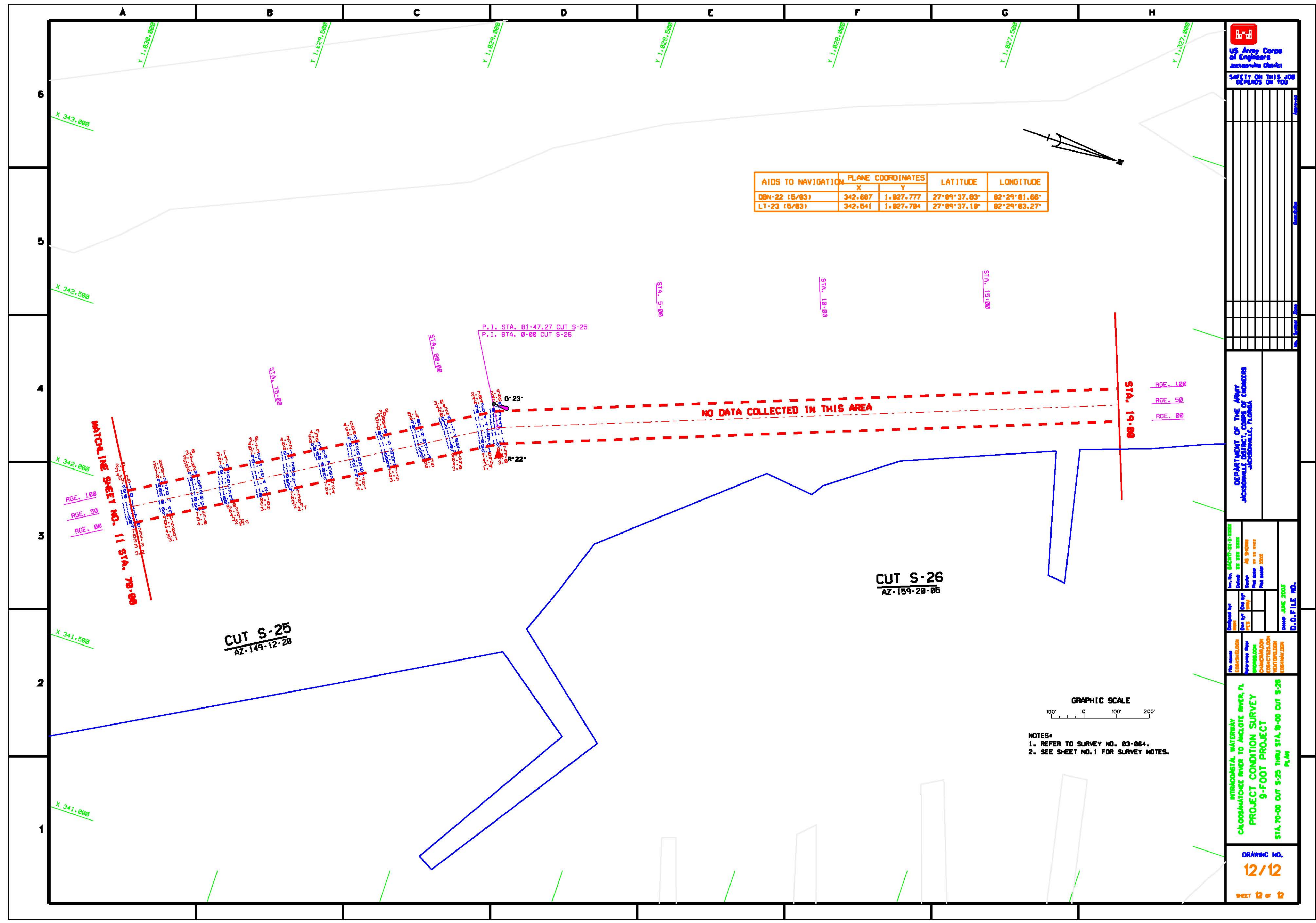

MATCHLINE SHEET NO. 11 STA. 70+00

CUT S-25
AZ-149-12-20

CUT S-26
AZ-159-20-05

NO DATA COLLECTED IN THIS AREA

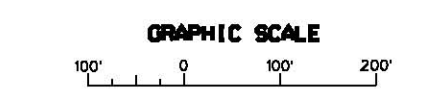

NOTES:
1. REFER TO SURVEY NO. 03-064.
2. SEE SHEET NO. 1 FOR SURVEY NOTES.

DEPARTMENT OF THE ARMY
Jacksonville, Florida

Drawn by	Checked by	Scale	Date
DESIGNED BY: [Redacted]	DESIGNED BY: [Redacted]	AS SHOWN	NO DATE
DESIGNED BY: [Redacted]	DESIGNED BY: [Redacted]	AS SHOWN	NO DATE
DESIGNED BY: [Redacted]	DESIGNED BY: [Redacted]	AS SHOWN	NO DATE
DESIGNED BY: [Redacted]	DESIGNED BY: [Redacted]	AS SHOWN	NO DATE

INTRACAST/A, WATERWAY
CALOOSAHATCHEE RIVER TO ANCLOTE RIVER, FL
PROJECT CONDITION SURVEY
9-FOOT PROJECT
STA. 70+00 CUT S-25 THRU STA. 9+00 CUT S-26
PLAN

DRAWING NO.
12/12
SHEET 12 OF 12