

DAYTONA BEACH SIDE CHANNEL VOLUSIA COUNTY, FLORIDA PROJECT CONDITION SURVEY

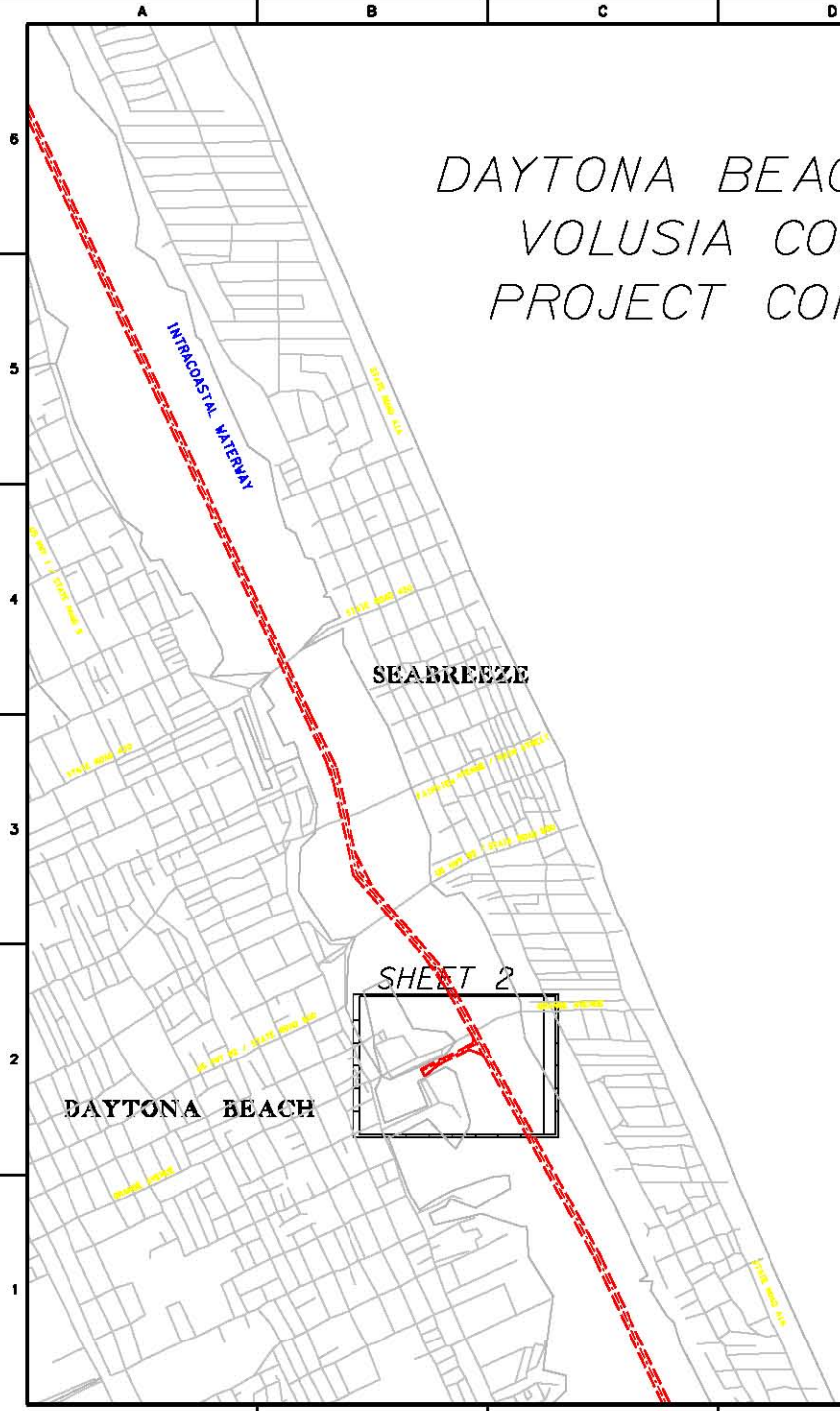

SURVEY NOTES

- REFER TO SURVEY NO. 03-024.
- SOUNDINGS ARE IN FEET AND TENTHS AND REFER TO MEAN LOW WATER (MLW) WHICH IS 0.70 FEET BELOW NGVD 1929.
- ALL ELEVATIONS ARE BELOW THE CHART DATUM UNLESS PRECEDED BY A (+) SIGN.
- TIDAL REDUCTIONS WERE MADE FROM A STAFF SET IN THE VICINITY OF, AND REFERENCED FROM BENCHMARK "INV-227".
- PLANE COORDINATES ARE BASED ON THE TRANSVERSE MERCATOR PROJECTION FOR THE EAST ZONE OF FLORIDA AND REFERENCED TO NORTH AMERICAN DATUM OF 1927 (NAD27).
- ALL AZIMUTHS ARE GRID, RECKONED CLOCKWISE FROM SOUTH.
- ALL STATIONING REFERS TO THE CENTERLINE OF THE CHANNEL.
- SURVEY WAS PERFORMED USING DIFFERENTIAL GPS FOR POSITIONING AND UTILIZING THE USCG NAVIGATOR SYSTEM AS THE REFERENCE SITE. VERTICAL MEASUREMENTS WERE MADE USING A ROSS SMART SOUNDER DEPTH RECORDER WITH A 100KHZ (HIGH FREQUENCY) TRANSDUCER.

VESSEL	DATE OF SURVEY	CUT
WB-34	27 FEB 2003	SIDE CHANNEL

- ADS TO NAVIGATION WERE LOCATED DURING THIS SURVEY.
- THE INFORMATION DEPICTED ON THIS MAP REPRESENTS THE RESULTS OF SURVEYS MADE ON THE DATES INDICATED ABOVE AND CAN ONLY BE CONSIDERED AS INDICATING THE GENERAL CONDITIONS AT THAT TIME.
- SURVEY ACCURACY PERFORMANCE STANDARDS, QUALITY CONTROL, AND QUALITY ASSURANCE STANDARDS WERE FOLLOWED DURING THIS SURVEY IN ACCORDANCE WITH USACE EM 110-2-1003, HYDROGRAPHIC SURVEYING, 1 JAN 02.

BENCHMARK	NGVD ELEV. (FT)
INV-227	4.13

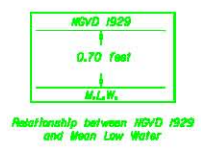
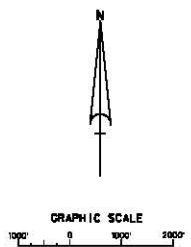

LEGEND	
BM	BENCHMARK
L	LIGHTED BEACON
GB	GREEN DAYBEACON
RB	RED DAYBEACON
LB	RED LIGHTED BUOY
GB	GREEN LIGHTED BUOY
S	SUN BUOY
MB	MIL BUOY
T	TIDE STAFF

US Army Corps of Engineers

 Jacksonville District

 SAFETY ON THIS JOB DEPENDS ON YOU

DEPARTMENT OF THE ARMY

 JACKSONVILLE DISTRICT

 JACKSONVILLE, FLORIDA

DAYTONA BEACH

 VOLUSIA COUNTY, FLORIDA

 PROJECT CONDITION SURVEY

 8-FOOT PROJECT

 COVER, PROX. AND LOCATION

 PLAN

DRAWING NO.

1/2

 SHEET 1 OF 2

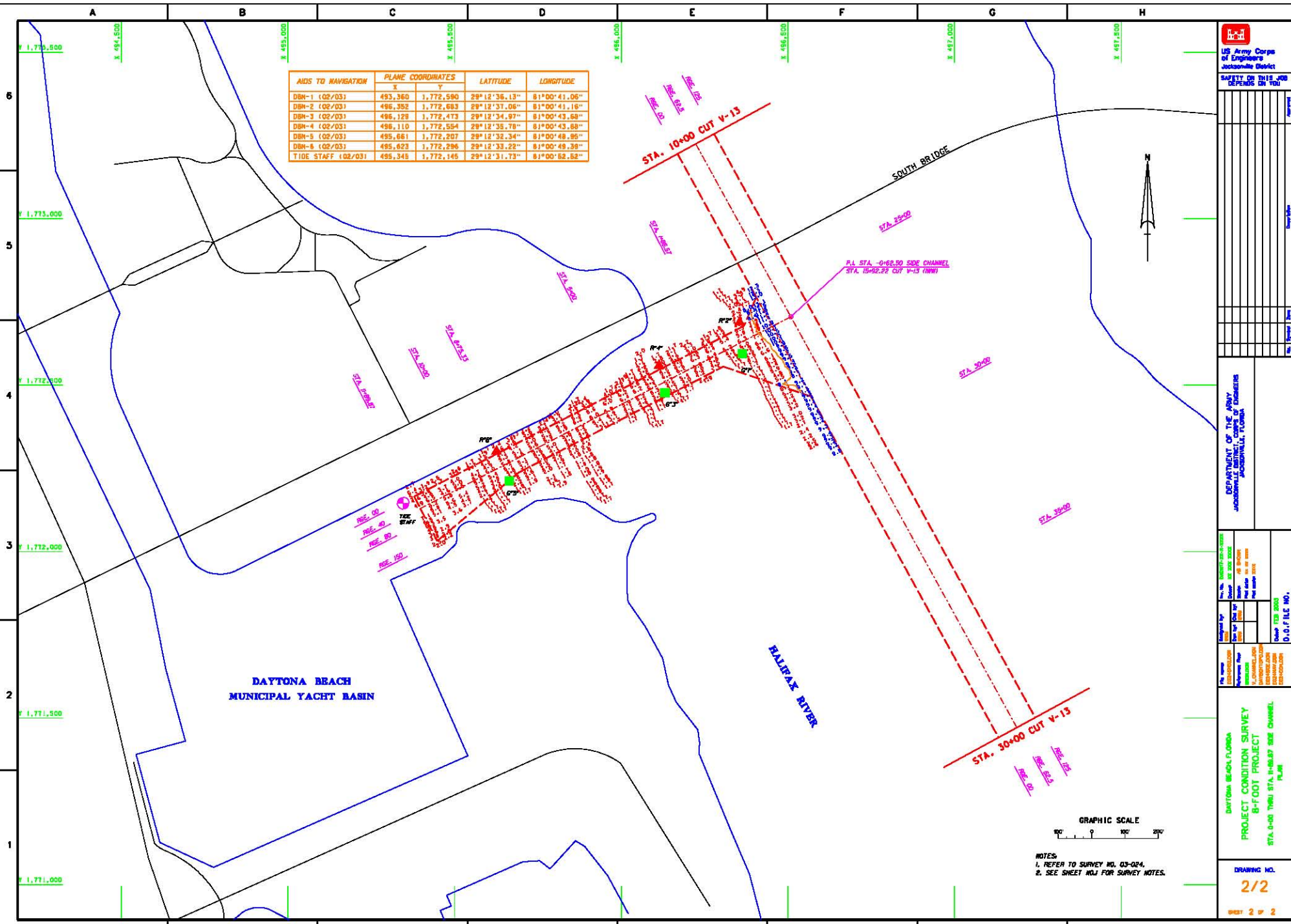

AIDS TO NAVIGATION	PLANE COORDINATES		LATITUDE	LONGITUDE
	X	Y		
DBN-1 (02/03)	493,360	1,772,590	29°12'36.13"	81°00'41.06"
DBN-2 (02/03)	495,352	1,772,693	29°12'37.06"	81°00'41.19"
DBN-3 (02/03)	496,128	1,772,473	29°12'34.97"	81°00'43.69"
DBN-4 (02/03)	496,110	1,772,554	29°12'35.76"	81°00'43.69"
DBN-5 (02/03)	495,661	1,772,207	29°12'32.34"	81°00'48.95"
DBN-6 (02/03)	495,623	1,772,296	29°12'33.22"	81°00'49.39"
TIDE STAFF (02/03)	495,345	1,772,145	29°12'31.73"	81°00'52.62"



 US Army Corps of Engineers

 Jacksonville District

 SAFETY IS THE JOB

 DEPENDS ON YOU

DEPARTMENT OF THE ARMY

 JACKSONVILLE DISTRICT

Drawn by	DATE
Checked by	DATE
Approved by	DATE

DAYTONA BEACH, FLORIDA

 PROJECT CONDITION SURVEY

 8'-FOOT PROJECT

 STA. 0+00 THRU STA. 34+00 SIDE CHANNEL

 PLAN

DRAWING NO.

2/2

 SHEET 2 OF 2

GRAPHIC SCALE

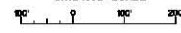

 NOTES:

 1. REFER TO SURVEY NO. 03-024.

 2. SEE SHEET NO. 1 FOR SURVEY NOTES.